



US00D589791S

(12) **United States Design Patent**
Kalberer

(10) **Patent No.:** **US D589,791 S**
(45) **Date of Patent:** **** Apr. 7, 2009**

(54) **CARTON**

D244,993 S 7/1977 Drysdale
4,155,500 A * 5/1979 Dutcher 229/120

(75) Inventor: **Roderick William Kalberer**, Cincinnati, OH (US)

(Continued)

(73) Assignee: **Evergreen Packaging Inc.**, Memphis, TN (US)

FOREIGN PATENT DOCUMENTS

EP 0 277 673 A1 8/1988

(**) Term: **14 Years**

(Continued)

(21) Appl. No.: **29/324,065**

OTHER PUBLICATIONS

(22) Filed: **Sep. 5, 2008**

Portion Package For Pourable Food Products, RD 414041, Oct. 1998, Research Disclosure Journal, ISSN 0374-4353.

(Continued)

Related U.S. Application Data

(62) Division of application No. 29/302,670, filed on Jan. 22, 2008, now Pat. No. Des. 578,389.

Primary Examiner—T. Chase Nelson

Assistant Examiner—Karen Acker

(51) **LOC (9) Cl.** **09-03**

(52) **U.S. Cl.** **D9/432**

(58) **Field of Classification Search** D9/430-433,
D9/414-418, 420-429, 560, 737, 756; D3/273,
D3/302; 206/421, 454, 457, 775-778, 784,
206/822; 220/500, 523-529, 552, 555; 229/100,
229/103.3, 104-106, 108, 108.1, 109, 110,
229/112-116, 116.1, 116.2, 117.15, 120,
229/125.015, 132, 138, 155, 162.1, 162.6,
229/162.7, 182.1, 213, 214, 247, 406, 407,
229/902, 911, 922, 930, 942, 137, 215-219,
229/248, 249

(74) *Attorney, Agent, or Firm*—Donald E. Hasse; Hasse & Nesbitt LLC

(57) **CLAIM**

The ornamental design for a carton, as shown and described.

See application file for complete search history.

DESCRIPTION

FIG. 1 is a top perspective view of the carton.
FIG. 2 is a bottom perspective view of the carton.
FIG. 3 is a front elevational view of the carton.
FIG. 4 is a back elevational view of the carton.
FIG. 5 is a left side elevational view of the carton.
FIG. 6 is a right side elevational view of the carton.
FIG. 7 is a top plan view of the carton.
FIG. 8 is a bottom plan view of the carton; and,
FIG. 9 is a sectional plan view of the carton taken along line 9-9 of FIG. 1.

The broken lines in the drawings represent unclaimed parts of the design included for the purpose of showing the design in a position of use and form no part of the claimed design.

(56) **References Cited**

U.S. PATENT DOCUMENTS

2,050,894 A	8/1936	Paige	
2,067,998 A	1/1937	Williamson	
D183,717 S	10/1958	Casler	
D194,246 S	12/1962	Engelmann	
3,126,143 A	3/1964	Hagan	
3,343,660 A *	9/1967	Bailey 229/114
3,365,111 A *	1/1968	Columbo et al. 229/249
3,610,514 A	10/1971	Samsing	
3,799,425 A *	3/1974	Fanter 229/126

1 Claim, 5 Drawing Sheets

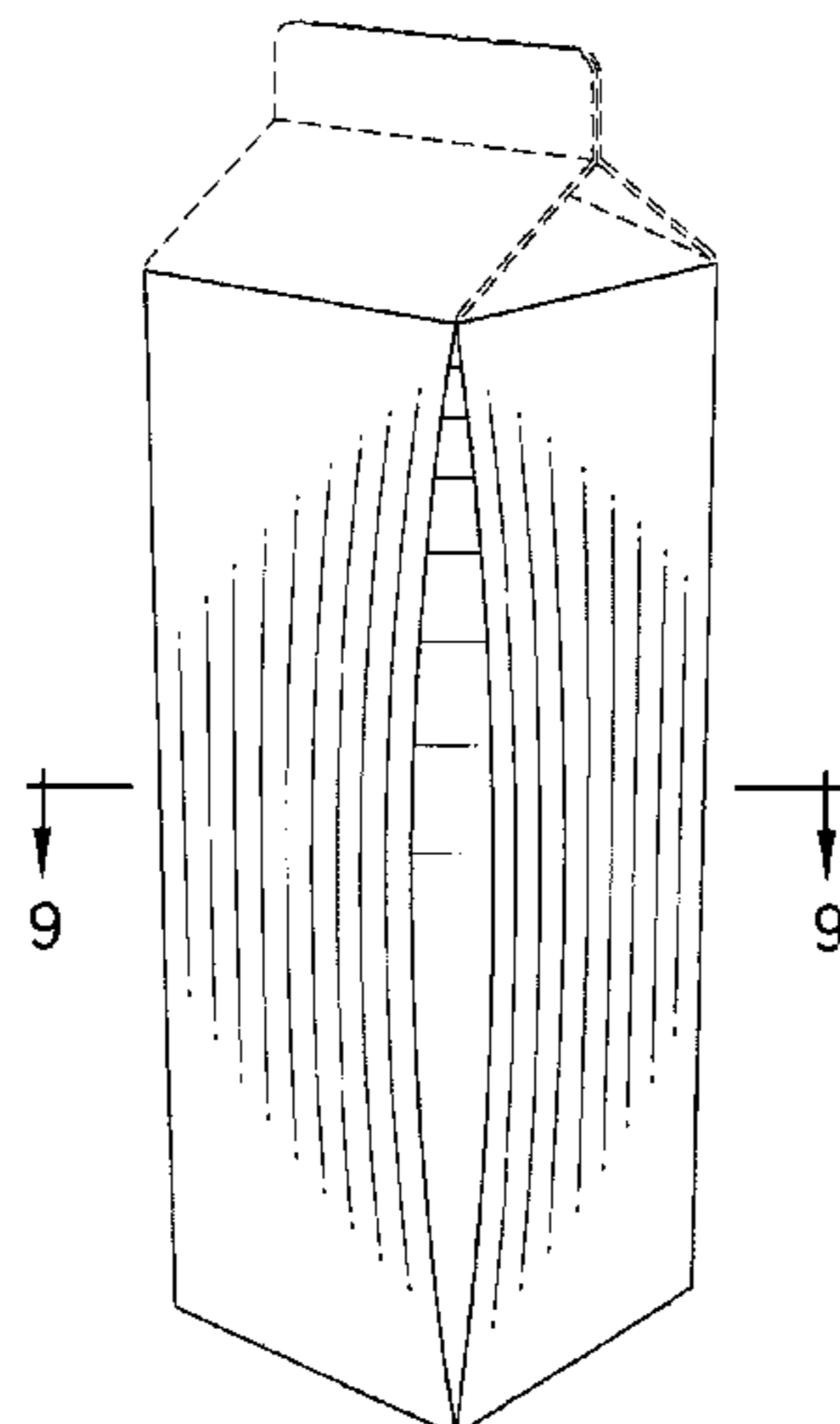

US D589,791 S

Page 2

U.S. PATENT DOCUMENTS

4,192,446 A * 3/1980 Naito 229/137
 4,206,867 A * 6/1980 Skjelby 229/248
 D261,613 S * 11/1981 Forbes, Jr. D9/418
 4,313,556 A 2/1982 Boyle et al.
 4,394,954 A * 7/1983 Lisiecki 229/249
 4,432,489 A * 2/1984 Cote 229/112
 4,586,643 A * 5/1986 Halabisky et al. 229/199
 4,601,425 A * 7/1986 Bachner 229/179
 4,813,546 A * 3/1989 Gordon et al. 229/214
 4,846,396 A 7/1989 Palazzolo
 4,871,080 A * 10/1989 Bennett 220/62
 4,887,709 A * 12/1989 Shimamine 206/6.1
 4,964,562 A 10/1990 Gordon
 5,018,660 A * 5/1991 Esper et al. 229/125.42
 5,143,281 A * 9/1992 Mainz et al. 229/132
 5,474,232 A * 12/1995 Ljungstrom et al. 229/137
 5,636,785 A * 6/1997 Kalberer et al. 229/137
 D389,055 S 1/1998 Seo et al.
 D391,847 S 3/1998 Seo et al.
 5,738,272 A 4/1998 Anchor et al.
 D394,385 S 5/1998 Laughlin
 D395,823 S 7/1998 Durand
 D397,294 S * 8/1998 Saulas D9/430
 5,803,349 A * 9/1998 Ljungstrom 229/137
 D399,136 S * 10/1998 Anchor D9/430
 5,848,748 A * 12/1998 Bouraoui et al. 229/125.42
 5,855,334 A * 1/1999 Abe et al. 242/348
 D407,970 S * 4/1999 Planchard D9/703
 D412,398 S * 8/1999 Watabe D3/294
 5,938,107 A 8/1999 Anchor et al.
 D420,907 S 2/2000 Stacy-Ryan et al.
 6,027,016 A 2/2000 Ljungstrom et al.
 D424,429 S 5/2000 Anchor et al.
 D430,026 S * 8/2000 Johansson et al. D9/432
 D436,032 S 1/2001 Croft et al.
 6,182,888 B1 * 2/2001 Ljungstrom 229/125.42
 D454,063 S 3/2002 Dammers
 D454,492 S 3/2002 Dammers
 D460,355 S 7/2002 Lenz et al.

D464,566 S 10/2002 Anchor et al.
 D468,638 S 1/2003 Nogami et al.
 D473,464 S 4/2003 Anchor et al.
 D494,861 S 8/2004 Guidotti et al.
 6,929,171 B1 8/2005 Thiersch
 D513,177 S 12/2005 Tachikawa et al.
 D518,368 S 4/2006 Tachikawa et al.
 D518,371 S 4/2006 Franic
 D519,832 S 5/2006 Demathieu et al.
 D521,373 S 5/2006 Stanton
 D521,376 S 5/2006 Mosto
 7,036,717 B2 5/2006 Furini et al.
 D527,629 S 9/2006 Franic
 D540,164 S 4/2007 Franic
 D548,591 S 8/2007 Learn et al.
 7,261,232 B2 8/2007 Schropp
 D553,496 S 10/2007 Martuch et al.
 D554,509 S 11/2007 Ghalebi
 D558,047 S 12/2007 Pinkstone
 D562,129 S 2/2008 Kortsmi et al.
 D562,130 S 2/2008 Kortsmi et al.
 D564,886 S 3/2008 Ghalebi
 2004/0169066 A1 * 9/2004 Palm 229/110
 2005/0082355 A1 * 4/2005 Beutler 229/116.1
 2005/0236463 A1 * 10/2005 Boldrini et al. 229/100
 2006/0144912 A1 7/2006 Franic
 2008/0029585 A1 * 2/2008 Driessen 229/100

FOREIGN PATENT DOCUMENTS

JP 2001080637 A2 3/2001
 JP 2001097362 A2 4/2001
 JP 2001097390 A2 4/2001
 JP 2001171658 A2 6/2001
 JP 2002002687 A2 1/2002
 JP 2002173104 A2 6/2002

OTHER PUBLICATIONS

U.S. Appl. No. 29/302,670, filed Jan. 22, 2008, R. W. Kalberer.
 U.S. Appl. No. 29/306,589, filed Apr. 11, 2008, R. W. Kalberer.

* cited by examiner

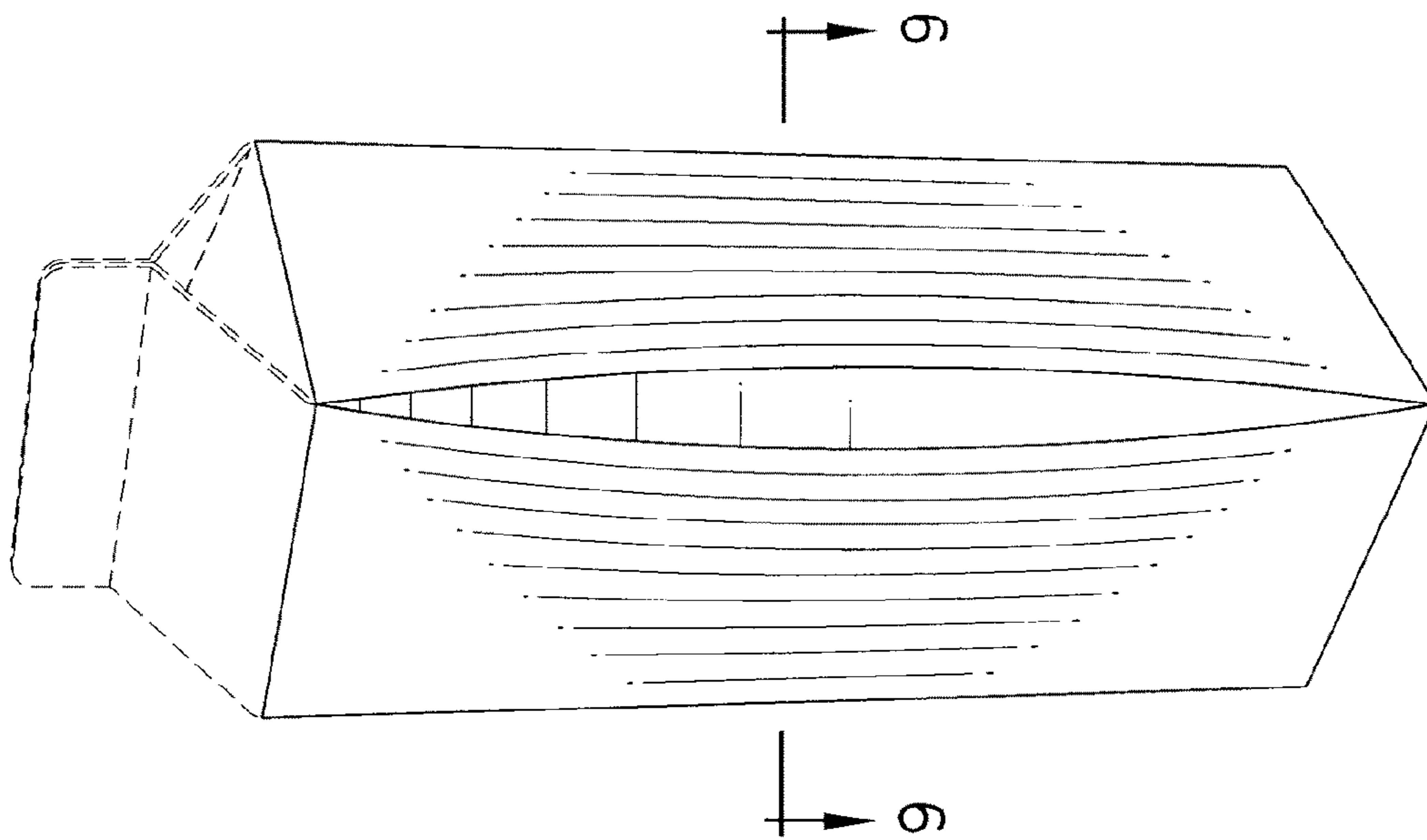

FIG. 1

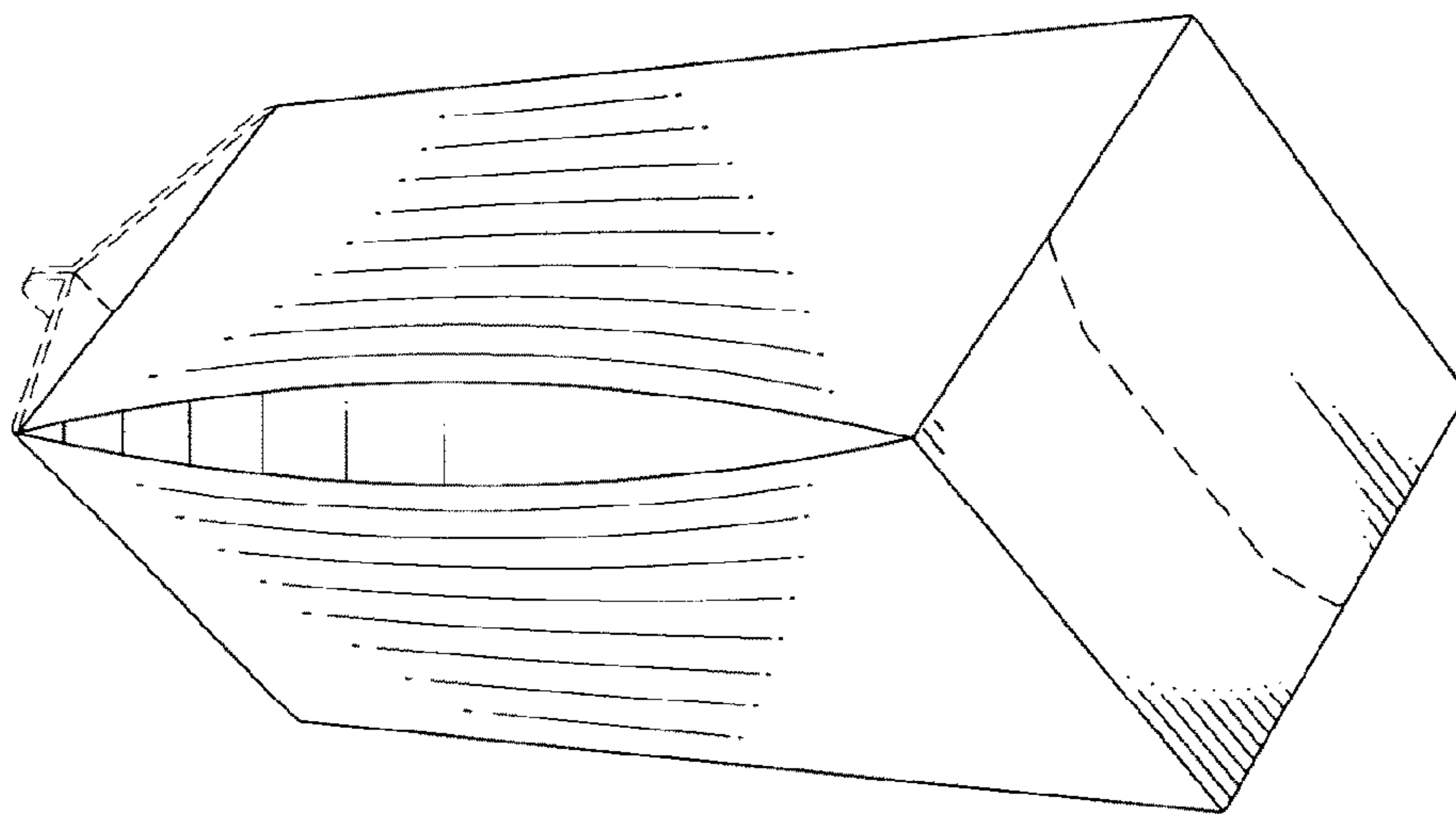

FIG. 2

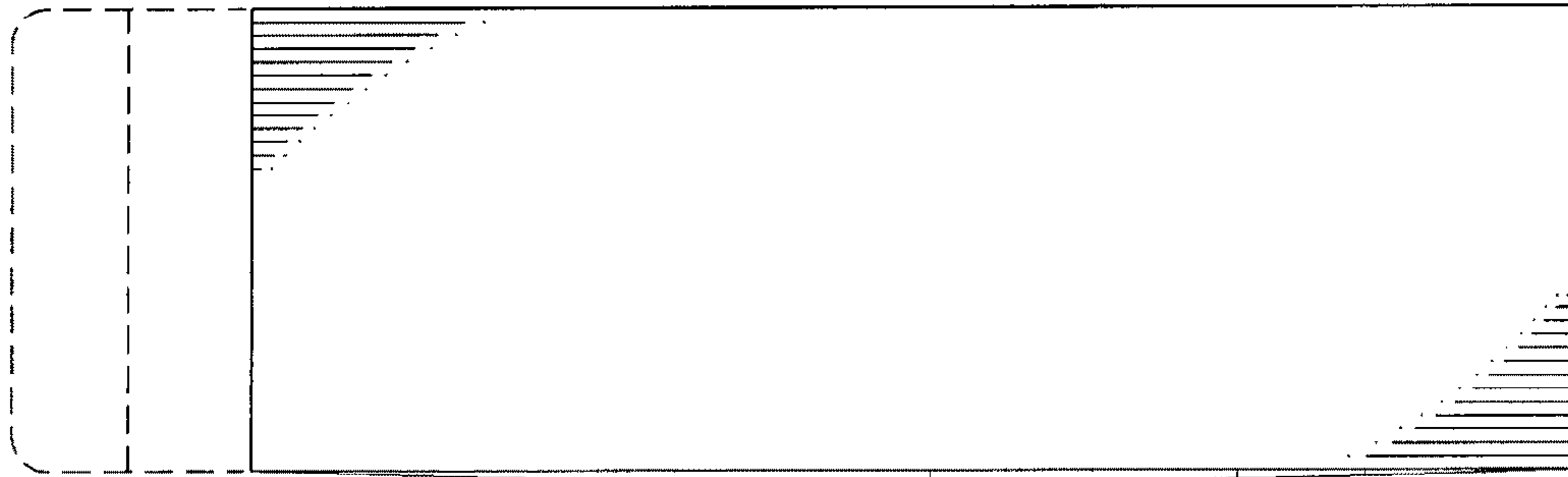

FIG. 4

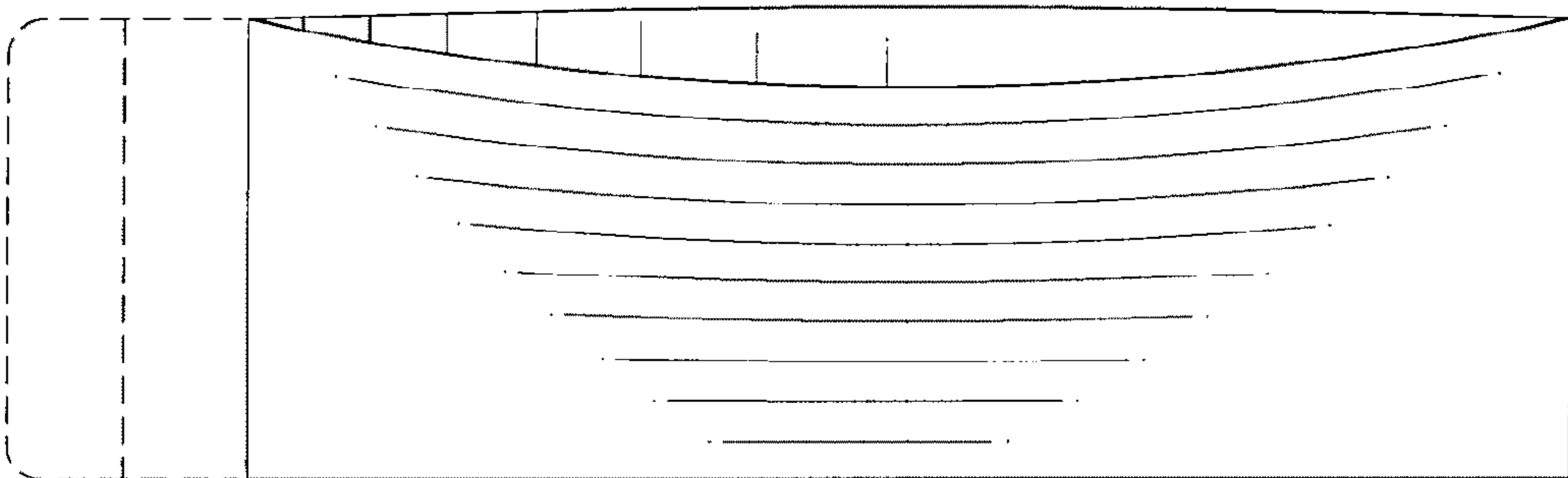

FIG. 3

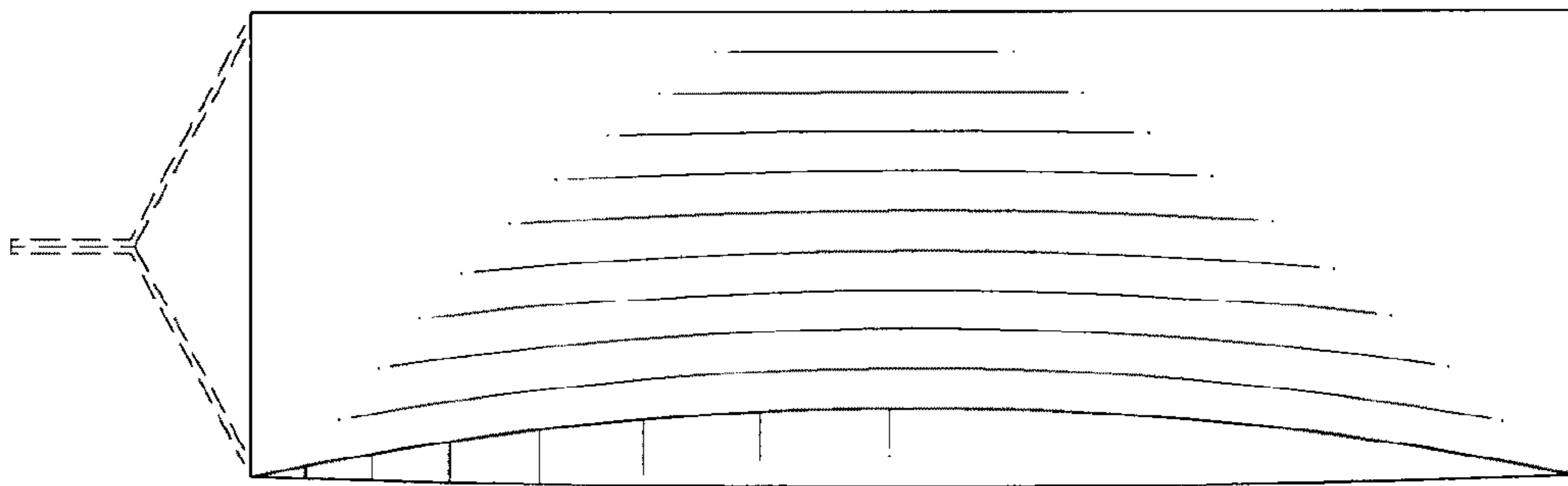

FIG. 5

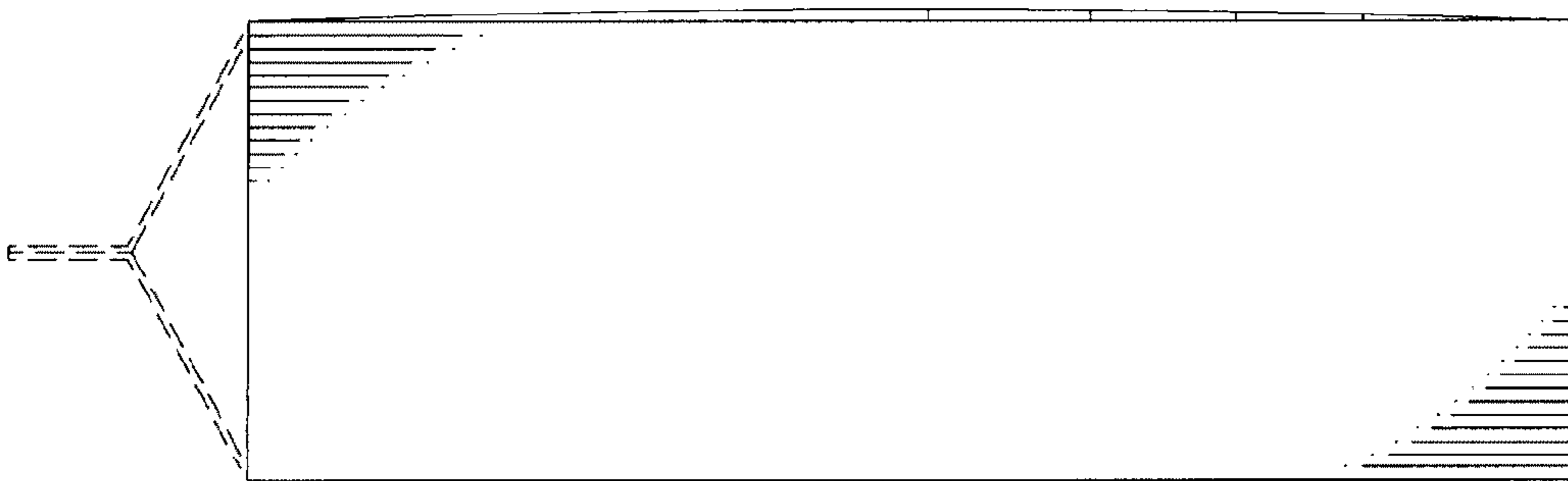

FIG. 6

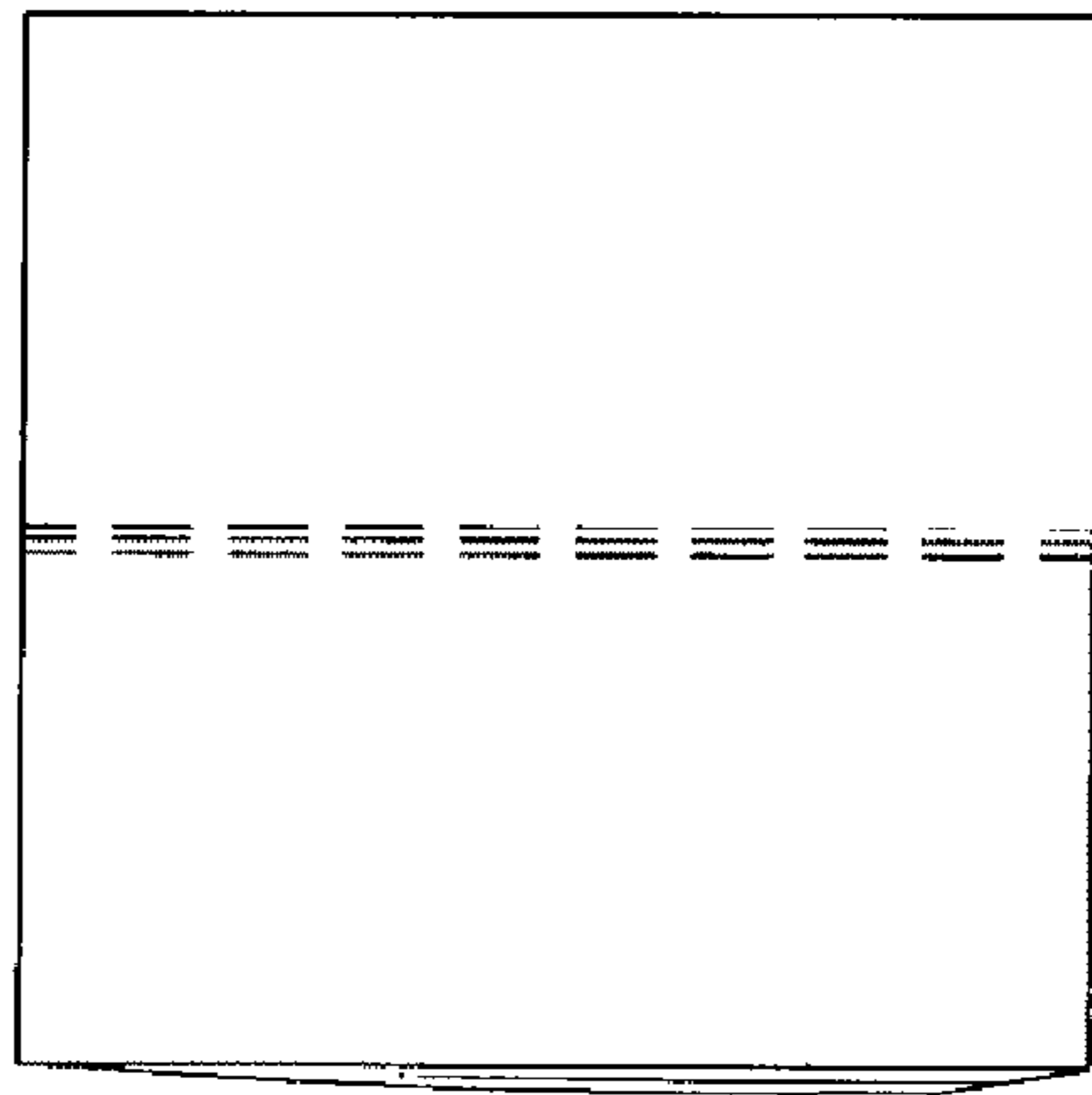

FIG. 7

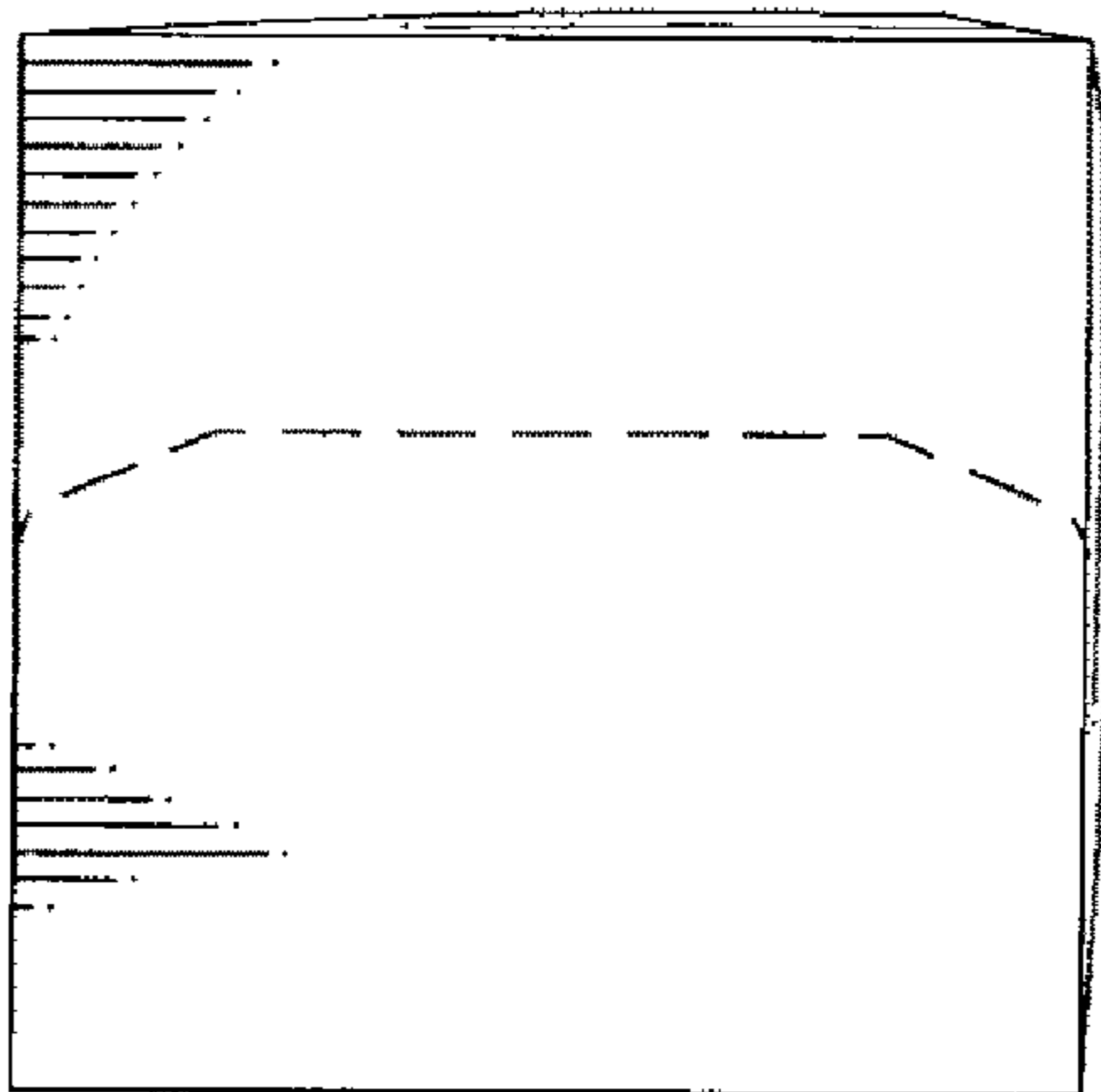

FIG. 8

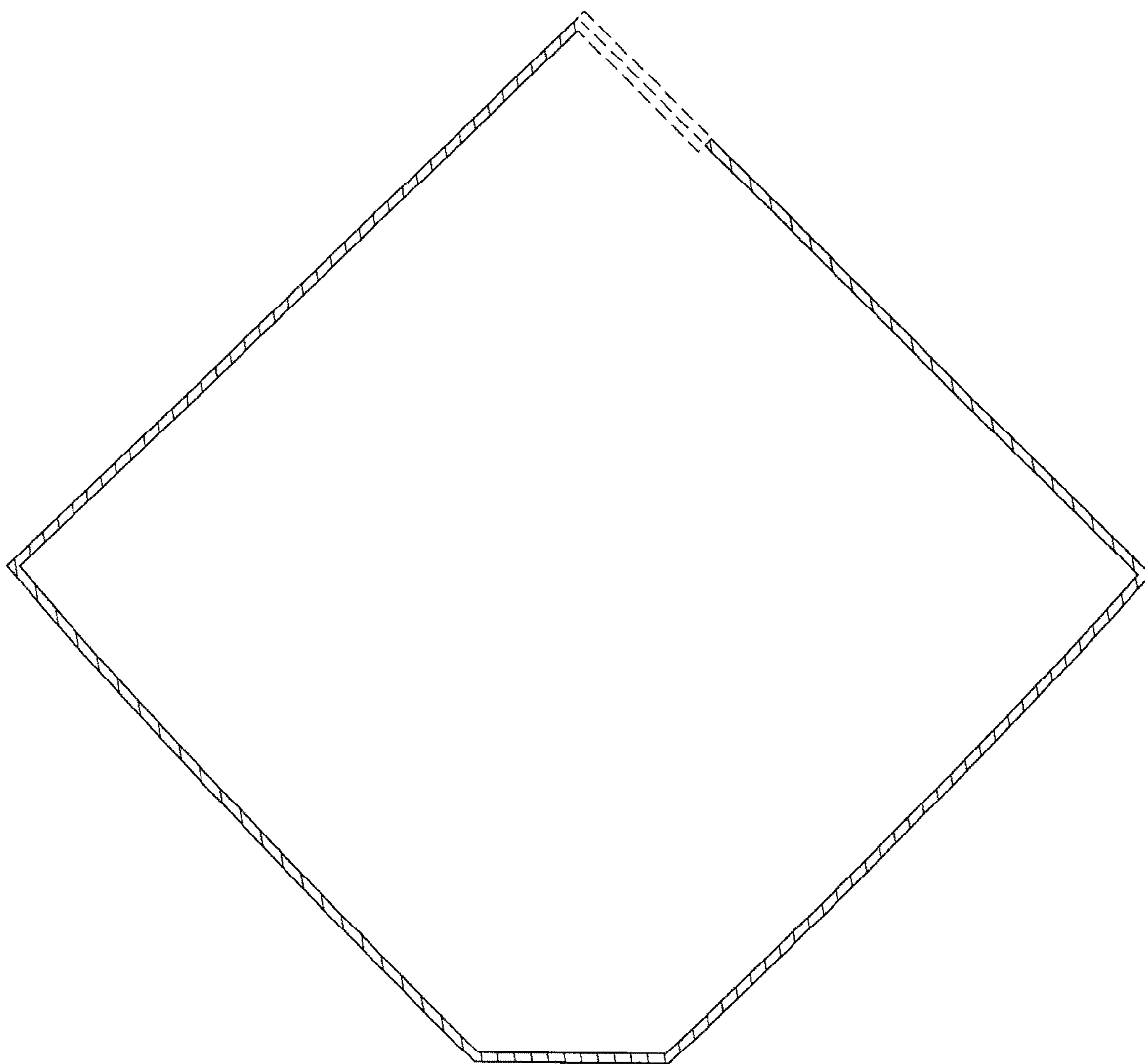

FIG. 9