



US00D589540S

(12) **United States Design Patent**
Park

(10) **Patent No.:** **US D589,540 S**

(45) **Date of Patent:** **** Mar. 31, 2009**

(54) **GRINDING TIP FOR GRINDER**

2007/0254568 A1* 11/2007 Park 451/548

(76) Inventor: **Rin-soon Park**, Yongsang APT 1-401,
150-3 Wonjong-Dong, Ojeong-Gu,
Bucheon-Si, Gyeonggi-Do (KR) 421-200

* cited by examiner

Primary Examiner—Sandra Snapp

Assistant Examiner—Patricia Palasik

(74) *Attorney, Agent, or Firm*—The Nath Law Group; Jerald
L. Meyer; Jiaxiao Zhang

(**) Term: **14 Years**

(21) Appl. No.: **29/300,989**

(57) **CLAIM**

(22) Filed: **Jun. 6, 2008**

The ornamental design for a grinding tip for grinder, as shown
and described.

(51) **LOC (9) Cl.** **15-09**

(52) **U.S. Cl.** **D15/126**

(58) **Field of Classification Search** D8/70,
D8/71, 90, 98; D15/124, 126, 138, 139;
D21/485, 488, 499, 500, 503, 504; D25/103,
D25/113–118; 83/589, 676, 863; 407/35,
407/42, 112–119; 451/548–551

DESCRIPTION

FIG. 1 is a bottom view of the grinding tip for grinder;
FIG. 2 is a front view of the grinding tip for grinder;
FIG. 3 is a top view of the grinding tip for grinder;
FIG. 4 is a left side view of the grinding tip for grinder;
FIG. 5 is a perspective view of the grinding tip for grinder;
FIG. 6 is a rear view of the grinding tip for grinder;
FIG. 7 is a reference view of the grinding tip for grinder; and,
FIG. 8 is a right side view of the grinding tip for grinder.

See application file for complete search history.

The broken line showing of the grinding tip for grinder; in
FIG. 7 is included for the purpose of illustrating environment
and forms no part of the claimed design.

(56) **References Cited**

U.S. PATENT DOCUMENTS

D241,059 S *	8/1976	Young	D15/124
4,457,765 A *	7/1984	Wilson	451/548
D548,758 S *	8/2007	Park	D15/126
D551,359 S *	9/2007	Price	D25/113
2005/0164620 A1 *	7/2005	Amamoto	451/548
2006/0116060 A1 *	6/2006	Thysell	451/548
2007/0155293 A1 *	7/2007	Endres et al.	451/56

1 Claim, 8 Drawing Sheets

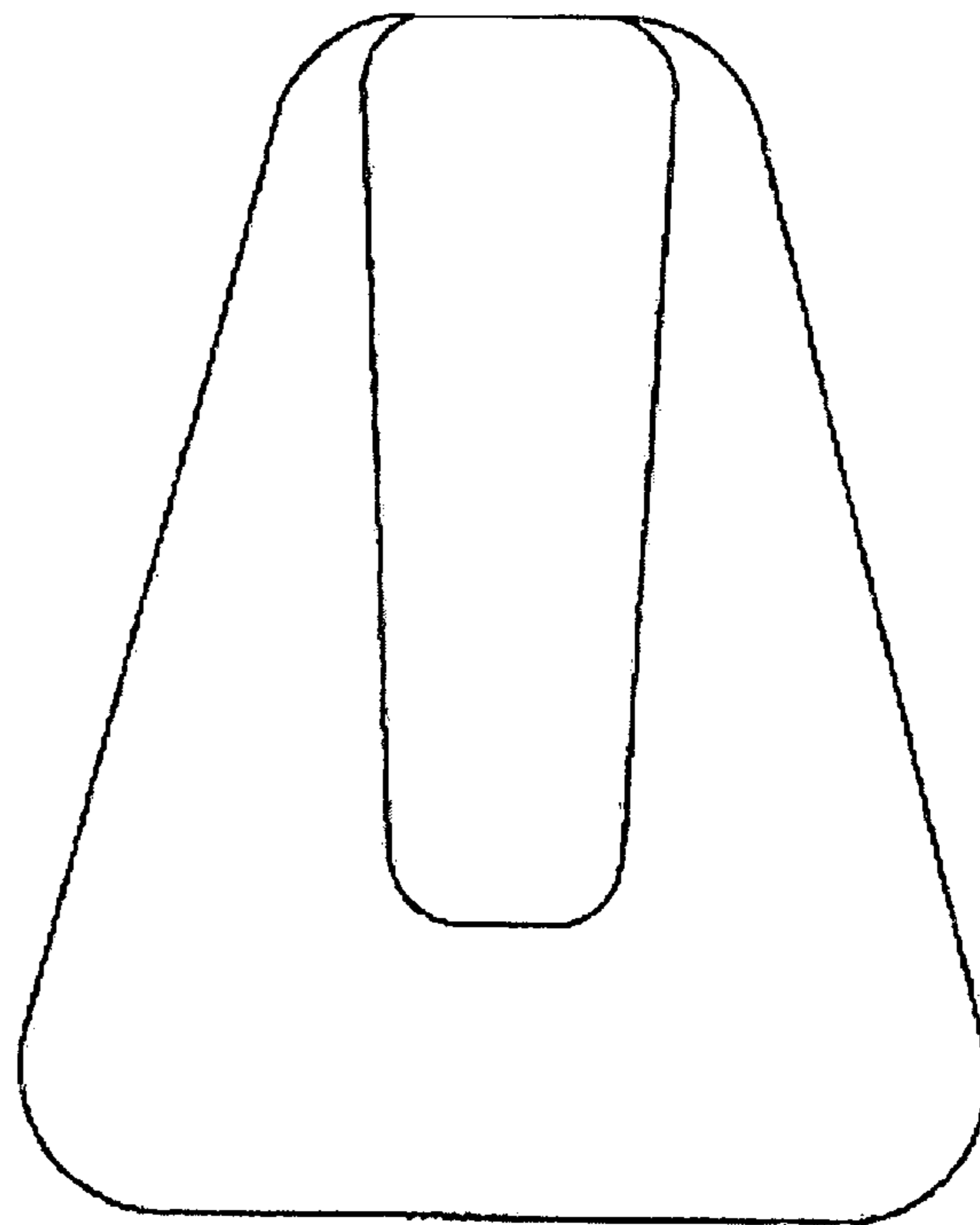
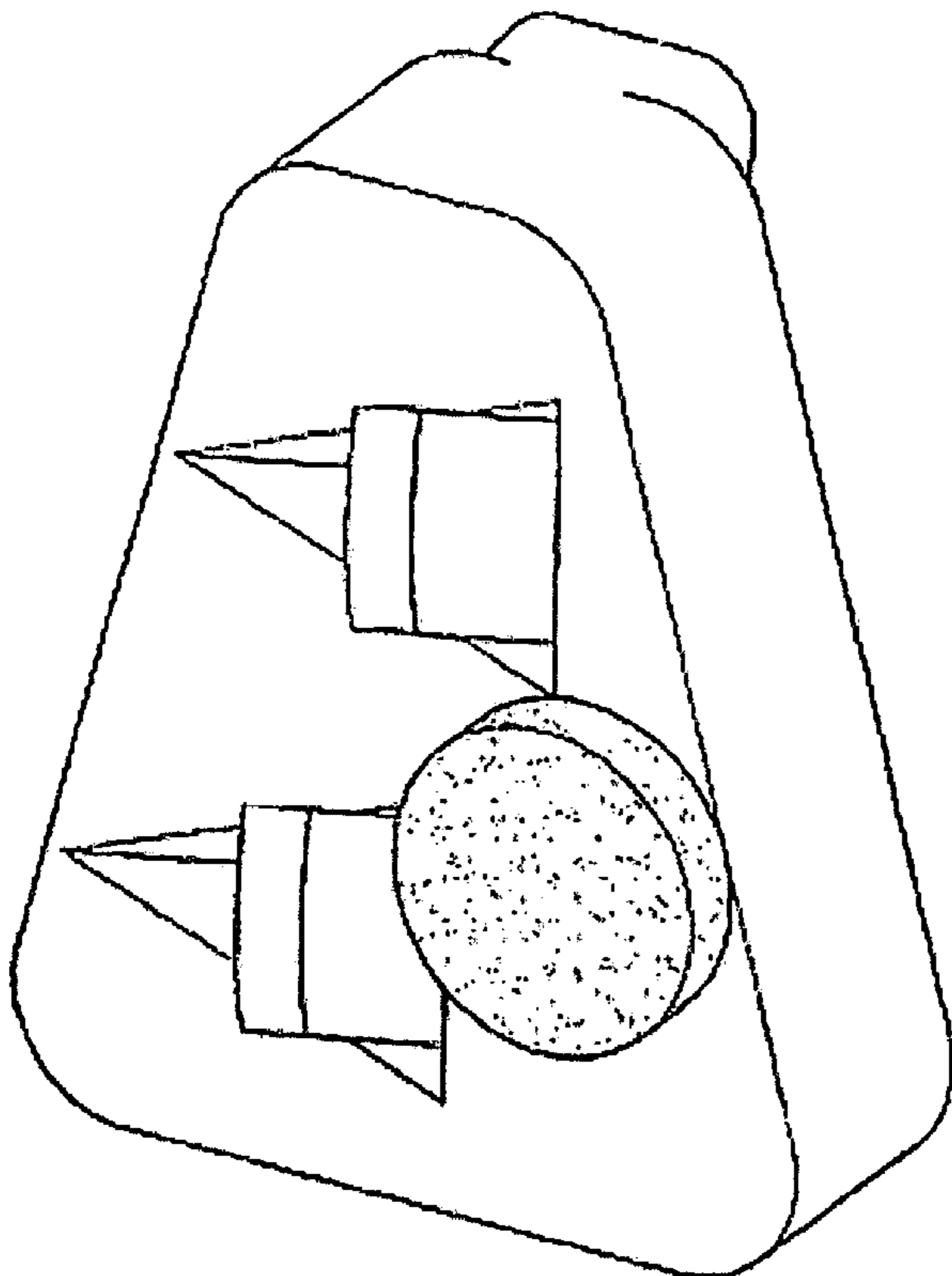

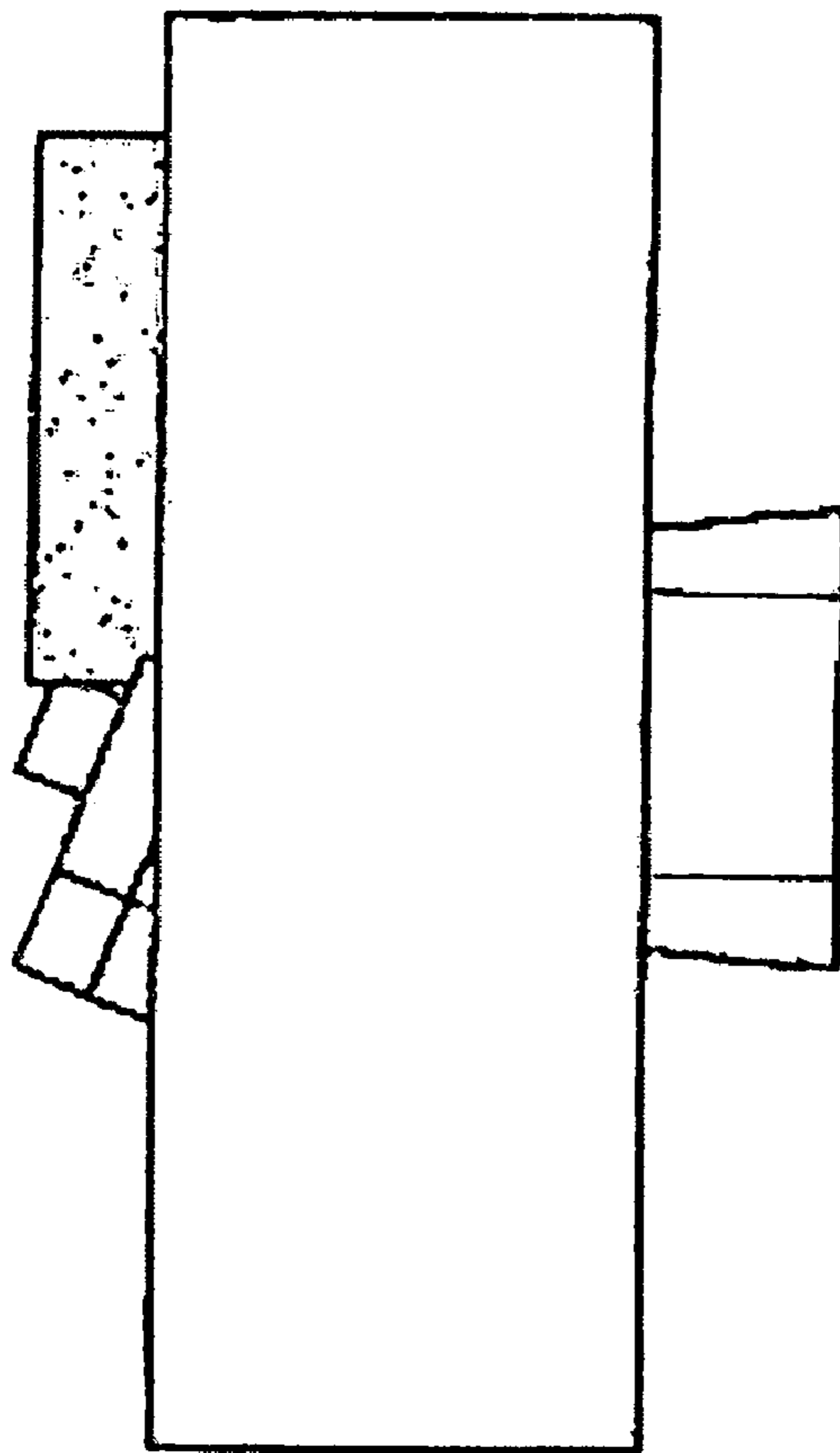

FIG. 1

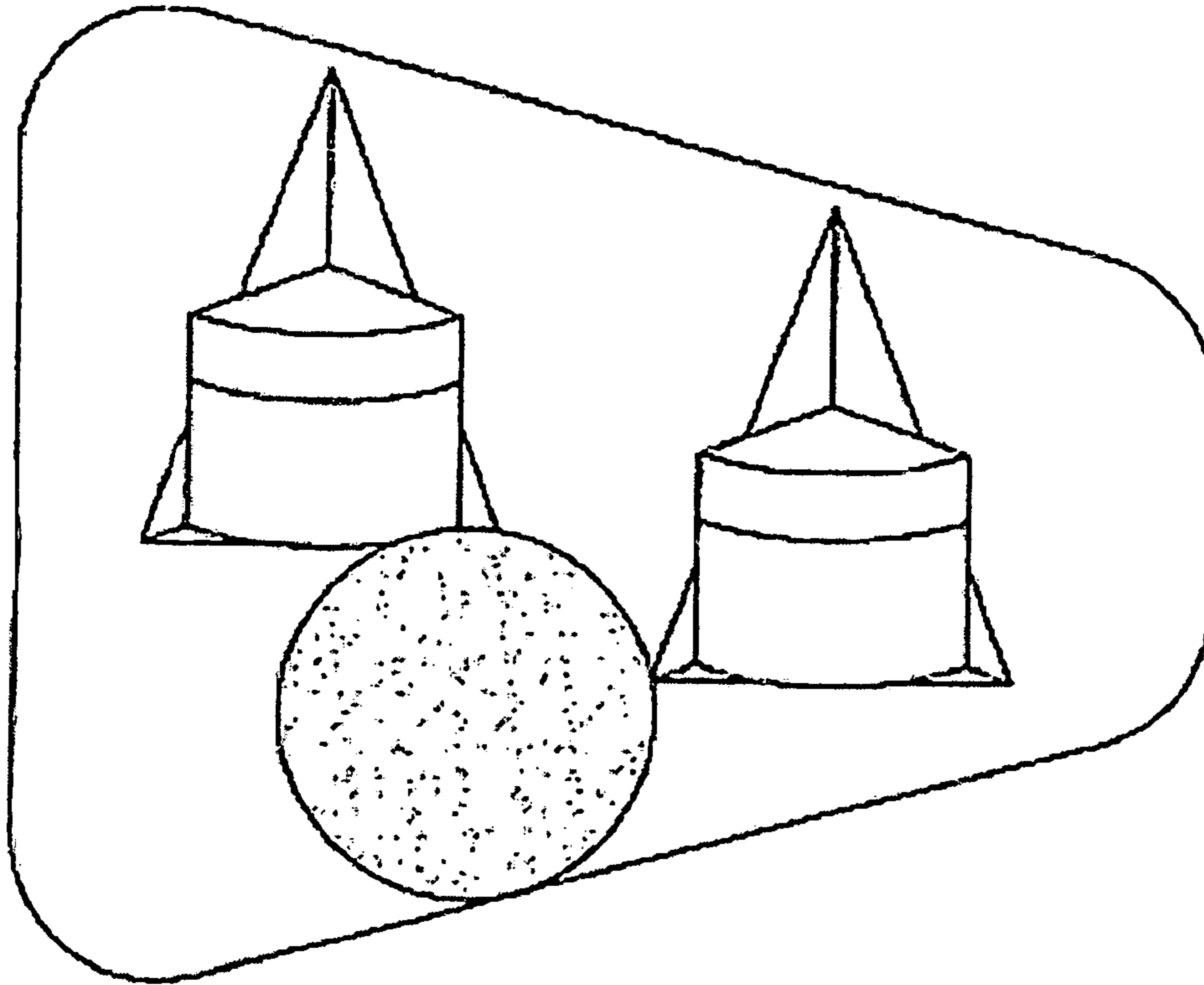

FIG. 2

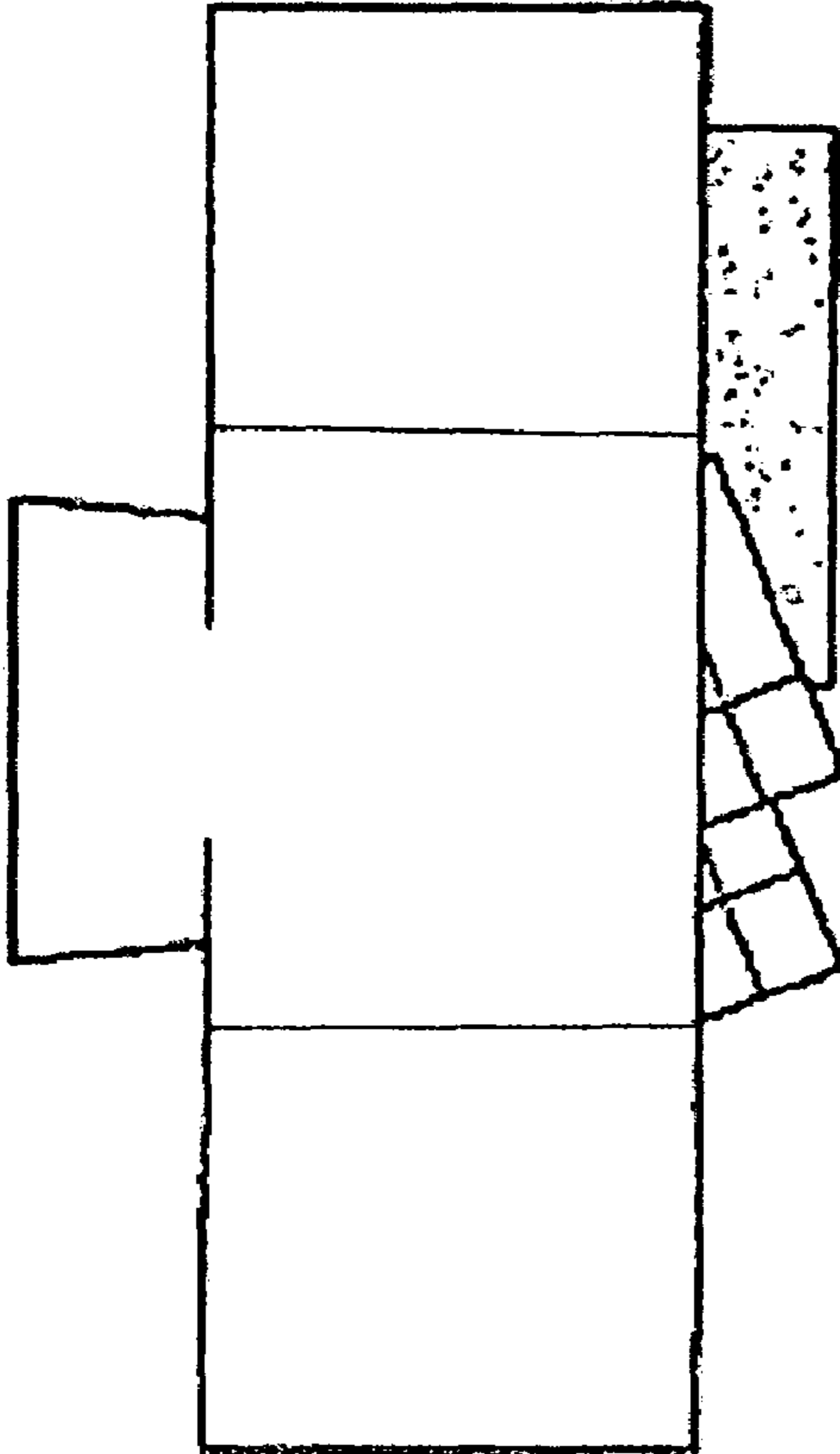

FIG. 3

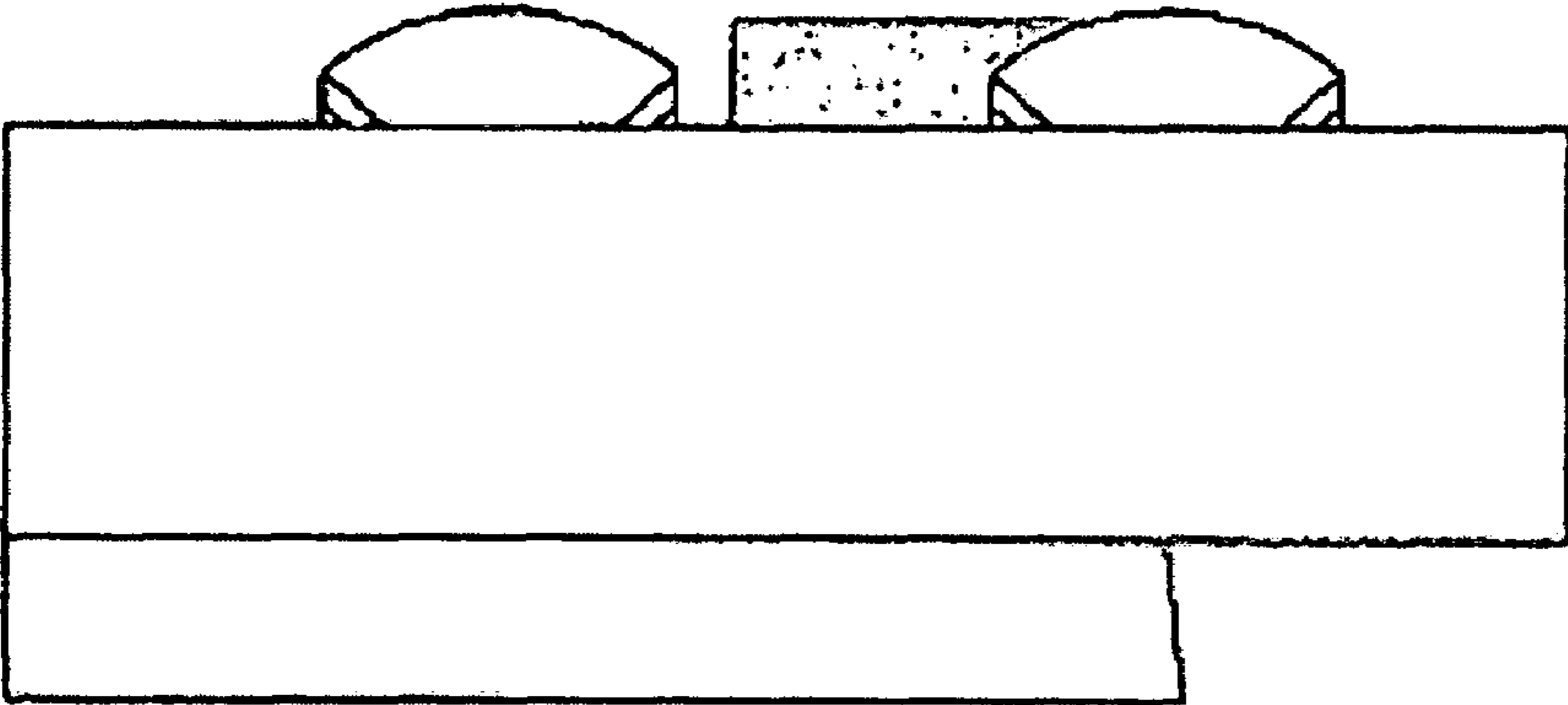

FIG. 4

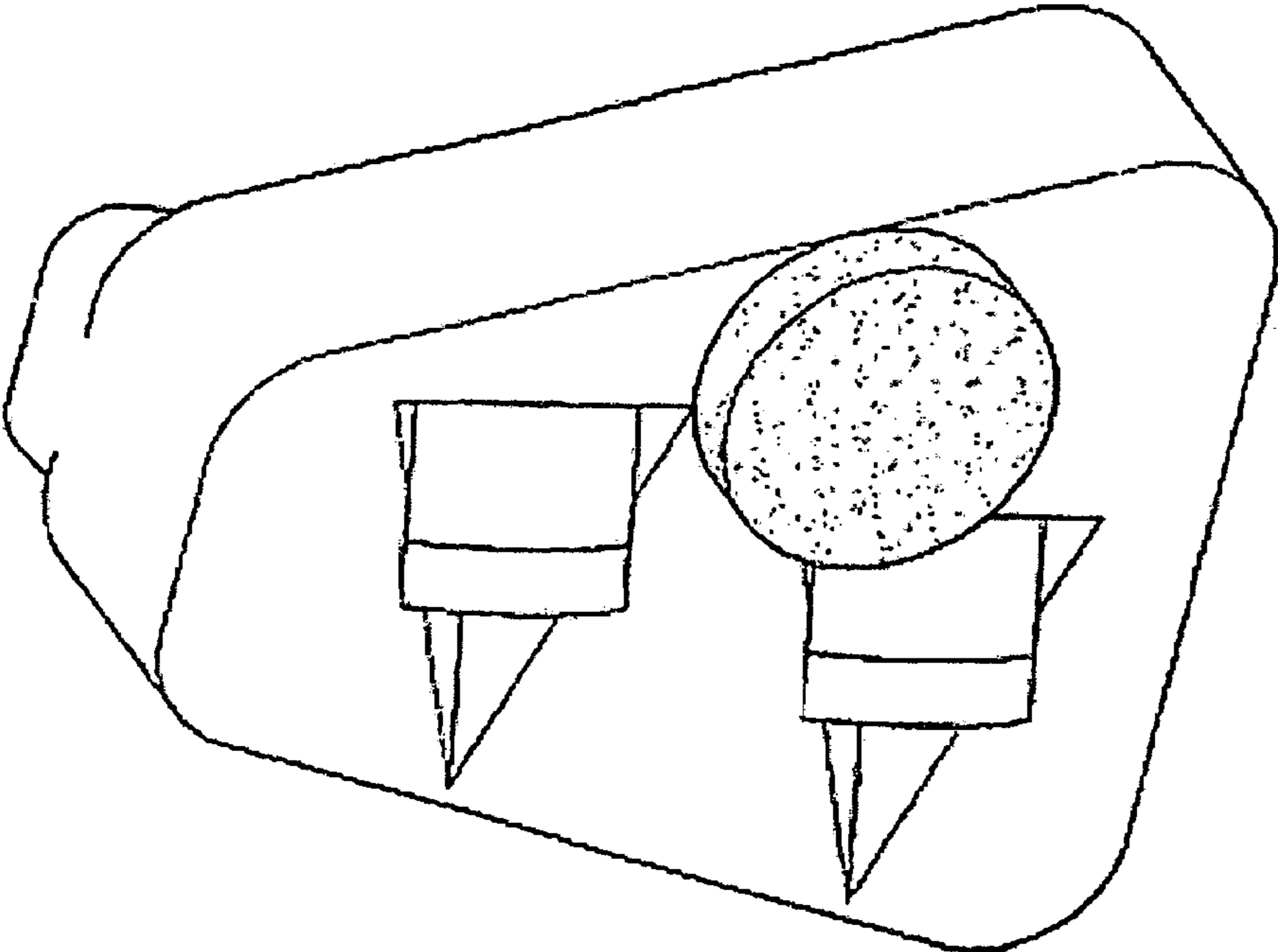

FIG. 5

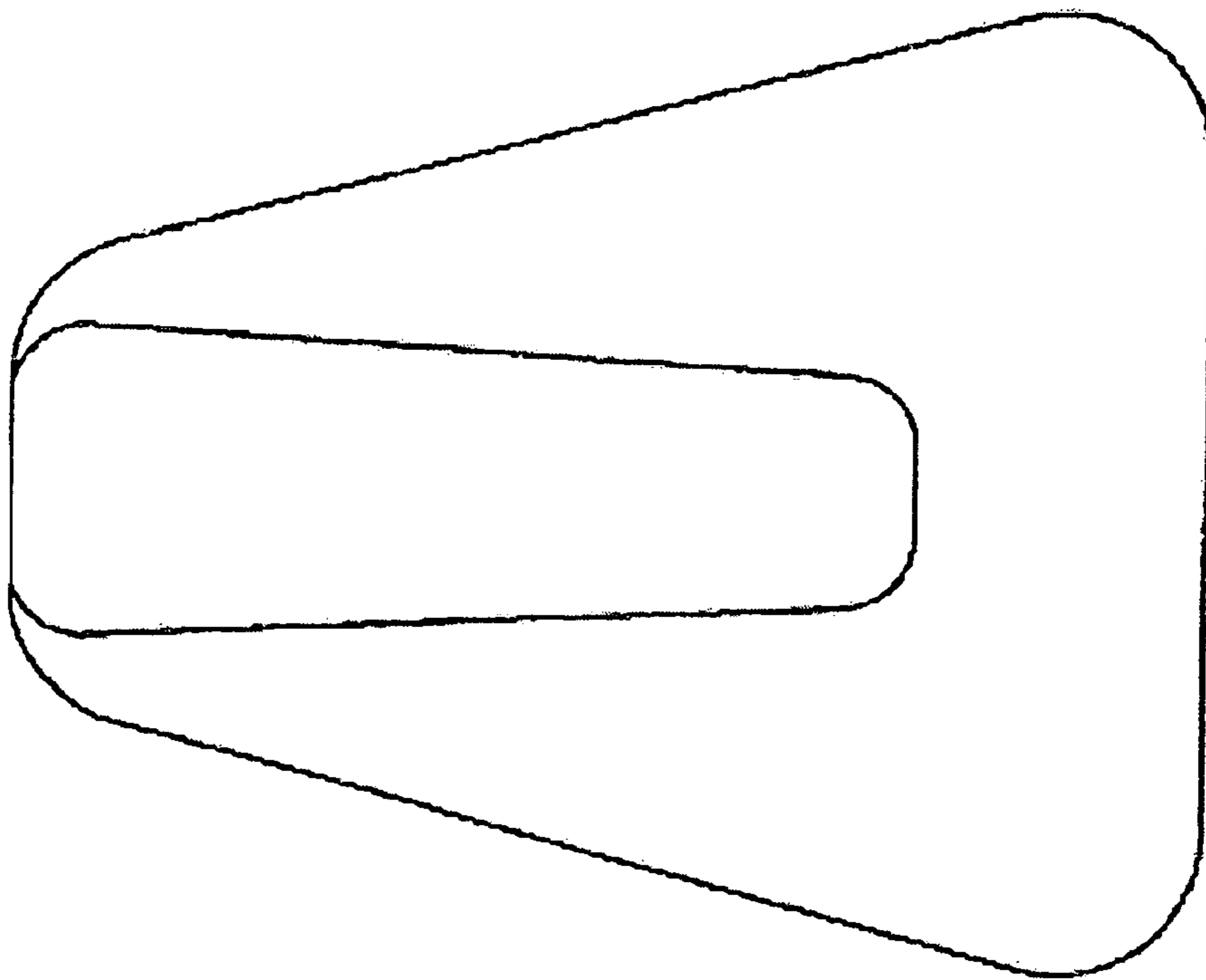

FIG. 6

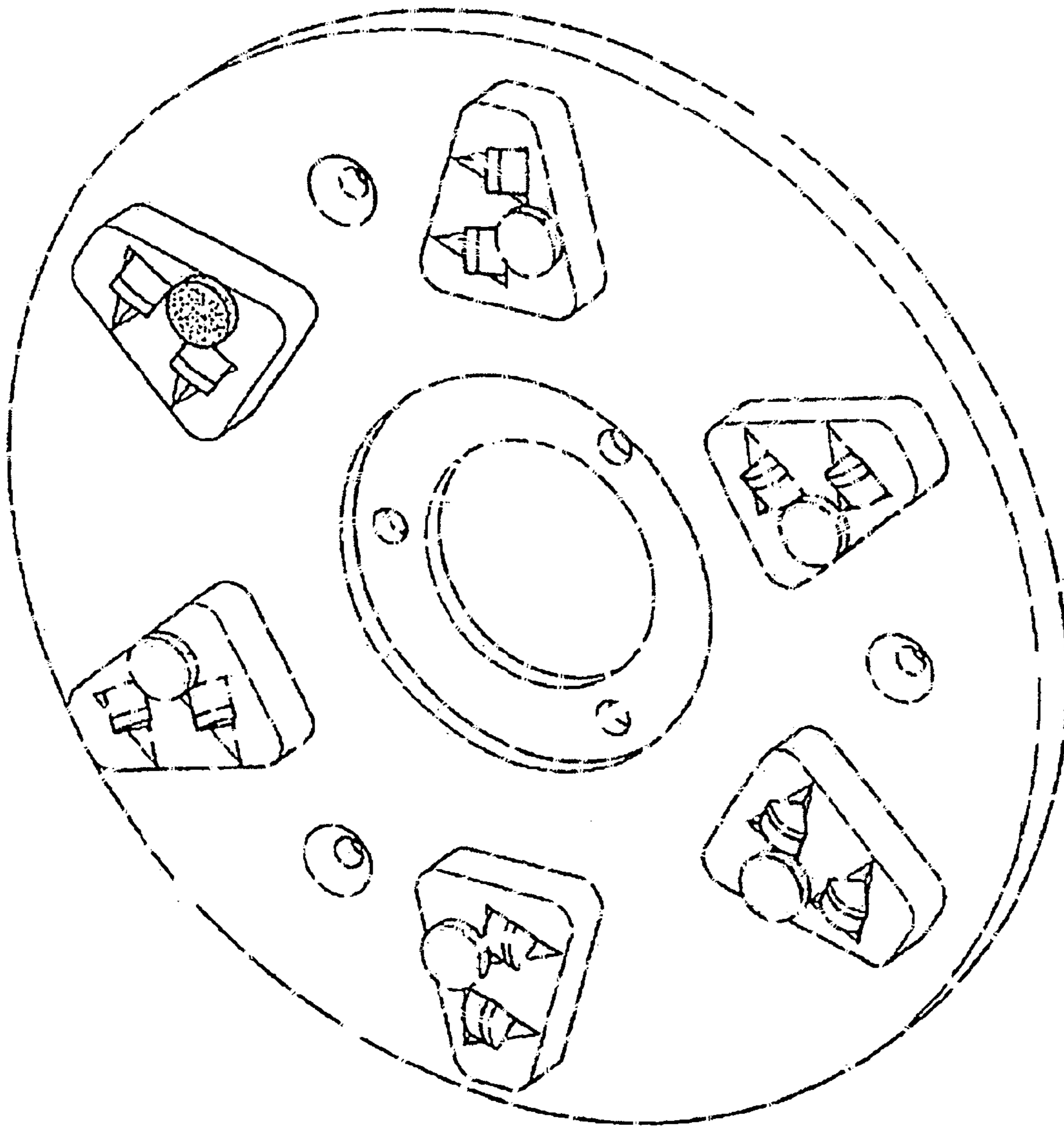

FIG. 7

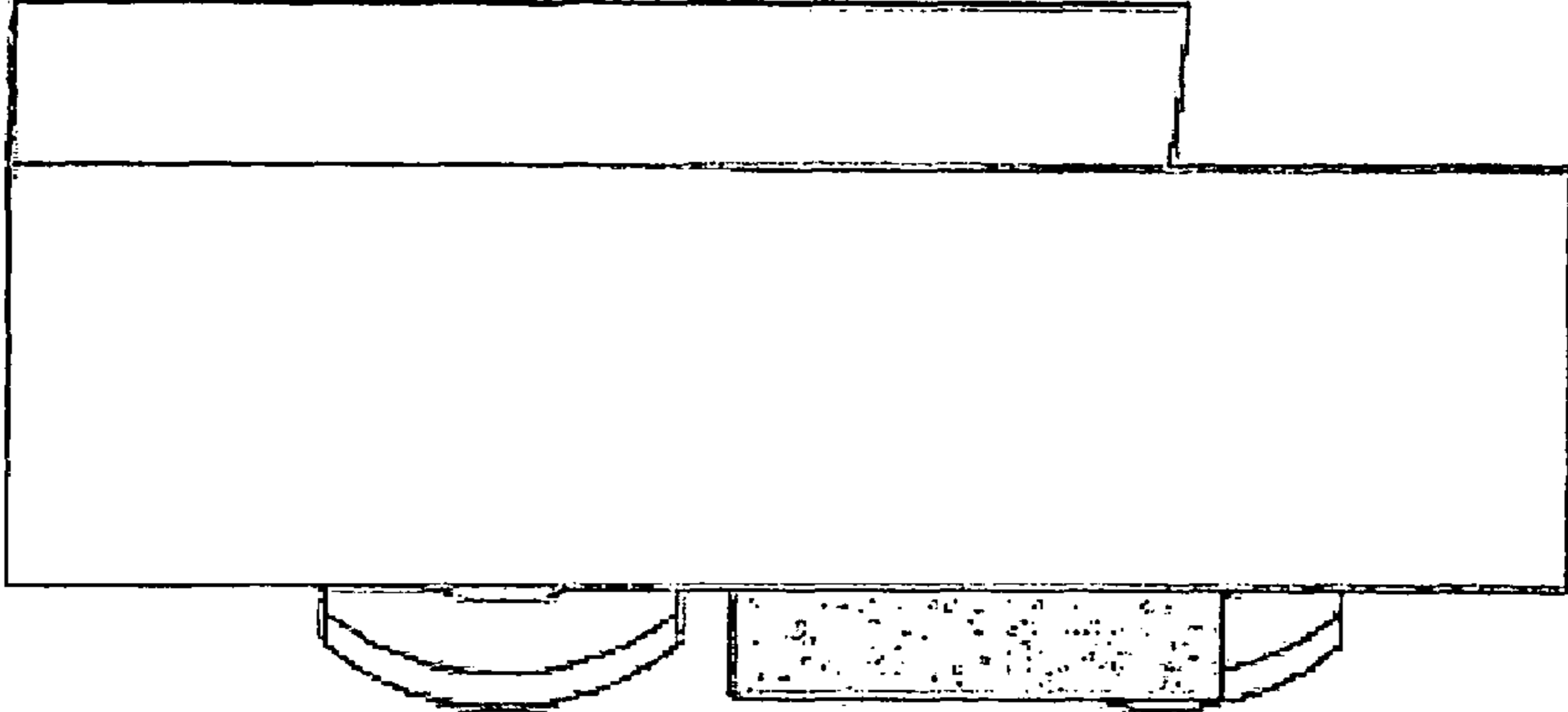

FIG. 8