



US00D589397S

(12) **United States Design Patent**  
**Tuo**

(10) **Patent No.:** **US D589,397 S**  
(45) **Date of Patent:** **\*\* Mar. 31, 2009**

(54) **HUNTING CAR**

(75) Inventor: **Xinyong Tuo**, Suzhou (CN)

(73) Assignee: **Suzhou Eagle Electric Vehicle Manufacturing Co., Ltd.**, Suzhou (CN)

(\*\*) Term: **14 Years**

(21) Appl. No.: **29/271,342**

(22) Filed: **Jan. 17, 2007**

(30) **Foreign Application Priority Data**

Sep. 29, 2006 (CN) ..... 2006 3 0141063

(51) **LOC (9) Cl.** ..... **12-14**

(52) **U.S. Cl.** ..... **D12/1; D12/16; D12/14**

(58) **Field of Classification Search** ..... D12/87,  
D12/86, 1, 433, 15, 16, 107, 82, 88, 89, 90,  
D12/91, 92, 93, 14; D15/30; D21/803; 180/233,  
180/908; 280/DIG. 5, 183, 184, 185, 186,  
280/28, 37.7

See application file for complete search history.

(56) **References Cited**

**U.S. PATENT DOCUMENTS**

D342,699 S	12/1993	Miyamoto et al.	
D439,548 S	3/2001	Kouchi et al.	
D439,549 S *	3/2001	Shambeau et al.	D12/14
D493,749 S *	8/2004	Duncan	D12/16
D497,324 S	10/2004	Chestnut et al.	
D498,704 S *	11/2004	Bonner et al.	D12/16
D503,905 S	4/2005	Saito et al.	
6,883,846 B2 *	4/2005	Cheek et al.	296/1.02
D511,715 S	11/2005	Hohnl et al.	

D514,981 S *	2/2006	Andrews et al.	D12/16
D520,937 S *	5/2006	Eisenhauer	D12/401
D533,326 S *	12/2006	Sugai	D34/15
D541,699 S *	5/2007	Andrews et al.	D12/16
2007/0216180 A1 *	9/2007	Hanson et al.	296/1.08
2007/0267237 A1 *	11/2007	Hanson et al.	180/89.1

**OTHER PUBLICATIONS**

Archived golf cars of charleston webpage from Aug. 18, 2006, <http://web.archive.org/web/20060818052505/www.golfcarsofcharleston.org/808742.htm>, Also attached way back machine p. I.\*

\* cited by examiner

*Primary Examiner*—T. Chase Nelson

*Assistant Examiner*—Ania K Dworzecka

(74) *Attorney, Agent, or Firm*—Oliff & Berridge, PLC

(57) **CLAIM**

The ornamental design for a hunting car, as shown and described.

**DESCRIPTION**

FIG. 1 is a perspective view of a hunting car;

FIG. 2 is a front view thereof;

FIG. 3 is a top view thereof;

FIG. 4 is a right side view thereof;

FIG. 5 is a left side view thereof;

FIG. 6 is a rear view thereof; and,

FIG. 7 is a rear perspective view thereof.

The broken lines are for illustrative purposes only and form no part of the claimed design.

**1 Claim, 7 Drawing Sheets**

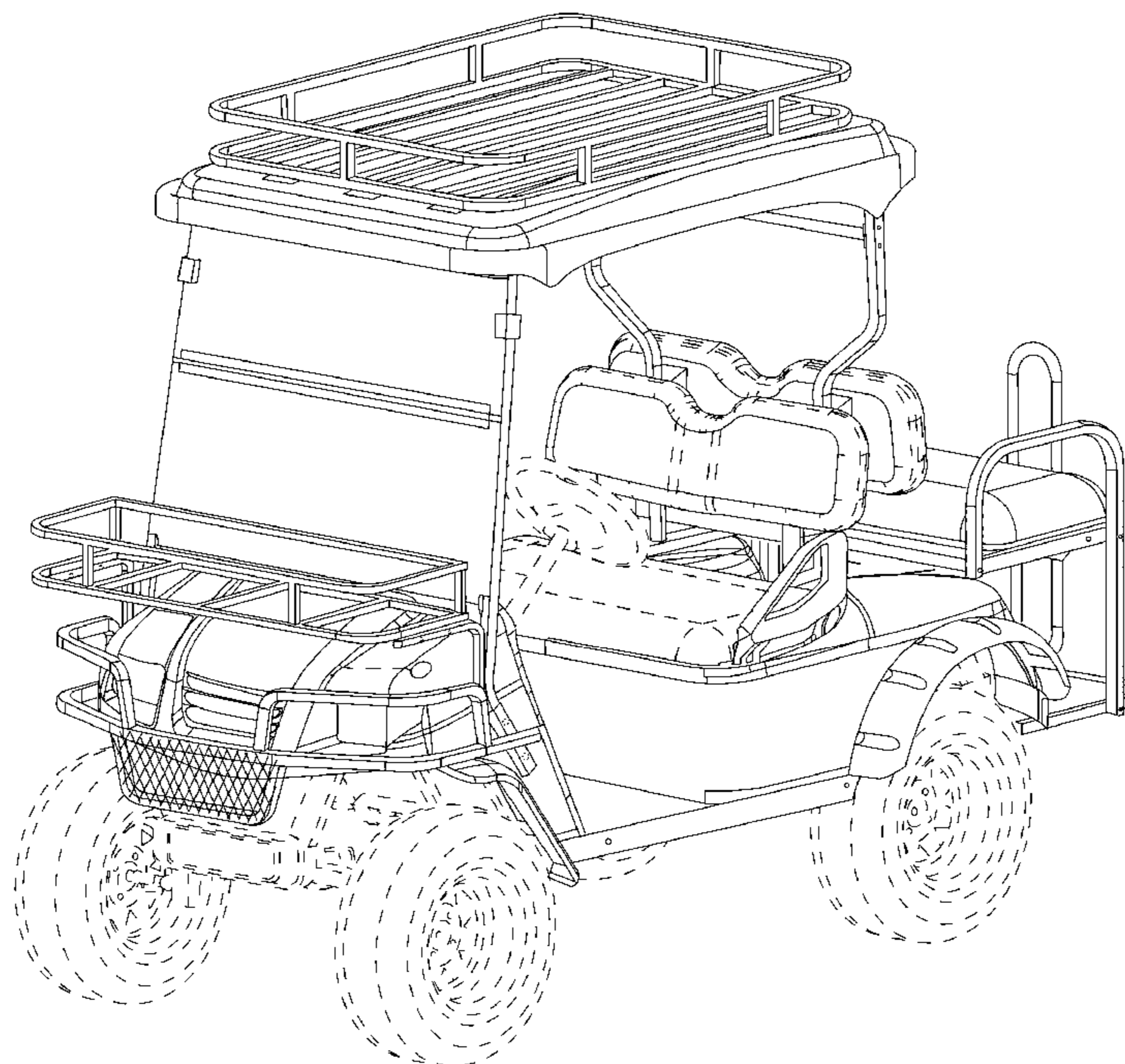

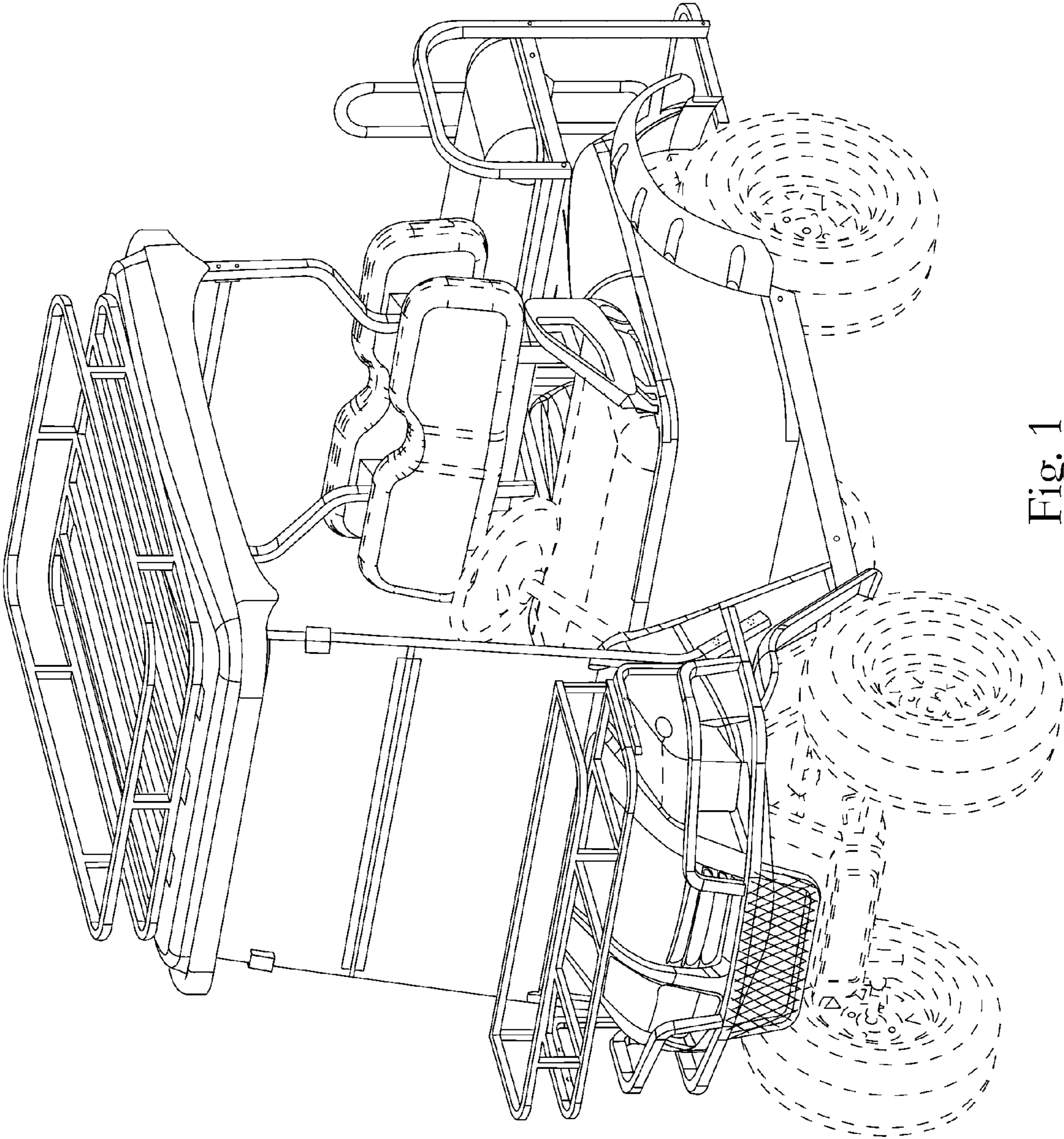

Fig. 1

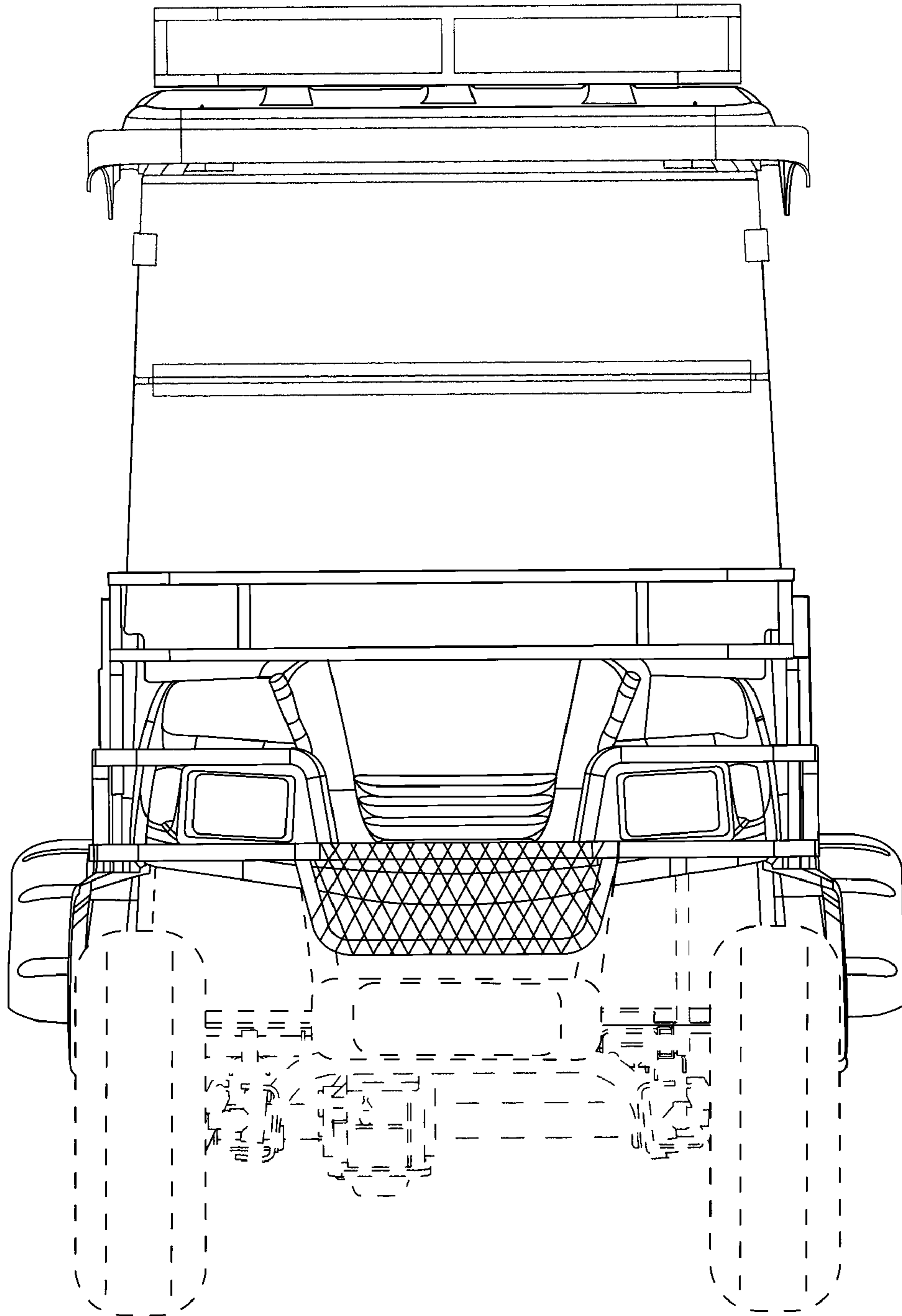

Fig. 2

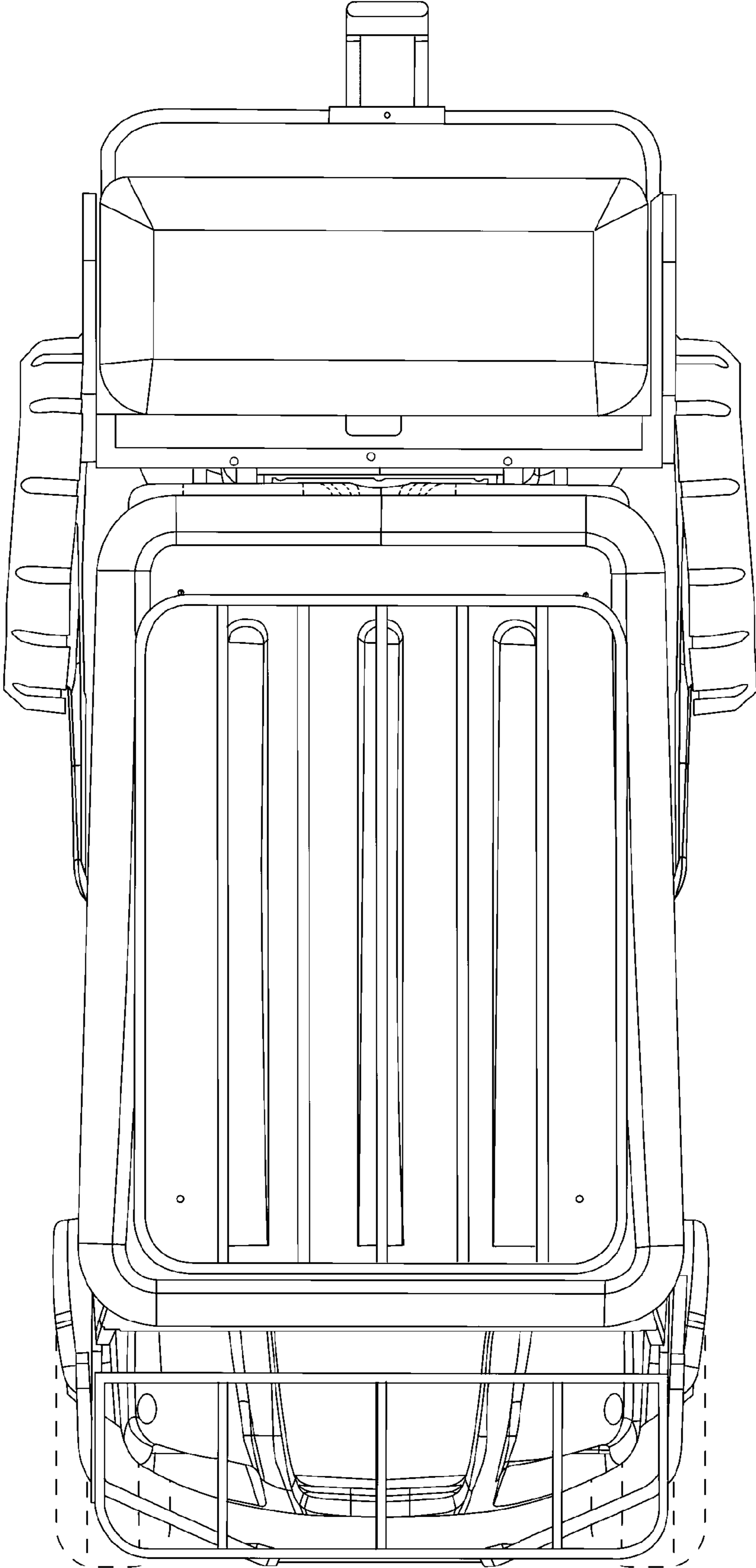

Fig. 3

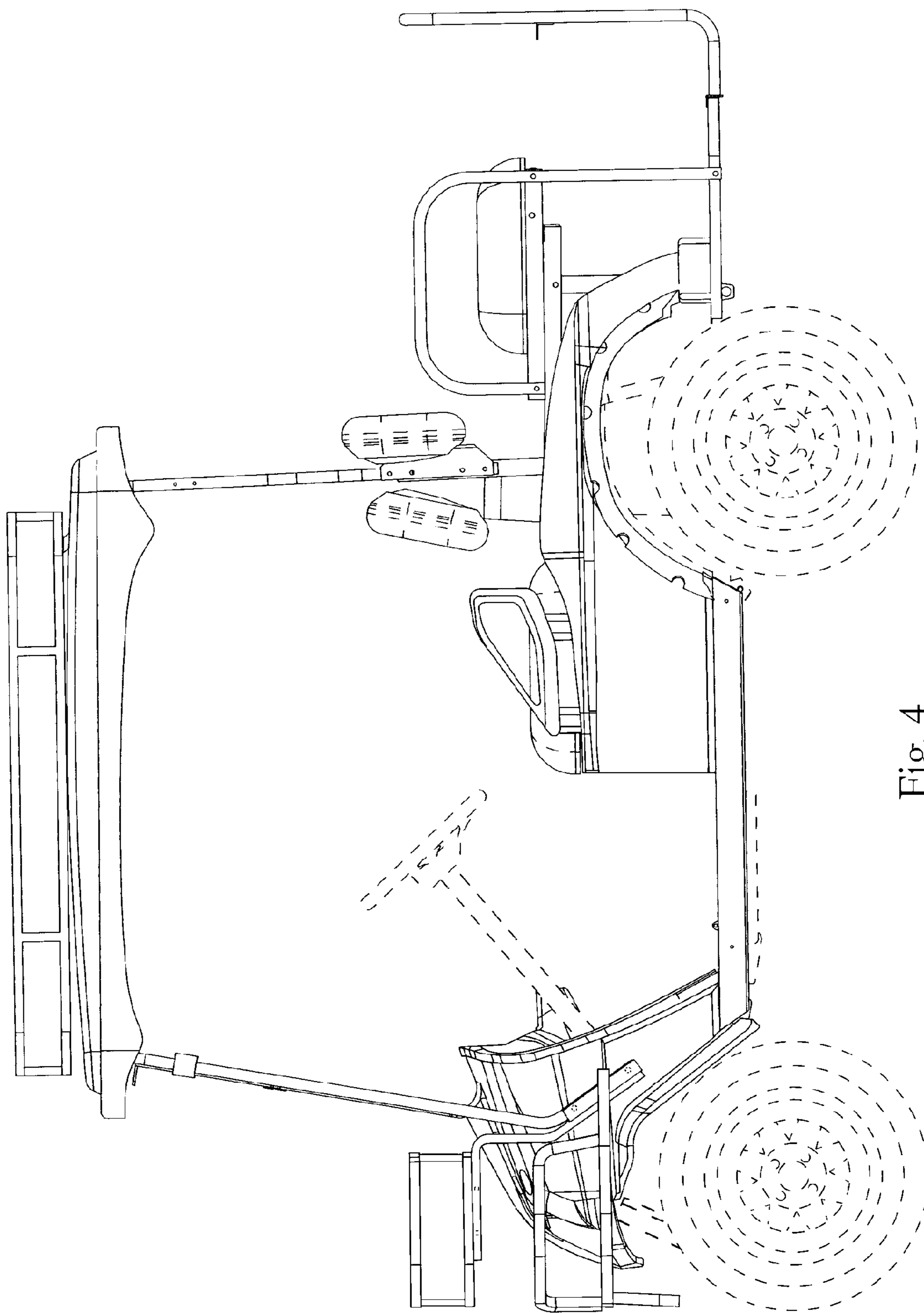

Fig. 4

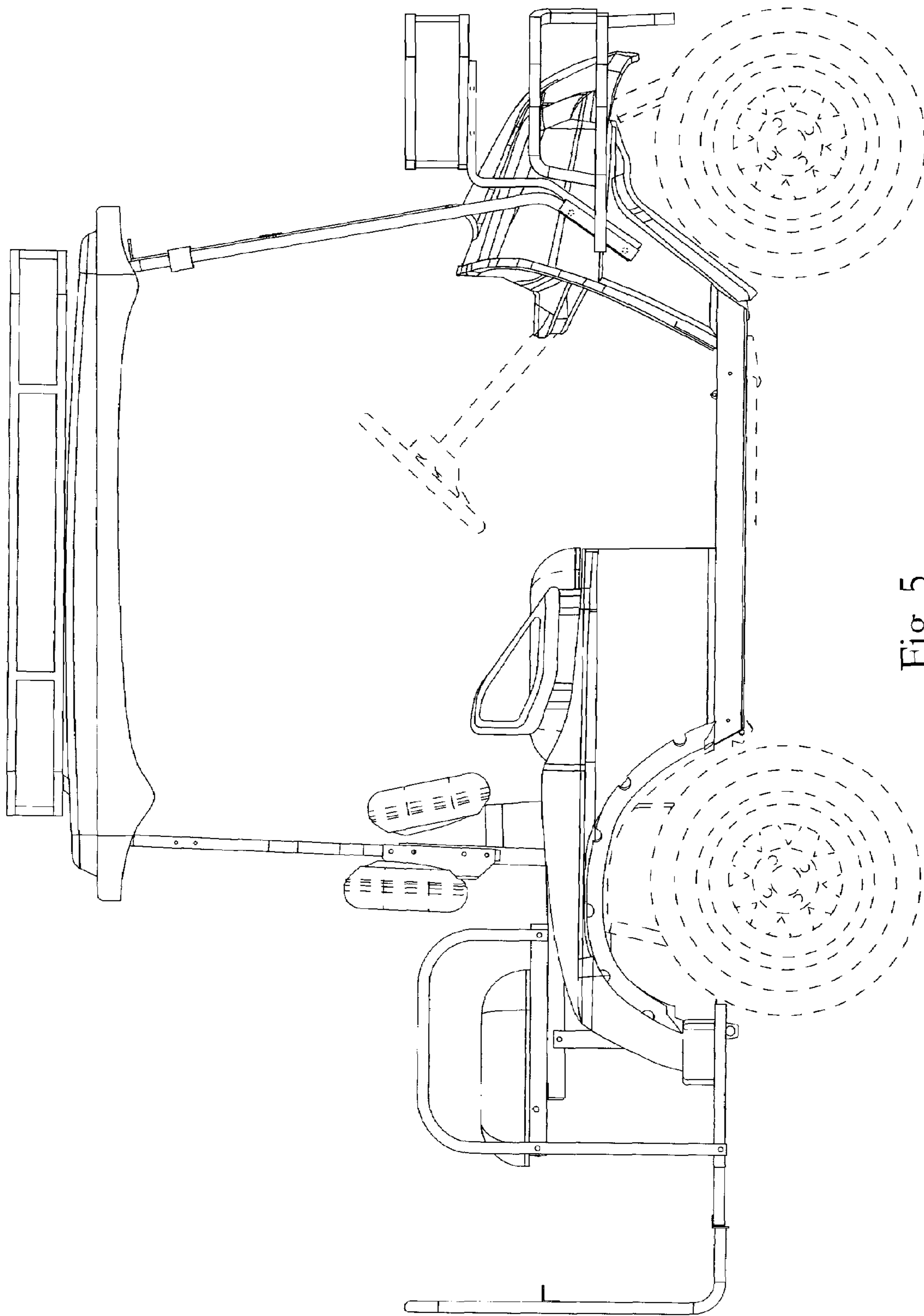

Fig. 5

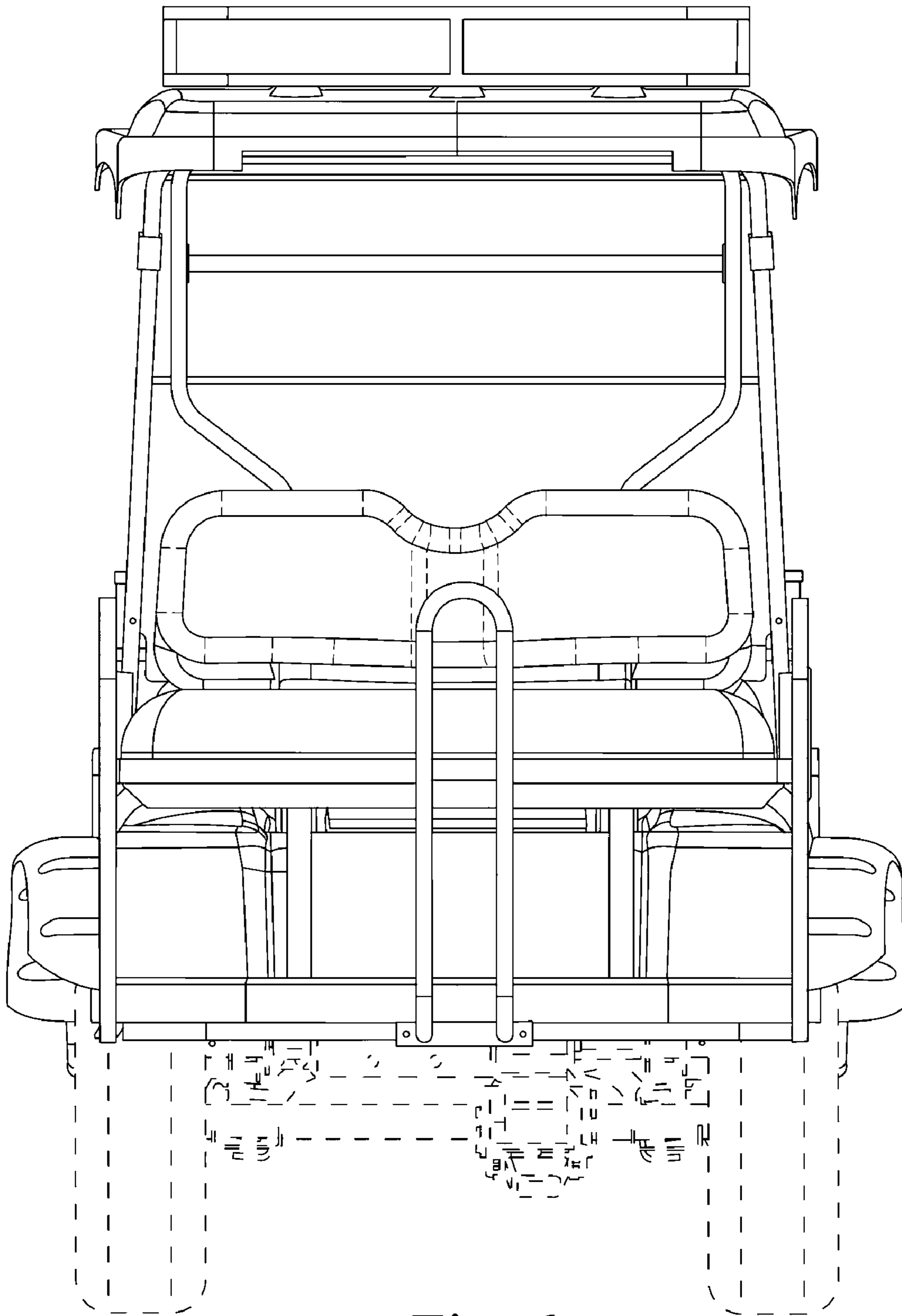

Fig. 6

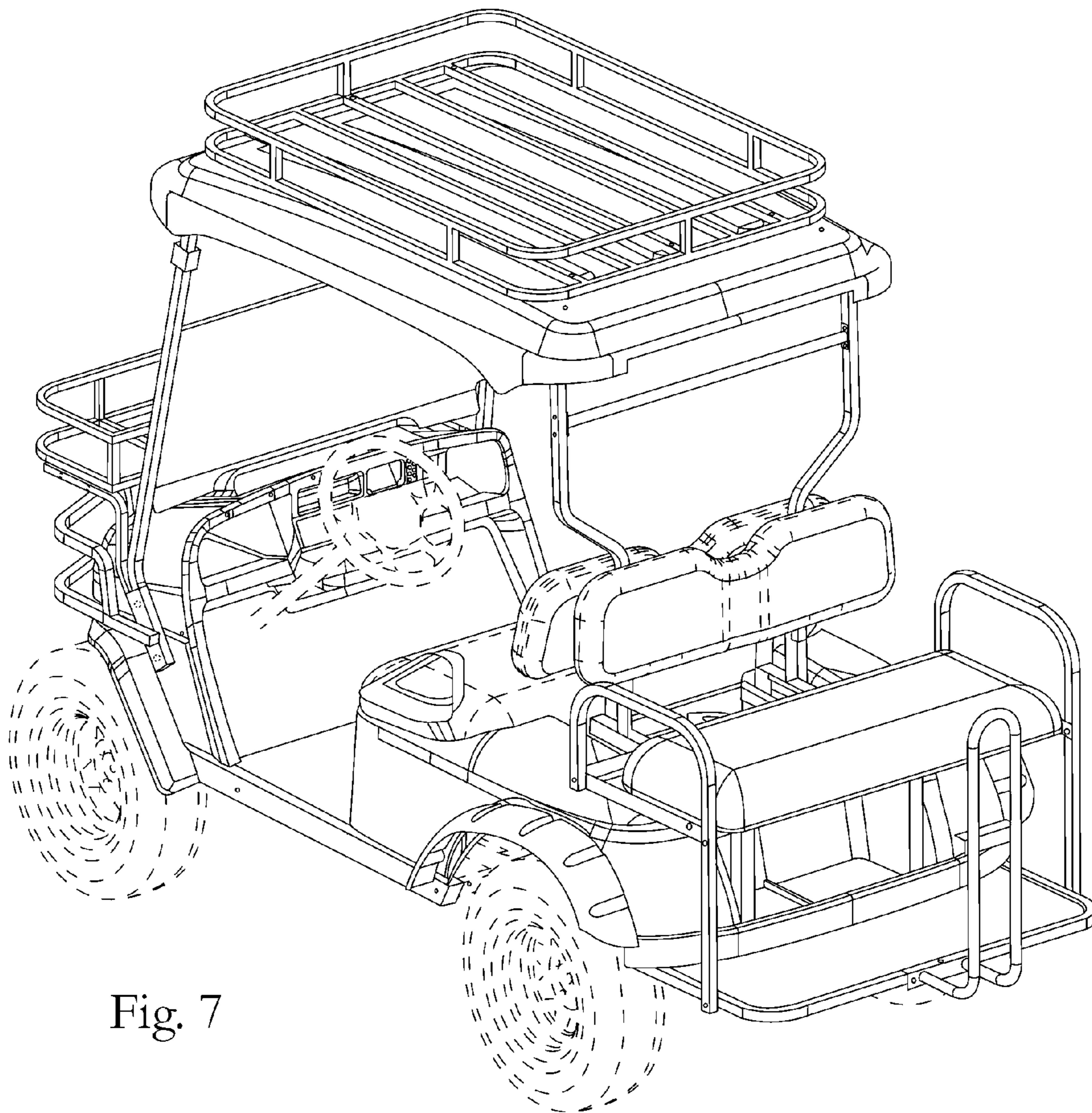

Fig. 7