



US00D588115S

(12) **United States Design Patent**
Yoshioka

(10) **Patent No.:** **US D588,115 S**
(45) **Date of Patent:** **** Mar. 10, 2009**

(54) **ANTENNA**

(75) Inventor: **Hiroki Yoshioka**, Tokyo (JP)

(73) Assignee: **Mitsumi Electric Co., Ltd**, Tokyo (JP)

(**) Term: **14 Years**

(21) Appl. No.: **29/303,754**

(22) Filed: **Feb. 15, 2008**

(30) **Foreign Application Priority Data**

Aug. 20, 2007 (JP) 2007-022449

(51) **LOC (9) Cl.** **14-03**

(52) **U.S. Cl.** **D14/230**

(58) **Field of Classification Search** D14/138,
D14/230-238, 299, 358; D12/42, 43; 343/700 MS,
343/700 R-705, 711-713, 741, 748, 767,
343/795, 819, 840, 846, 866, 871-908; 455/90.2,
455/90.3, 91, 128, 269, 344, 347, 562.1
See application file for complete search history.

(56) **References Cited**

U.S. PATENT DOCUMENTS

6,724,348 B2 * 4/2004 Fang 343/702
7,148,849 B2 * 12/2006 Lin 343/700 MS
D535,290 S * 1/2007 Su et al. D14/230
D555,154 S * 11/2007 Lin et al. D14/230
7,352,329 B2 * 4/2008 Chung et al. 343/700 MS
7,405,704 B1 * 7/2008 Lin et al. 343/702
7,427,956 B2 * 9/2008 Liao 343/700 MS

7,429,955 B2 * 9/2008 Tai et al. 343/702
2005/0073462 A1 * 4/2005 Lin et al. 343/702
2005/0128151 A1 * 6/2005 Kwak et al. 343/702
2006/0017620 A1 * 1/2006 Chen et al. 343/700 MS
2006/0197705 A1 * 9/2006 Chen et al. 343/700 MS
2007/0040750 A1 * 2/2007 Tai et al. 343/700 MS
2008/0111760 A1 * 5/2008 Sakama et al. 343/860
2008/0150829 A1 * 6/2008 Lin et al. 343/860

* cited by examiner

Primary Examiner—T. Chase Nelson

Assistant Examiner—John Windmuller

(74) *Attorney, Agent, or Firm*—Sughrue Mion, PLLC

(57) **CLAIM**

The ornamental design for an antenna, as shown and described.

DESCRIPTION

FIG. 1 is a perspective view of the bottom, front and right side of an antenna showing my new design;

FIG. 2 is a front elevational view thereof;

FIG. 3 is a rear elevational view thereof;

FIG. 4 is a left side elevational view thereof;

FIG. 5 is a right side elevational view thereof;

FIG. 6 is a top plan view thereof; and,

FIG. 7 is a bottom plan view thereof.

The portions shown in broken lines are for illustrative purposes only and form no part of the claimed design.

1 Claim, 5 Drawing Sheets

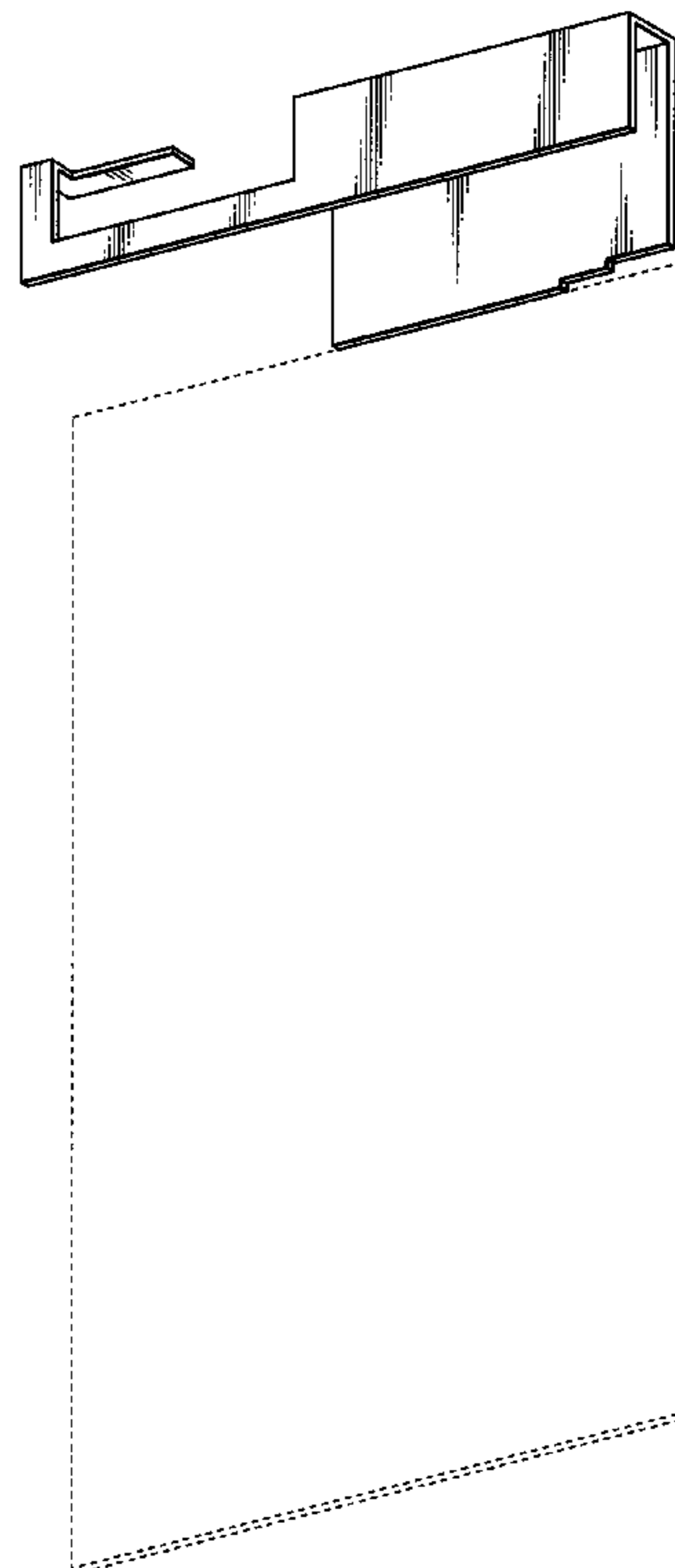

FIG. 1



FIG.2



FIG.3

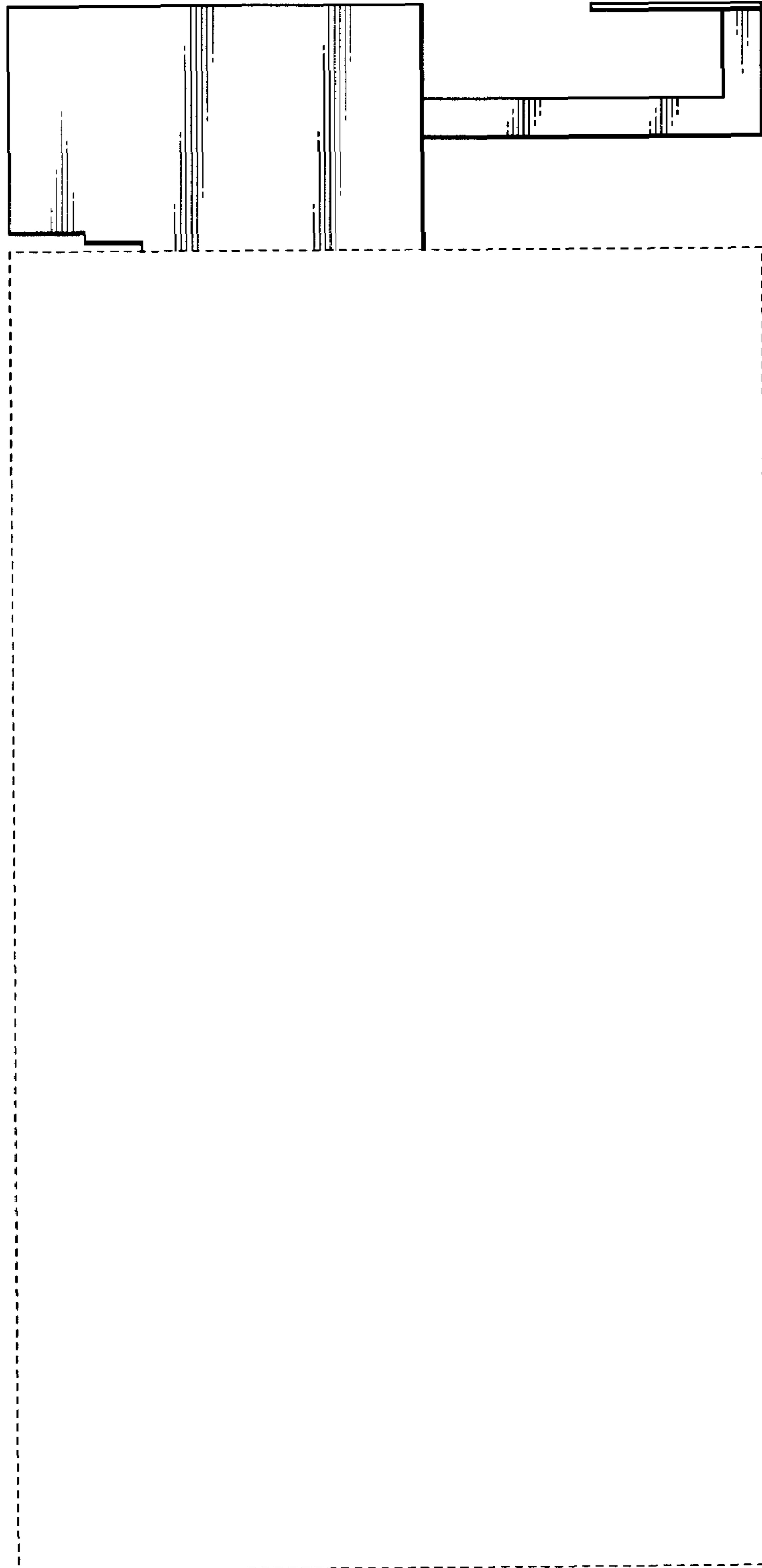

FIG.4

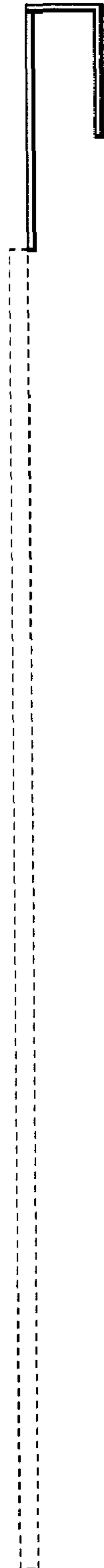

FIG.5

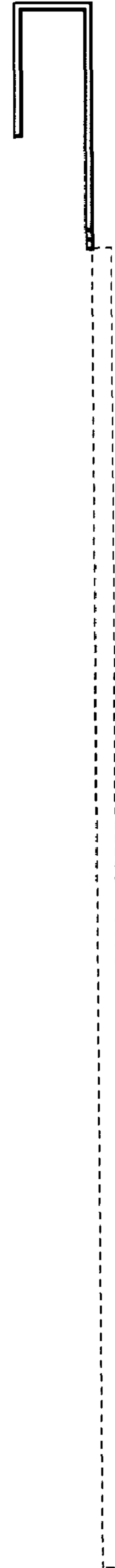

FIG.6

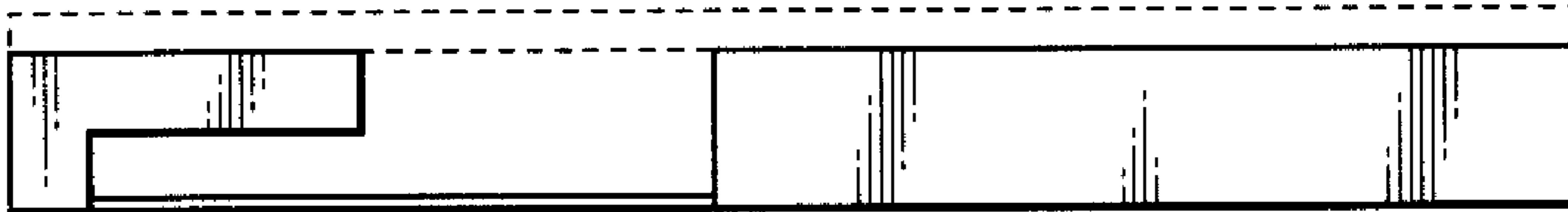

FIG.7

