



US00D585967S

(12) **United States Design Patent**
Shieh

(10) **Patent No.:** **US D585,967 S**

(45) **Date of Patent:** **** Feb. 3, 2009**

(54) **FAUCET BODY**

(75) Inventor: **Ming-Dang Shieh**, Chang Hua Hsien (TW)

(73) Assignee: **Horng Lai Industrial Co., Ltd.**, Chang Hua Hsien (TW)

(**) Term: **14 Years**

(21) Appl. No.: **29/295,842**

(22) Filed: **Oct. 9, 2007**

(51) **LOC (9) Cl.** **23-01**

(52) **U.S. Cl.** **D23/255**

(58) **Field of Classification Search** D23/200,
D23/238-257; 4/675-678; 137/801; 16/110.1,
16/441

See application file for complete search history.

(56) **References Cited**

U.S. PATENT DOCUMENTS

D522,105 S *	5/2006	Fritz	D23/255
D530,783 S *	10/2006	Bayer	D23/238
D561,876 S *	2/2008	Krumpe et al.	D23/242
D569,950 S *	5/2008	Williams	D23/238

* cited by examiner

Primary Examiner—Robert A Delehanty

(74) *Attorney, Agent, or Firm*—Alan Kamrath; Kamrath & Associates PA

(57) **CLAIM**

The ornamental design for a faucet body, as shown and described.

DESCRIPTION

FIG. 1 is a perspective view of a faucet body showing my design;

FIG. 2 is a front faucet body view thereof;

FIG. 3 is a rear faucet body view thereof;

FIG. 4 is a left side faucet body view thereof;

FIG. 5 is a right side faucet body view thereof; and,

FIG. 6 is a top plan view thereof.

The broken line showing of the interior of the spout is for illustrative purposes only and forms no part of the claimed design.

1 Claim, 4 Drawing Sheets

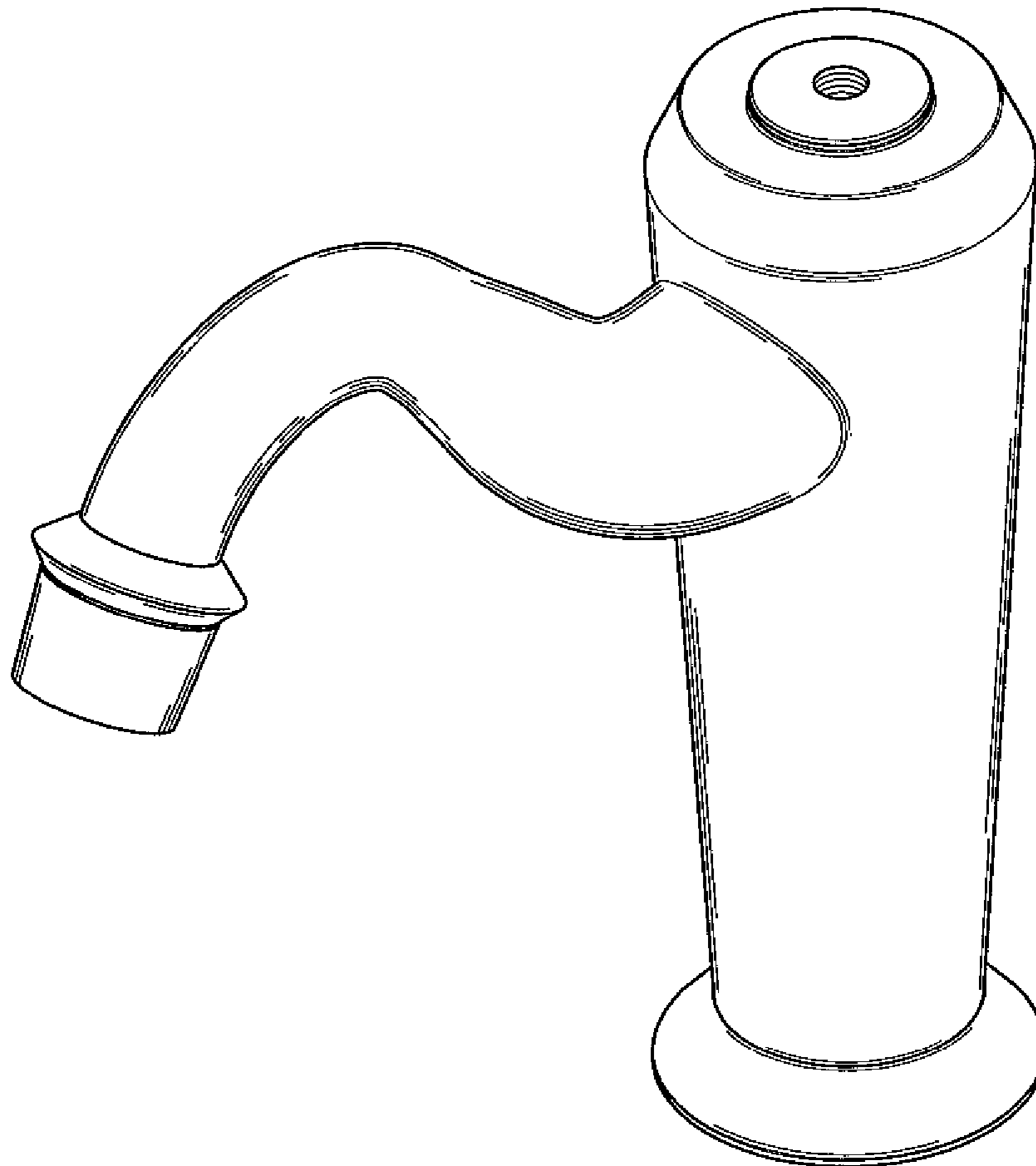

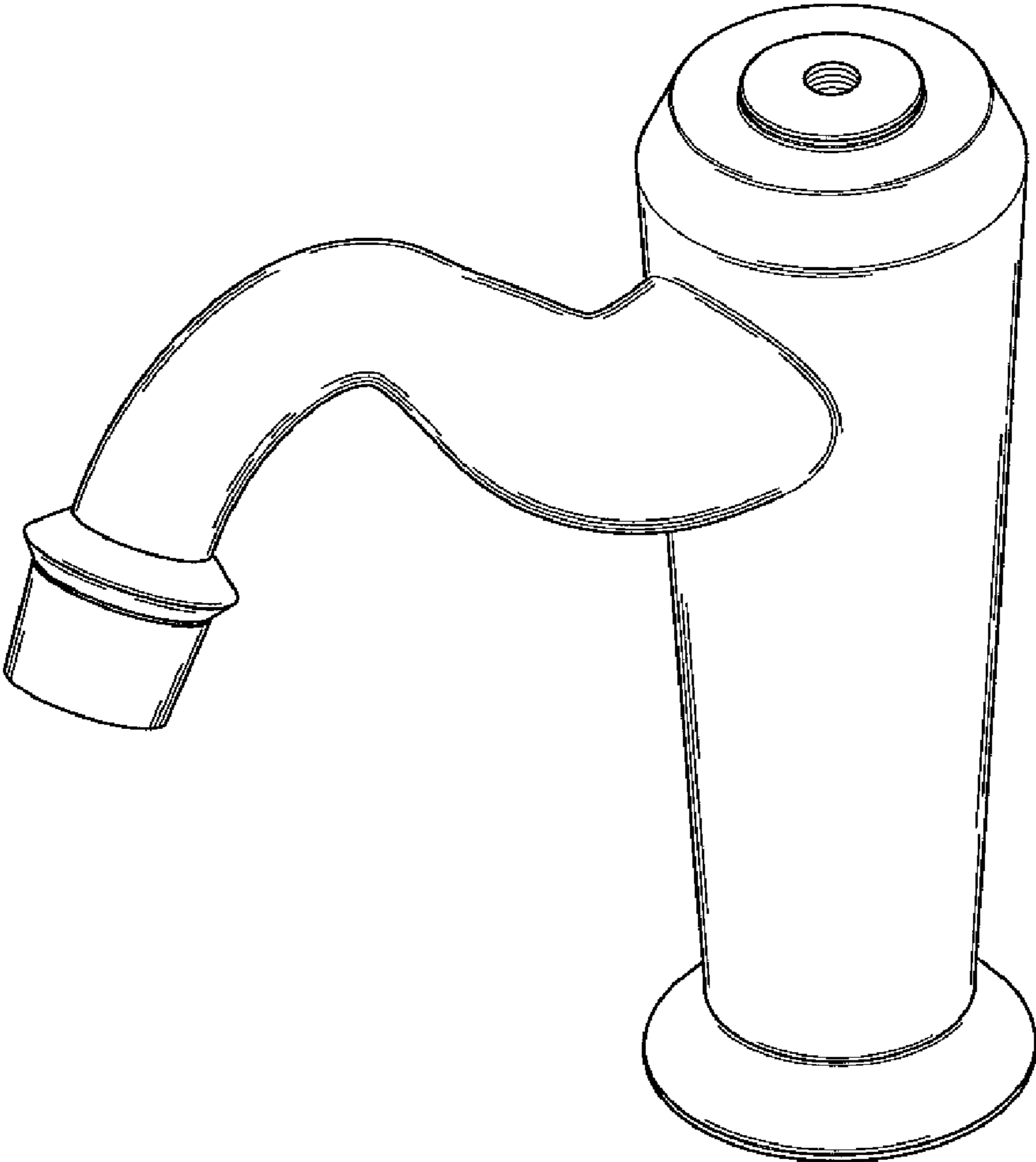

FIG. 1

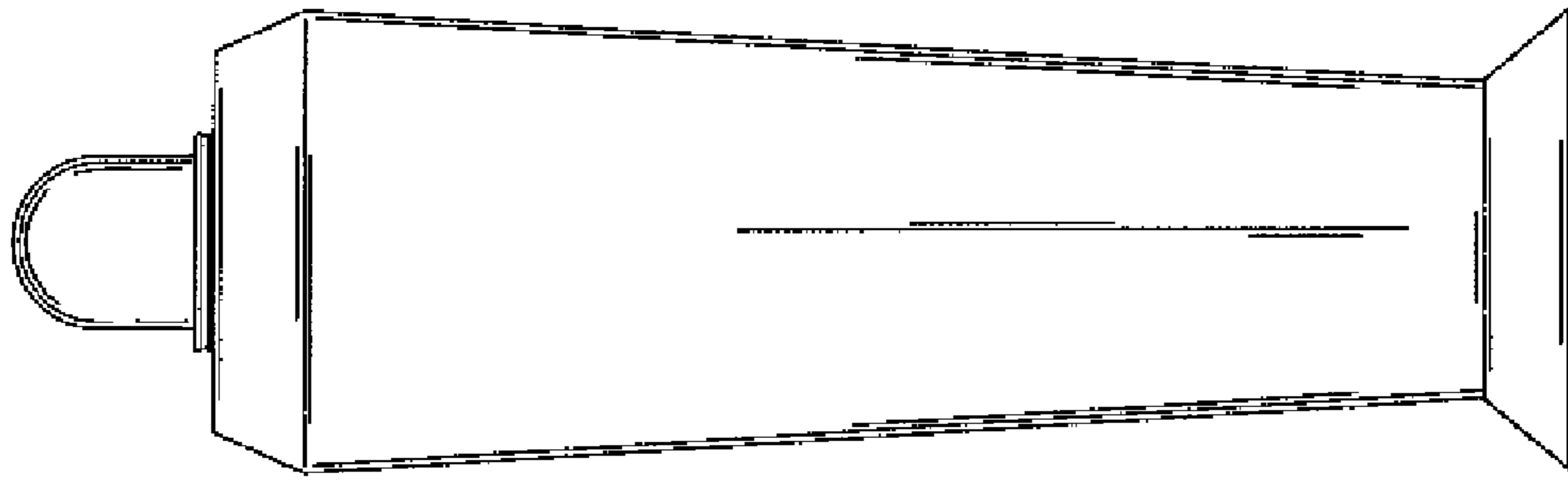

FIG. 3

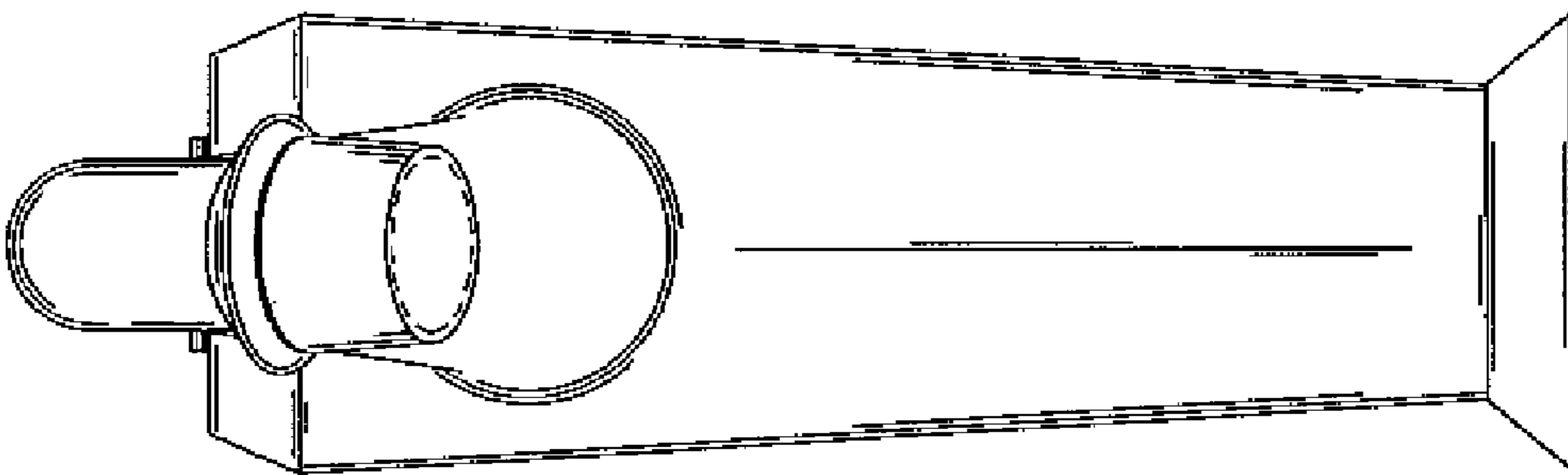

FIG. 2

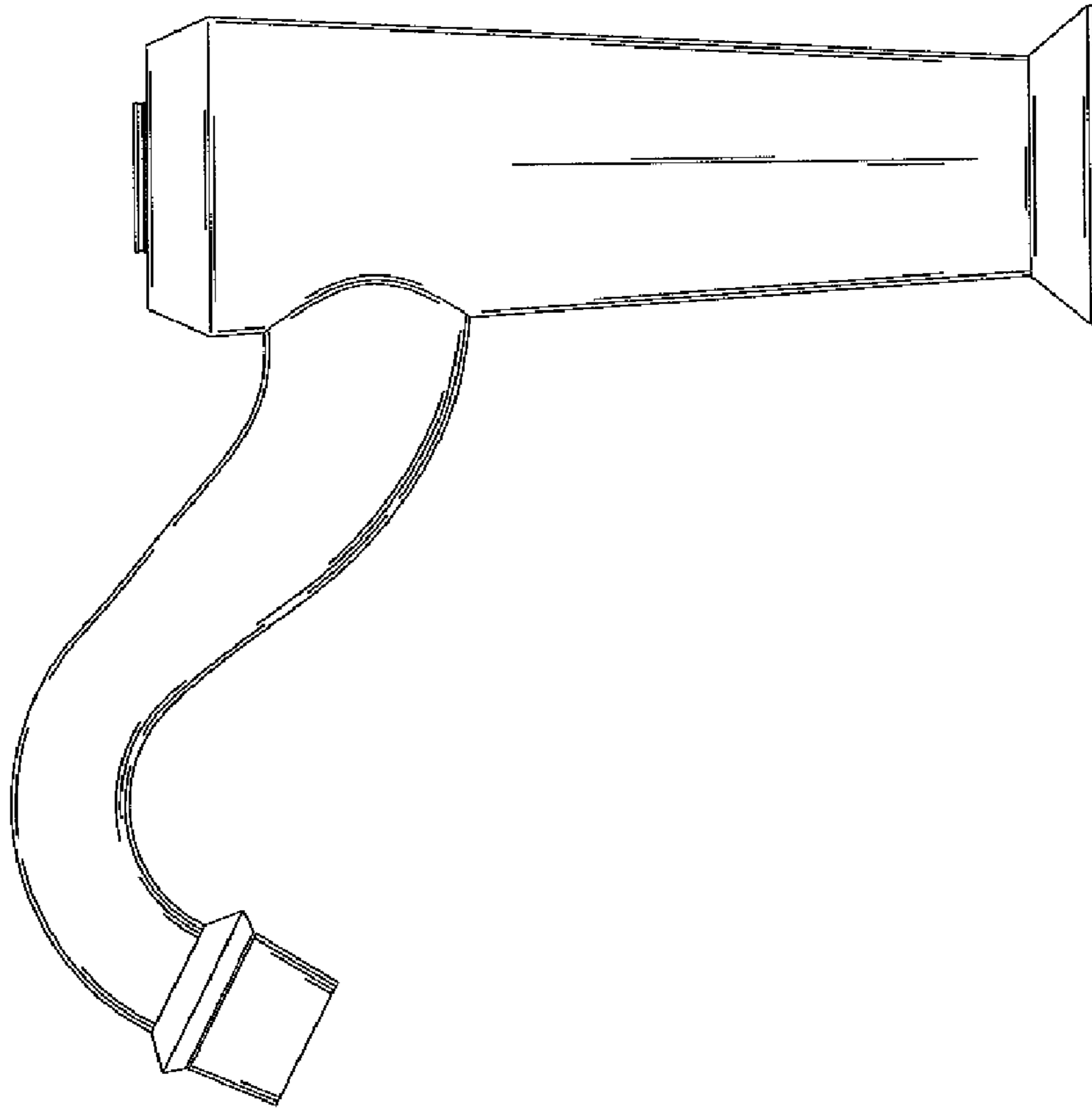

FIG. 4

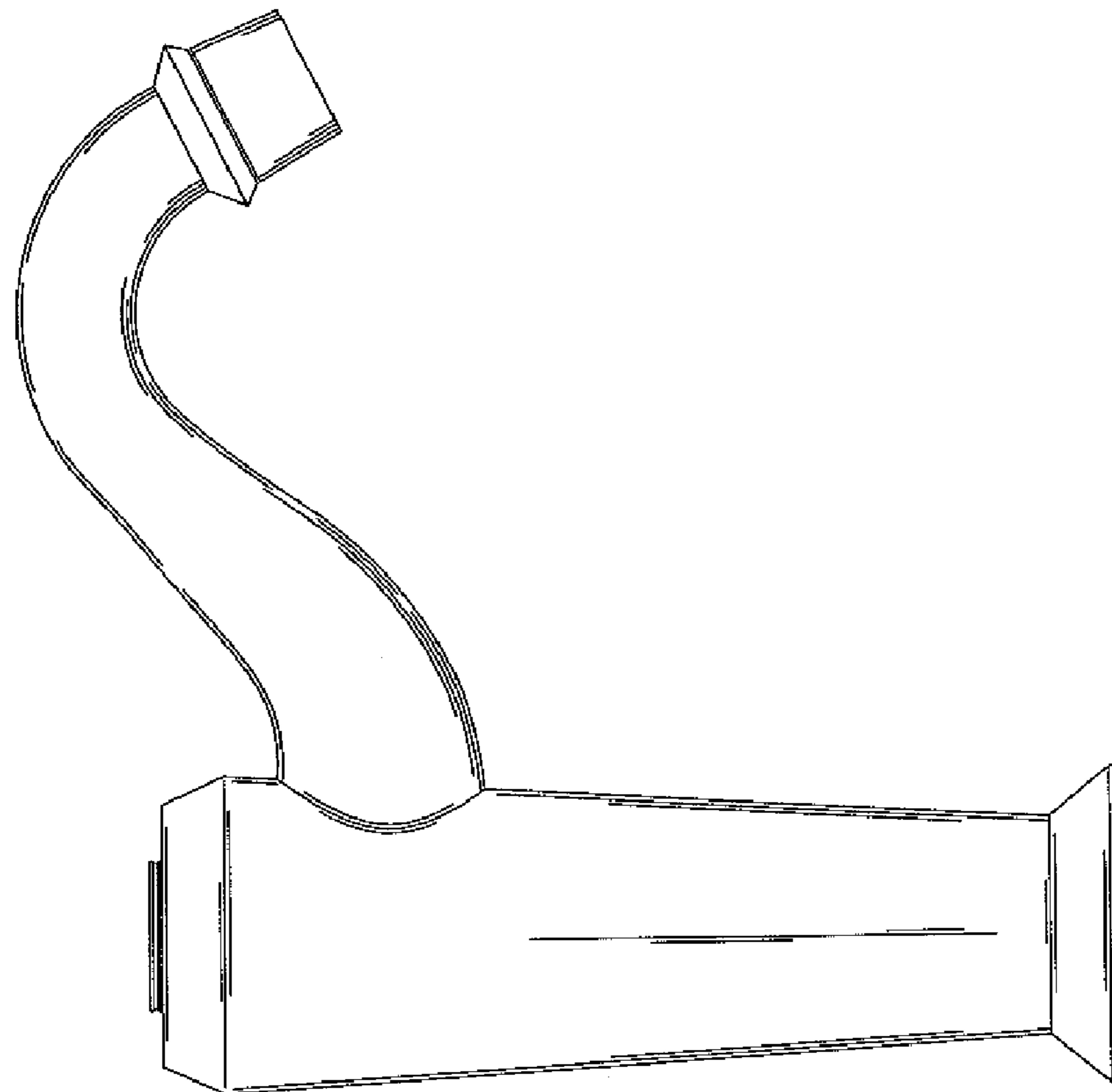

FIG. 5

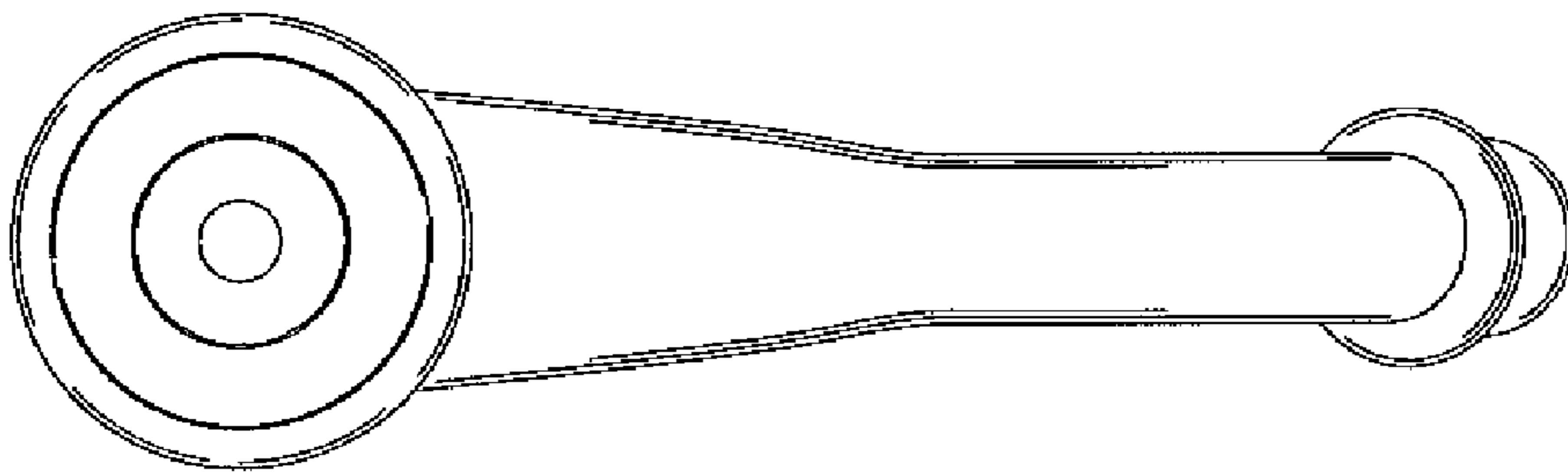

FIG. 6