



US00D585515S

(12) **United States Design Patent**
Faifer

(10) **Patent No.:** **US D585,515 S**

(45) **Date of Patent:** **** Jan. 27, 2009**

(54) **RAIL CONNECTOR**

(76) Inventor: **Tuvia Faifer**, 43 Yaacov Olamy Street,
50297 Mishmar HaShiva (IL)

(**) Term: **14 Years**

(21) Appl. No.: **29/223,624**

(22) Filed: **Feb. 16, 2005**

(30) **Foreign Application Priority Data**

| | | | |
|---------------|------|-------|-------|
| Aug. 17, 2004 | (IL) | | 39578 |
| Jan. 23, 2005 | (IL) | | 40203 |

(51) **LOC (9) Cl.** **22-01**

(52) **U.S. Cl.** **D22/108**

(58) **Field of Classification Search** D22/108,
D22/109, 110, 199; 42/85, 94, 124-128;
D3/222, 223; 89/37.01, 37.04, 37.12; 224/149,
224/150, 913; D6/315, 318, 327, 328; 24/2.5,
24/24

See application file for complete search history.

(56) **References Cited**

U.S. PATENT DOCUMENTS

| | | | | | |
|-----------|------|---------|----------------|-------|---------|
| 5,303,859 | A * | 4/1994 | Jenkin | | 224/149 |
| D391,335 | S * | 2/1998 | Bechtel | | D22/110 |
| 6,325,258 | B1 * | 12/2001 | Verdugo et al. | | 42/85 |
| D508,726 | S * | 8/2005 | Storch | | D22/108 |
| D525,336 | S * | 7/2006 | Esch | | D22/108 |

Primary Examiner—Cathron C Brooks

Assistant Examiner—Melanie Levy

(74) *Attorney, Agent, or Firm*—Robert L. Stone

(57) **CLAIM**

The ornamental design for a rail connector, as shown and described.

DESCRIPTION

FIG. 1 is a front elevational view of a rail connector showing my new design;

FIG. 2 is a front and side perspective view thereof;

FIG. 3 is a top perspective view thereof;

FIG. 4 is a rear and side perspective view thereof;

FIG. 5 is a bottom perspective view thereof;

FIG. 6 is a front perspective view thereof;

FIG. 7 is a top plan view thereof;

FIG. 8 is a rear and side perspective view of FIG. 6;

FIG. 9 is a bottom perspective view of FIG. 6;

FIG. 10 is a side elevational view of FIG. 6;

FIG. 11 is a bottom plan view of FIG. 6;

FIG. 12 is a rear elevational view of FIG. 6;

FIG. 13 is a perspective view of the rail connector of FIG. 6, with the broken lines being for illustrative purposes only and forming no part of the claimed design; and,

FIG. 14 is a perspective view of the rail connector of FIG. 1, with the broken lines being for illustrative purposes only and forming no part of the claimed design.

* cited by examiner

1 Claim, 4 Drawing Sheets

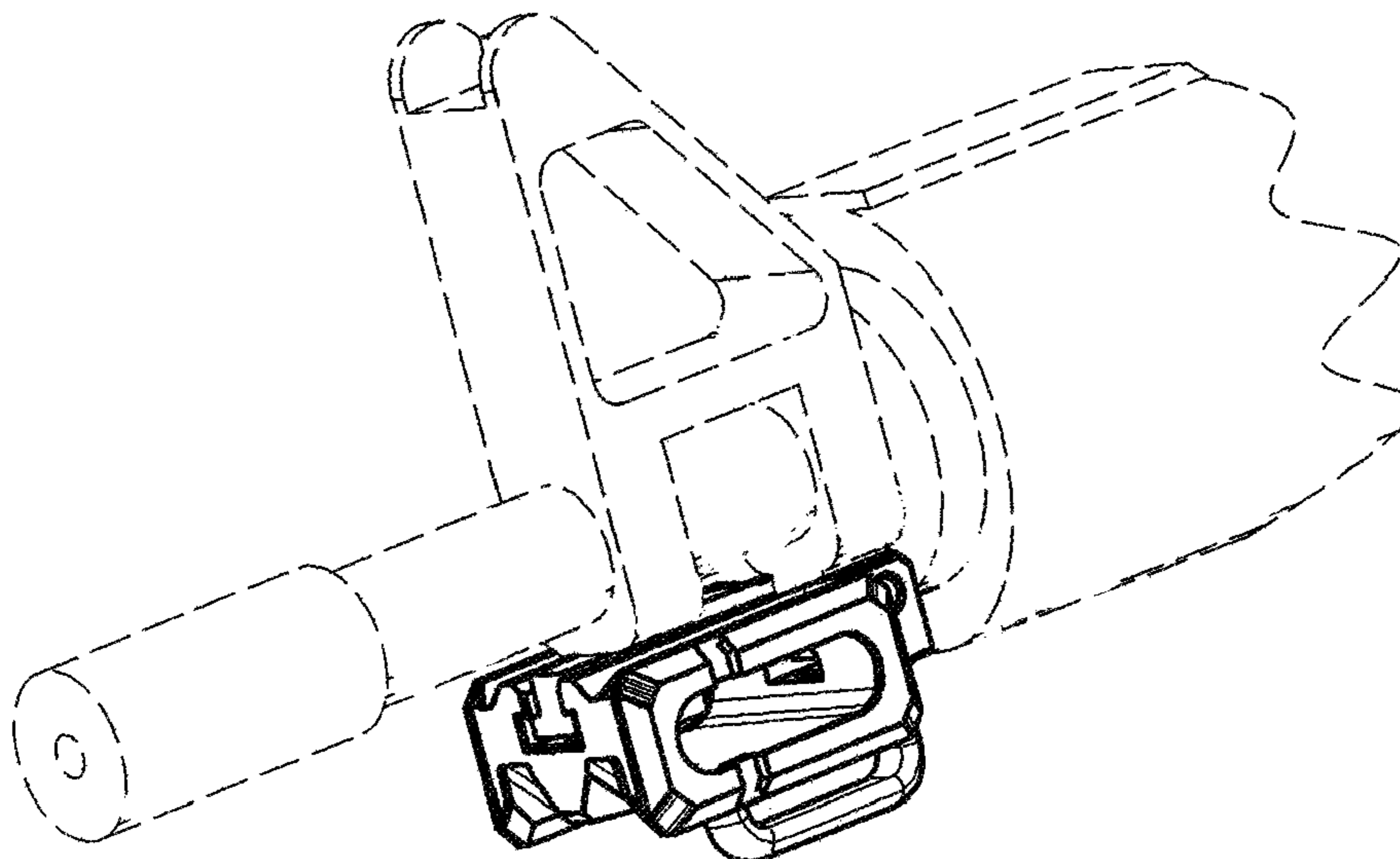

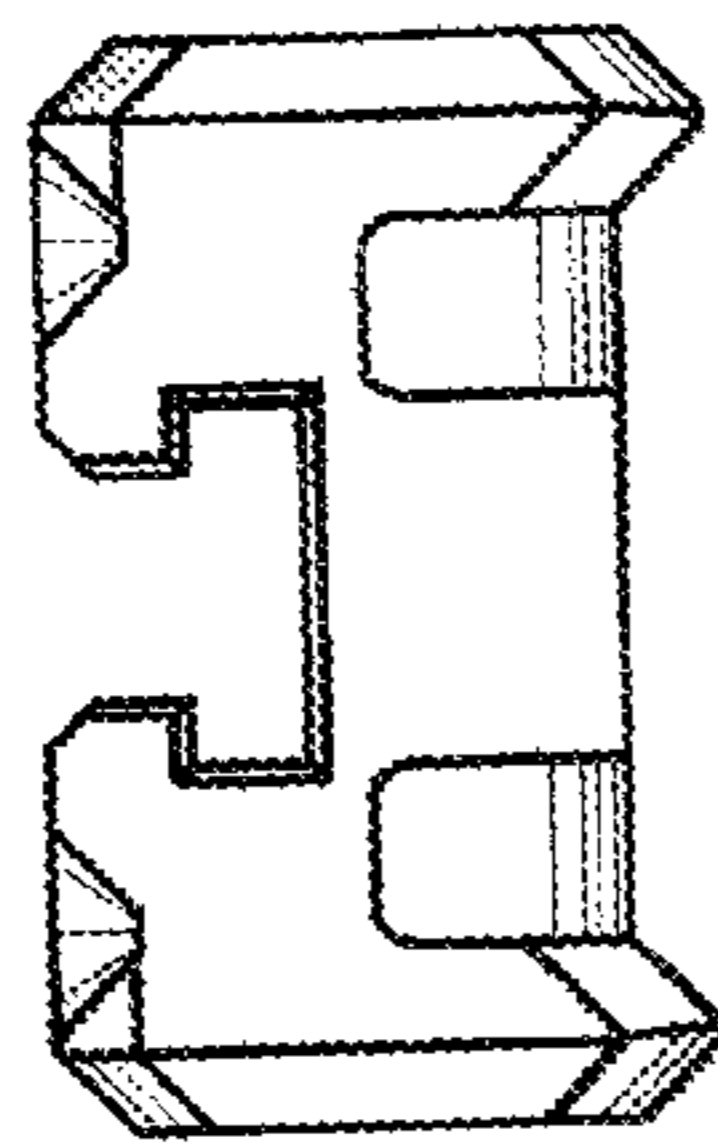

fig. 1

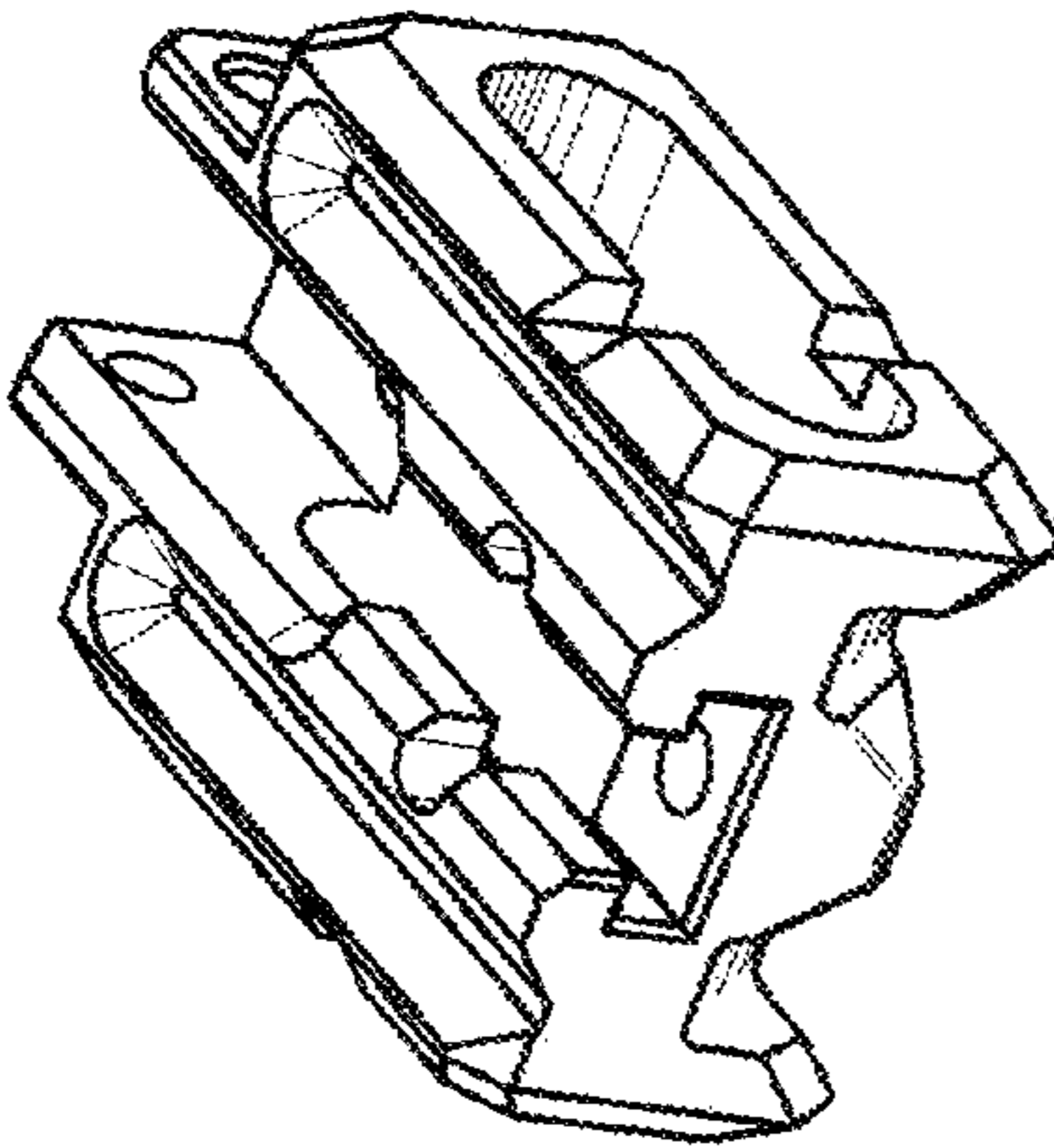

fig. 2

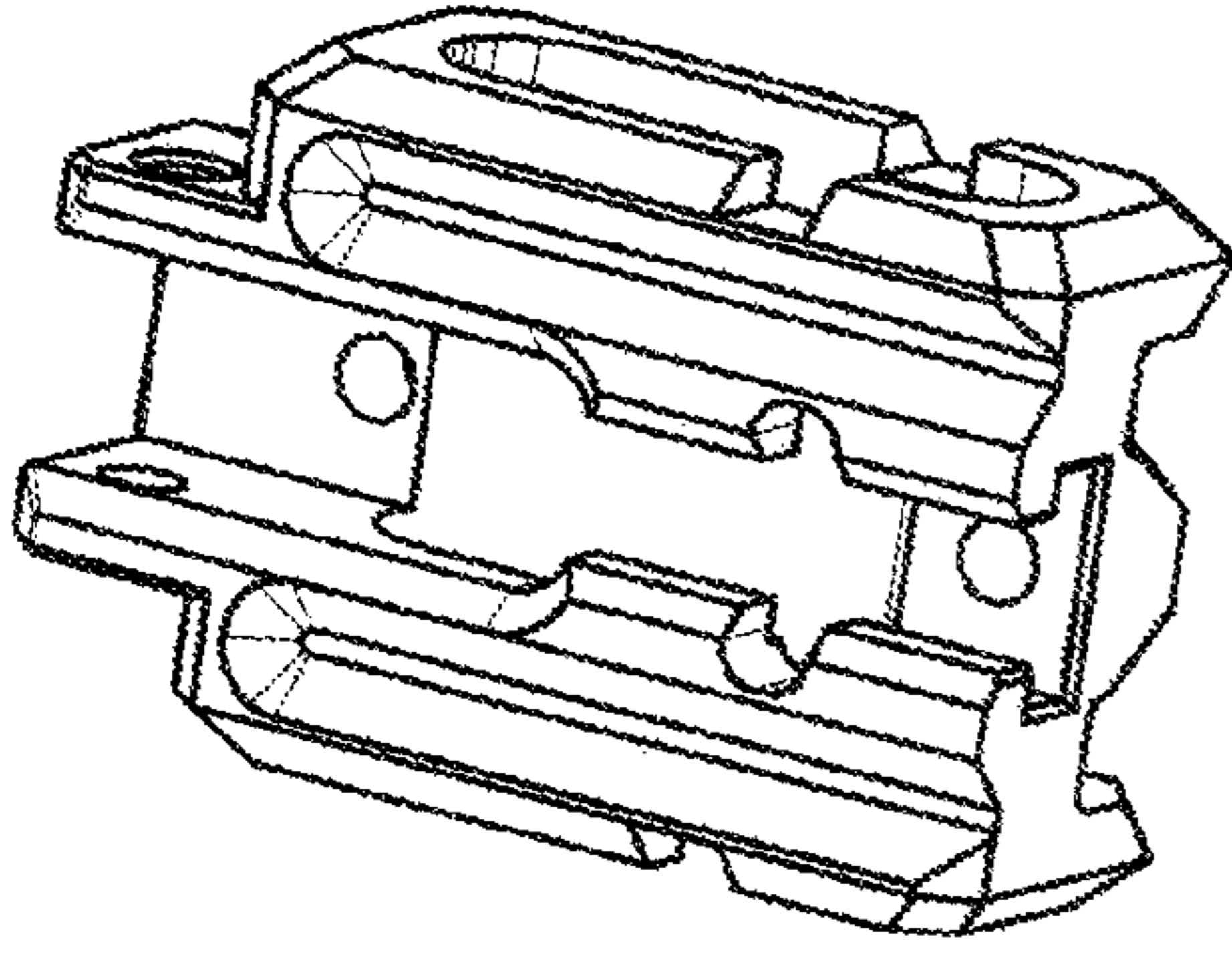

fig. 3

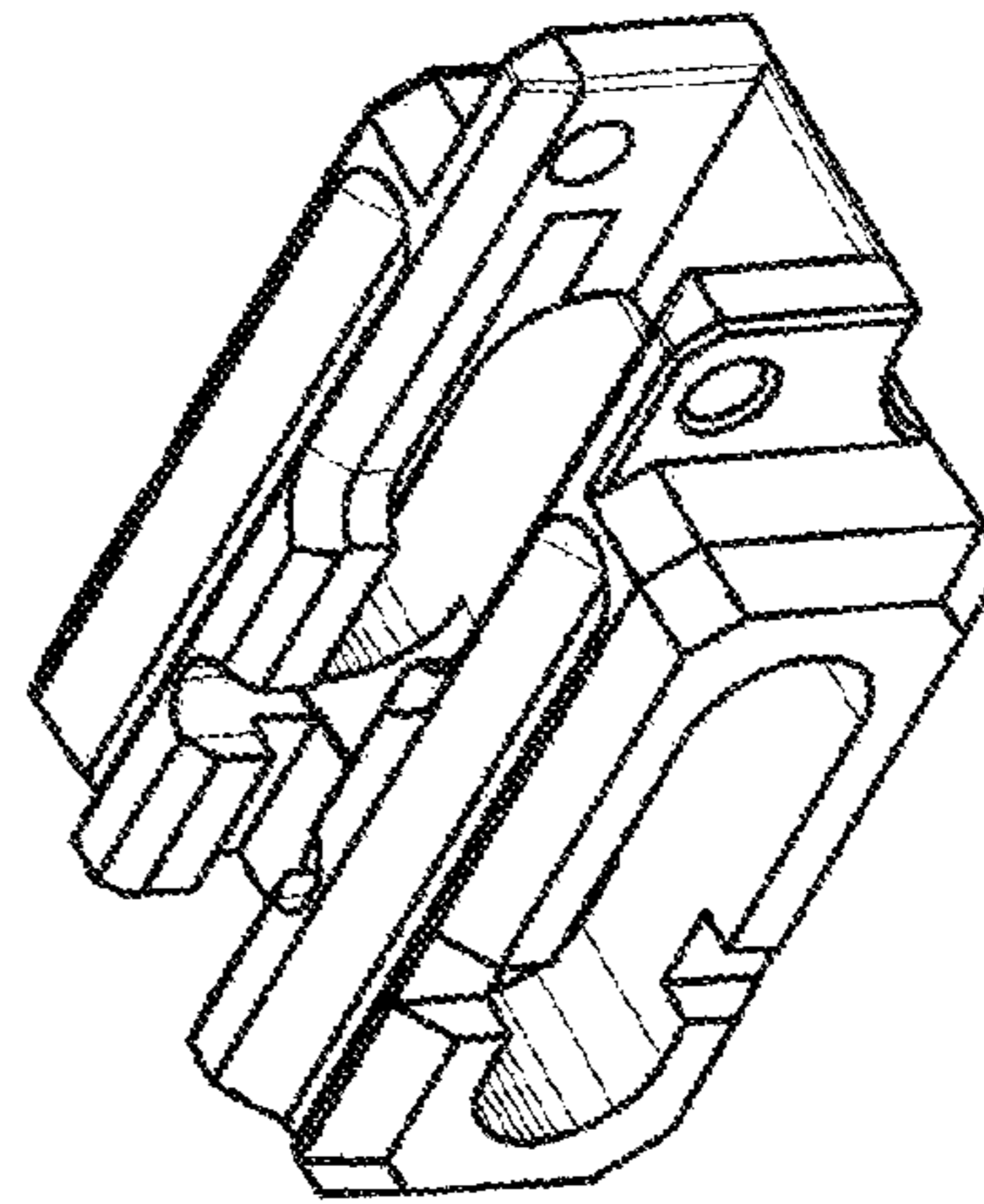

fig. 4

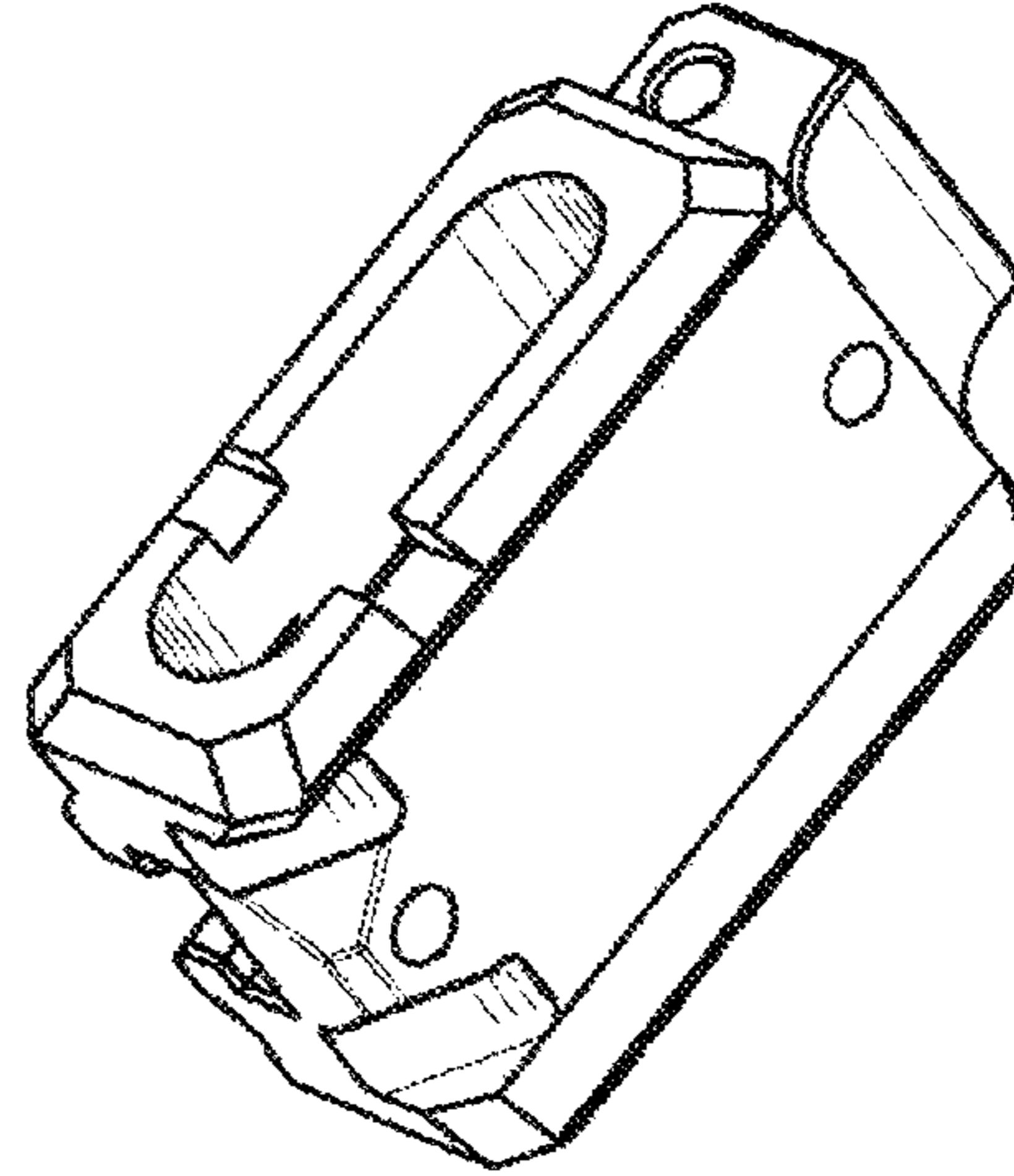

fig. 5

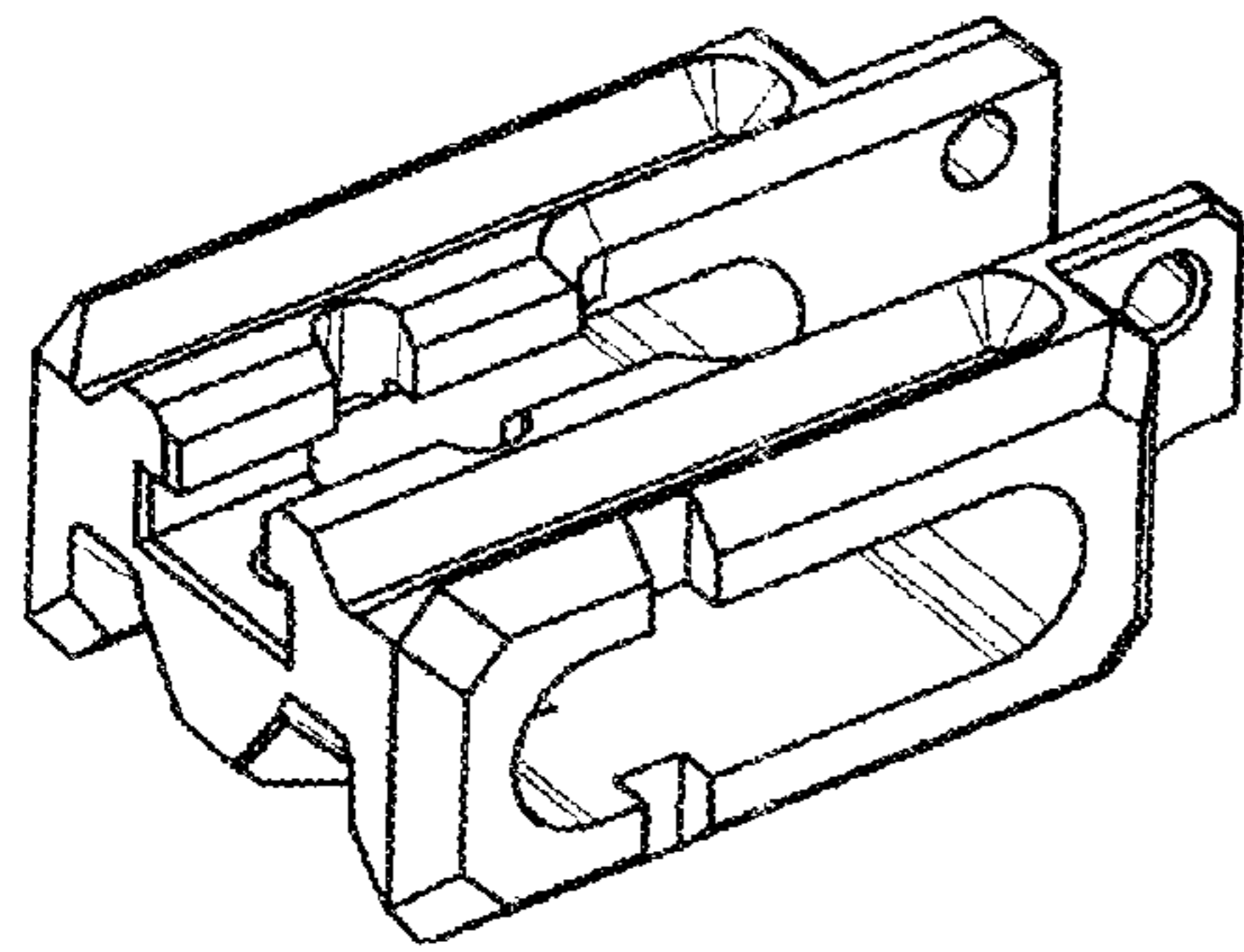

Fig.6

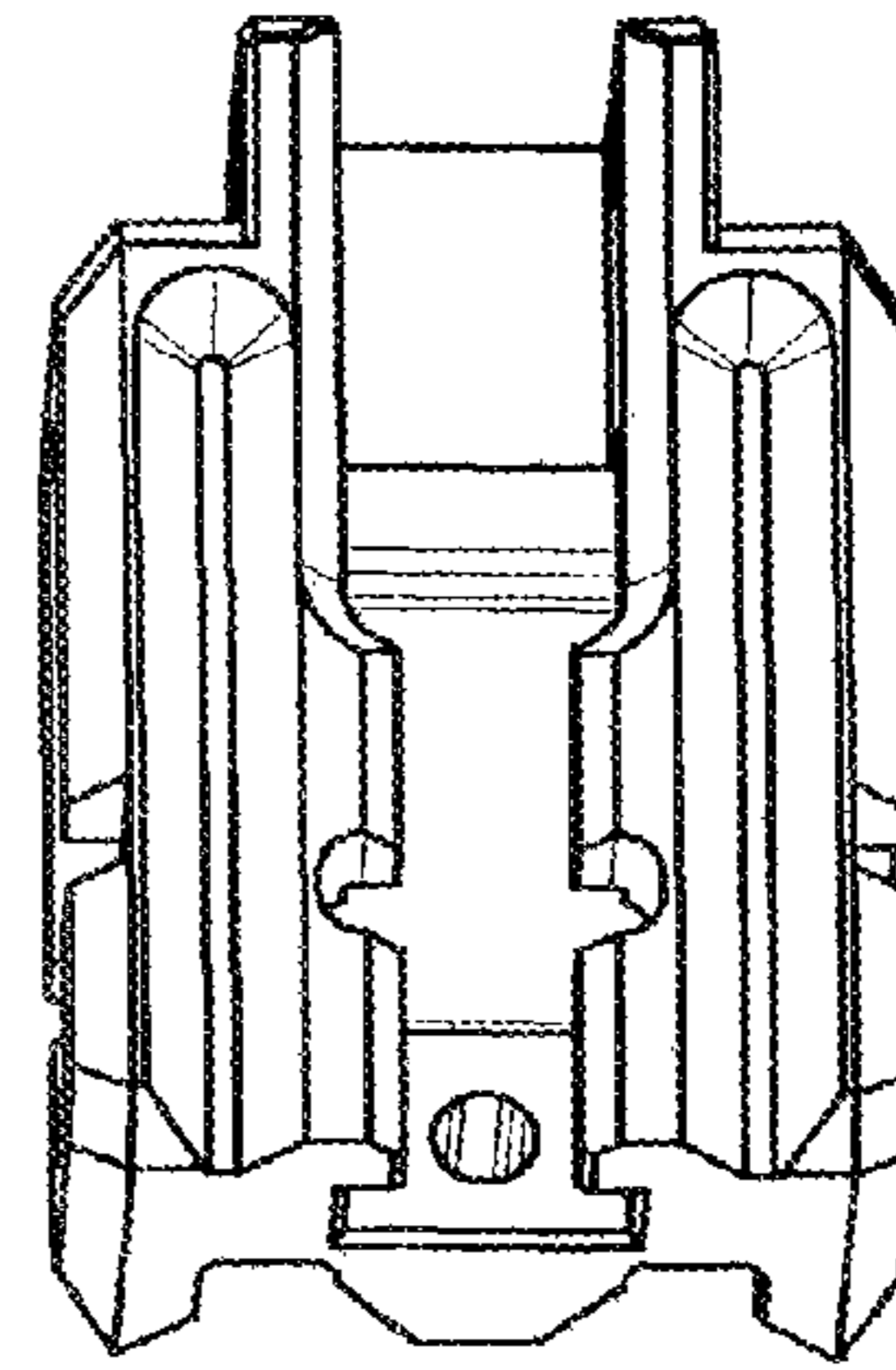

Fig.7

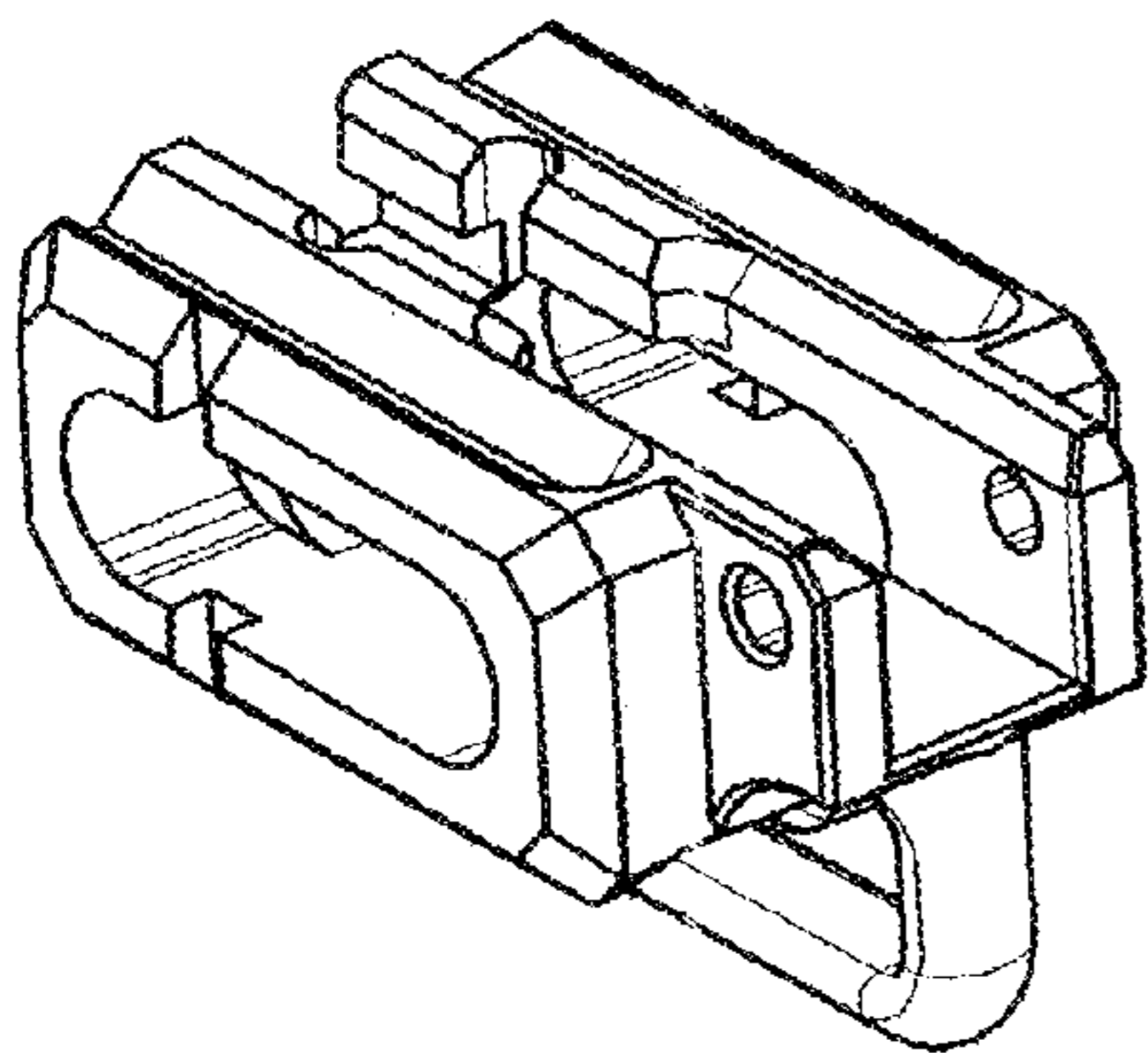

Fig.8

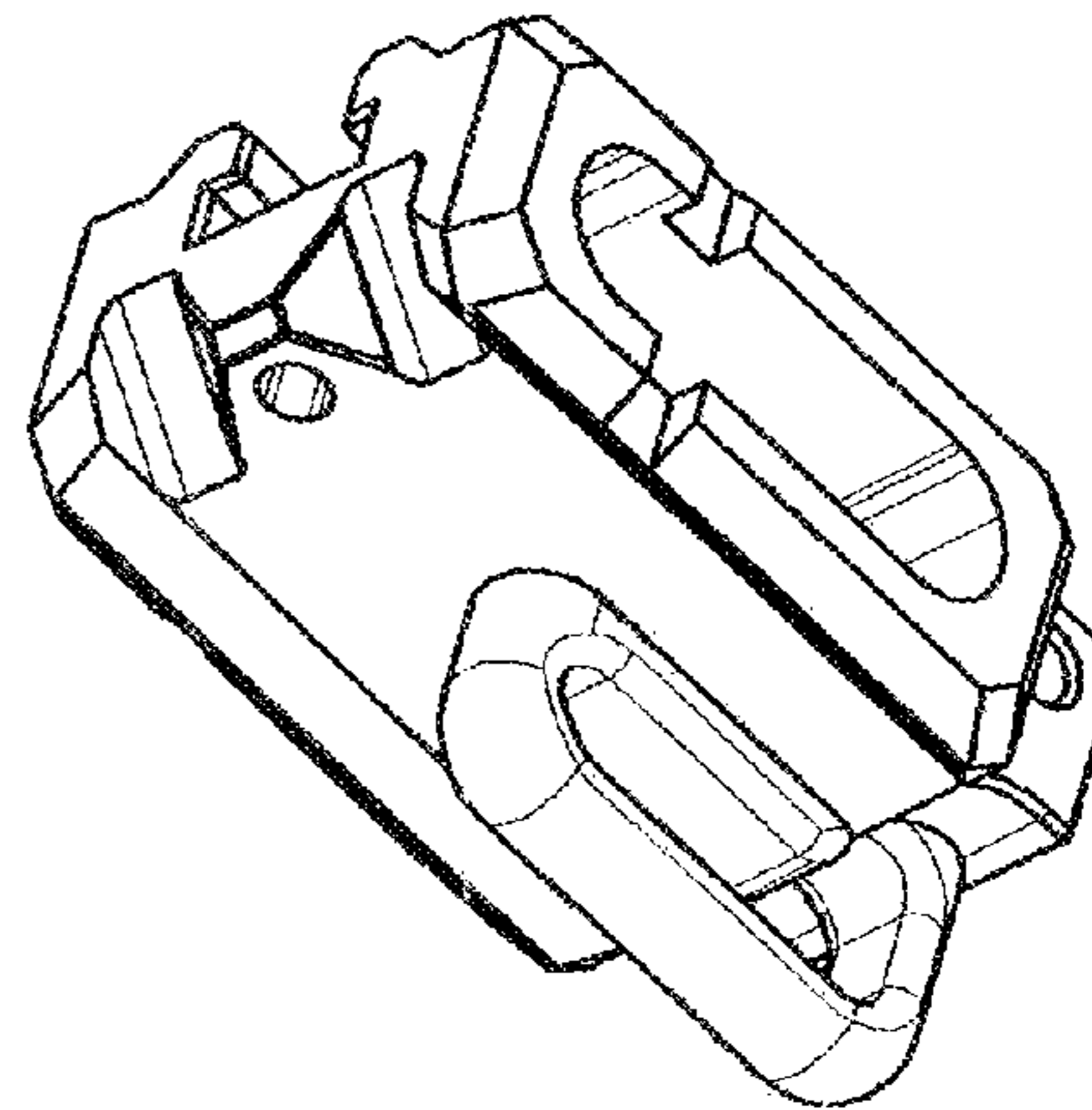

Fig.9

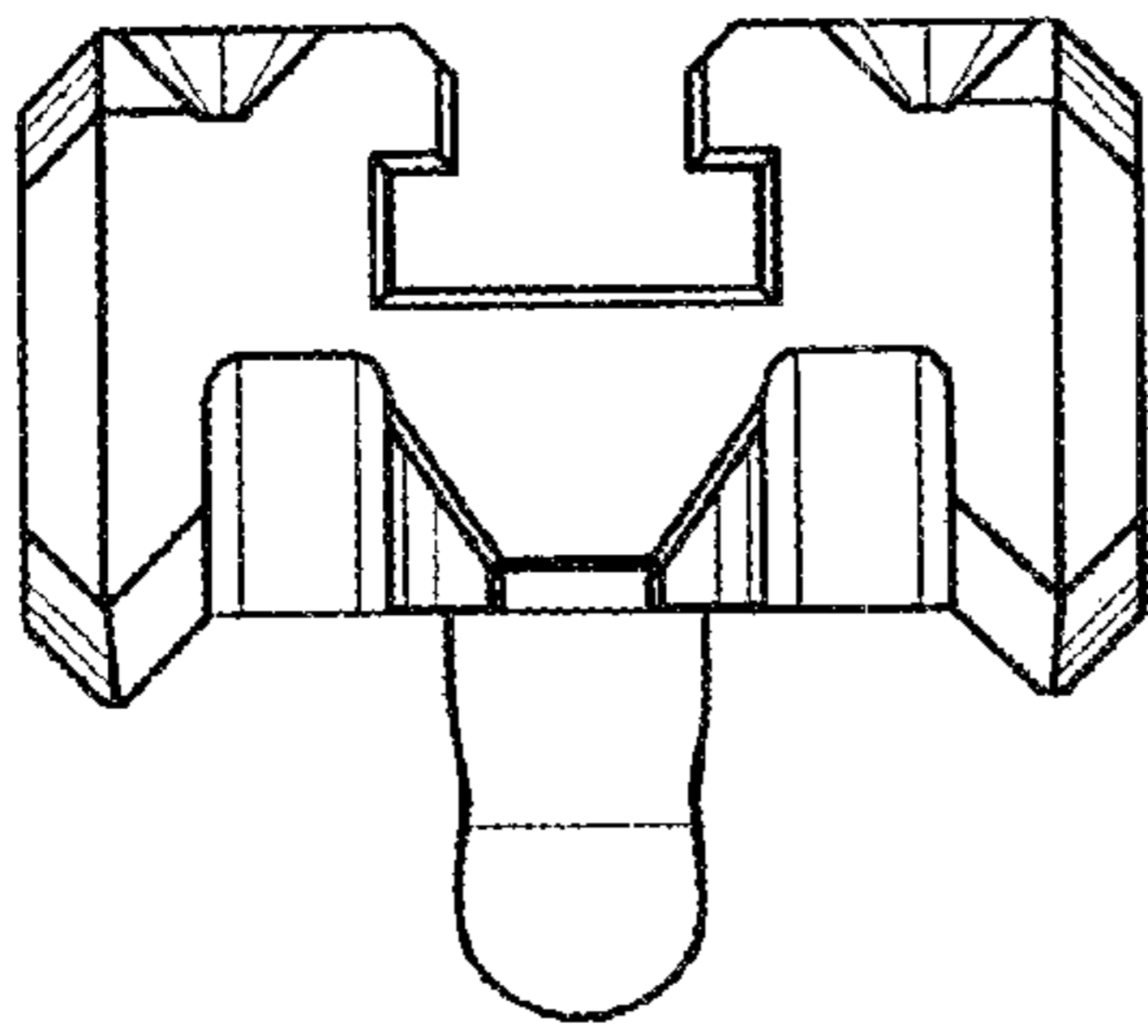

Fig. 12

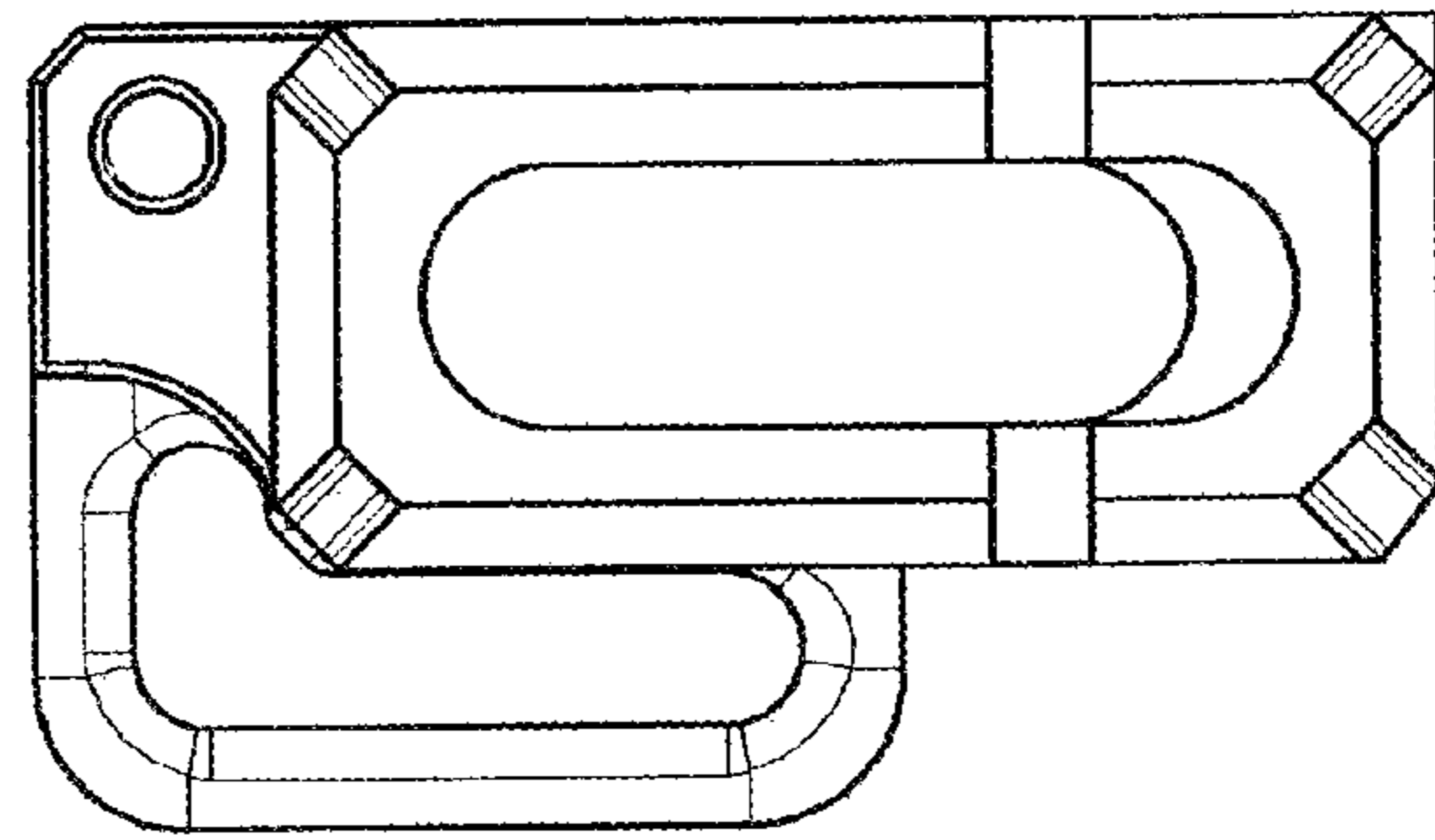

Fig. 10

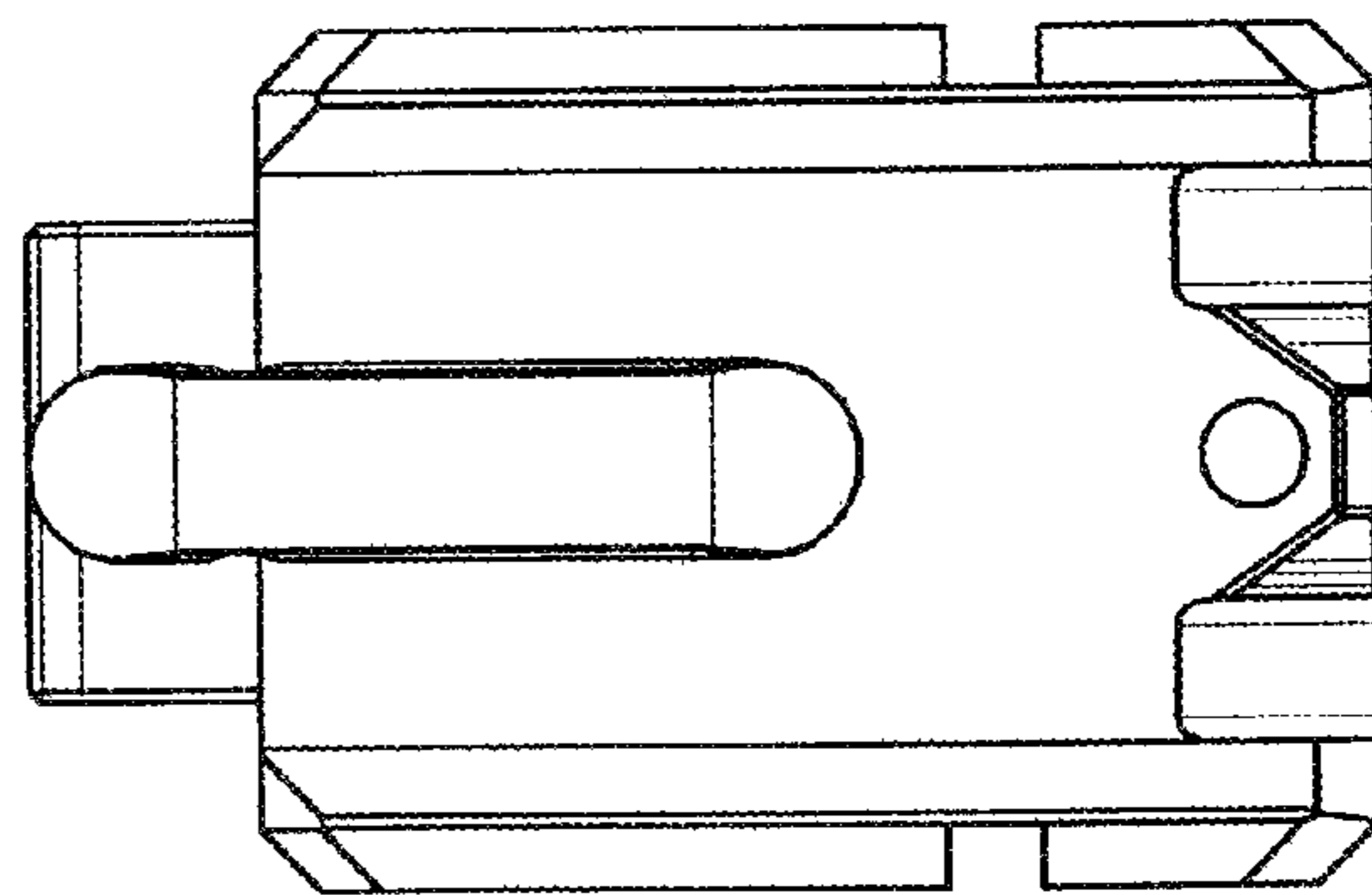

Fig. 11

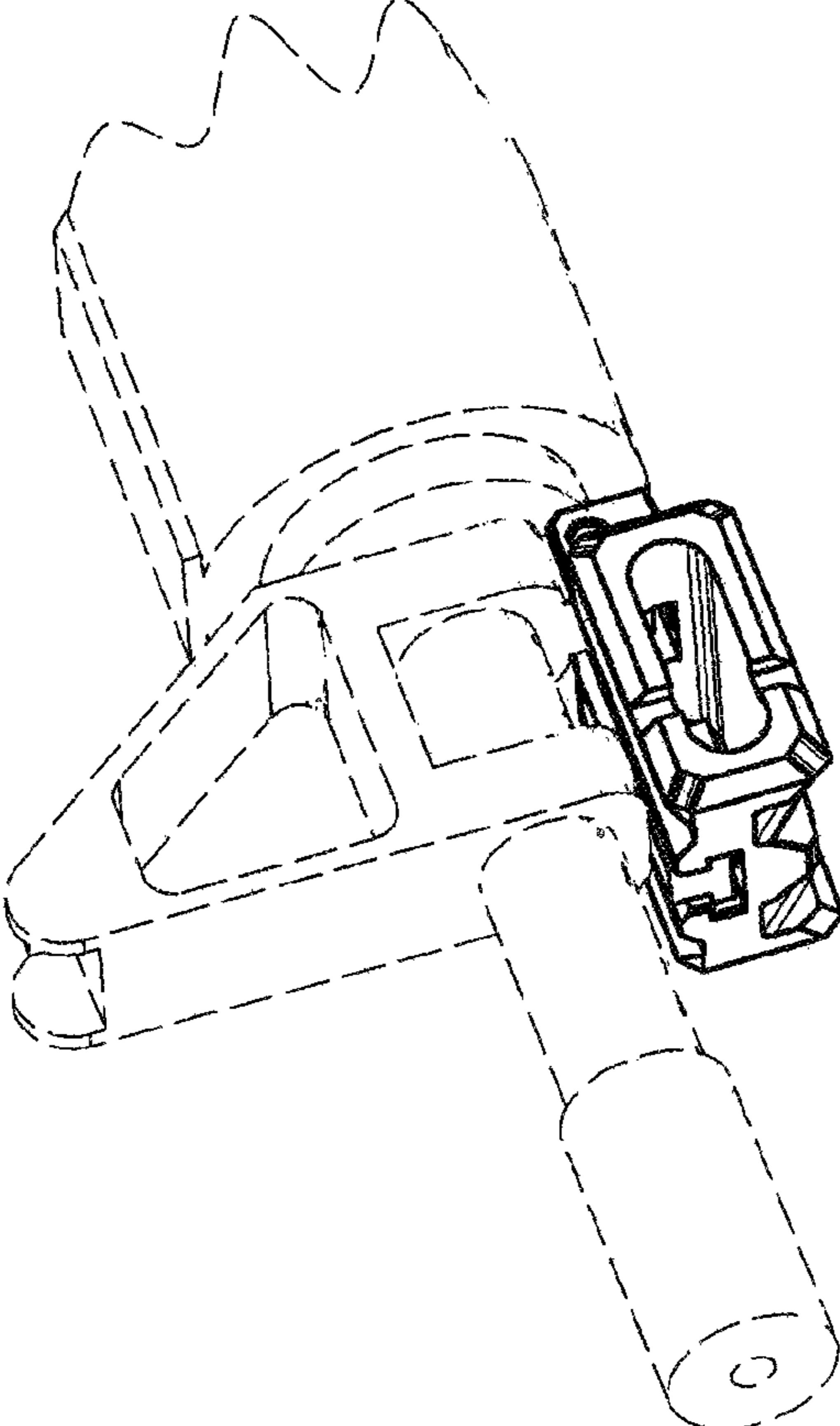

fig. 14

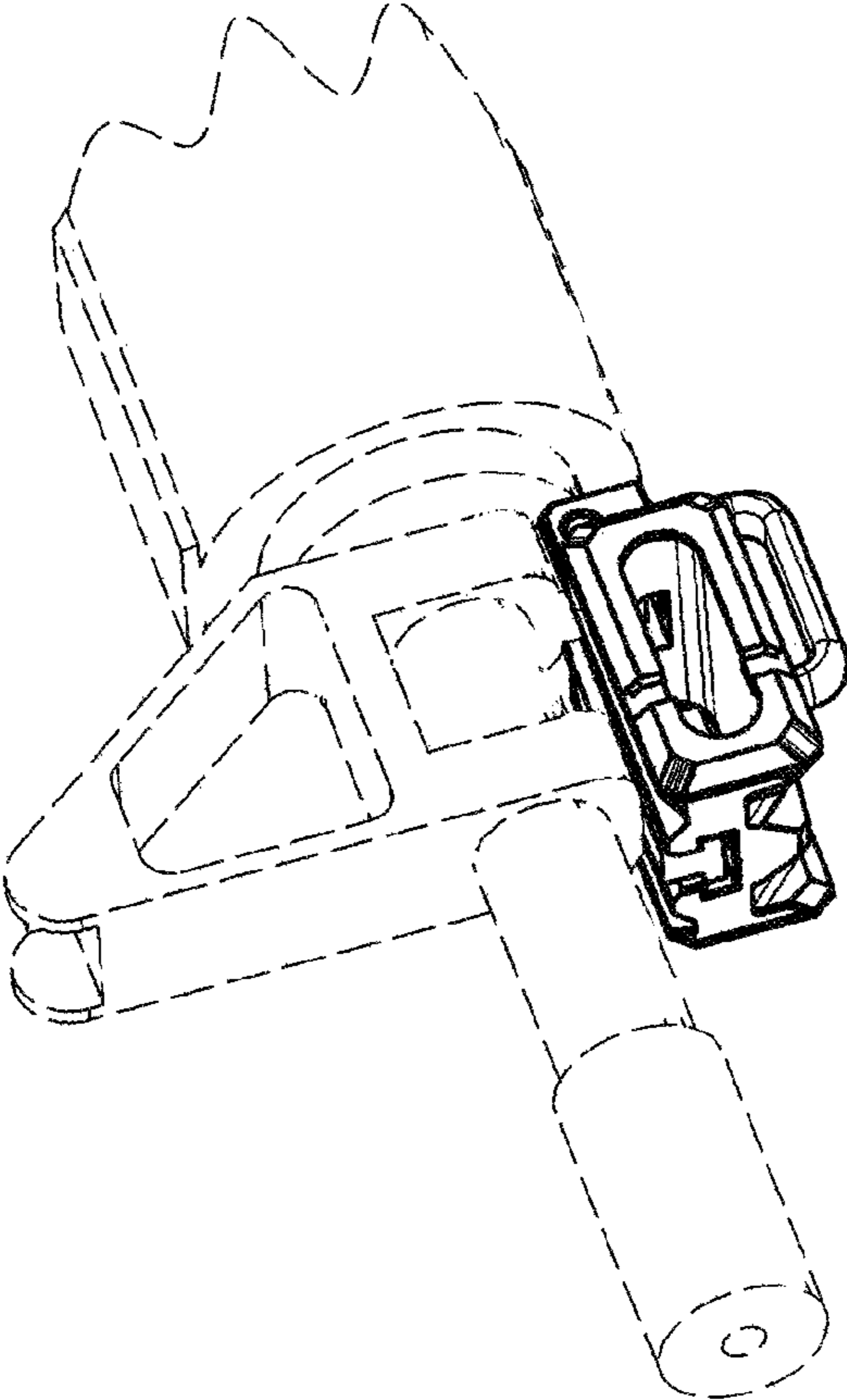

fig. 13