



US00D585461S

(12) **United States Design Patent**
Kovach et al.

(10) **Patent No.:** **US D585,461 S**
(45) **Date of Patent:** **** Jan. 27, 2009**

(54) **AGRICULTURAL TILLAGE PIVOTING GAUGE WHEEL**

6,052,644 A * 4/2000 Murakami et al. 701/93
6,880,644 B2 * 4/2005 Weast et al. 172/196
7,156,186 B2 * 1/2007 Knobloch et al. 172/701

(75) Inventors: **Michael George Kovach**, Morton, IL (US); **Greg Scott Smart**, Bettendorf, IA (US)

* cited by examiner

Primary Examiner—Antoine D Davis

(74) *Attorney, Agent, or Firm*—Rebecca Henkel

(73) Assignee: **CNH America, LLC**, Racine, WI (US)

(57) **CLAIM**

(**) Term: **14 Years**

We claim the ornamental design for the agricultural tillage pivoting gauge wheel, as shown and described.

(21) Appl. No.: **29/317,834**

(22) Filed: **May 8, 2008**

DESCRIPTION

(51) **LOC (9) Cl.** **15-03**

FIG. 1 is an upper right, perspective view of the agricultural tillage pivoting gauge wheel;

(52) **U.S. Cl.** **D15/11; D15/27**

FIG. 2 is a right view of the agricultural tillage pivoting gauge wheel;

(58) **Field of Classification Search** D15/11,

D15/27–28; 111/73, 123, 195; 172/701, 172/149, 551, 552, 540, 518, 553, 150, 151

See application file for complete search history.

FIG. 3 is a left view of the agricultural tillage pivoting gauge wheel;

FIG. 4 is a front view of the agricultural tillage pivoting gauge wheel;

(56) **References Cited**

U.S. PATENT DOCUMENTS

- 2,694,356 A * 11/1954 Haas 172/483
- 3,175,622 A * 3/1965 Stam 172/159
- 4,579,071 A * 4/1986 Johnson 111/195
- 4,723,495 A * 2/1988 Dietrich et al. 111/123
- 4,831,945 A * 5/1989 Neumeyer 111/73
- 5,080,178 A * 1/1992 Dietrich, Sr. 172/153
- 5,333,694 A * 8/1994 Roggenbuck et al. 172/156
- 5,431,232 A * 7/1995 Kirsch 172/438
- 5,562,055 A * 10/1996 Petersen 111/195
- 5,623,997 A * 4/1997 Rawson et al. 172/156
- 5,782,307 A * 7/1998 Forsyth 172/156

FIG. 5 is a rear view of agricultural tillage pivoting gauge wheel;

FIG. 6 is a top view of agricultural tillage pivoting gauge wheel; and,

FIG. 7 is a bottom view of agricultural tillage pivoting gauge wheel.

The broken line showing of environmental features is included for the purpose of illustrating non-claimed subject matter and forms no part of the claimed design.

1 Claim, 4 Drawing Sheets

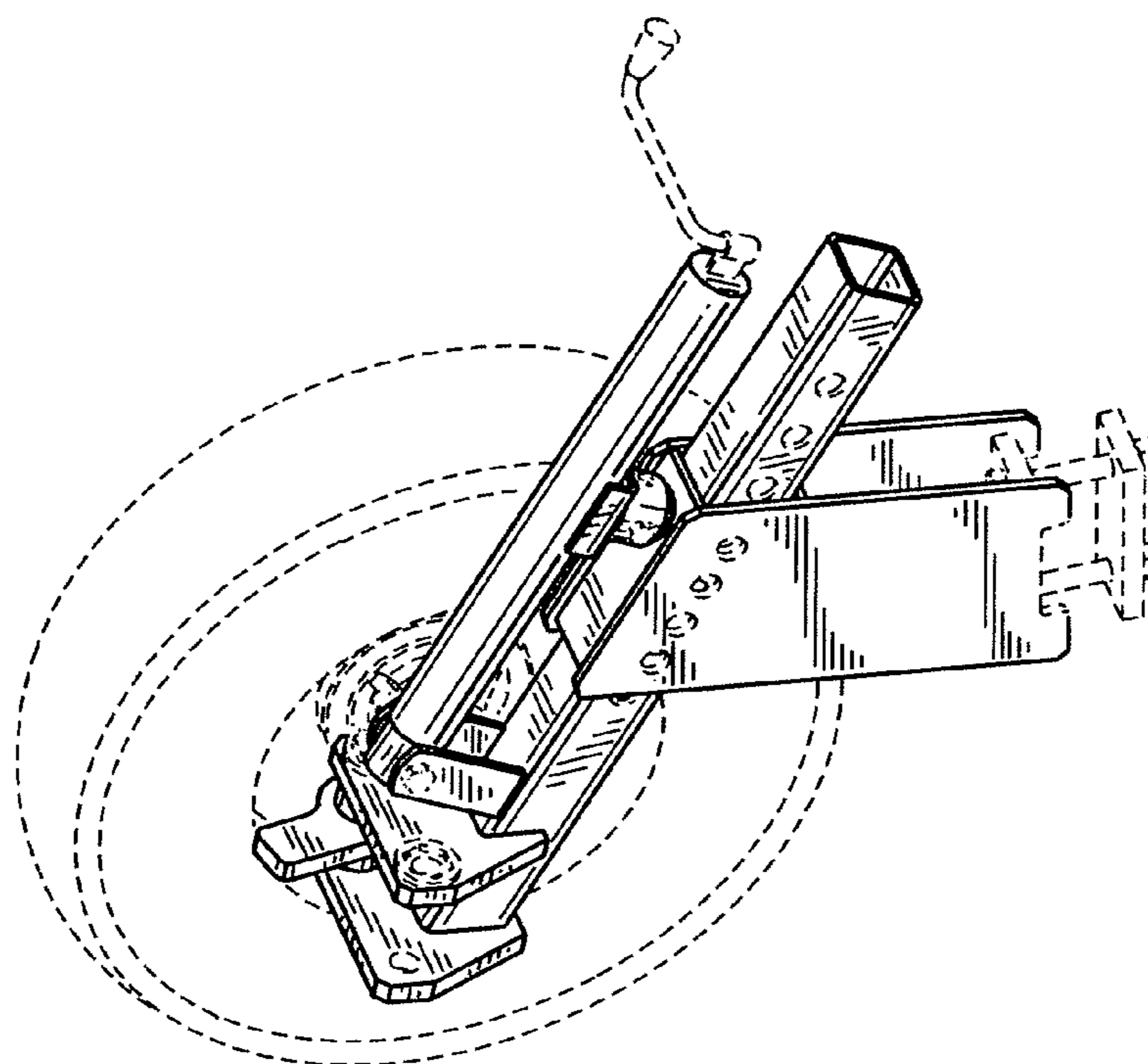

FIG. 1

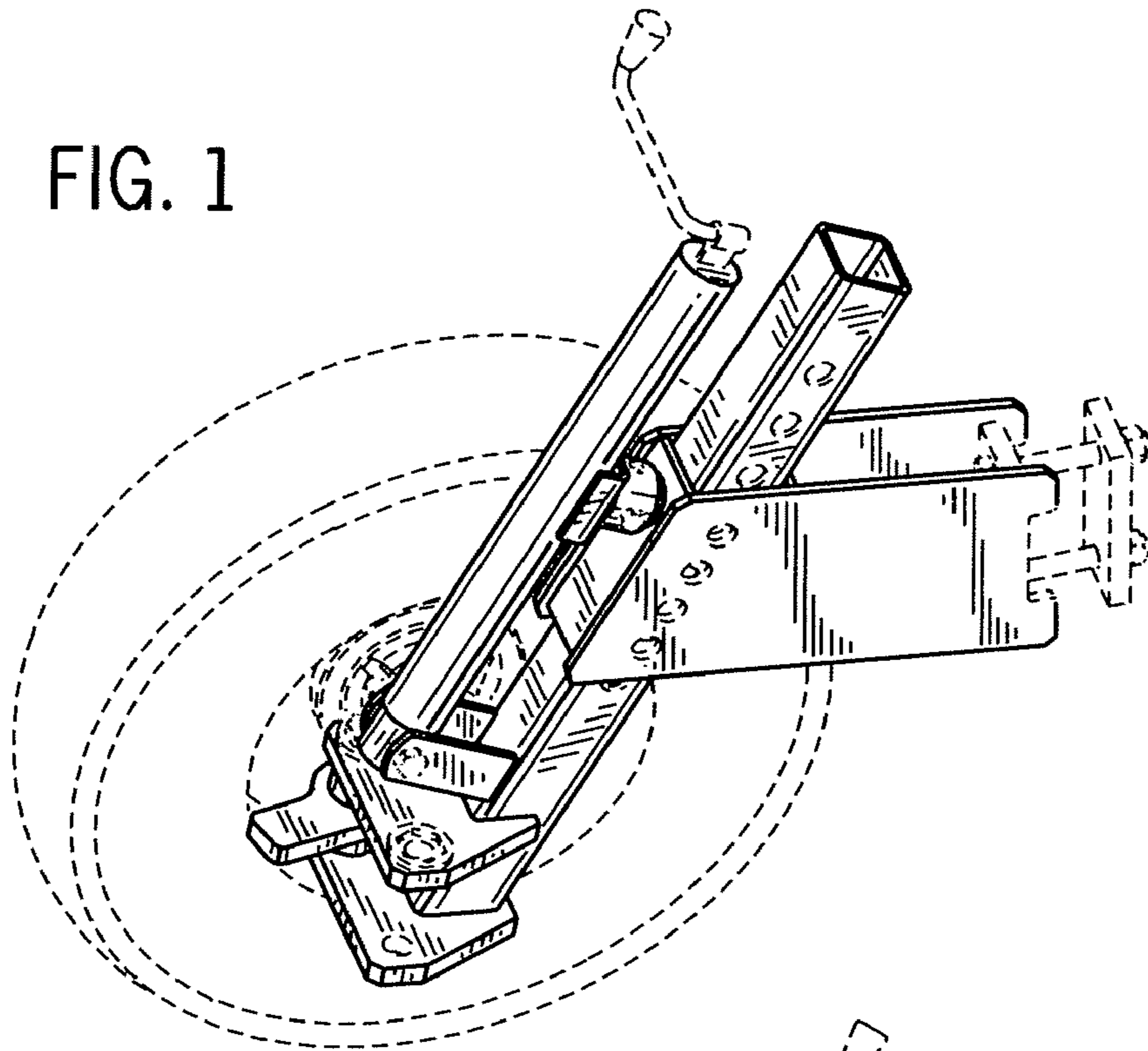

FIG. 2

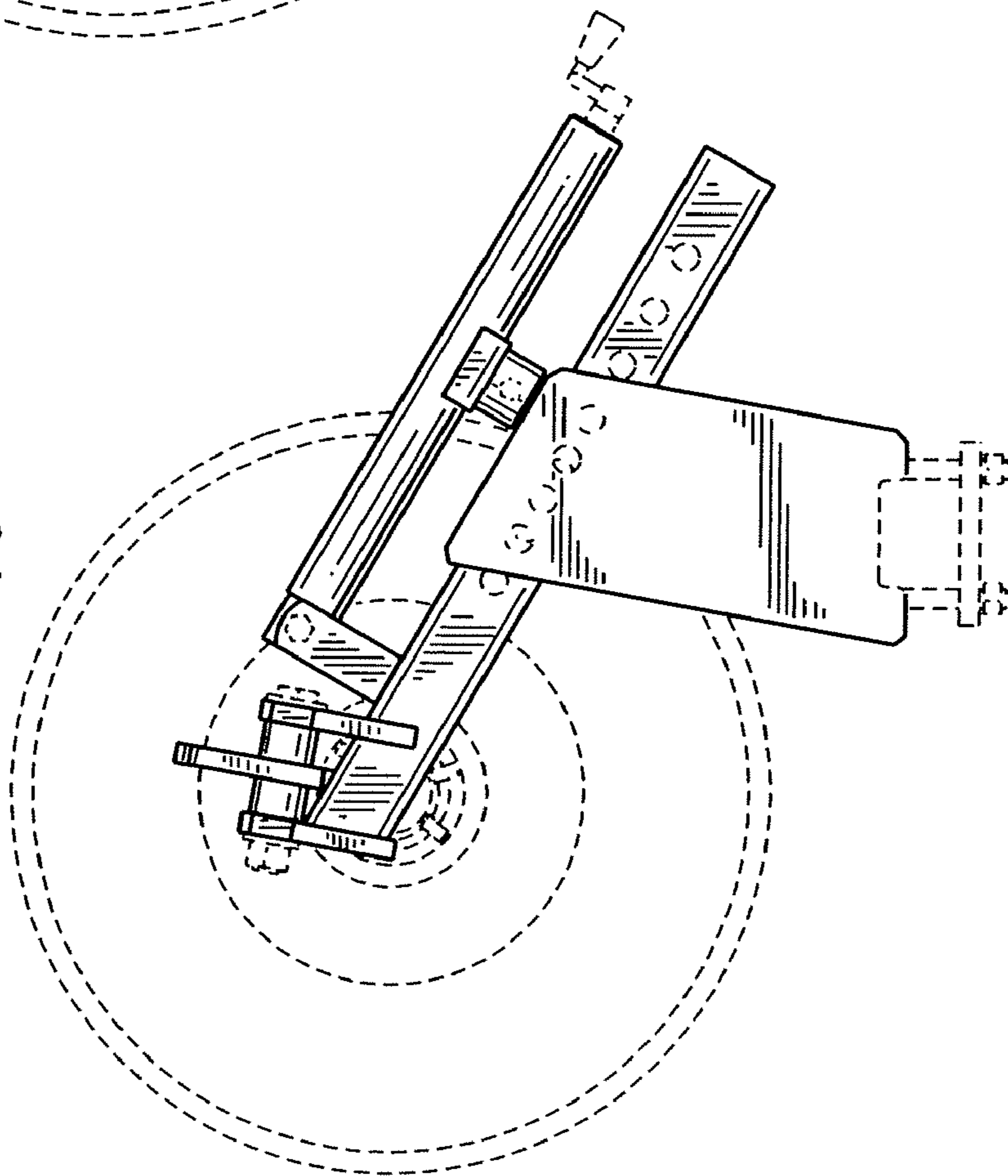
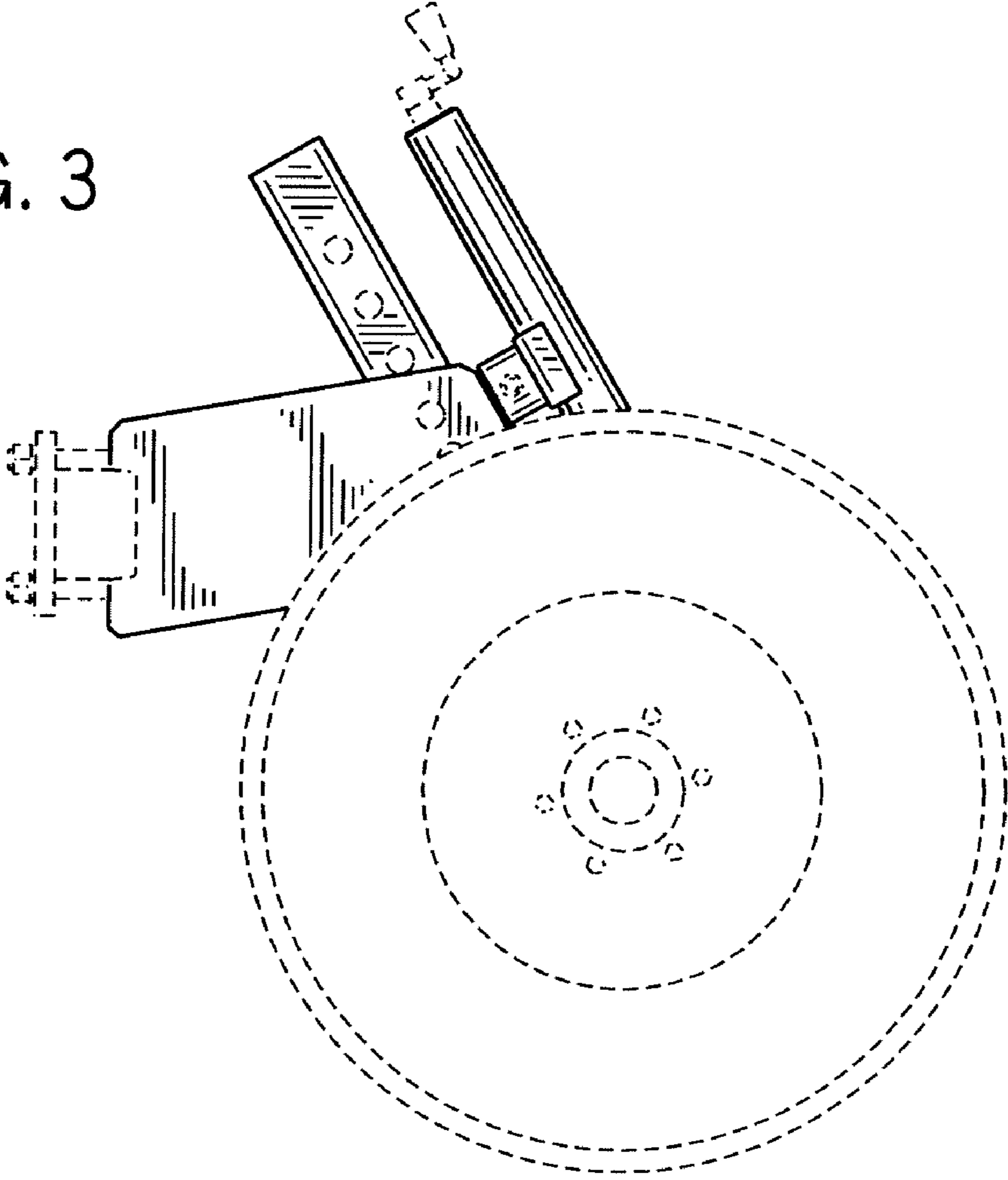

FIG. 3



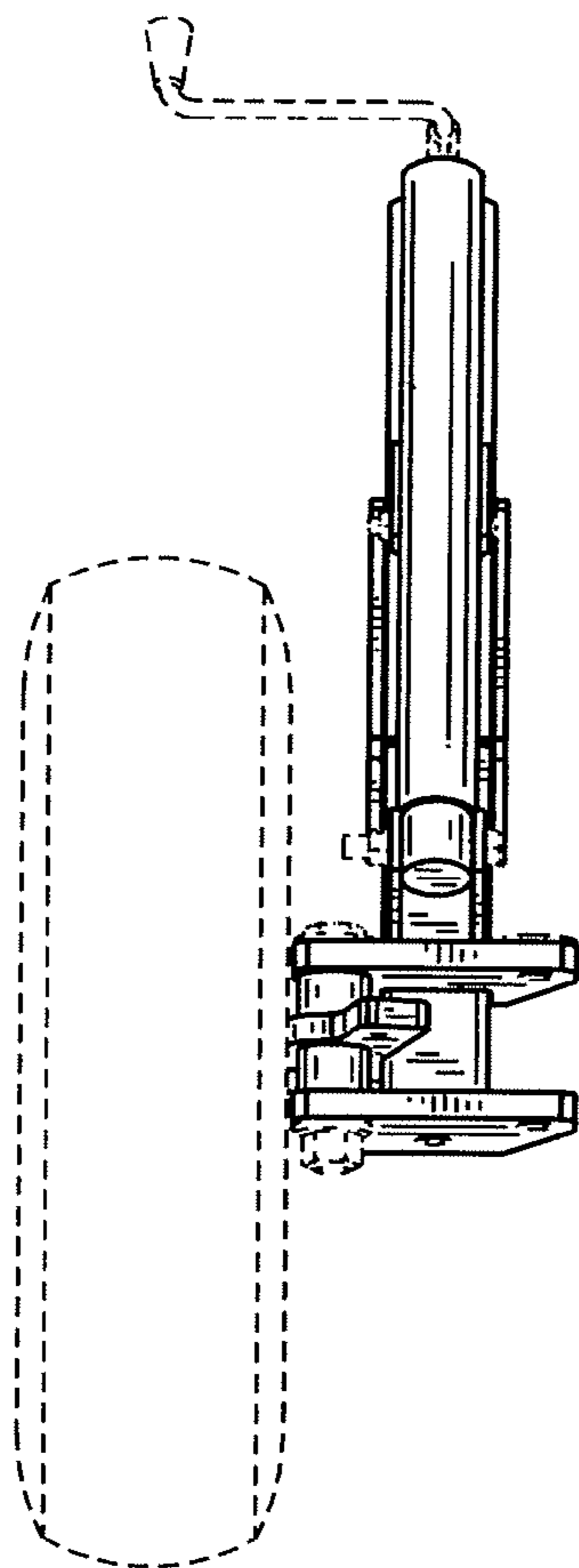

FIG. 4

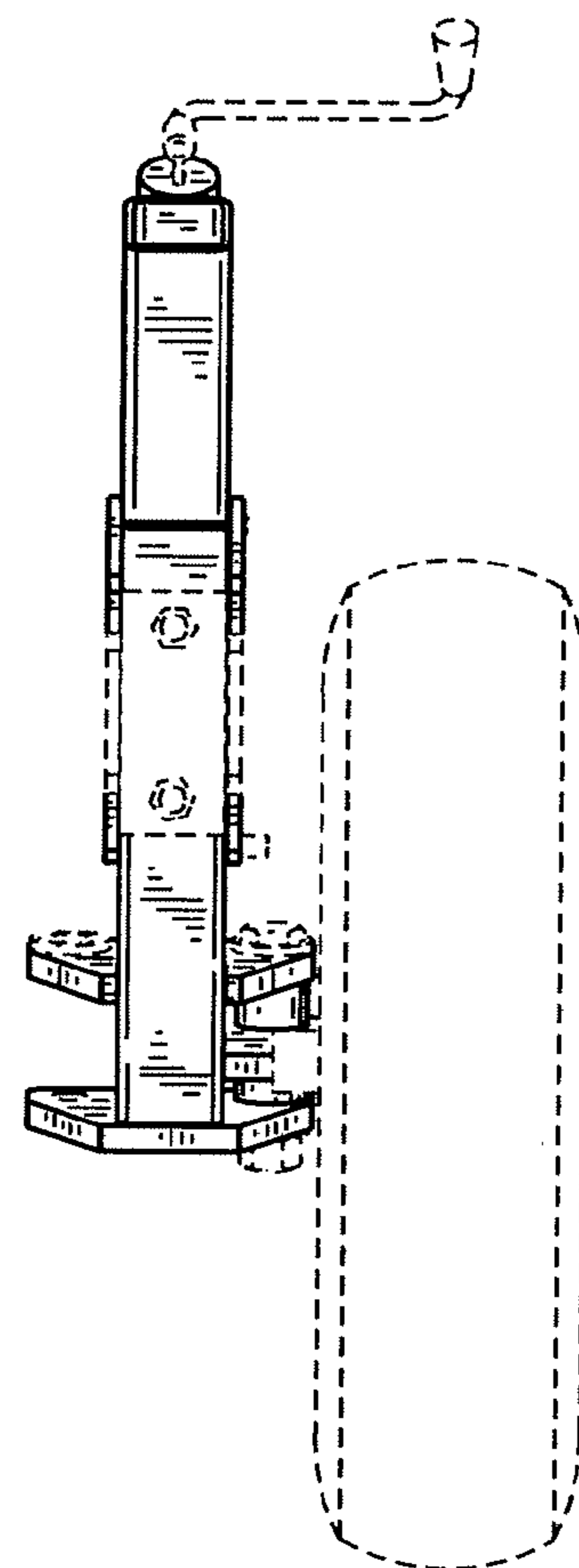

FIG. 5

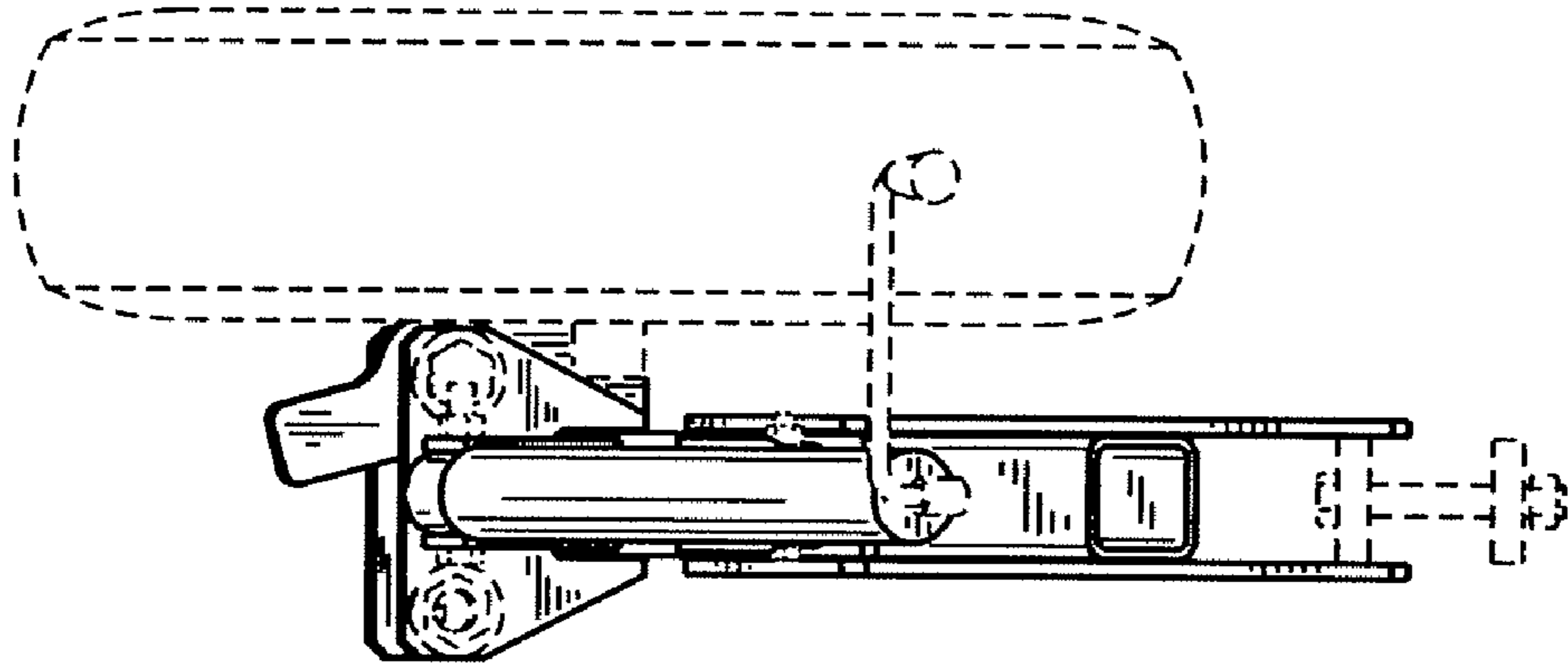

FIG. 6

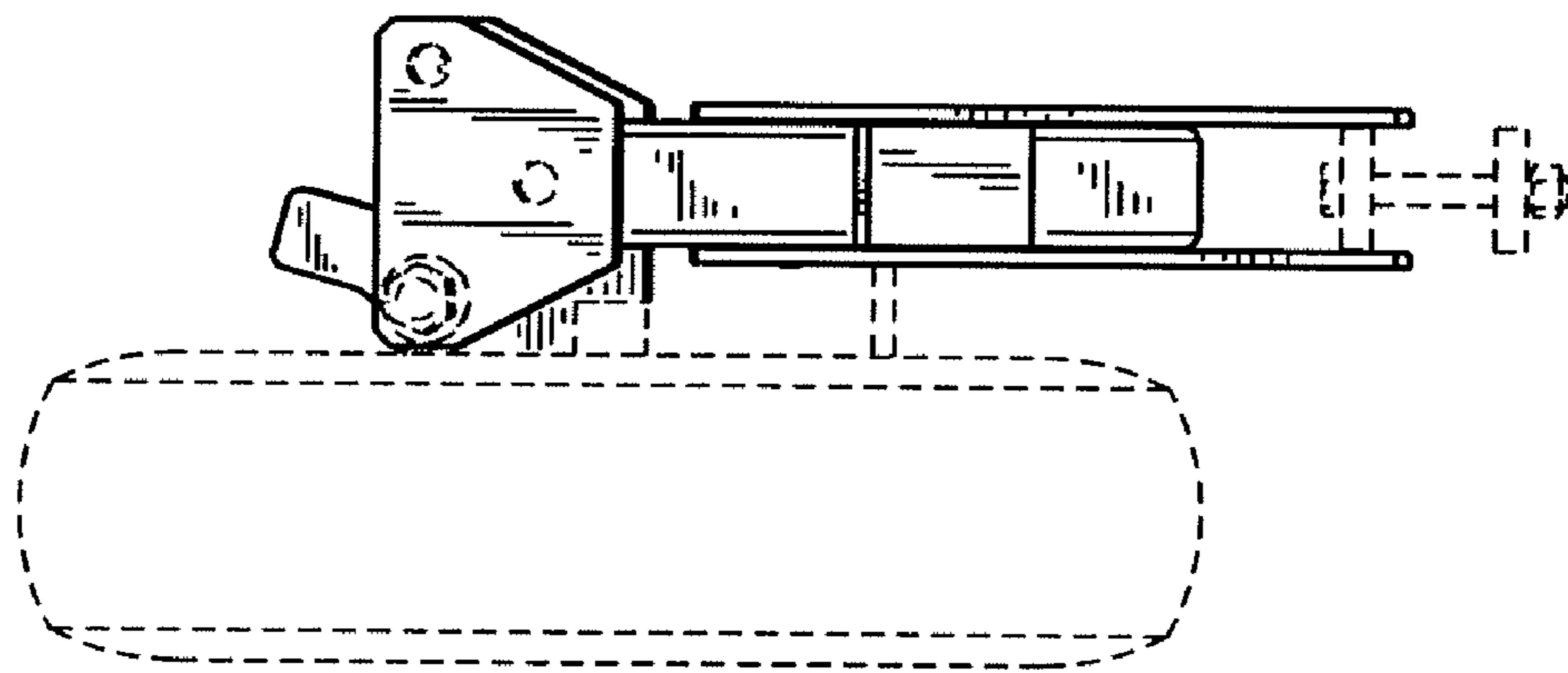

FIG. 7