



US00D583831S

(12) **United States Design Patent**  
**Post et al.**

(10) **Patent No.:** **US D583,831 S**  
(45) **Date of Patent:** **\*\* Dec. 30, 2008**

(54) **ENGINE**

(75) Inventors: **Ronald V. Post**, Manitowoc, WI (US);  
**David O. Meyers**, Kaysville, UT (US);  
**Christopher T. Boyer**, Oak Park, IL  
(US)

(73) Assignee: **Kohler Co.**, Kohler, WI (US)

(\*\*) Term: **14 Years**

(21) Appl. No.: **29/284,457**

(22) Filed: **Sep. 7, 2007**

(51) **LOC (8) Cl.** ..... **15-01**

(52) **U.S. Cl.** ..... **D15/5**

(58) **Field of Classification Search** ..... D15/1,  
D15/3, 5, 15, 17, 31; 123/50 A, 306, 308  
See application file for complete search history.

(56) **References Cited**

**U.S. PATENT DOCUMENTS**

D330,897 S	11/1992	Carlson et al.	
D352,042 S	11/1994	Davies, III	
D352,043 S	11/1994	Davies, III	
D396,045 S	7/1998	Neeley	
D396,476 S *	7/1998	Shimizu	..... D15/1
D397,342 S	8/1998	Shimizu	
D466,905 S	12/2002	Neeley et al.	
D468,751 S	1/2003	Neeley et al.	
D471,560 S	3/2003	Davis	

D484,889 S	1/2004	Neeley et al.	
D487,751 S	3/2004	Neeley et al.	
D491,192 S	6/2004	Davis	
D491,193 S	6/2004	Davis	
D513,012 S	12/2005	Strandell et al.	
D513,754 S	1/2006	Strandell et al.	
D525,991 S	8/2006	Walters	
D527,022 S	8/2006	Walters	
D527,741 S *	9/2006	Vervoorn	..... D15/5
D538,823 S	3/2007	Vervoors	
D548,750 S *	8/2007	Neeley et al.	..... D15/5
D553,645 S *	10/2007	Drew et al.	..... D15/5

\* cited by examiner

*Primary Examiner*—Lisa P Lichtenstein

(74) *Attorney, Agent, or Firm*—Whyte Hirschboeck Dudek  
SC

(57) **CLAIM**

The ornamental design for an engine, as shown and described.

**DESCRIPTION**

FIG. 1 is a front view thereof;  
FIG. 2 is a side view thereof;  
FIG. 3 is a side view thereof;  
FIG. 4 is a front view thereof;  
FIG. 5 is a rear view thereof; and,  
FIG. 6 is a top view thereof.

**1 Claim, 6 Drawing Sheets**

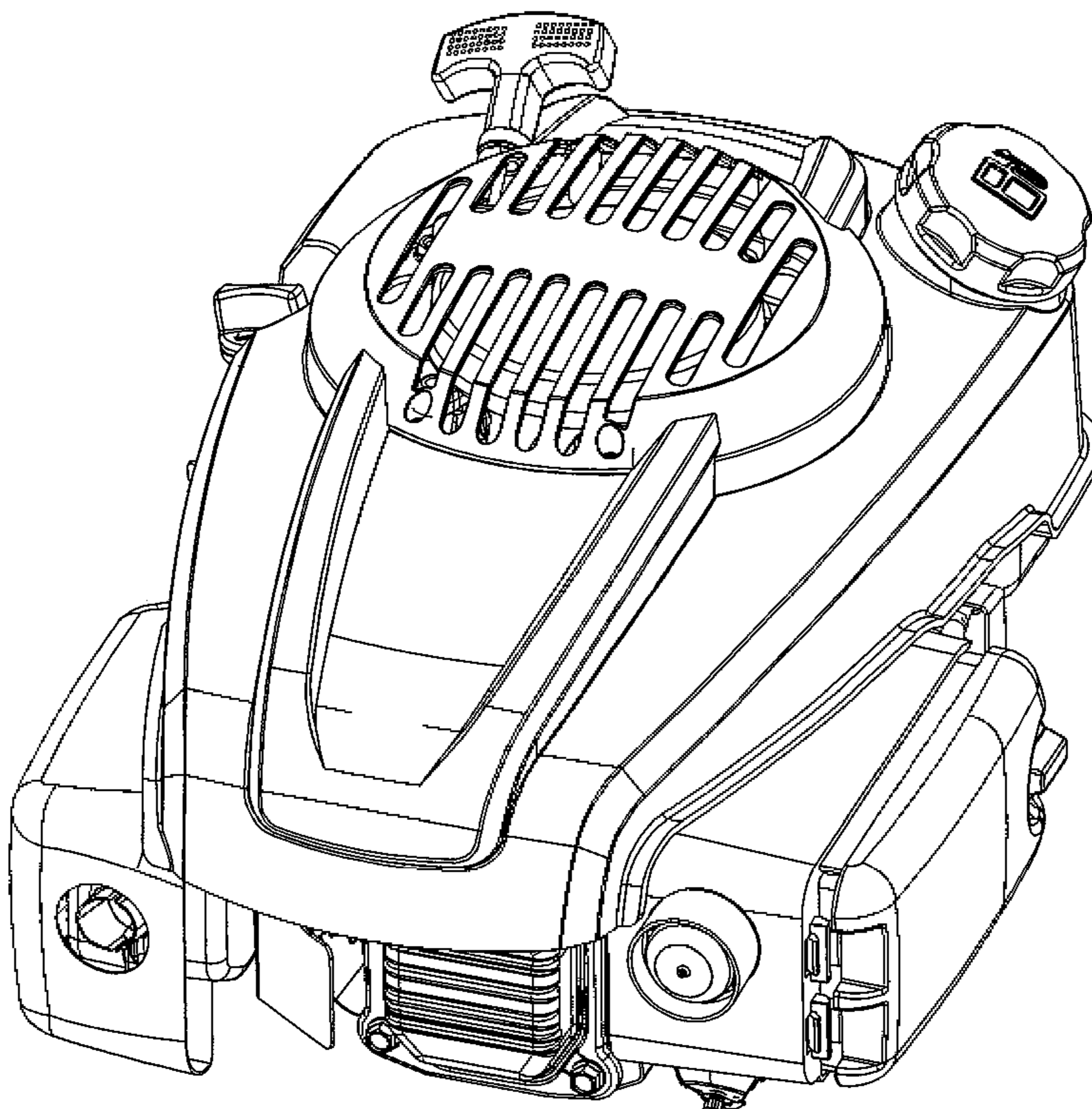

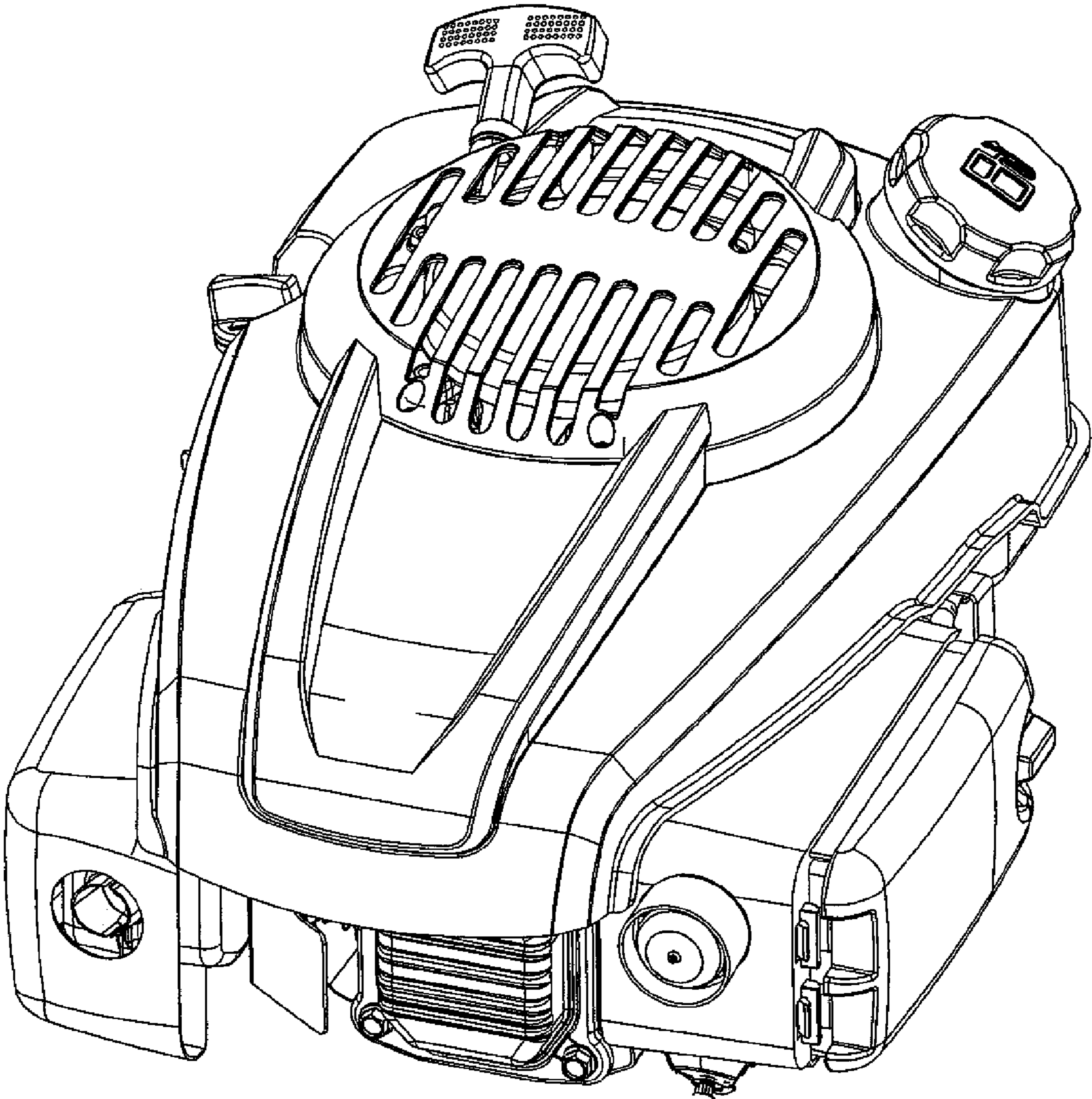

FIG. 1

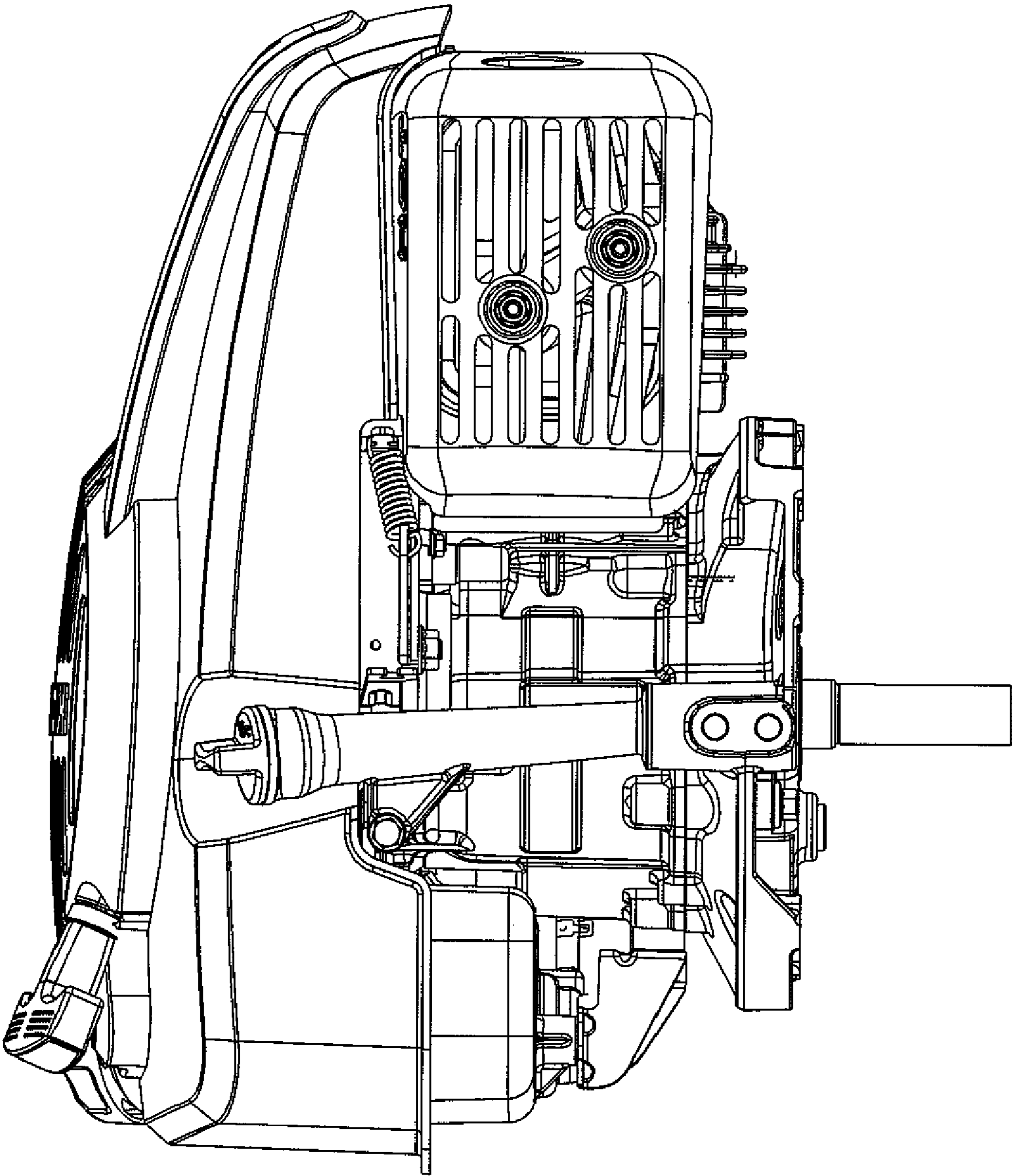

FIG. 2

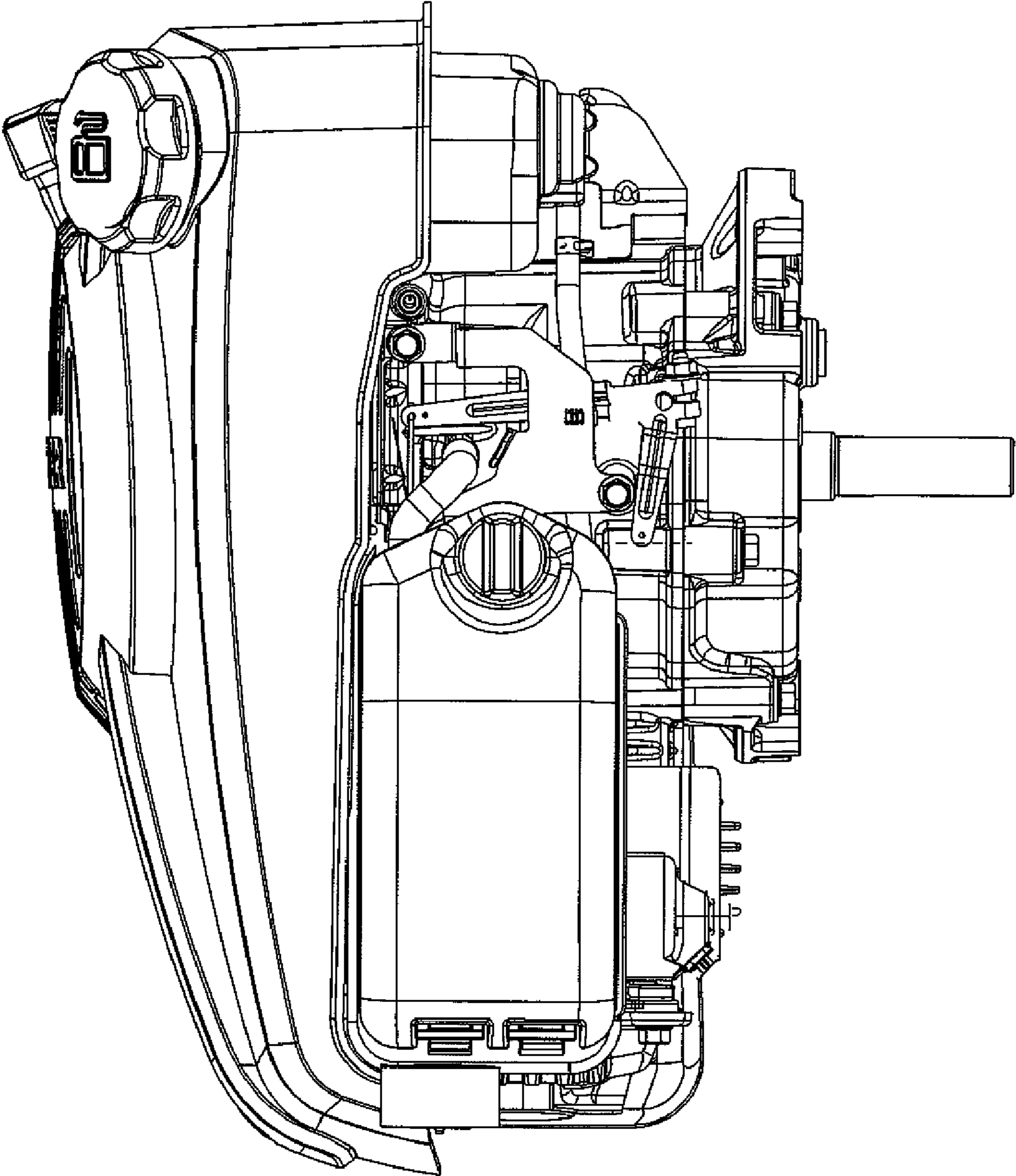

FIG. 3

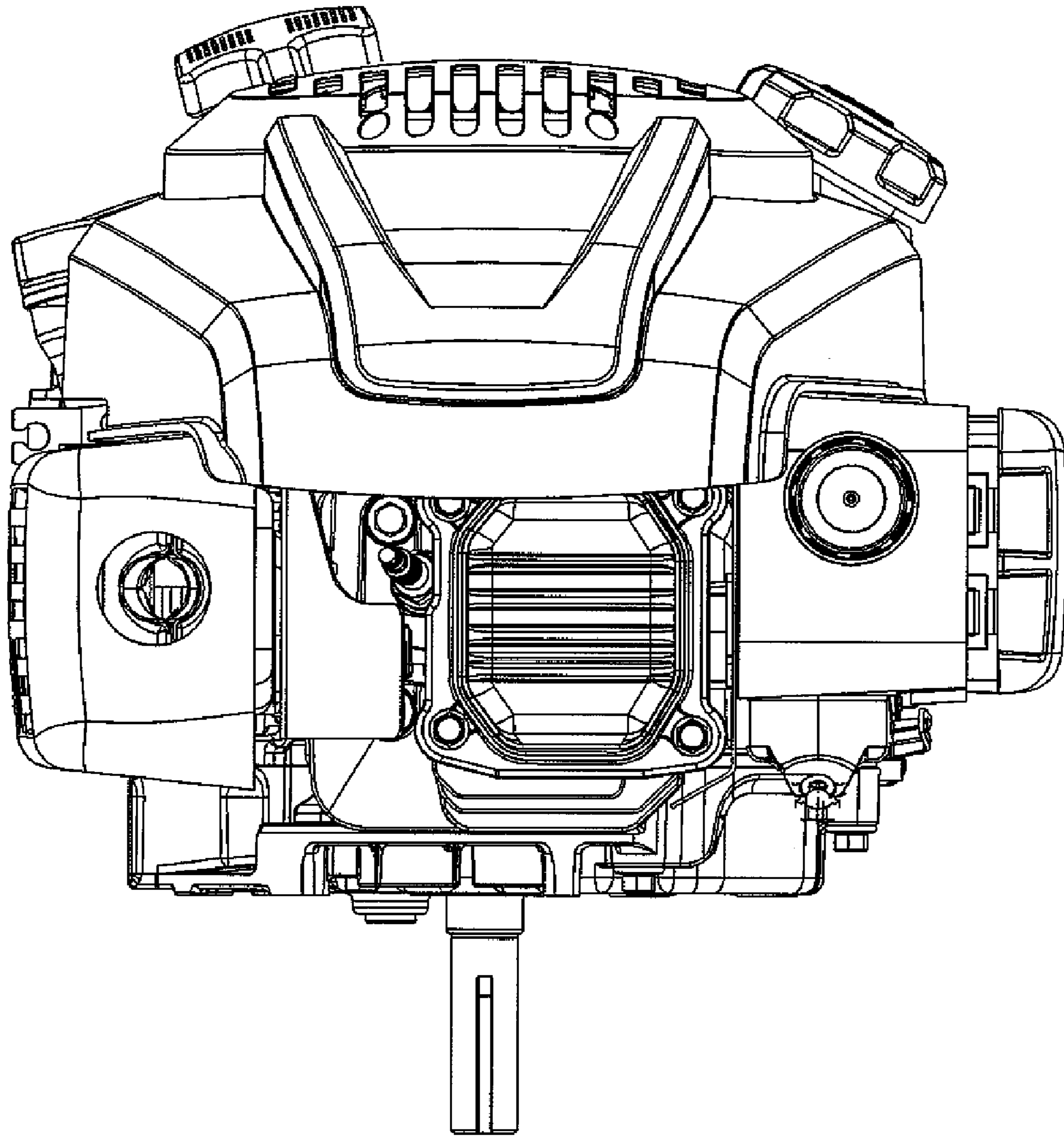

FIG. 4

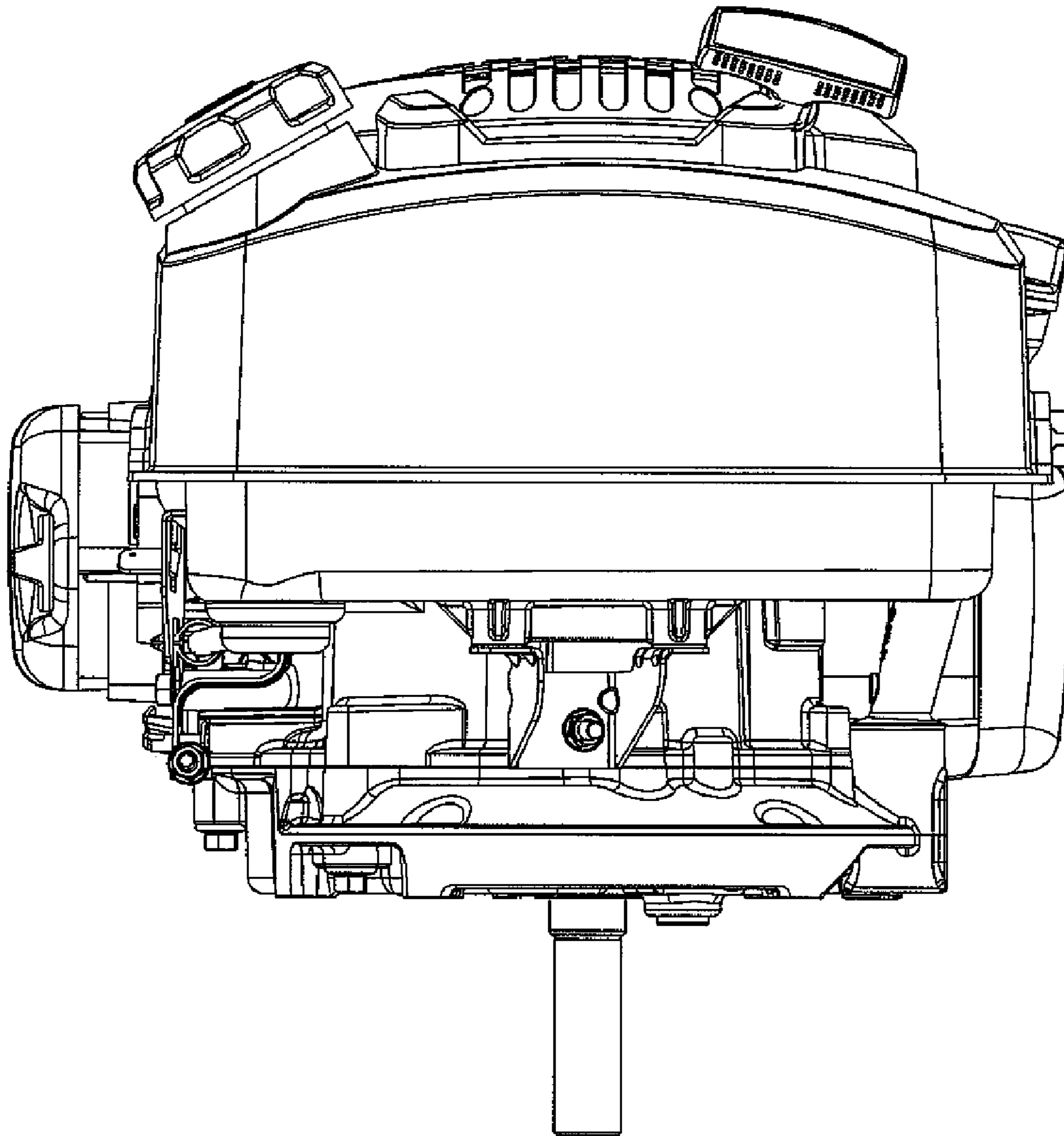

FIG. 5

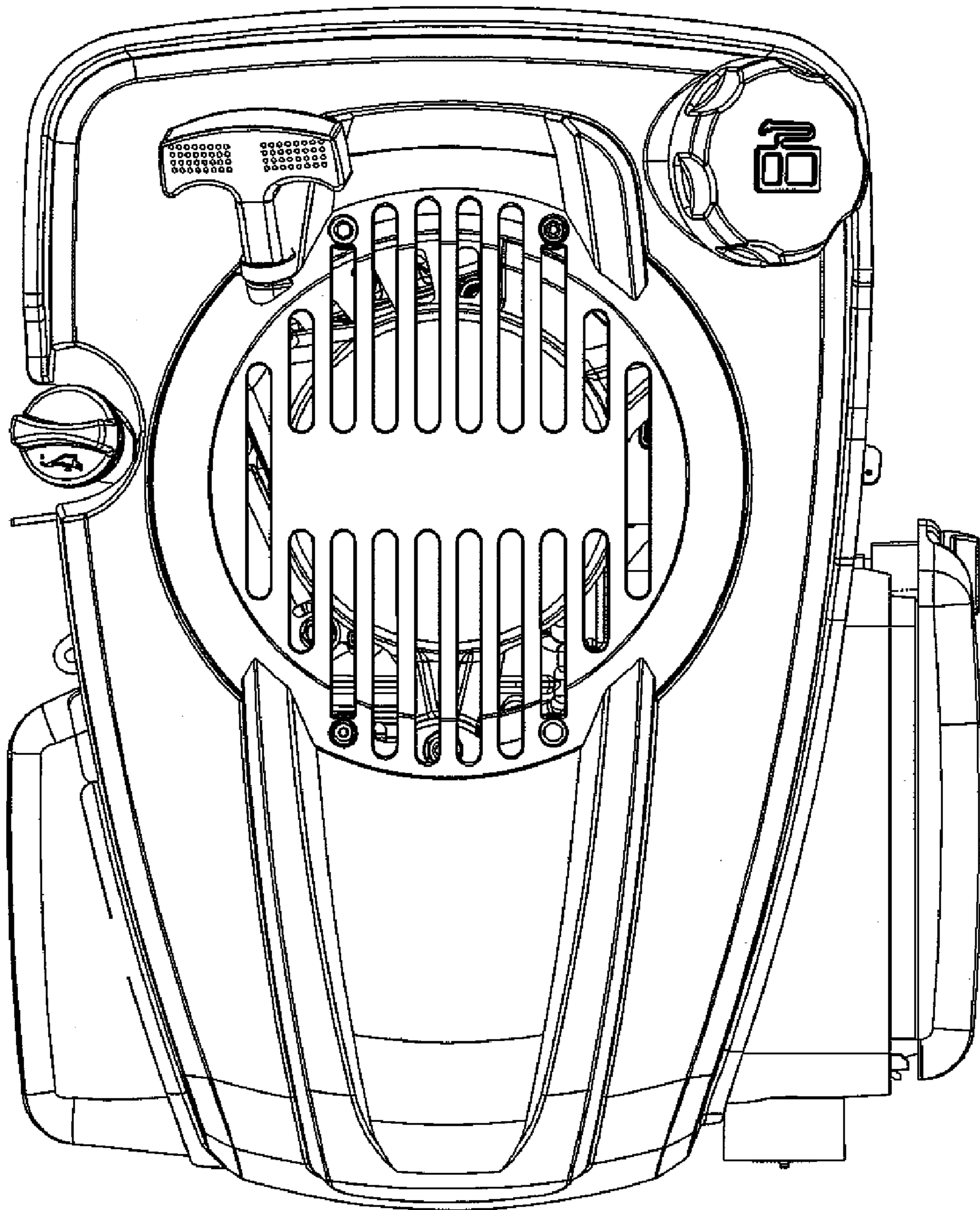

FIG. 6