



US00D583397S

(12) **United States Design Patent**  
**Sanders et al.**

(10) **Patent No.:** **US D583,397 S**  
(45) **Date of Patent:** **\*\* Dec. 23, 2008**

(54) **ACTUATOR COMPONENT**

(75) Inventors: **Peter George Sanders**, Bath (GB);  
**Stuart Masefield Lay**, Chippenham  
(GB)

(73) Assignee: **Rotork Controls Limited** (GB)

(\*\*) Term: **14 Years**

(21) Appl. No.: **29/302,668**

(22) Filed: **Jan. 22, 2008**

(30) **Foreign Application Priority Data**

Jul. 27, 2007	(EM)	000764766-0001
Jul. 27, 2007	(EM)	000764766-0002
Jul. 27, 2007	(EM)	000764766-0003
Jul. 27, 2007	(EM)	000764766-0004
Jul. 27, 2007	(EM)	000764766-0005

(51) **LOC (8) Cl.** ..... **15-09**

(52) **U.S. Cl.** ..... **D15/143**

(58) **Field of Classification Search** ..... D13/101,  
D13/110, 116, 167, 174, 199; D15/5, 143,  
D15/148, 149, 199; 74/89.15, 481, 490.09,  
74/490.14, 606 R; 310/20, 80; 319/80; 345/156;  
414/560-569

See application file for complete search history.

(56) **References Cited**

**U.S. PATENT DOCUMENTS**

D303,265 S *	9/1989	Miyoshi et al.	.....	D15/199
D365,353 S *	12/1995	Brewer	.....	D15/199

D511,369 S *	11/2005	Croft	.....	D23/233
D521,599 S *	5/2006	Bates et al.	.....	D23/233
D546,252 S *	7/2007	Belisle	.....	D12/180
D552,643 S *	10/2007	Bonomi	.....	D15/199
D578,064 S *	10/2008	Nimberger	.....	D13/114
2003/0184171 A1 *	10/2003	Teraoka et al.	.....	310/80
2008/0084130 A1 *	4/2008	Darby et al.	.....	310/83

\* cited by examiner

*Primary Examiner*—Sandra Snapp

*Assistant Examiner*—Patricia Palasik

(74) *Attorney, Agent, or Firm*—King & Schickli, PLLC

(57) **CLAIM**

The ornamental design for an actuator component as shown and described.

**DESCRIPTION**

FIG. 1 is a perspective view of a right side of a first embodiment of the actuator component;

FIG. 2 is a perspective view of a left side thereof;

FIG. 3 is perspective view of a rear side thereof;

FIG. 4 is an elevational side view thereof;

FIG. 5 is a top view thereof;

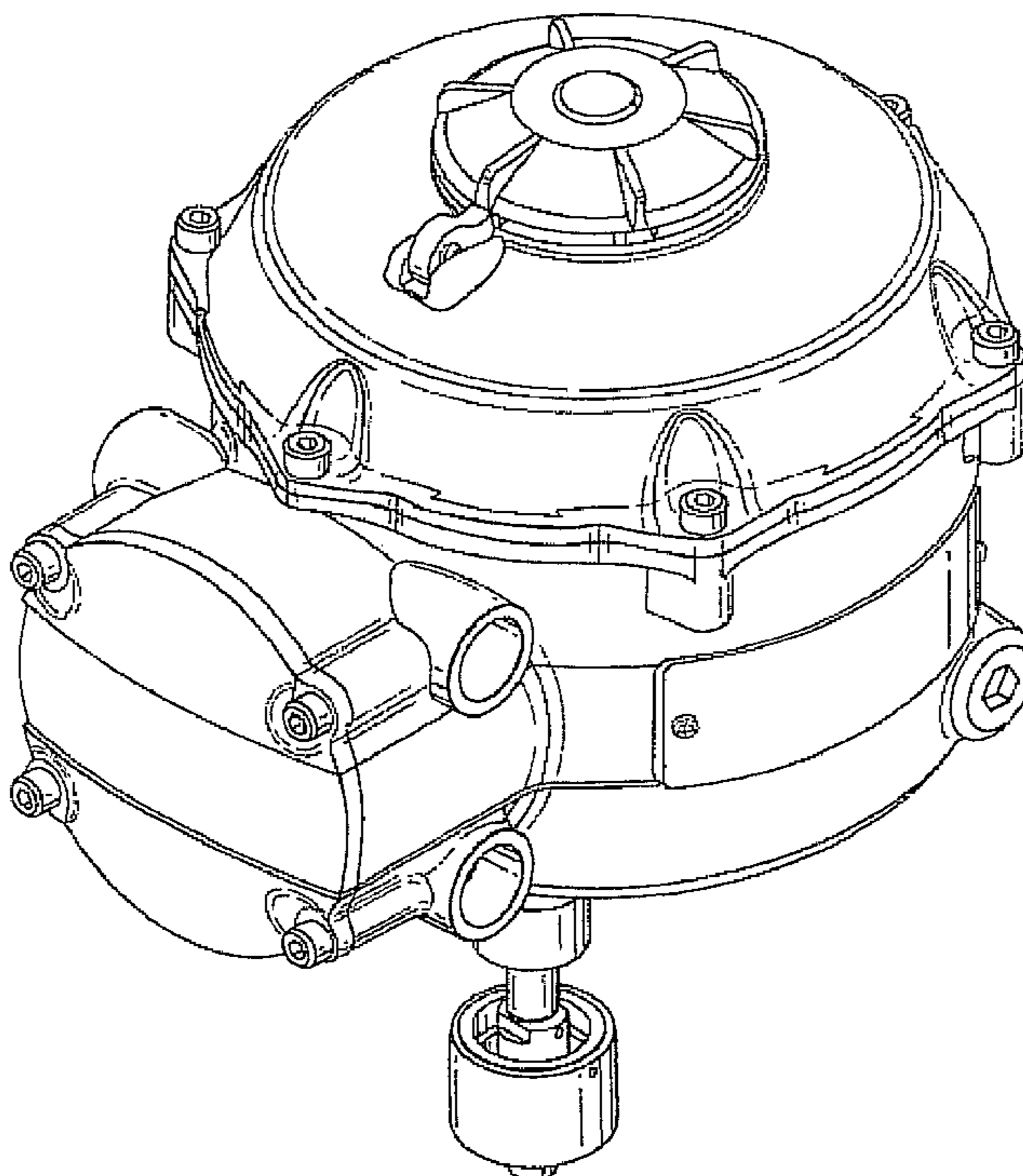
FIG. 6 is a perspective view of a right side of a second embodiment of the actuator component;

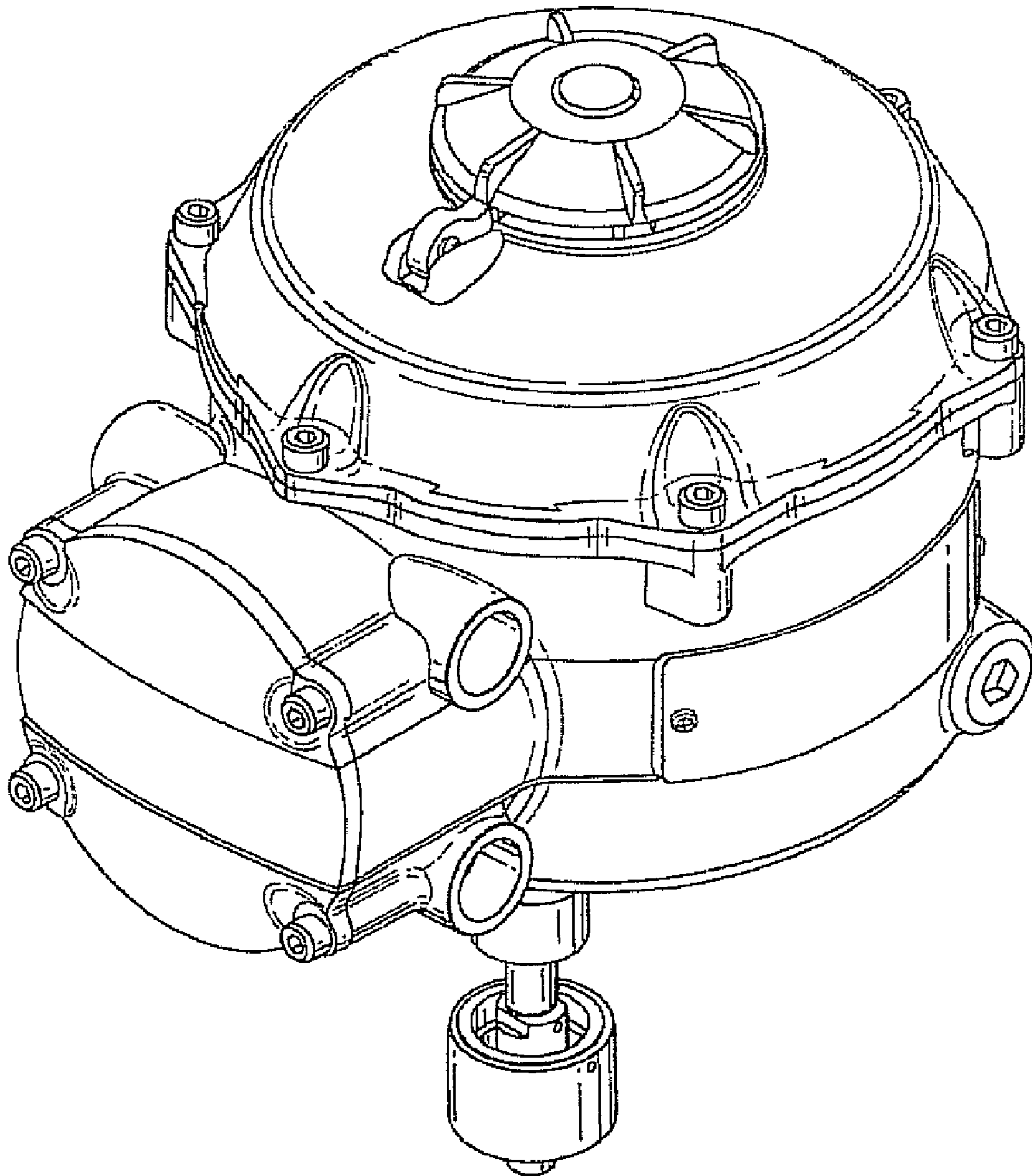
FIG. 7 is a perspective view of a left side thereof;

FIG. 8 is perspective view of a rear side thereof; and,

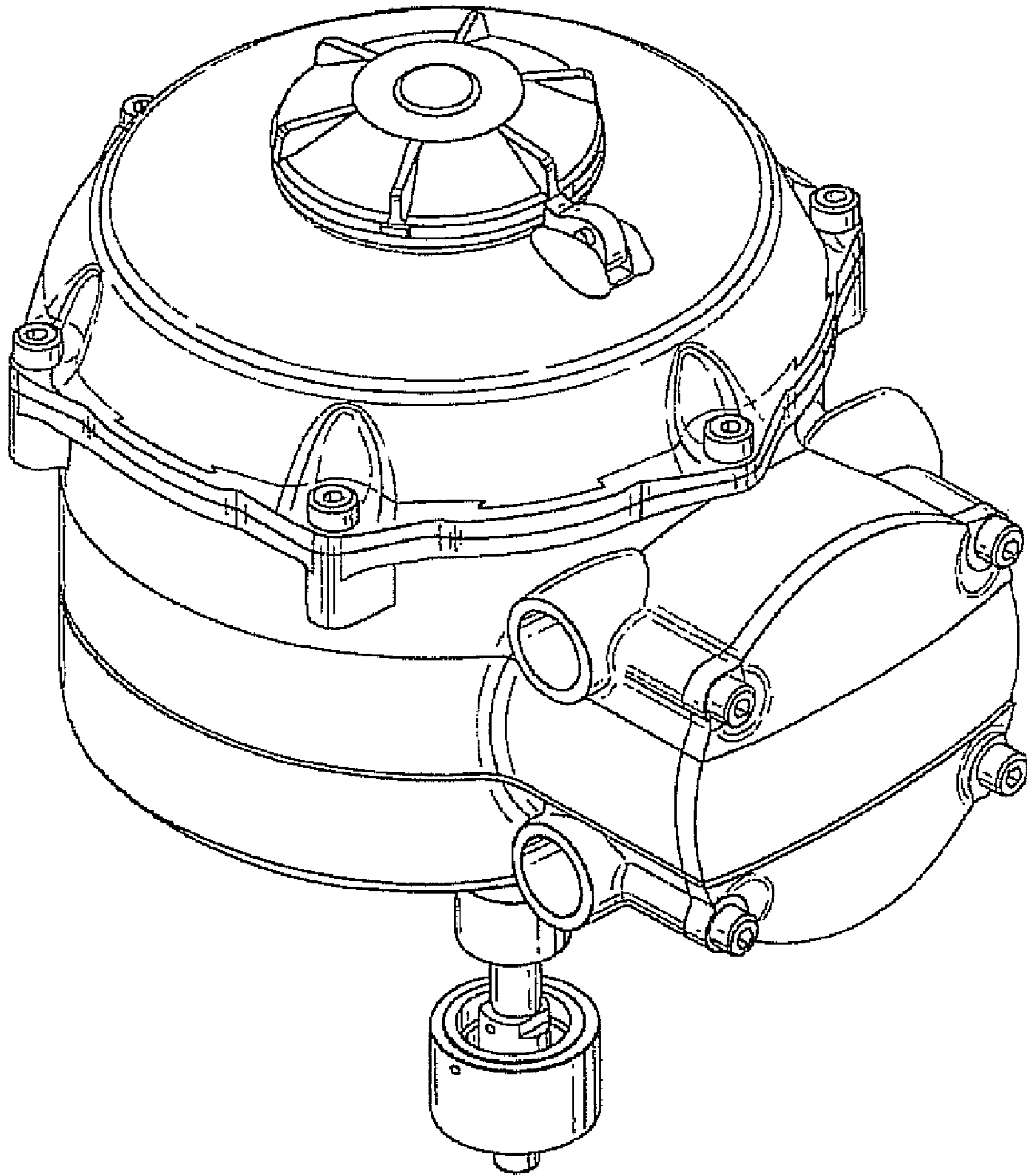
FIG. 9 is an elevational side view thereof.

**1 Claim, 9 Drawing Sheets**

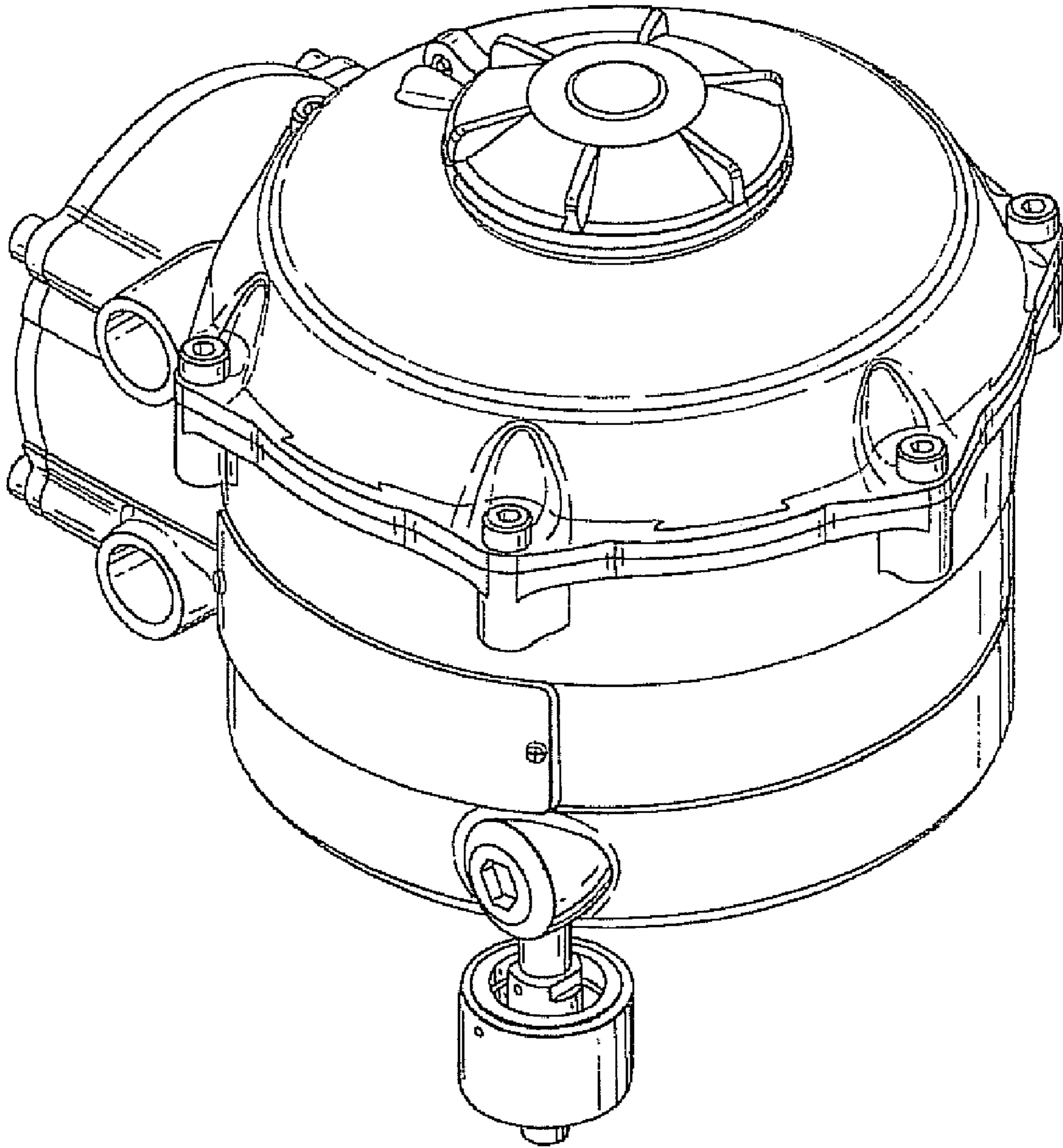




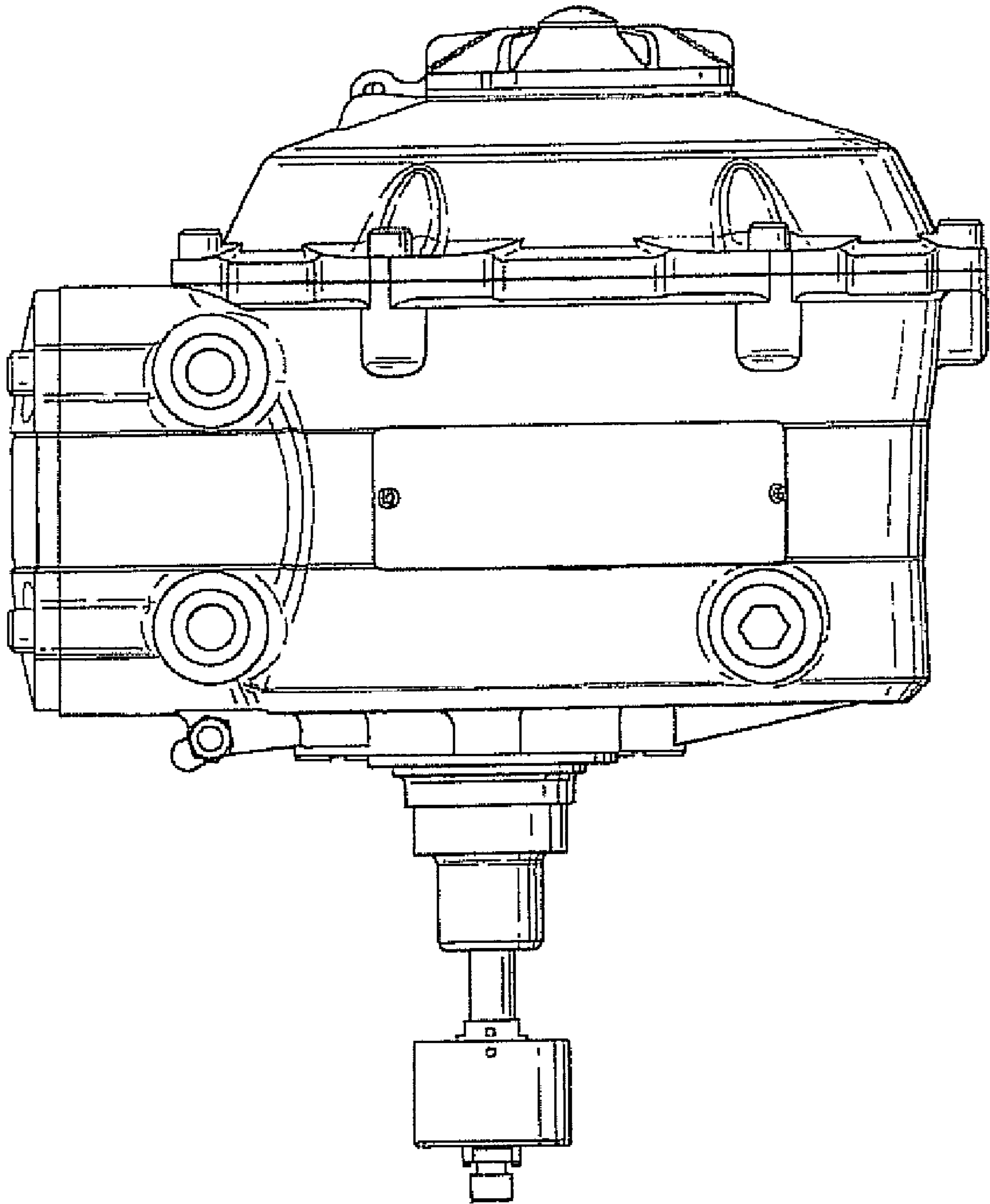
**Fig. 1**



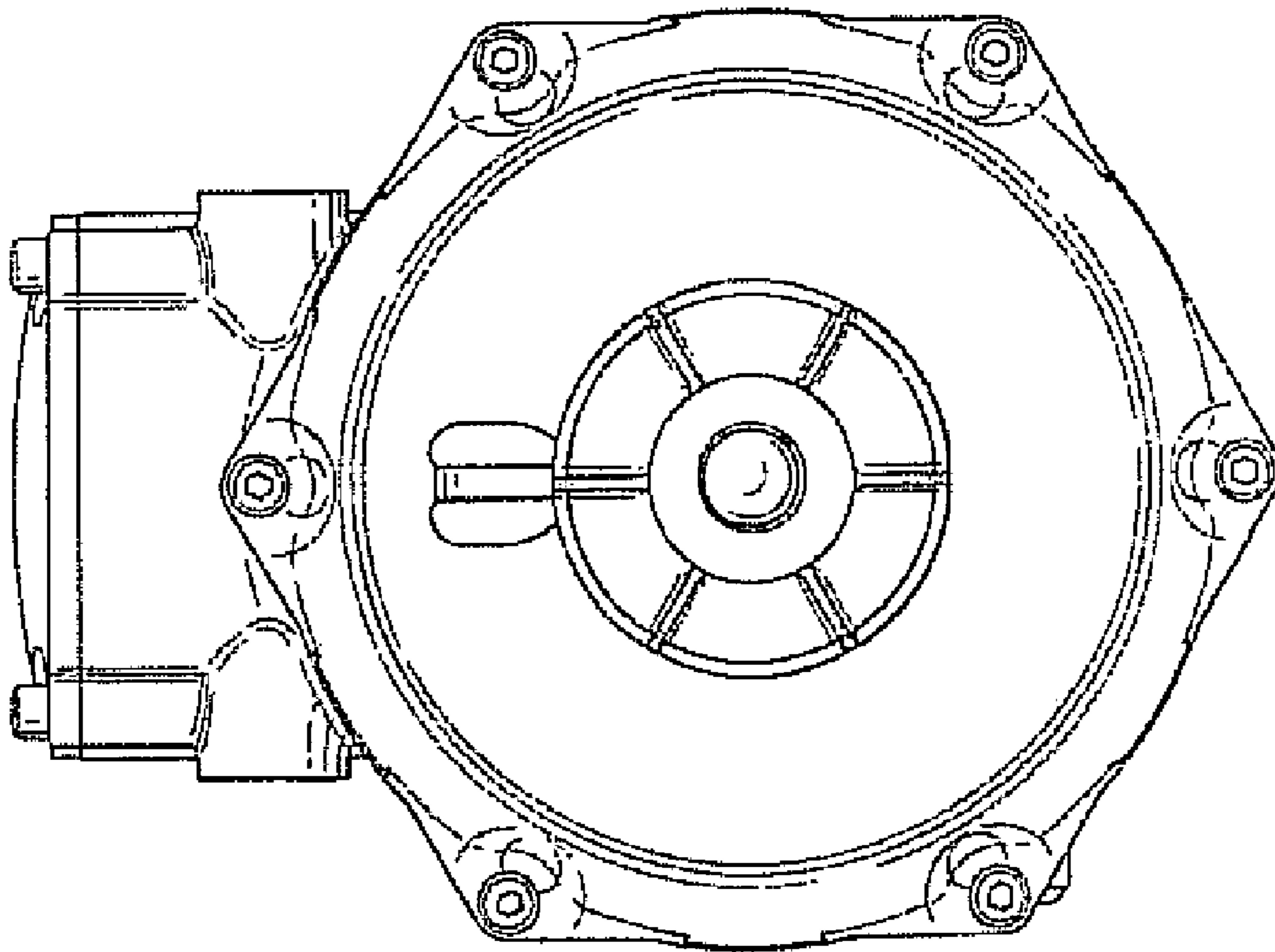
**Fig. 2**



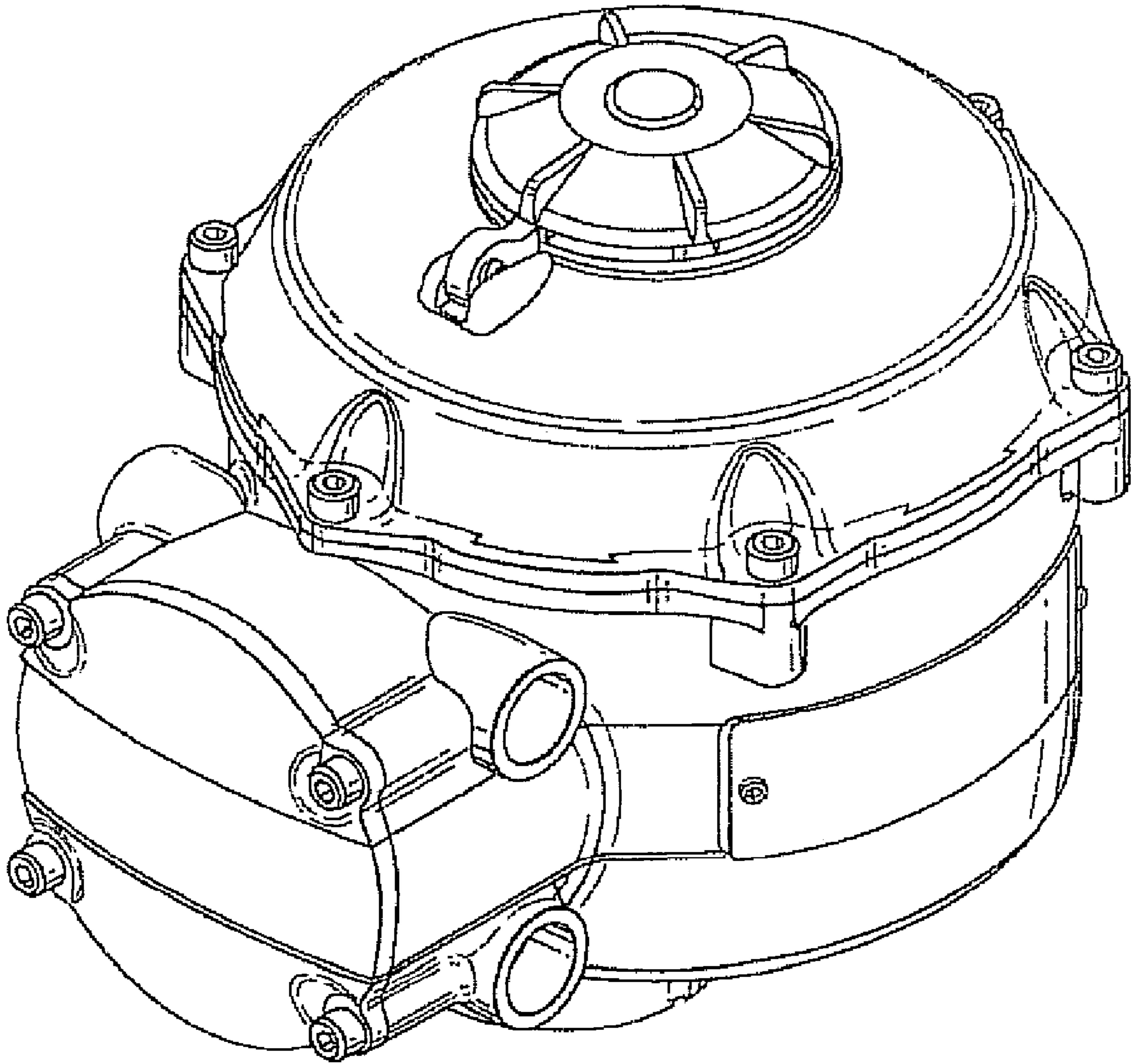
**Fig. 3**



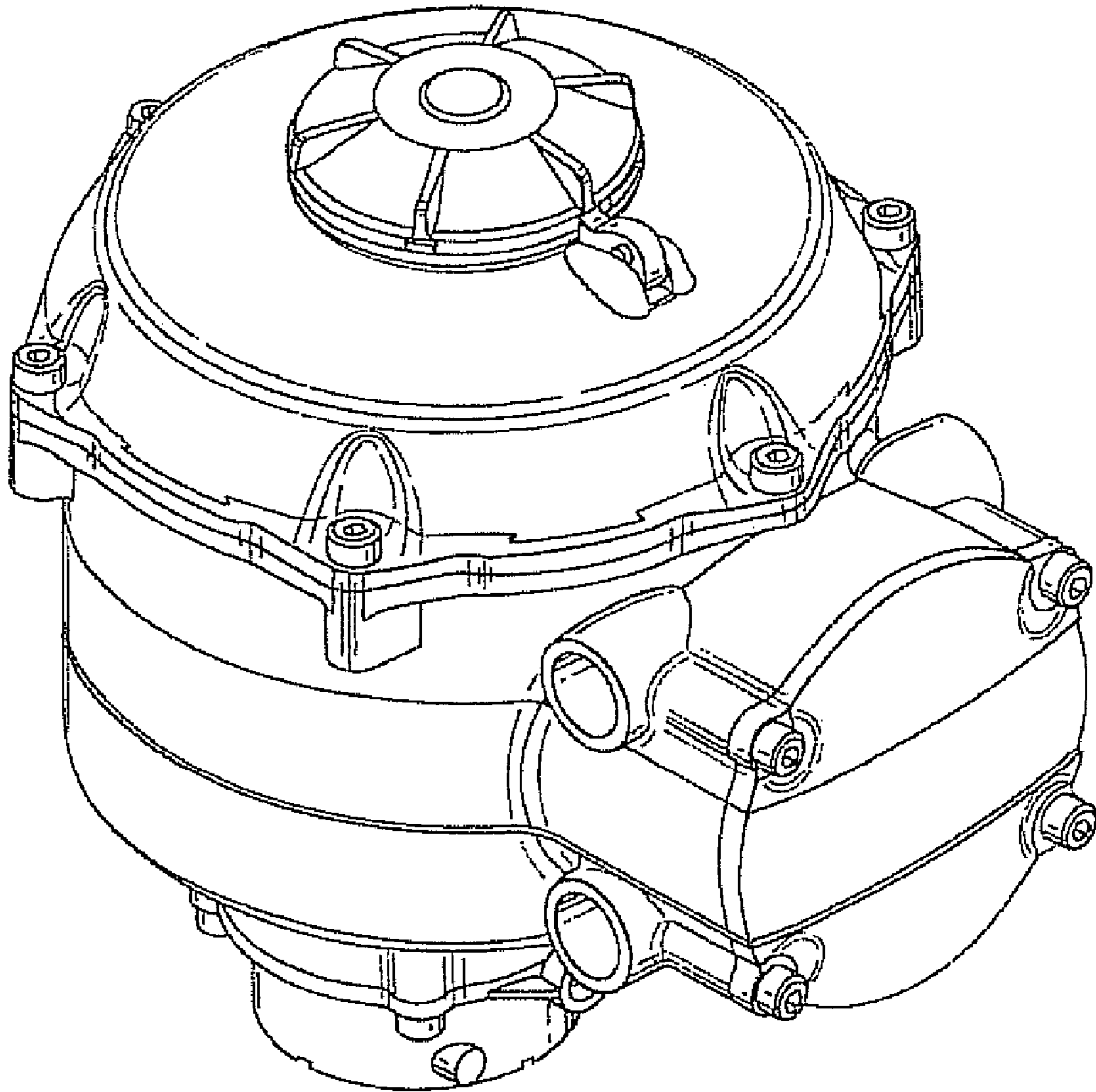
*Fig. 4*



**Fig. 5**

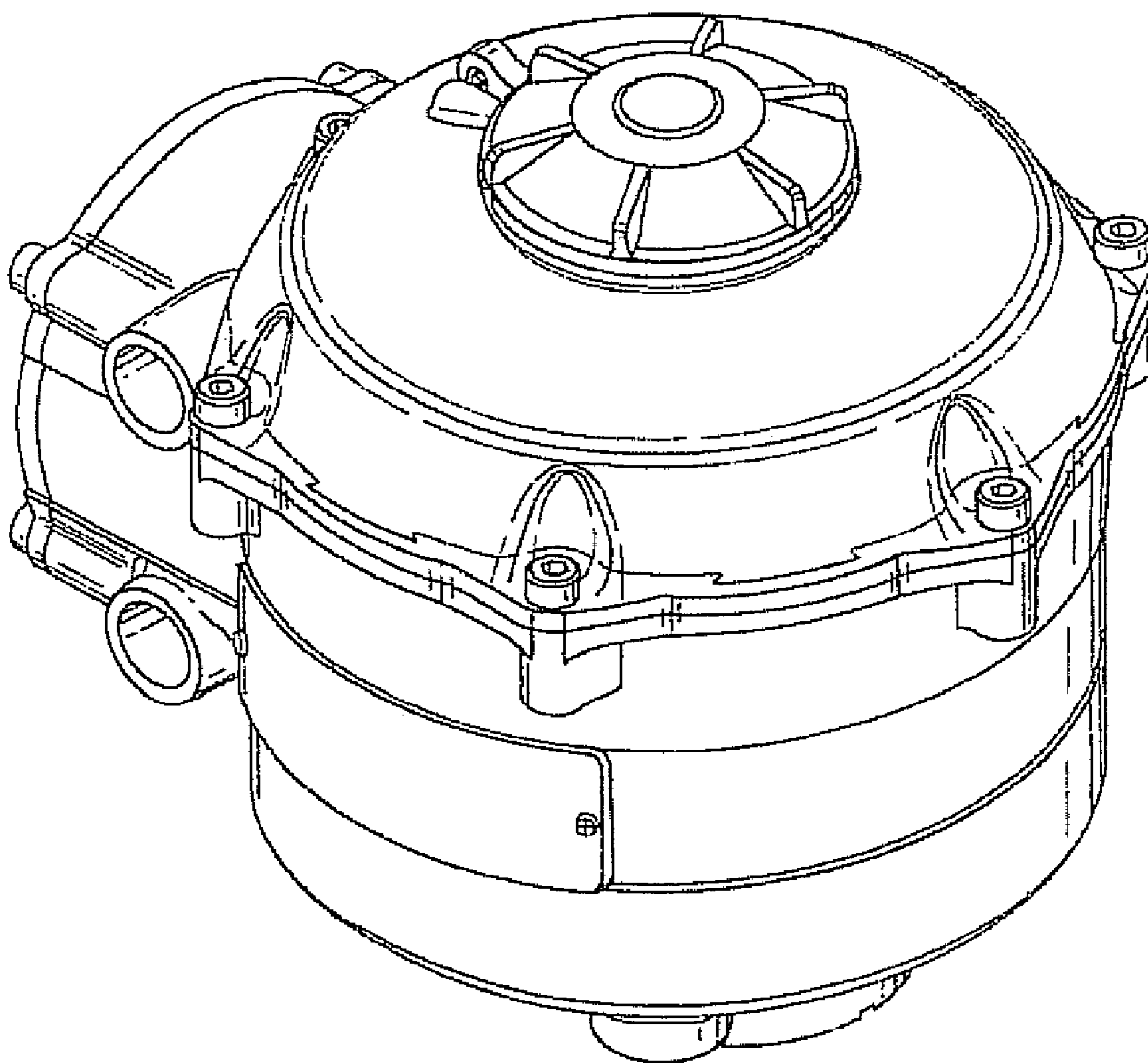


**Fig. 6**

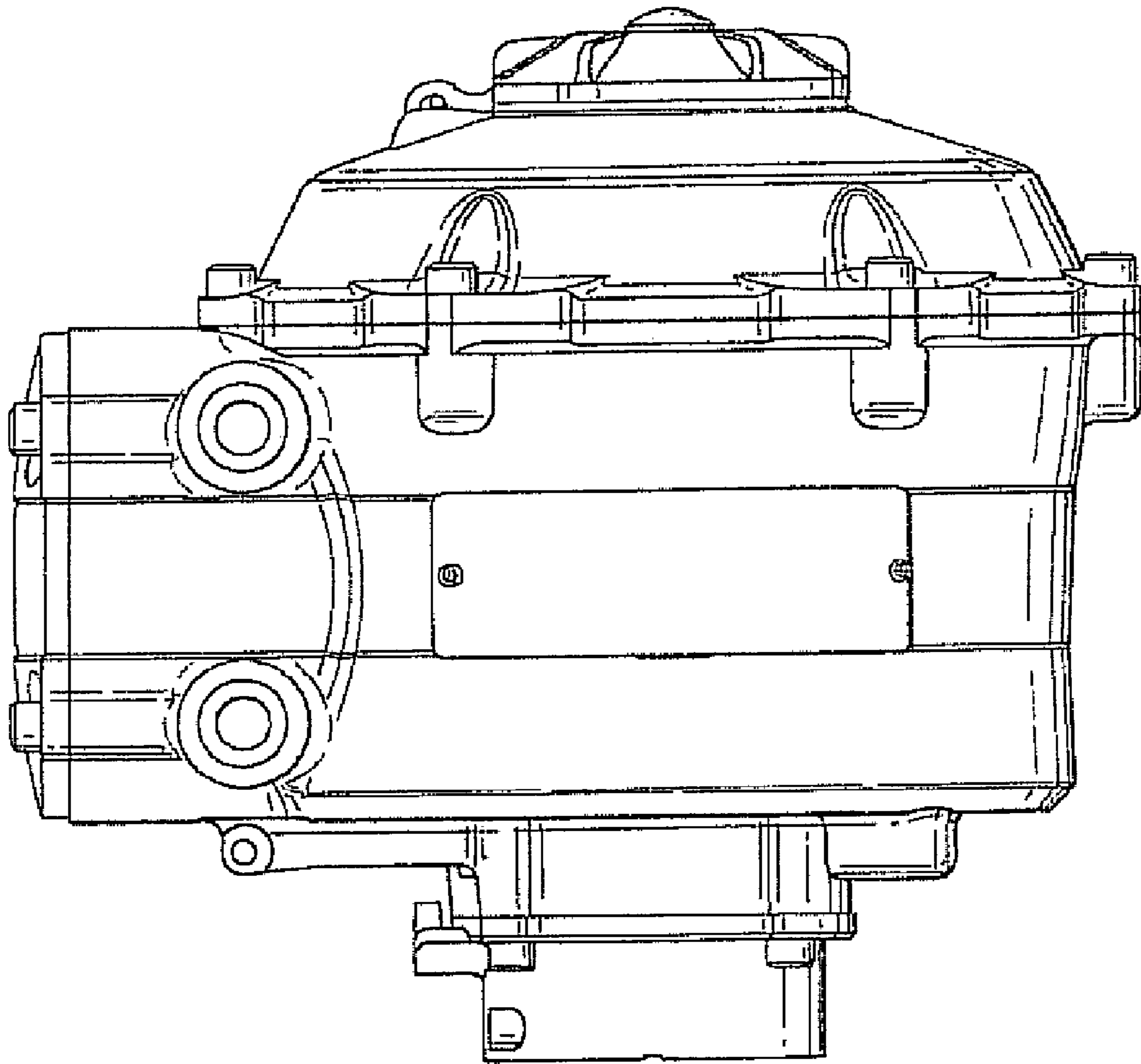


**Fig. 7**





**Fig. 8**



**Fig. 9**