



US00D583210S

(12) **United States Design Patent**
Koepp

(10) **Patent No.:** **US D583,210 S**

(45) **Date of Patent:** **** Dec. 23, 2008**

(54) **SPRING STEEL PRY BAR**

6,663,083 B1 * 12/2003 Smith 254/25
D493,078 S * 7/2004 McGee et al. D8/14

(75) Inventor: **Lawrence E. W. Koepp**, Garretson, SD
(US)

* cited by examiner

Primary Examiner—Philip S Hyder

(73) Assignee: **Vincent L. Koepp**, Columbia, IL (US)

(74) *Attorney, Agent, or Firm*—Grace J. Fishel

(**) Term: **14 Years**

(57) **CLAIM**

(21) Appl. No.: **29/298,212**

The ornamental design for a spring steel pry bar, as shown.

(22) Filed: **Nov. 30, 2007**

DESCRIPTION

(51) **LOC (8) Cl.** **08-05**

FIG. 1 is a perspective view of a spring steel pry bar showing my new design;

(52) **U.S. Cl.** **D8/89**

FIG. 2 is a perspective view thereof with a handle extension shown in broken lines;

(58) **Field of Classification Search** D8/14,
D8/88, 89, 10; 254/25, 26 R, 28, 130, 131
See application file for complete search history.

FIG. 3 is a front elevation thereof;

FIG. 4 is a right side elevation thereof, the left side being a mirror image;

(56) **References Cited**

U.S. PATENT DOCUMENTS

FIG. 5 is a rear elevation thereof;

D199,019 S * 8/1964 Marson D8/89

FIG. 6 is a top plan view thereof; and,

3,836,119 A * 9/1974 Saucier et al. 254/131

FIG. 7 is a bottom plan view thereof.

4,042,210 A * 8/1977 Feldmann 254/26 R

The handle extension shown in broken lines in FIG. 2 is not part of the claimed design.

D277,359 S * 1/1985 Schiller D8/89

D383,662 S * 9/1997 Ackerman D8/89

5,749,113 A * 5/1998 Witter 7/166

D426,131 S * 6/2000 Martinez D8/89

1 Claim, 2 Drawing Sheets

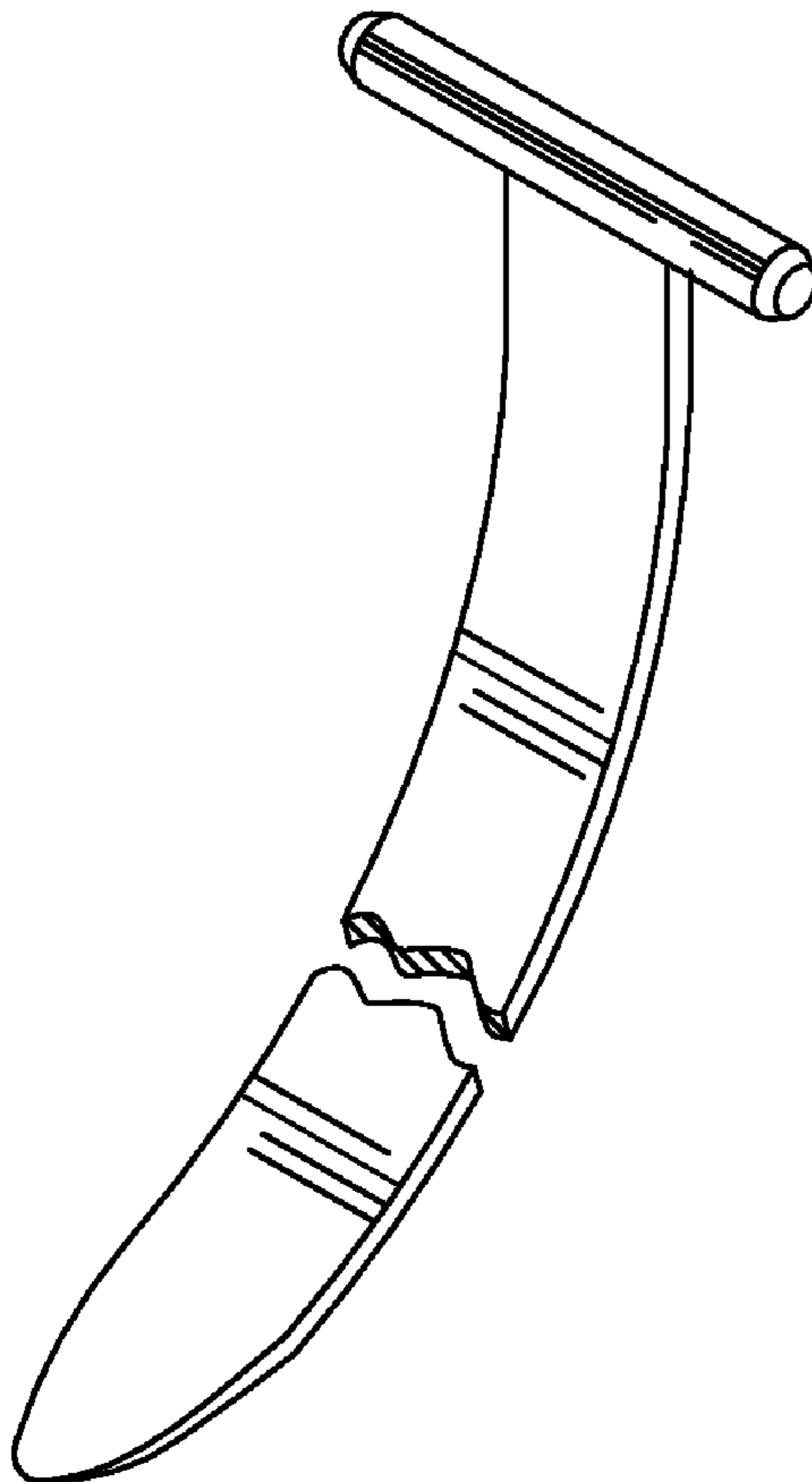

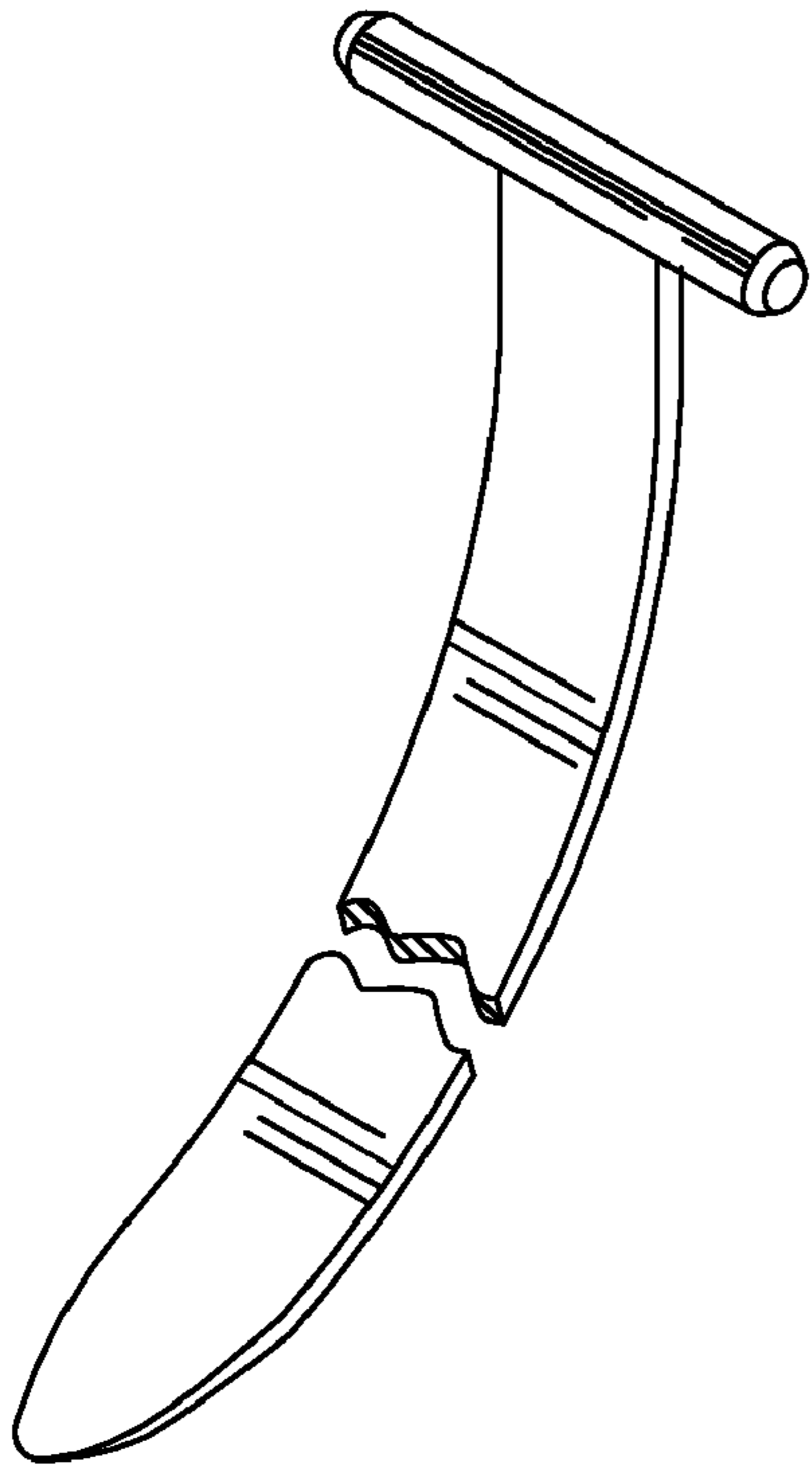

Fig. 1

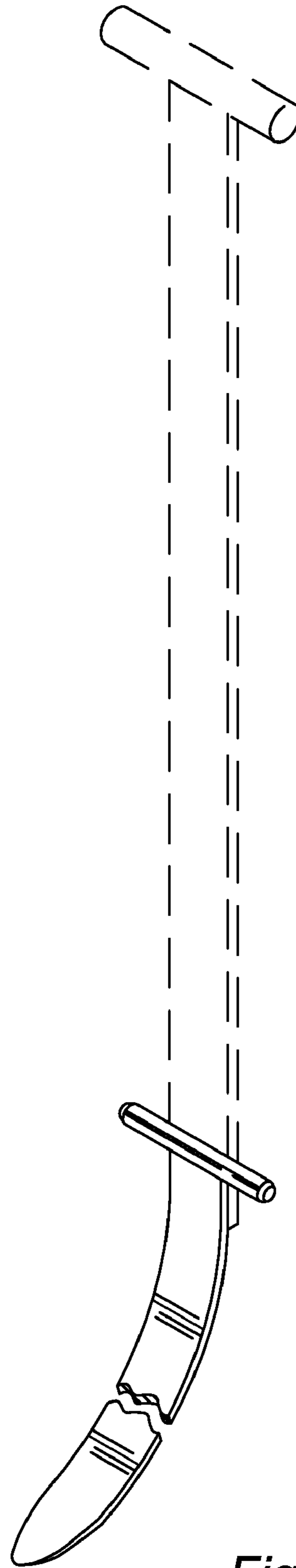

Fig. 2

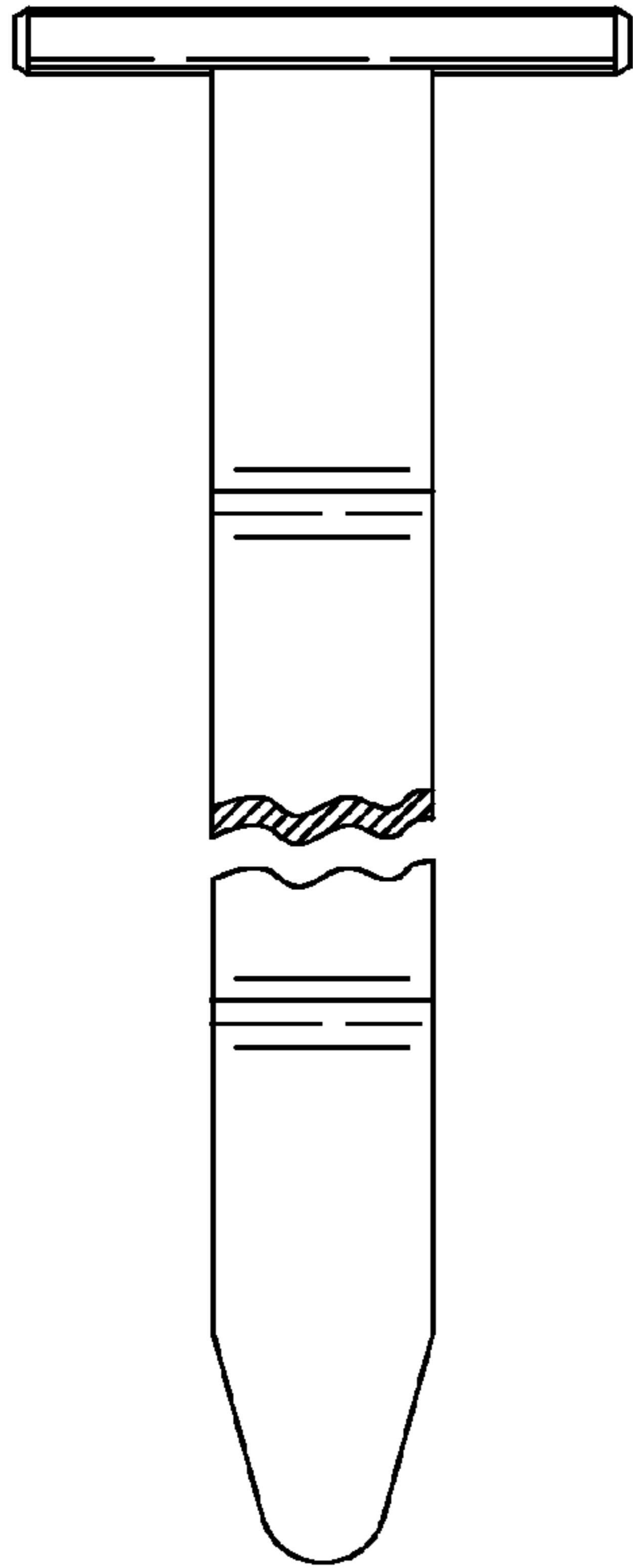

Fig. 3



Fig. 4

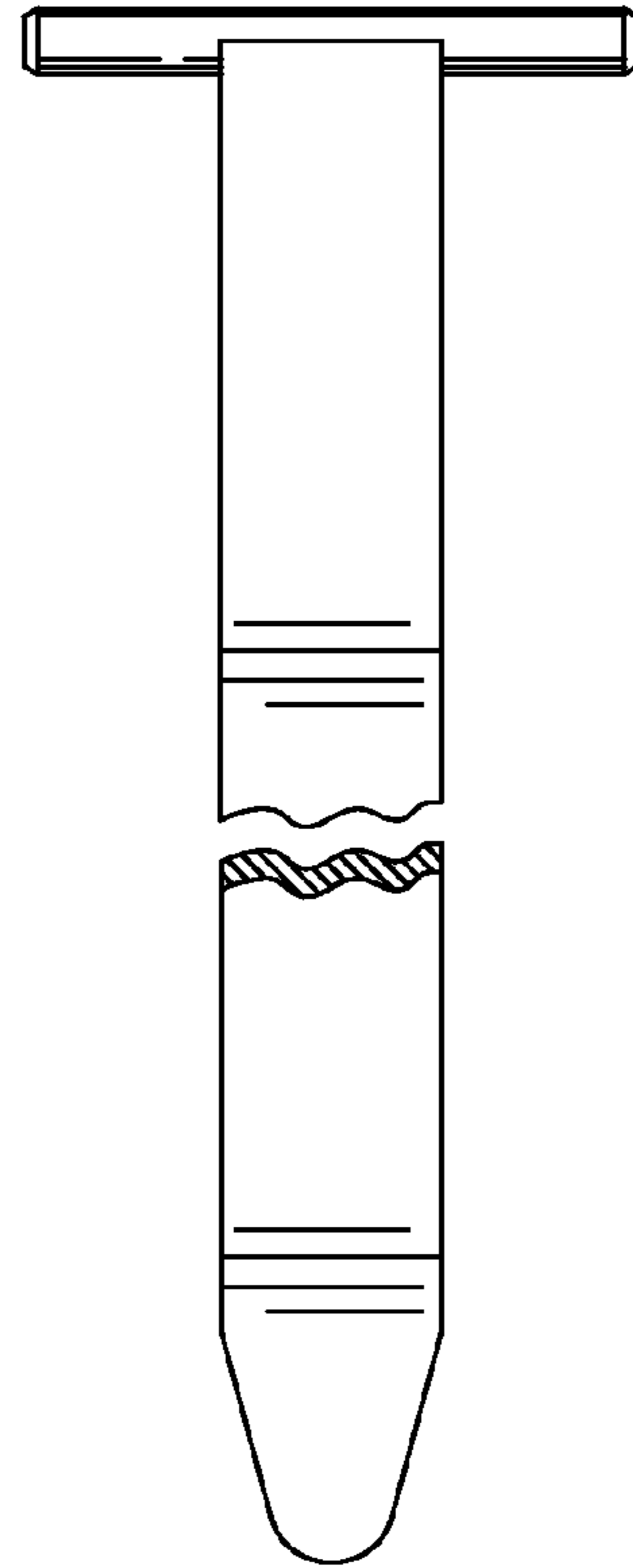

Fig. 5

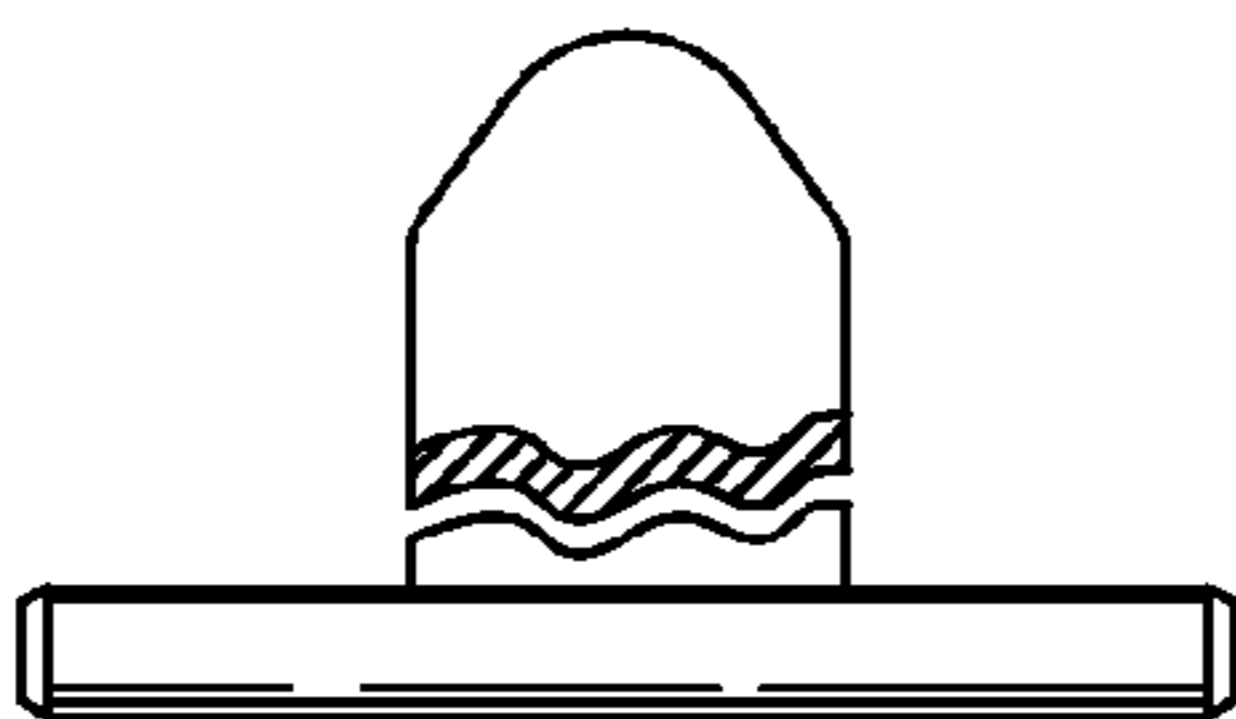

Fig. 6

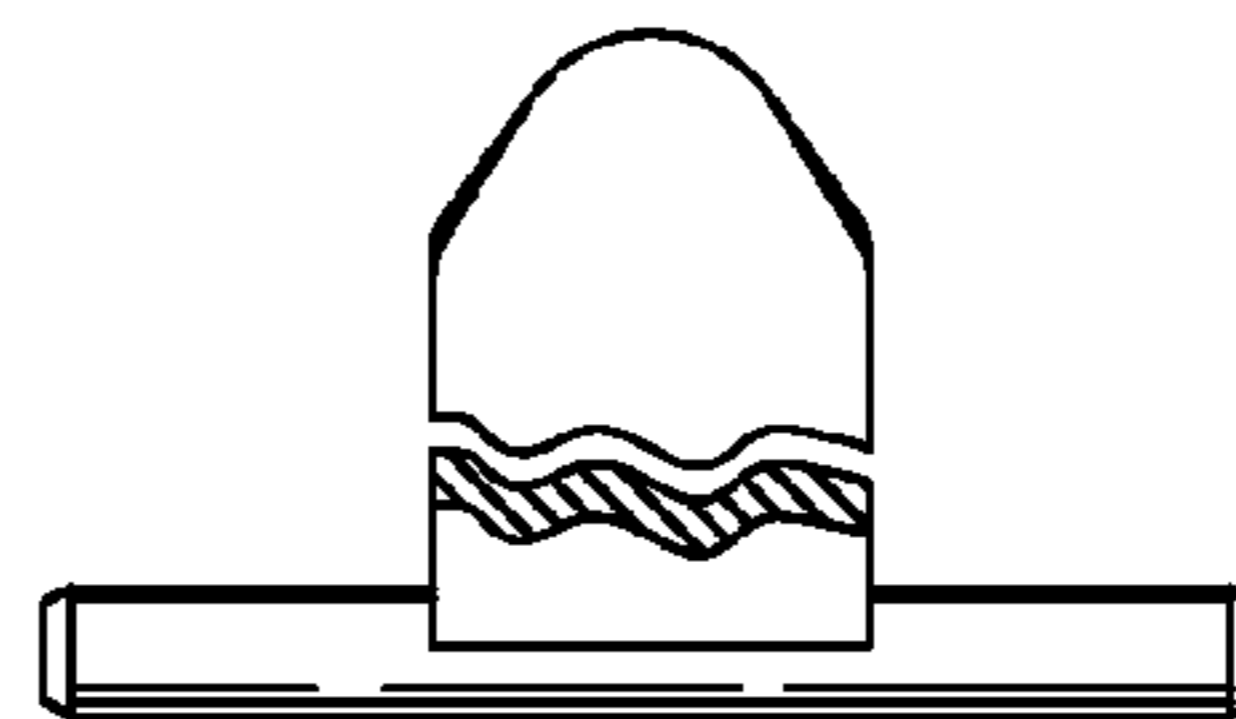

Fig. 7