



US00D582736S

(12) **United States Design Patent**
Ghirardi

(10) **Patent No.:** **US D582,736 S**

(45) **Date of Patent:** **** Dec. 16, 2008**

(54) **HEDGE TRIMMER**

(75) Inventor: **Simone Ghirardi**, Parma (IT)

(73) Assignee: **A.M.A. S.p.A.**, San Martino in Rio (IT)

(**) Term: **14 Years**

(21) Appl. No.: **29/289,716**

(22) Filed: **Jul. 30, 2007**

(30) **Foreign Application Priority Data**

Jan. 29, 2007 (EM) 000660543

(51) **LOC (8) Cl.** **08-01**

(52) **U.S. Cl.** **D8/9**

(58) **Field of Classification Search** D8/8,
D8/9

See application file for complete search history.

(56) **References Cited**

U.S. PATENT DOCUMENTS

3,293,746	A *	12/1966	Maxson	30/223
3,422,531	A *	1/1969	Lill et al.	30/210
3,751,805	A *	8/1973	Grahn	30/220
D313,538	S *	1/1991	Fushiya et al.	D8/8
5,075,972	A *	12/1991	Huang	30/216
D325,856	S *	5/1992	Gierke	D8/8
D333,953	S *	3/1993	Miyoshi et al.	D8/8
D351,096	S *	10/1994	Gierke	D8/8
D364,541	S *	11/1995	McJunkin et al.	D8/8
D372,407	S *	8/1996	Haneda et al.	D8/8
D382,451	S *	8/1997	Kikuchi	D8/8
D389,707	S *	1/1998	Ohi et al.	D8/8
D397,590	S *	9/1998	Meloni et al.	D8/8
D460,329	S *	7/2002	Waldron	D8/9
D460,667	S *	7/2002	Waldron	D8/8

D462,882	S *	9/2002	Evans	D8/8
D463,228	S *	9/2002	Cooper	D8/8
D463,229	S *	9/2002	Gabriel	D8/8
D468,600	S *	1/2003	Evans	D8/8
D482,943	S *	12/2003	Chunn et al.	D8/8
D500,431	S *	1/2005	Gice	D8/8
D505,602	S *	5/2005	Houghton	D8/8
D505,844	S *	6/2005	Houghton	D8/8
D506,653	S *	6/2005	Elsworthy	D8/8
D522,818	S *	6/2006	Andriolo	D8/8
D536,585	S *	2/2007	Baskar et al.	D8/8
D543,804	S *	6/2007	Houghton	D8/8
D543,805	S *	6/2007	Houghton	D8/8
D547,623	S *	7/2007	Mooney et al.	D8/8
D560,984	S *	2/2008	Tinius	D8/8

* cited by examiner

Primary Examiner—Holly H. Baynham

Assistant Examiner—Sheryl Lane

(74) *Attorney, Agent, or Firm*—Frommer Lawrence & Haug LLP; Ronald R Santucci

(57) **CLAIM**

The designs for hedge trimmer, substantially as shown in the accompanying drawings.

DESCRIPTION

FIG. 1 is a perspective view of a hedge trimmer;

FIG. 2 is a right side view thereof;

FIG. 3 is a left side view thereof;

FIG. 4 is a front view thereof;

FIG. 5 is a rear view thereof;

FIG. 6 is a top plan view thereof; and,

FIG. 7 is a bottom plan view thereof.

1 Claim, 7 Drawing Sheets

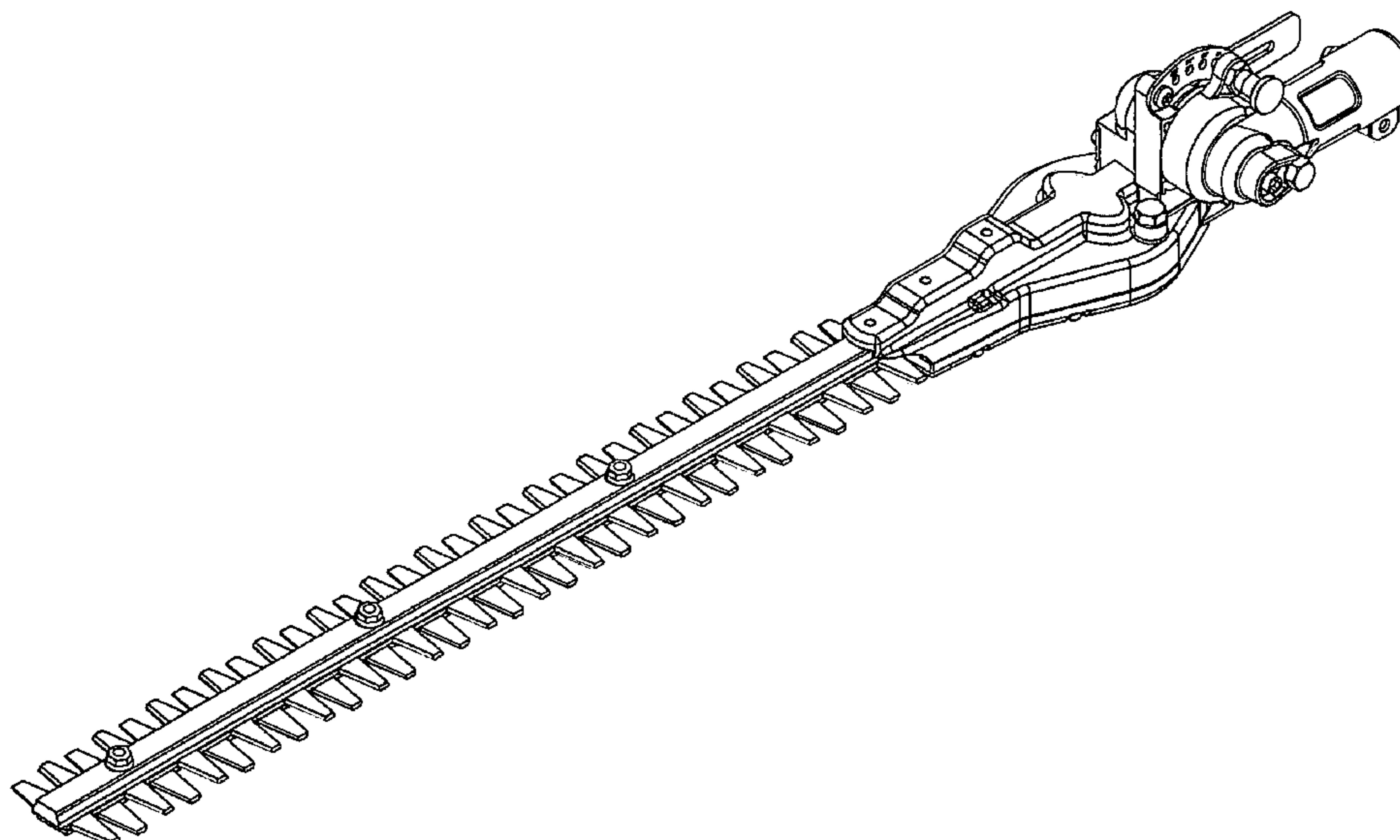

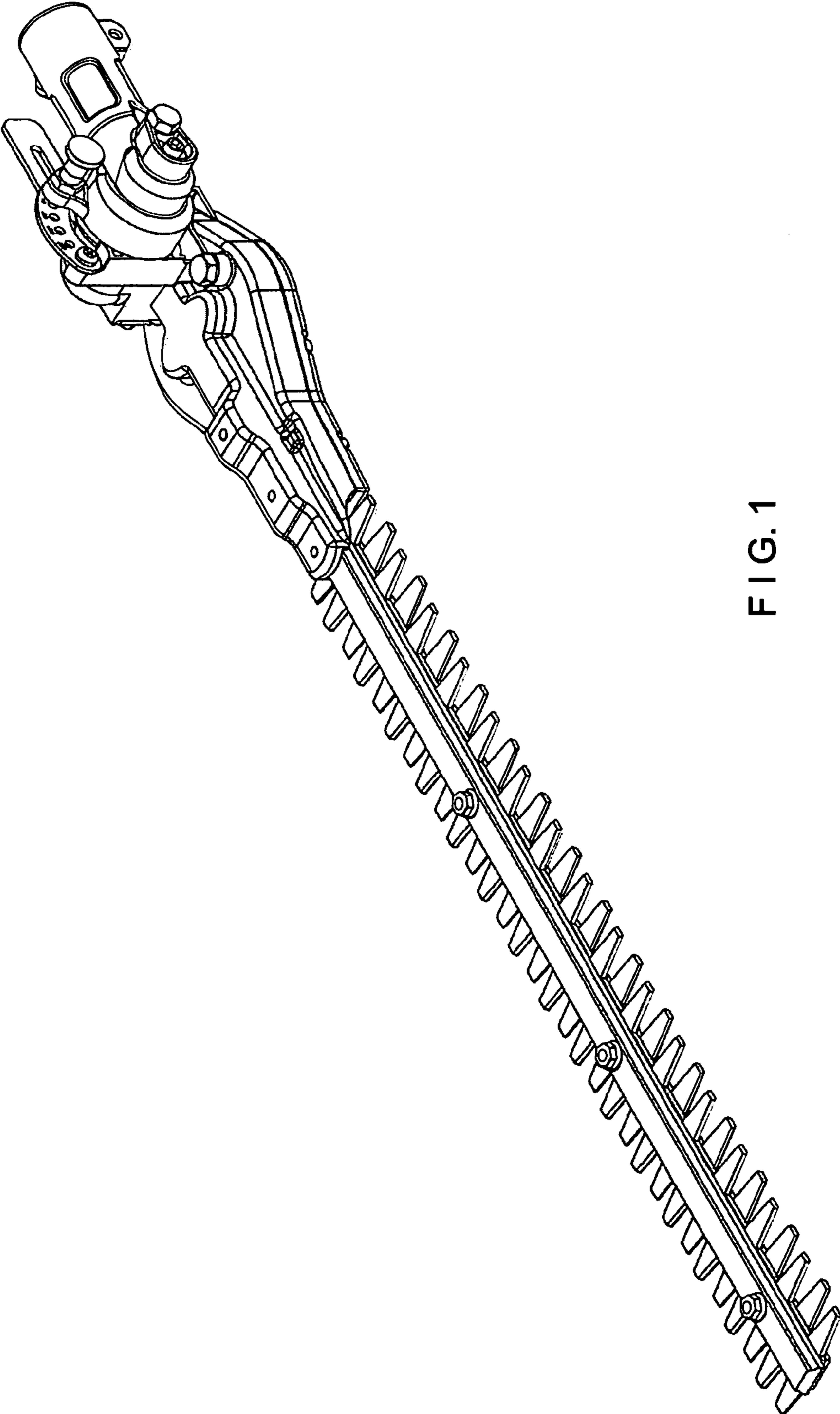

FIG. 1

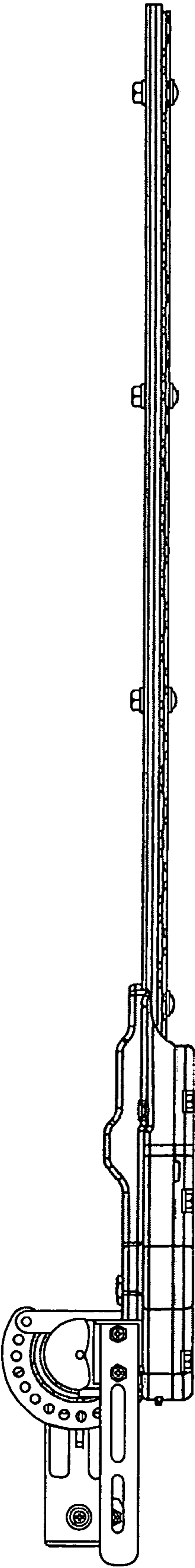

FIG. 2

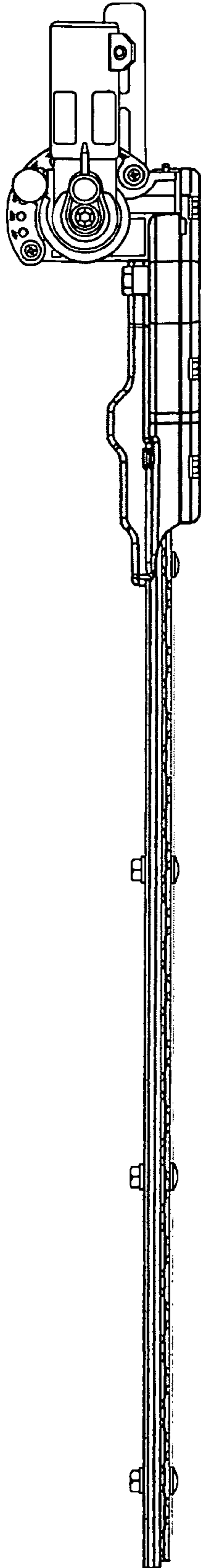

FIG. 3

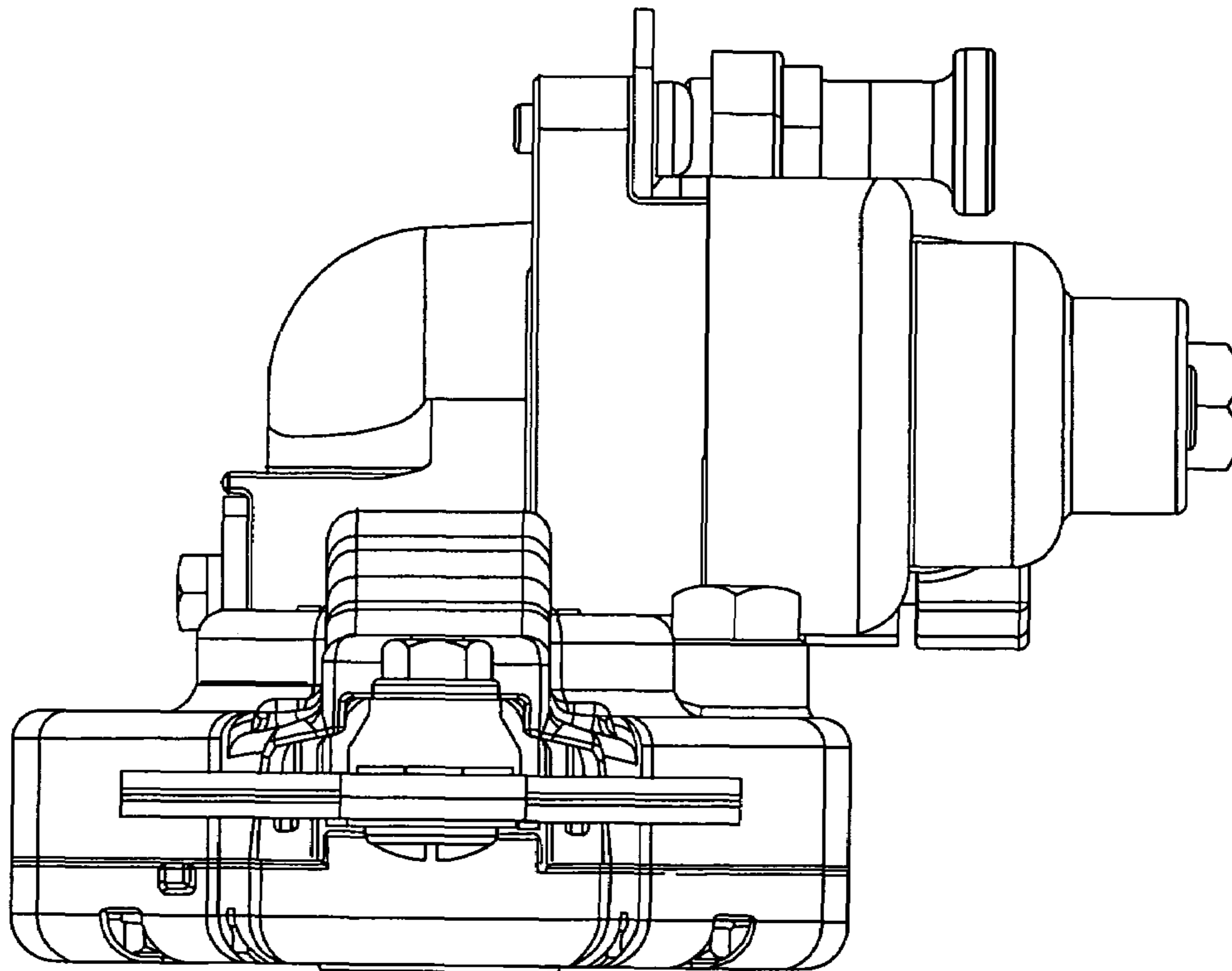

FIG. 4

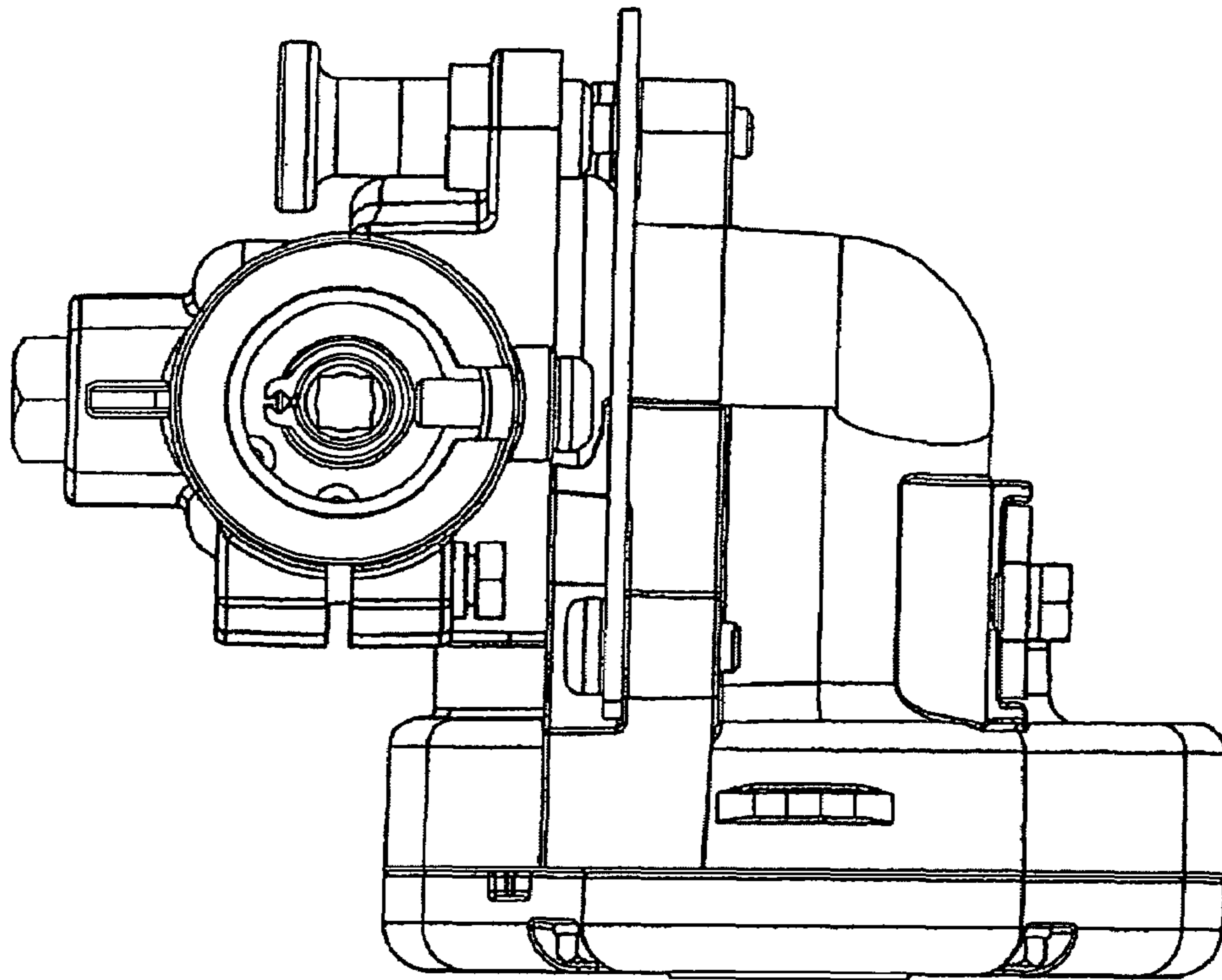

FIG. 5

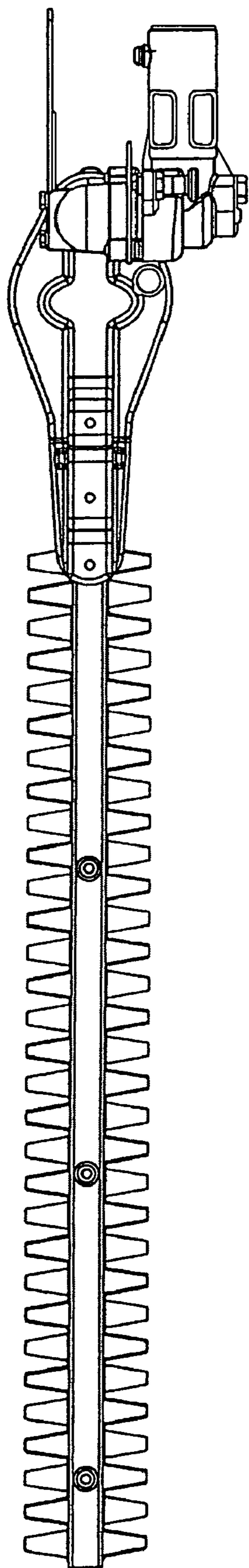

FIG. 6

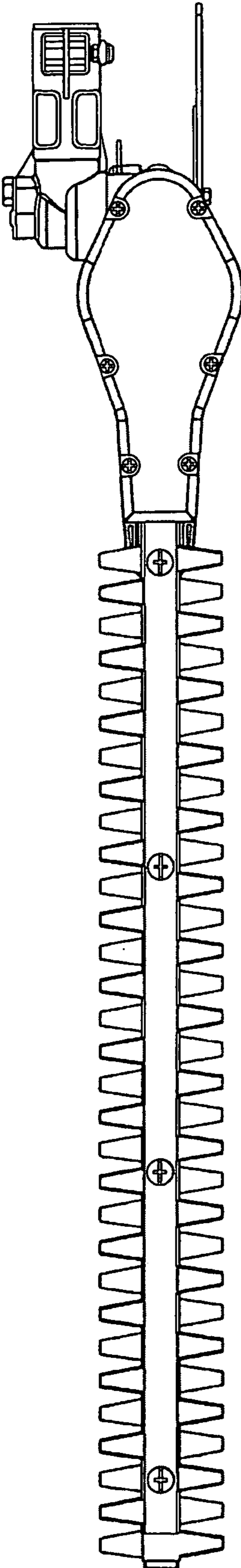

FIG. 7