



US00D581974S

(12) **United States Design Patent**
Mekada et al.

(10) **Patent No.:** **US D581,974 S**
(45) **Date of Patent:** **** Dec. 2, 2008**

(54) **DEVELOPING APPARATUS FOR PRINTER**

JP D1216182 S 8/2004

(75) Inventors: **Hideki Mekada**, Shinshiro (JP); **Yuichi Yamamoto**, Toyokawa (JP)

(73) Assignee: **Konica Minolta Business Technologies, Inc.**, Chiyoda-Ku, Tokyo (JP)

(**) Term: **14 Years**

(21) Appl. No.: **29/265,451**

(22) Filed: **Sep. 1, 2006**

(30) **Foreign Application Priority Data**

Mar. 3, 2006 (JP) 2006-005406

(51) **LOC (8) Cl.** **16-03**

(52) **U.S. Cl.** **D18/43**

(58) **Field of Classification Search** D14/471;
D18/12, 36, 40, 43, 44, 56; 222/DIG. 1;
347/197, 222; 399/24-28, 107-112, 119,
399/121, 122, 222-224

See application file for complete search history.

(56) **References Cited**

U.S. PATENT DOCUMENTS

D448,042 S * 9/2001 Hale et al. D18/43
D524,850 S * 7/2006 Hashimoto et al. D18/43
D529,076 S * 9/2006 Kobayashi et al. D18/43
D534,576 S * 1/2007 Hashimoto et al. D18/43
D552,163 S * 10/2007 Kouroku et al. D18/43
D553,183 S * 10/2007 Hashimoto et al. D18/43

FOREIGN PATENT DOCUMENTS

JP D1216043 S 8/2004

OTHER PUBLICATIONS

Product information for magicolor 5440 DL, Konica Minolta Holdings Inc., <http://konicaminoltajp/products/business/printers/laser/color/magicolor5440dl/...>, pp. 1-5, Aug. 23, 2006.

Optional product information for magicolor 5440 DL, Konica Minolta Holdings Inc., <http://konicaminoltajp/products/business/printers/laser/color/magicolor5440dl/...>, pp. 1-4, Aug. 23, 2006.

Optional product information for magicolor 7300, Konica Minolta Holdings Inc., <http://konicaminoltajp/products/business/printers/laser/archive/magi7300/730...>, pp. 1-3, Aug. 23, 2006.

* cited by examiner

Primary Examiner—Caron D. Veynar

Assistant Examiner—Garth Rademaker

(74) *Attorney, Agent, or Firm*—Buchanan Ingersoll & Rooney PC

(57) **CLAIM**

The ornamental design for a developing apparatus for printer, as shown and described.

DESCRIPTION

FIG. 1 is a top, front and right side perspective view of a developing apparatus for a printer showing our new design;

FIG. 2 is a front elevational view thereof;

FIG. 3 is a rear elevational view thereof;

FIG. 4 is a top plan view thereof;

FIG. 5 is a bottom plan view thereof;

FIG. 6 is a right side view thereof; and,

FIG. 7 is a left side view thereof.

The broken lines depict environmental subject matter only and form no part of the claimed design.

1 Claim, 6 Drawing Sheets

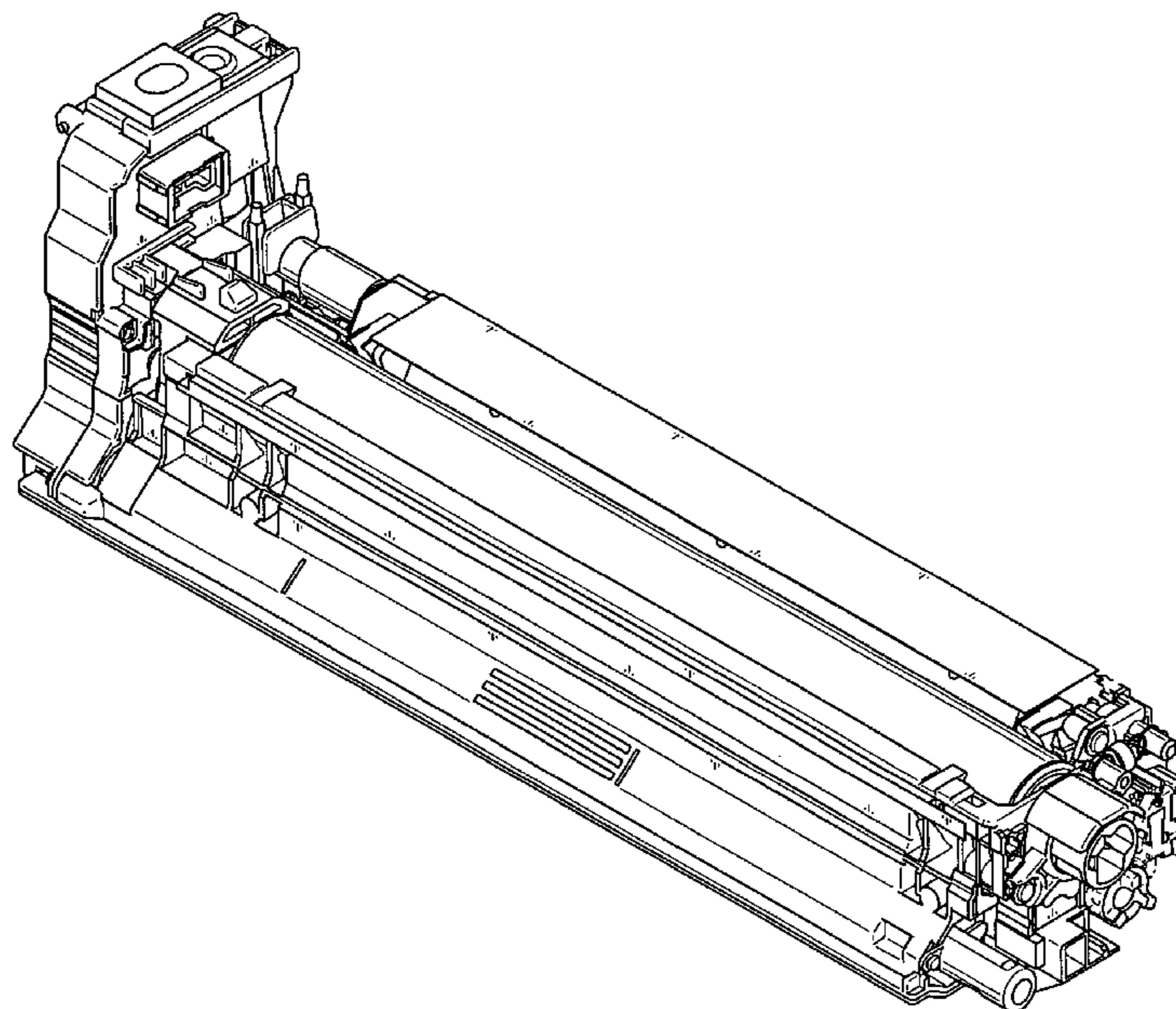

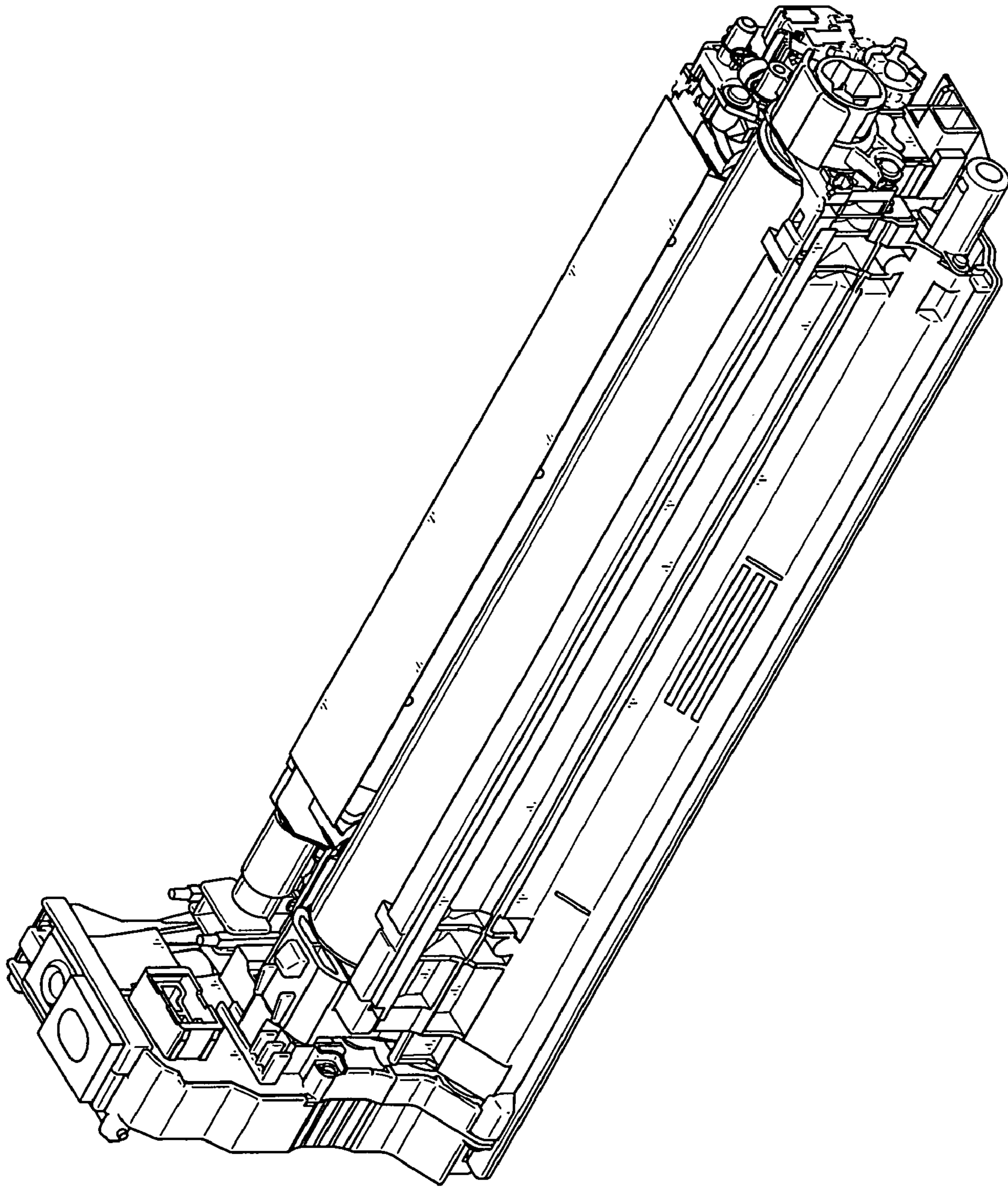
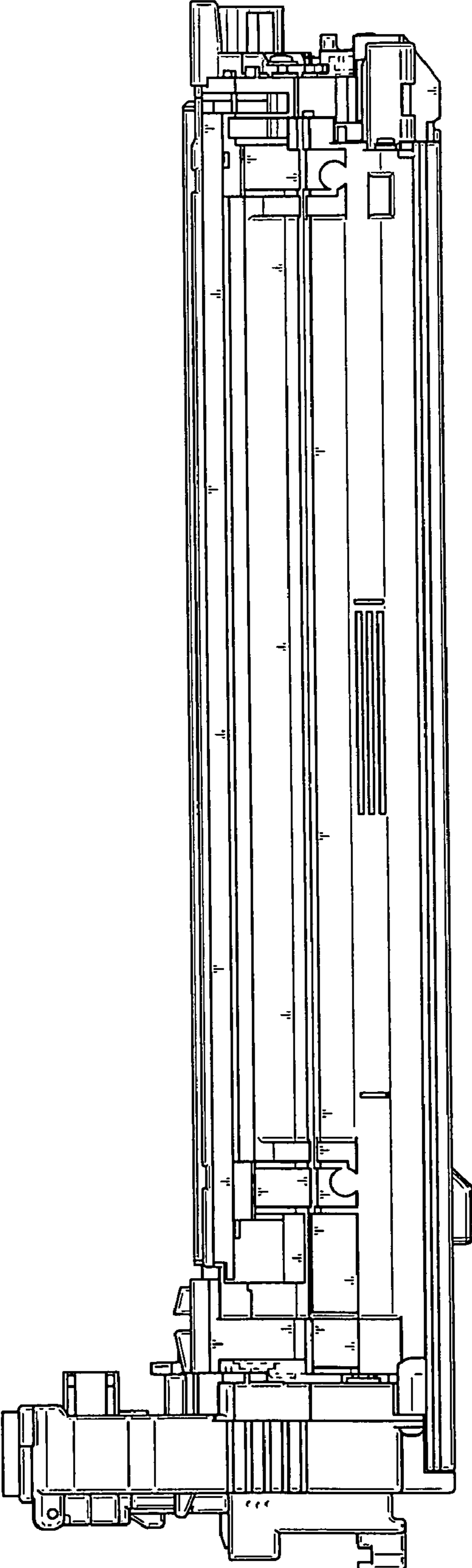

Fig. 1

Fig. 2



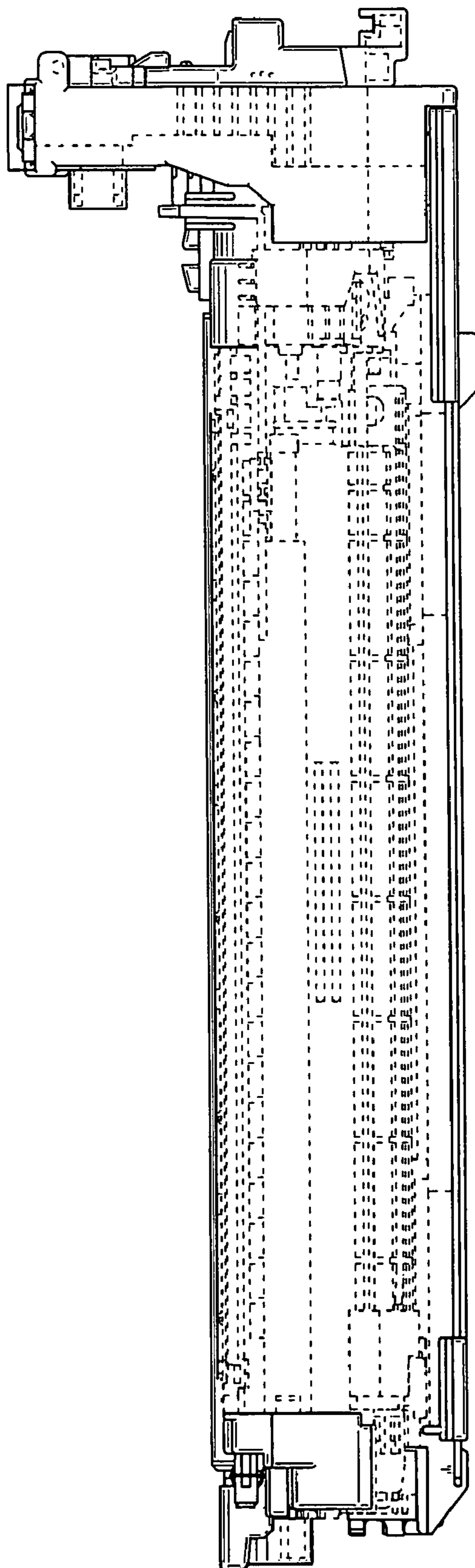

Fig. 3

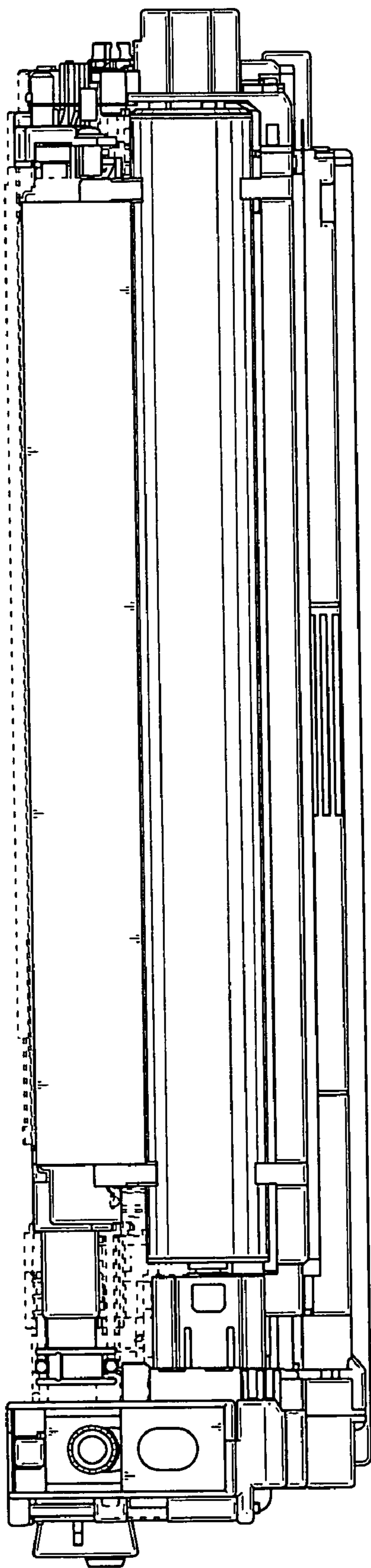

Fig. 4

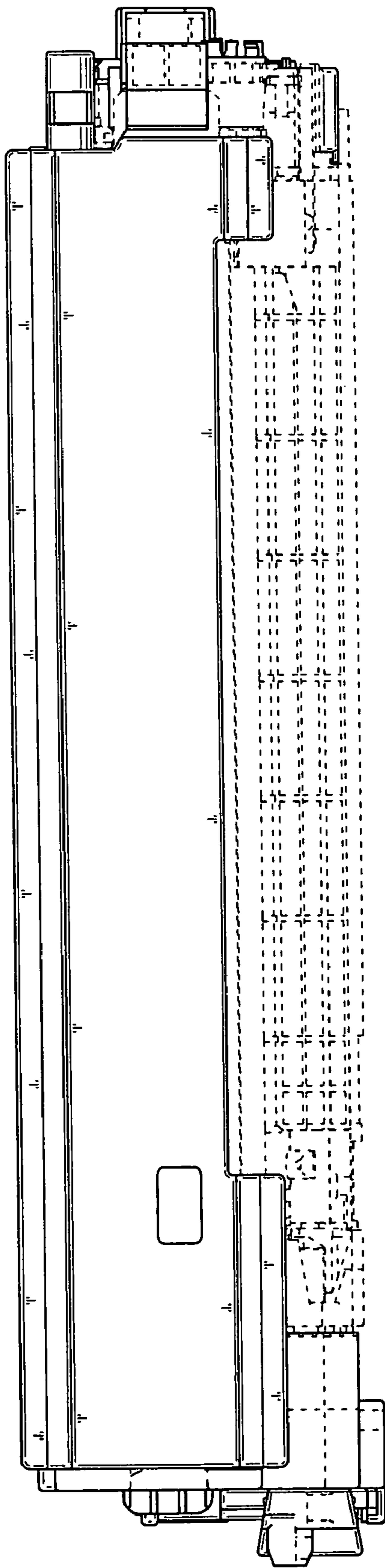

Fig. 5

Fig. 7

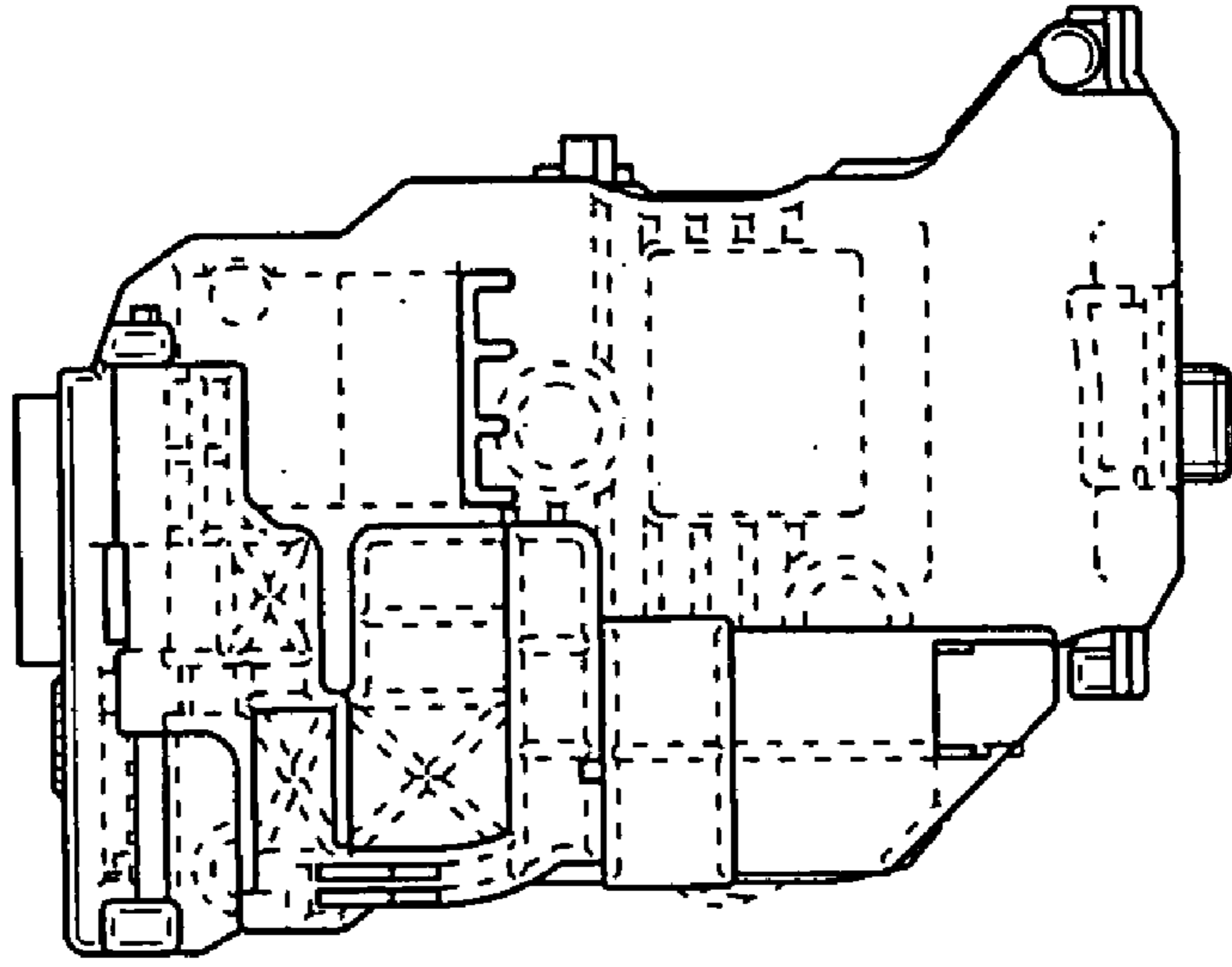

Fig. 6

