



US00D581263S

(12) **United States Design Patent**  
**Suyama et al.**

(10) **Patent No.:** **US D581,263 S**

(45) **Date of Patent:** **\*\* Nov. 25, 2008**

(54) **PACKING BOX FOR FISHING LINE**

(75) Inventors: **Koji Suyama**, Tokyo (JP); **Keisuke Narumi**, New York, NY (US); **Takahiro Oizumi**, Tokyo (JP)

(73) Assignee: **Kureha Corporation**, Tokyo (JP)

(\*\*) Term: **14 Years**

(21) Appl. No.: **29/290,514**

(22) Filed: **Dec. 12, 2007**

(30) **Foreign Application Priority Data**

Jul. 11, 2007 (JP) ..... 2007-018902

(51) **LOC (8) Cl.** ..... **09-03**

(52) **U.S. Cl.** ..... **D9/415; D9/600**

(58) **Field of Classification Search** ..... D9/600-681,  
D9/414-433; 206/303, 315.11, 388, 389,  
206/395-398, 457, 461-471, 806; 229/100,  
229/102.5, 116.1, 117.09, 117.12, 117.18,  
229/117.24, 922

See application file for complete search history.

(56) **References Cited**

**U.S. PATENT DOCUMENTS**

D241,718 S \* 10/1976 Hourahine ..... D9/457  
D285,175 S \* 8/1986 Ewry ..... D9/415  
5,660,322 A \* 8/1997 Jensen ..... 229/193  
D420,906 S \* 2/2000 Nash et al. .... D9/415

6,053,325 A \* 4/2000 Yonker et al. .... 206/736  
D428,335 S \* 7/2000 Toyota et al. .... D9/432  
D496,859 S \* 10/2004 Hamuro et al. .... D9/432  
D509,424 S \* 9/2005 Berner ..... D9/415  
D536,988 S \* 2/2007 Kusumi et al. .... D9/624  
D546,667 S \* 7/2007 Sexton, Jr. .... D9/415  
D546,673 S \* 7/2007 Mongeon et al. .... D9/432  
D552,985 S \* 10/2007 Shiiya et al. .... D9/432  
D554,500 S \* 11/2007 Bone et al. .... D9/432

\* cited by examiner

*Primary Examiner*—Catherine Tuttle

(57) **CLAIM**

The ornamental design for the packing box for fishing line, as shown.

**DESCRIPTION**

FIG. 1 is a front view of the packing box for fishing line showing our new design;

FIG. 2 is a rear view thereof;

FIG. 3 is a top plan view thereof;

FIG. 4 is a bottom plan view thereof;

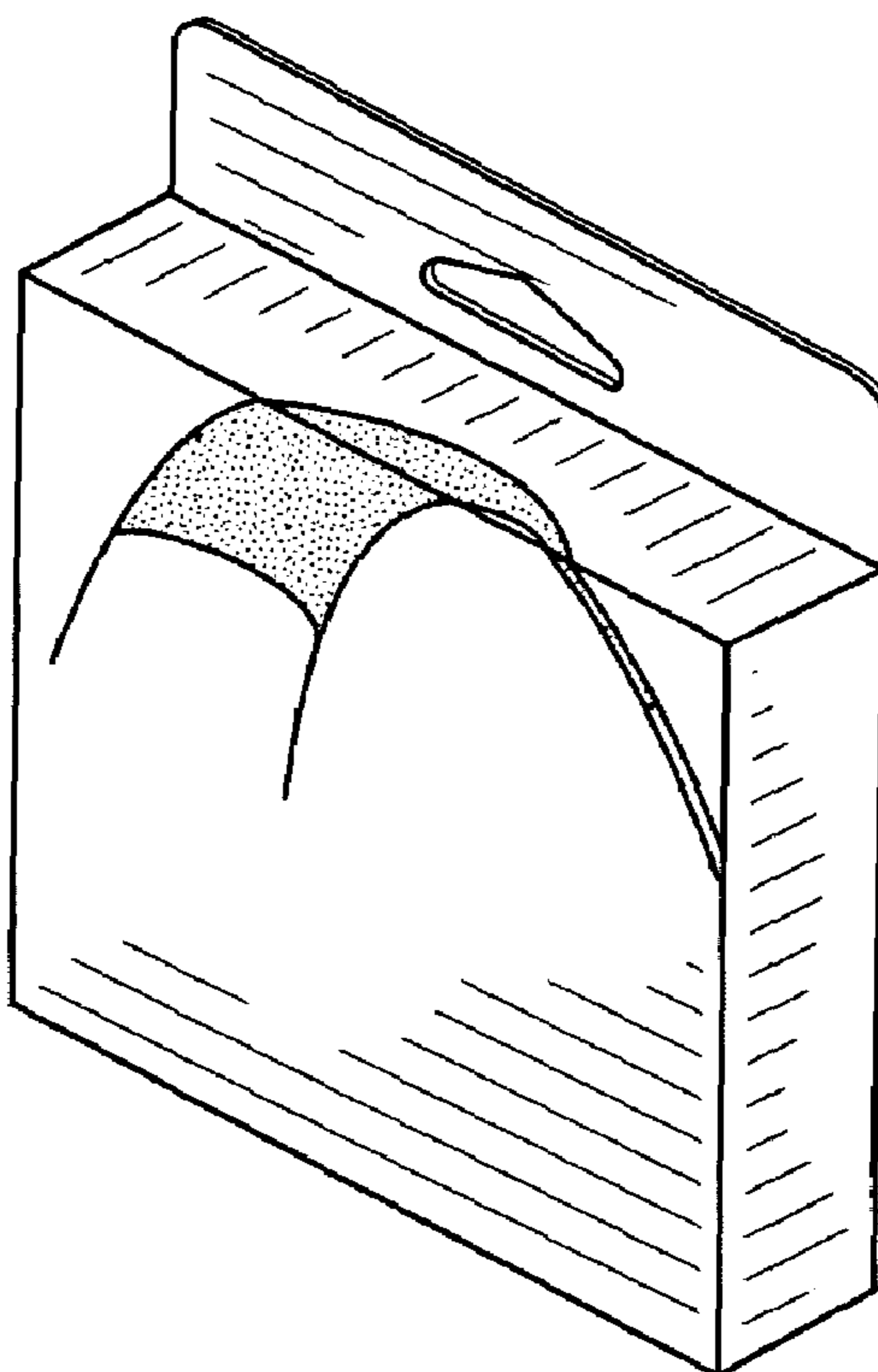
FIG. 5 is a right side view thereof;

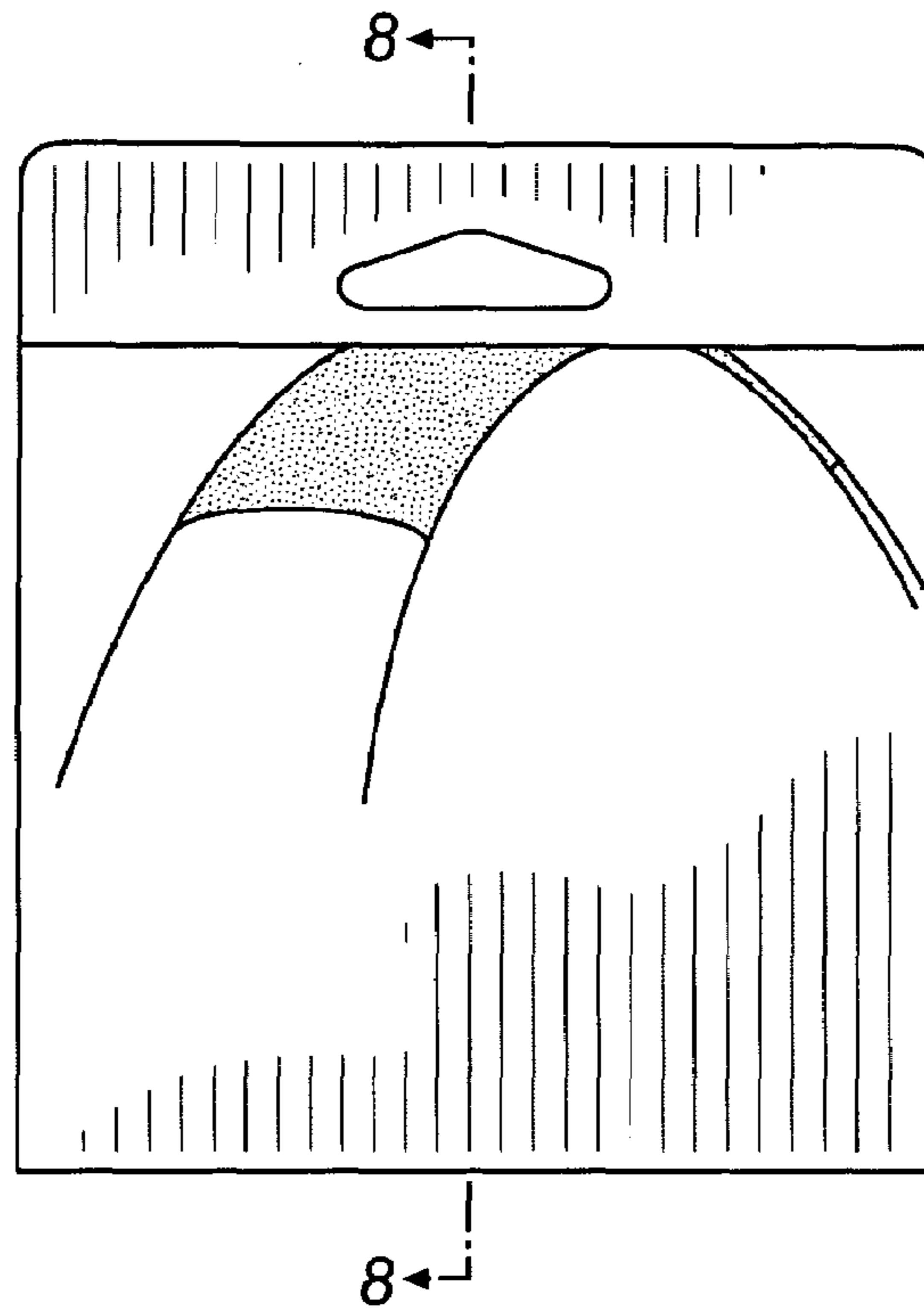
FIG. 6 is a left side view thereof;

FIG. 7 is a perspective view thereof; and,

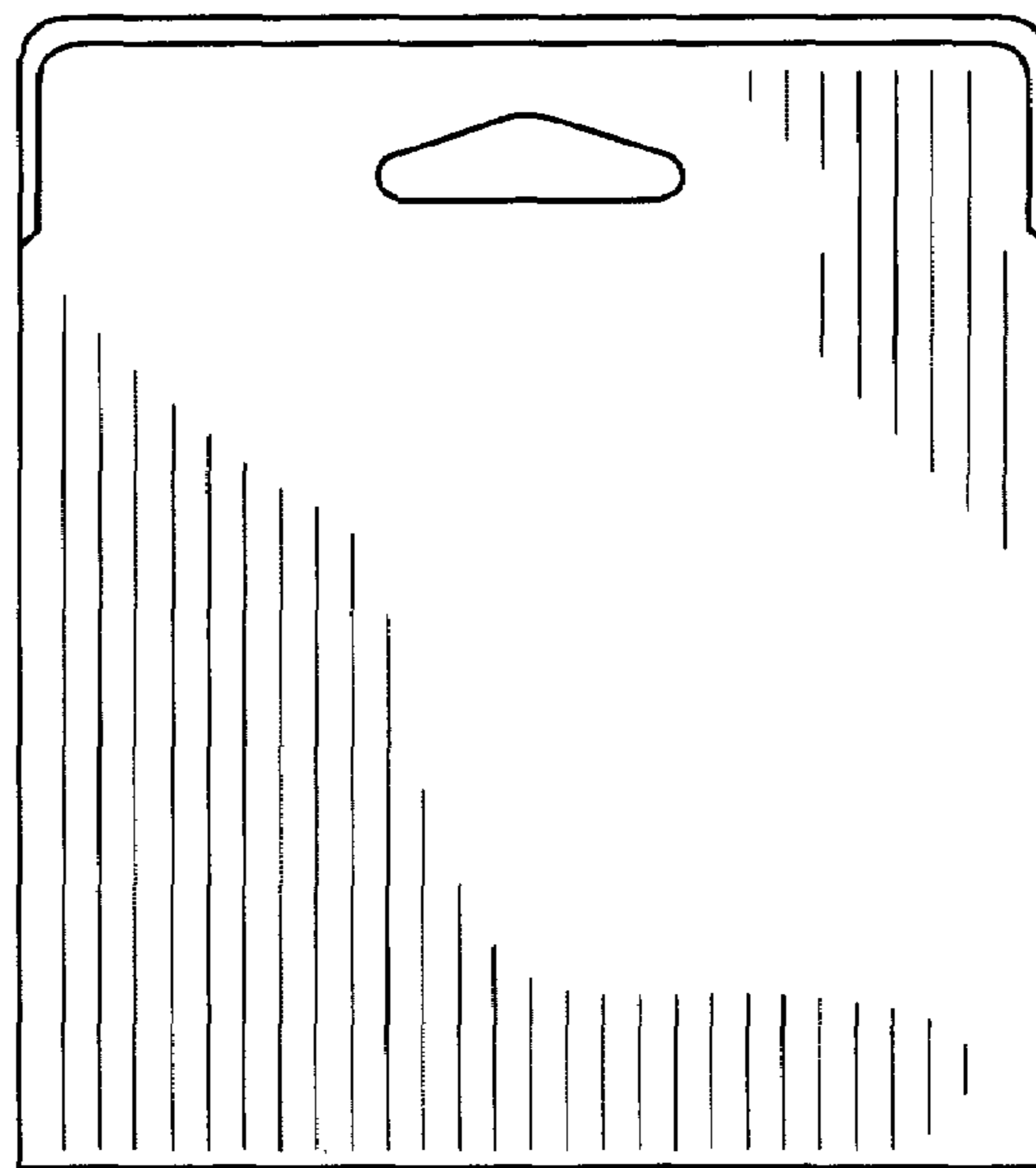
FIG. 8 is a cross sectional view of the plane indicated by line 8—8 in FIG. 1.

**1 Claim, 3 Drawing Sheets**

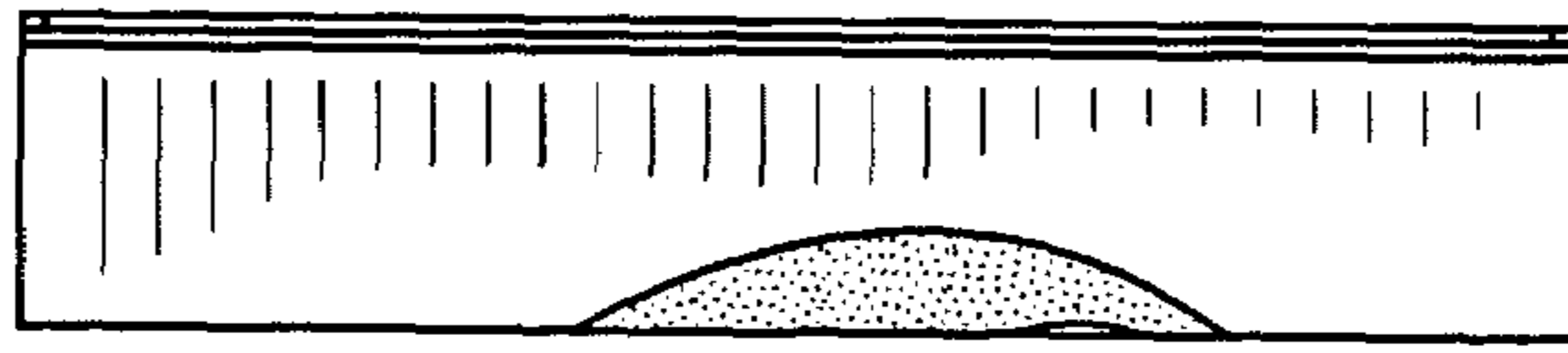




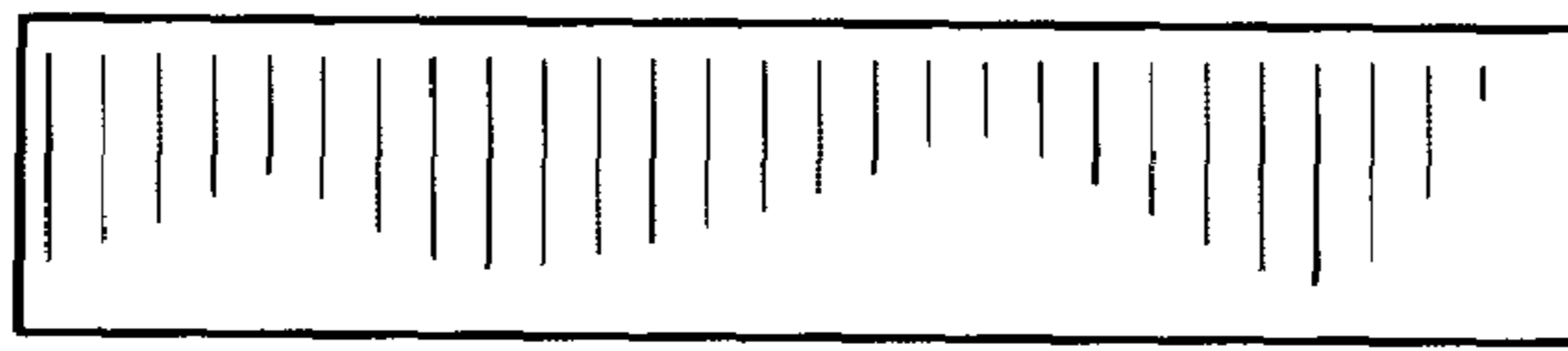
**FIG. 1**



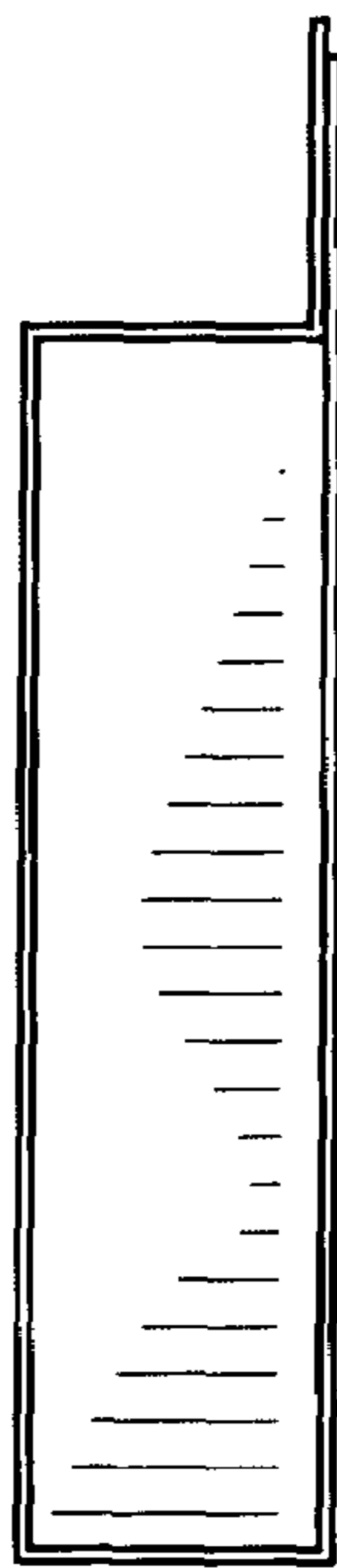
**FIG. 2**



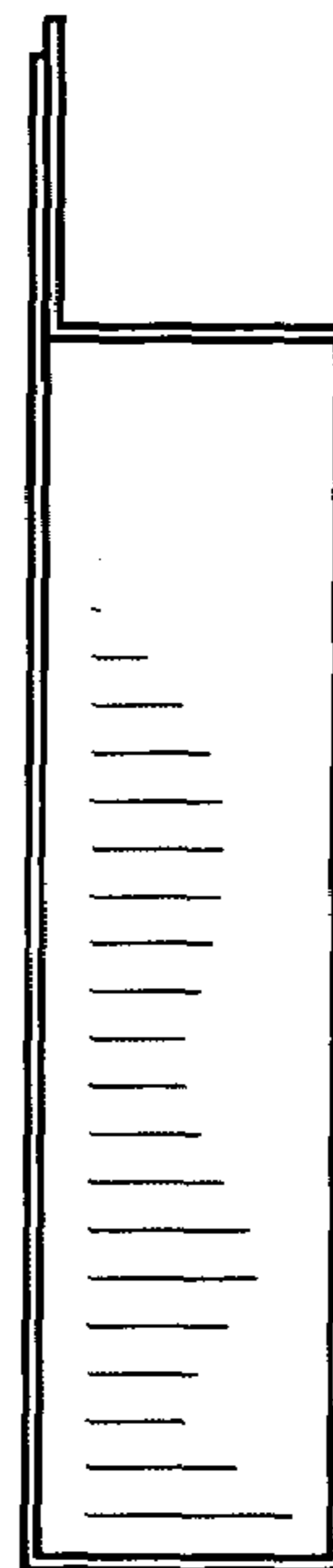
**FIG. 3**



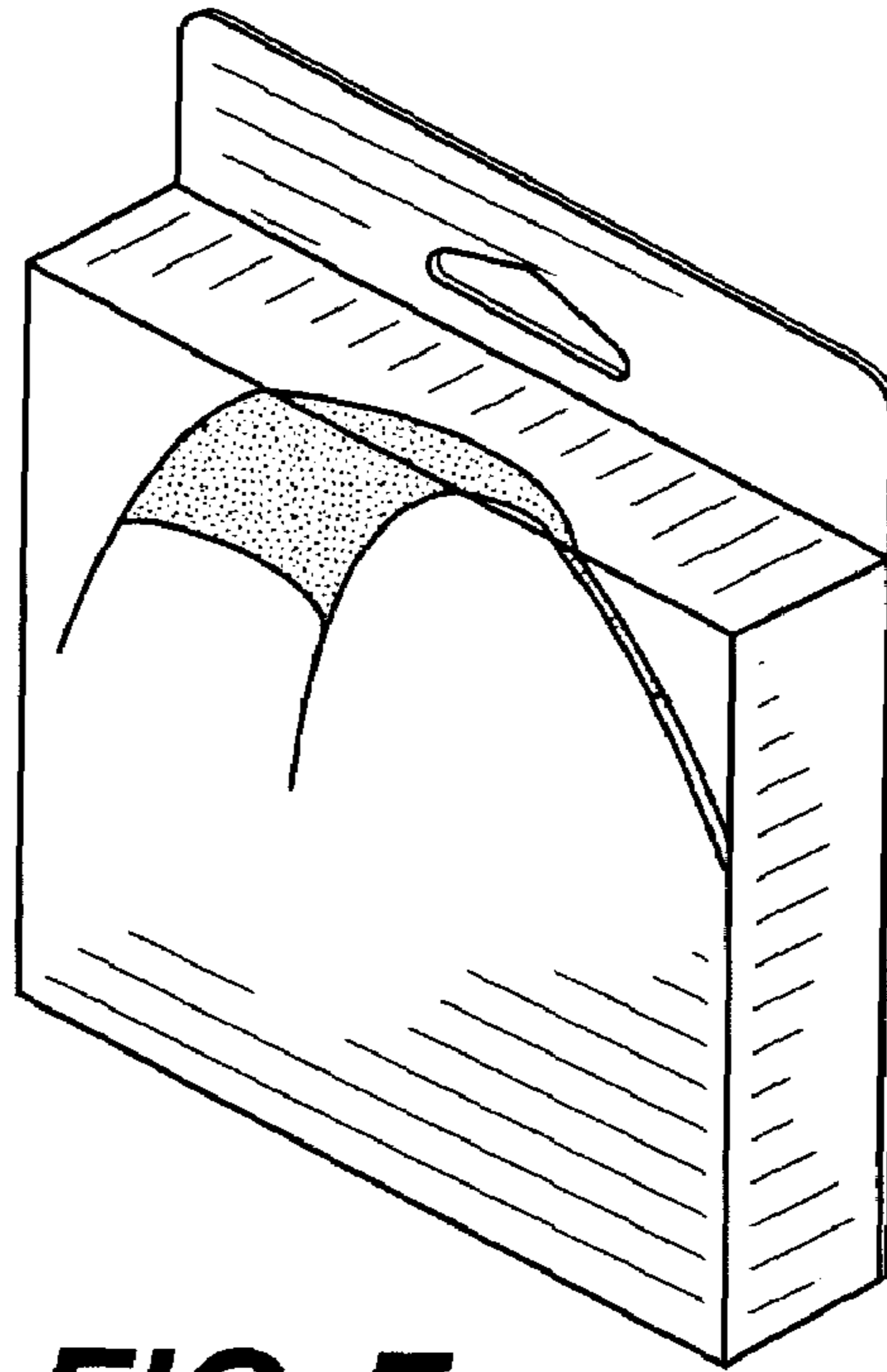
**FIG. 4**



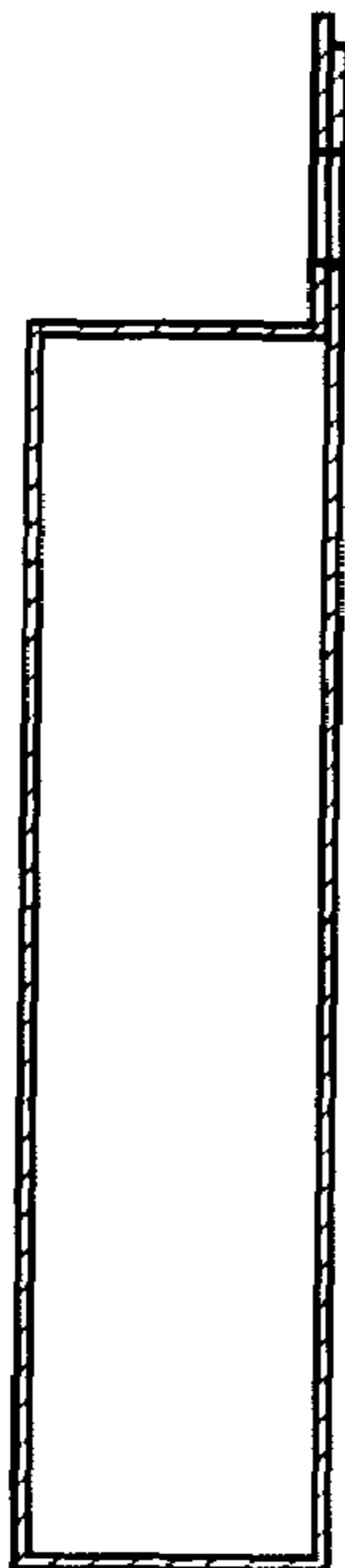
**FIG. 5**



**FIG. 6**



**FIG. 7**



**FIG. 8**