



US00D581247S

(12) **United States Design Patent**  
**Durrant**

(10) **Patent No.:** **US D581,247 S**  
(45) **Date of Patent:** **\*\* Nov. 25, 2008**

- (54) **WINDOW LOCK**
- (75) Inventor: **John Durrant**, Hadleigh (GB)
- (73) Assignee: **Mighton Products Limited** (GB)
- (\*\*) Term: **14 Years**
- (21) Appl. No.: **29/278,250**
- (22) Filed: **Mar. 23, 2007**
- (51) **LOC (8) Cl.** ..... **08-07**
- (52) **U.S. Cl.** ..... **D8/331**
- (58) **Field of Classification Search** ..... D8/330,  
D8/331, 339, 343; 70/14, 51, 52, 57.1, 141,  
70/142; 292/92, 96, 37, 348, 358, 359  
See application file for complete search history.

(56) **References Cited**

**U.S. PATENT DOCUMENTS**

- 2,837,905 A \* 6/1958 Wroughton ..... 70/90
- 3,813,120 A \* 5/1974 Kelly ..... 292/251
- 4,989,908 A \* 2/1991 Futch et al. .... 292/341.15
- D388,686 S \* 1/1998 Goodwin et al. .... D8/331
- D432,392 S \* 10/2000 Miller et al. .... D8/337
- 6,135,510 A \* 10/2000 Diginosa ..... 292/145
- 6,519,984 B1 \* 2/2003 Morris ..... 70/210

- D495,582 S \* 9/2004 Richardson et al. .... D8/337
- 7,296,831 B2 \* 11/2007 Generowicz et al. .... 292/242
- D567,063 S \* 4/2008 Farrell ..... D8/331

\* cited by examiner

*Primary Examiner*—Prabhakar Deshmukh  
(74) *Attorney, Agent, or Firm*—Bourque & Associates

(57) **CLAIM**

The ornamental design for a window lock, as shown and described herein.

**DESCRIPTION**

FIG. 1 is a front and left side perspective view of a window lock showing my new design;

FIG. 2 is an exploded rear and left side perspective view thereof, the right side being a mirror image thereof;

FIG. 3 is an exploded front and left perspective view thereof; and,

FIG. 4 is a rear and left perspective view thereof.

The broken lines showing of a square engagement shank in FIG. 1 is for illustrative purpose only and forms no part of the claimed design.

**1 Claim, 4 Drawing Sheets**

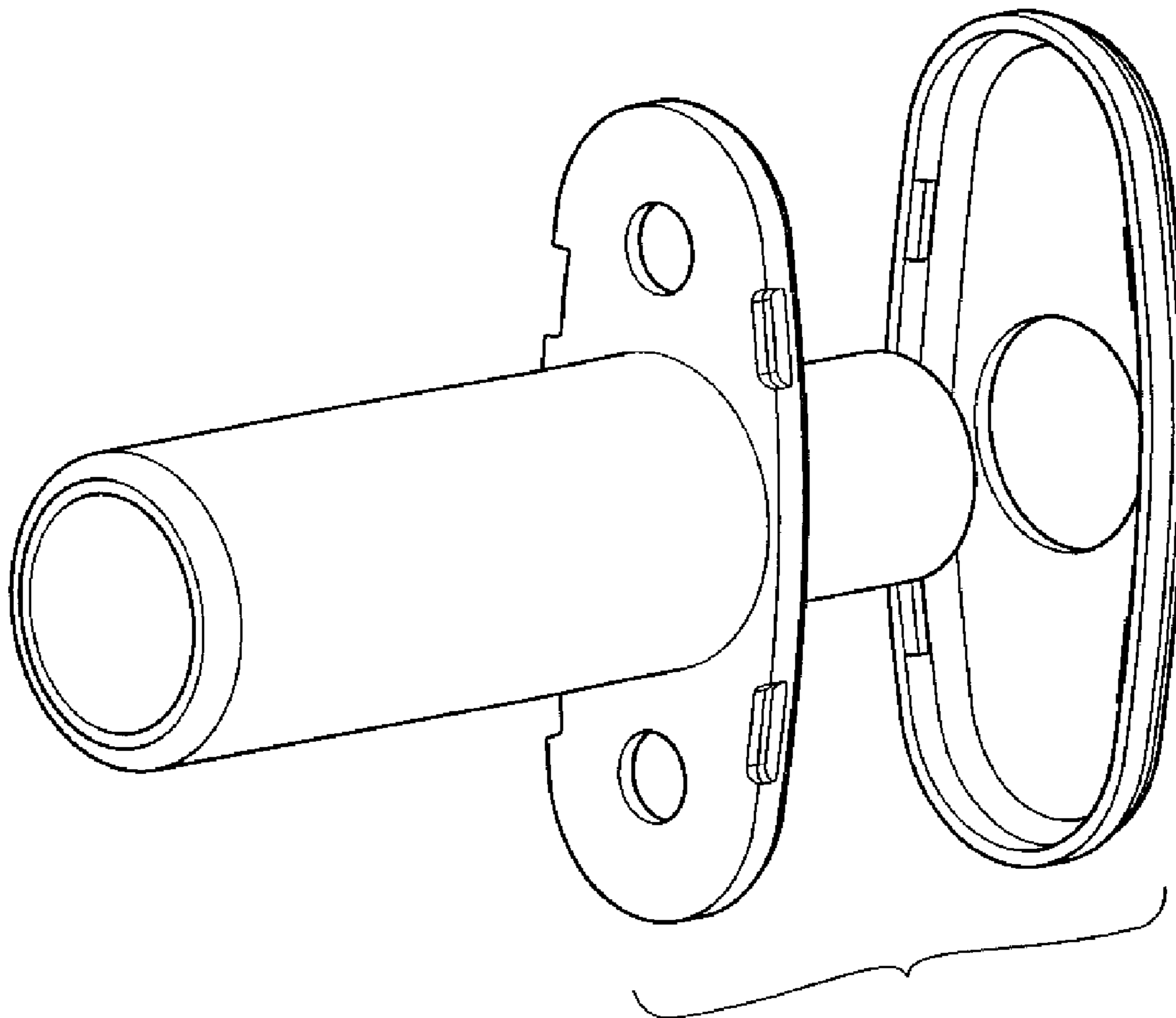

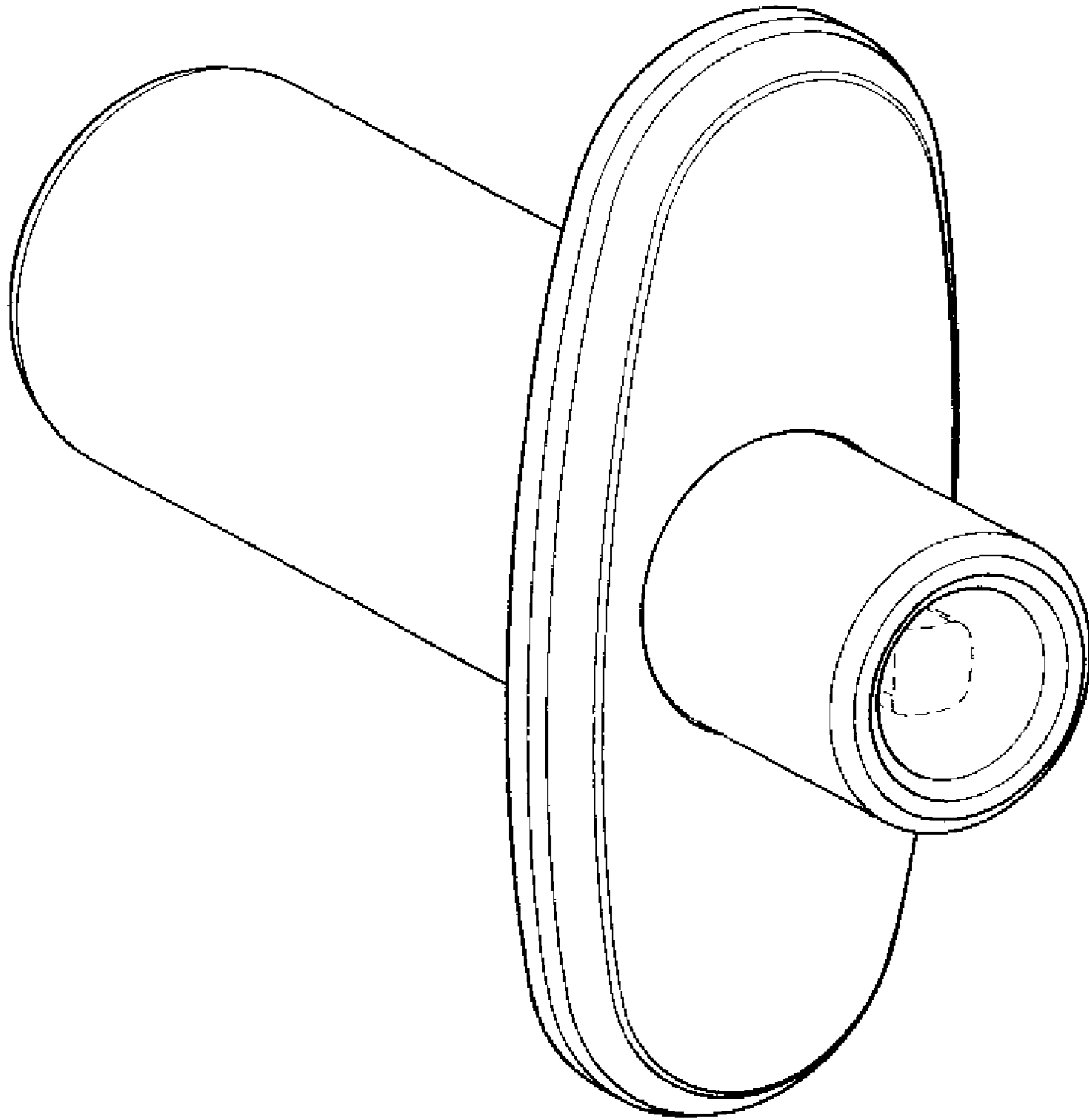

Figure 1

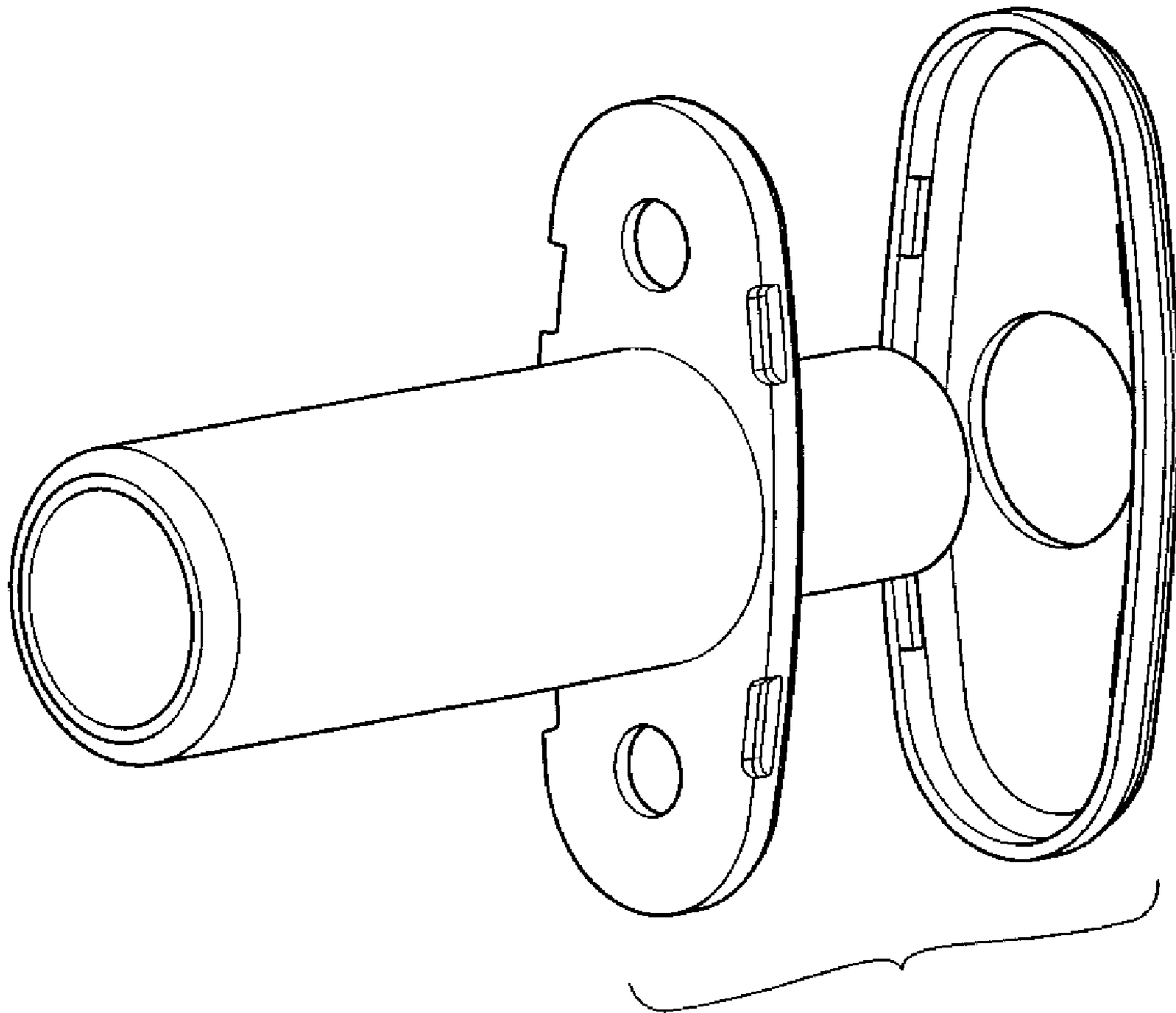

Figure 2

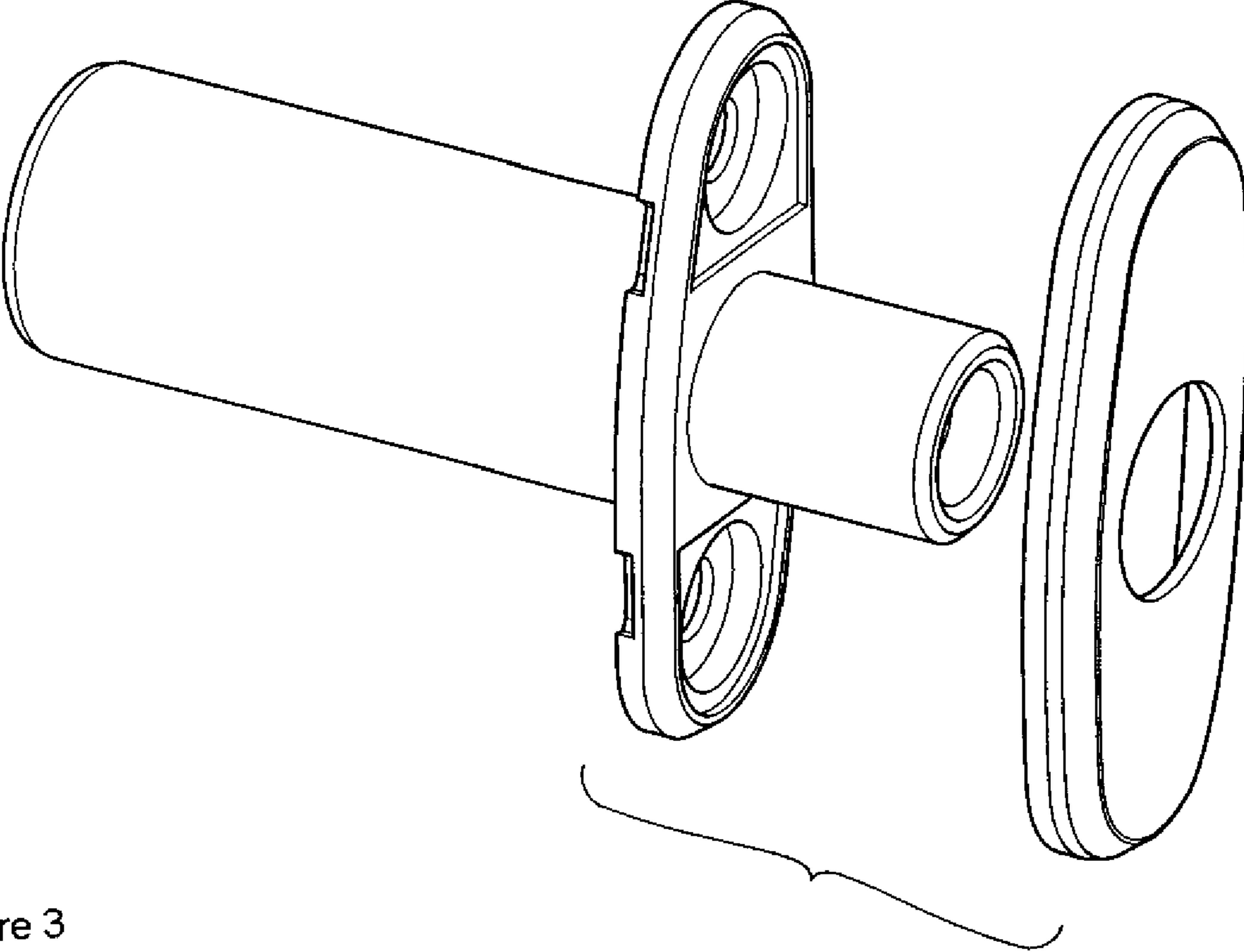

Figure 3

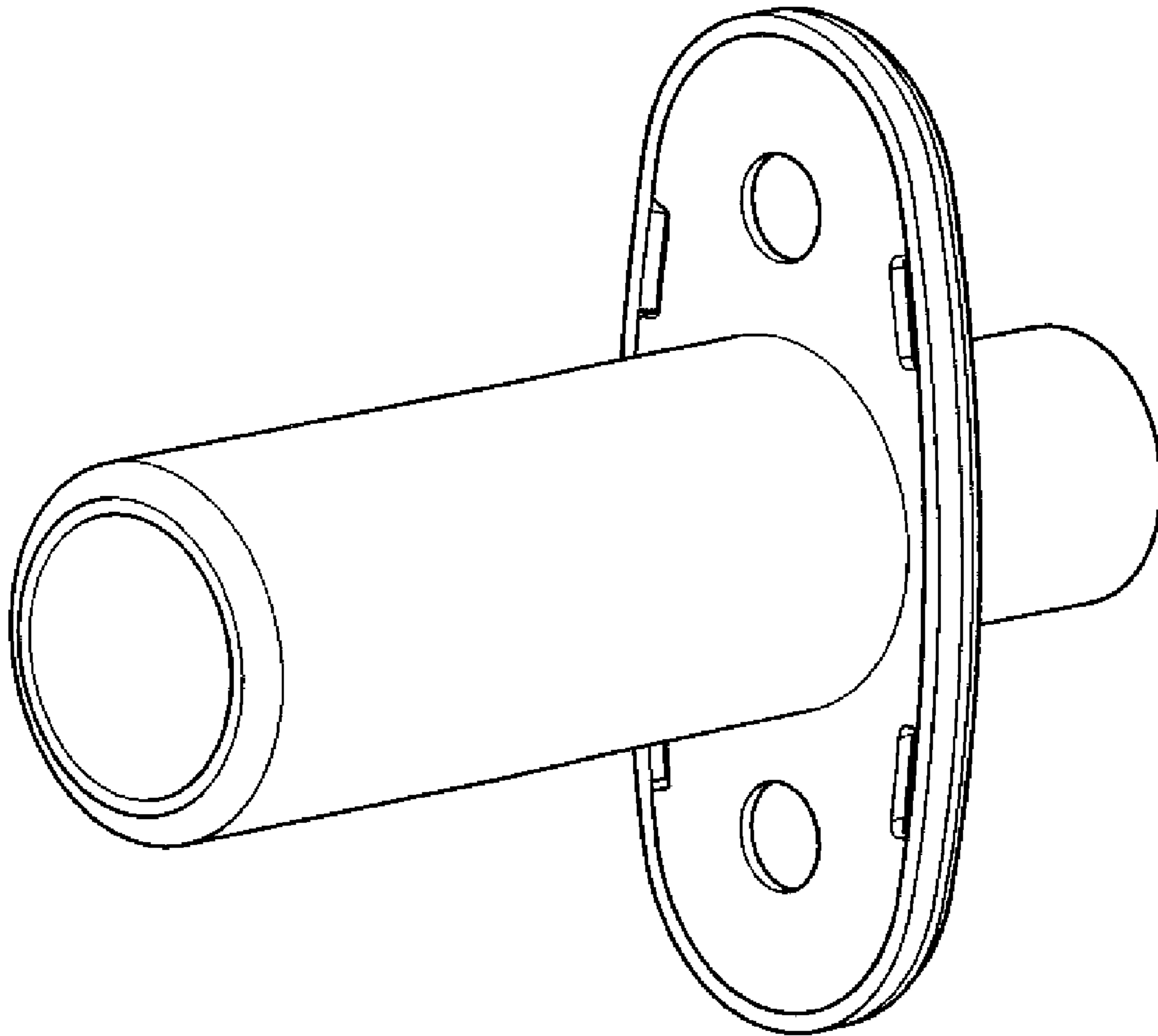

Figure 4