



US00D581055S

(12) **United States Design Patent**
Mateyka

(10) **Patent No.:** **US D581,055 S**
(45) **Date of Patent:** **** Nov. 18, 2008**

(54) **DYNAMIC SPINAL PLATE IMPLANT**

(76) Inventor: **Richard M. Mateyka**, 10116 Oakmoor Pl., Las Vegas, NV (US) 89144

(**) Term: **14 Years**

(21) Appl. No.: **29/281,313**

(22) Filed: **Jun. 20, 2007**

(51) **LOC (8) Cl.** **24-03**

(52) **U.S. Cl.** **D24/155**

(58) **Field of Classification Search** D24/155,
D24/156, 157; 623/17.11, 16.71; D8/391-393,
D8/382, 354; 606/246, 247, 248, 249, 258,
606/267, 280, 70, 71, 283, 299, 166, 903,
606/905, 906, 286, 396, 296
See application file for complete search history.

(56) **References Cited**

U.S. PATENT DOCUMENTS

4,312,336	A	1/1982	Danieletto et al.	
5,246,458	A	9/1993	Graham	
RE34,985	E	6/1995	Pennig	
5,681,313	A *	10/1997	Diez	606/70
D402,032	S *	12/1998	Stone	D24/155
5,961,519	A *	10/1999	Bruce et al.	606/280
6,306,136	B1	10/2001	Bacelli	
6,471,706	B1 *	10/2002	Schumacher et al.	606/70
6,652,525	B1 *	11/2003	Assaker et al.	606/296
D505,205	S *	5/2005	Freid	D24/155
6,916,320	B2 *	7/2005	Michelson	606/280
7,186,256	B2 *	3/2007	Michelson	606/71
7,306,605	B2 *	12/2007	Ross	606/70
7,318,825	B2 *	1/2008	Butler et al.	606/71
2003/0225409	A1	12/2003	Fried et al.	
2004/0092939	A1	5/2004	Fried et al.	

2004/0102778	A1	5/2004	Huebner et al.
2004/0133199	A1	7/2004	Coati et al.
2004/0158250	A1	8/2004	Chappuis
2004/0204712	A1	10/2004	Kolb et al.
2004/0204713	A1	10/2004	Abdou
2005/0049595	A1	3/2005	Suh et al.
2005/0149026	A1	7/2005	Butler et al.
2005/0187552	A1	8/2005	Michaelson
2005/0240184	A1	10/2005	Osman

* cited by examiner

Primary Examiner—Charles A Rademaker

(74) *Attorney, Agent, or Firm*—Stephen C. Beuerle; Procopio Cory Hargreaves & Savitch LLP

(57) **CLAIM**

The ornamental design for a dynamic spinal plate implant, as shown and described.

DESCRIPTION

FIG. 1 is a front perspective view of a dynamic spinal plate implant showing my new design;

FIG. 2 is left side perspective view thereof;

FIG. 3 is a right side perspective view thereof;

FIG. 4 is a top plan view thereof;

FIG. 5 is a front elevational view thereof;

FIG. 6 is a bottom plan view thereof;

FIG. 7 is a rear elevational view thereof;

FIG. 8 is a cross-sectional view thereof taken along line 8—8 in FIG. 5 shown in fragment and on an enlarged scale; and,

FIG. 9 is a cross-sectional view thereof taken along line 9—9 in FIG. 6 shown in fragment and on an enlarged scale.

1 Claim, 2 Drawing Sheets

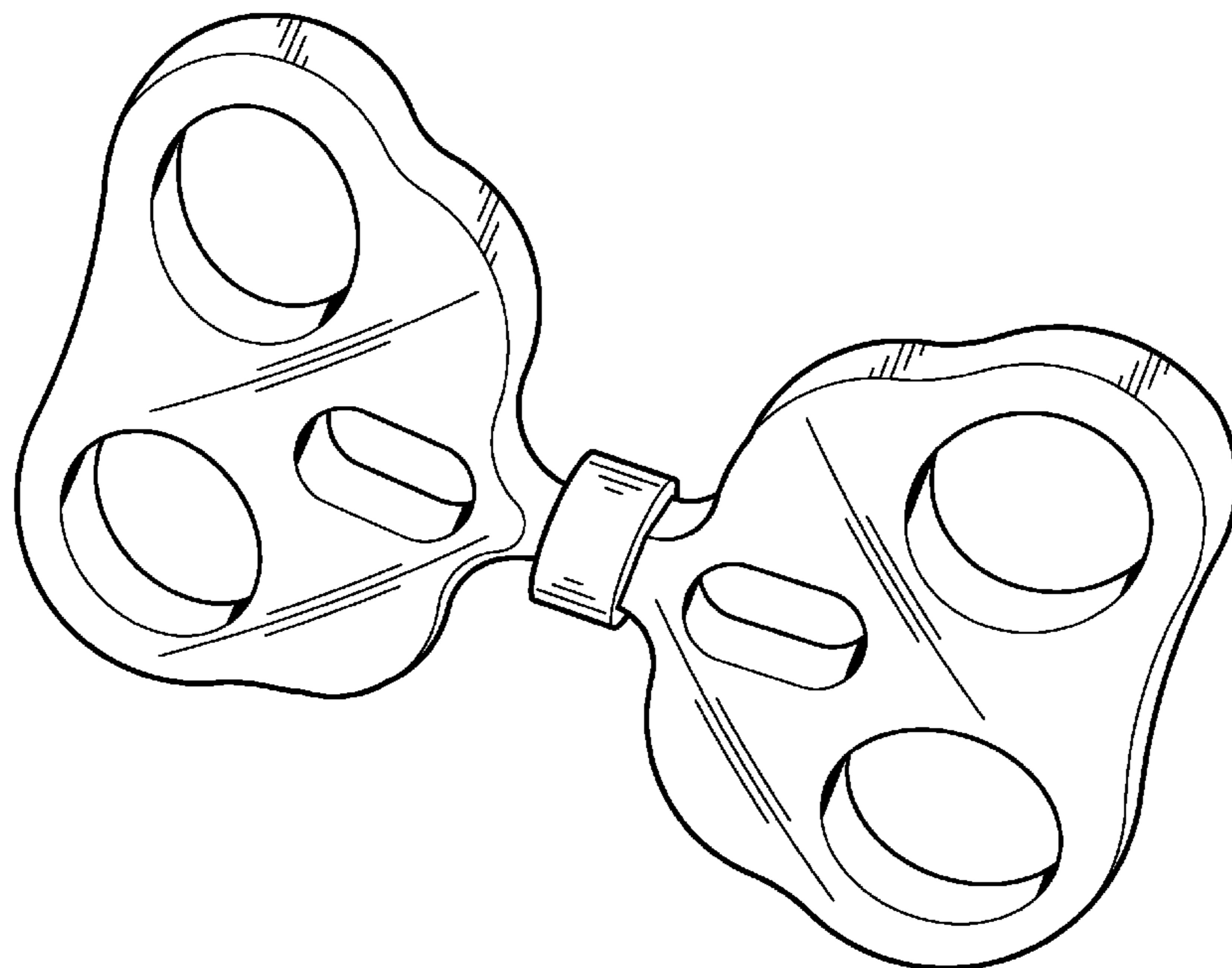

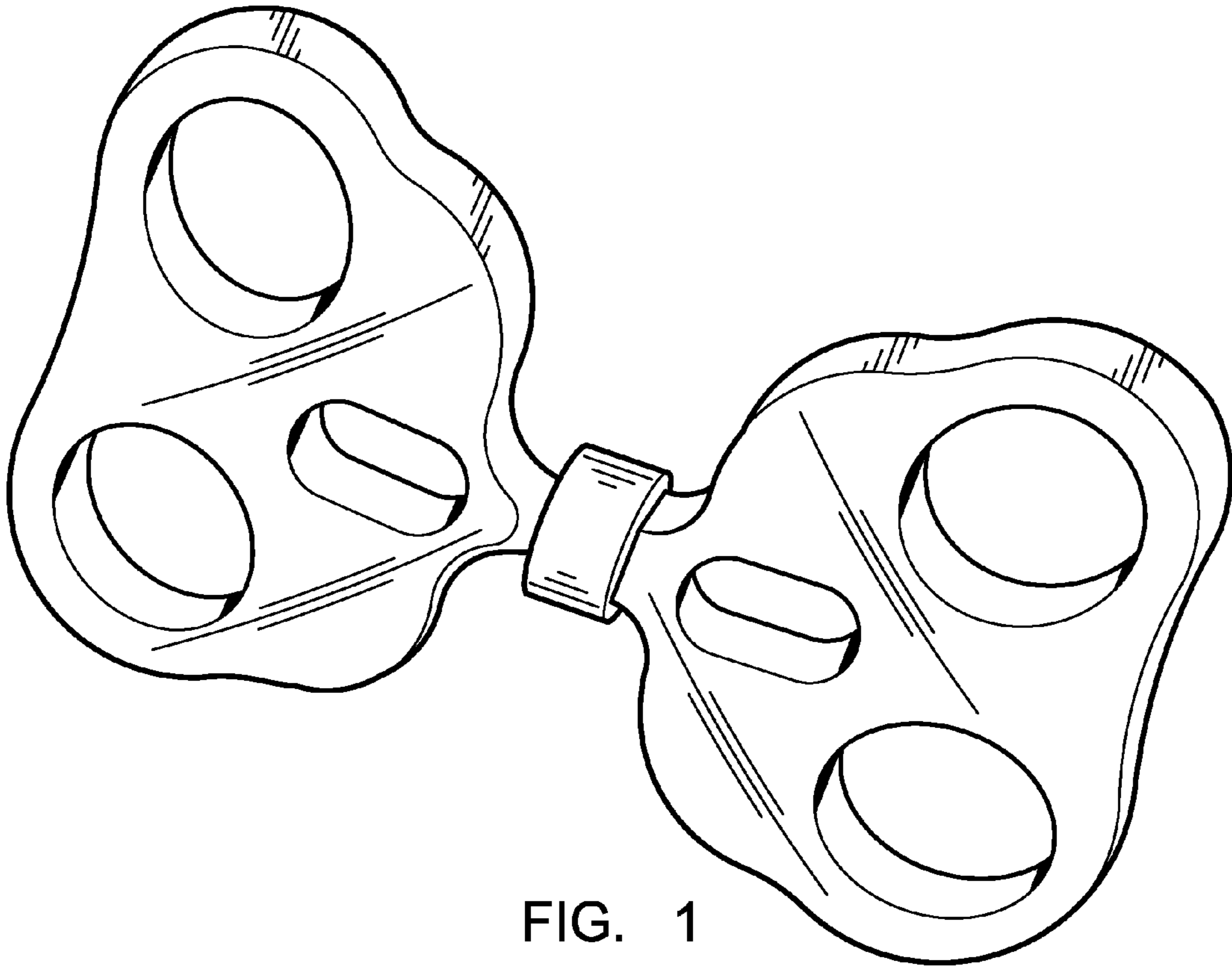

FIG. 1

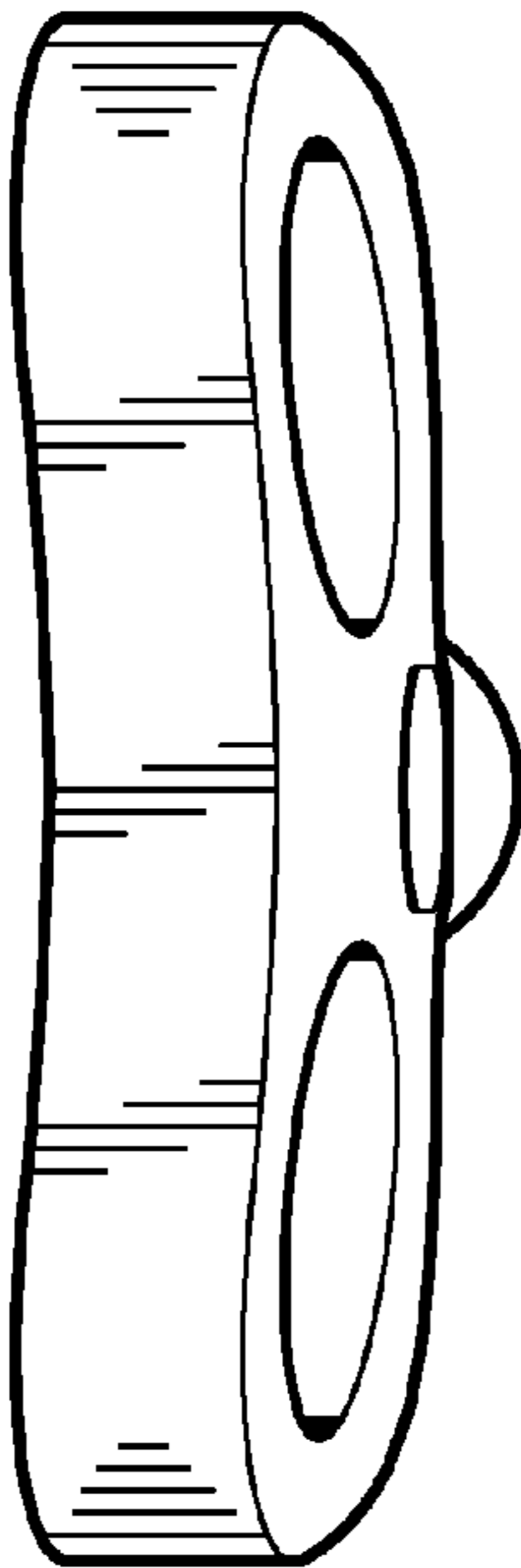

FIG. 2

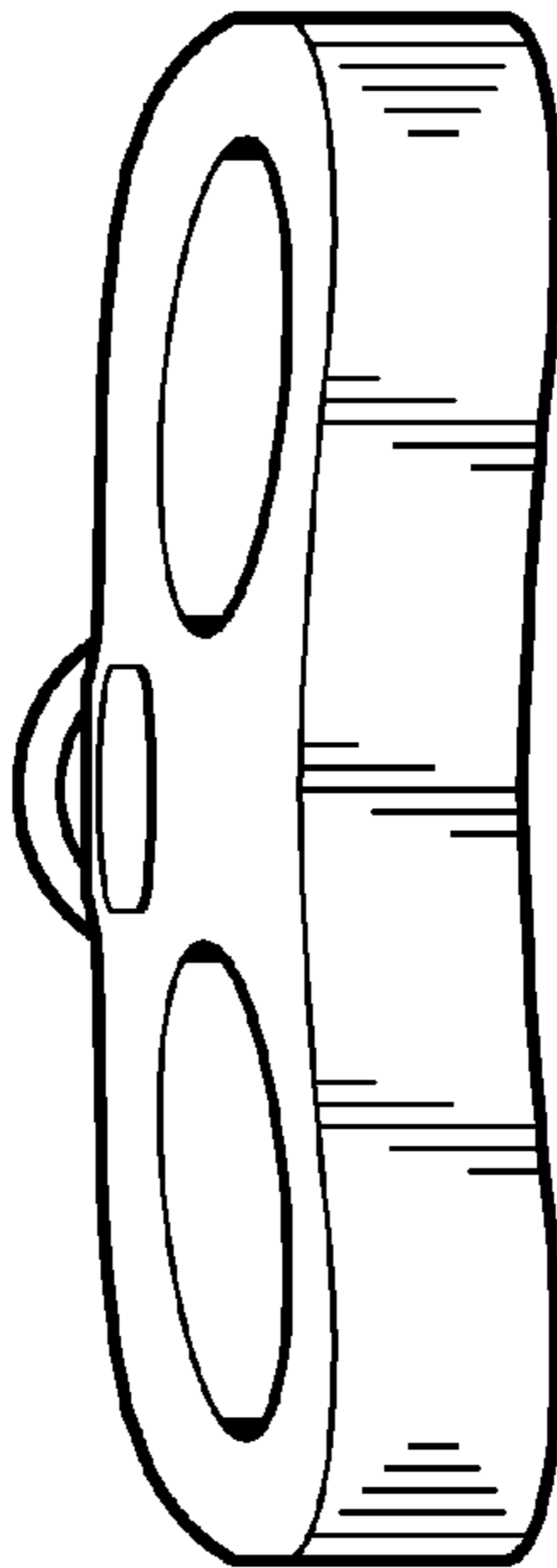

FIG. 3

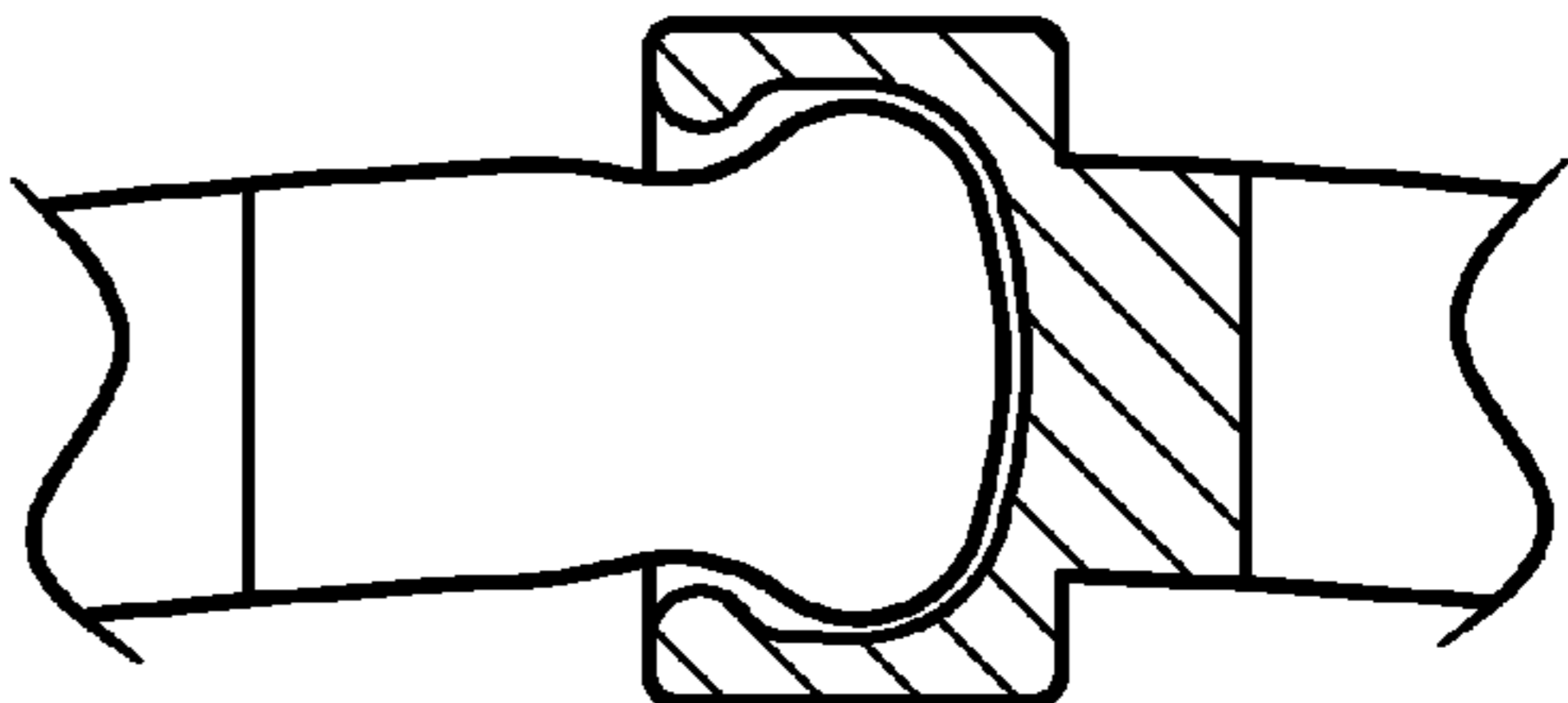

FIG. 8

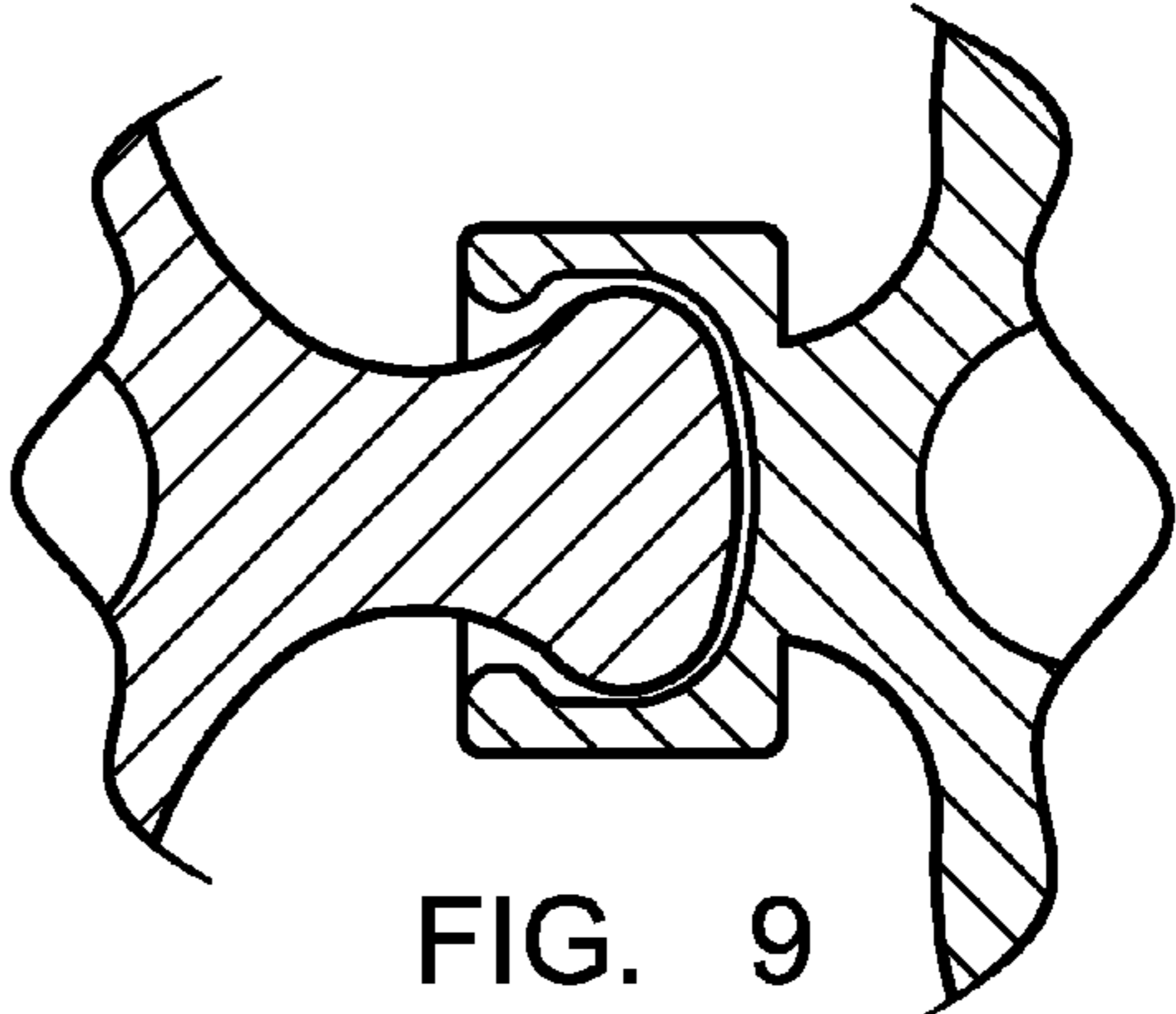

FIG. 9

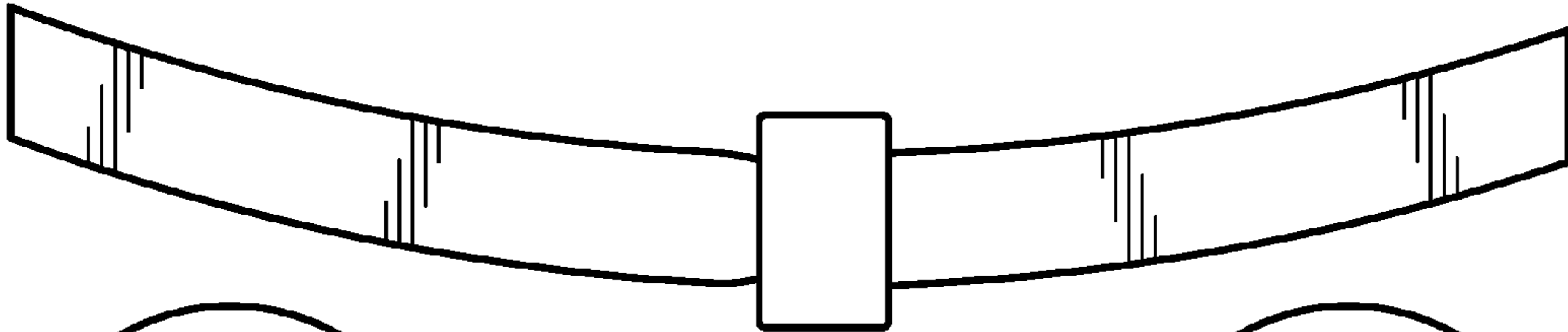

FIG. 4

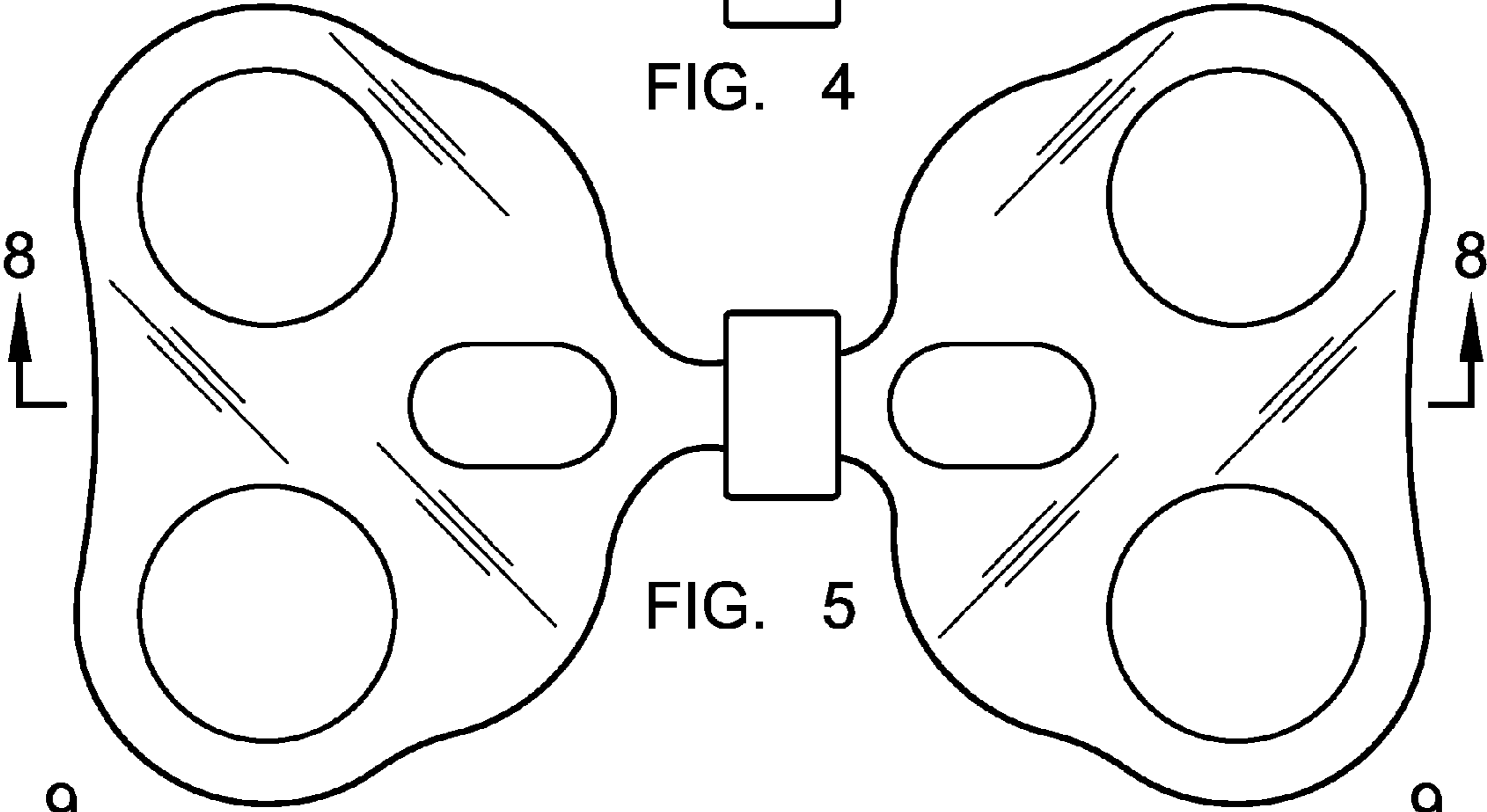

FIG. 5

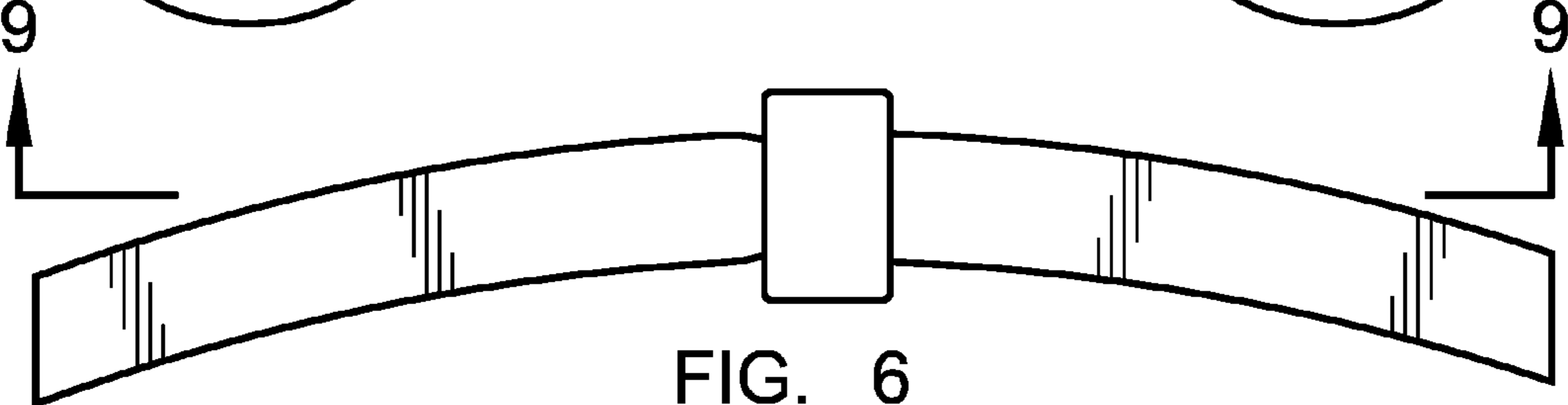

FIG. 6

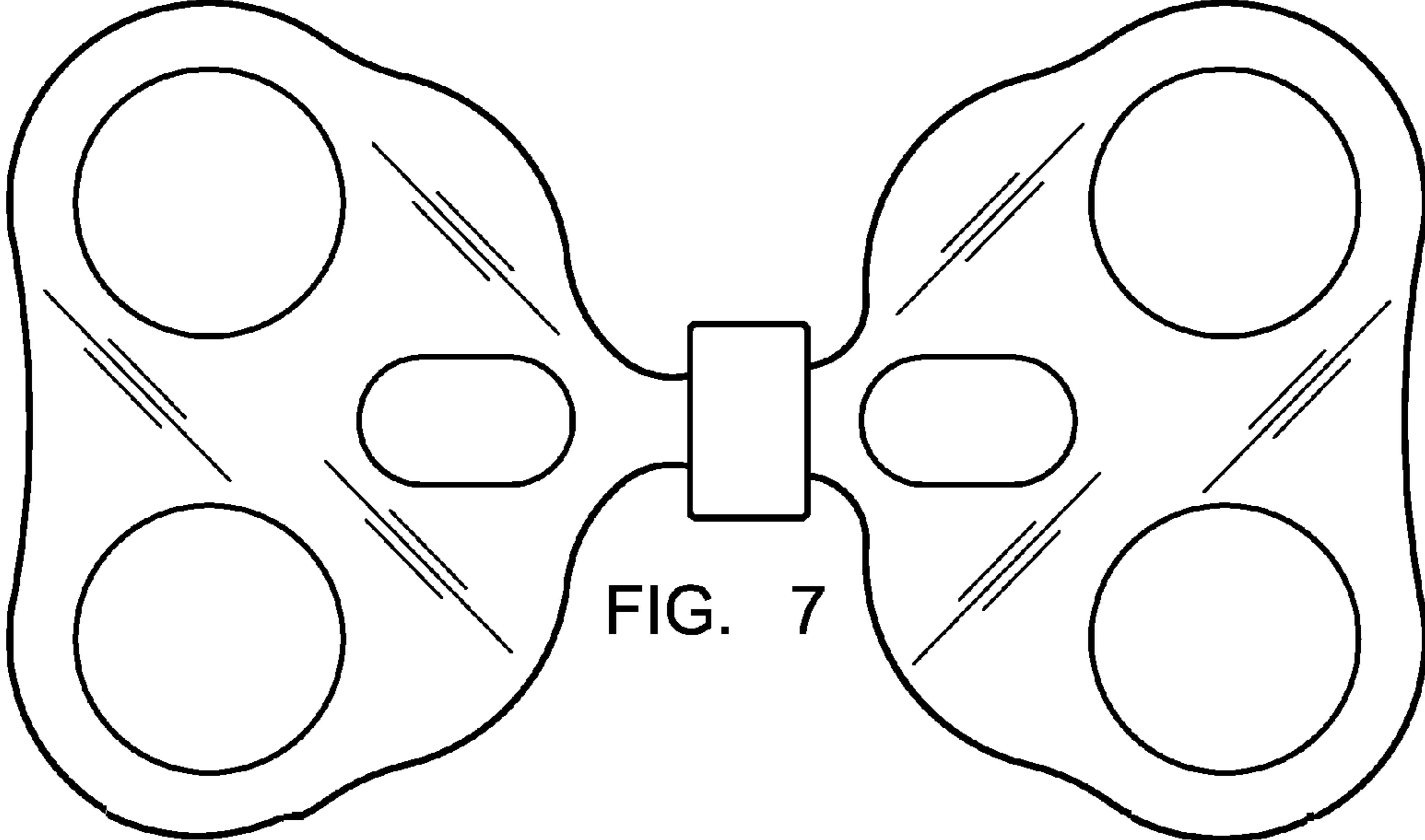

FIG. 7