

US00D578537S

(12) **United States Design Patent**
Tsukahara

(10) **Patent No.:** **US D578,537 S**
(45) **Date of Patent:** **** Oct. 14, 2008**

(54) **PERSONAL COMPUTER**

(75) Inventor: **Takashi Tsukahara**, Kadoma (JP)

(73) Assignee: **Matsushita Electric Industrial Co., Ltd.**, Osaka (JP)

(**) Term: **14 Years**

(21) Appl. No.: **29/288,233**

(22) Filed: **Jun. 5, 2007**

(30) **Foreign Application Priority Data**

Dec. 25, 2006 (JP) 2006-035494

(51) **LOC (8) Cl.** **14-02**

(52) **U.S. Cl.** **D14/439**

(58) **Field of Classification Search** D14/315–327,
D14/384, 432, 439–446, 341, 345, 353–355,
D14/125, 130, 132, 138, 239; D16/202,
D16/208; 235/145 A, 145 R; 341/22, 23;
349/12; 361/680–686; D9/424–432; D6/491;
D8/403

See application file for complete search history.

(56) **References Cited**

U.S. PATENT DOCUMENTS

- D221,958 S * 9/1971 Finebaum D8/403
- D246,625 S * 12/1977 Becker, III D8/403
- D301,953 S * 7/1989 Evenson D6/491
- D324,172 S * 2/1992 Mederer D9/426
- D339,112 S 9/1993 Foy et al.
- D345,347 S 3/1994 Yamazaki
- D380,740 S 7/1997 Mieki et al.
- D430,156 S * 8/2000 Yamada D14/328
- 6,108,196 A * 8/2000 Jung 361/683
- D442,182 S * 5/2001 Oross D14/439
- D456,398 S * 4/2002 Horiki D14/328
- 6,535,380 B1 * 3/2003 Lee et al. 361/683

- D483,664 S * 12/2003 Cadiente D9/432
- D546,632 S * 7/2007 Oberloier D9/432
- D557,432 S * 12/2007 Smith D8/403
- D558,754 S * 1/2008 Takemasa et al. D14/328

FOREIGN PATENT DOCUMENTS

JP D 1024046 10/1998

OTHER PUBLICATIONS

U.S. Appl. No. 29/288,231, filed Jun. 5, 2007, Tsukahara.

* cited by examiner

Primary Examiner—Cathron Brooks

Assistant Examiner—Deanna Fluegeman

(74) *Attorney, Agent, or Firm*—Brinks Hofer Gilson & Lione

(57) **CLAIM**

I claim the ornamental design for a personal computer, as shown and described.

DESCRIPTION

FIG. 1 is a top perspective view of a personal computer of the present invention;

FIG. 2 is a front view thereof;

FIG. 3 is a top view thereof;

FIG. 4 is a rear view thereof;

FIG. 5 is a first side view thereof;

FIG. 6 is a second side view thereof;

FIG. 7 is a bottom view thereof; and,

FIG. 8 is a top perspective view thereof shown in a closed position.

The broken line showing of portions of the personal computer is included for the purpose of illustrating environment and forms no part of the claimed design.

1 Claim, 8 Drawing Sheets

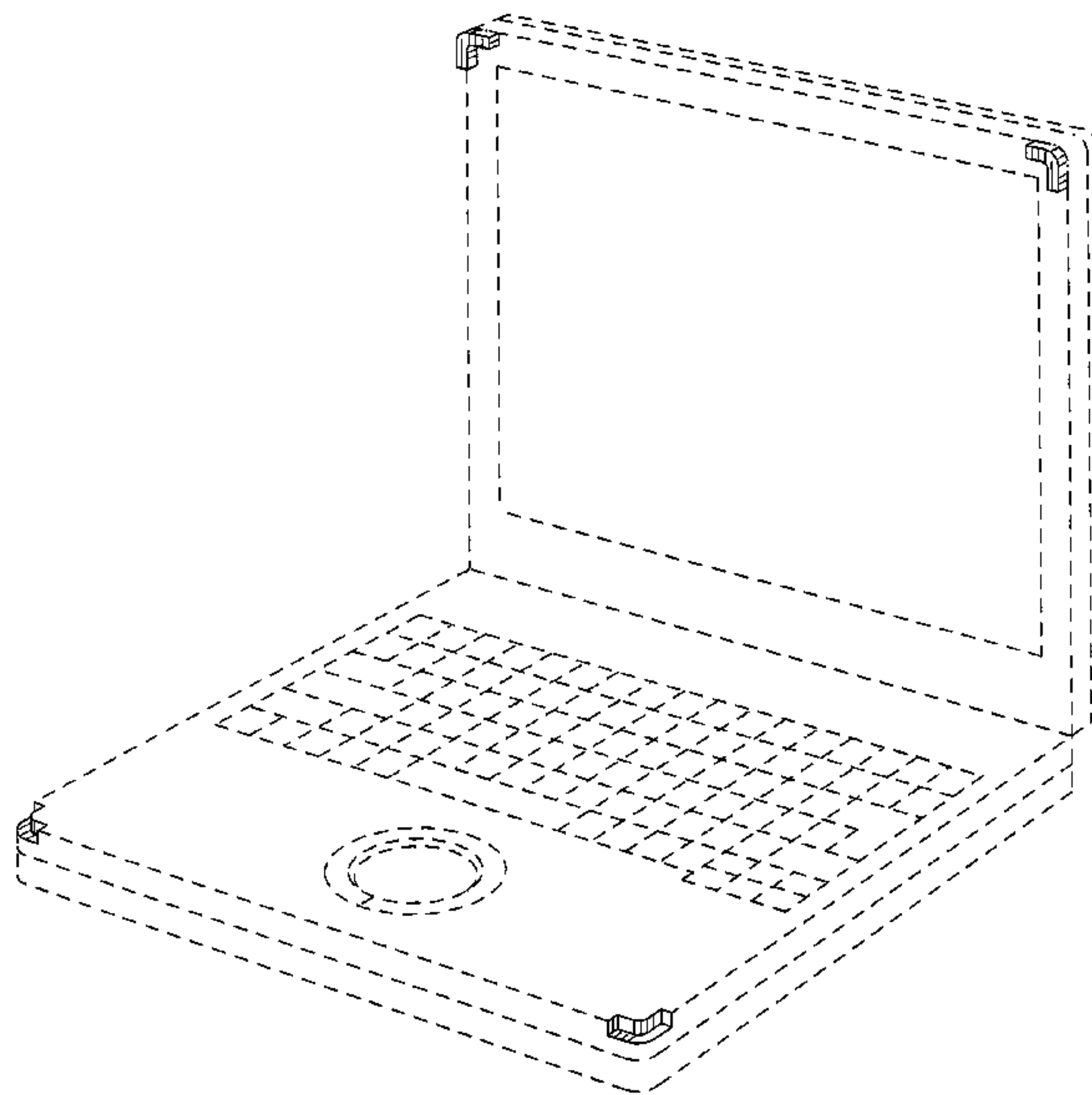

FIG.1

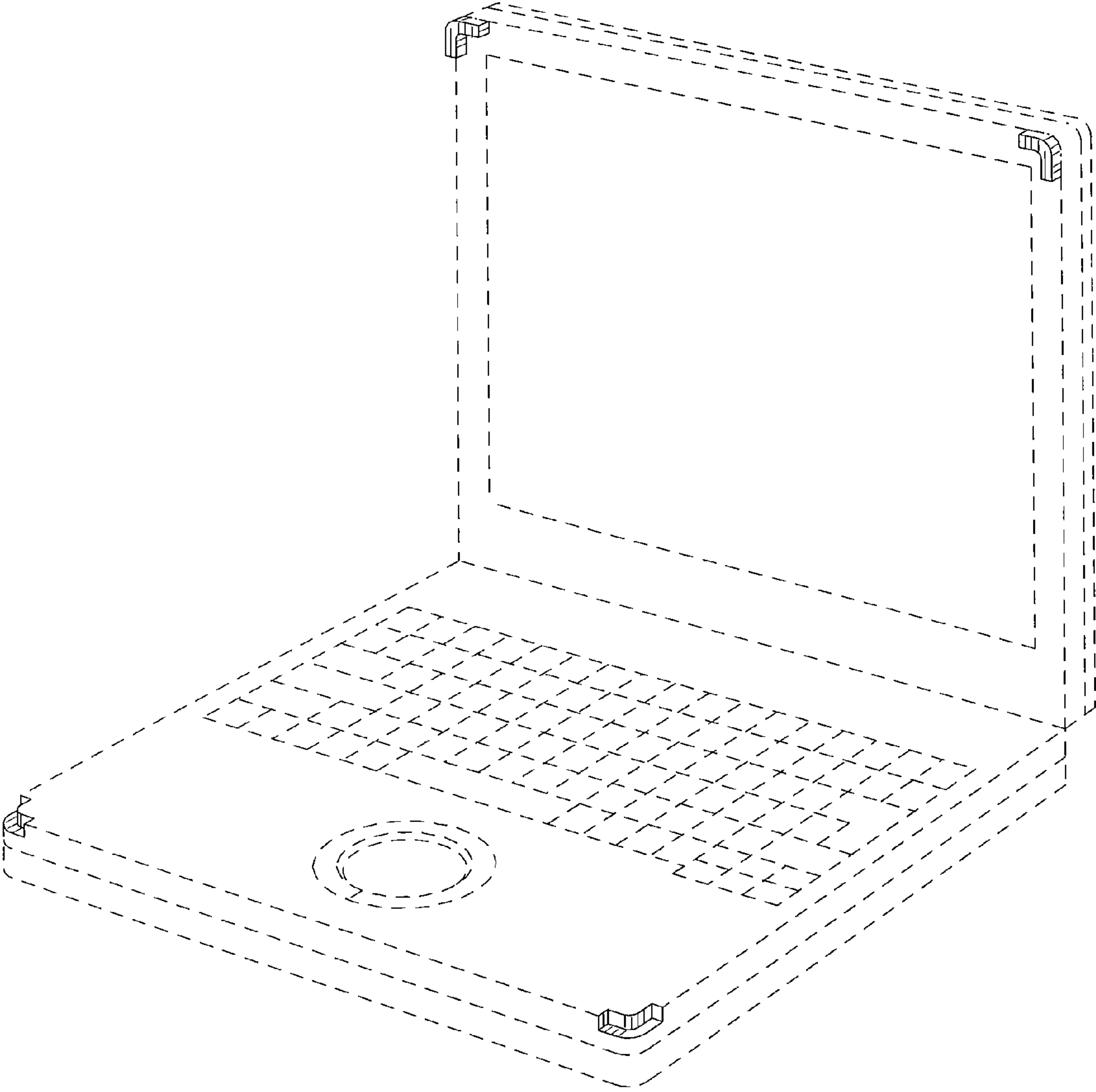

FIG.2

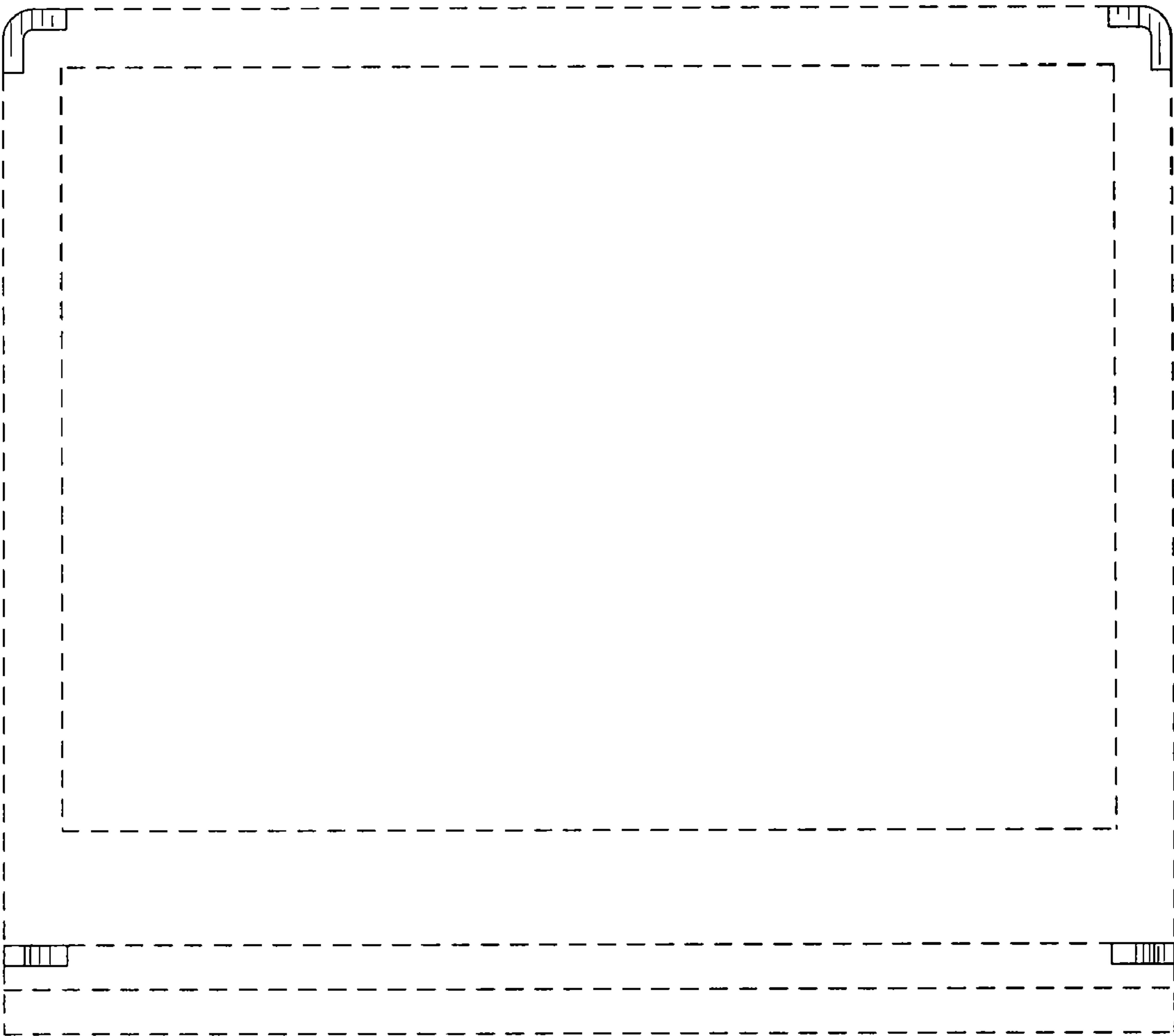

FIG.3

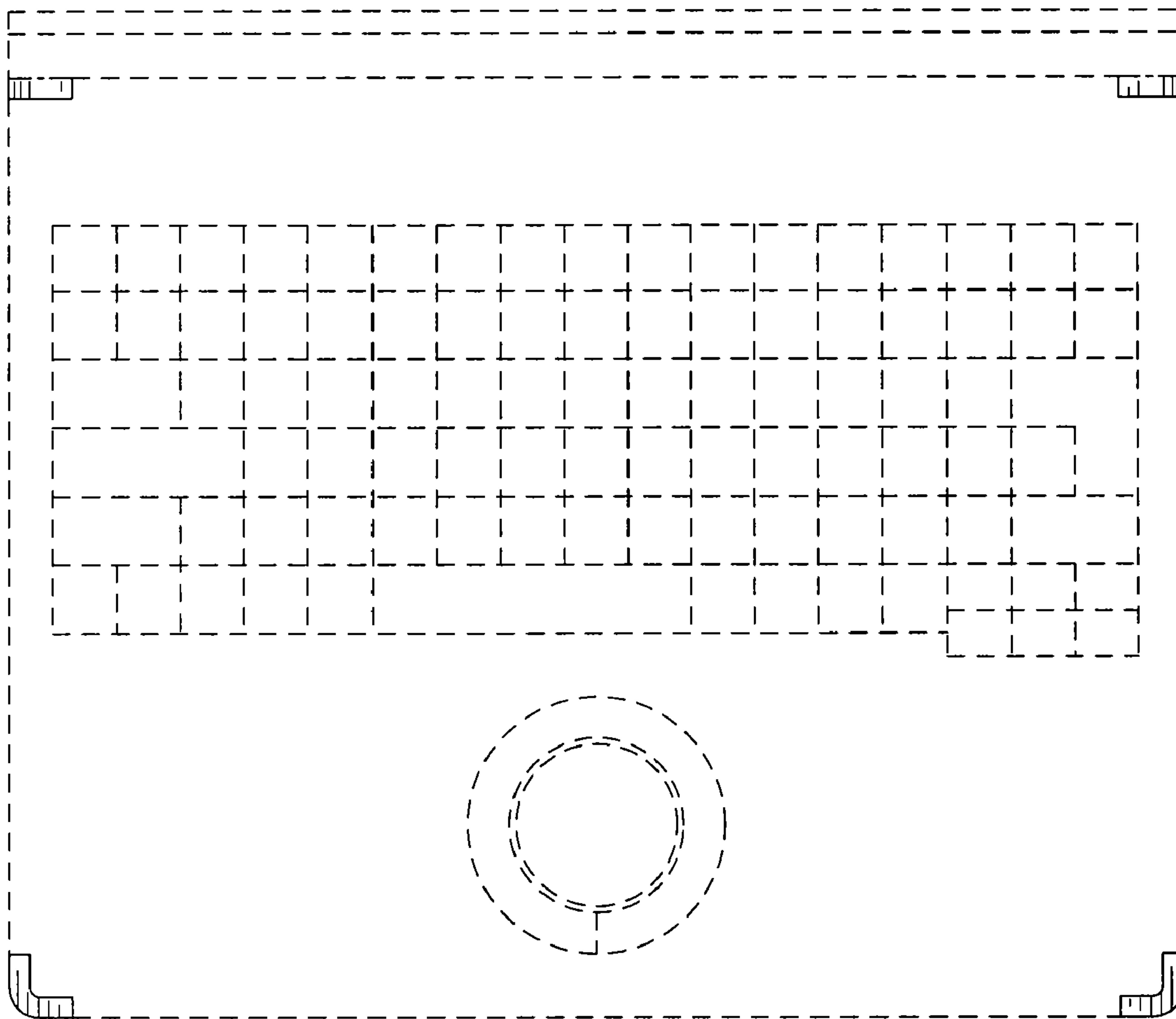

FIG.4

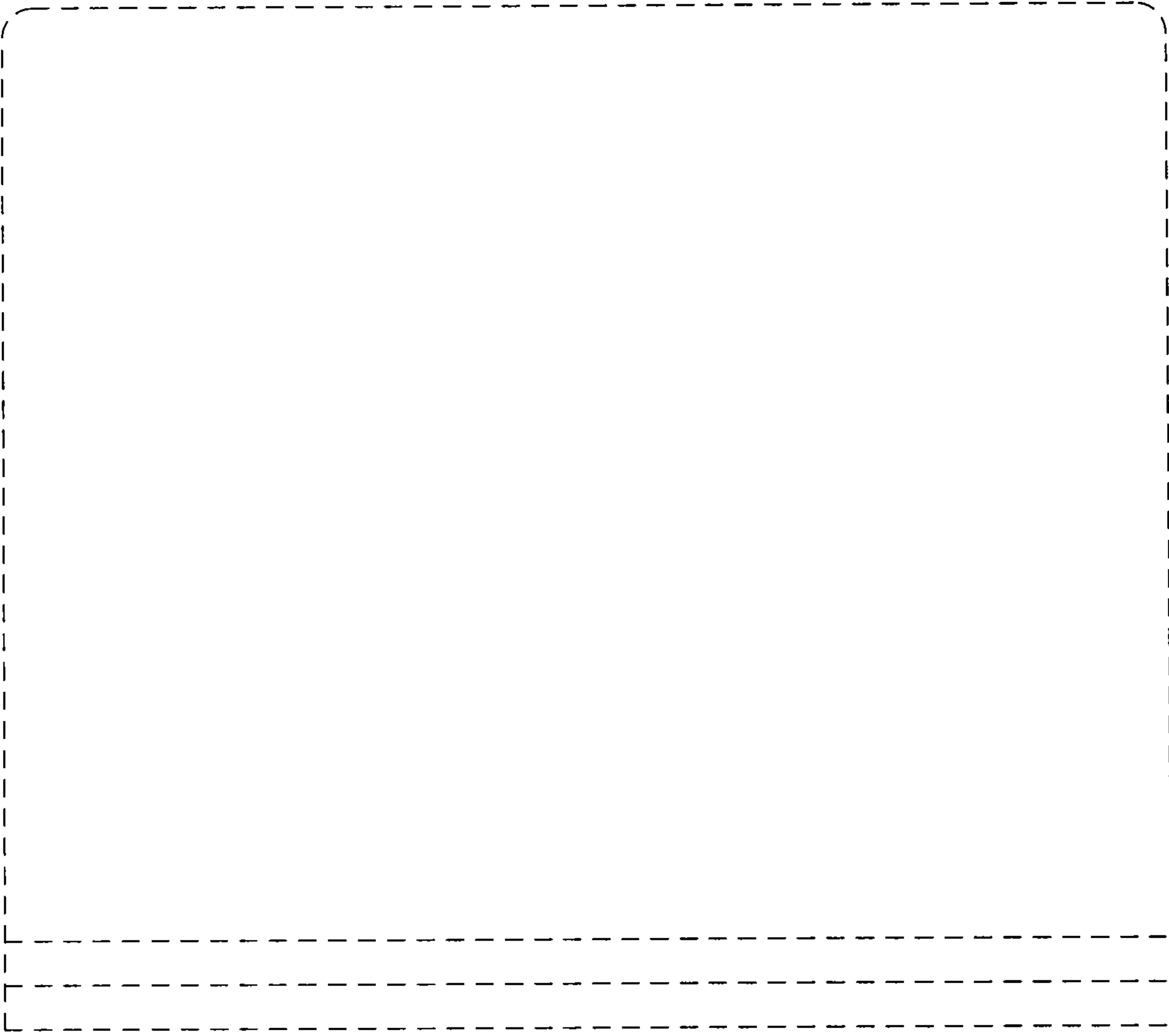

FIG. 5

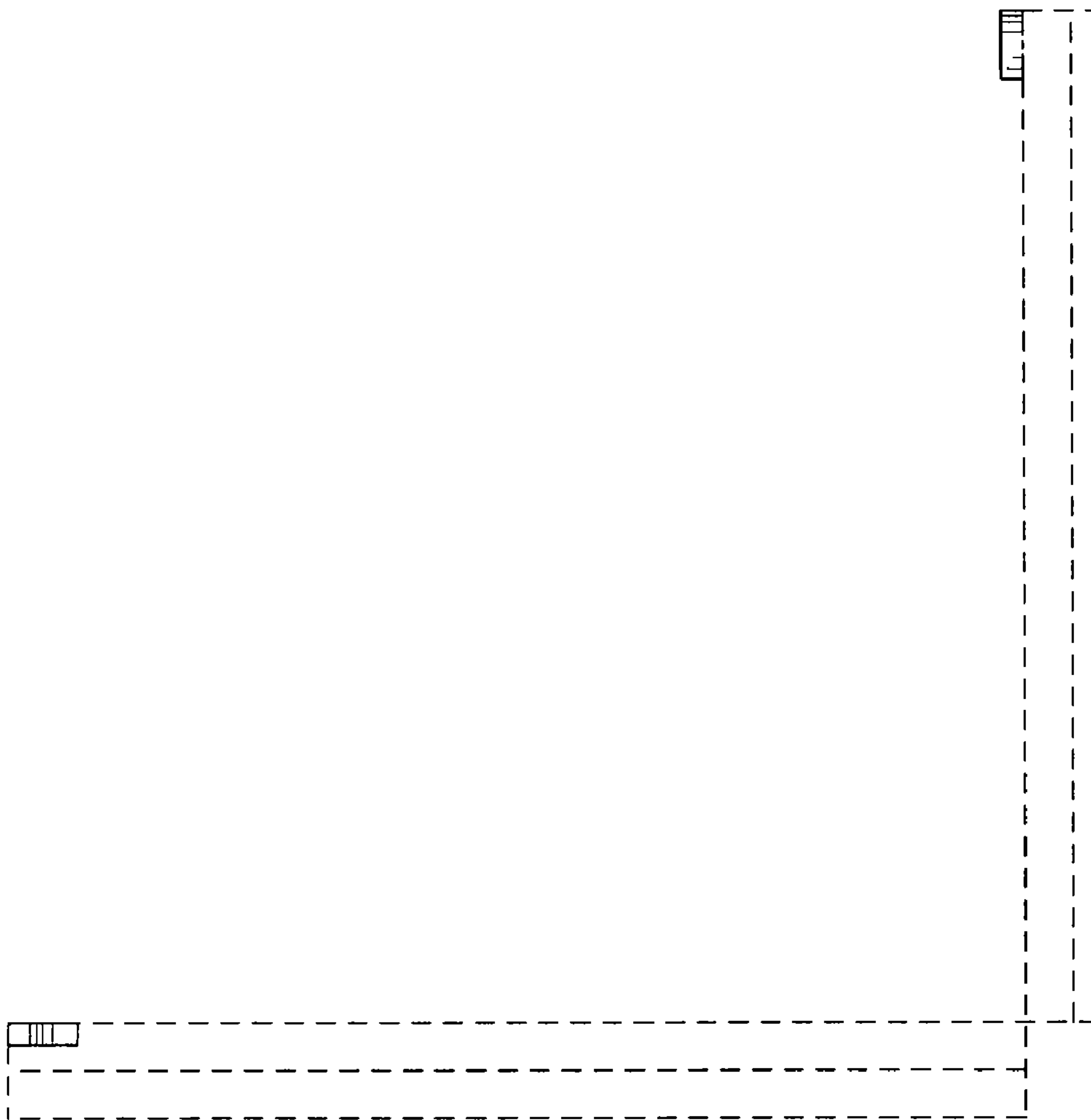

FIG.6

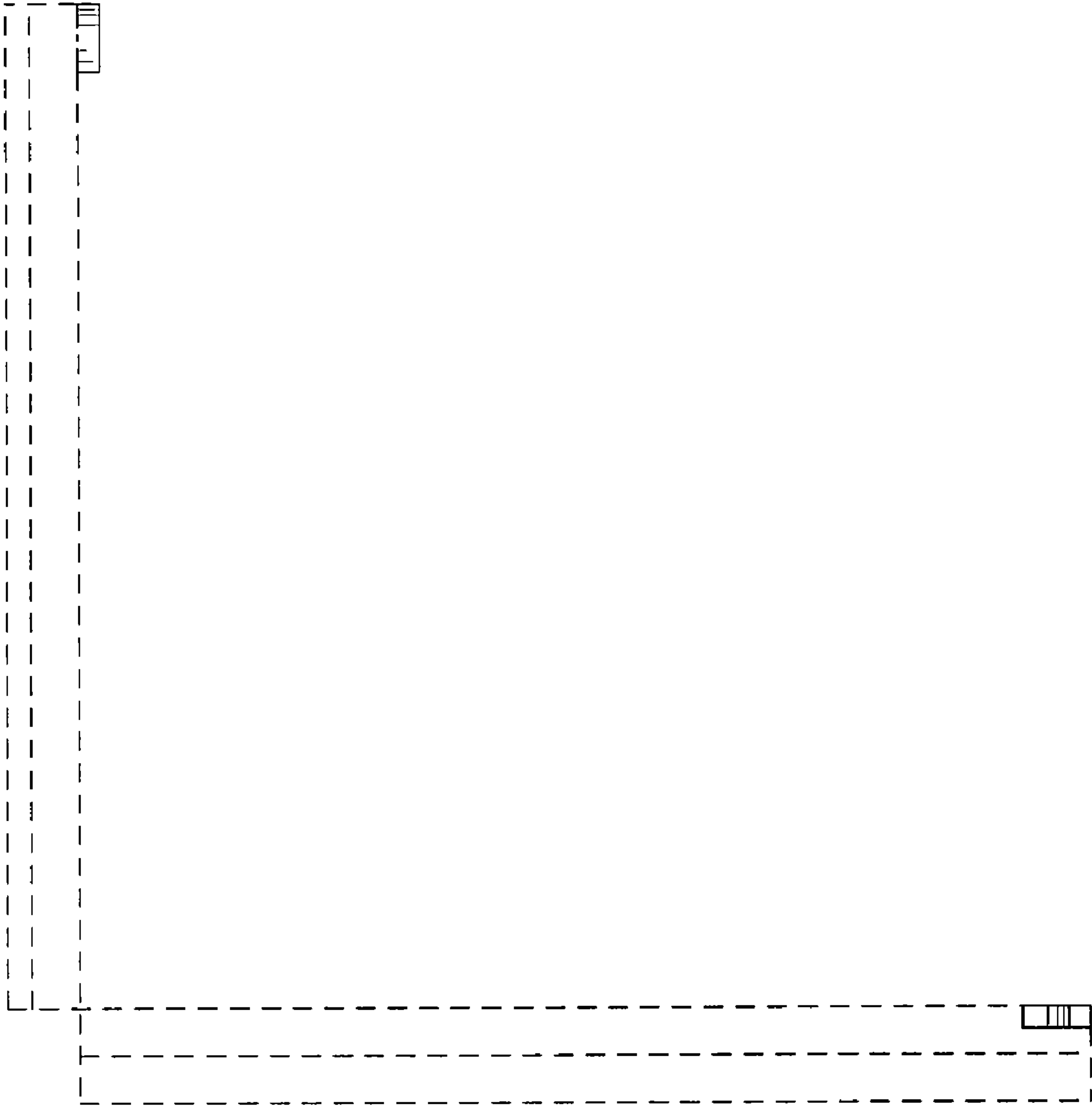

FIG. 7

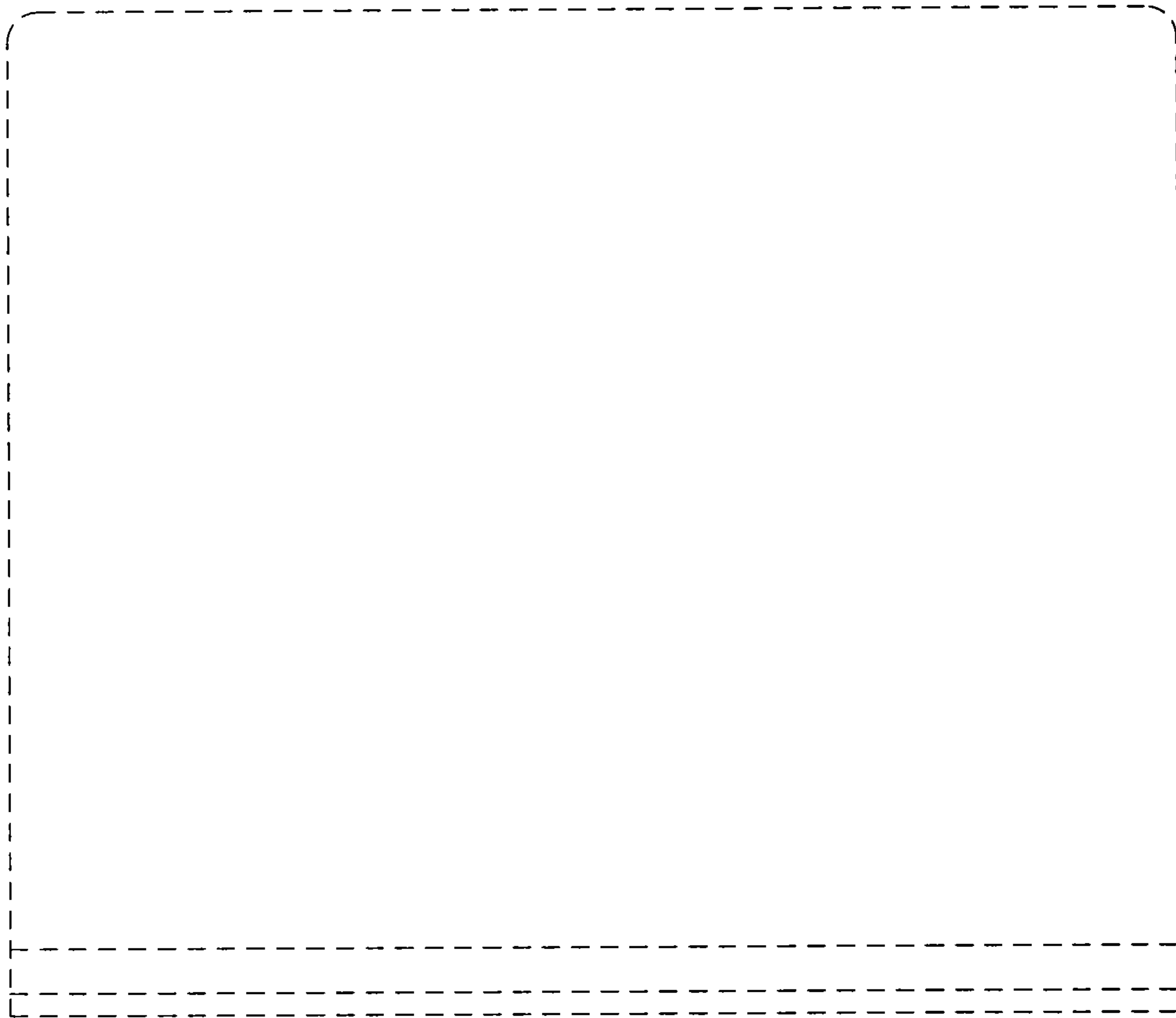

FIG.8

