



US00D577450S

(12) **United States Design Patent**  
**Shiu**

(10) **Patent No.:** **US D577,450 S**

(45) **Date of Patent:** **\*\* Sep. 23, 2008**

(54) **FLASHLIGHT**

(75) **Inventor:** **Stephanie Wai Man Shiu**, Kowloon  
(HK)

(73) **Assignee:** **Gold Coral International Limited**, San  
Po Kong, Kowloon (HK)

(\*\*) **Term:** **14 Years**

(21) **Appl. No.:** **29/304,206**

(22) **Filed:** **Feb. 27, 2008**

(30) **Foreign Application Priority Data**

Sep. 11, 2007 (HK) ..... 0702262

(51) **LOC (8) Cl.** ..... **26-02**

(52) **U.S. Cl.** ..... **D26/49**

(58) **Field of Classification Search** ..... D26/37-50;  
362/157, 158, 171-174, 183-208  
See application file for complete search history.

(56) **References Cited**

**U.S. PATENT DOCUMENTS**

D434,164 S \* 11/2000 Galli ..... D26/49

D455,510 S \* 4/2002 Galli ..... D26/37  
D455,513 S \* 4/2002 Galli ..... D26/49  
D501,054 S \* 1/2005 Galli ..... D26/37  
D522,154 S \* 5/2006 Man ..... D26/49  
D523,163 S \* 6/2006 Man ..... D26/49

\* cited by examiner

*Primary Examiner*—Marcus A Jackson

(74) *Attorney, Agent, or Firm*—Joseph G. Swan, PC

(57) **CLAIM**

The ornamental design for a flashlight, as shown and described.

**DESCRIPTION**

FIG. 1 is a top plan view of a flashlight according to the present invention.

FIG. 2 is a right side elevational view of the flashlight.

FIG. 3 is a rear elevational view of the flashlight.

FIG. 4 is a front elevational view of the flashlight.

FIG. 5 is a bottom plan view of the flashlight; and,

FIG. 6 is a left side elevational view of the flashlight.

**1 Claim, 2 Drawing Sheets**

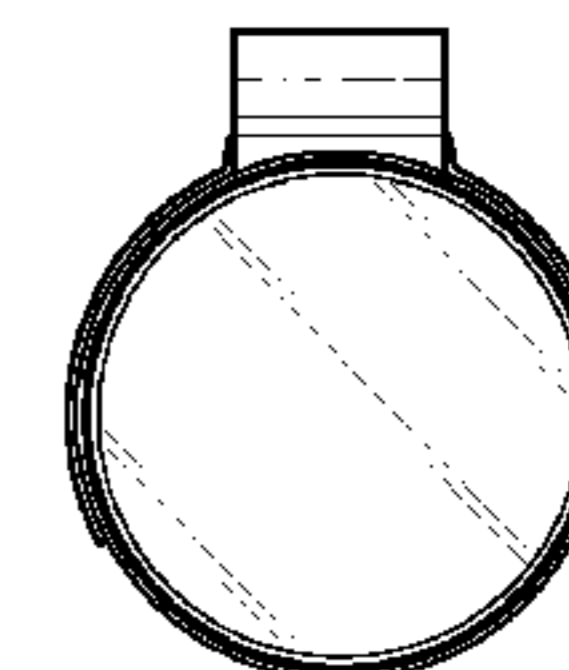
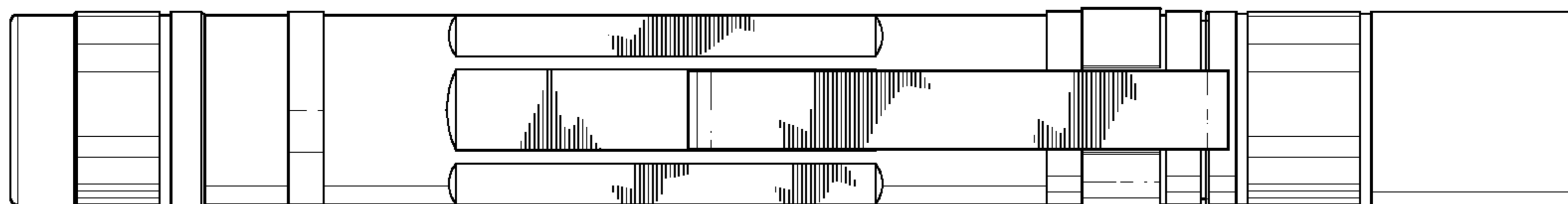

FIG. 1

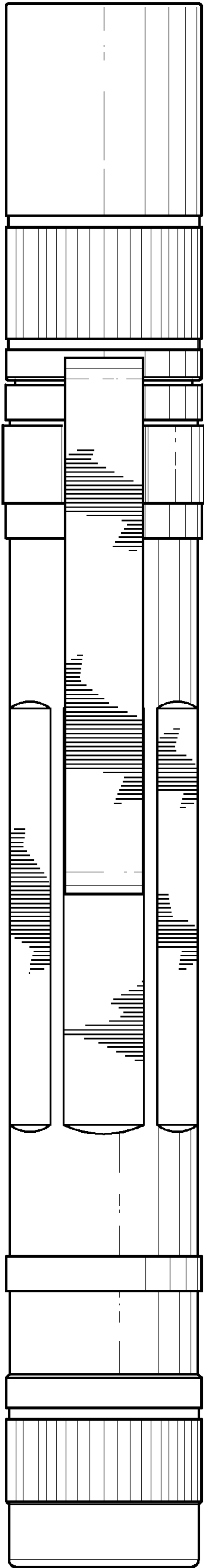

FIG. 2

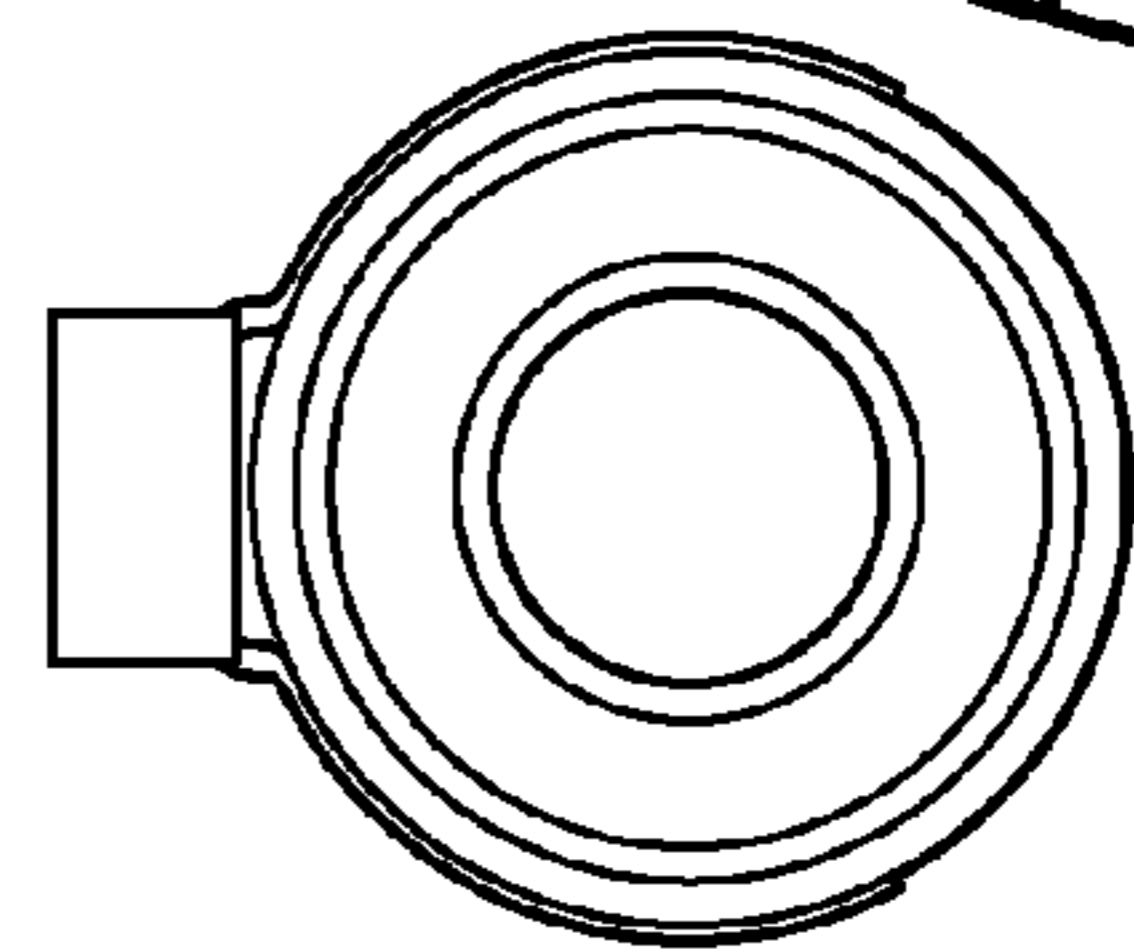
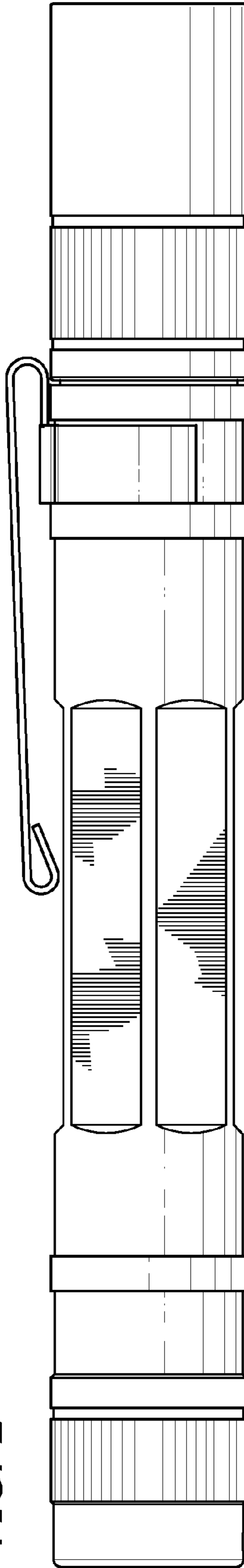

FIG. 3

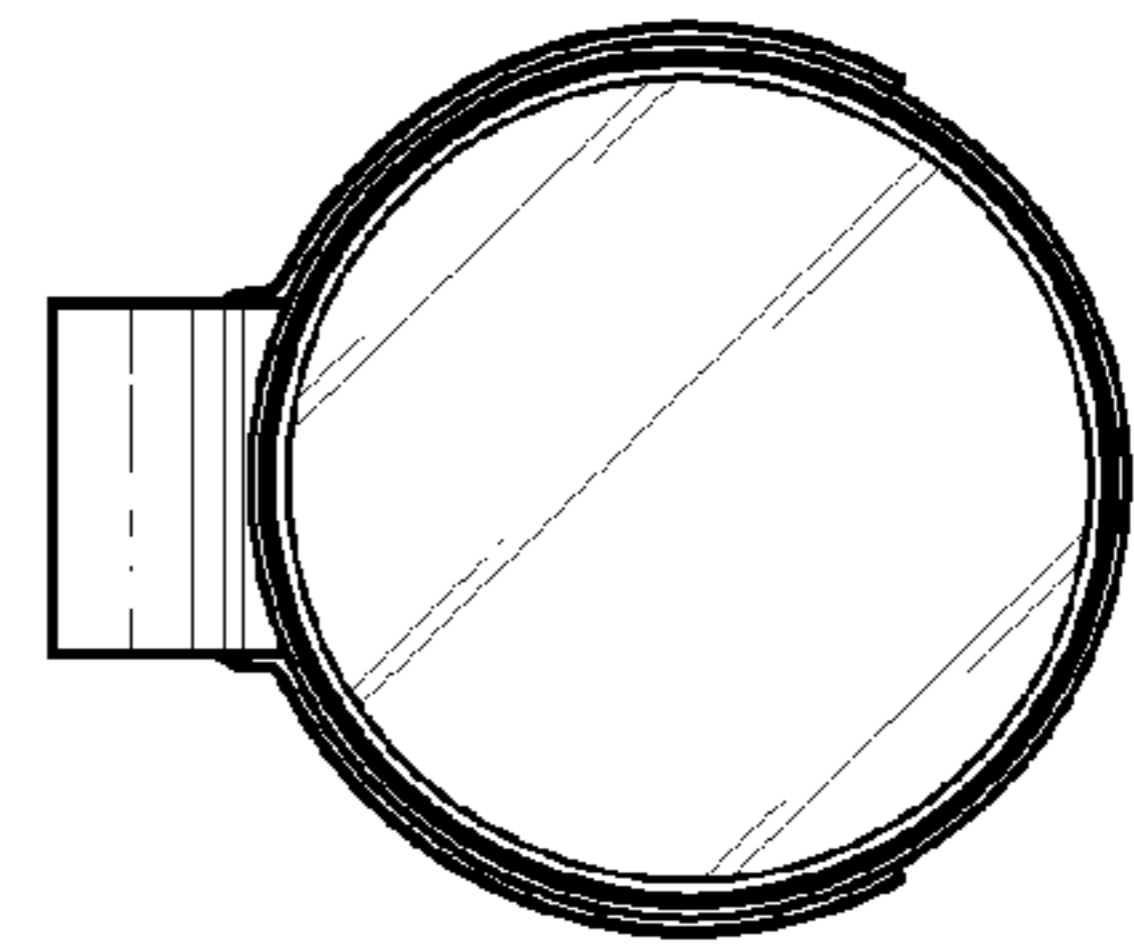

FIG. 4

FIG. 5

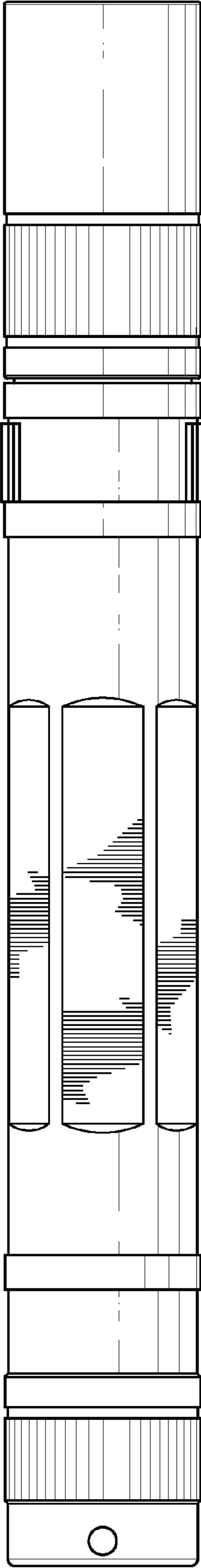

FIG. 6

