



US00D576005S

(12) **United States Design Patent**  
**Shimokawa et al.**

(10) **Patent No.:** **US D576,005 S**

(45) **Date of Patent:** **\*\* Sep. 2, 2008**

(54) **MAIN BODY OF A PORTABLE CHAIN SAW**

(75) Inventors: **Kouichi Shimokawa**, Kawagoe (JP);  
**Kiminobu Satou**, Kawagoe (JP);  
**Kiyoshi Anbo**, Kawagoe (JP)

(73) Assignee: **Husqvarna Zenoah Co., Ltd.**,  
Kawagoe-shi (JP)

(\*\*) Term: **14 Years**

(21) Appl. No.: **29/299,253**

(22) Filed: **Dec. 20, 2007**

(30) **Foreign Application Priority Data**

Jun. 20, 2007 (JP) ..... 2007-016485

(51) **LOC (8) Cl.** ..... **08-03**

(52) **U.S. Cl.** ..... **D8/65**

(58) **Field of Classification Search** ..... D8/7,  
D8/8, 9, 68, 70, 65, 66, 67, 62, 63, 64, 61;  
30/386, 383, 382, 371, 123; 125/21; 123/1 R  
See application file for complete search history.

(56) **References Cited**

**U.S. PATENT DOCUMENTS**

|           |   |   |         |                |       |        |
|-----------|---|---|---------|----------------|-------|--------|
| D176,963  | S | * | 2/1956  | Mall et al.    | ..... | D15/1  |
| 4,630,372 | A | * | 12/1986 | Nagashima      | ..... | 30/381 |
| 4,654,970 | A | * | 4/1987  | Nagashima      | ..... | 30/383 |
| 4,662,071 | A | * | 5/1987  | Hoppner et al. | ..... | 30/381 |
| H378      | H | * | 12/1987 | Matsumoto      | ..... | 30/382 |
| 4,753,012 | A | * | 6/1988  | Schurr         | ..... | 30/382 |
| D320,728  | S | * | 10/1991 | Arvidsson      | ..... | D8/65  |
| 5,070,618 | A | * | 12/1991 | Edlund         | ..... | 30/386 |
| D361,251  | S | * | 8/1995  | Griffin        | ..... | D8/65  |
| D364,326  | S | * | 11/1995 | Lohse et al.   | ..... | D8/65  |

|              |    |   |         |                   |       |         |
|--------------|----|---|---------|-------------------|-------|---------|
| D377,441     | S  | * | 1/1997  | Hoppner et al.    | ..... | D8/65   |
| D378,184     | S  | * | 2/1997  | Naslund et al.    | ..... | D8/64   |
| D386,958     | S  | * | 12/1997 | Karlsson et al.   | ..... | D8/65   |
| D412,652     | S  | * | 8/1999  | Durr et al.       | ..... | D8/65   |
| 5,992,025    | A  | * | 11/1999 | Fricke            | ..... | 30/381  |
| 6,016,604    | A  | * | 1/2000  | Wolf et al.       | ..... | 30/383  |
| 6,637,117    | B2 | * | 10/2003 | Kobayashi         | ..... | 30/381  |
| 6,842,987    | B1 | * | 1/2005  | Martinsson et al. | ..... | 30/382  |
| D549,537     | S  | * | 8/2007  | Harada et al.     | ..... | D8/65   |
| D558,019     | S  | * | 12/2007 | Granberg et al.   | ..... | D8/65   |
| D558,020     | S  | * | 12/2007 | Karlsson et al.   | ..... | D8/65   |
| 2004/0103857 | A1 | * | 6/2004  | Kruse             | ..... | 123/1 R |

\* cited by examiner

*Primary Examiner*—Cathron Brooks

*Assistant Examiner*—Austin Murphy

(74) *Attorney, Agent, or Firm*—Synnestvedt & Lechner, LLP

(57) **CLAIM**

The ornamental design for a main body of a portable chain saw, as shown and described.

**DESCRIPTION**

FIG. 1 is a front perspective view of a main body of a portable chain saw showing our new design;

FIG. 2 is a rear perspective view thereof;

FIG. 3 is a front view thereof;

FIG. 4 is a rear view thereof;

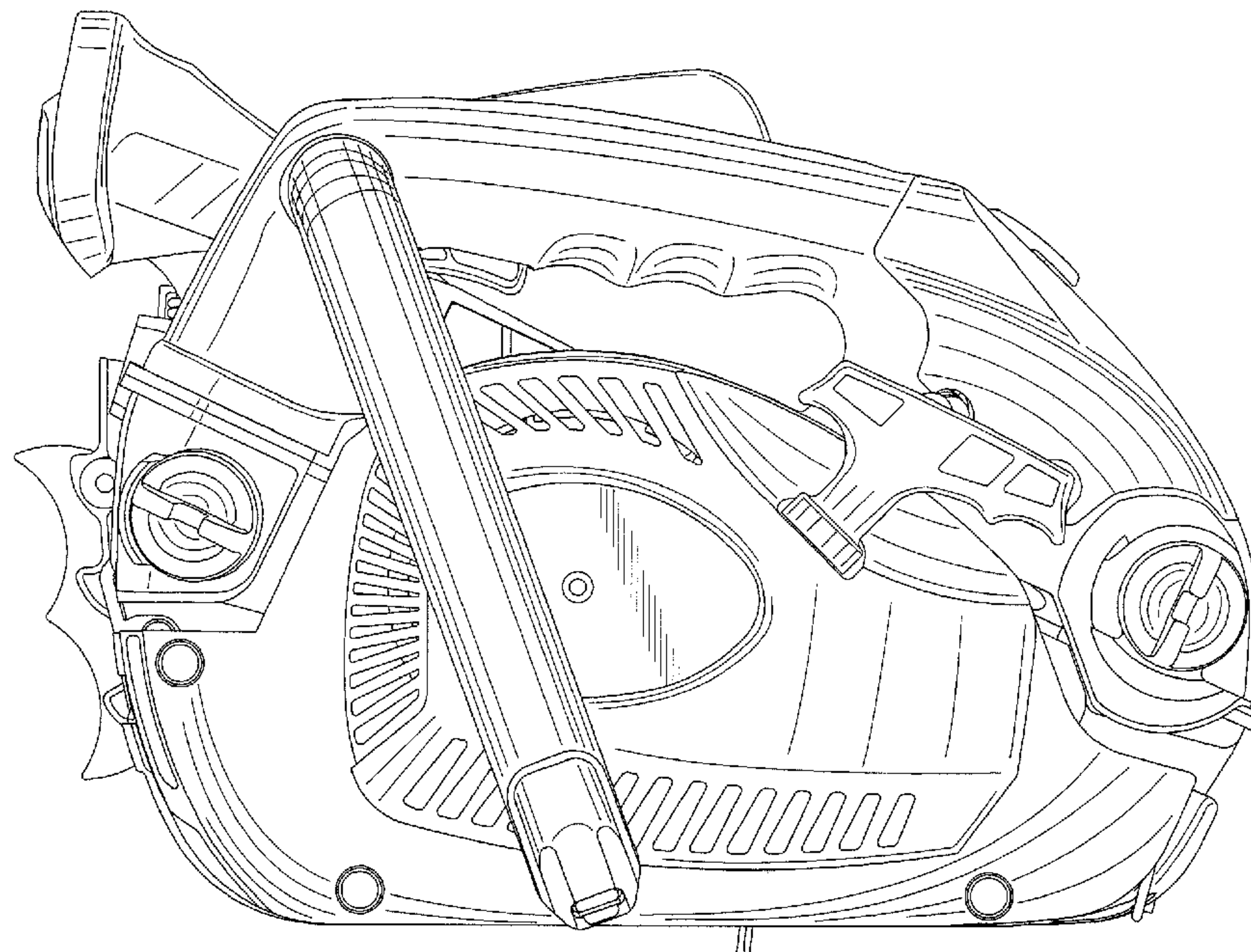
FIG. 5 is a top plan view thereof;

FIG. 6 is a bottom plan view thereof;

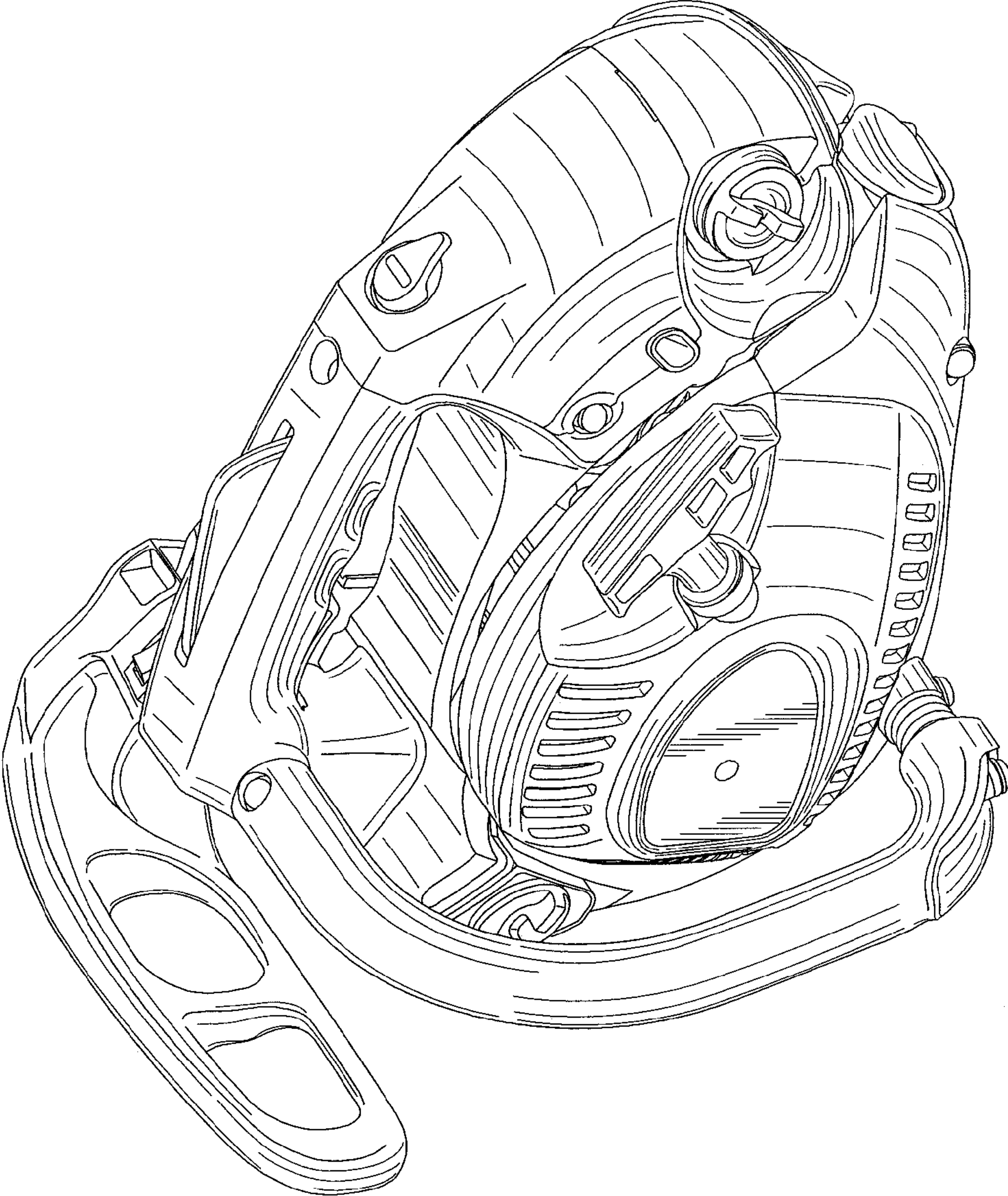
FIG. 7 is a right side view thereof; and,

FIG. 8 is a left side view thereof.

**1 Claim, 8 Drawing Sheets**

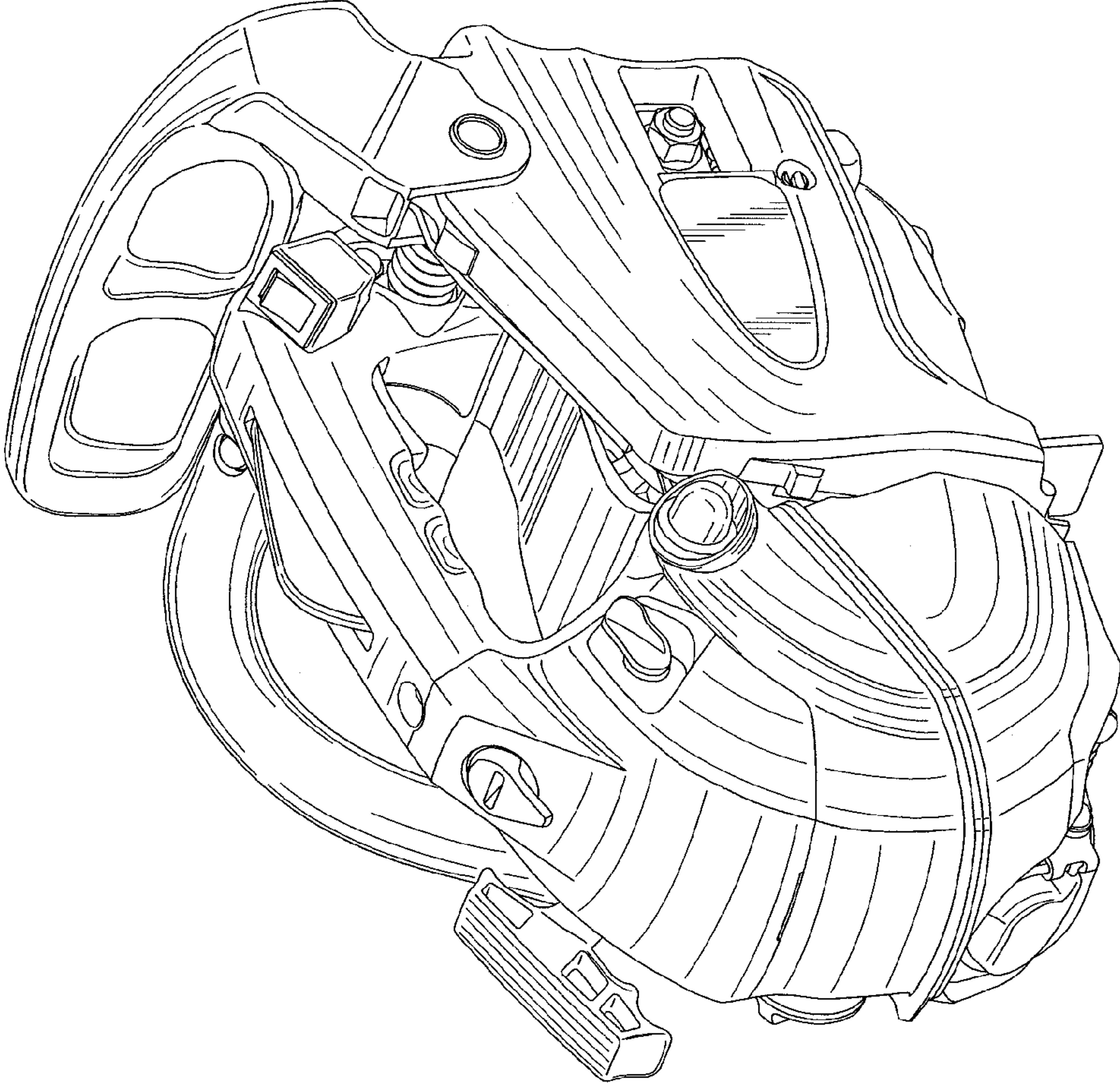


**FIG. 1**

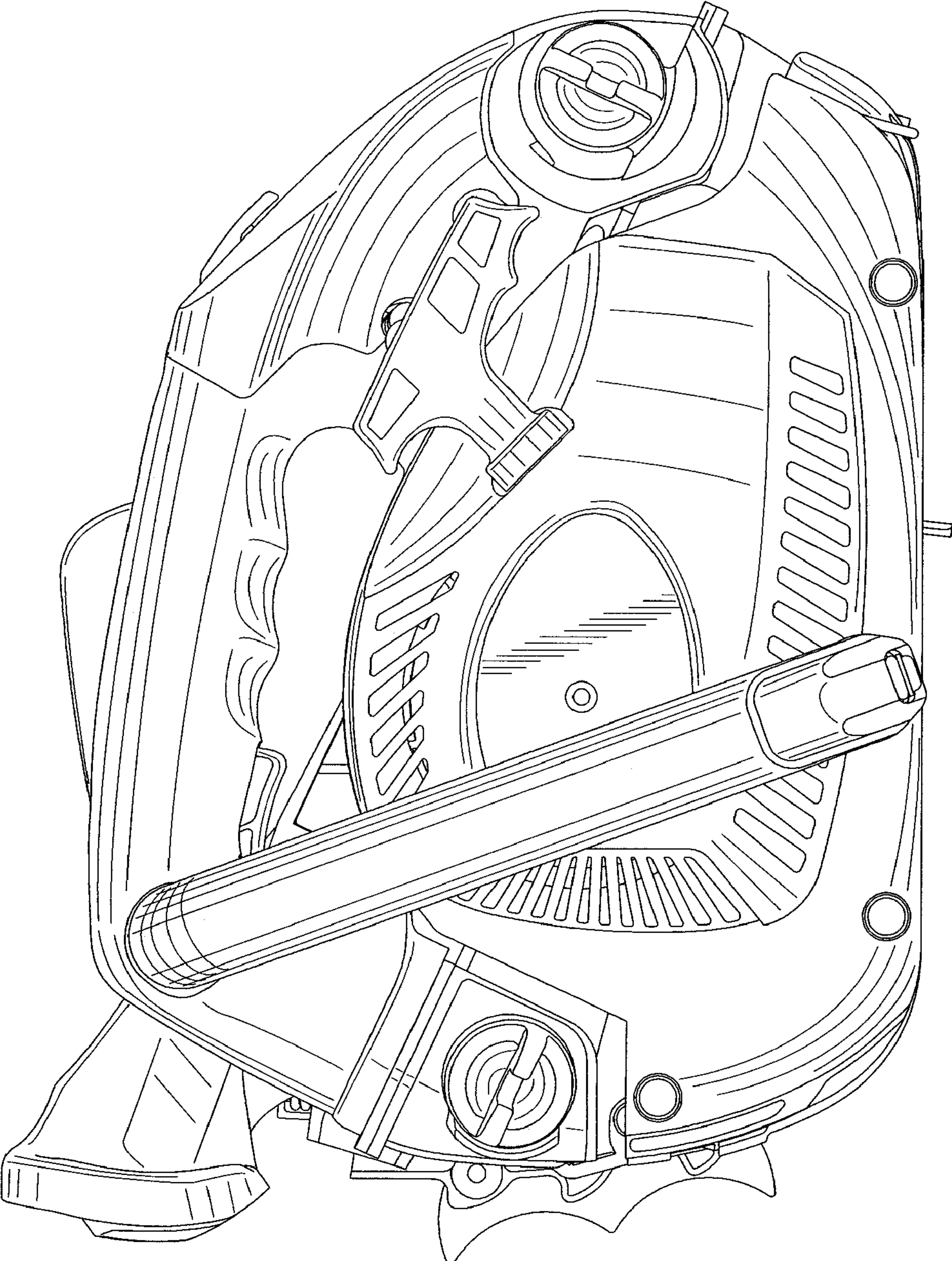




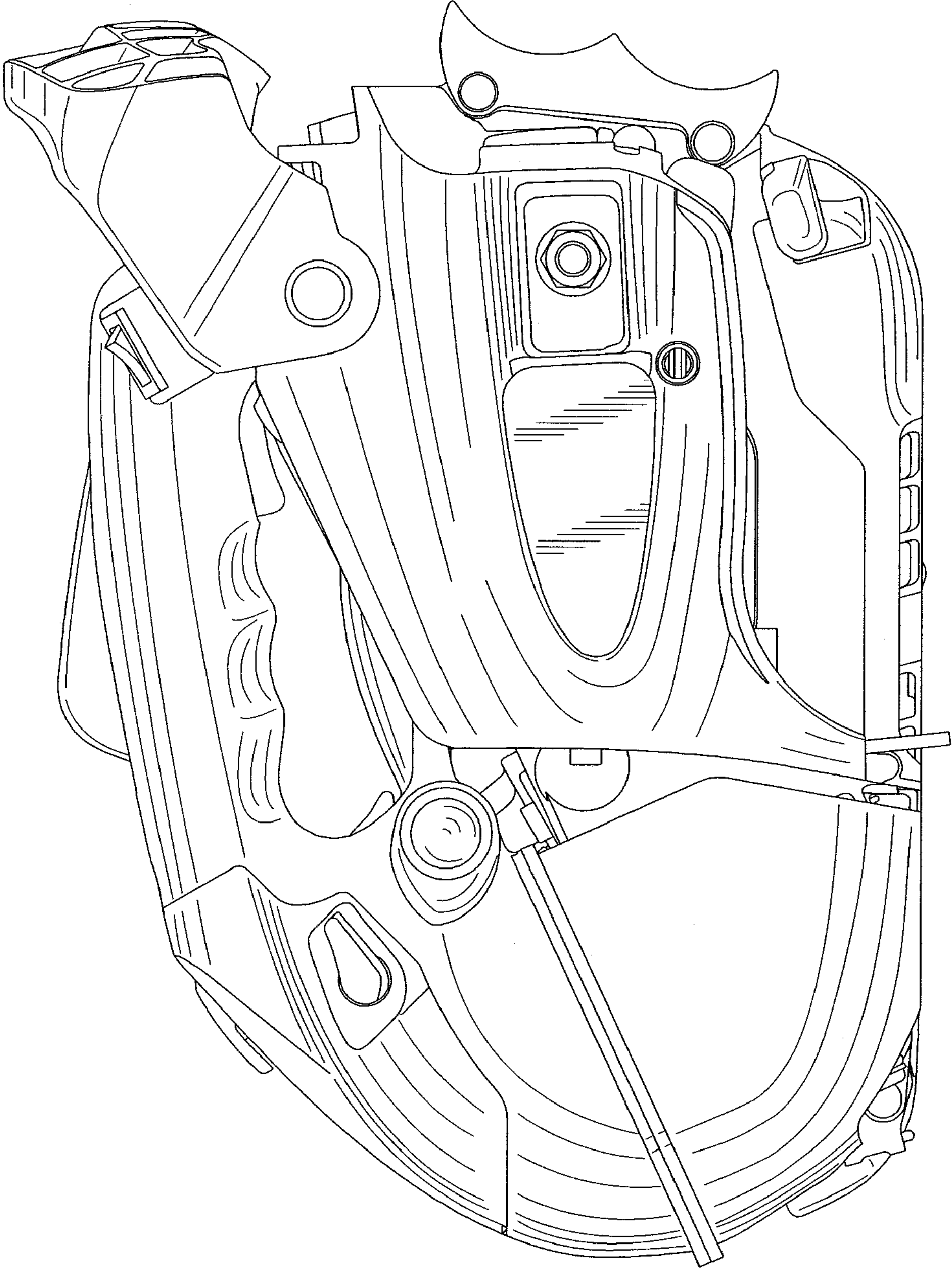
**FIG. 2**



**FIG. 3**

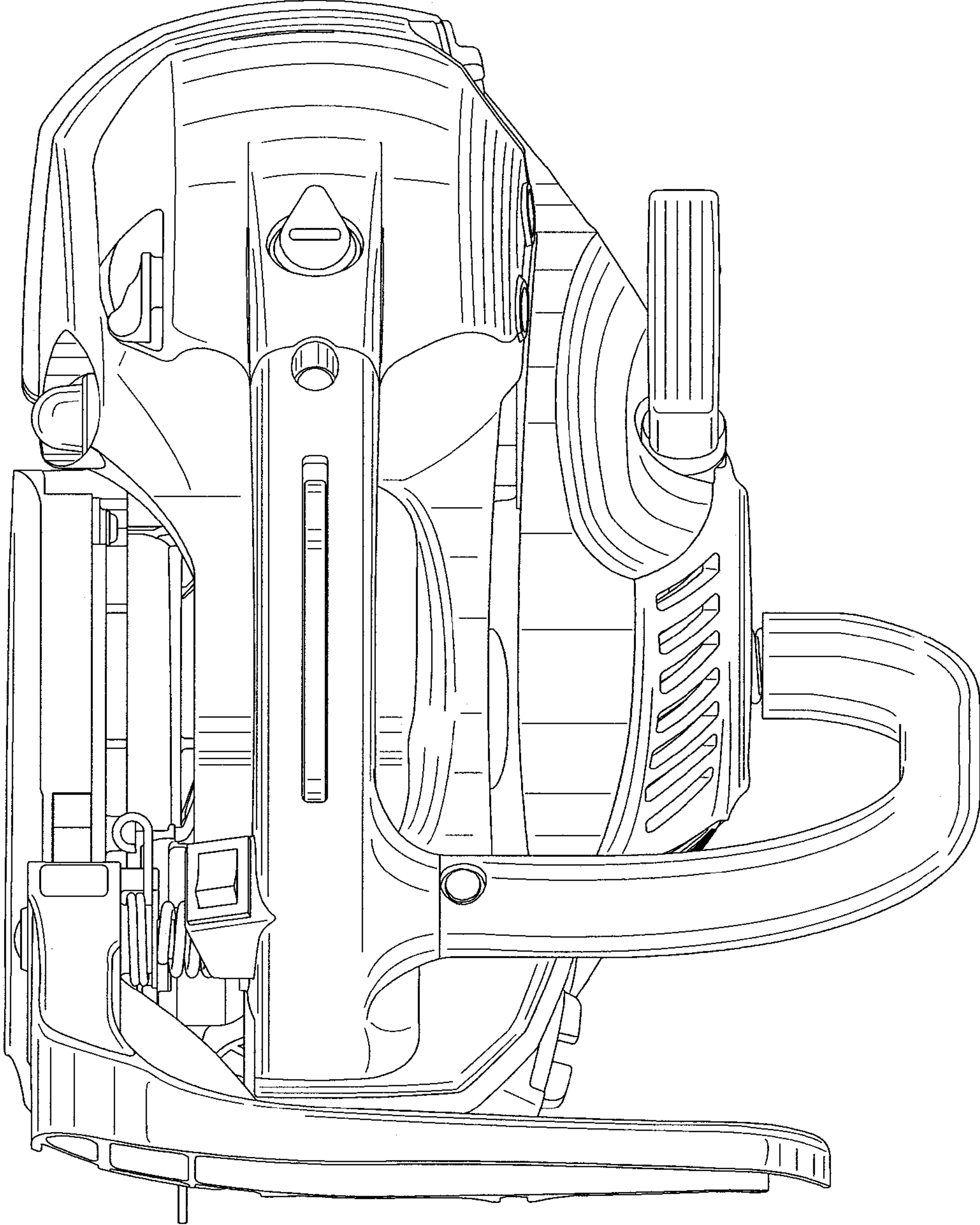


**FIG. 4**

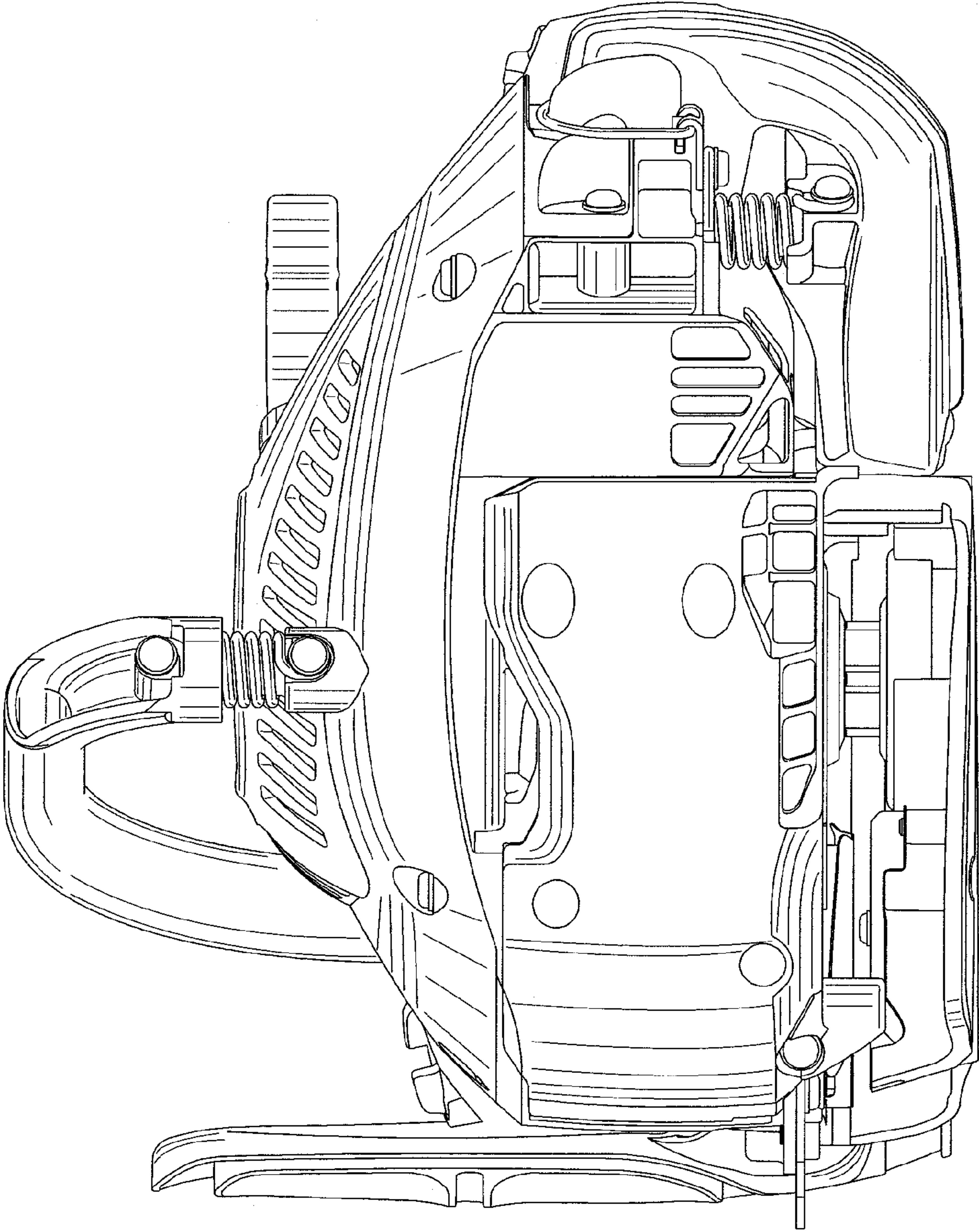




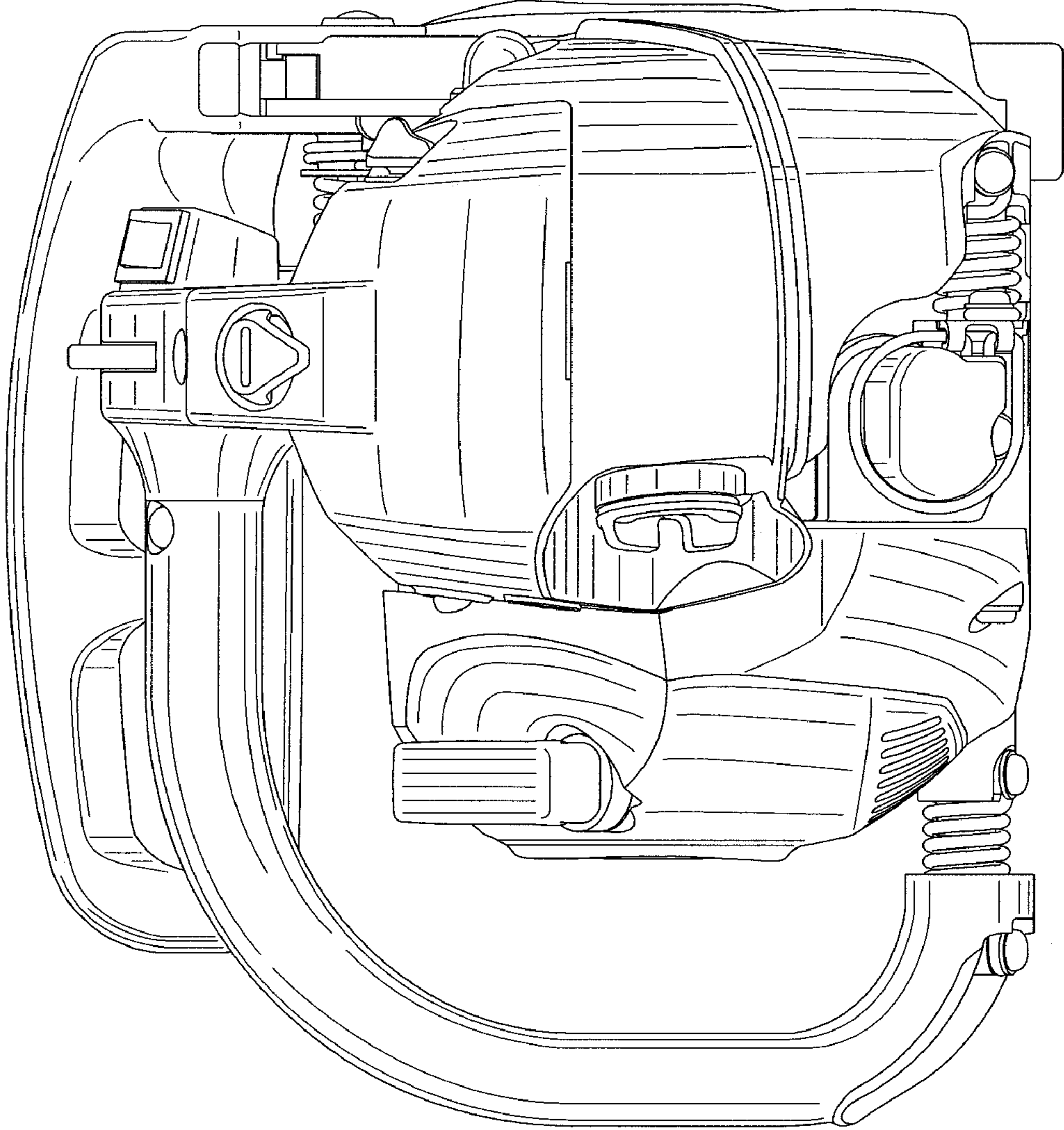
**FIG. 5**



**FIG. 6**



**FIG. 7**





**FIG. 8**

