



US00D574689S

(12) **United States Design Patent**
Holl et al.

(10) **Patent No.:** **US D574,689 S**
(45) **Date of Patent:** **** Aug. 12, 2008**

(54) **CHISEL HOLDER**

D373,299 S * 9/1996 Hall et al. D8/309
5,683,144 A 11/1997 Kammerer et al.

(75) Inventors: **Bernd Holl**, Neustadt/Wied (DE);
Thomas Lehnert, Oberraden (DE);
Günter Tewes, Unkel/Rhein (DE);
Günter Hähn, Königswinter (DE)

(Continued)

OTHER PUBLICATIONS

(73) Assignee: **Wirtgen GmbH** (DE)

Wirtgen Quick-change toolholder system HT3 Plus 1997-2004 and HT2 1992-1996, pp. 58-60 https://www.wirtgenamerica.com/pdf/ps_pdf/p_parts07_a.pdf*

(**) Term: **14 Years**

(Continued)

(21) Appl. No.: **29/265,791**

Primary Examiner—T. Chase Nelson

Assistant Examiner—Karen Acker

(22) Filed: **Sep. 8, 2006**

(74) *Attorney, Agent, or Firm*—Jansson Shupe & Munger Ltd.

(30) **Foreign Application Priority Data**

Mar. 10, 2006 (EP) 000493150

(57) **CLAIM**

(51) **LOC (8) Cl.** **08-05**

The ornamental design for a chisel holder, as shown and described.

(52) **U.S. Cl.** **D8/71**

(58) **Field of Classification Search** D8/70-74,
D8/349, 354, 355, 373, 395, 14; D3/315;
D6/553; D15/130, 132, 135, 136, 138-141,
D15/144.1, 144.2; D19/78; 206/349, 372,
206/373; 211/70.1, 70.6; 220/696; 294/19.1,
294/27.1, 86.4; 299/104, 106; 16/429; 29/527.1,
29/527.5; 248/229.15

DESCRIPTION

See application file for complete search history.

FIG. 1 is a perspective view of the chisel holder;
FIG. 2 is a front elevation of the chisel holder of FIG. 1;
FIG. 3 is a left side elevation of the chisel holder of FIG. 1;
FIG. 4 is a right side elevation of the chisel holder of FIG. 1;
FIG. 5 is a top plan view of the chisel holder of FIG. 1;
FIG. 6 is a back elevation of the chisel holder;
FIG. 7 is a bottom plan view of the chisel holder;
FIG. 8 is a back elevation of a second embodiment of the chisel holder, the only difference being the inclusion of the notch, it being understood that all other surfaces are the same as those of the first embodiment; and,
FIG. 9 is a bottom plan view of the chisel holder of FIG. 8.

(56) **References Cited**

U.S. PATENT DOCUMENTS

3,397,012 A * 8/1968 Krekeler 299/104
4,240,669 A * 12/1980 Rollins 299/102
4,489,986 A * 12/1984 Dziak 299/104
4,542,943 A * 9/1985 Montgomery, Jr. 299/102
4,828,327 A * 5/1989 Wechner 299/102
4,932,723 A * 6/1990 Mills 299/104
5,011,229 A * 4/1991 O'Neill et al. 299/102
5,378,050 A * 1/1995 Kammerer et al. 299/102

1 Claim, 9 Drawing Sheets

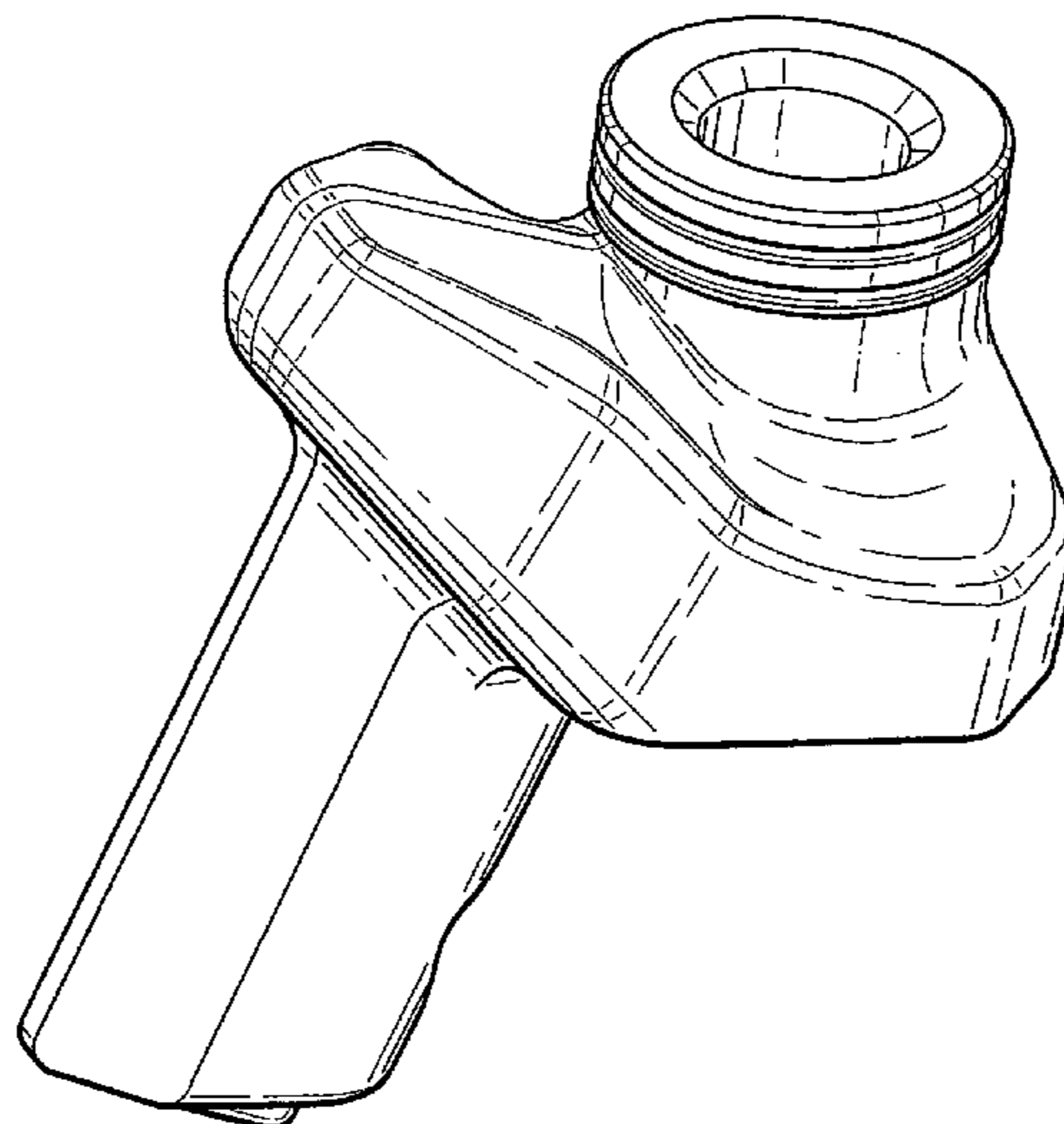

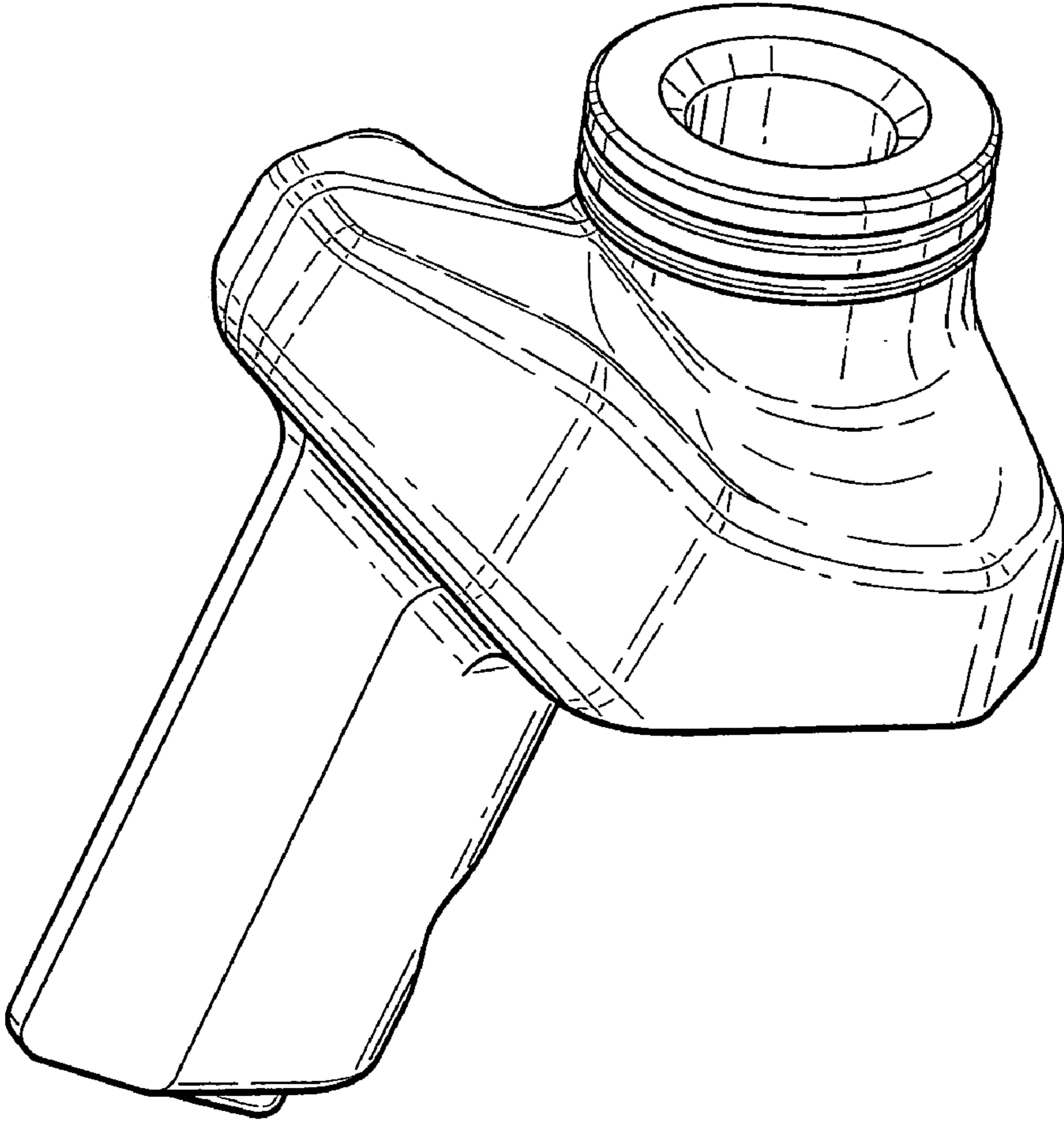

FIG. 1

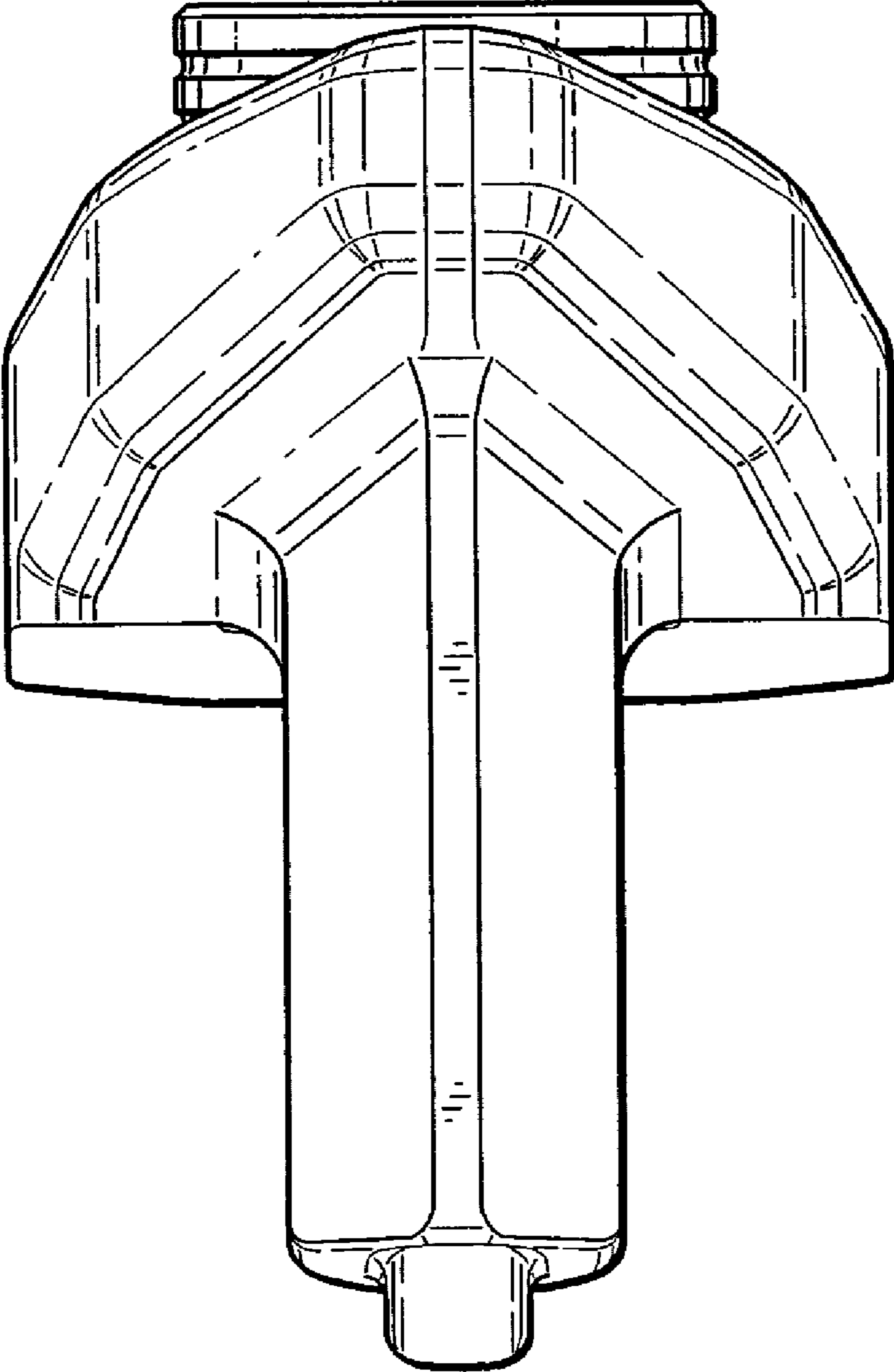

FIG. 2

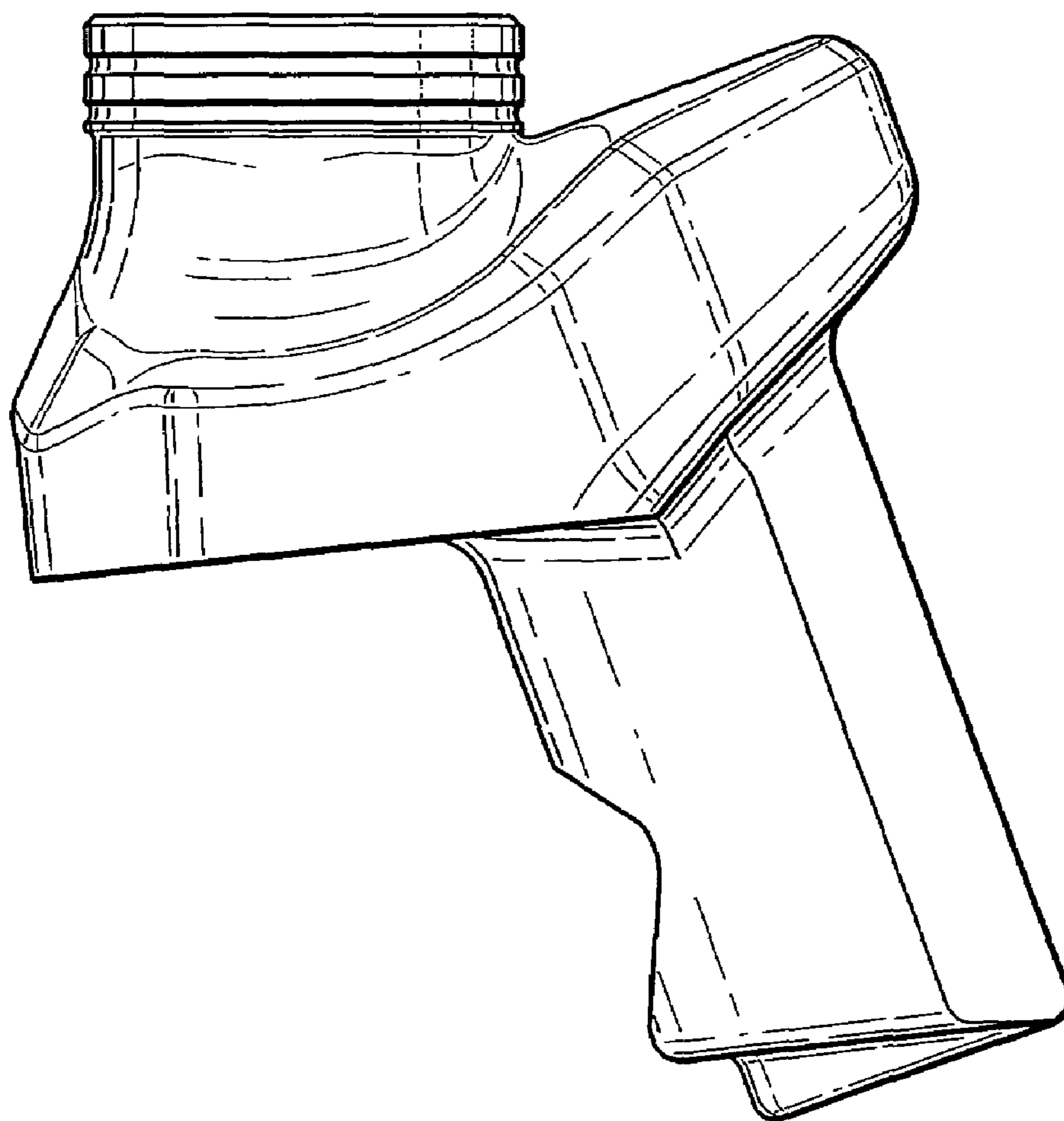

FIG. 3

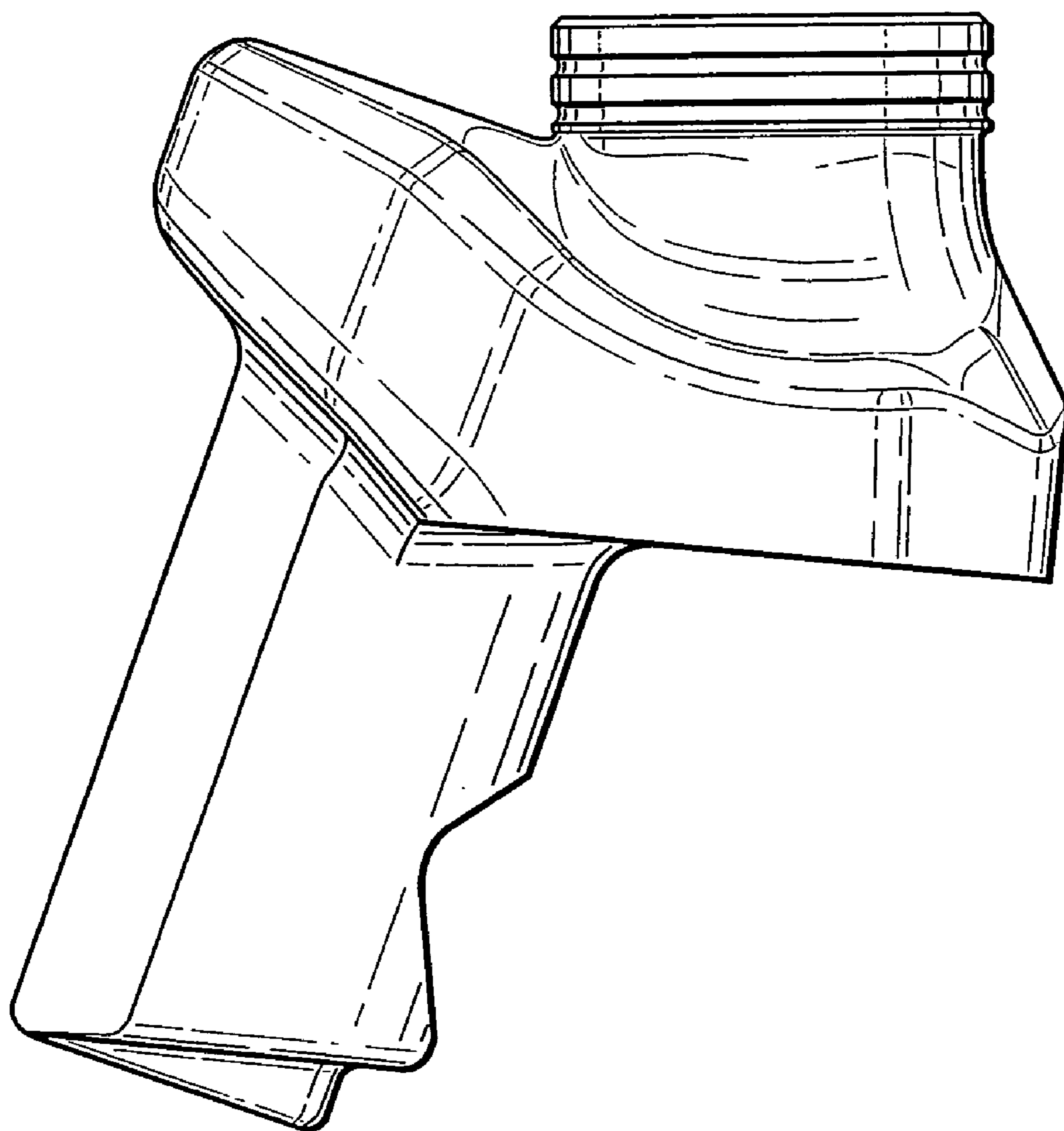

FIG. 4

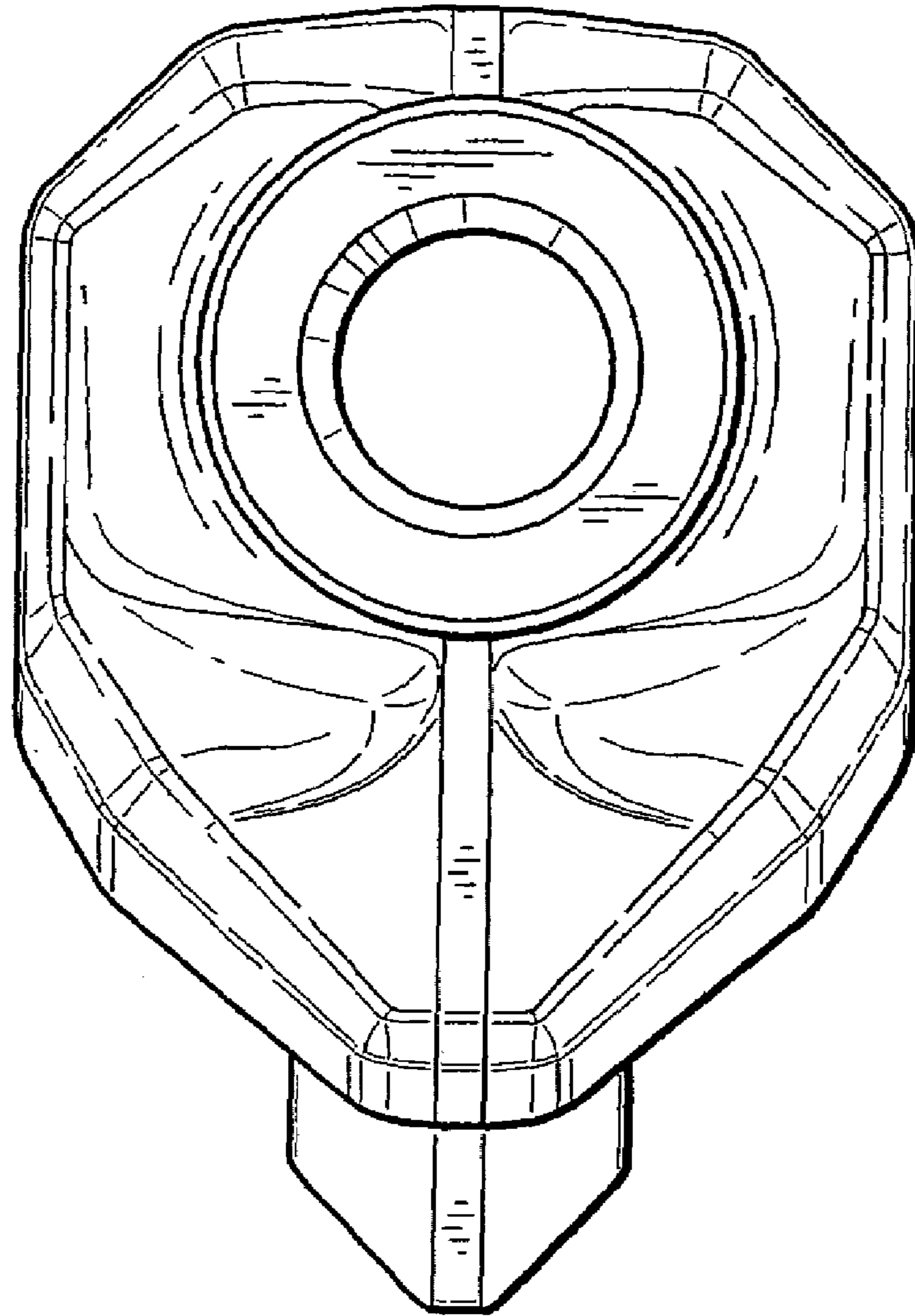

FIG. 5

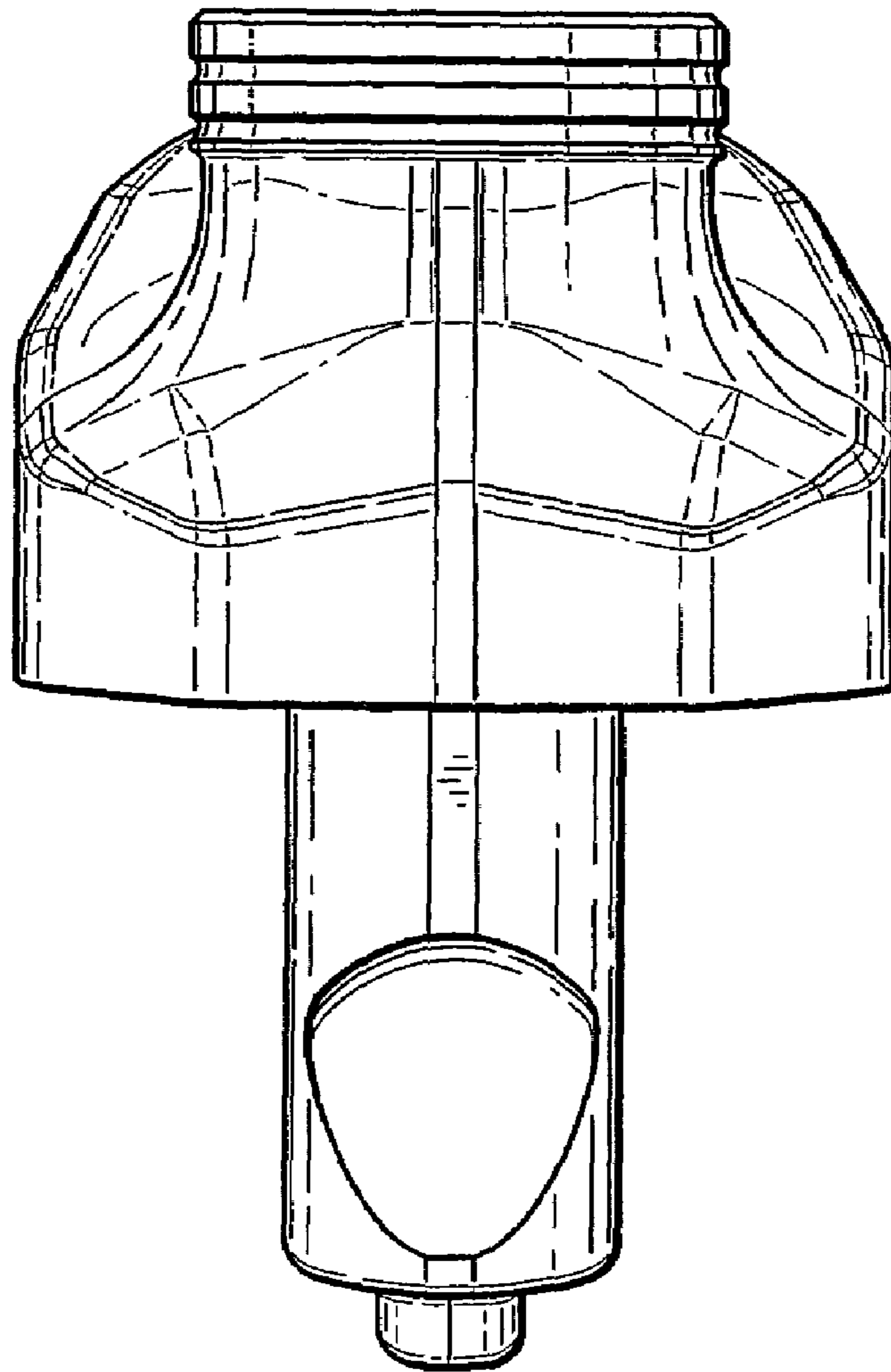

FIG. 6

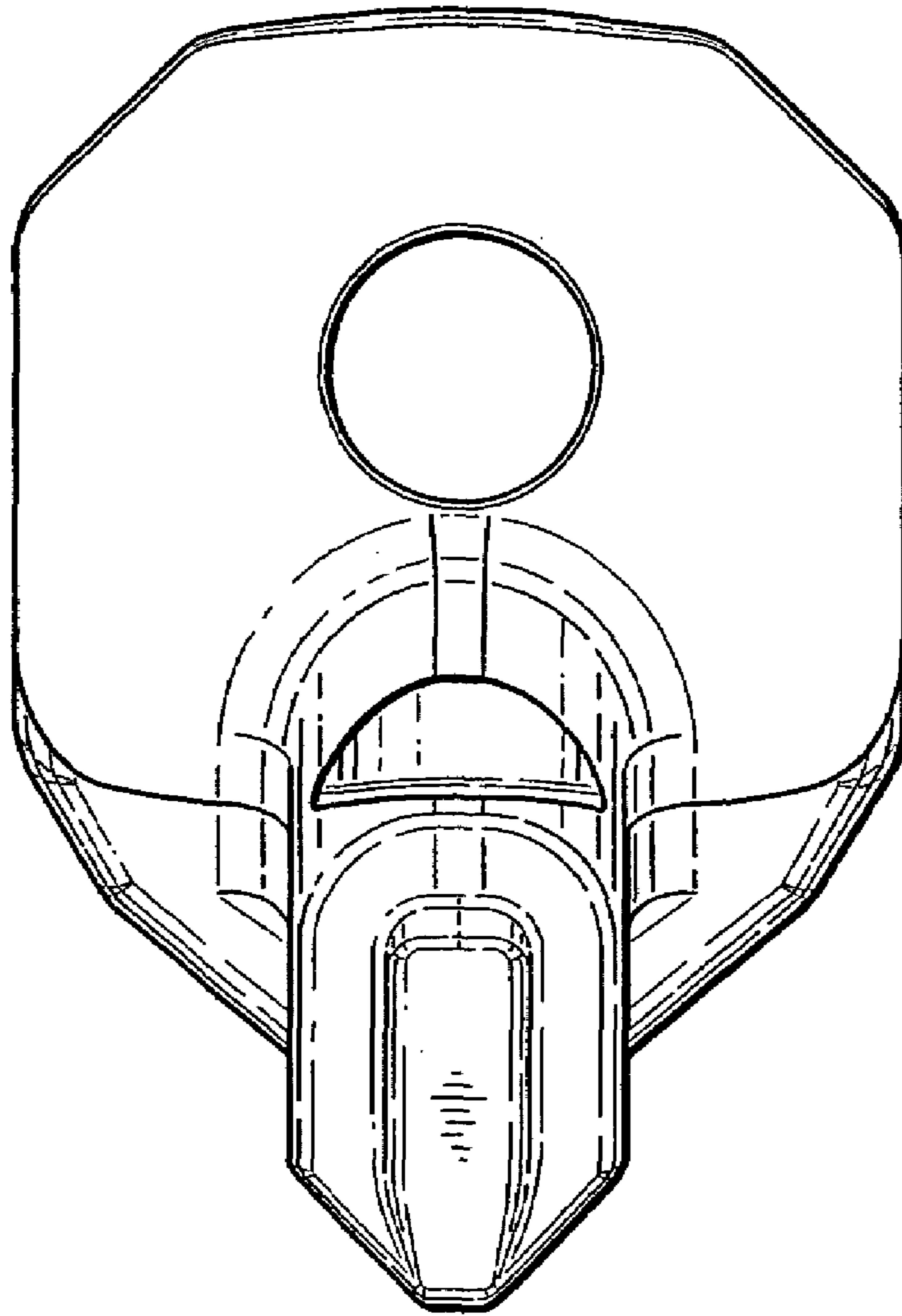

FIG. 7

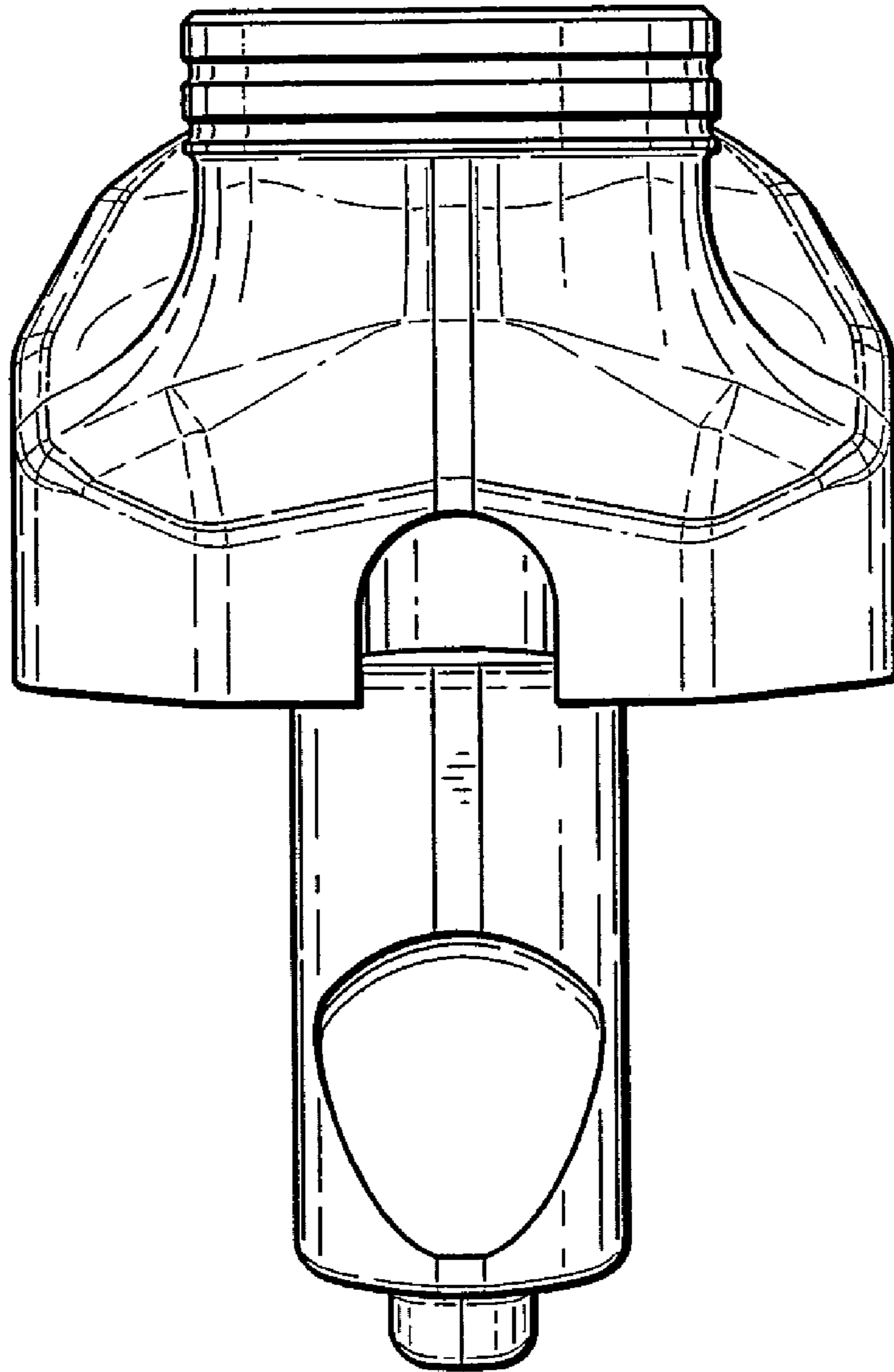

FIG. 8

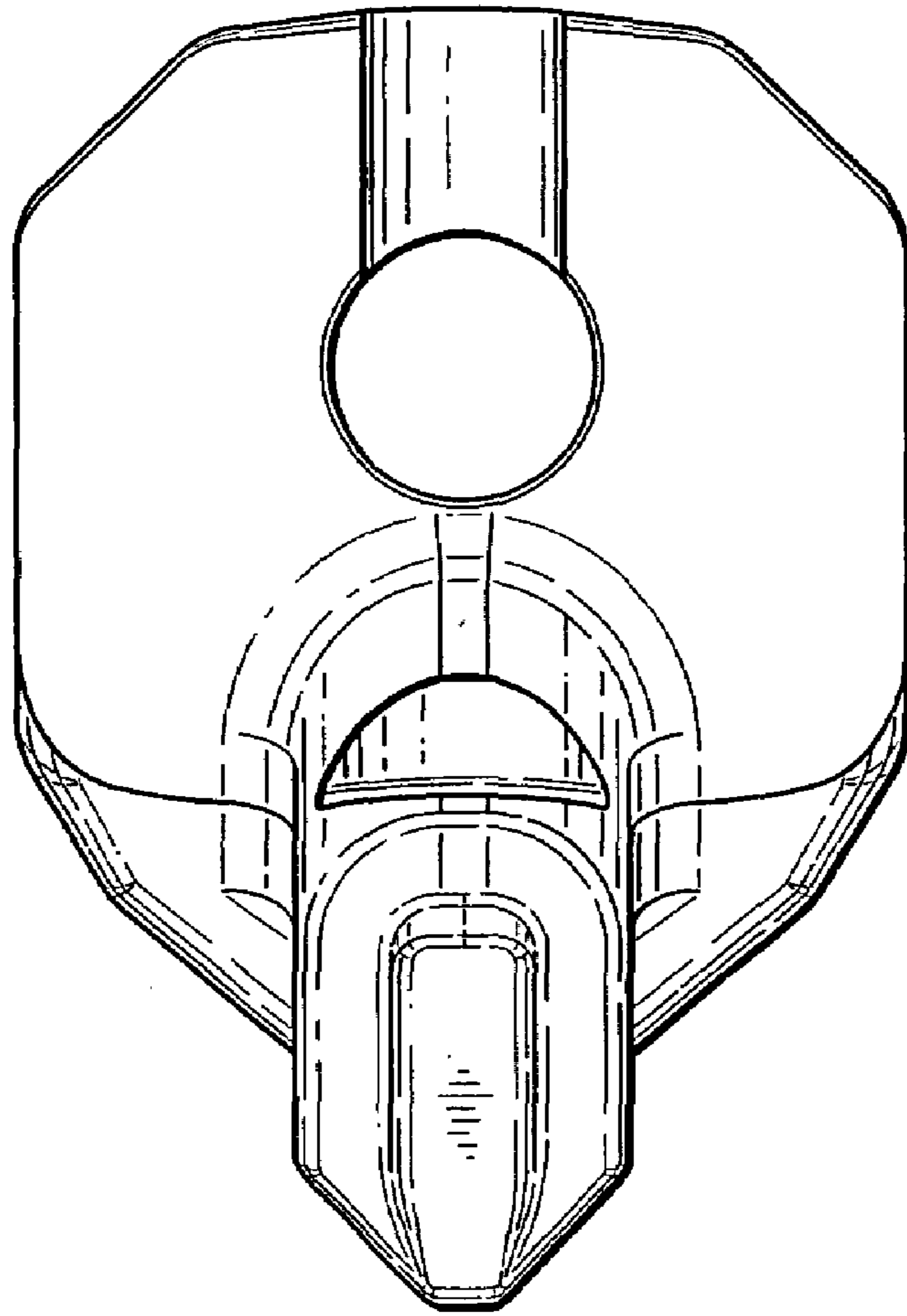

FIG. 9