

US00D574568S

(12) **United States Design Patent**  
**Lee**

(10) **Patent No.:** **US D574,568 S**

(45) **Date of Patent:** **\*\* Aug. 5, 2008**

(54) **STEAM IRON**

6,711,840 B1 \* 3/2004 Rosenzweig ..... 38/69  
D548,418 S \* 8/2007 Cahen ..... D32/70

(76) Inventor: **Benny Lee**, 1300 NW. 43<sup>rd</sup> St., Kansas  
City, MO (US) 64116

\* cited by examiner

(\*\*) Term: **14 Years**

*Primary Examiner*—Pamela J. Burgess

(21) Appl. No.: **29/238,219**

(74) *Attorney, Agent, or Firm*—Sonnenschen Nath &  
Rosenthal LLP; Bryan P. Stanley

(22) Filed: **Sep. 13, 2005**

(57) **CLAIM**

(51) **LOC (8) Cl.** ..... **07-05**

The ornamental design for a steam iron, as shown and  
described.

(52) **U.S. Cl.** ..... **D32/70**

(58) **Field of Classification Search** ..... D32/70-71,  
D32/73, 68; 38/15, 77.1-77.9, 79, 96, 106-107,  
38/69, 141-142; 248/117.1-117; 219/245-249;  
392/383

**DESCRIPTION**

See application file for complete search history.

FIG. 1 is a perspective view of a steam iron showing my new  
design, the handle shown removed from the base for clarity of  
disclosure;

(56) **References Cited**

FIG. 2 is a perspective view thereof, with the handle shown  
resting in the base;

**U.S. PATENT DOCUMENTS**

FIG. 3 is a top plan view thereof;

3,811,208 A *	5/1974	Vieceli et al. ....	38/77.8
D315,434 S *	3/1991	Paulin .....	D32/68
D379,702 S *	6/1997	Gudefin et al. ....	D32/73
D388,921 S *	1/1998	Doria .....	D32/73
D423,163 S *	4/2000	Stutzer et al. ....	D32/73
6,212,332 B1 *	4/2001	Sham et al. ....	392/404
D446,621 S *	8/2001	Schier .....	D34/24
D452,354 S *	12/2001	Hsu .....	D32/70
D463,641 S *	9/2002	Powell .....	D32/71
D470,637 S *	2/2003	Berthier .....	D32/73
D470,986 S *	2/2003	Berthier .....	D32/73

FIG. 4 is a left side elevational view thereof;

FIG. 5 is a right side elevational view thereof; and,

FIG. 6 is a rear elevational view thereof, the connecting  
element or hose that attaches to the base at one end, and the  
iron at the other end is not shown for clarity of disclosure.

The broken lines shown in the drawings are for illustrative  
purposes only and form no part of the claimed design.

**1 Claim, 2 Drawing Sheets**

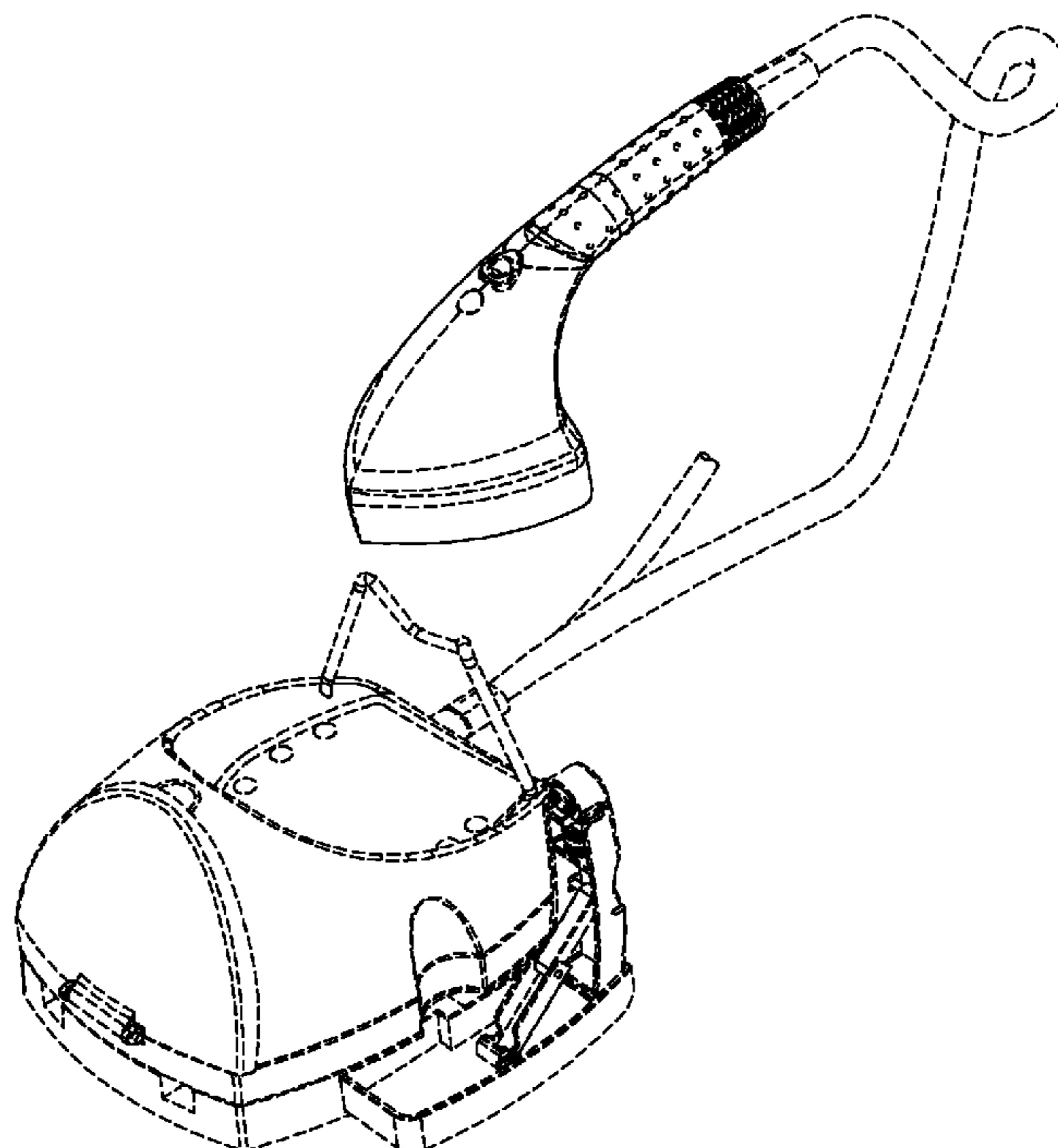

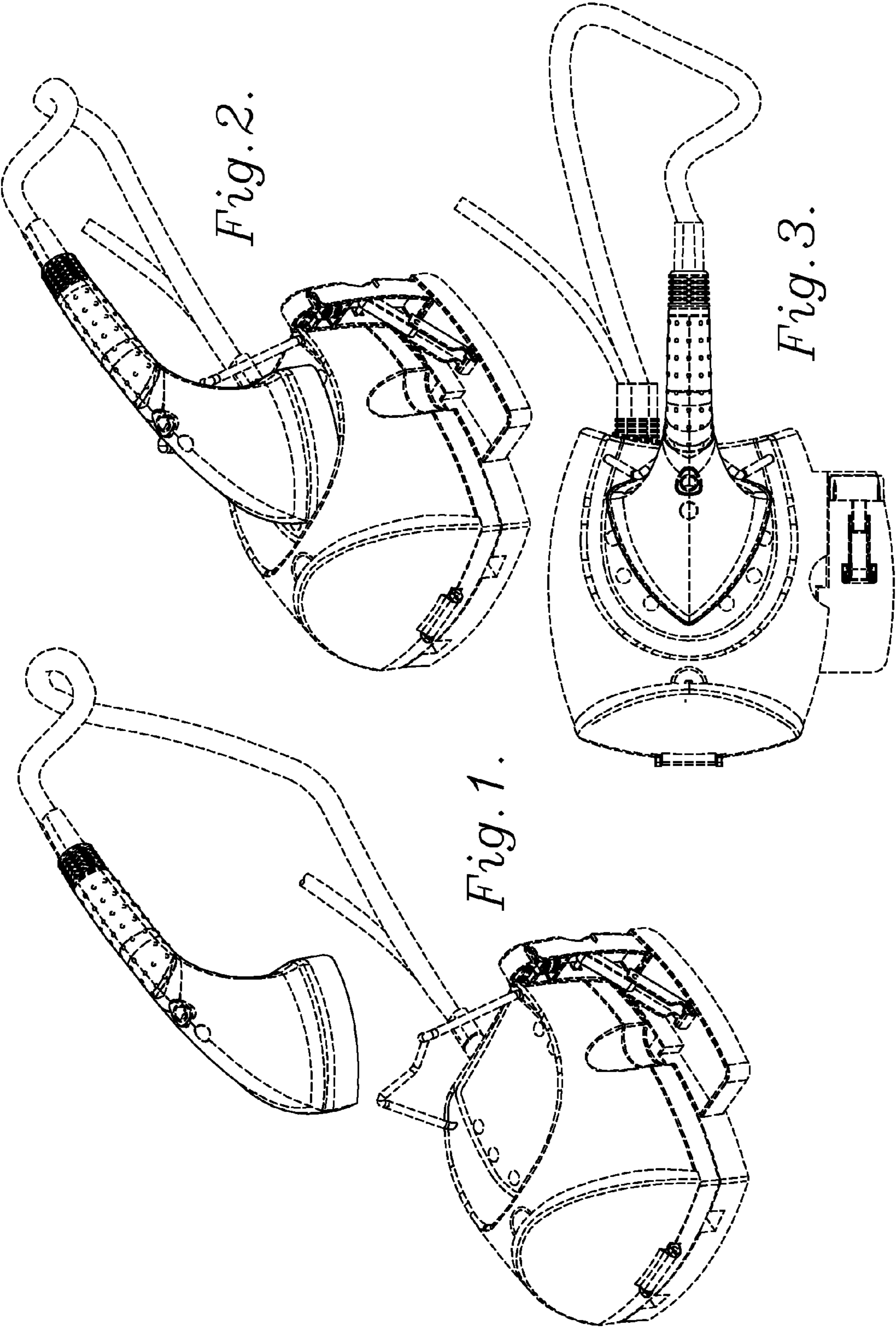

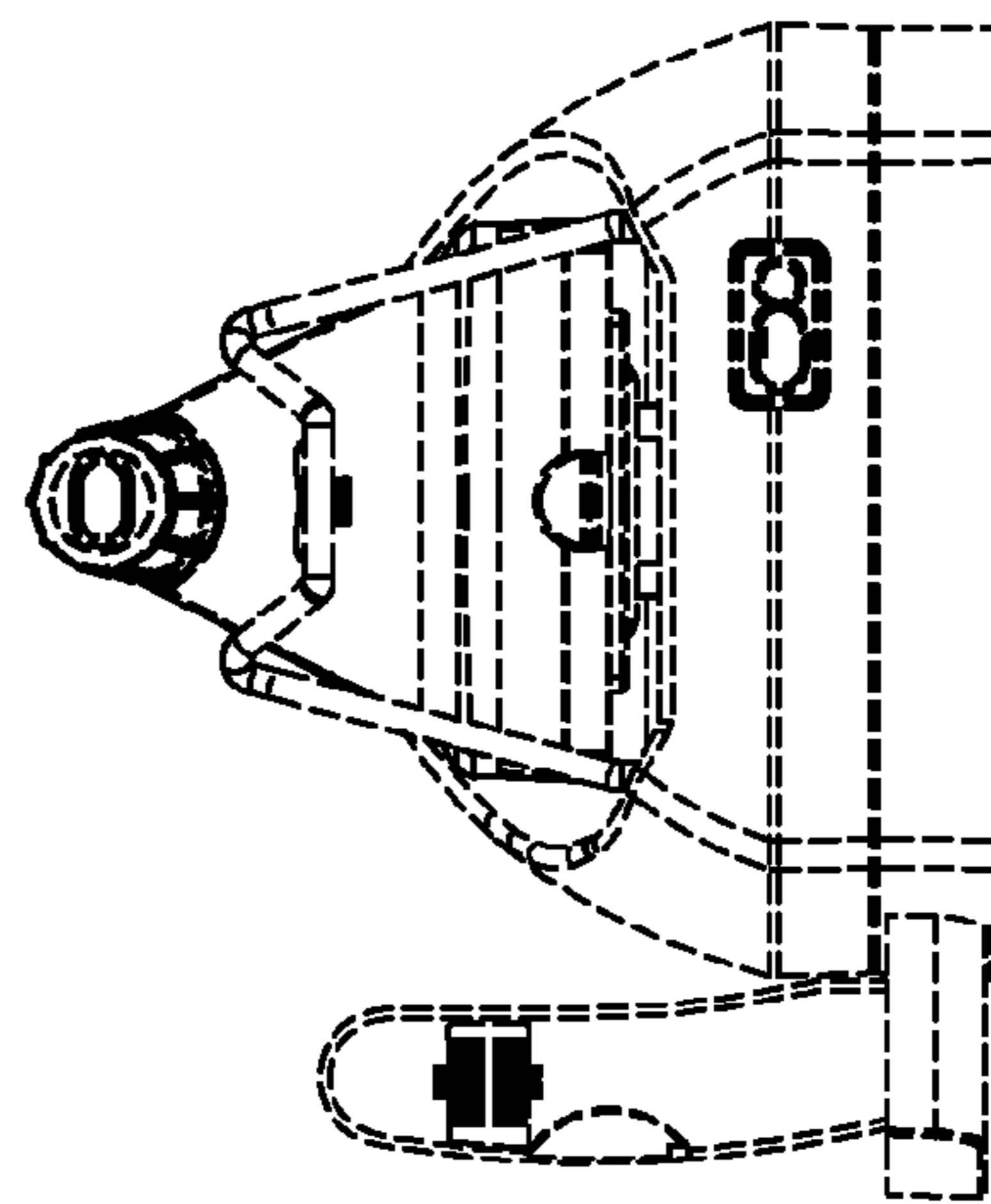
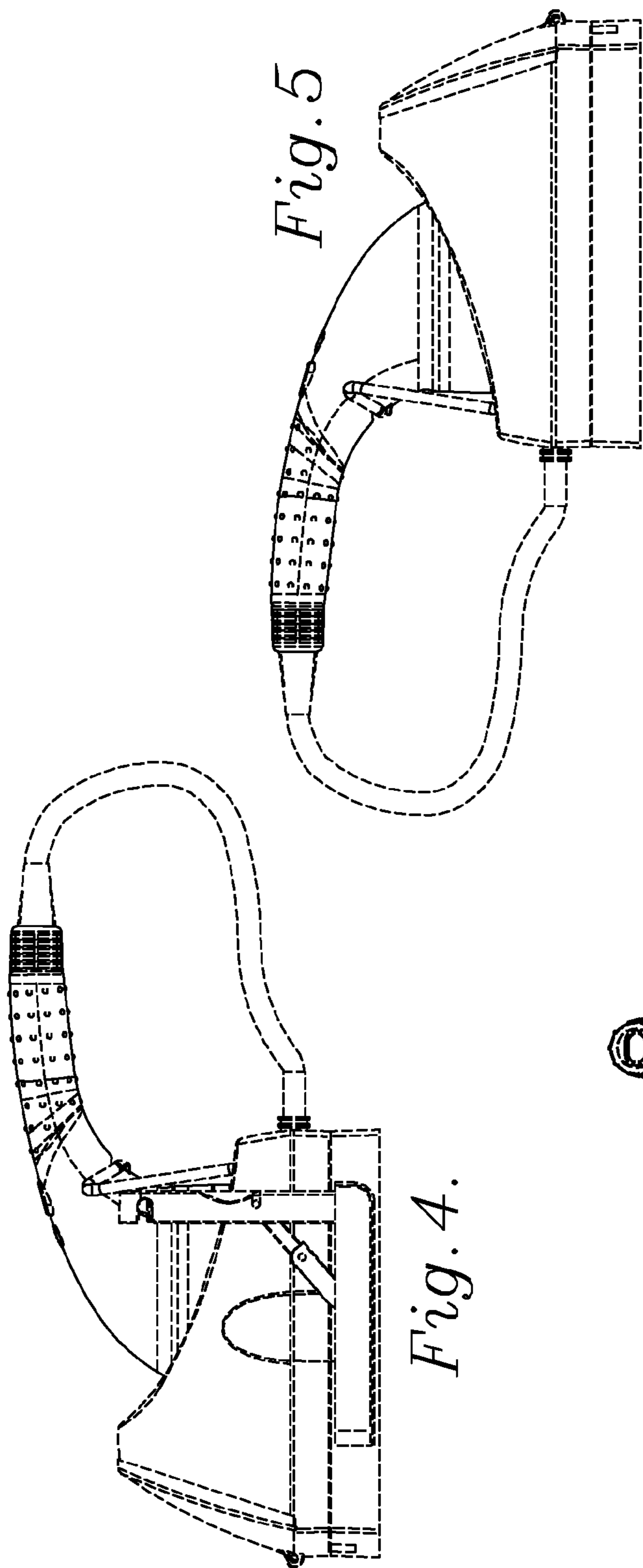

*Fig. 5*

*Fig. 4.*

*Fig. 6*