



US00D574561S

(12) **United States Design Patent**
Ni

(10) **Patent No.:** **US D574,561 S**

(45) **Date of Patent:** **** *Aug. 5, 2008**

(54) **HIGH-PRESSURE CLEANER**

(75) Inventor: **Zugen Ni**, Suzhou (CN)

(73) Assignee: **Suzhou Kingclean Floorcare Co., Ltd.**,
Suzhou (CN)

(**) Term: **14 Years**

(21) Appl. No.: **29/271,343**

(22) Filed: **Jan. 17, 2007**

(30) **Foreign Application Priority Data**

Sep. 20, 2006 (CN) 2006 3 0143253

(51) **LOC (8) Cl.** **15-05**

(52) **U.S. Cl.** **D32/16**

(58) **Field of Classification Search** D32/1,
D32/25, 15, 16, 21-22; 15/79.1, 79.2, 320,
15/321, 323, 3, 353, 403, 405; 134/199-201,
134/103.2; 239/146-158; D23/213

See application file for complete search history.

(56) **References Cited**

U.S. PATENT DOCUMENTS

D481,838 S * 11/2003 Renner D32/15
D488,596 S * 4/2004 Cattaneo D32/15
D489,497 S * 5/2004 Cattaneo D32/15
D489,498 S * 5/2004 Cattaneo D32/15

D490,948 S * 6/2004 Cattaneo D32/15
D496,503 S * 9/2004 Chen D32/16
D496,763 S * 9/2004 Chen D32/16
D532,166 S * 11/2006 Reverberi D32/4

* cited by examiner

Primary Examiner—Louis S Zarfaz

Assistant Examiner—Kathleen M Sims

(74) *Attorney, Agent, or Firm*—Oliff & Berridge, PLC

(57) **CLAIM**

The ornamental design for a high-pressure cleaner, as shown and described.

DESCRIPTION

FIG. 1 is a perspective view of a high-pressure cleaner;

FIG. 2 is a front view thereof;

FIG. 3 is a top view thereof;

FIG. 4 is a right side view thereof;

FIG. 5 is a left side view thereof;

FIG. 6 is a rear view thereof; and,

FIG. 7 is a bottom view thereof.

The broken line showing in FIGS. 1-7 is included for the purpose of illustrating portions of the high-pressure cleaner and forms no part of the claimed design.

1 Claim, 7 Drawing Sheets

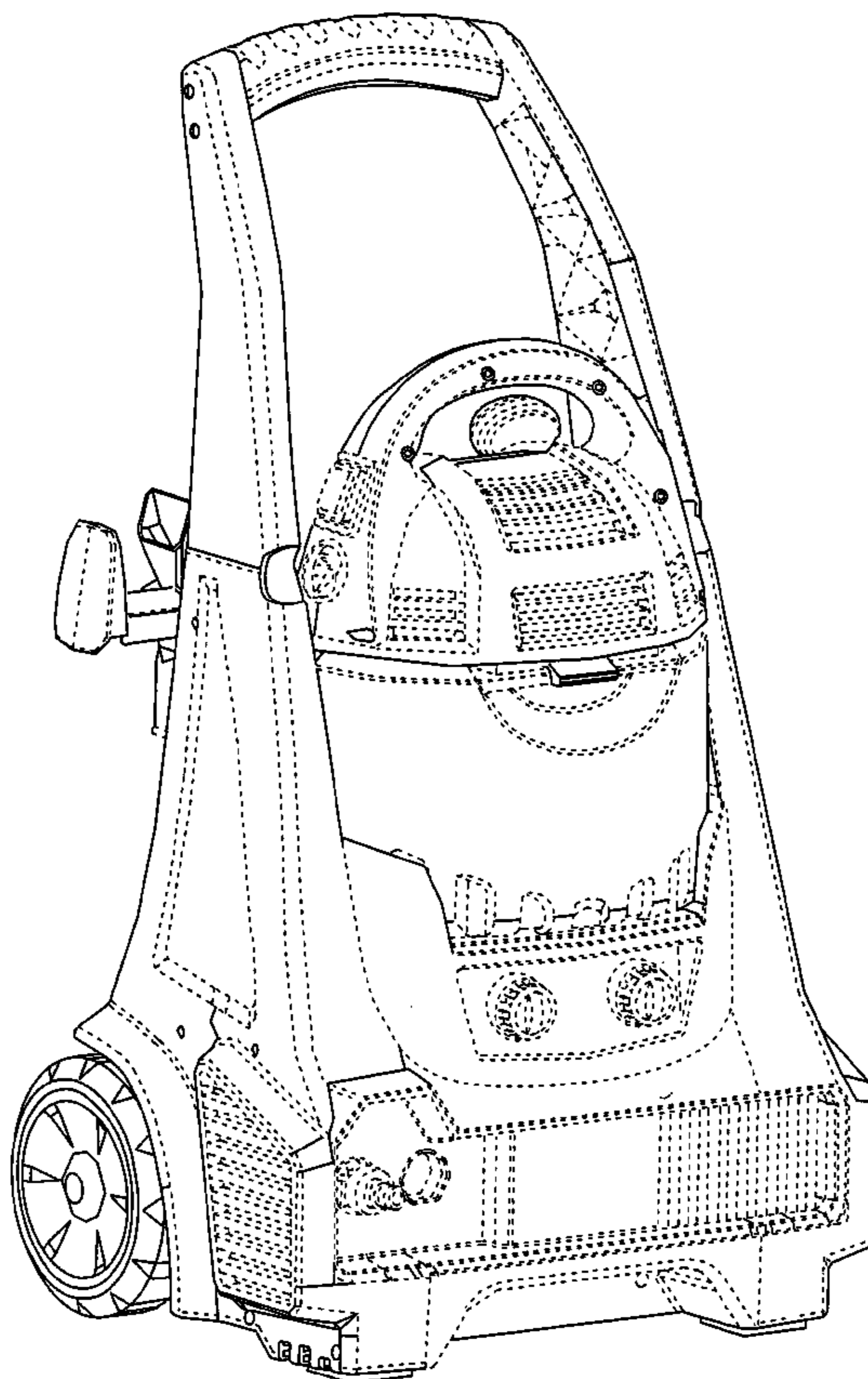

FIG. 1

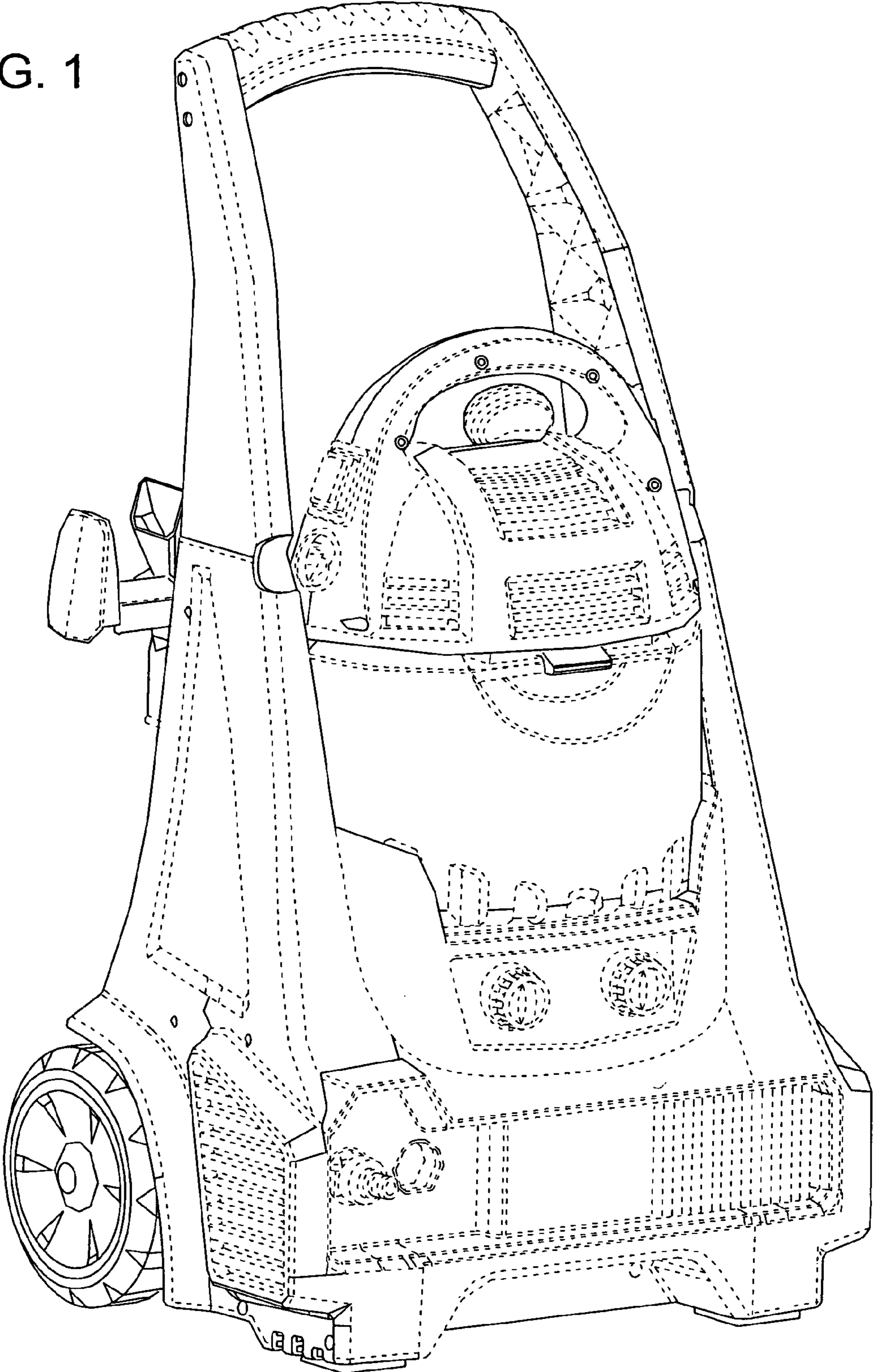
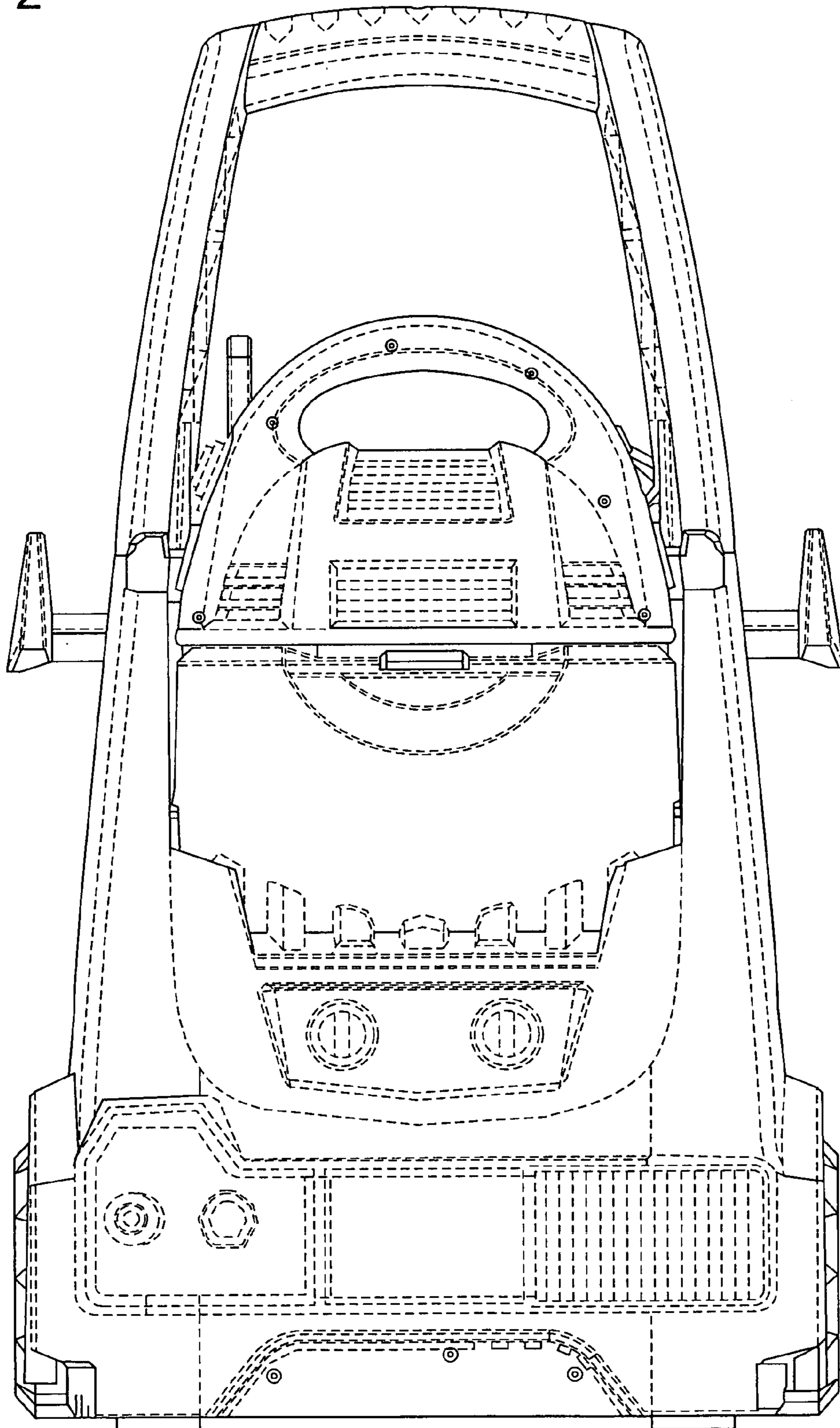

FIG. 2



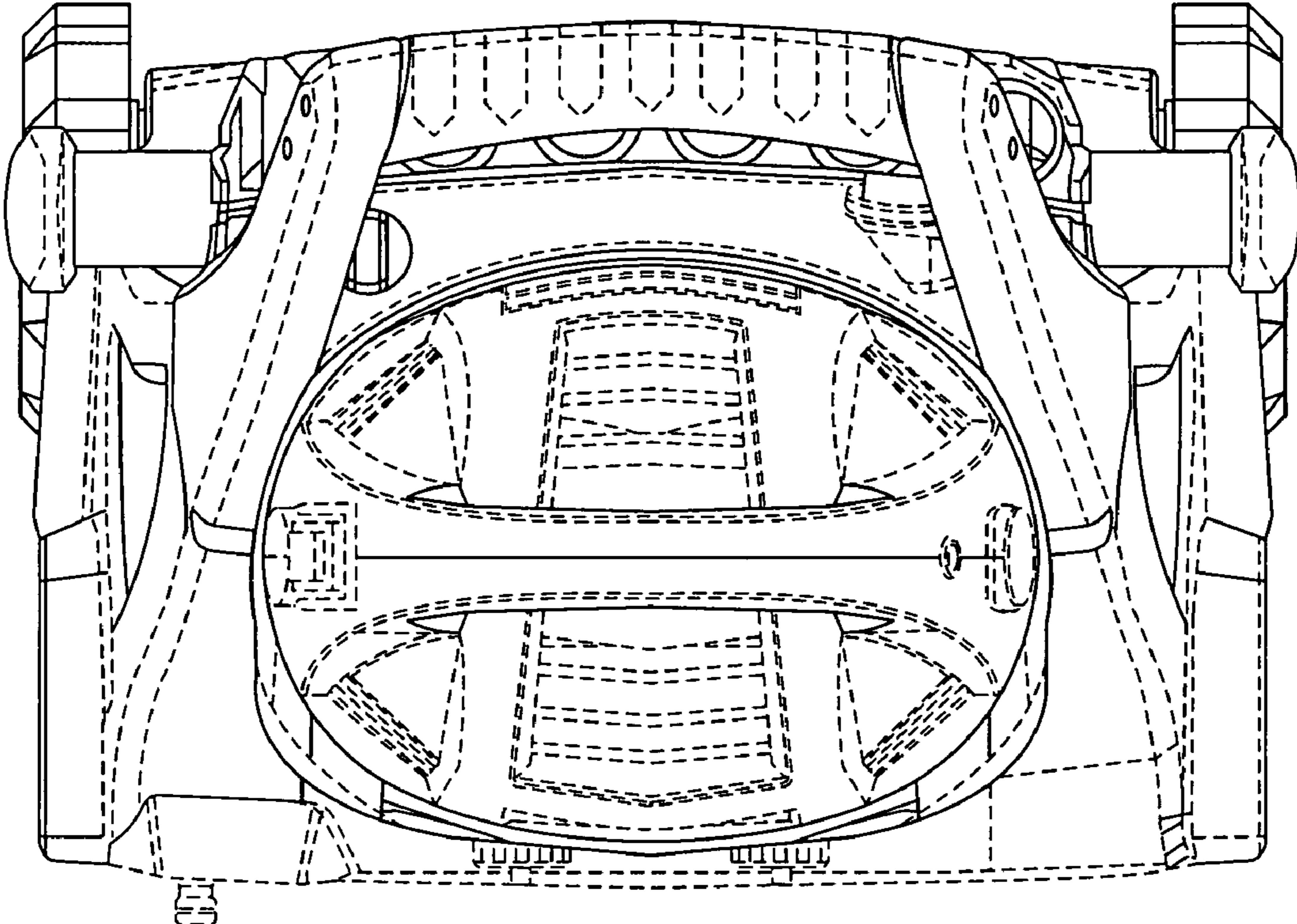

FIG. 3

FIG. 4

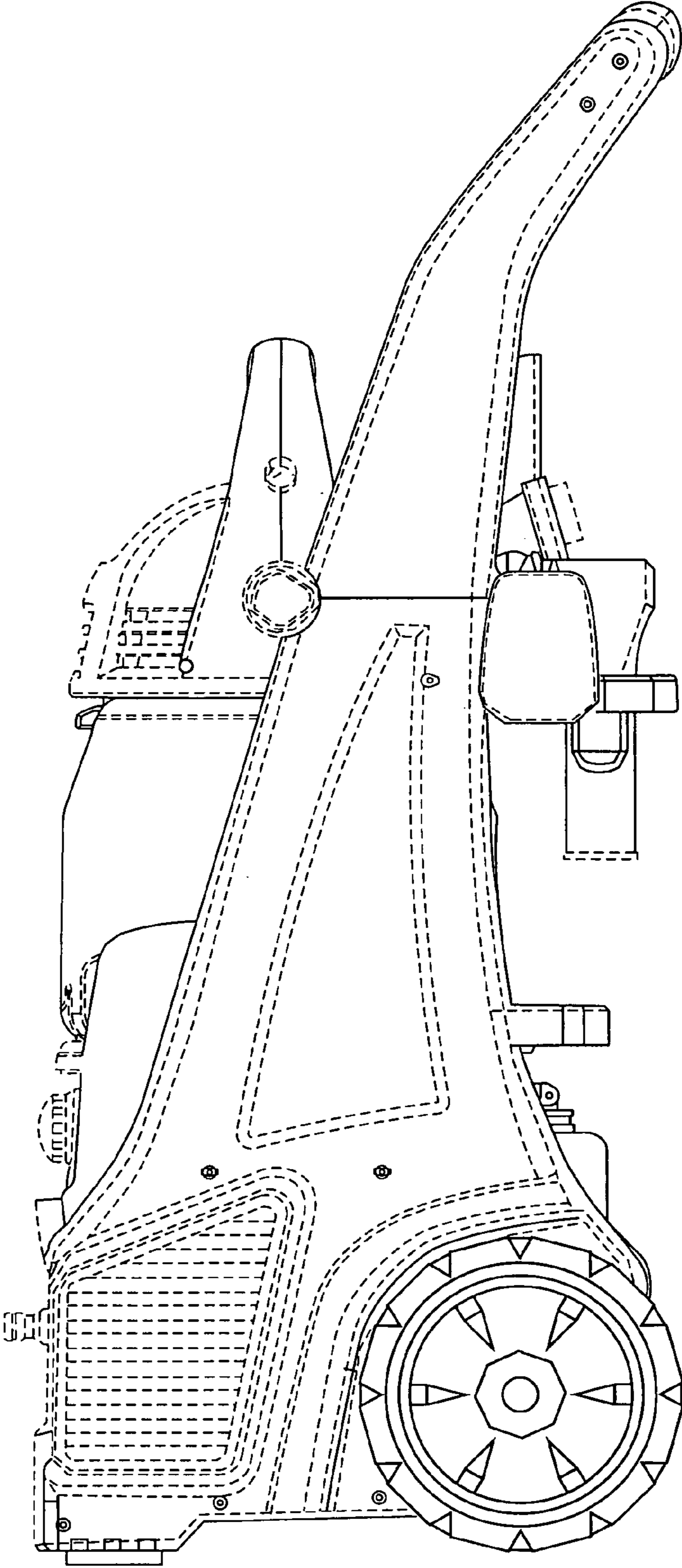

FIG. 5

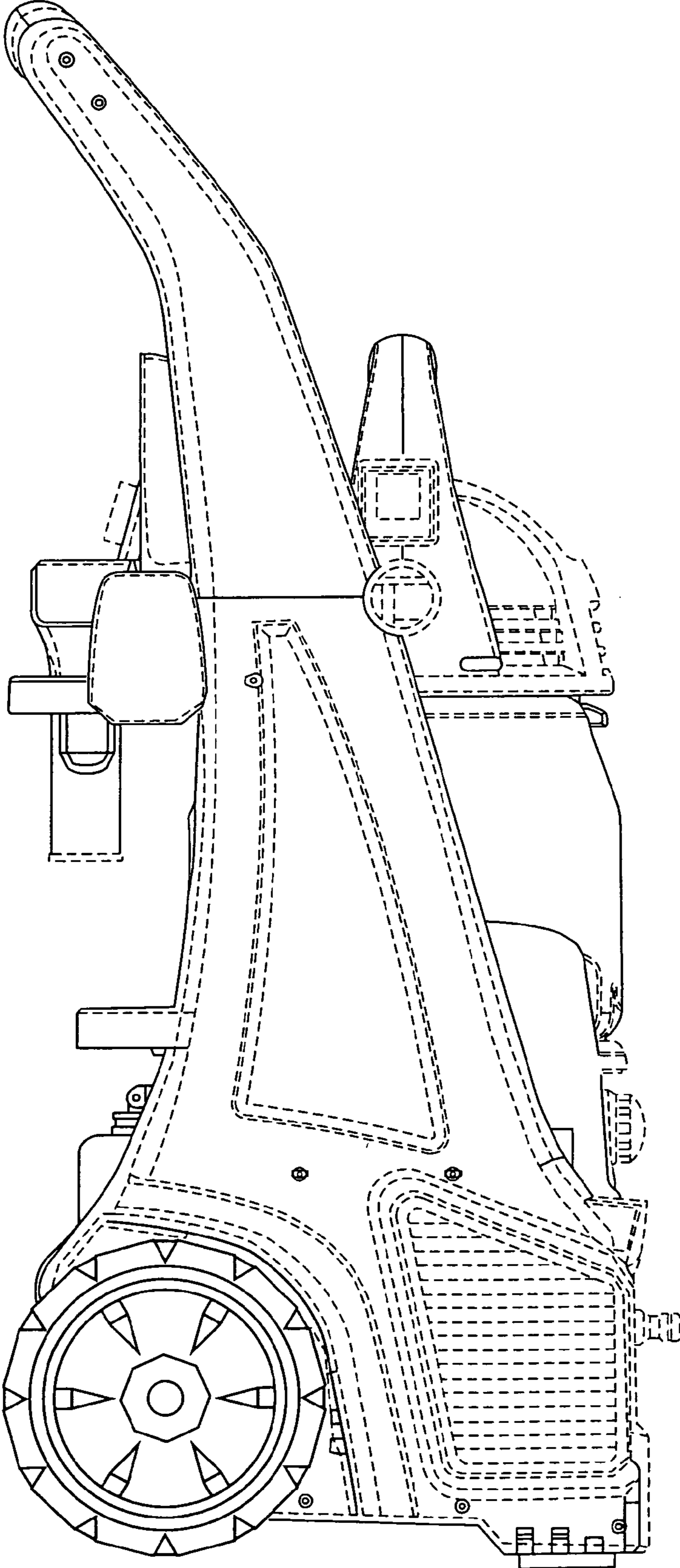
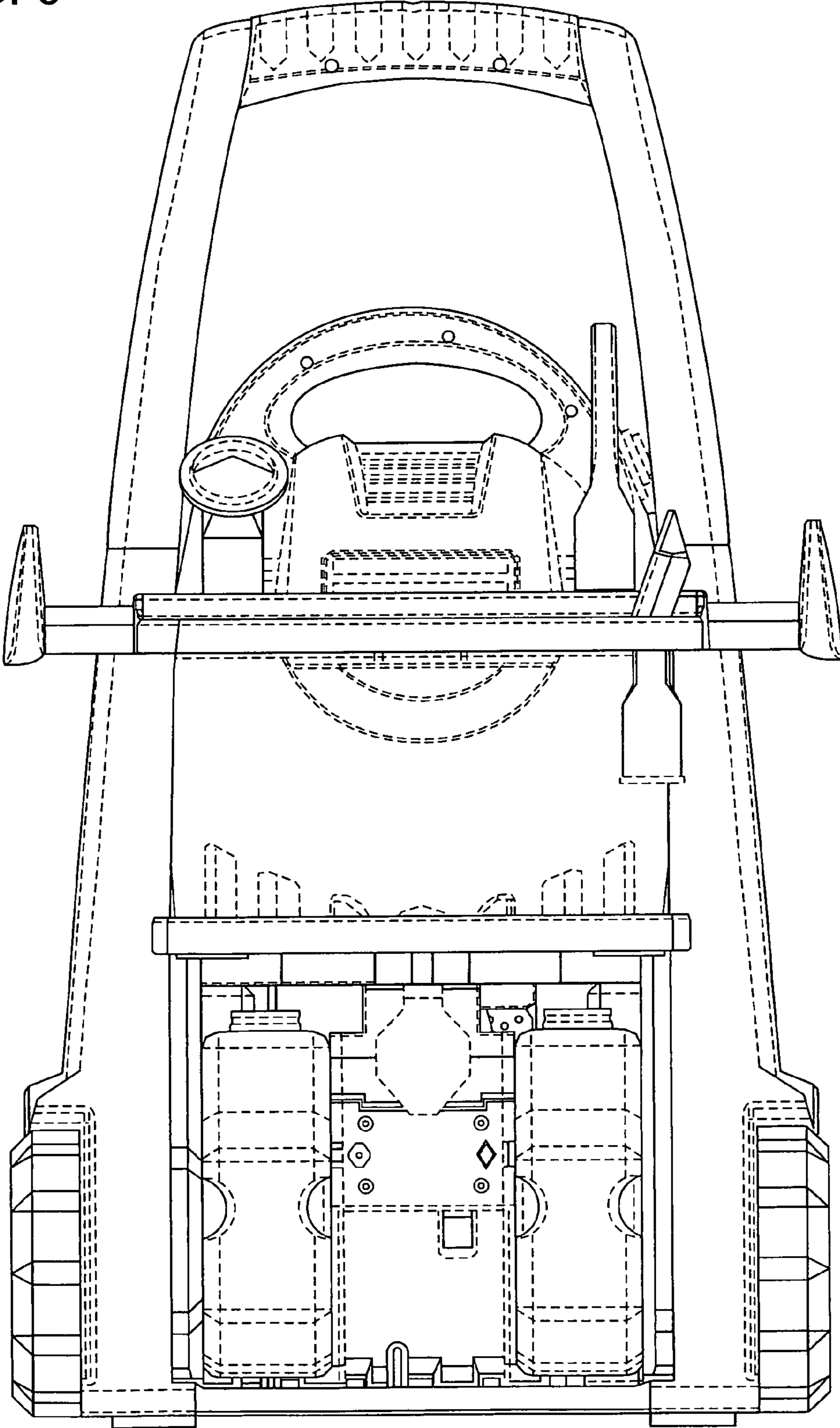

FIG. 6



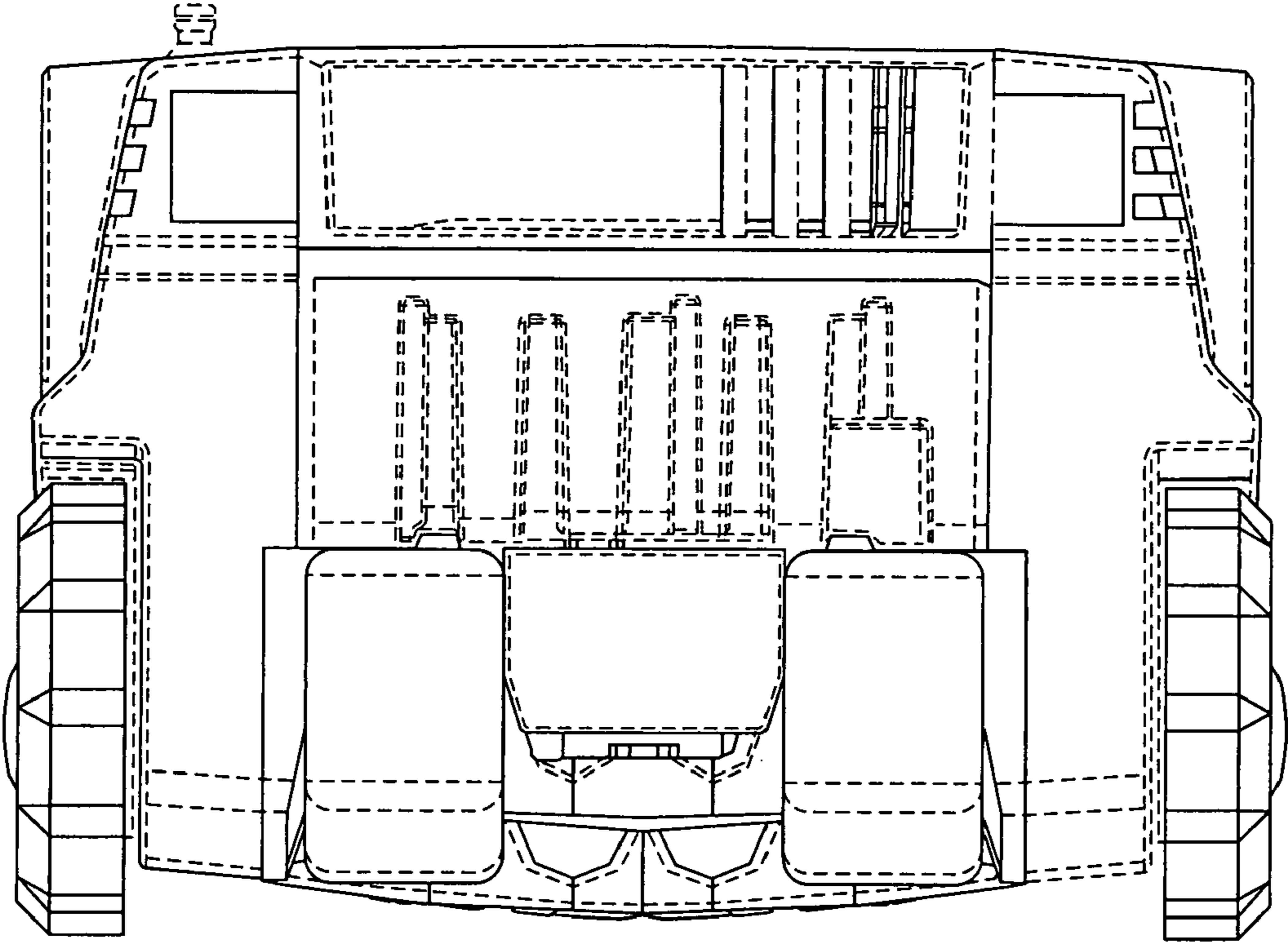

FIG. 7