



US00D573231S

(12) **United States Design Patent**  
**Kulig**

(10) **Patent No.:** **US D573,231 S**  
(45) **Date of Patent:** **\*\* Jul. 15, 2008**

(54) **FAUCET**

(75) Inventor: **Zbigniew Kulig**, Wadsworth, IL (US)

(73) Assignee: **Graff Faucets**, Milwaukee, WI (US)

(\*\*) Term: **14 Years**

(21) Appl. No.: **29/279,192**

(22) Filed: **Apr. 23, 2007**

(51) **LOC (8) Cl.** ..... **23-01**

(52) **U.S. Cl.** ..... **D23/242**

(58) **Field of Classification Search** ..... D23/200,  
D23/238-257; D6/512, 546, 550; D8/300,  
D8/307-308, 310-312, 321; 4/675-678;  
137/801; 16/110.1, 441

See application file for complete search history.

(56) **References Cited**

**U.S. PATENT DOCUMENTS**

D287,160 S *	12/1986	Rademacher	.....	D23/242
D290,159 S *	6/1987	Jans	.....	D23/242
D290,869 S *	7/1987	Paul	.....	D23/242
D301,056 S *	5/1989	Paul	.....	D23/242
D303,565 S *	9/1989	Paul	.....	D23/242
D308,718 S *	6/1990	Strignano	.....	D23/242
D312,496 S *	11/1990	Strignano	.....	D23/242
D313,066 S *	12/1990	Strignano	.....	D23/242
D317,349 S *	6/1991	Rodstein	.....	D23/242
D510,612 S *	10/2005	Lammel et al.	.....	D23/241
D510,978 S	10/2005	Kulig		
D511,201 S	11/2005	Kulig et al.		
D511,816 S	11/2005	Kulig		
D512,125 S	11/2005	Kulig		

D512,487 S	12/2005	Kulig et al.		
D512,488 S	12/2005	Kulig		
D517,648 S	3/2006	Kulig et al.		
D525,346 S	7/2006	Kulig		
D529,586 S	10/2006	Kulig		
D529,994 S	10/2006	Kulig		
D533,639 S *	12/2006	Hoernig	.....	D23/241

**OTHER PUBLICATIONS**

Kulig, U.S. Appl. No. 29/200,369, filed Feb. 26, 2004, entitled "Faucet".

\* cited by examiner

*Primary Examiner*—Robert A. Delehanty

*Assistant Examiner*—Mark Cavanna

(74) *Attorney, Agent, or Firm*—Boyle Fredrickson S.C.

(57) **CLAIM**

The ornamental design for a faucet, as shown and described.

**DESCRIPTION**

FIG. 1 is perspective view of a faucet incorporating my new design, viewed from in front of, above, and from the left side of the faucet;

FIG. 2 is a front elevation view thereof;

FIG. 3 is a rear elevation view thereof;

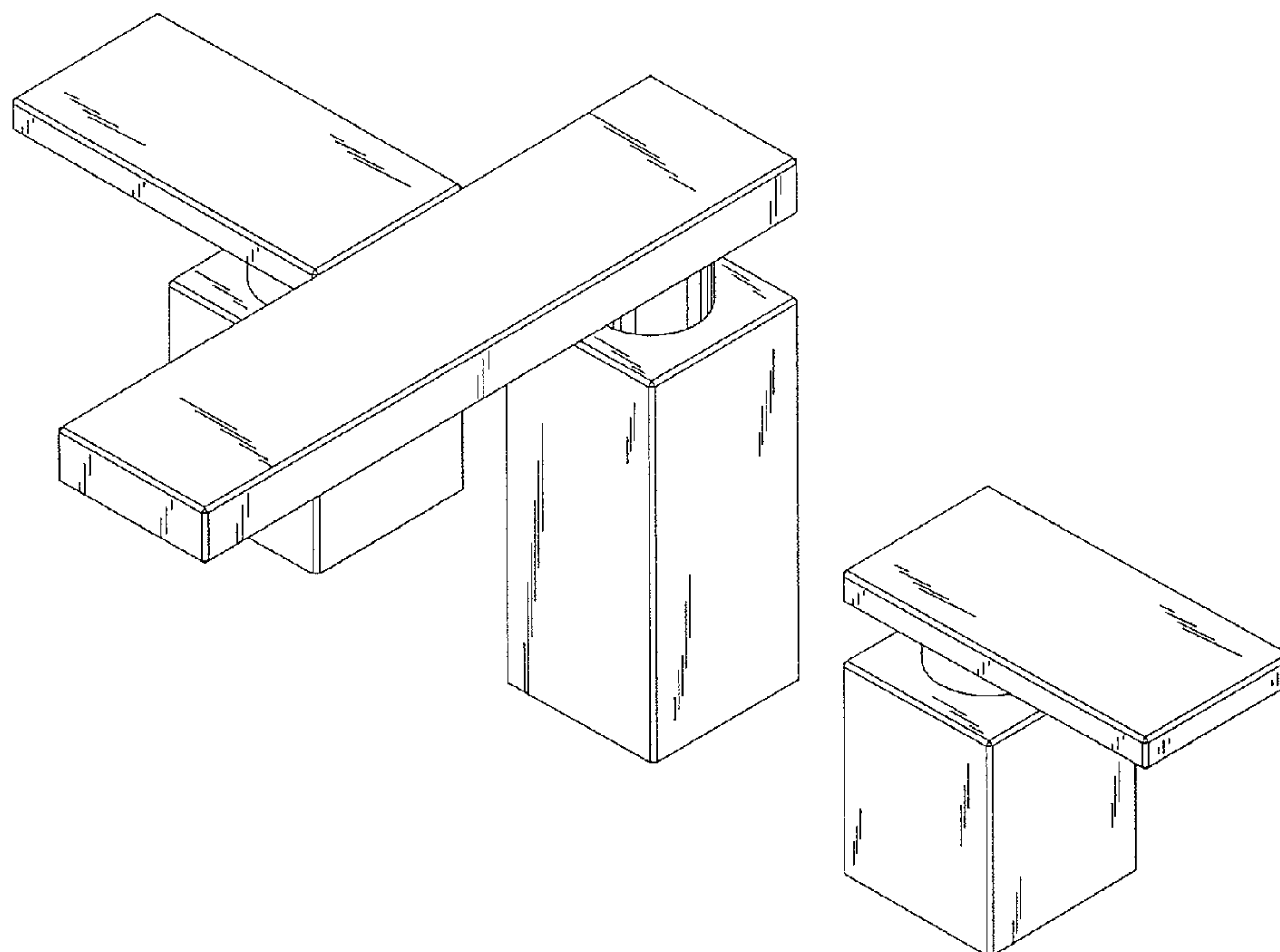
FIG. 4 is a top plan view thereof;

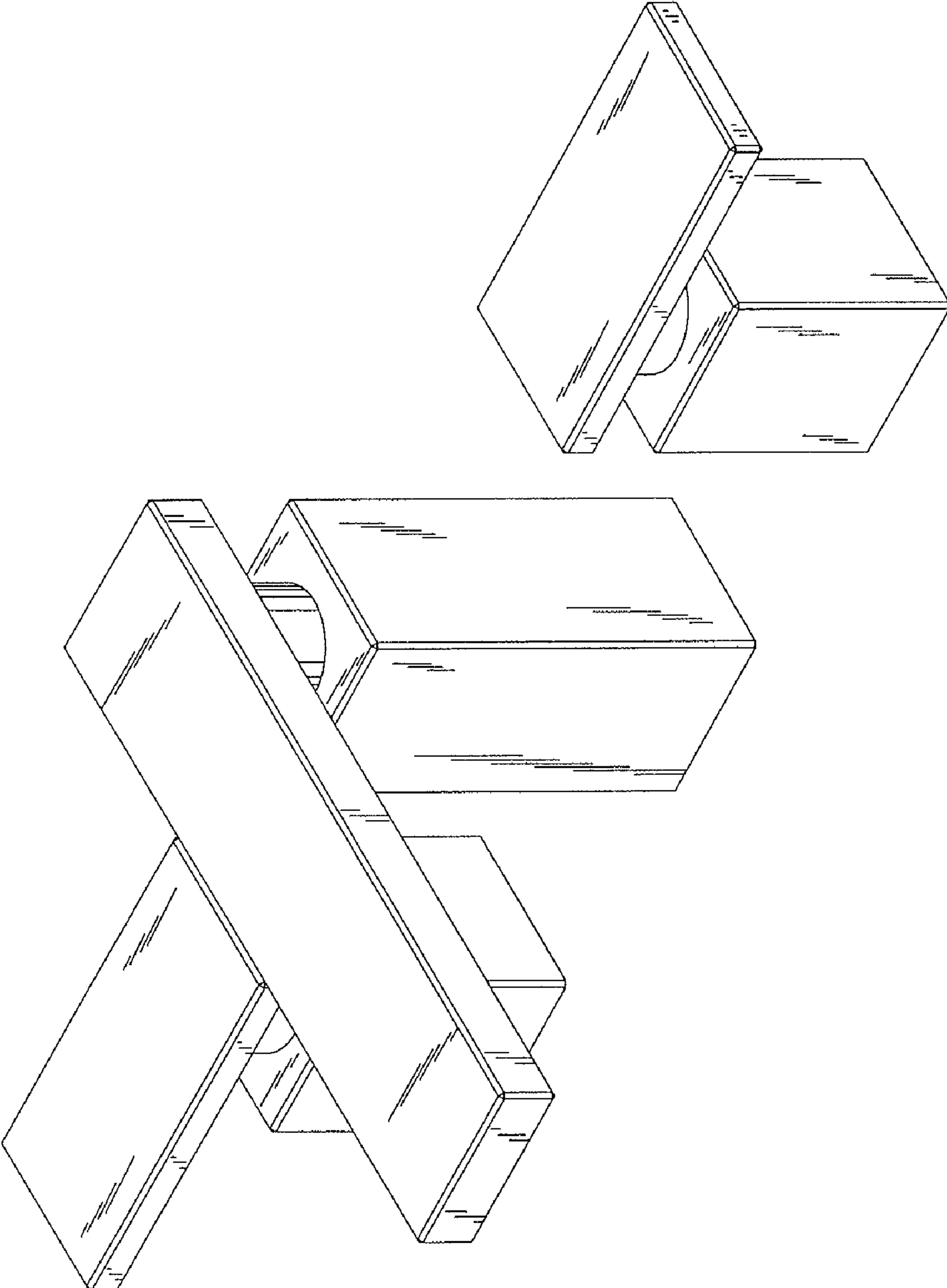
FIG. 5 is a bottom plan view thereof;

FIG. 6 is a left-side elevation view thereof; and,

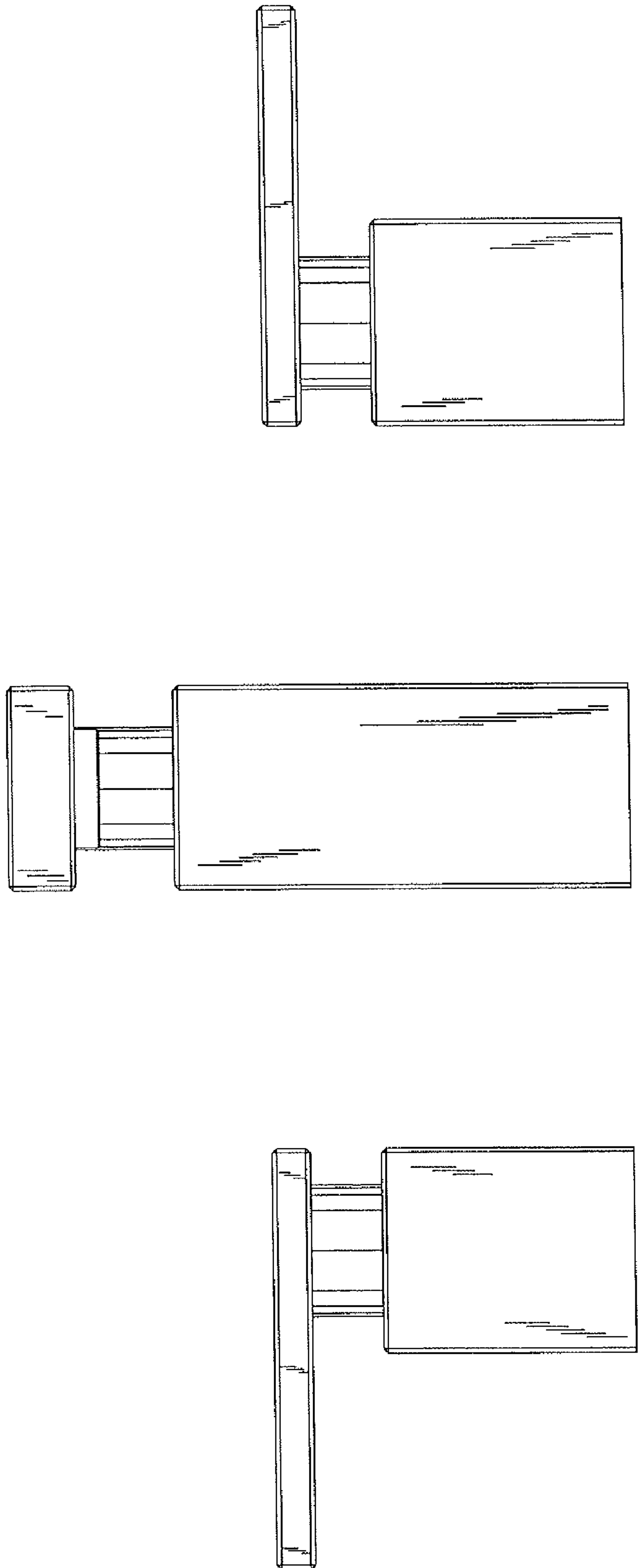
FIG. 7 is a right-side elevation view thereof.

**1 Claim, 7 Drawing Sheets**

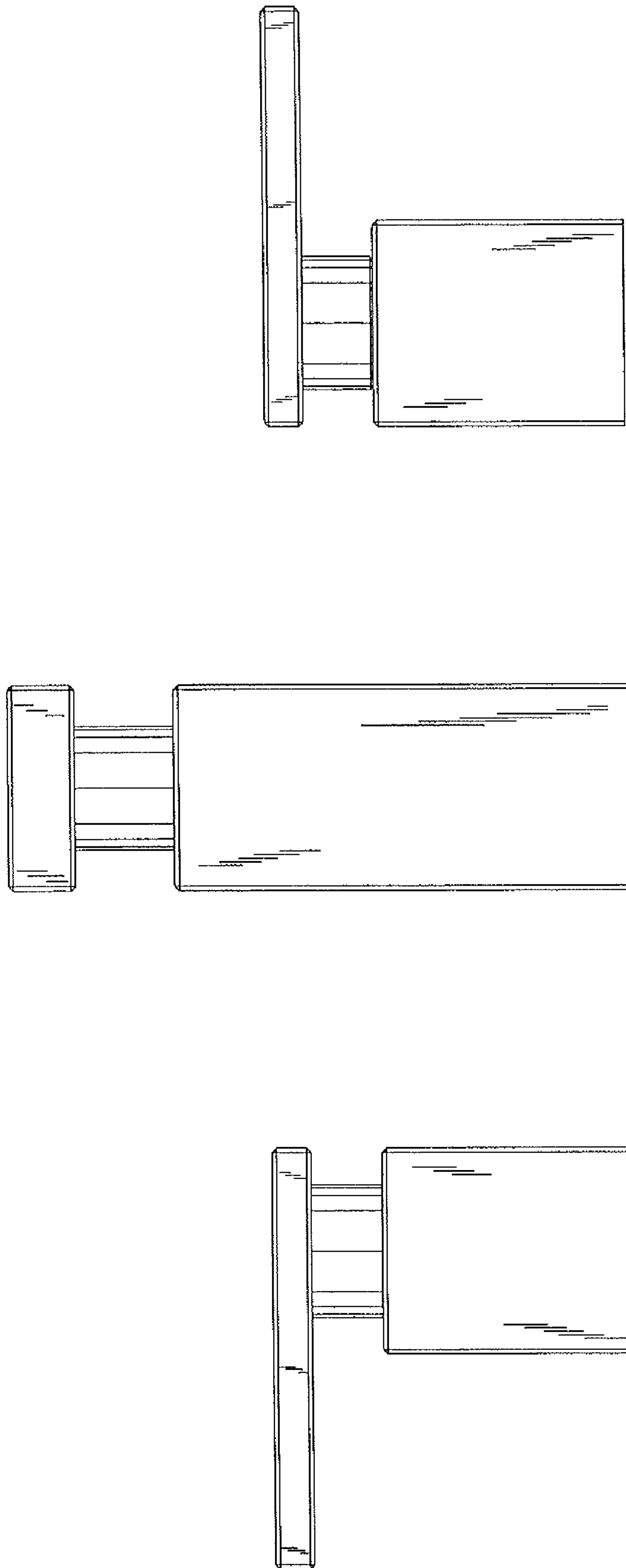




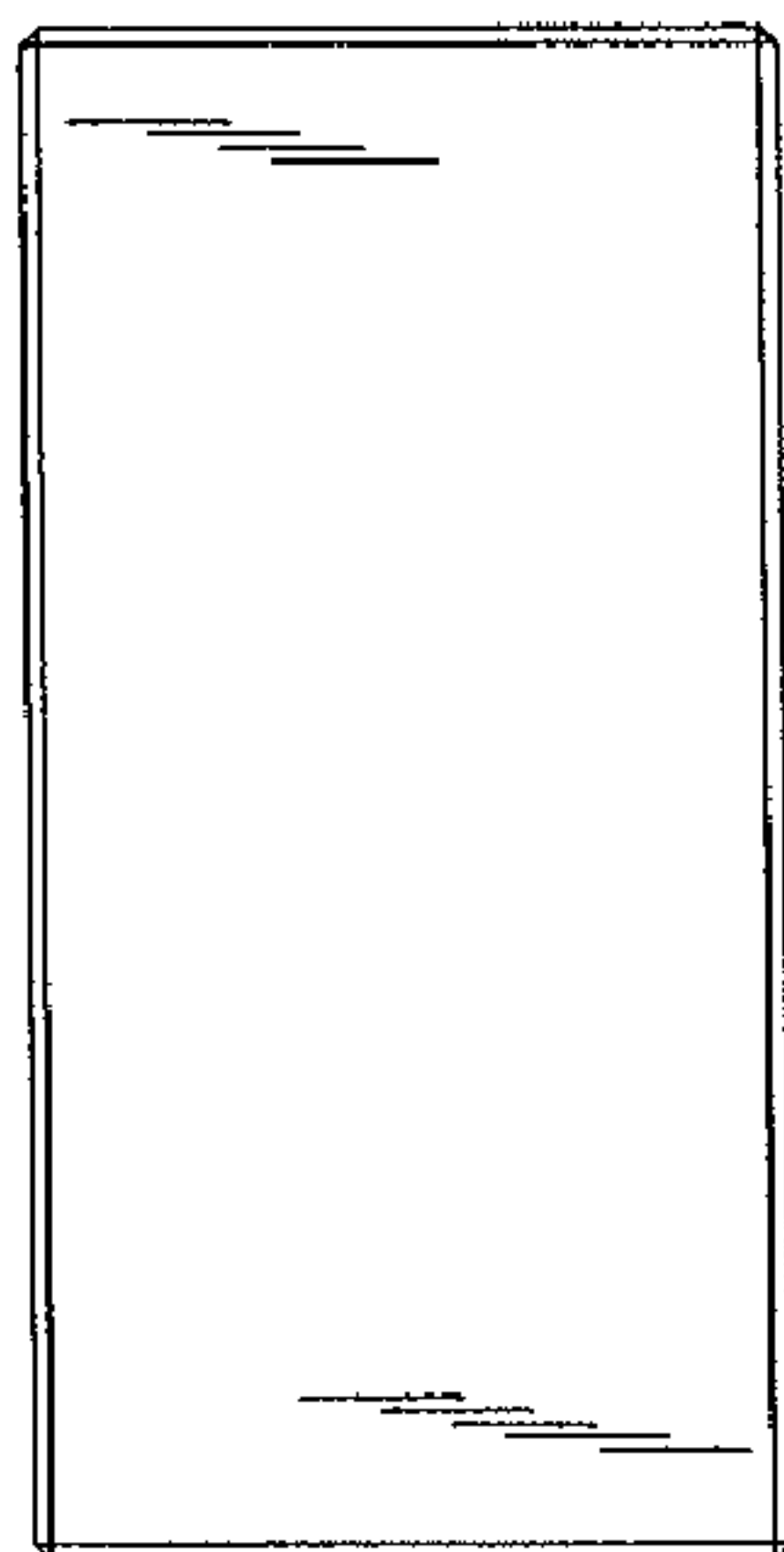
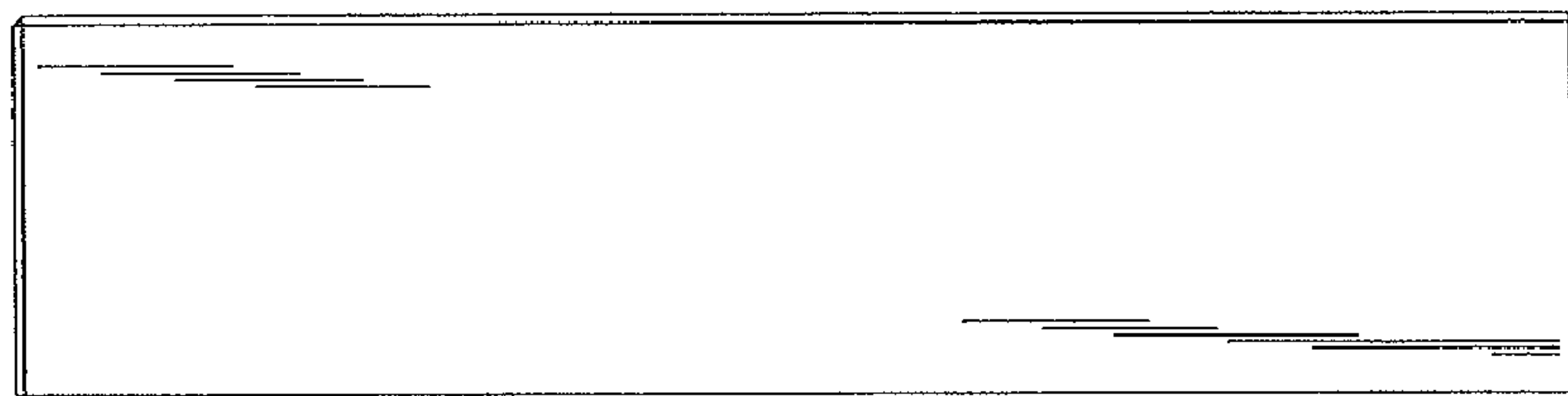
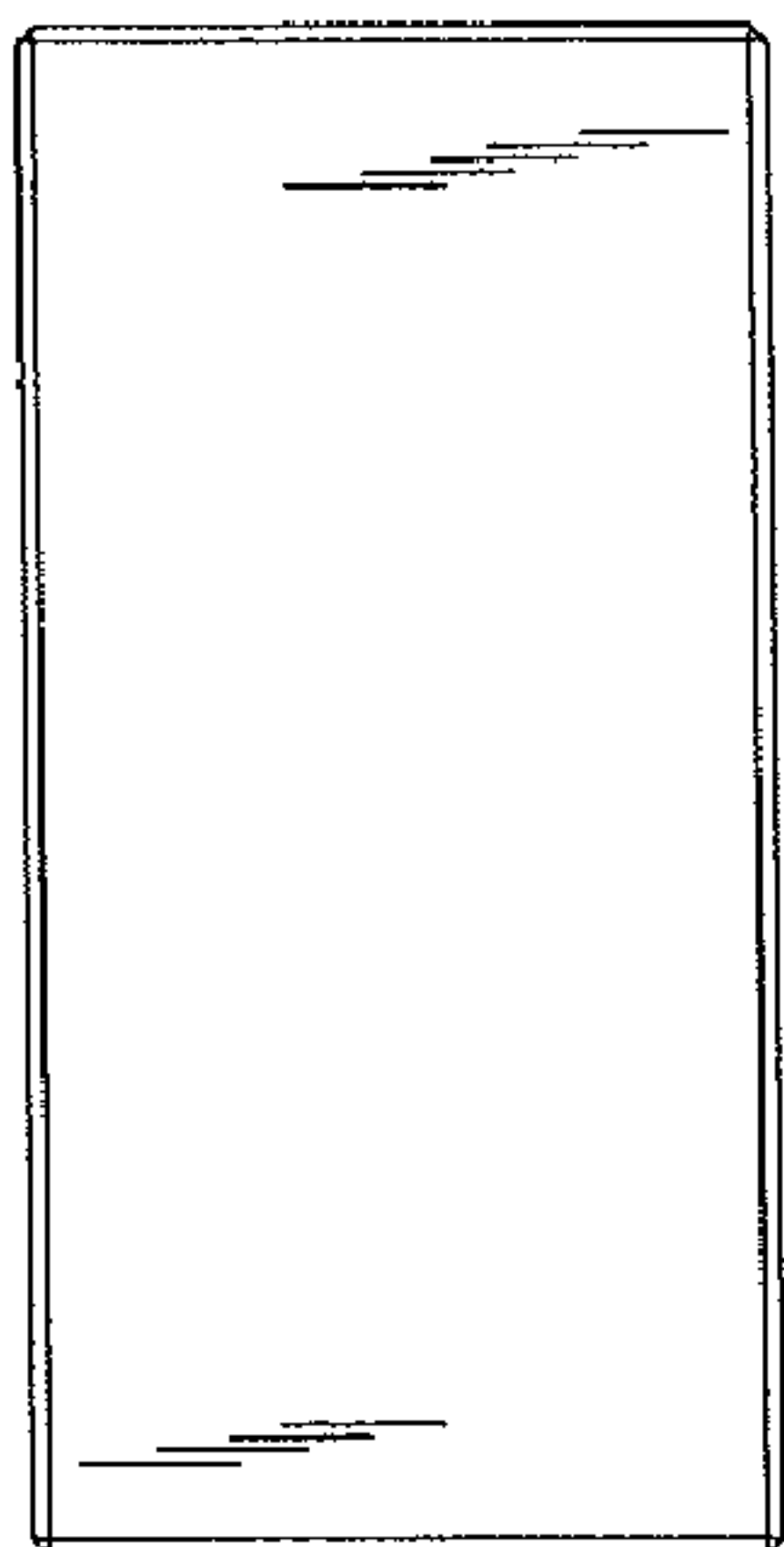
**FIG. 1**



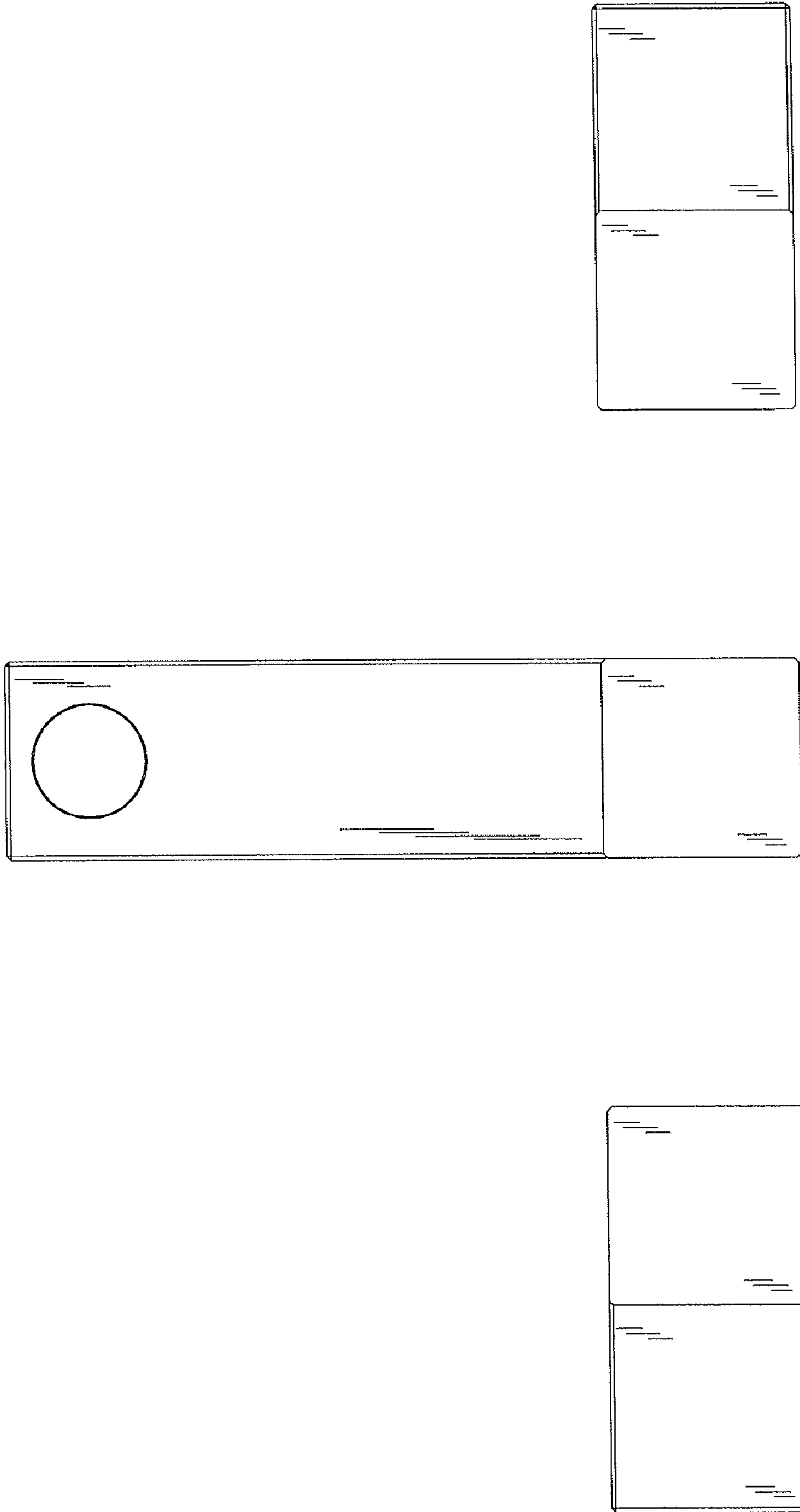
**FIG. 2**



**FIG. 3**



**FIG. 4**



**FIG. 5**

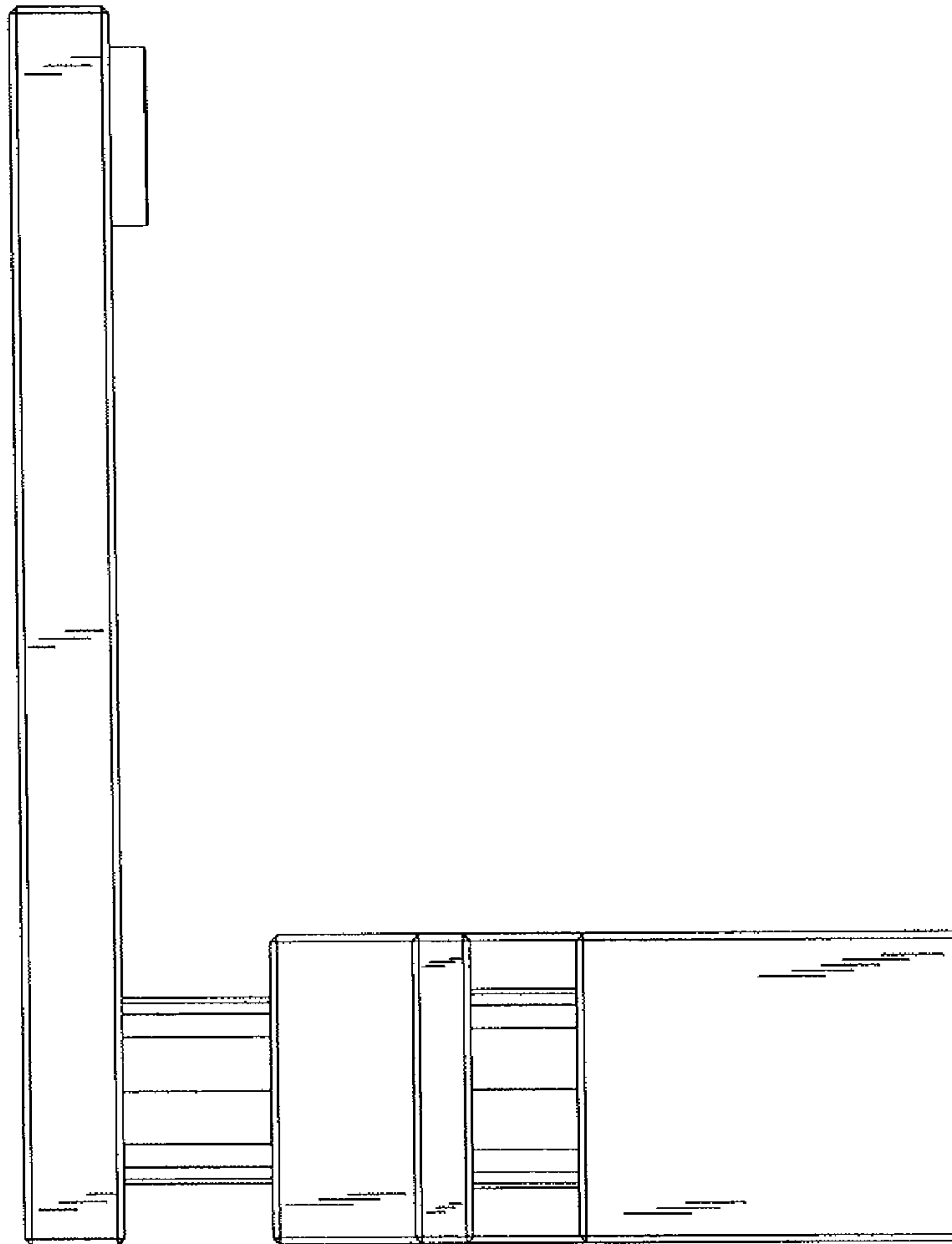
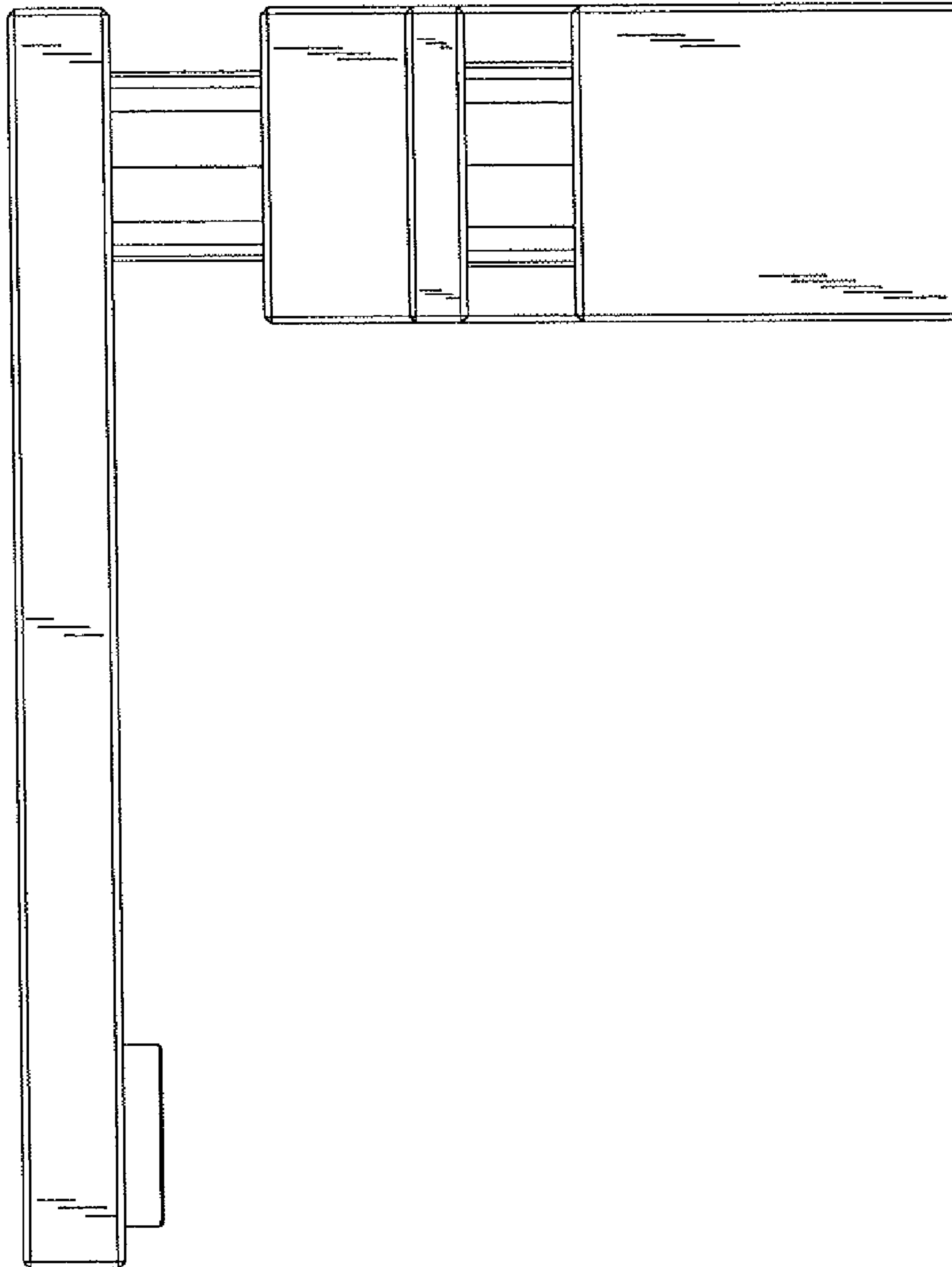


FIG. 6



**FIG. 7**