



US00D572673S

(12) **United States Design Patent**
Kuriyama et al.

(10) **Patent No.:** **US D572,673 S**
(45) **Date of Patent:** **** Jul. 8, 2008**

(54) **ANODE SHAFT**

(75) Inventors: **Fumio Kuriyama**, Tokyo (JP); **Masaaki Kimura**, Tokyo (JP)

(73) Assignee: **Ebara Corporation**, Tokyo (JP)

(**) Term: **14 Years**

(21) Appl. No.: **29/262,882**

(22) Filed: **Jul. 13, 2006**

(51) **LOC (8) Cl.** **13-99**

(52) **U.S. Cl.** **D13/199**

(58) **Field of Classification Search** D13/199,
D13/182, 181, 180, 165, 166; 205/256, 272,
205/284, 292, 336, 375, 399, 400, 528, 576,
205/588, 708, 730, 143, 148, 732, 733, 737,
205/738, 739, 98; 204/297; D24/187, 170,
D24/144, 233

See application file for complete search history.

(56) **References Cited**

U.S. PATENT DOCUMENTS

1,794,942	A *	3/1931	Boyle	29/888.43
D216,286	S *	12/1969	Valeska	D24/144
3,627,670	A *	12/1971	Duclaux	204/297.14
3,739,456	A *	6/1973	Scherer et al.	29/447
4,035,903	A *	7/1977	Taggart	29/458
4,118,291	A *	10/1978	Juckniess et al.	205/400
4,544,464	A *	10/1985	Bianchi et al.	205/724
D337,495	S *	7/1993	Alexander	D8/376
D382,472	S *	8/1997	Davies et al.	D8/400
6,077,412	A *	6/2000	Ting et al.	205/143
6,274,024	B1 *	8/2001	Kaufman et al.	205/96

6,299,751	B1 *	10/2001	Kaufman et al.	205/148
6,365,020	B1	4/2002	Yoshioka et al.		
6,716,332	B1	4/2004	Yoshioka et al.		
6,977,031	B1 *	12/2005	Jakovac et al.	204/280
2003/0010643	A1 *	1/2003	Gramarossa et al.	205/137

* cited by examiner

Primary Examiner—Robert M. Spear

Assistant Examiner—Ania K Dworzecka

(74) *Attorney, Agent, or Firm*—Wenderoth, Lind & Ponack, L.L.P.

(57) **CLAIM**

The ornamental design for an anode shaft, as shown.

DESCRIPTION

FIG. 1 is a front elevation view of an anode shaft;
 FIG. 2 is a rear view of the anode shaft shown in FIG. 1;
 FIG. 3 is a top plan view of the anode shaft shown in FIG. 1;
 FIG. 4 is a bottom plan view of the anode shaft shown in FIG. 1;
 FIG. 5 is a right side view of the anode shaft shown in FIG. 1;
 FIG. 6 is a left side view of the anode shaft shown in FIG. 1;
 FIG. 7 is a perspective view of the anode shaft shown in FIG. 1; and,
 FIG. 8 is an enlarged perspective view of the ends of the anode shaft shown in FIG. 1.

In the drawings, the broken lines immediately adjacent the solid lines represent the boundaries of the claim; all other broken lines depict environmental subject matter only. None of the broken lines form any part of the claimed design.

1 Claim, 6 Drawing Sheets

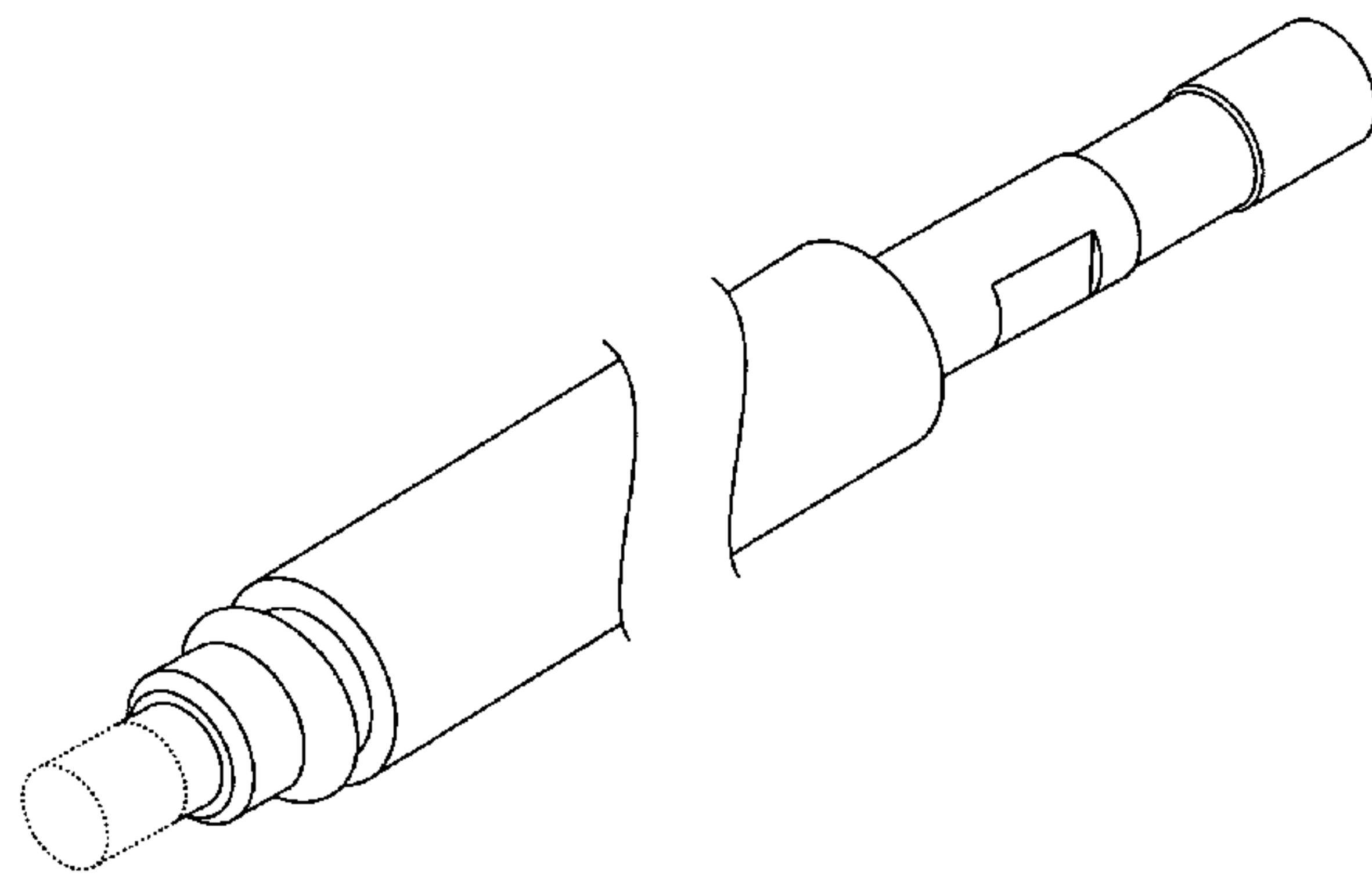
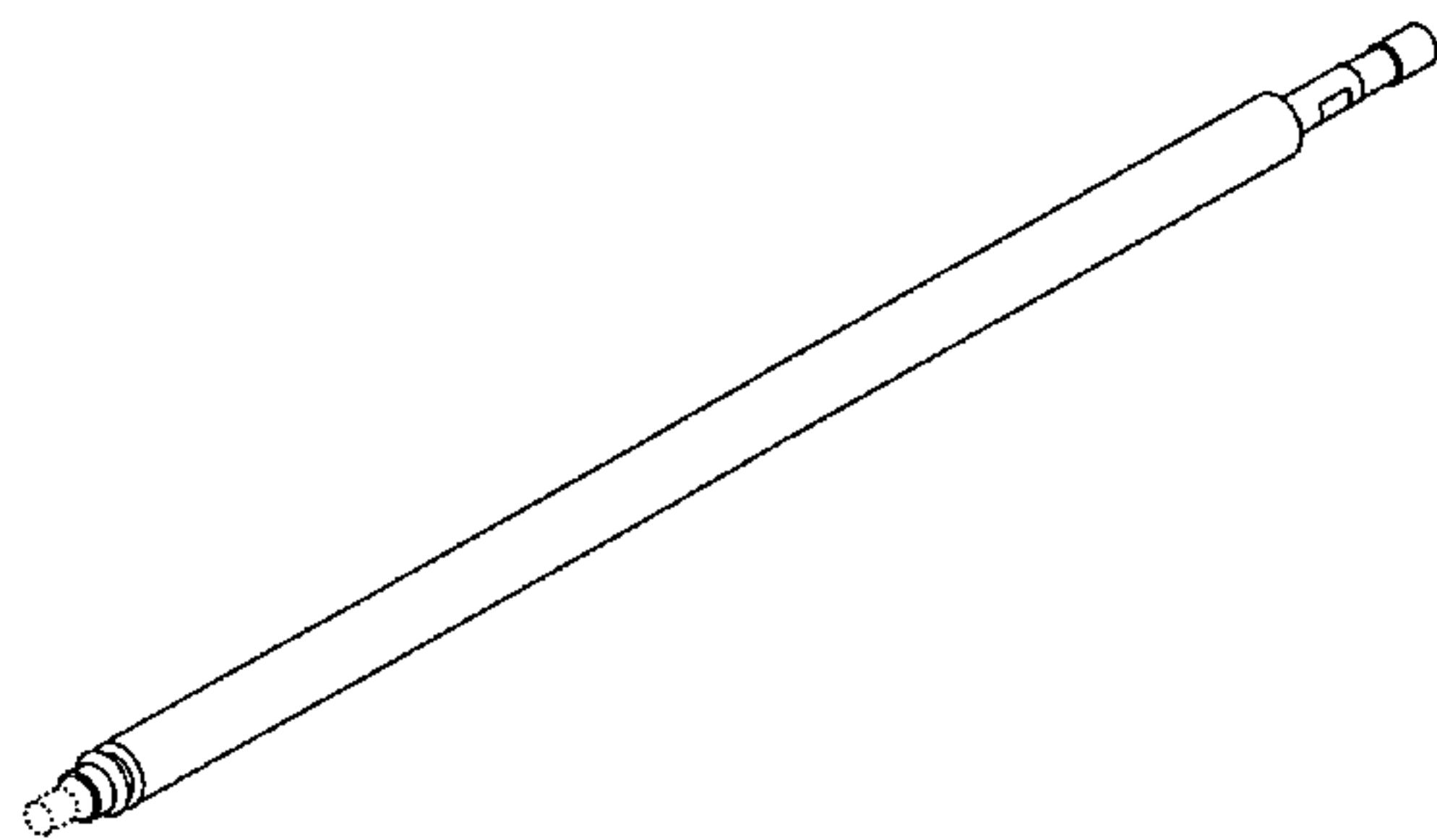

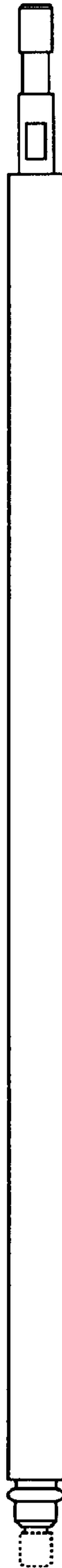

FIG. 1



FIG. 2



FIG. 3



FIG. 4

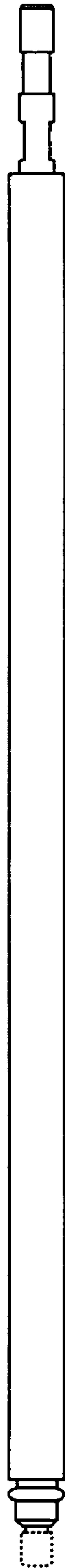

FIG. 5



FIG. 6

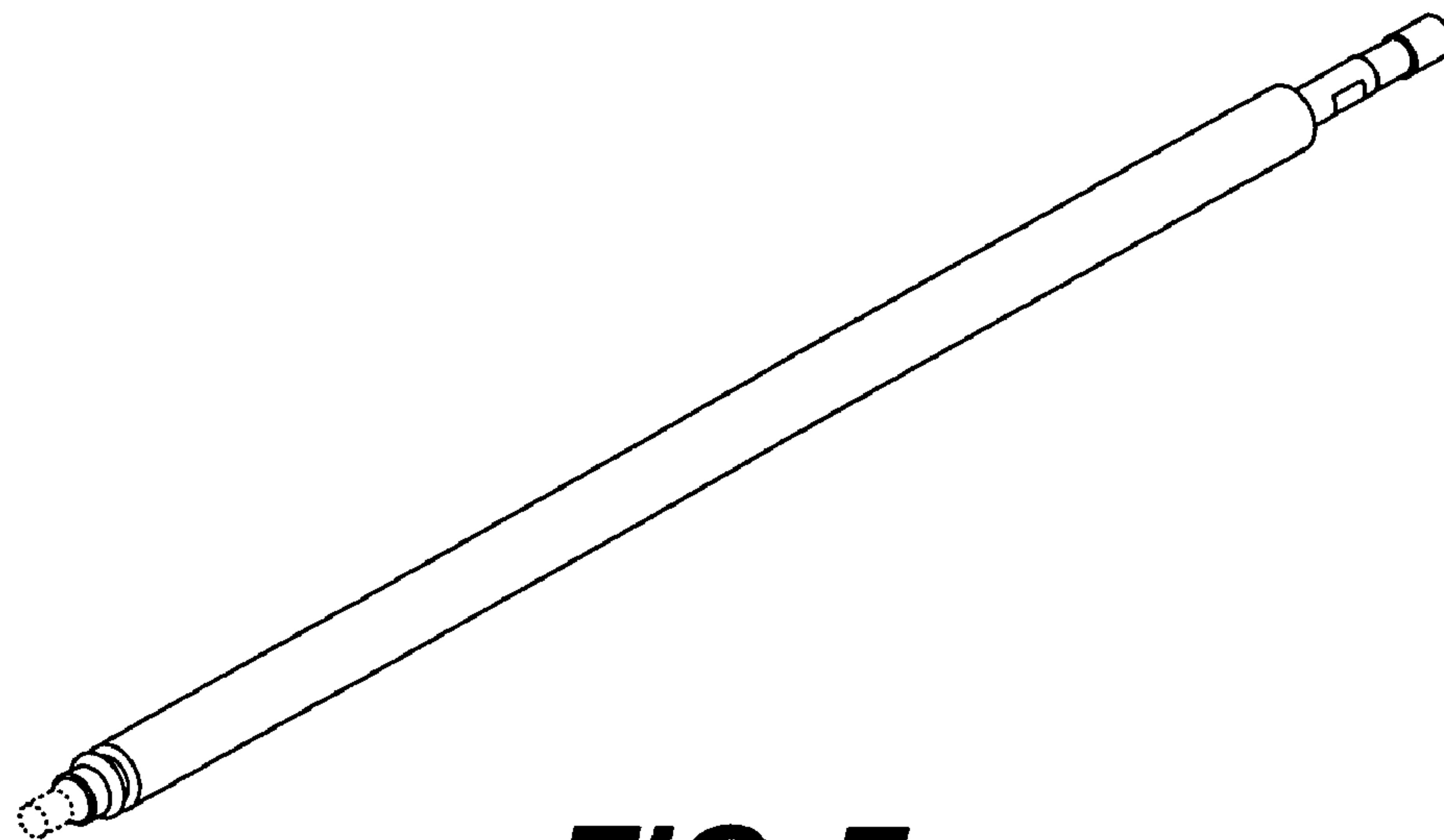

FIG. 7

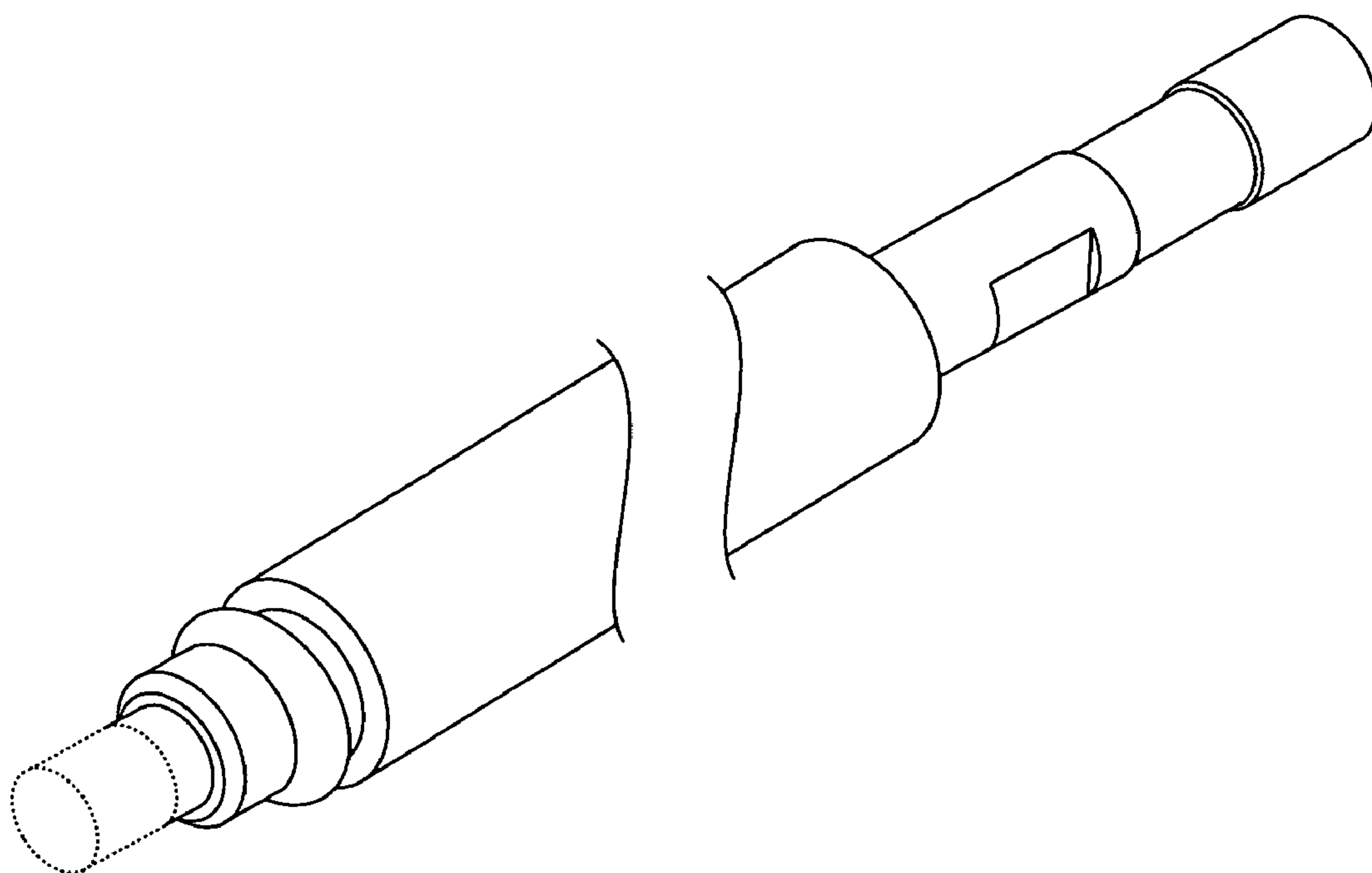

FIG. 8