

US00D572392S

(12) **United States Design Patent**  
**Gale et al.**

(10) **Patent No.:** **US D572,392 S**  
(45) **Date of Patent:** **\*\* Jul. 1, 2008**

(54) **VEHICLE HEADLAMP**

(75) Inventors: **Jeffrey C Gale**, Rochester, MI (US);  
**Timothy W Anness**, Rochester Hills, MI (US)

(73) Assignee: **Chrysler LLC**, Auburn Hills, MI (US)

(\*\*) Term: **14 Years**

(21) Appl. No.: **29/296,199**

(22) Filed: **Oct. 16, 2007**

**Related U.S. Application Data**

(63) Continuation-in-part of application No. 29/249,265, filed on Sep. 29, 2006.

(51) **LOC (8) Cl.** ..... **26-06**

(52) **U.S. Cl.** ..... **D26/28**

(58) **Field of Classification Search** ..... D26/28-36;  
362/459-468, 475-478, 485-487  
See application file for complete search history.

(56) **References Cited**

**U.S. PATENT DOCUMENTS**

D535,763 S \* 1/2007 Pfeiffer ..... D26/28  
D536,113 S \* 1/2007 Pfeiffer ..... D26/28  
D537,180 S \* 2/2007 Hsu ..... D26/28

D540,482 S \* 4/2007 Miwa et al. .... D26/28  
D558,906 S \* 1/2008 Golden et al. .... D26/28  
D559,413 S \* 1/2008 Schiavone et al. .... D26/28

\* cited by examiner

*Primary Examiner*—Marcus A. Jackson

(74) *Attorney, Agent, or Firm*—Ralph E. Smith

(57) **CLAIM**

The ornamental design for a vehicle headlamp, as shown and described.

**DESCRIPTION**

FIG. 1 is a front perspective view of a vehicle right headlamp (as viewed from the front of a vehicle) showing our new design;

FIG. 2 is a rear perspective view thereof;

FIG. 3 is a front view thereof;

FIG. 4 is a rear view thereof;

FIG. 5 is a side view thereof;

FIG. 6 is a top plan view thereof; and,

FIG. 7 is a bottom plan view thereof.

It will be understood that the broken lines presented in the drawings are for illustration only, and do not form a part of the claimed design.

**1 Claim, 7 Drawing Sheets**

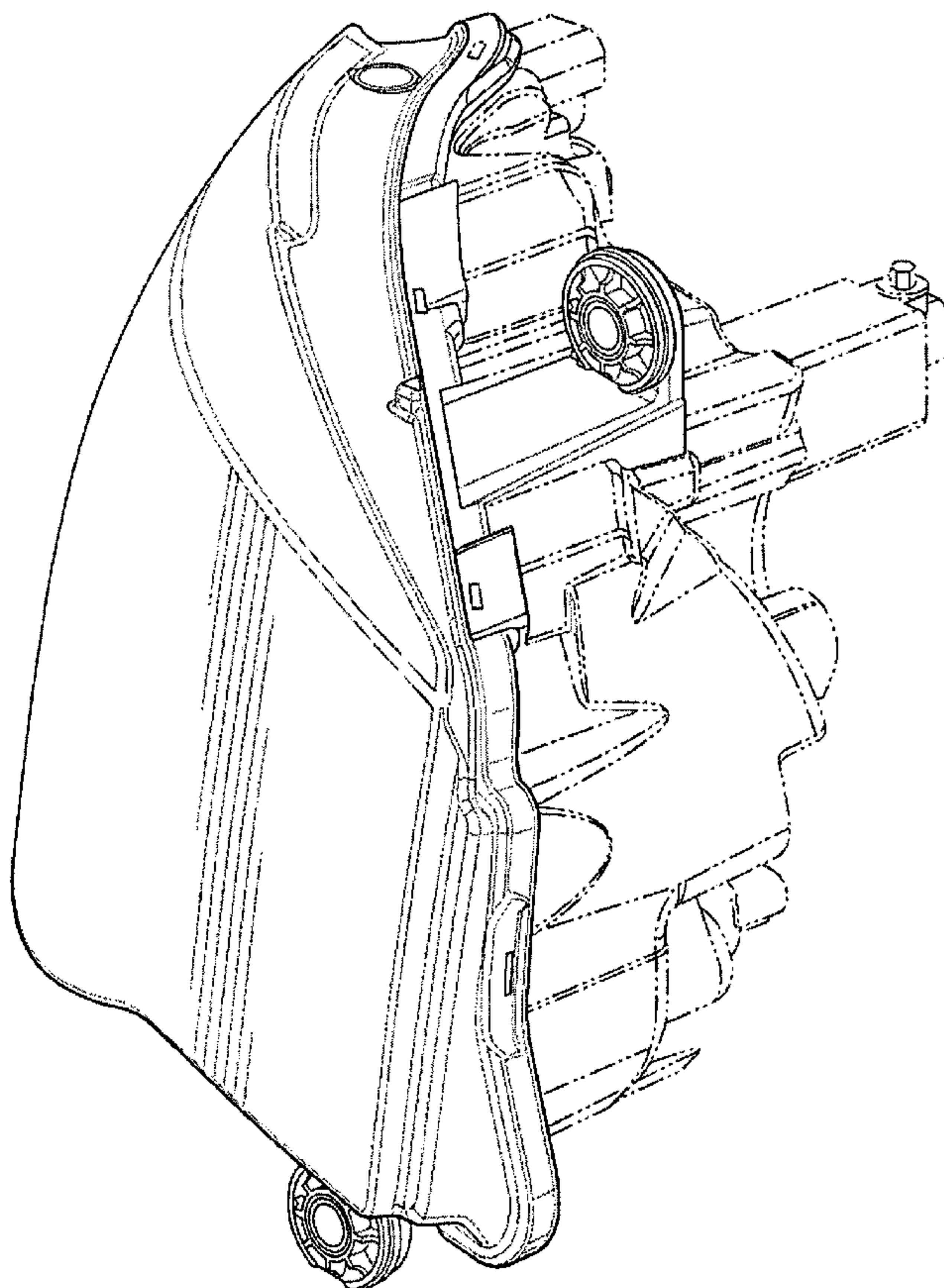

FIG - 1

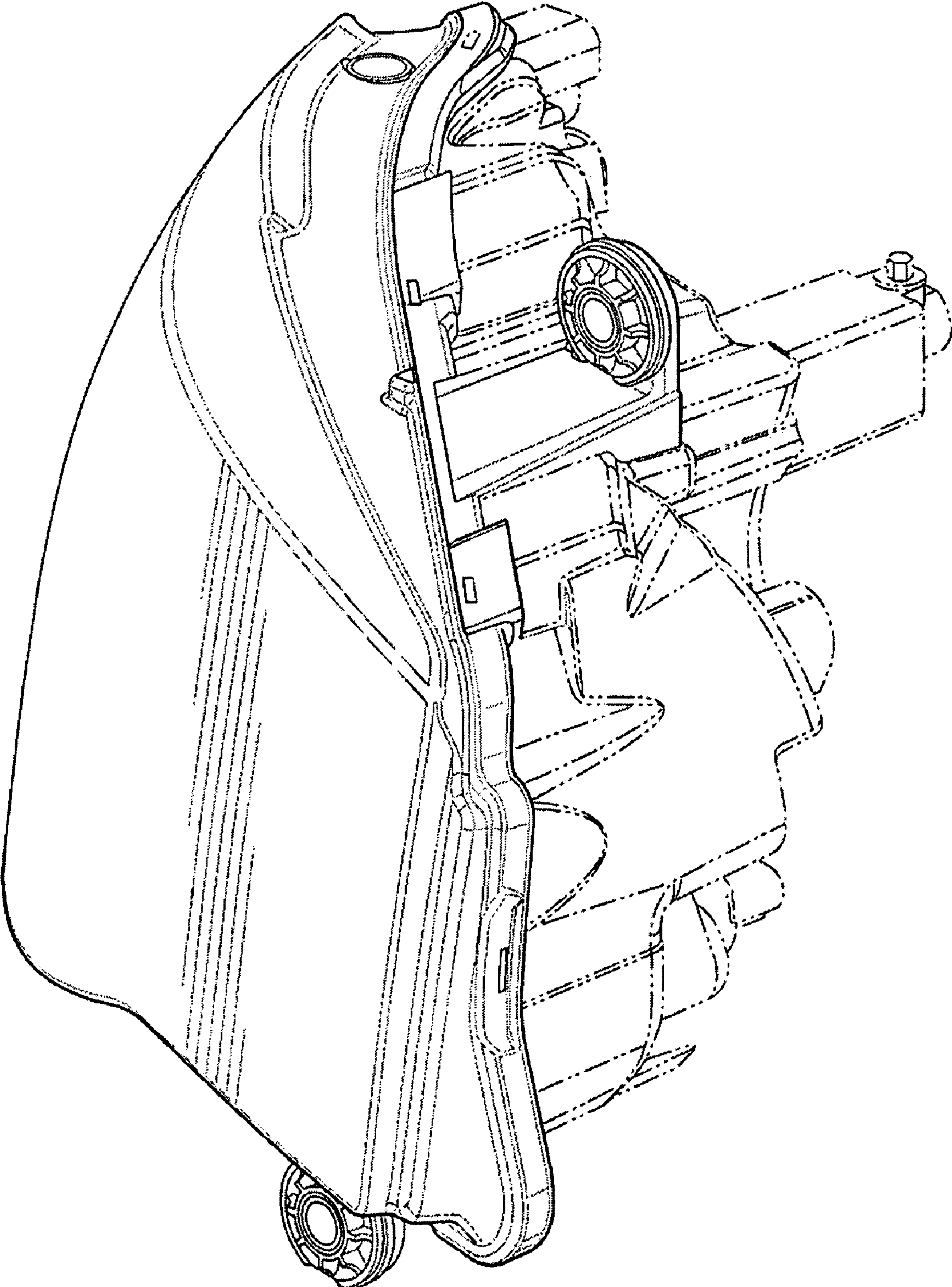
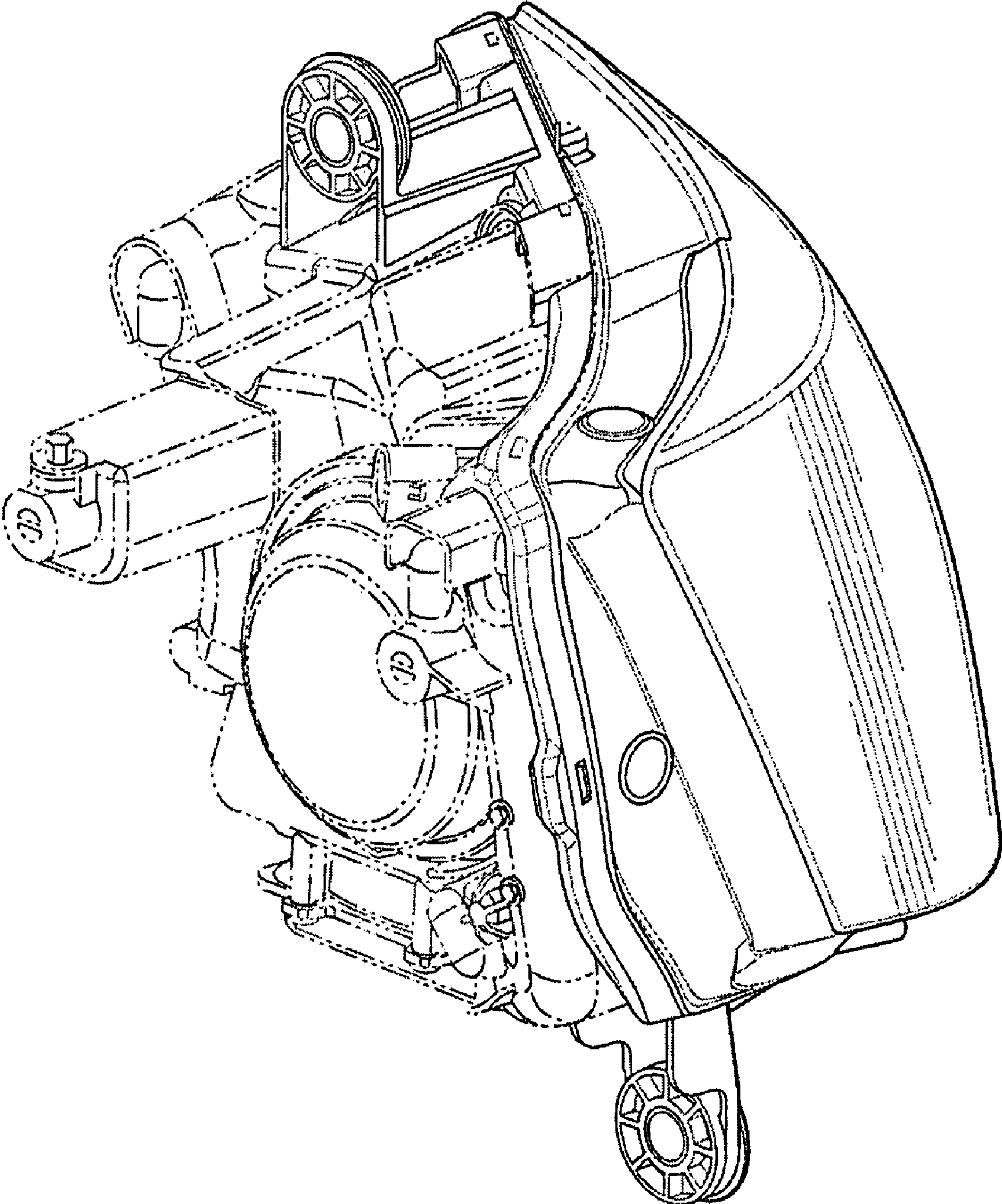



FIG - 2



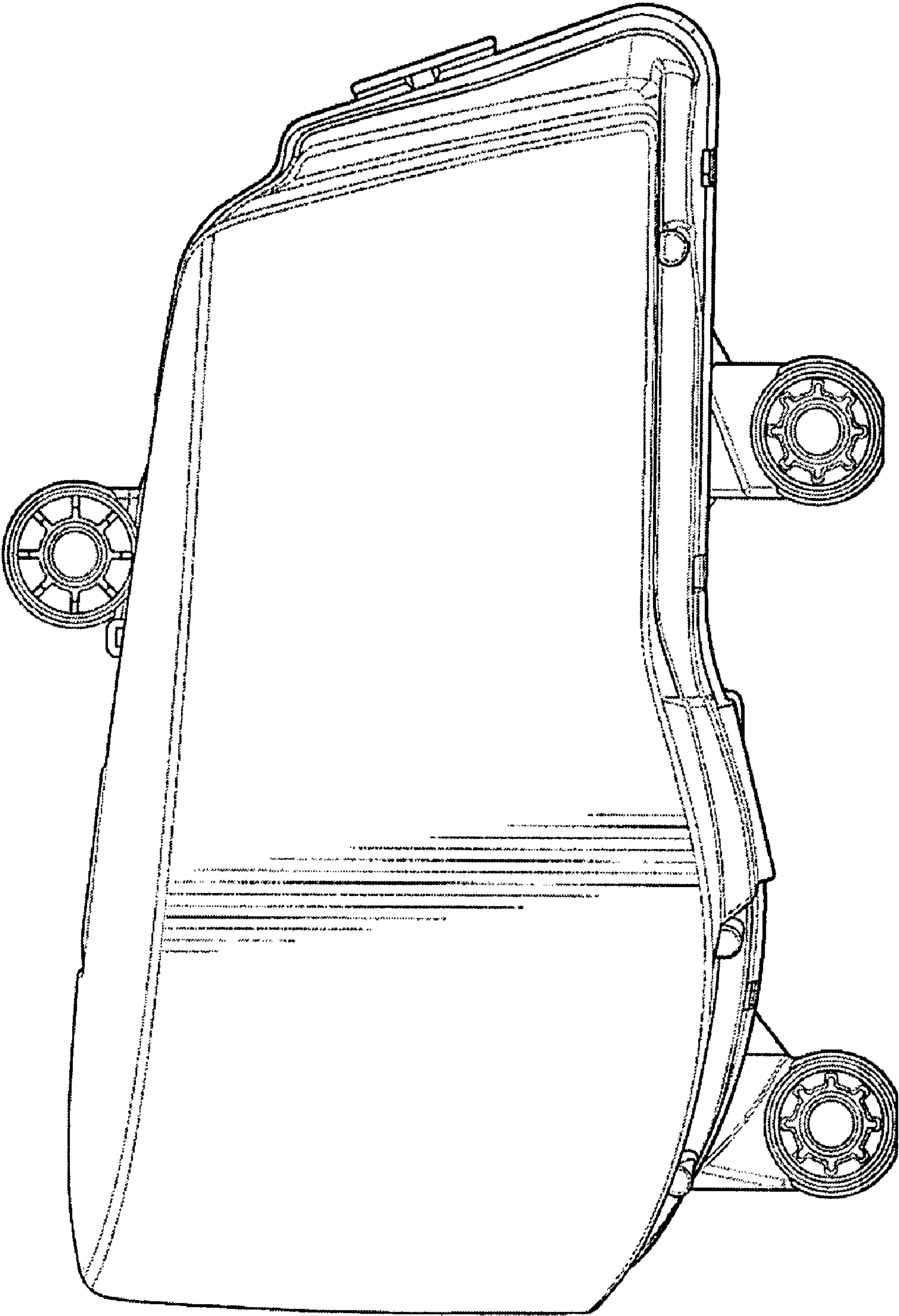

FIG - 3



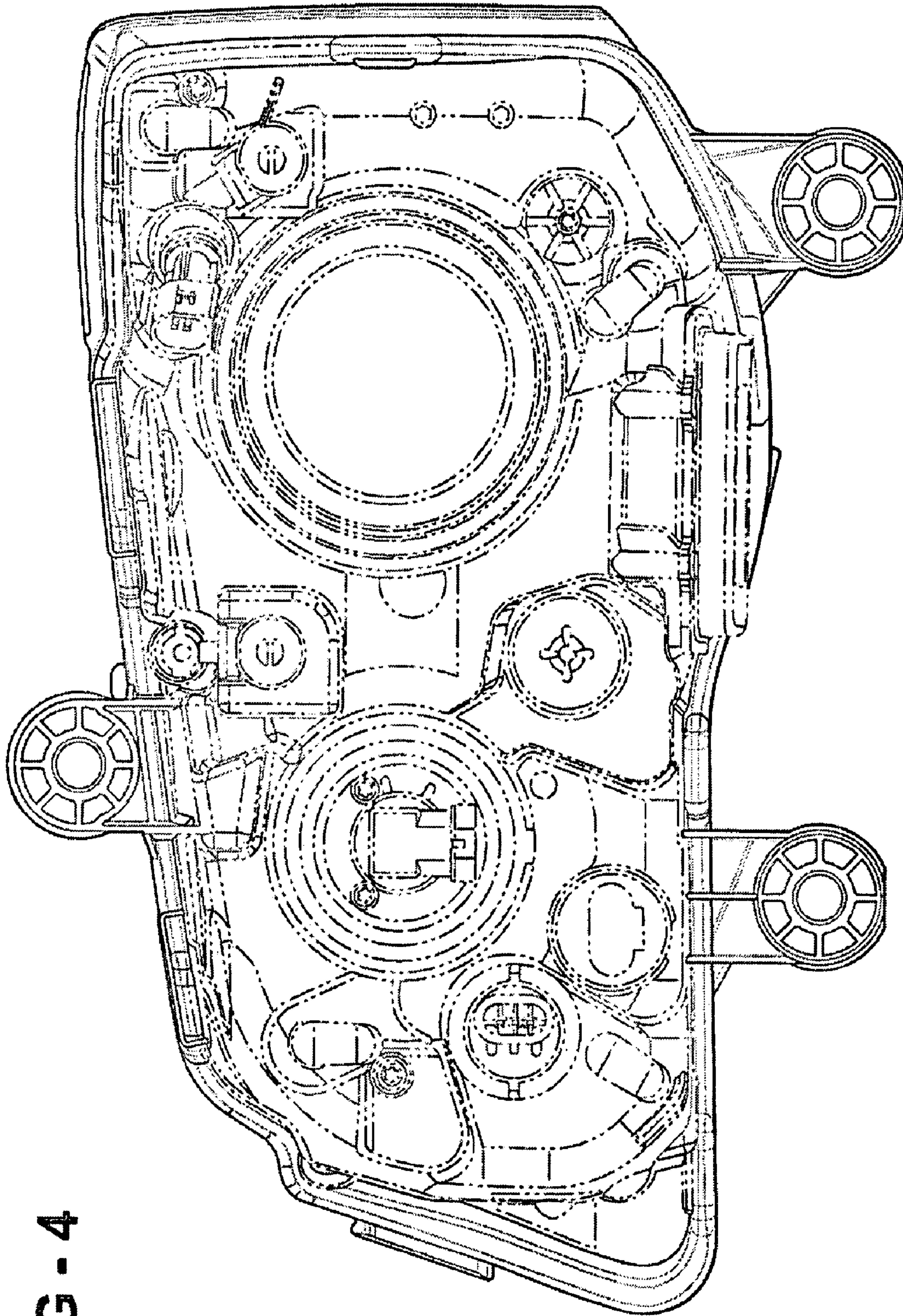

FIG - 4

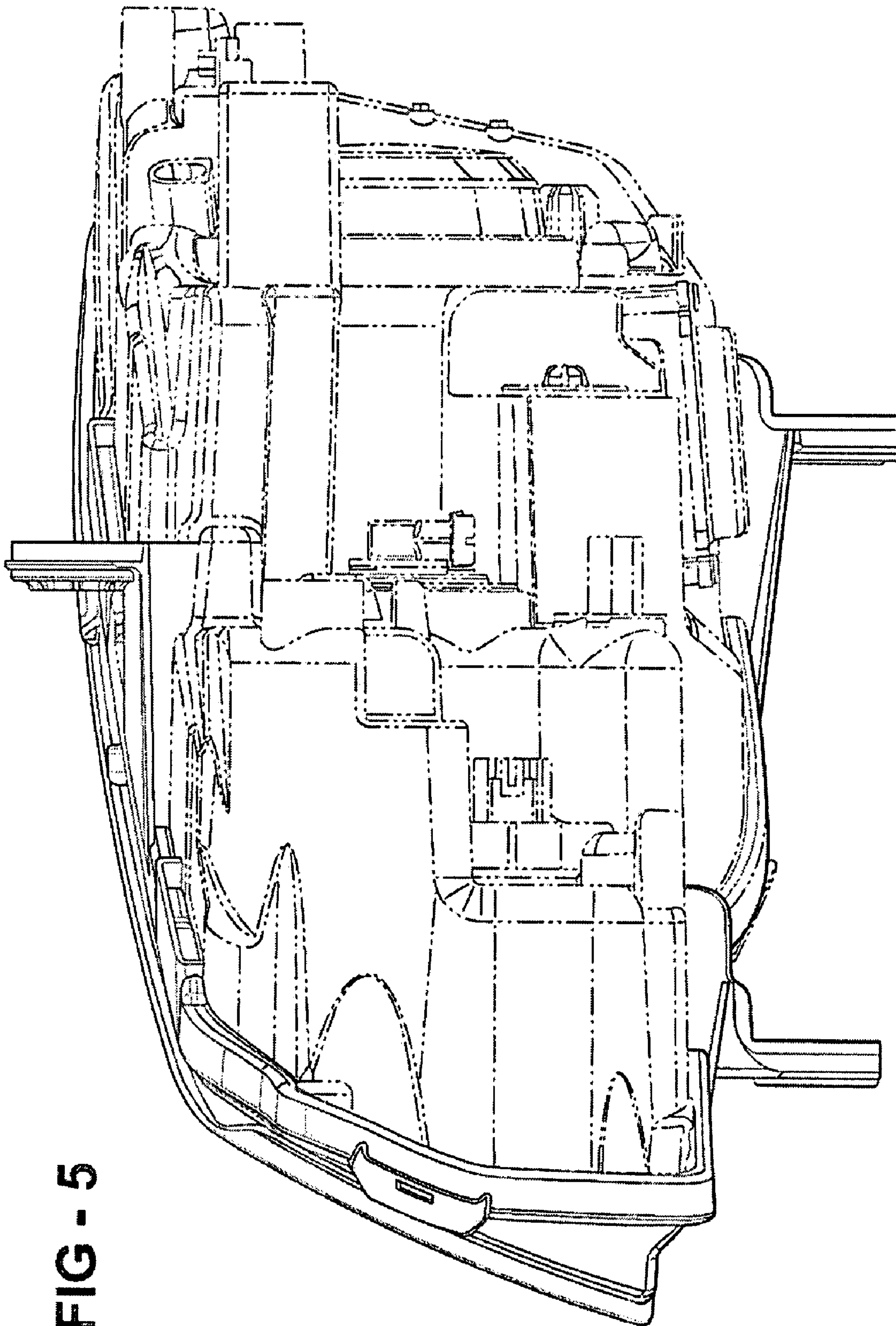

FIG - 5



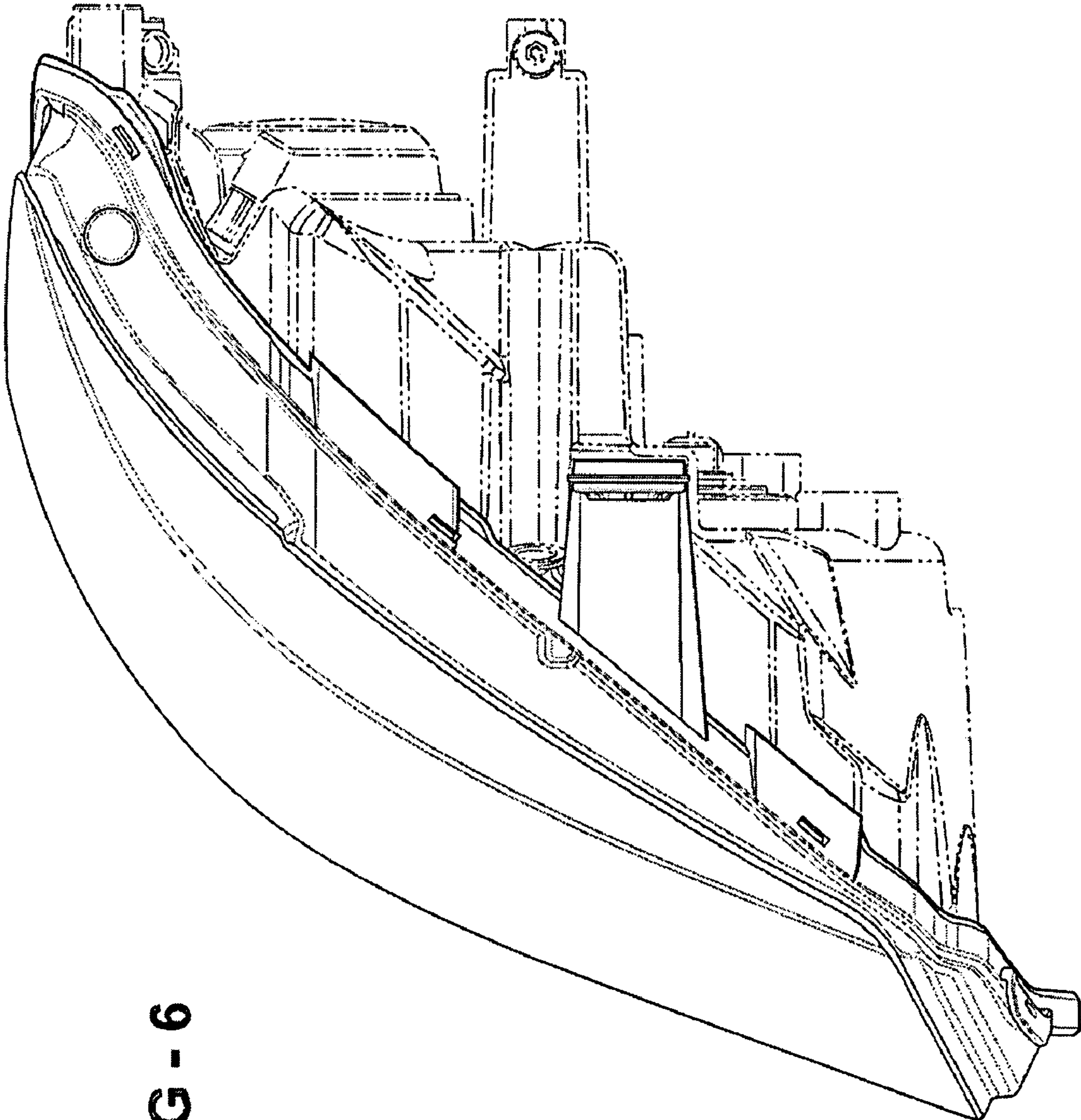

FIG - 6

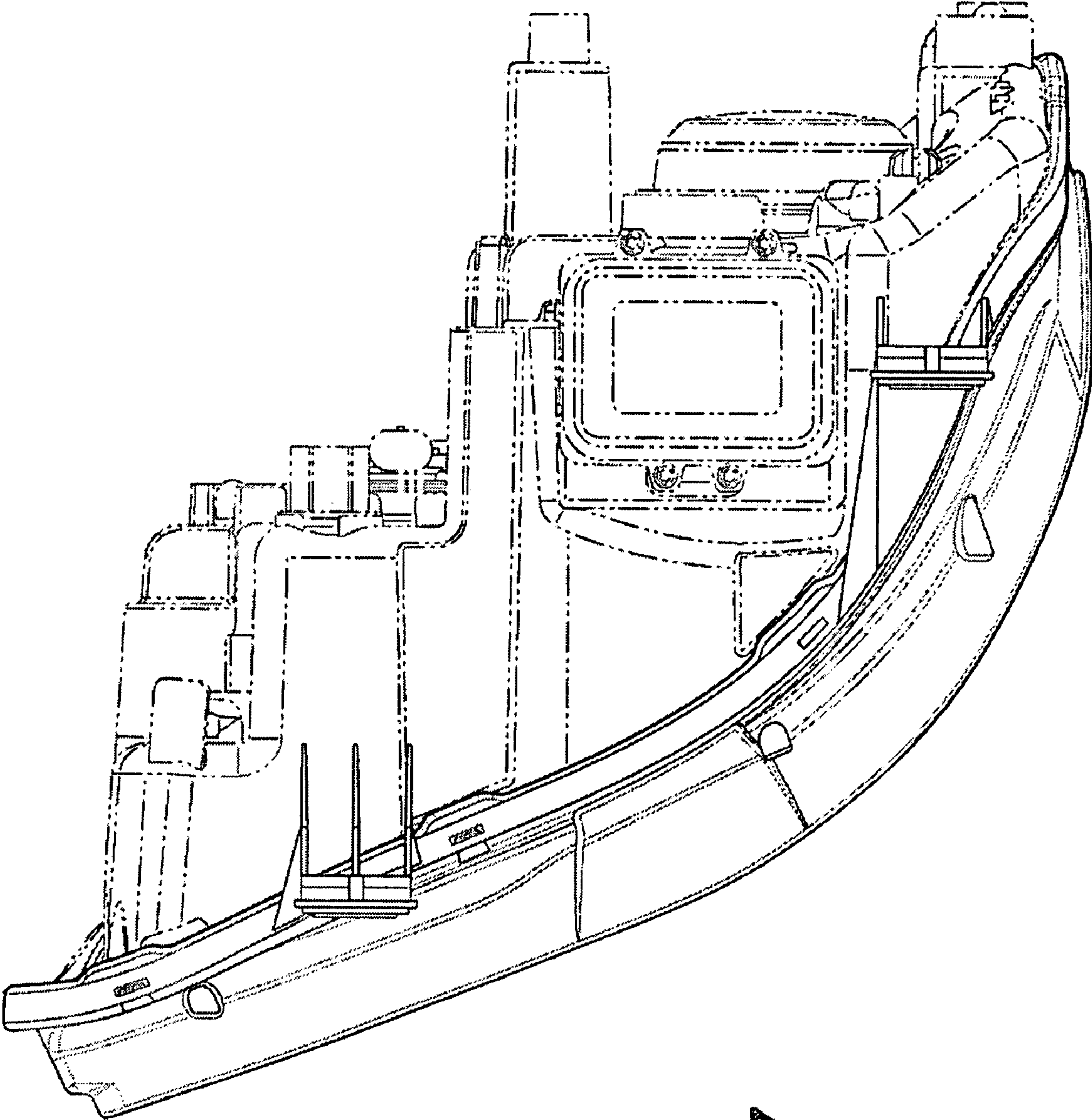

FIG - 7