



US00D571974S

(12) **United States Design Patent**
Shibata et al.

(10) **Patent No.:** **US D571,974 S**
(45) **Date of Patent:** **** Jun. 24, 2008**

(54) **LIQUID CRYSTAL DISPLAY PANEL FOR FORKLIFT TRUCK**

FOREIGN PATENT DOCUMENTS

(75) Inventors: **Naoki Shibata**, Aichi-Ken (JP); **Kumiko Shibata**, Aichi-Ken (JP)

JP 2000-247164 A 9/2000
JP 2002-247706 A 8/2002

(73) Assignee: **Mitsubishi Heavy Industries, Ltd.**, Tokyo (JP)

* cited by examiner

(**) Term: **14 Years**

Primary Examiner—Cynthia E Ramirez
(74) *Attorney, Agent, or Firm*—Birch, Stewart, Kolasch & Birch, LLP

(21) Appl. No.: **29/273,007**

(57) **CLAIM**

(22) Filed: **Feb. 26, 2007**

The ornamental design for a liquid crystal display panel for forklift truck, as shown and described.

(30) **Foreign Application Priority Data**

DESCRIPTION

Aug. 29, 2006 (JP) 2006-022855

(51) **LOC (8) Cl.** **12-05**

(52) **U.S. Cl.** **D34/35**

(58) **Field of Classification Search** D34/34,
D34/35; 180/90, 287; 296/70; D15/28;
D12/192; D14/247; D10/103, 125

See application file for complete search history.

FIG. 1 is a front view of the liquid crystal display panel for forklift truck showing our new design:

FIG. 2 is a rear view thereof:

FIG. 3 is left side view thereof:

FIG. 4 is a right side view thereof:

FIG. 5 is a top(plan) view thereof:

FIG. 6 is a bottom view thereof:

FIG. 7 is a first reference diagram illustrating a usage state;

FIG. 8 is a second reference diagram illustrating a usage state;

FIG. 9 is a first reference diagram illustrating an attached state; and,

FIG. 10 is a second reference diagram illustrating an attached state.

The broken lines shown in the Figures are for illustrative purposes only and form no part of the claimed design.

(56) **References Cited**

U.S. PATENT DOCUMENTS

D382,569 S * 8/1997 Esposito D15/28
D407,075 S * 3/1999 Wung D14/335
6,039,141 A * 3/2000 Denny 180/329
D434,425 S * 11/2000 Rossow et al. D15/28
D439,257 S * 3/2001 Rossow et al. D15/28
D497,394 S * 10/2004 Svanson et al. D21/329
D512,670 S * 12/2005 Pfeiffer et al. D12/192
D542,504 S * 5/2007 Yanagida et al. D34/35

1 Claim, 10 Drawing Sheets

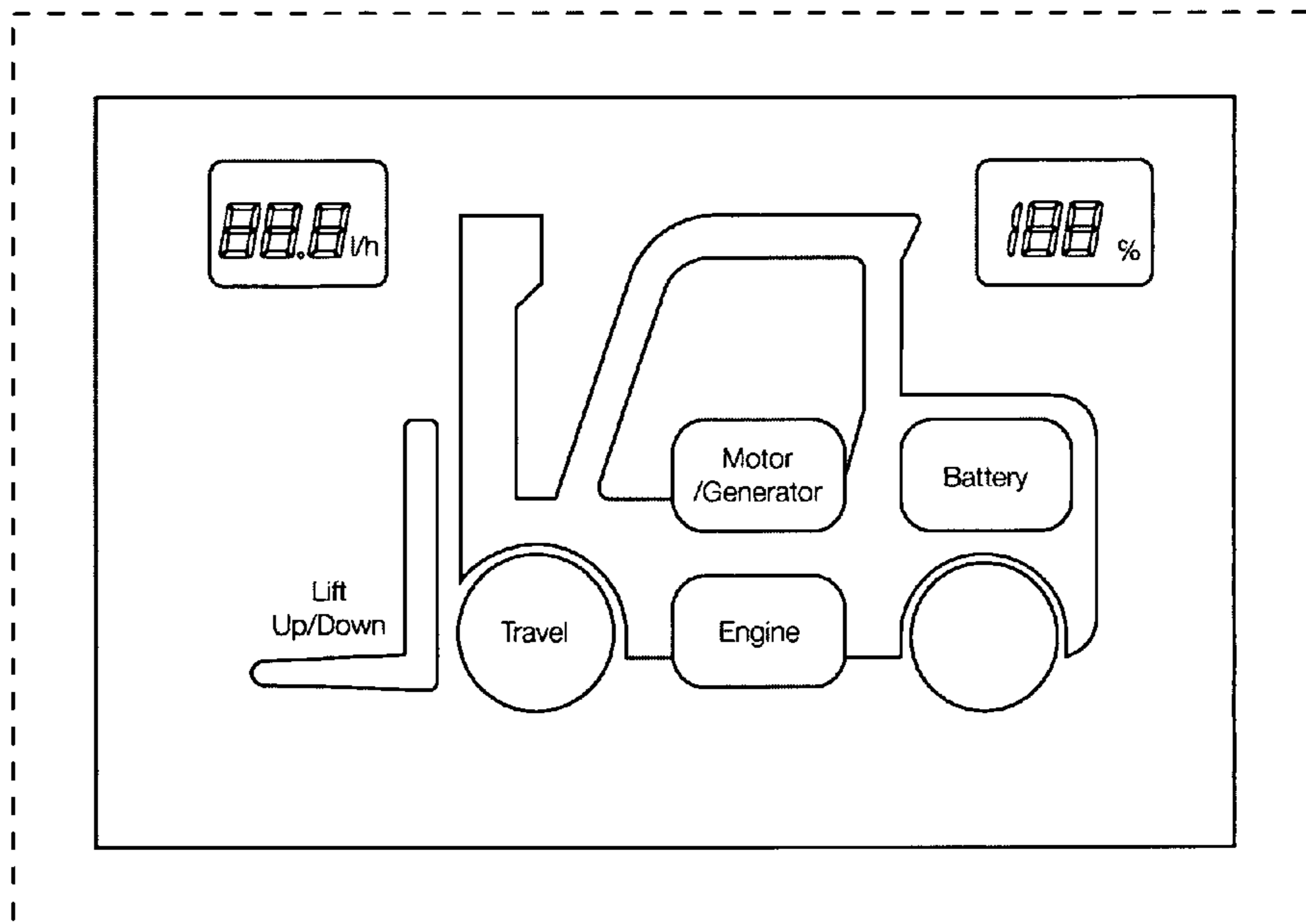

FIG. 1

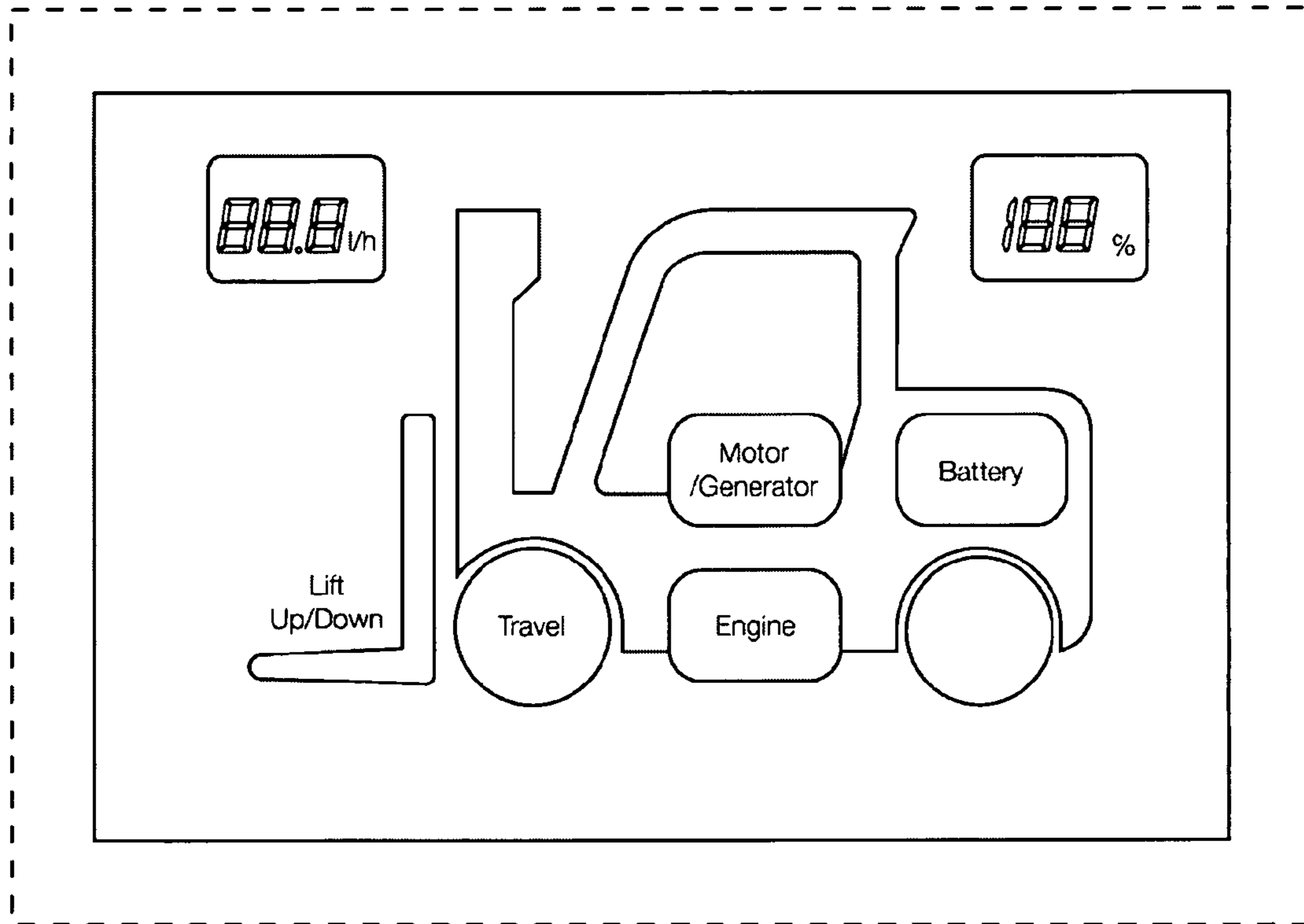

FIG.2

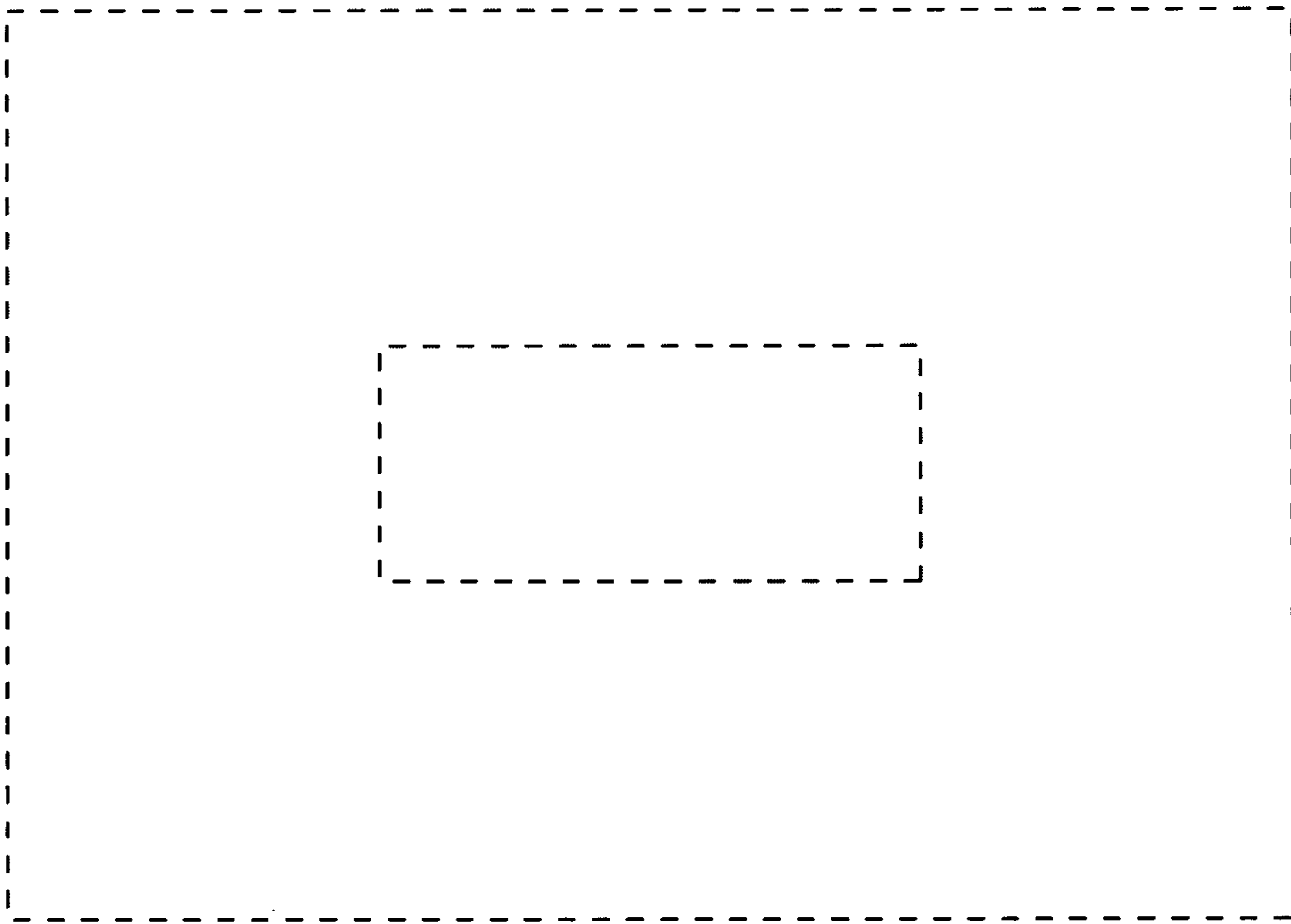

FIG.3

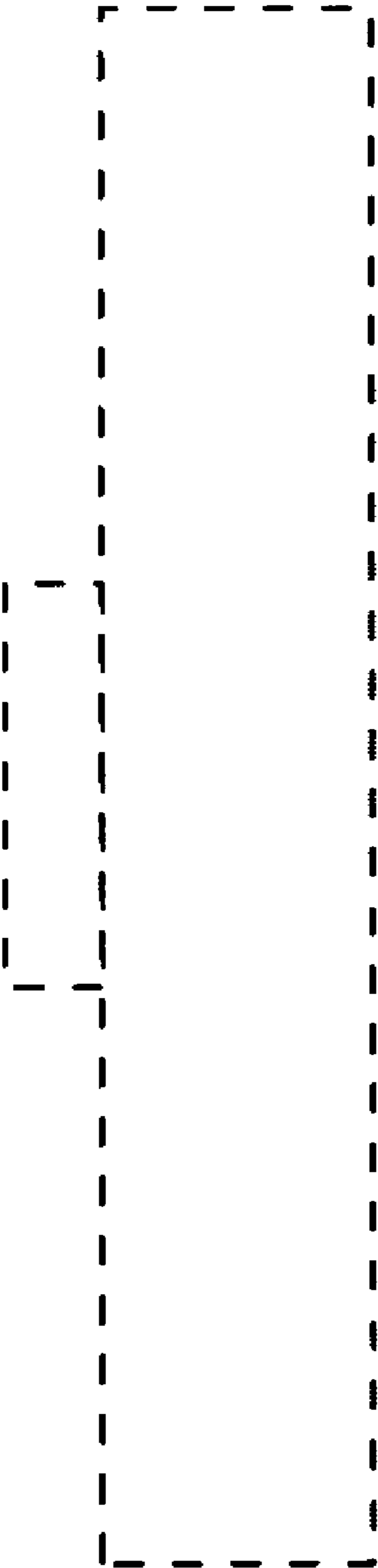

FIG. 4

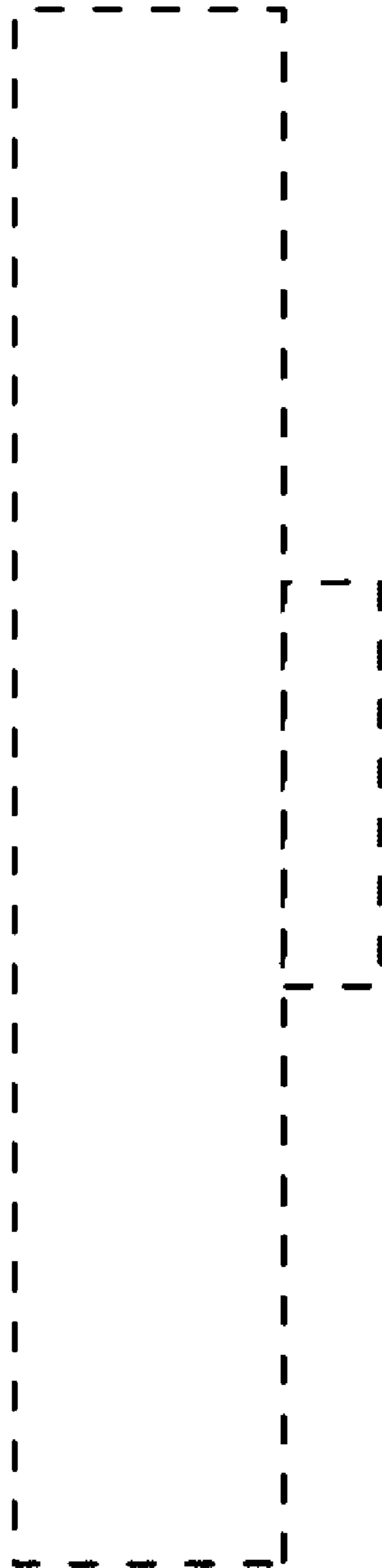

FIG.5

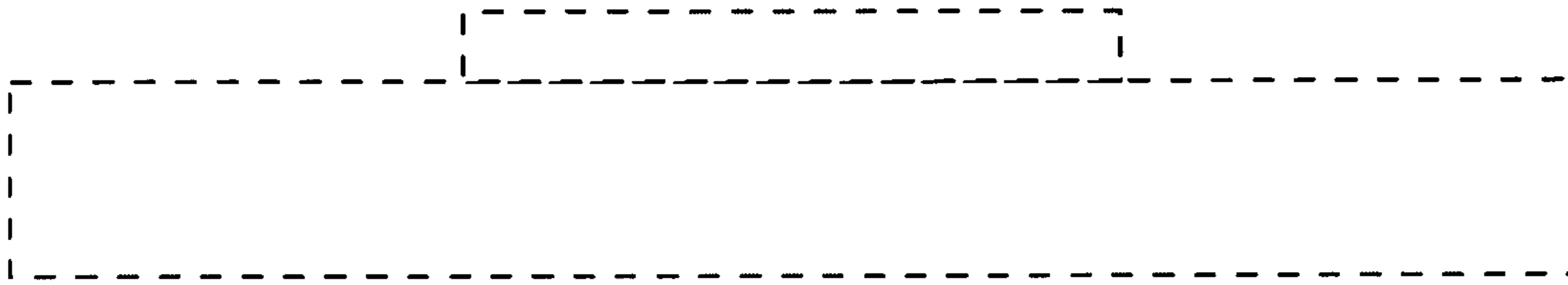

FIG.6



FIG.7

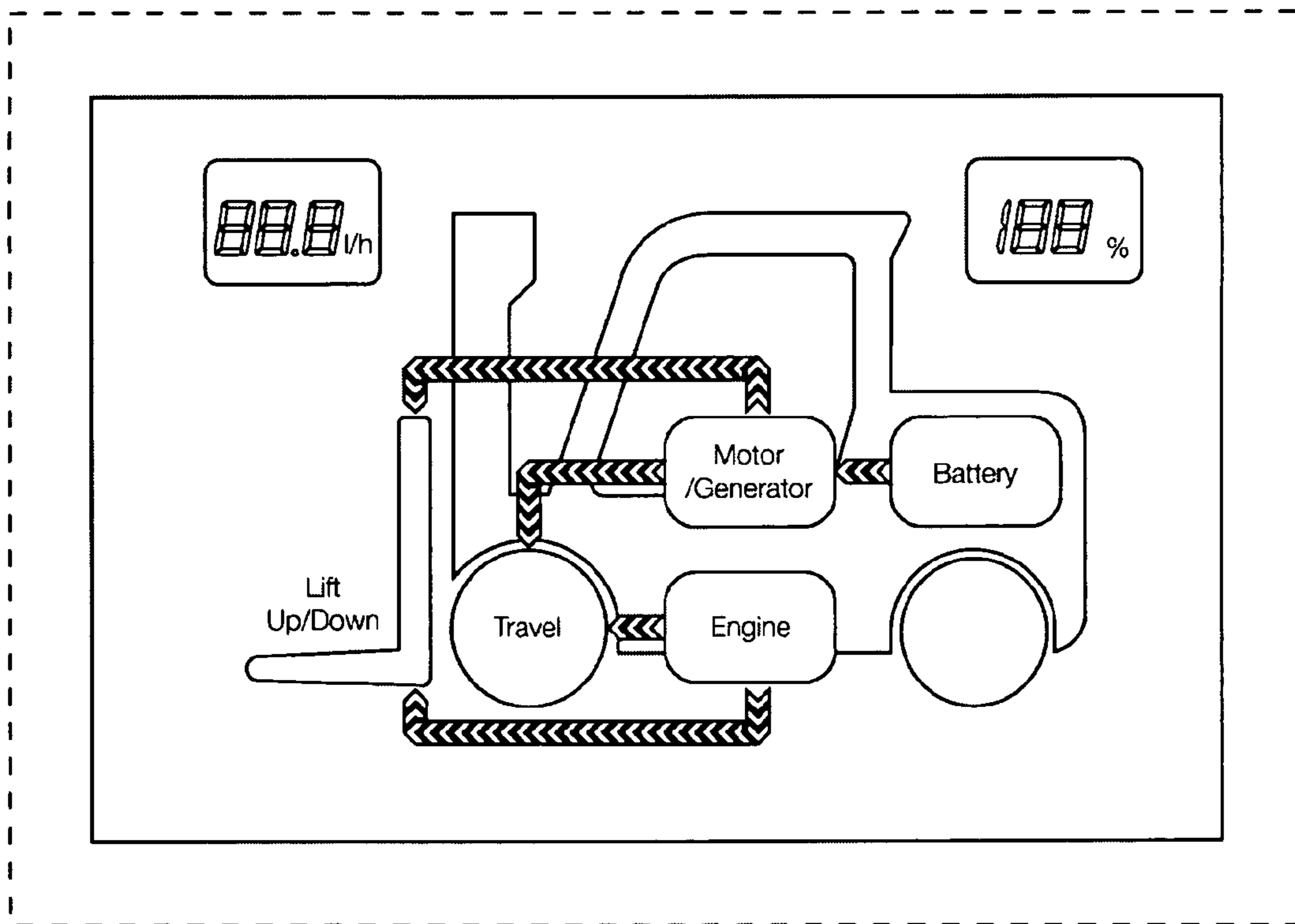

FIG.8

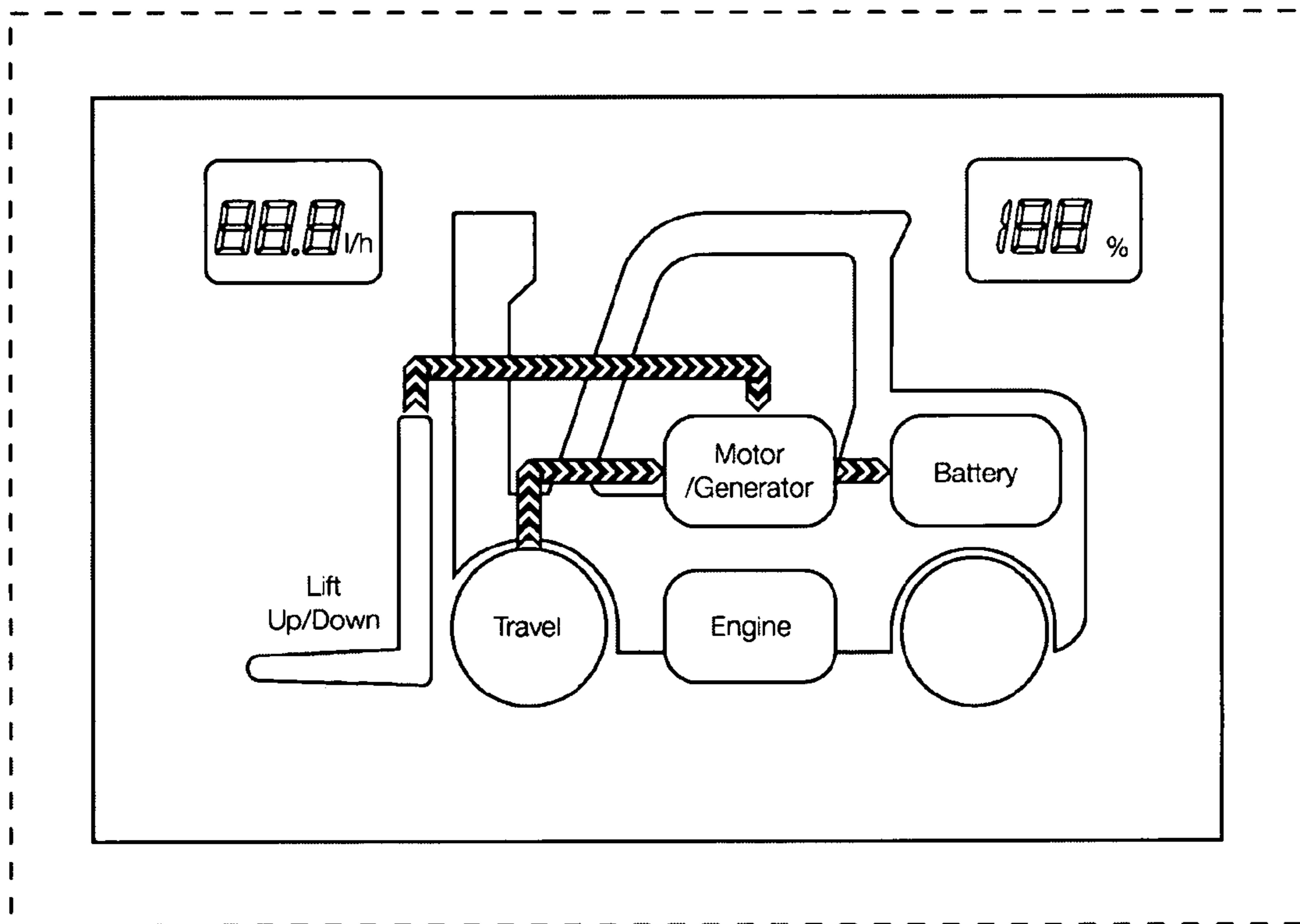

FIG.9

