



US00D571805S

(12) **United States Design Patent**
Leung et al.

(10) **Patent No.:** **US D571,805 S**
(45) **Date of Patent:** **** Jun. 24, 2008**

(54) **CARD READER**

(75) Inventors: **Chris K. C. Leung**, Richmond Hill
(CA); **Ryan Mitchell Bayne**, Waterloo
(CA)

(73) Assignee: **Research In Motion Limited**, Waterloo,
Ontario (CA)

(**) Term: **14 Years**

(21) Appl. No.: **29/297,369**

(22) Filed: **Nov. 9, 2007**

(51) **LOC (8) Cl.** **14-02**

(52) **U.S. Cl.** **D14/385**

(58) **Field of Classification Search** D14/383-389,
D14/424, 356-358, 363, 365, 367-370, 432,
D14/434, 441, 442, 344, 347, 439; 235/441,
235/451, 492, 380, 439; 439/160, 327; 361/740,
361/679, 684, 686, 728, 736, 737, 741, 807,
361/808

See application file for complete search history.

(56) **References Cited**

U.S. PATENT DOCUMENTS

D305,717	S	*	1/1990	Soren et al.	D14/138
D366,472	S	*	1/1996	Youens	D14/367
5,601,489	A	*	2/1997	Komaki	235/146
D410,916	S	*	6/1999	Oba	D14/432
6,068,186	A	*	5/2000	Jubert	235/441
6,075,706	A	*	6/2000	Learmonth et al.	361/737
D450,707	S	*	11/2001	Francavilla et al.	D14/434
D451,508	S	*	12/2001	Liston et al.	D14/385
D451,509	S	*	12/2001	Liston et al.	D14/385
D465,486	S	*	11/2002	Lee	D14/341
D469,438	S	*	1/2003	Corrales	D14/432

6,735,075	B1	*	5/2004	Lin	361/679
6,736,318	B2	*	5/2004	Reichardt et al.	235/441
6,769,614	B2	*	8/2004	Kanayama	235/449
6,840,447	B2	*	1/2005	Hirata et al.	235/451
6,915,957	B2	*	7/2005	Kisliakov	235/492
6,971,583	B2	*	12/2005	Kisliakov	235/492
D522,512	S	*	6/2006	Little et al.	D14/385
D544,487	S	*	6/2007	Hussaini et al.	D14/434
D558,199	S	*	12/2007	Fiorentino et al.	D14/356
2002/0066785	A1	*	6/2002	Liston et al.	235/441
2007/0040017	A1	*	2/2007	Kozlay	235/380

* cited by examiner

Primary Examiner—Cathron Brooks

Assistant Examiner—Deanna Fluegeman

(74) *Attorney, Agent, or Firm*—Brij K. Agarwal; Eckert
Seamans Cherin & Mellott, LLC

(57) **CLAIM**

The ornamental design for a card reader, as shown and described.

DESCRIPTION

FIG. 1 is a front perspective view of a card reader depicting our new design;

FIG. 2 is a rear perspective view thereof;

FIG. 3 is a front elevational view thereof;

FIG. 4 left side elevational view thereof;

FIG. 5 is a right side elevational view thereof;

FIG. 6 is a top plan view thereof; and,

FIG. 7 is a bottom plan view thereof.

The broken lines shown in the drawings are for illustrative purposes only and form no part of the claimed design.

1 Claim, 5 Drawing Sheets

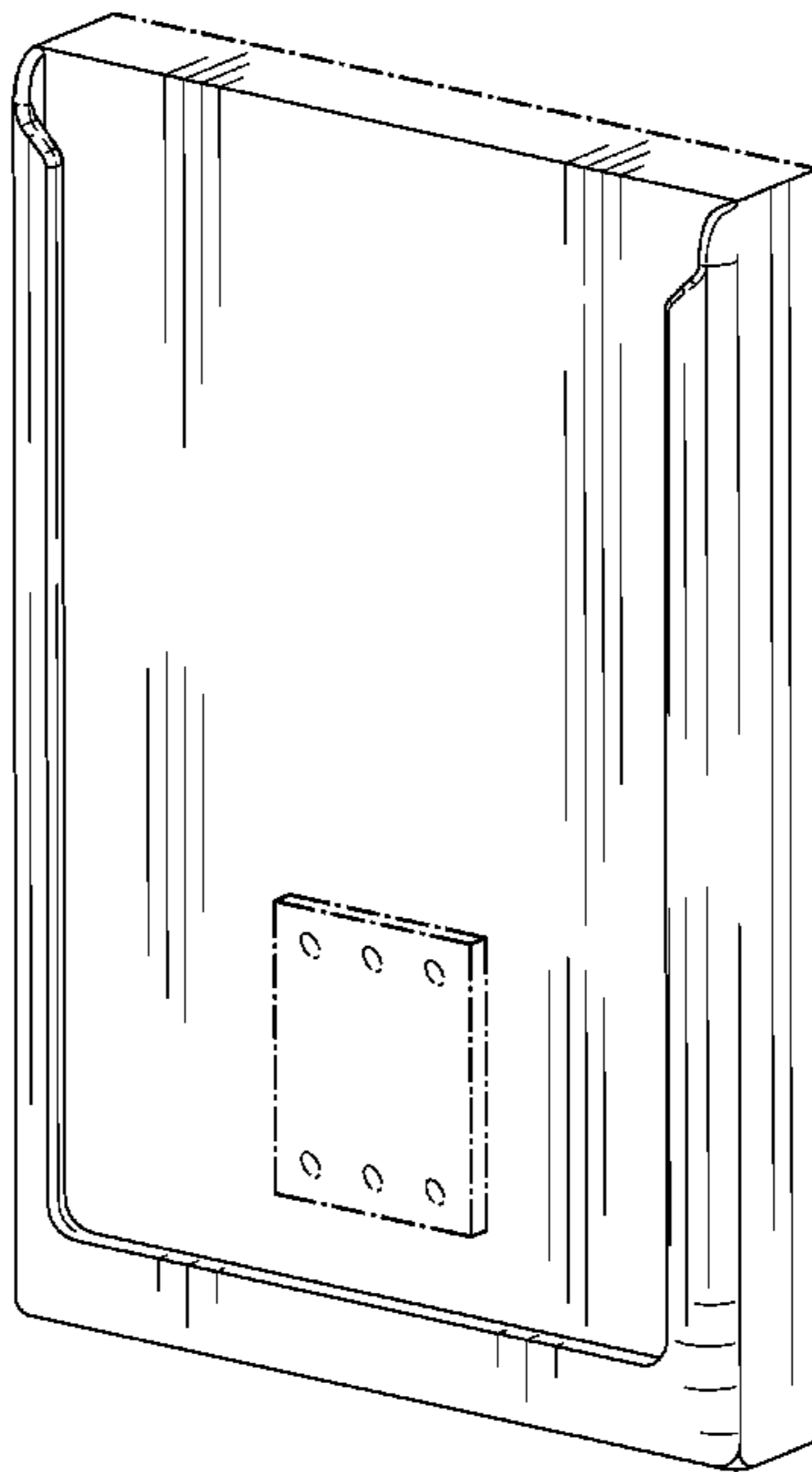

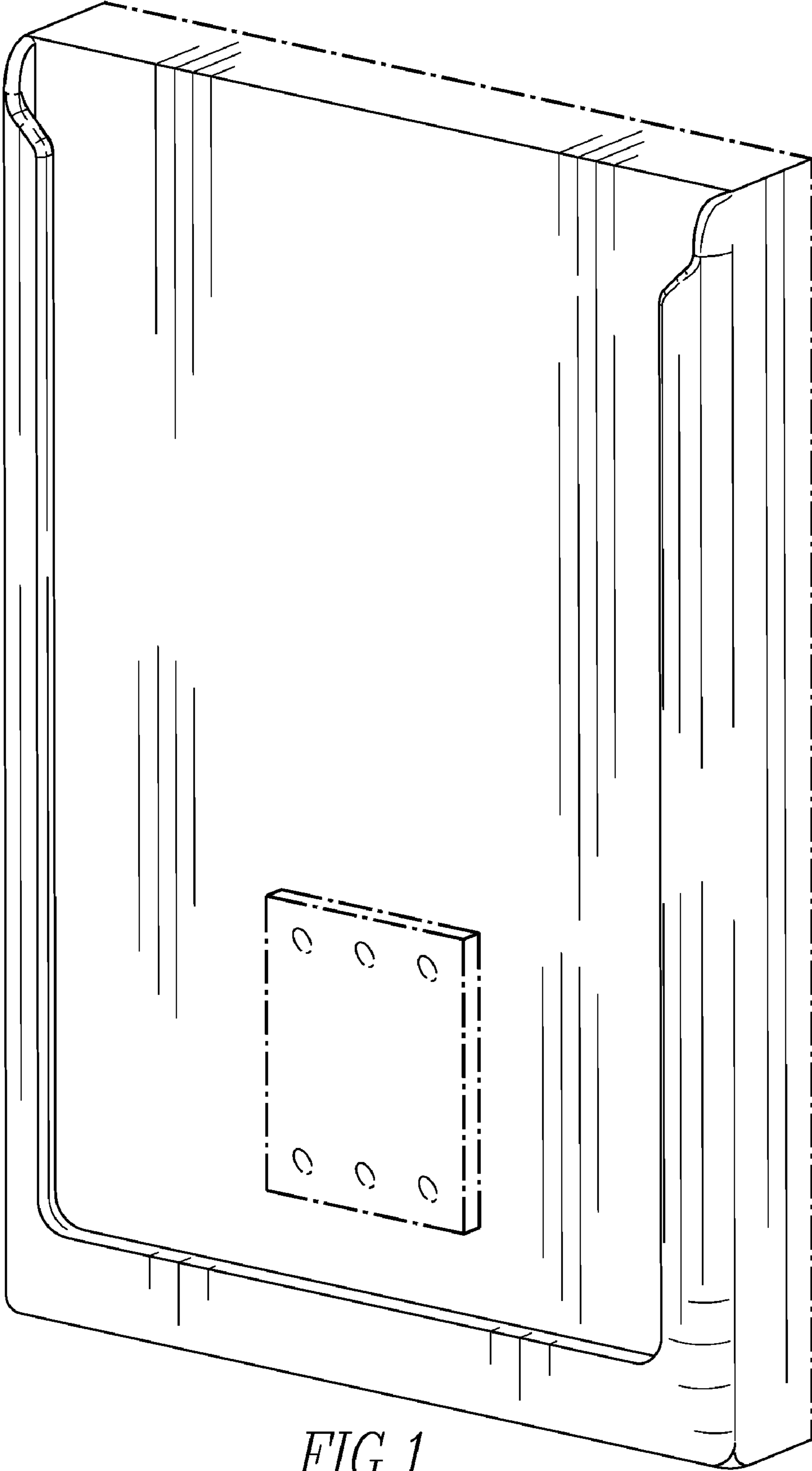

FIG. 1

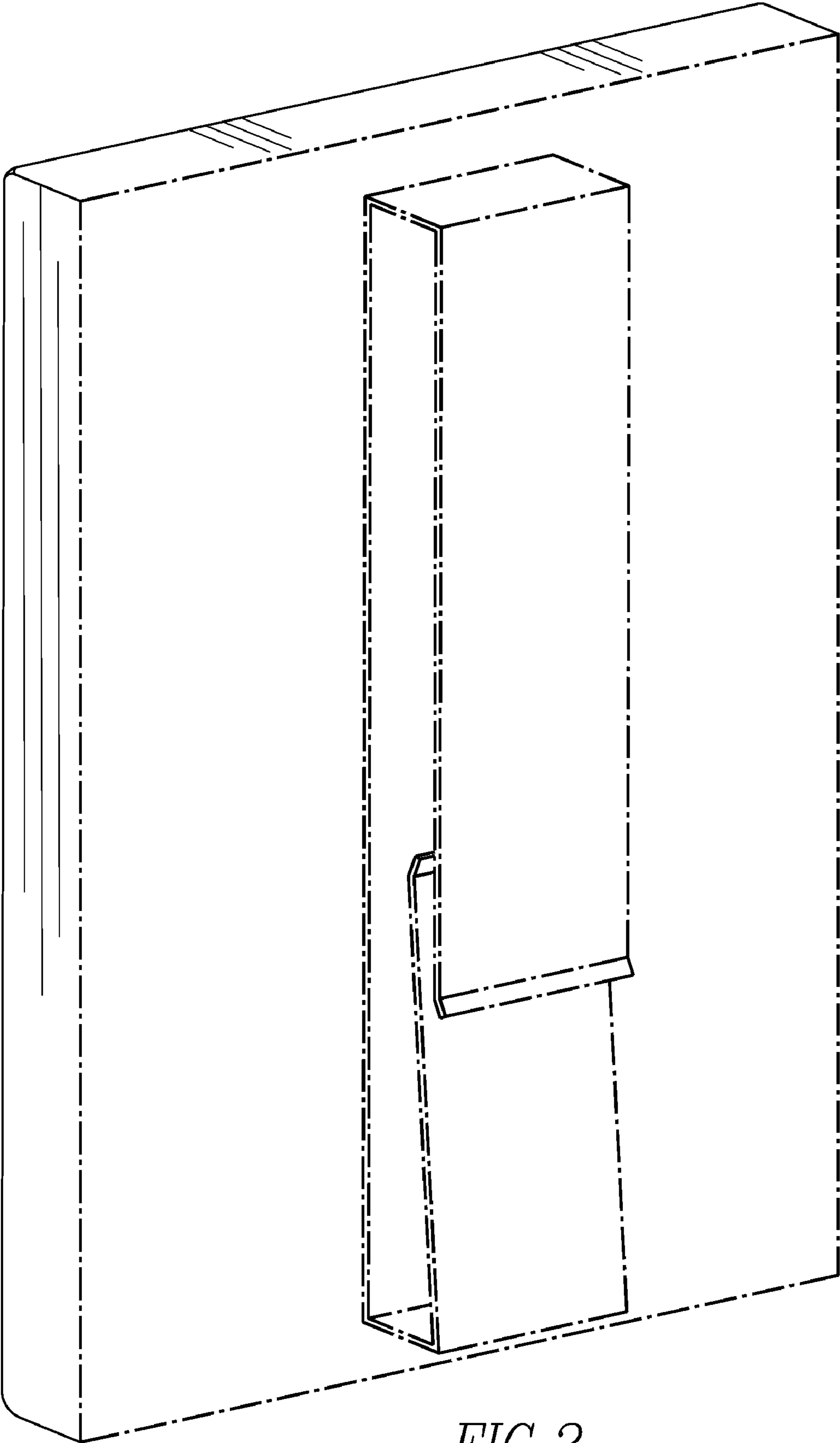

FIG. 2

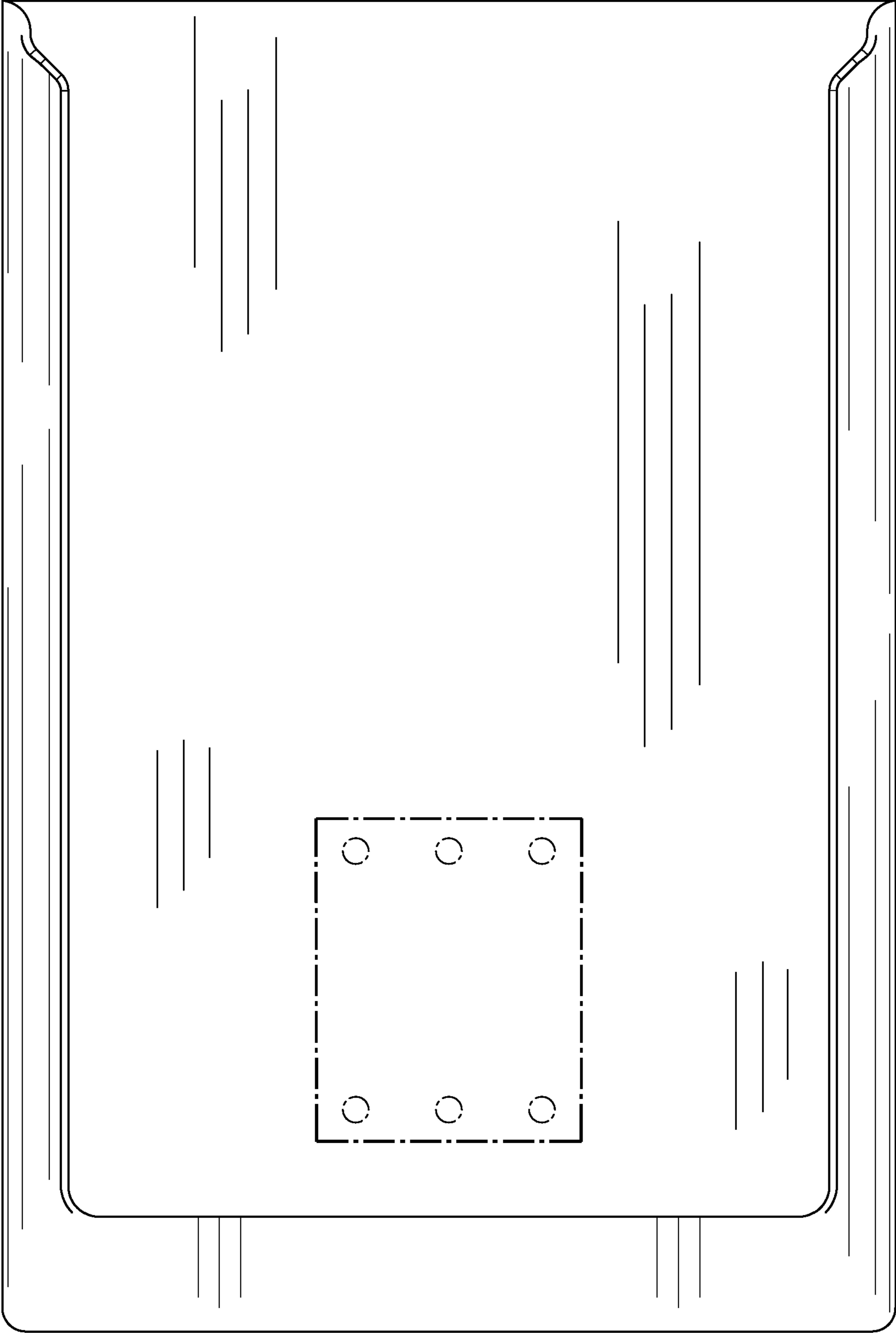

FIG. 3

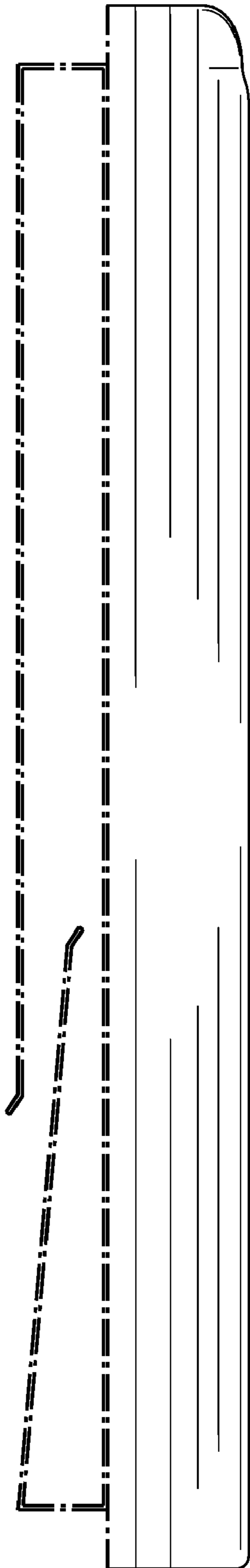

FIG. 4

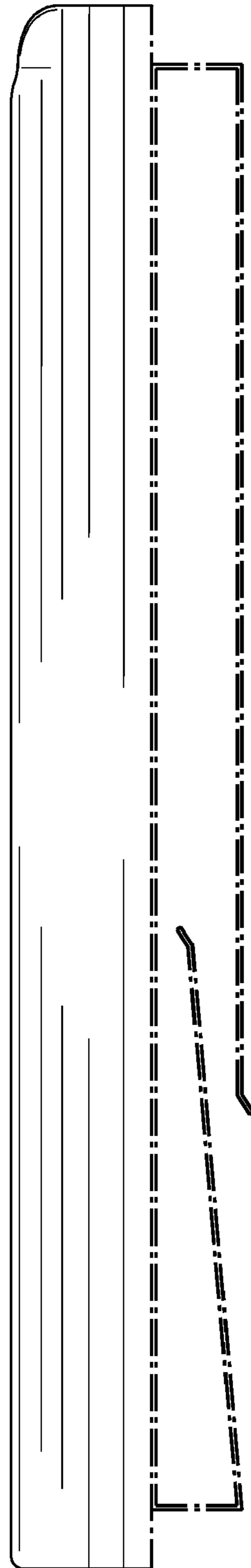

FIG. 5

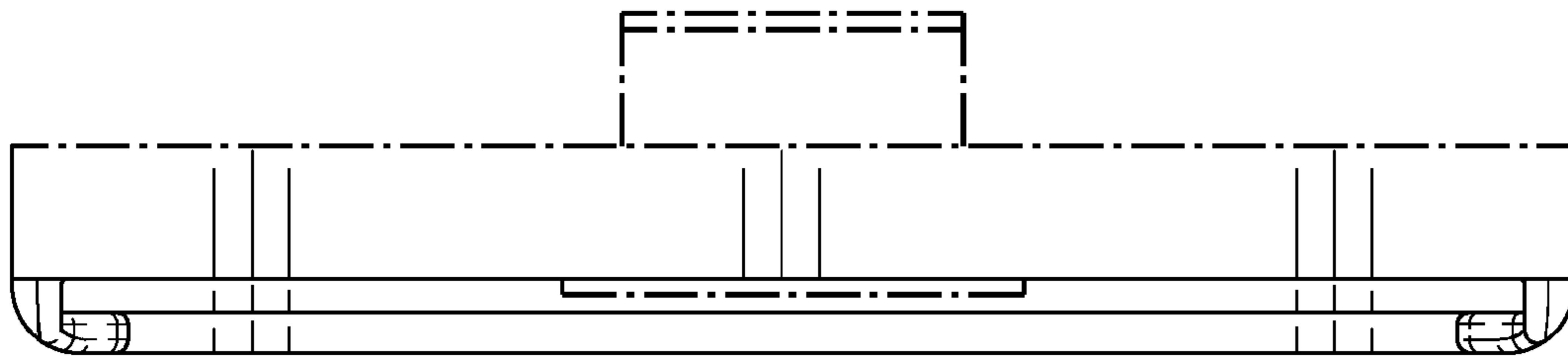

FIG. 6

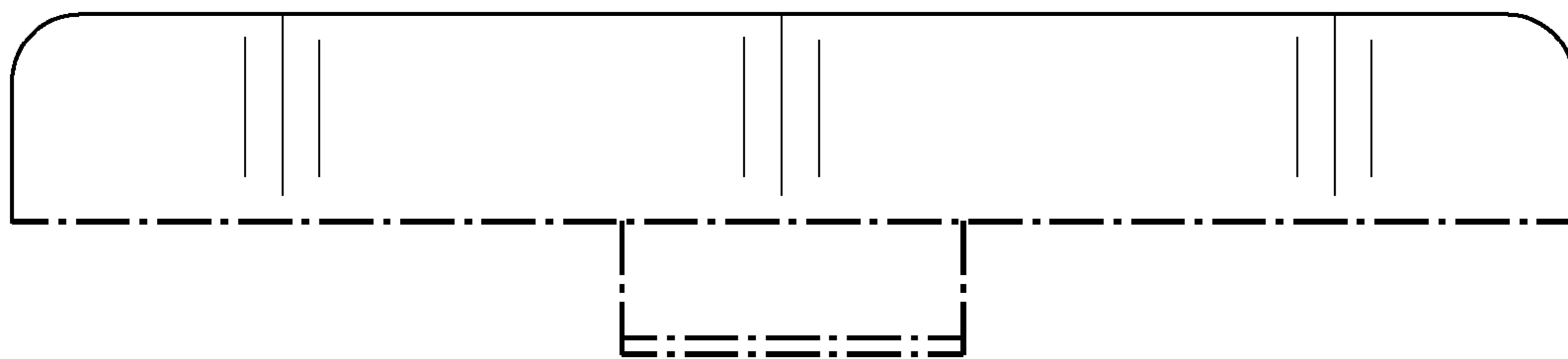

FIG. 7