



US00D571122S

(12) **United States Design Patent**
Bostick

(10) **Patent No.:** **US D571,122 S**

(45) **Date of Patent:** **** Jun. 17, 2008**

(54) **DISPLAY UNIT FOR CABINETRY**

(75) Inventor: **Richard Bostick**, Yorba Linda, CA (US)

(73) Assignee: **RSI Home Products Management, Inc.**, Newport Beach, CA (US)

(**) Term: **14 Years**

(21) Appl. No.: **29/217,060**

(22) Filed: **Nov. 12, 2004**

(51) **LOC (8) Cl.** **06-07**

(52) **U.S. Cl.** **D6/449**

(58) **Field of Classification Search** D6/449,
D6/396, 475, 432, 448, 455, 456, 470, 477,
D6/479; 211/189, 190, 49.1, 50, 59.2; 248/174
See application file for complete search history.

(56) **References Cited**

U.S. PATENT DOCUMENTS

D232,505 S *	8/1974	Steeves, Jr.	D6/465
6,698,604 B2 *	3/2004	Denny et al.	211/189
7,150,361 B2 *	12/2006	Calleja	211/49.1
2002/0144965 A1 *	10/2002	Calleja	211/183
2002/0158034 A1 *	10/2002	Denny et al.	211/189
2005/0199569 A1 *	9/2005	Calleja	211/189

2007/0119808 A1* 5/2007 Wishart et al. 211/189

* cited by examiner

Primary Examiner—Caron D. Veynar

Assistant Examiner—Sydney R Buffalow

(74) *Attorney, Agent, or Firm*—O'Melveny & Myers LLP

(57) **CLAIM**

The ornamental design for a display unit for cabinetry, as shown and described.

DESCRIPTION

FIG. 1 is a front view of the display unit for cabinetry fixtures with cabinetry pieces mounted.

FIG. 2 is a side view of the display unit for cabinetry fixtures.

FIG. 3 is a perspective view of the display unit for cabinetry fixtures as viewed looking down and to the left from a point facing, above, and to the right of the display unit.

FIG. 4 is a perspective view of the display unit for cabinetry fixtures as viewed looking up and to the left from a point facing, below, and to the right of the display unit; and,

FIG. 5 is a perspective view looking down and to the left from a point facing above and to the right of the display unit.

1 Claim, 4 Drawing Sheets

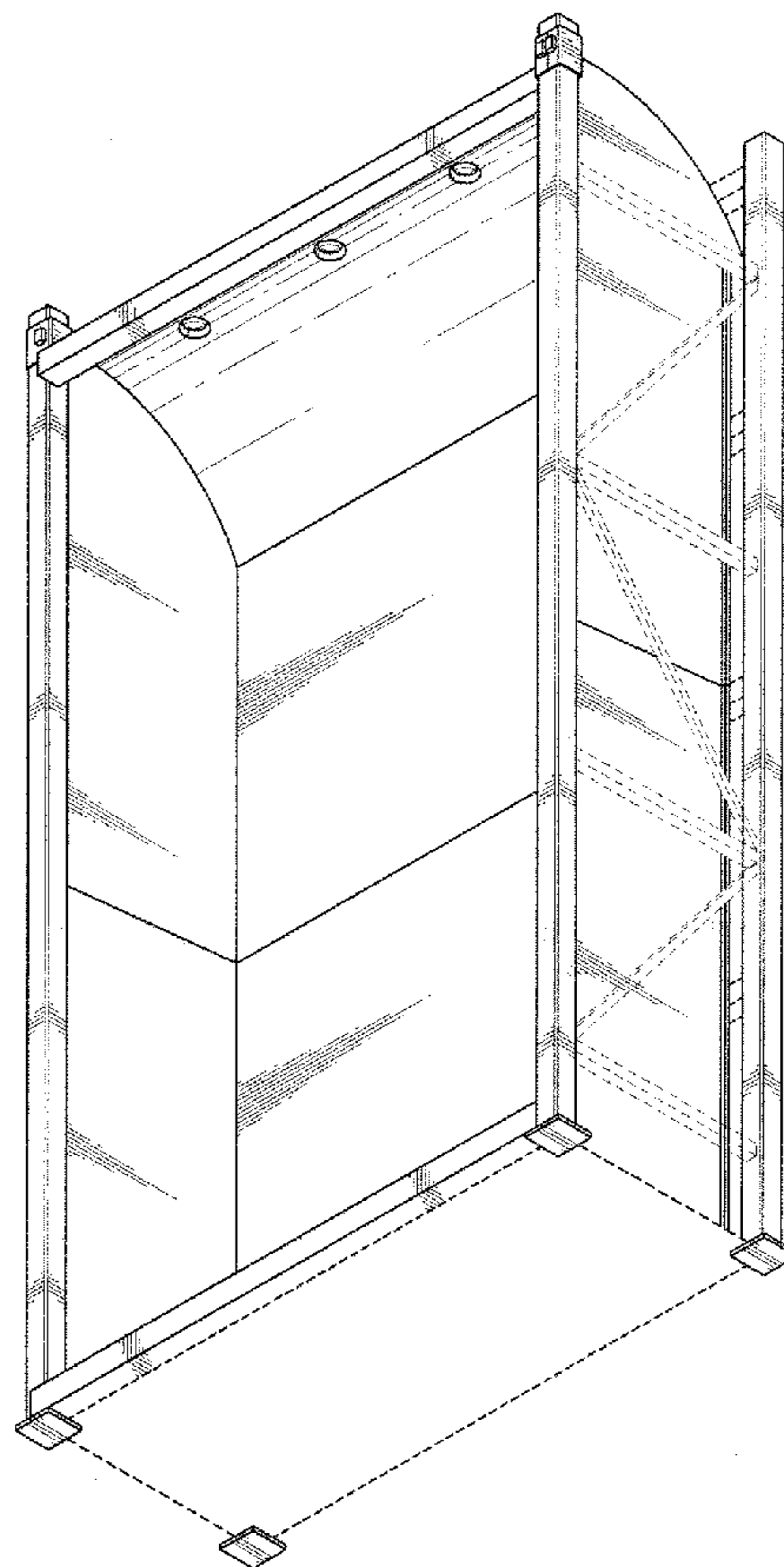
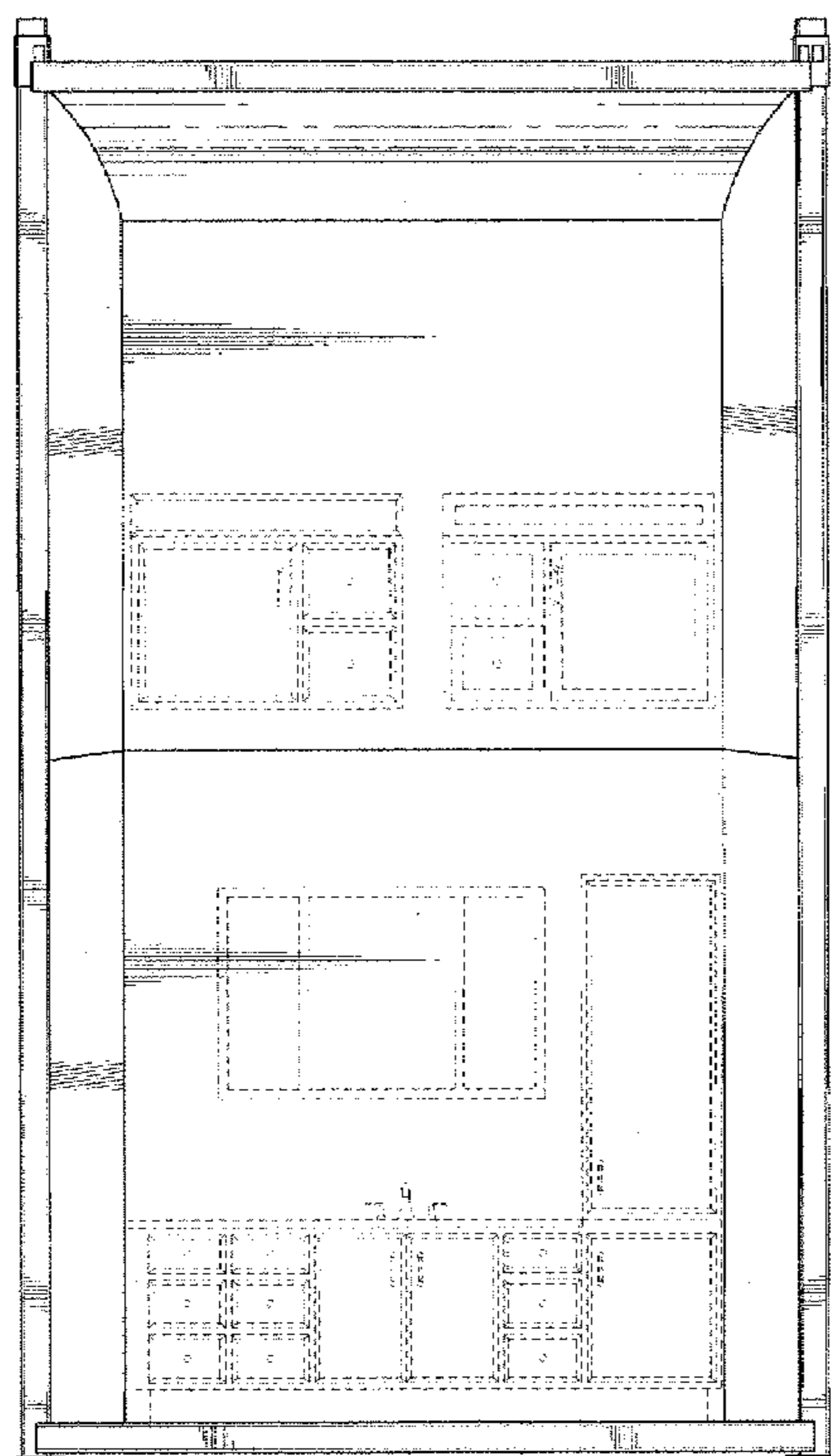

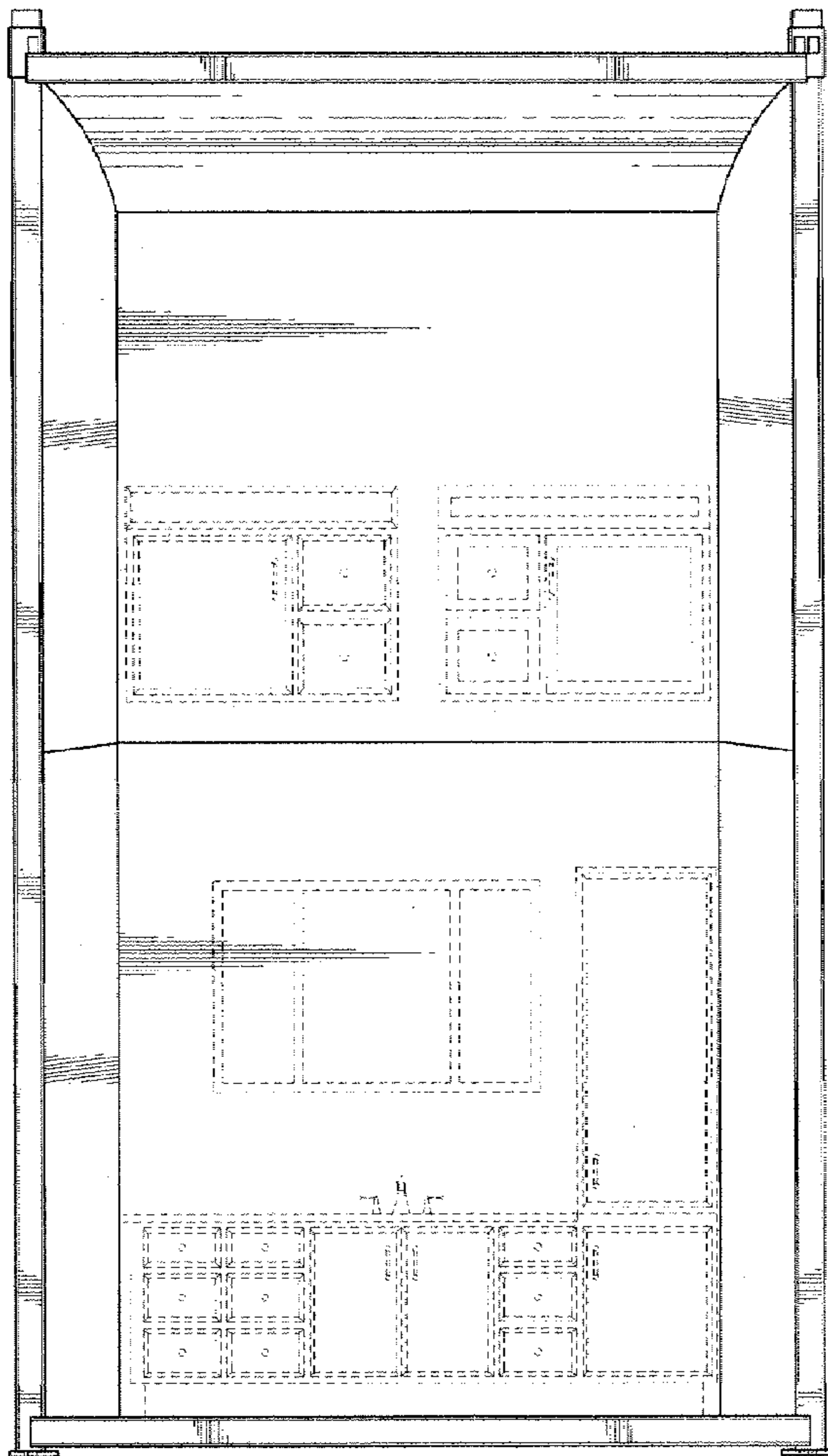

FIG. 1

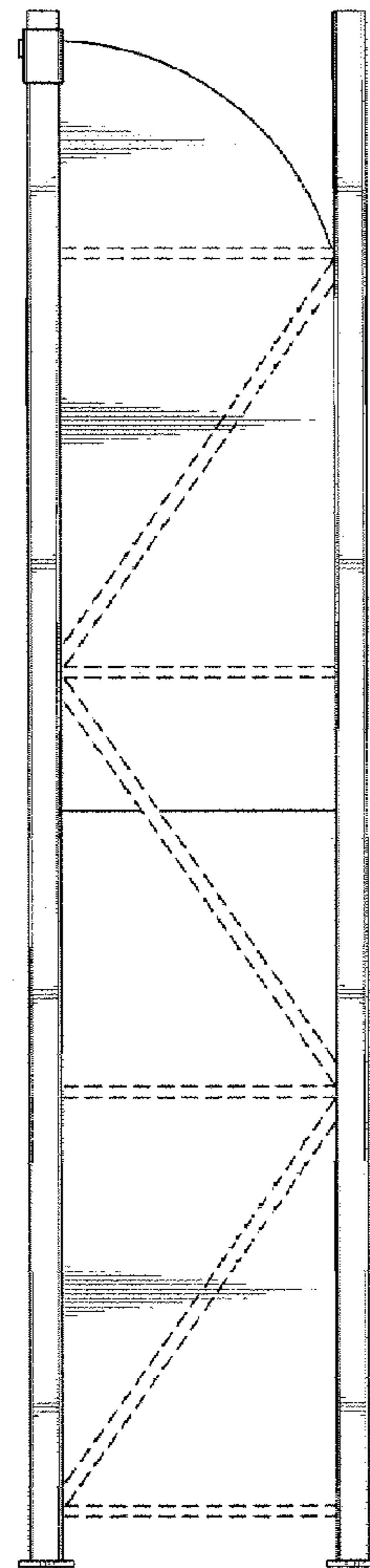

FIG. 2

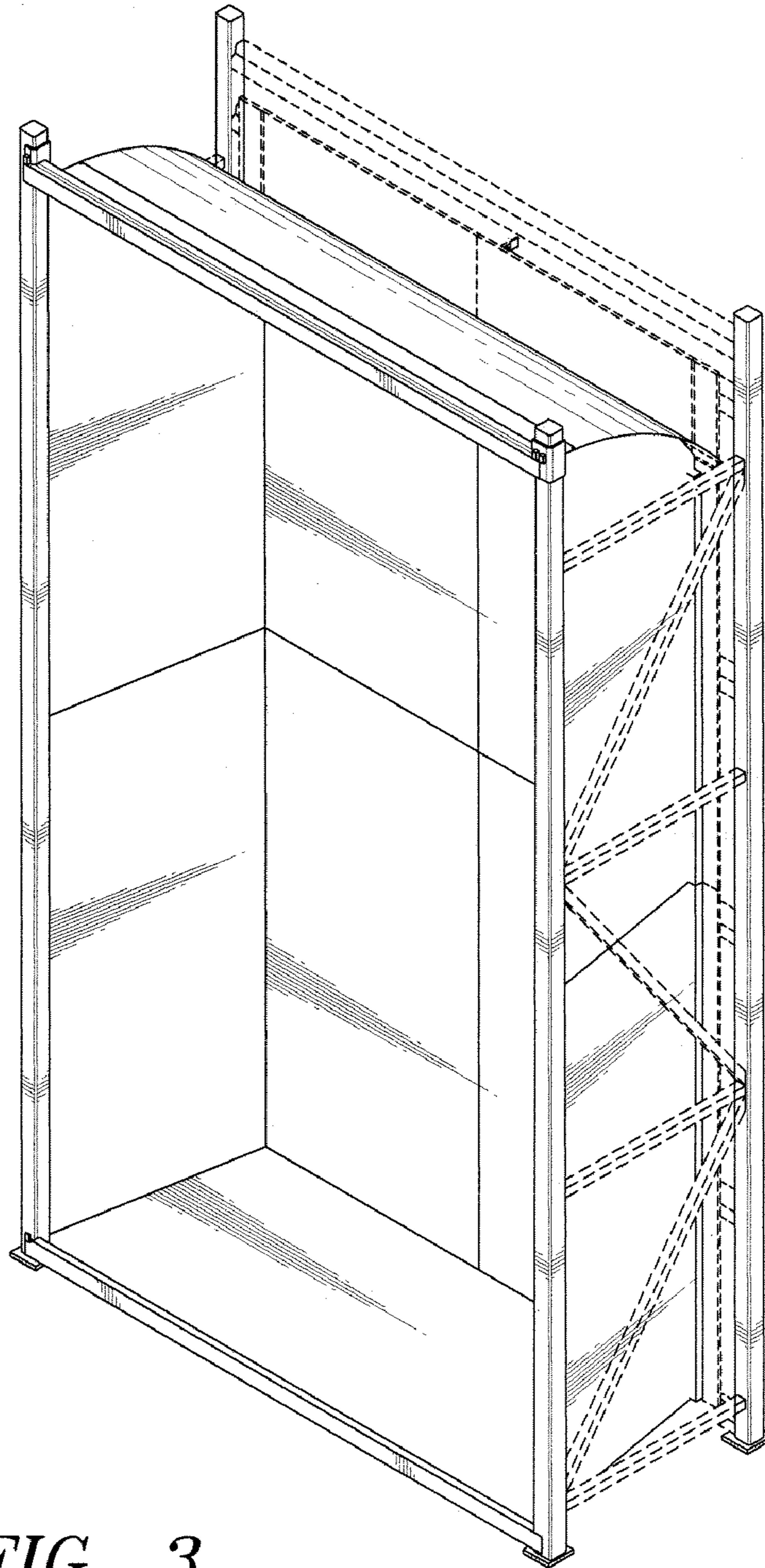

FIG. 3

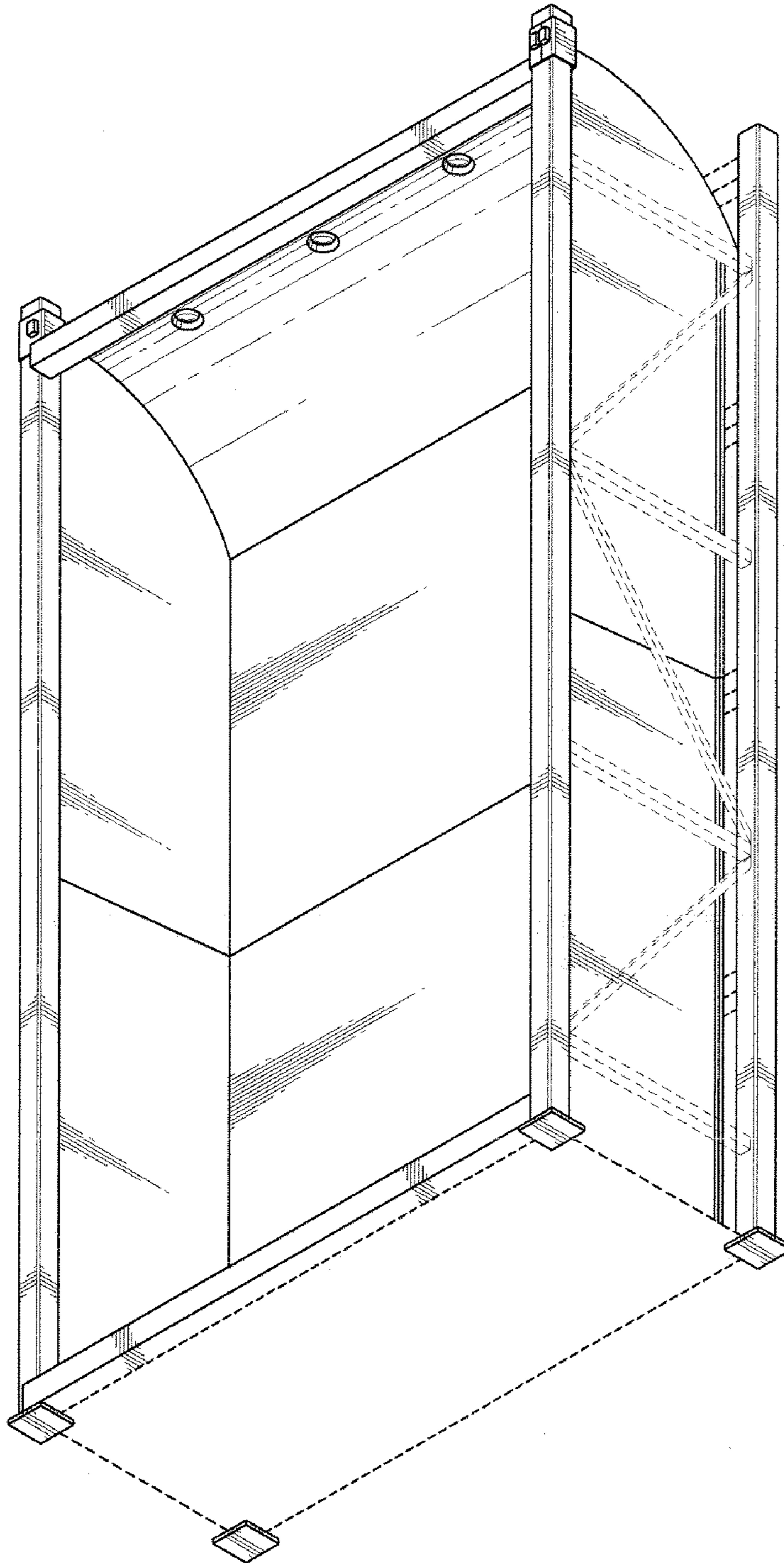

FIG. 4

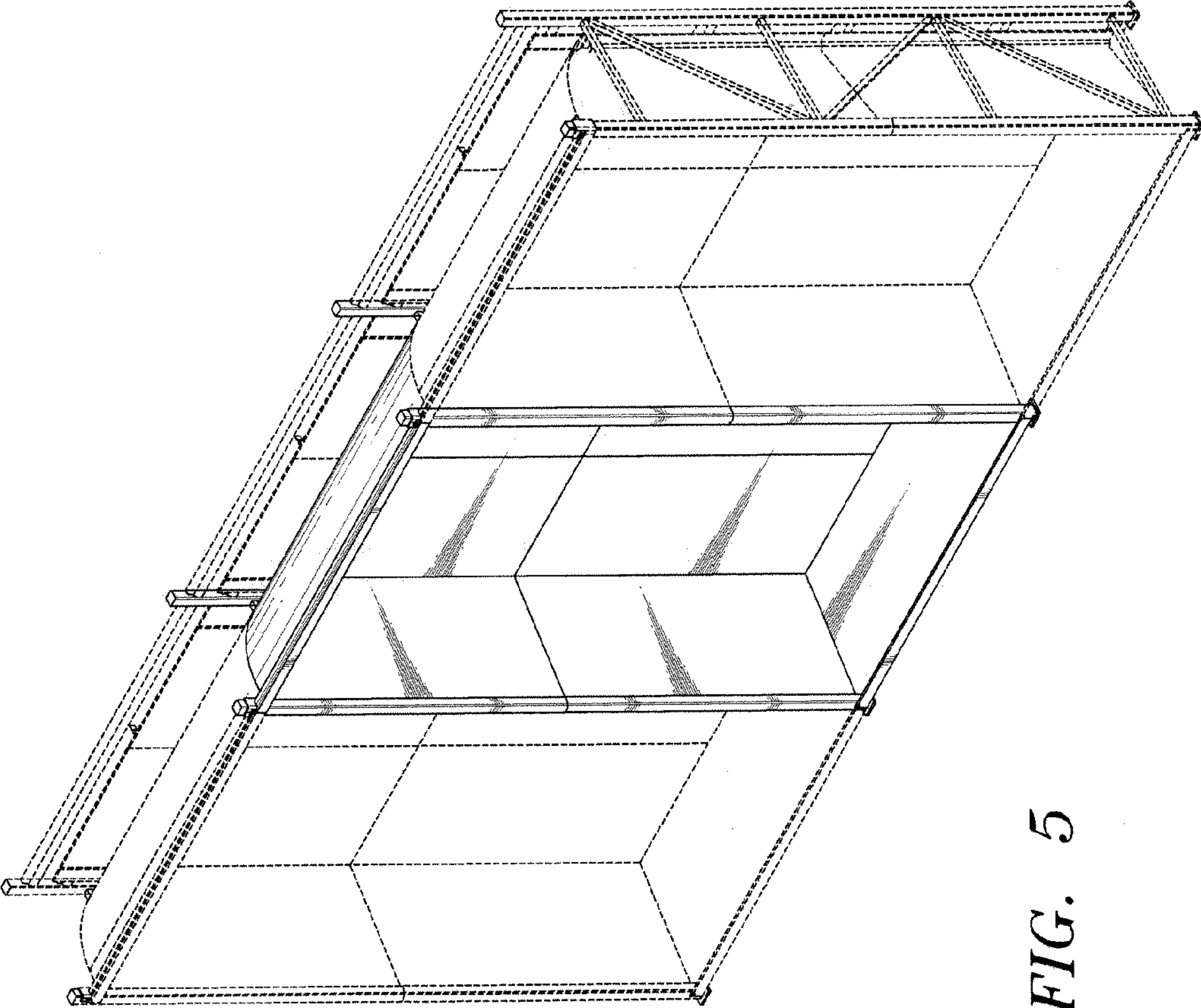

FIG. 5