



US00D569651S

(12) **United States Design Patent** (10) **Patent No.:** **US D569,651 S**
Pallucco et al. (45) **Date of Patent:** **** May 27, 2008**

(54) **TABLE**

(75) Inventors: **Paolo Pallucco**, Rome (IT); **Mireille Riviere**, Rome (IT)

(73) Assignee: **De Padova S.R.L.**, Milan (IT)

(**) Term: **14 Years**

(21) Appl. No.: **29/270,202**

(22) Filed: **Dec. 18, 2006**

(30) **Foreign Application Priority Data**

Jun. 20, 2006 (EM) 000546965

(51) **LOC (8) Cl.** **06-03**

(52) **U.S. Cl.** **D6/429; D6/484**

(58) **Field of Classification Search** D6/480-489,
D6/495-499, 511, 429-431; 108/150, 153.1,
108/155, 156, 157.17, 116, 124, 161, 65,
108/67, 137; 248/188, 188.1, 188.7, 188.8
See application file for complete search history.

(56) **References Cited**

U.S. PATENT DOCUMENTS

D214,741 S *	7/1969	Wellesley	D6/484
D284,431 S *	7/1986	Berry, Jr.	D6/474
D331,678 S *	12/1992	McCann, Jr.	D6/482
D386,020 S *	11/1997	Grabowski	D6/480
D527,199 S *	8/2006	Shaw	D6/400
2007/0169673 A1 *	7/2007	Tseng	108/65

* cited by examiner

Primary Examiner—Janice E. Seeger

(74) *Attorney, Agent, or Firm*—Andrew Wilford

(57) **CLAIM**

The ornamental design for a table, as shown and described.

DESCRIPTION

FIG. 1 is a perspective view from above, in front, and to the left of the table according to the invention in closed condition;

FIGS. 2, 3, and 4 are elevational views of the closed table, taken respectively from the front, the right side, and the left side as shown in FIG. 1;

FIG. 5 is a bottom view of the closed table;

FIG. 6 is another side elevational view of the closed table taken from the rear;

FIG. 7 is a perspective view from above, in front, and to the left of the table according to the invention in open position;

FIG. 8 is a top view of the open table;

FIGS. 9, 10, and 11 are elevational views of the open table, taken respectively from the front, the right side, and the left side as shown in FIG. 7;

FIG. 12 is a bottom view of the open table;

FIG. 13 is another side elevational view of the open table taken from the rear; and,

FIGS. 14 is a large-scale perspective view of a hinge of the inventive table.

1 Claim, 14 Drawing Sheets

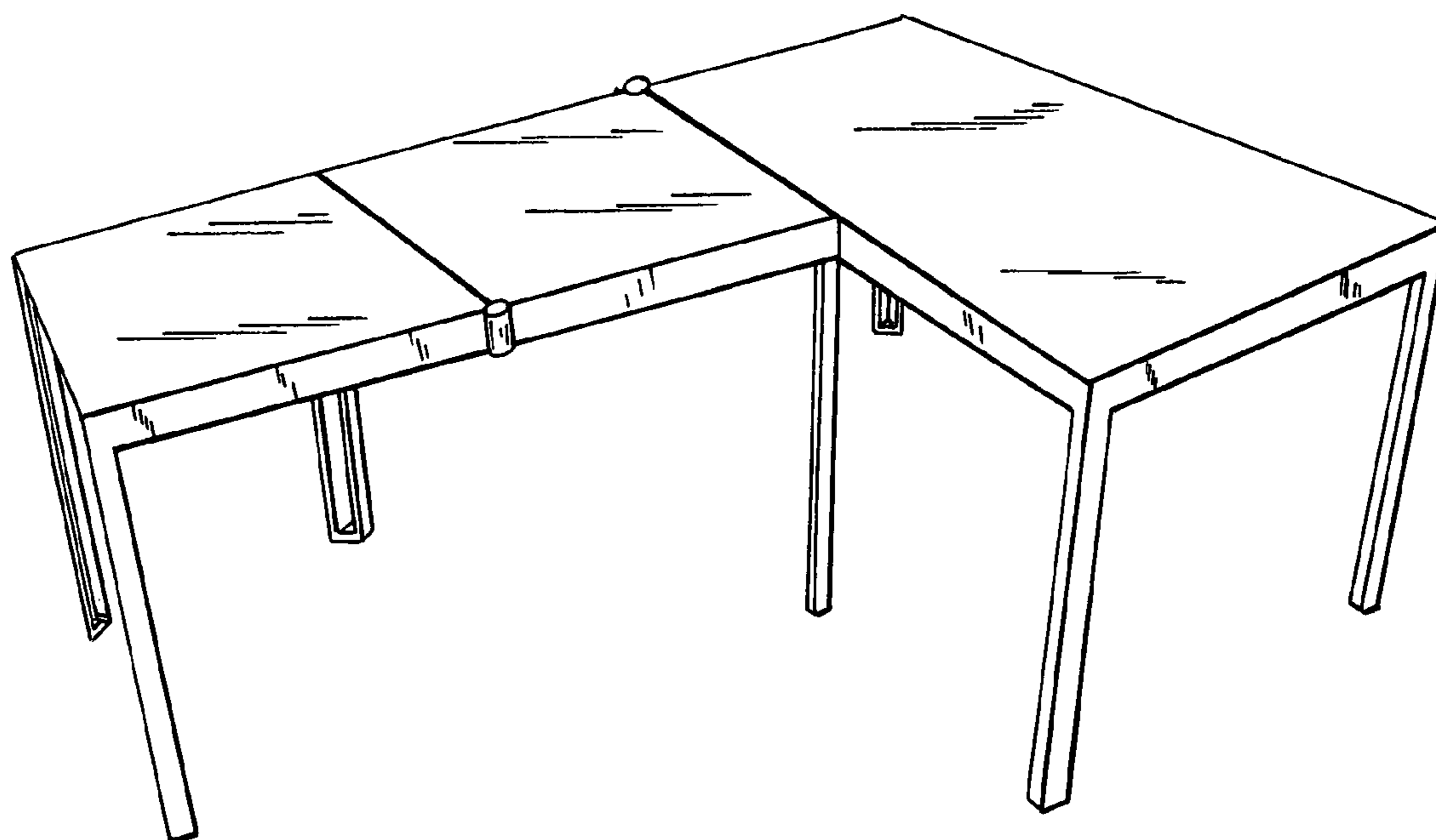

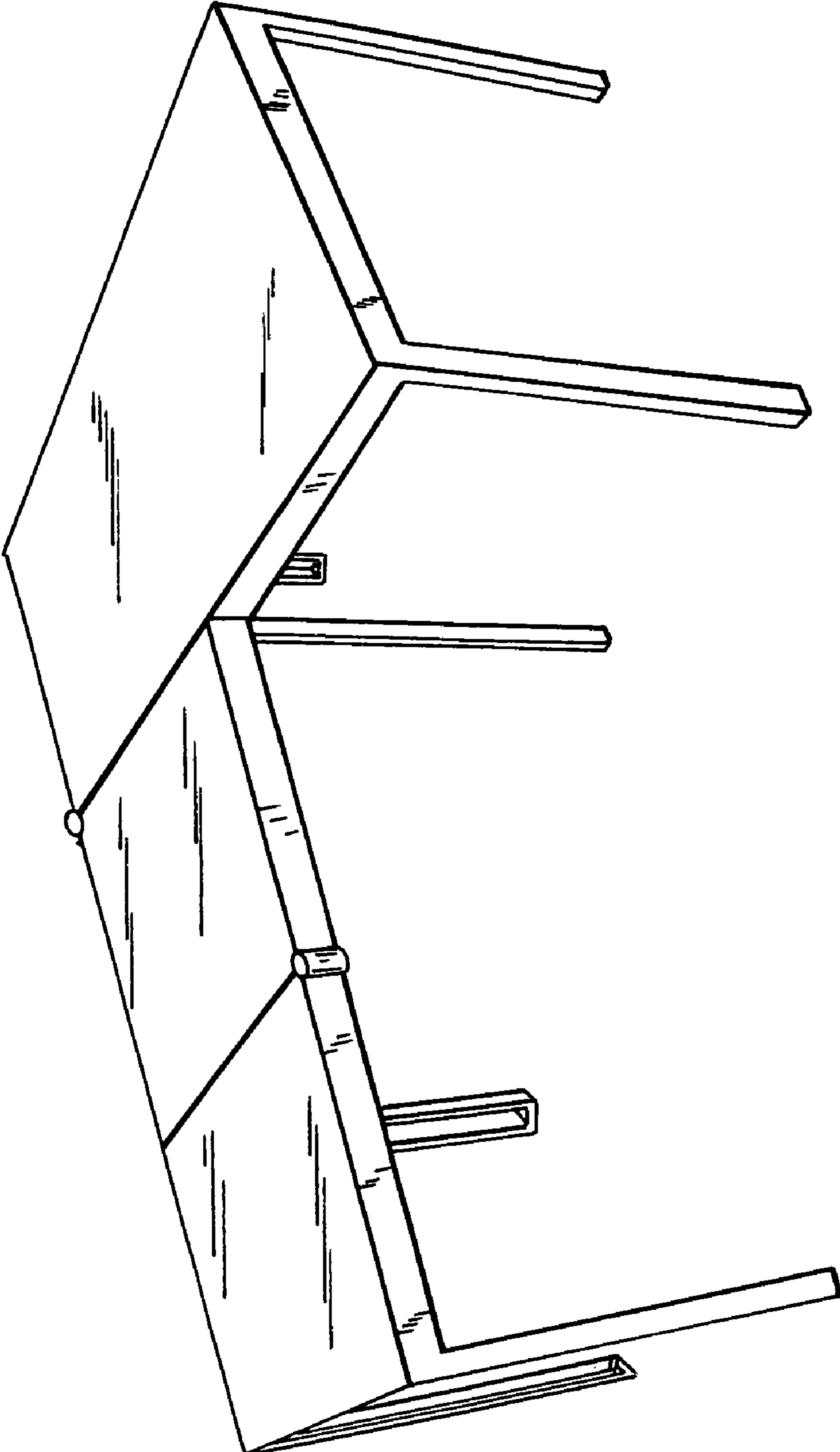

FIG.1

FIG. 2

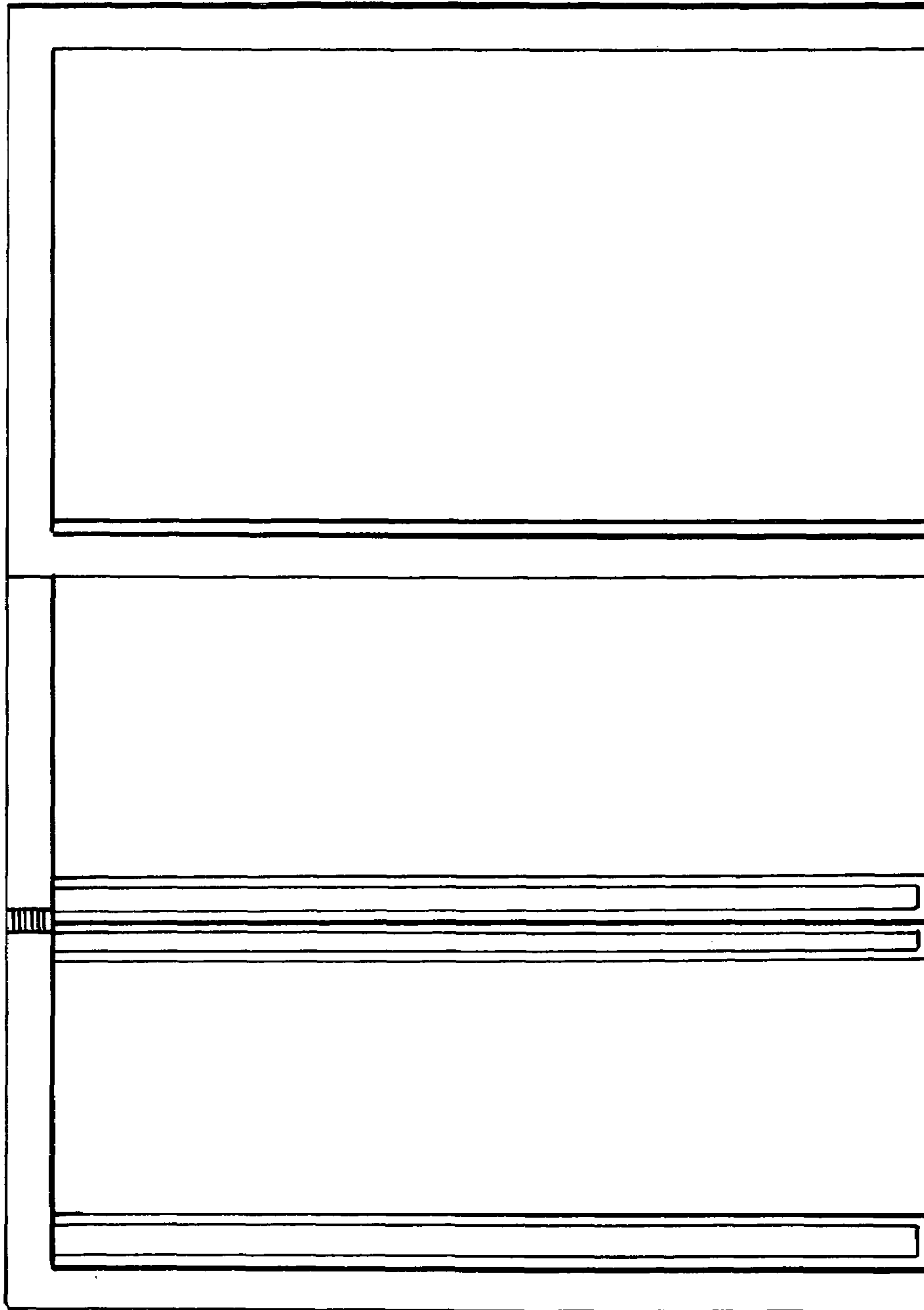

FIG. 3

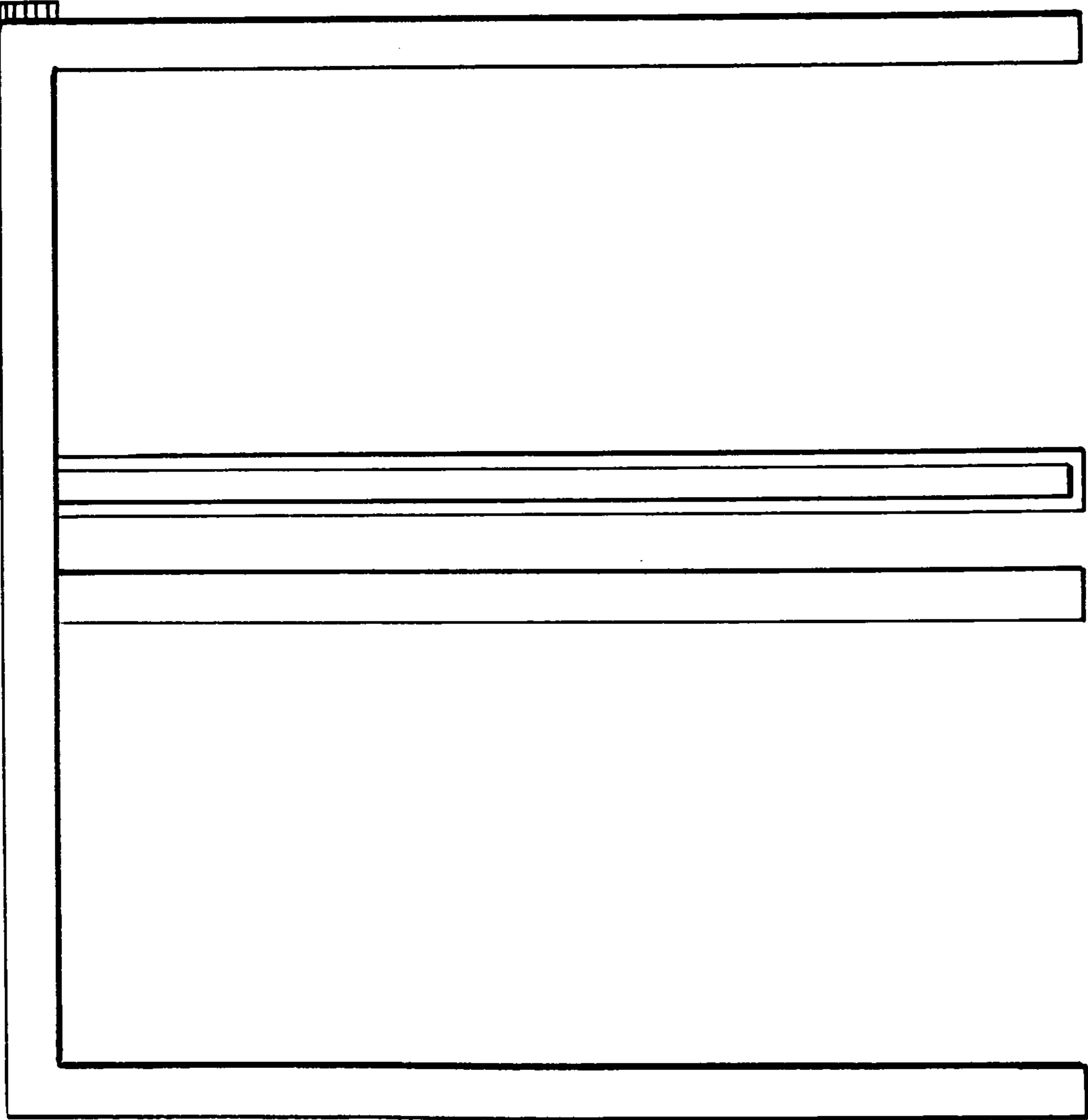
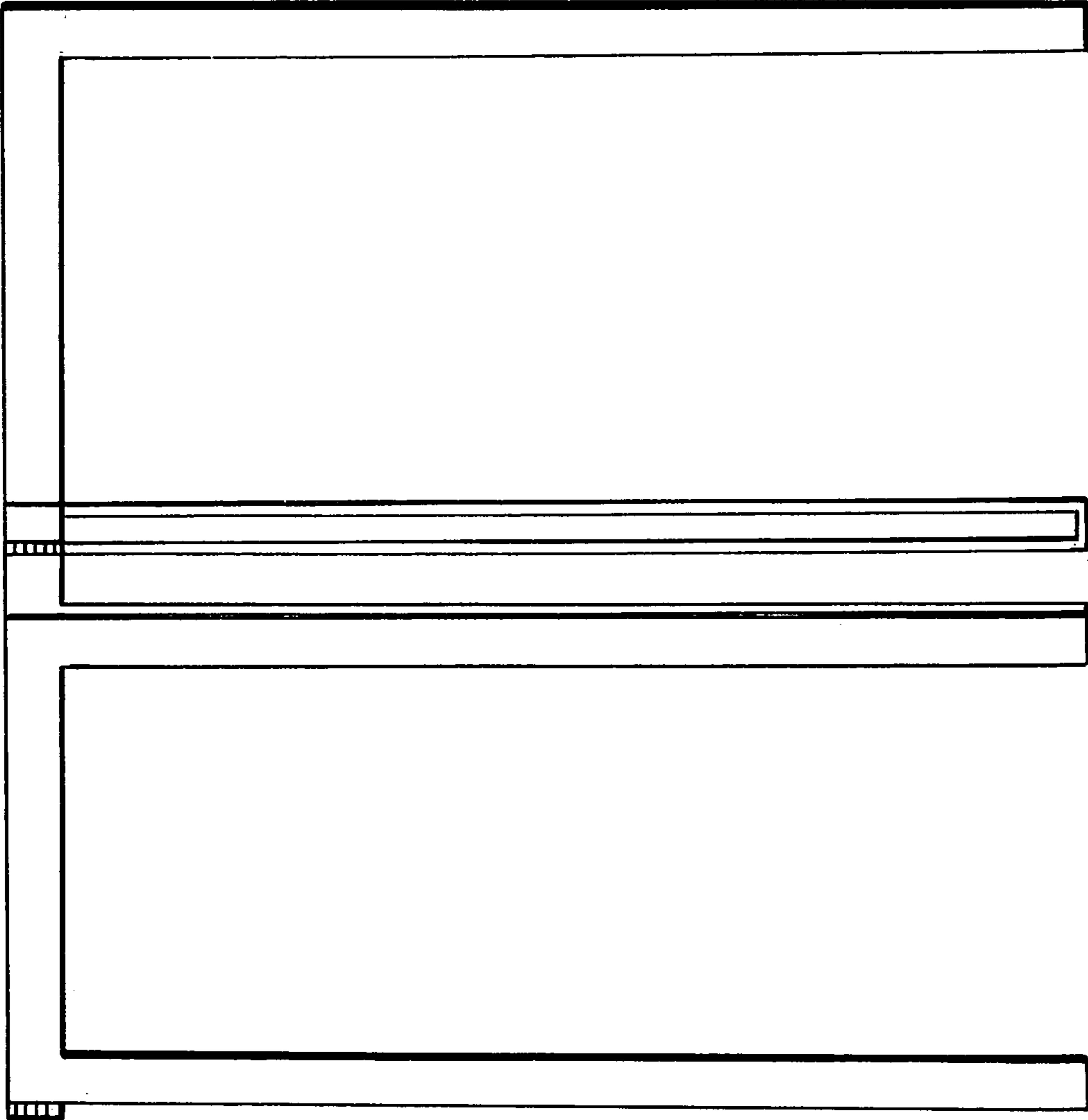

FIG. 4



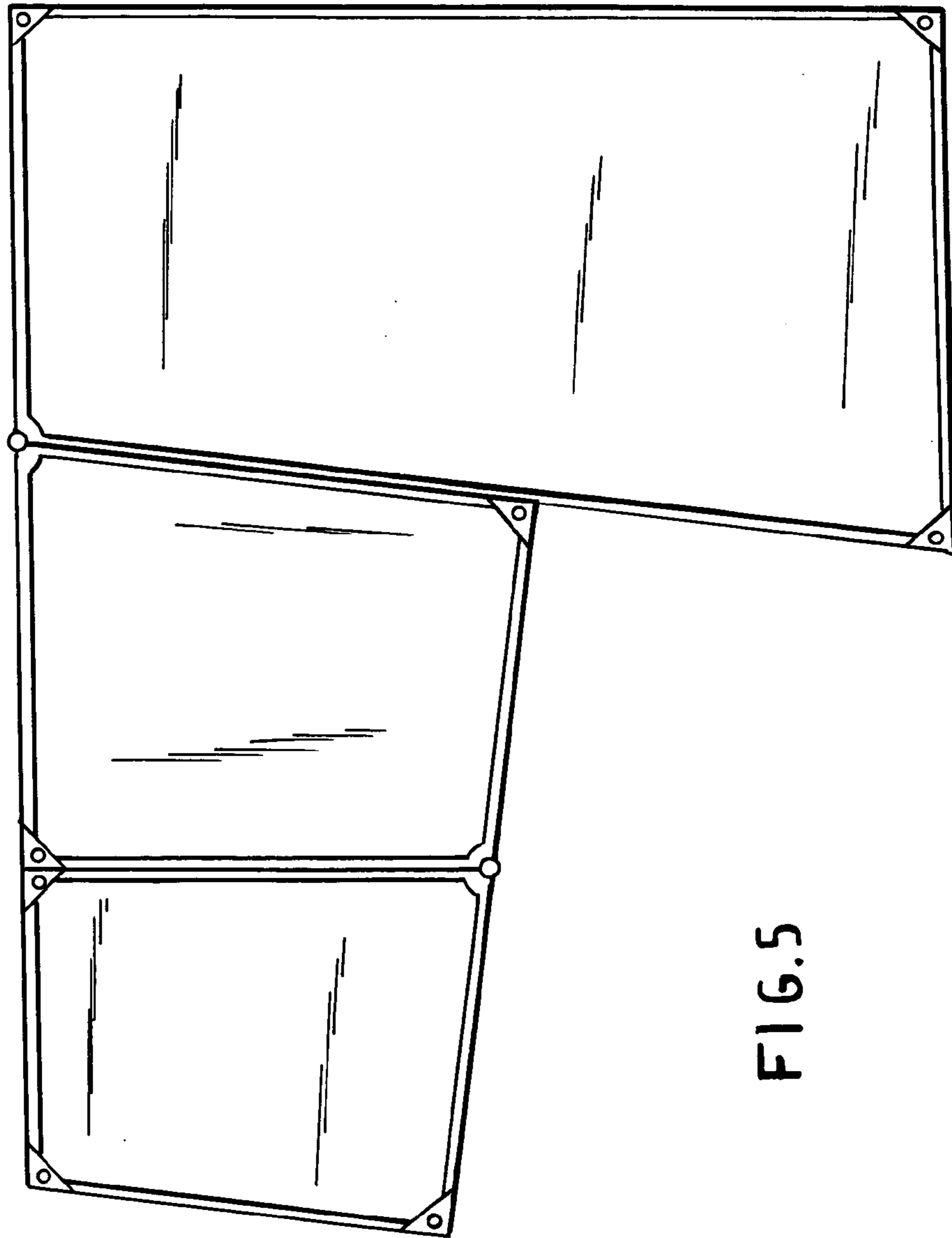
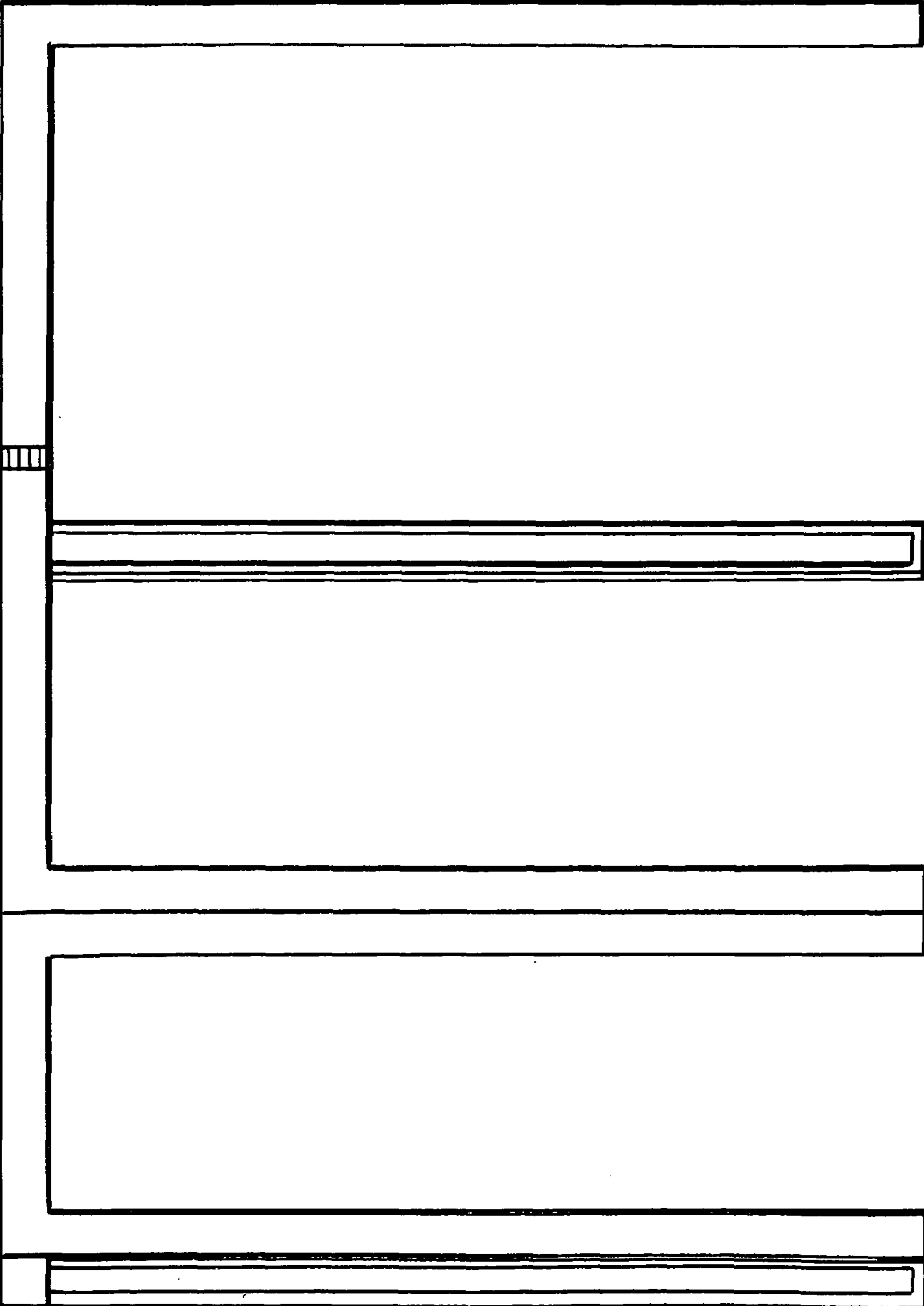

FIG. 5

FIG. 6



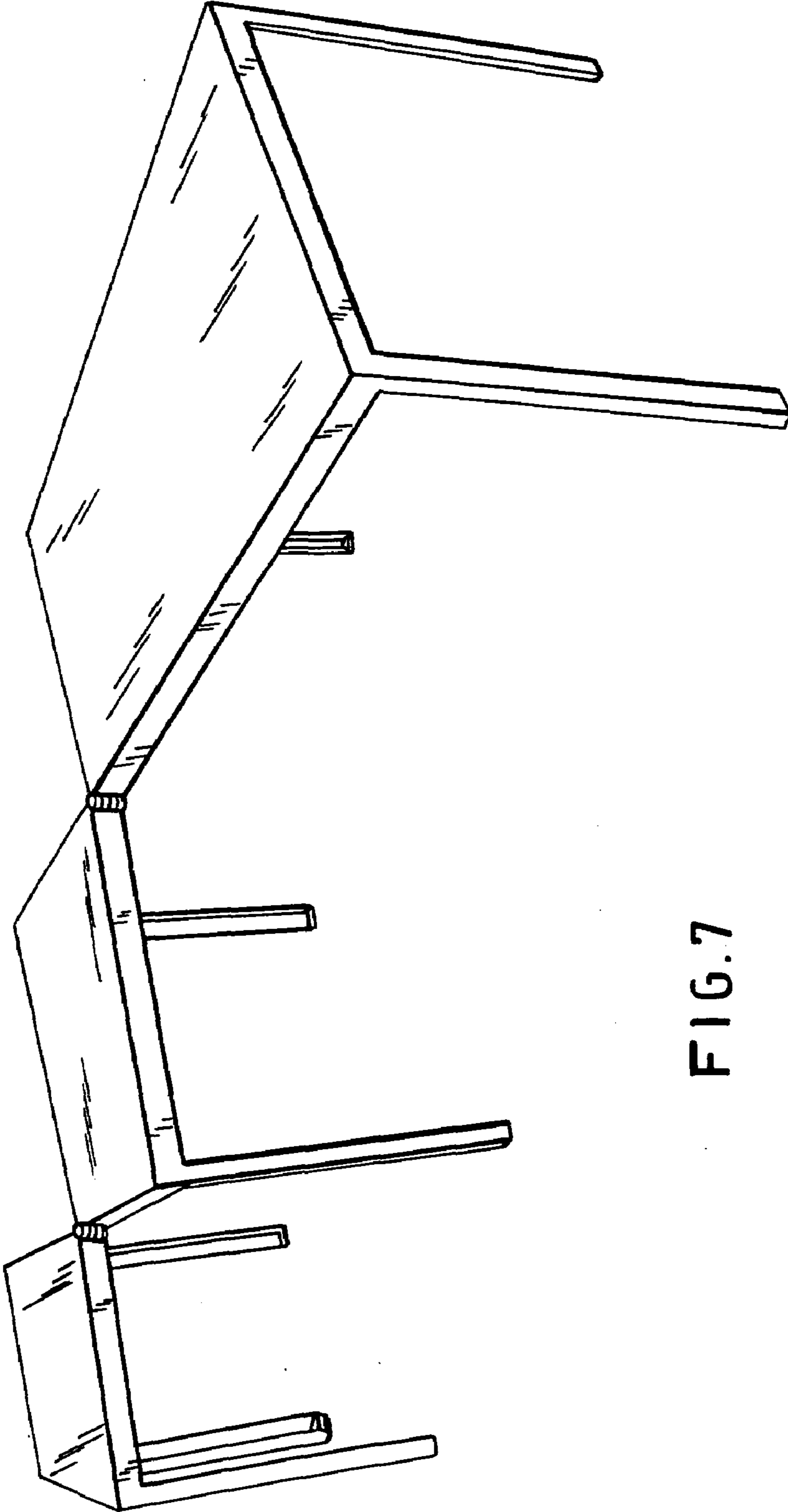

FIG. 7

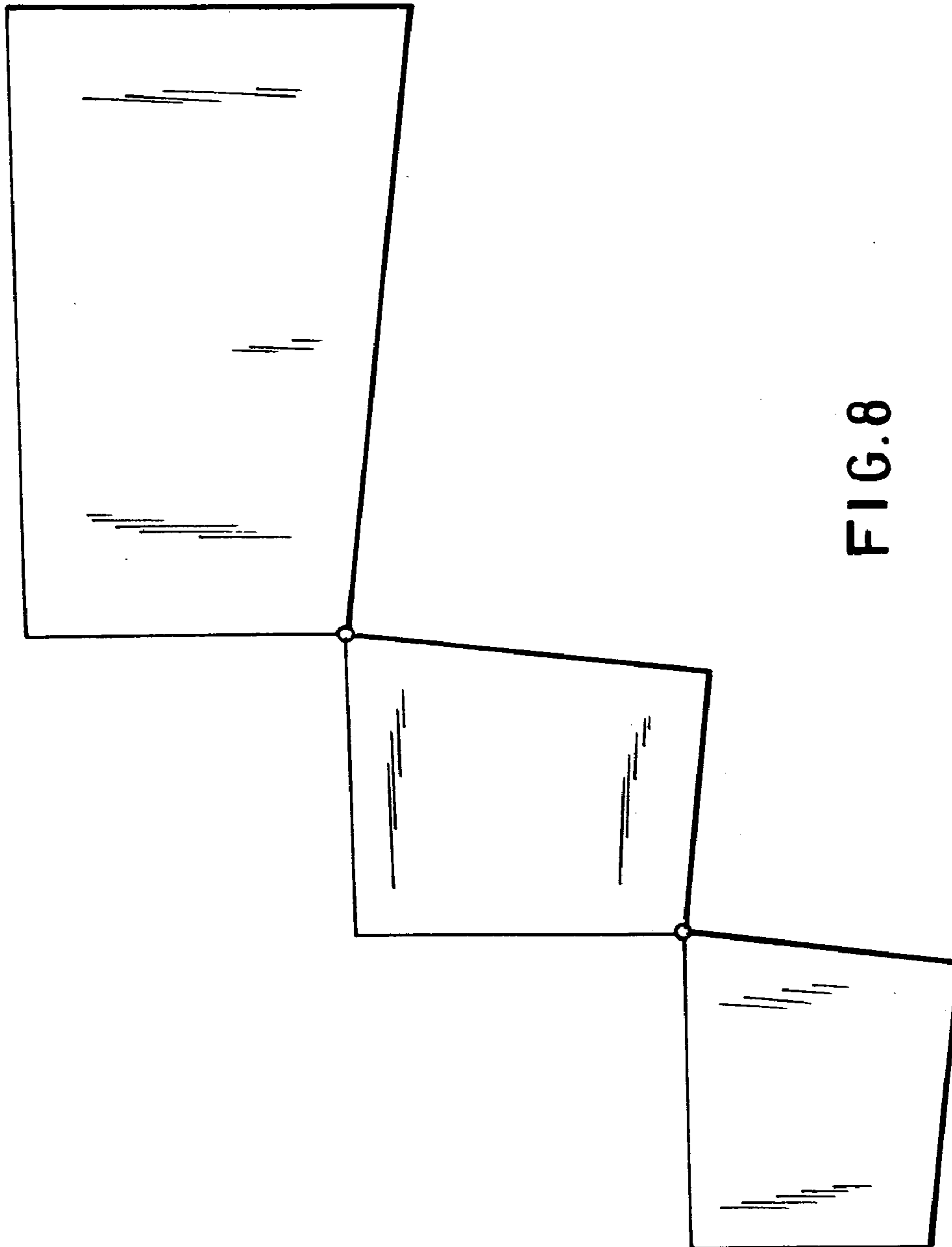

FIG. 8

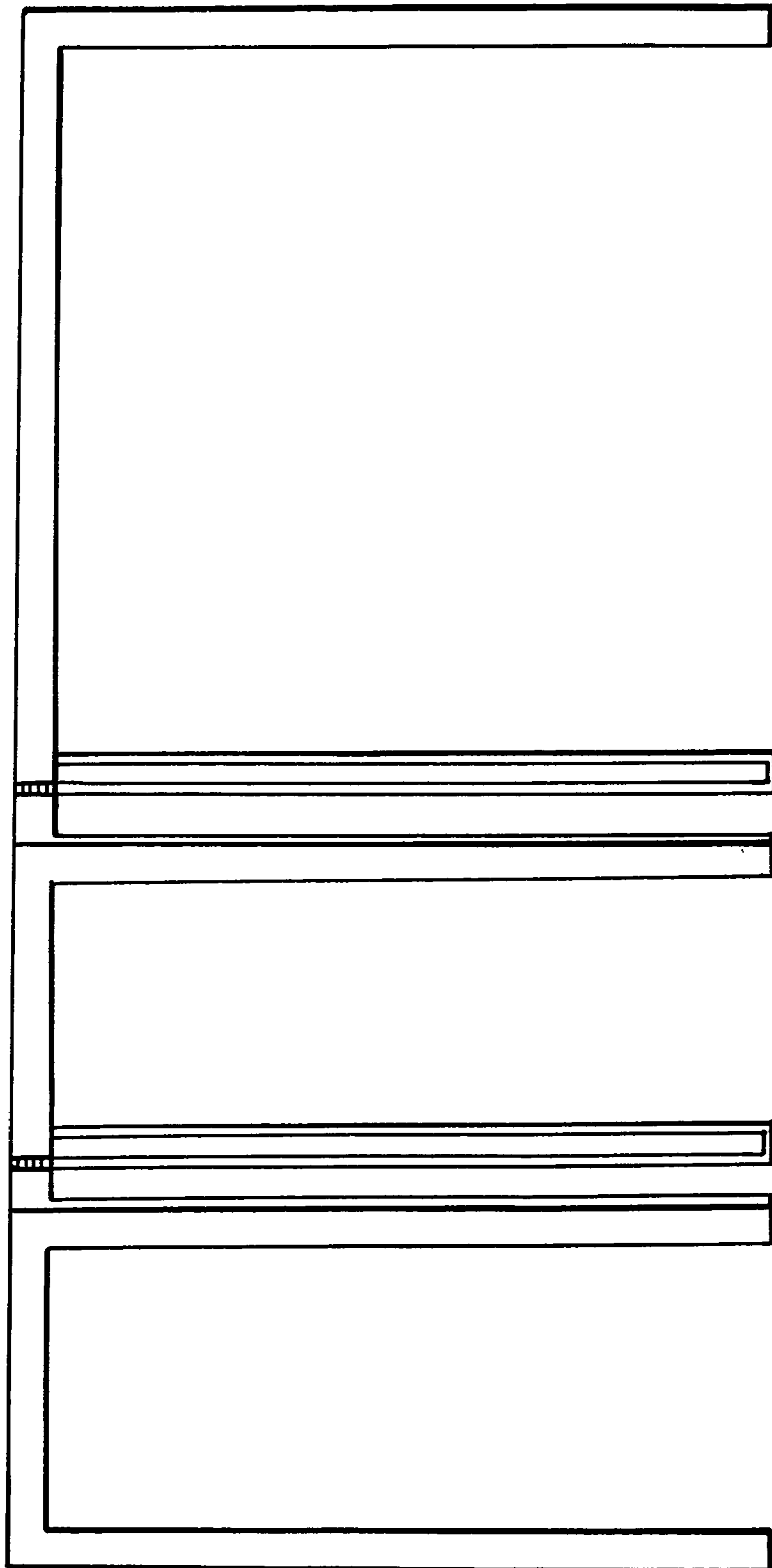

FIG. 9

FIG.10

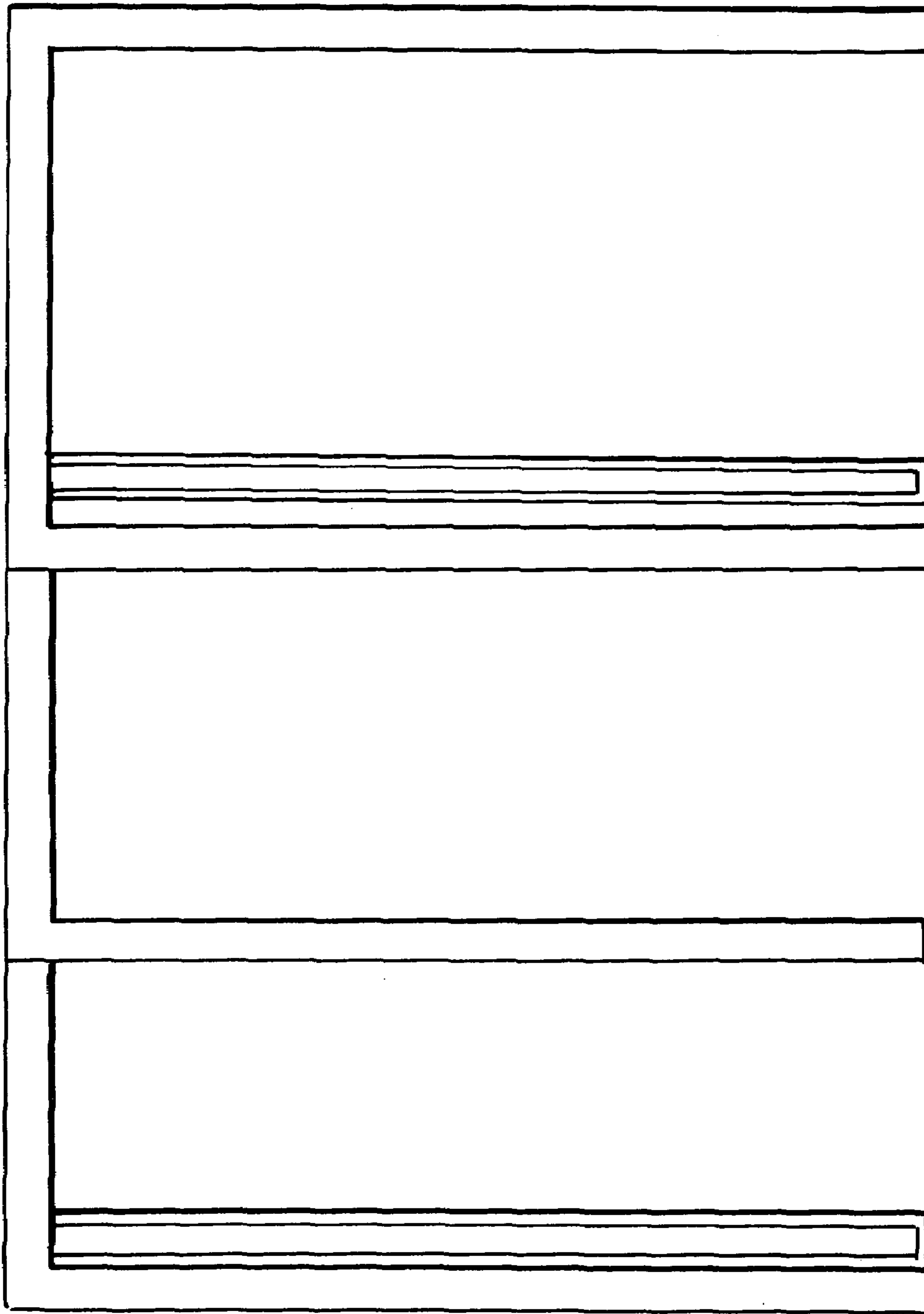
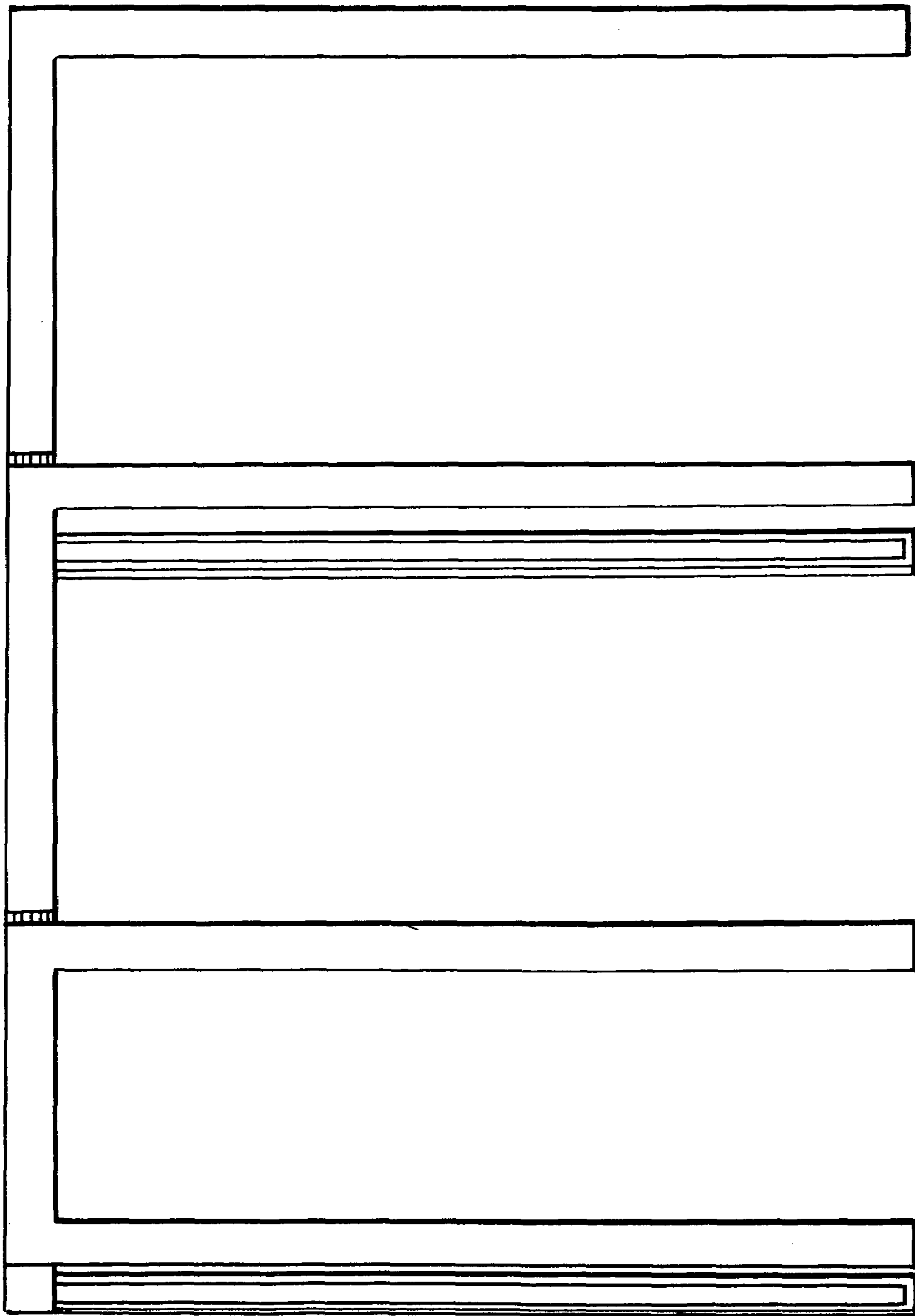

FIG. 11



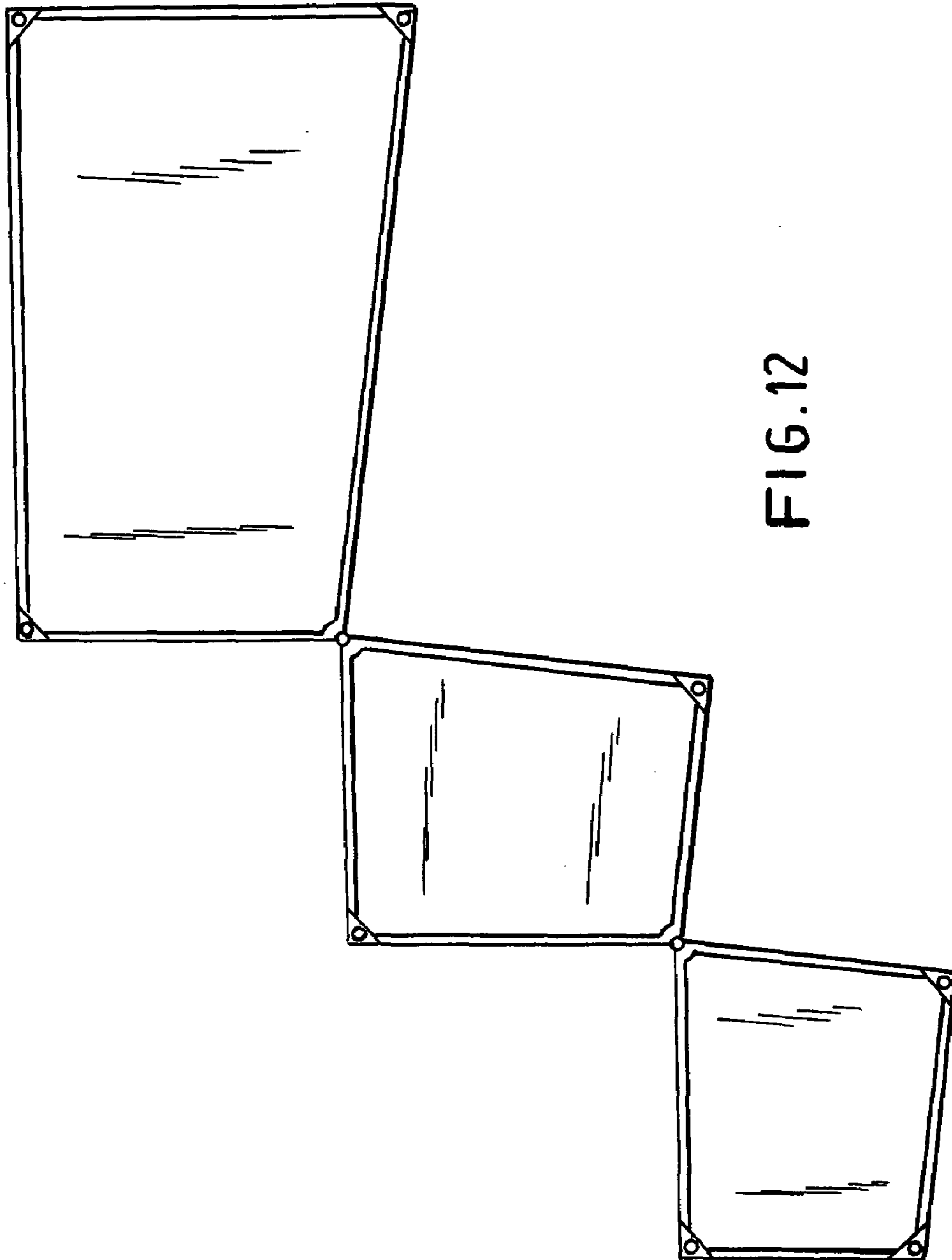

FIG. 12

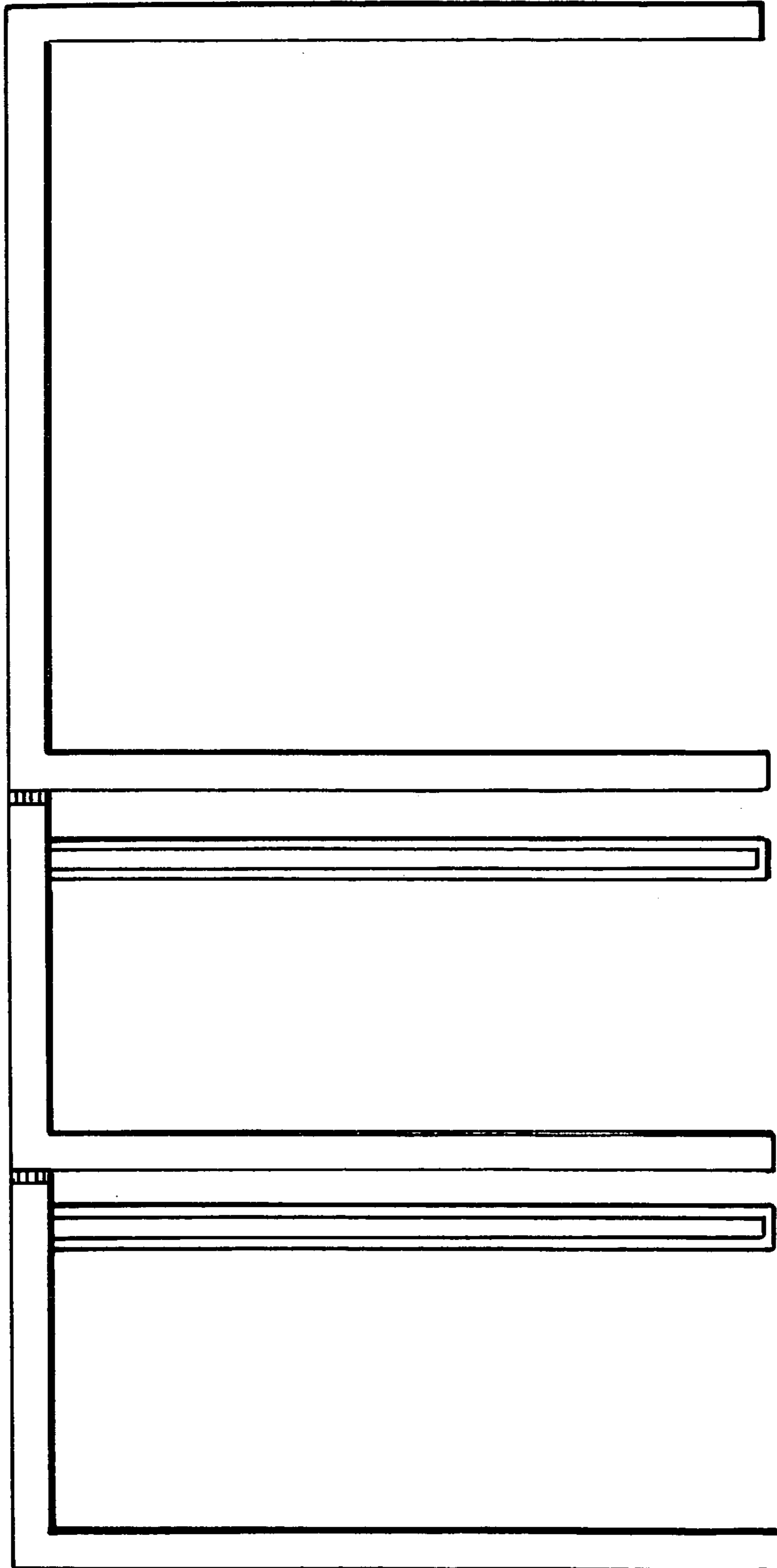

FIG.13

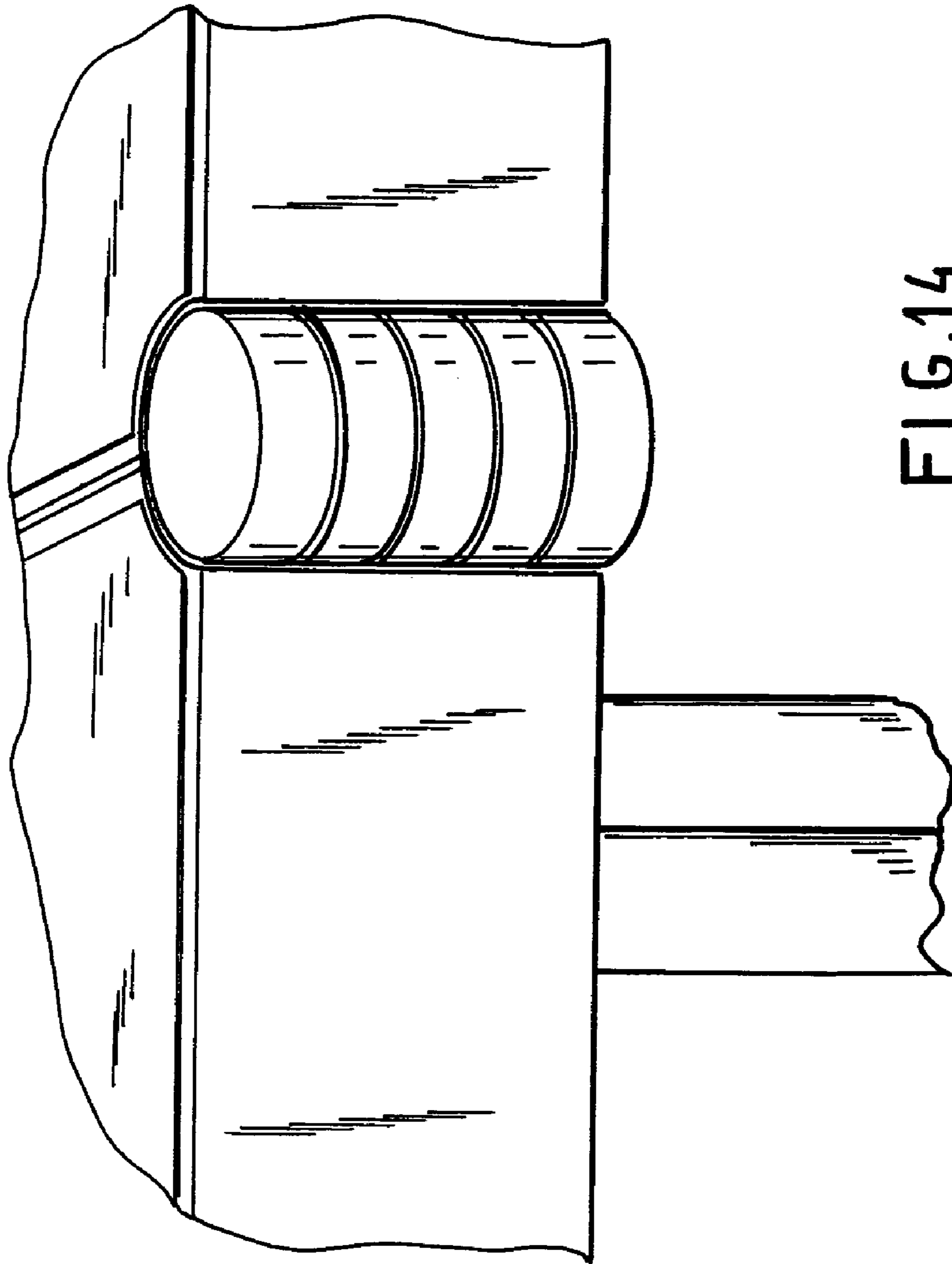

FIG. 14