



US00D569450S

(12) **United States Design Patent**  
**Halliday et al.**

(10) **Patent No.:** **US D569,450 S**

(45) **Date of Patent:** **\*\* May 20, 2008**

(54) **PLAY HOUSE**

(75) Inventors: **Glen H. Halliday**, Windham, ME (US);  
**Jeffery L. Leighton**, Windham, ME  
(US)

(73) Assignee: **Kids Crooked House, LLC**, Windham,  
ME (US)

(\*\*) Term: **14 Years**

(21) Appl. No.: **29/287,327**

(22) Filed: **Jul. 24, 2007**

(51) **LOC (8) Cl.** ..... **21-01**

(52) **U.S. Cl.** ..... **D21/511**

(58) **Field of Classification Search** ..... D21/483,  
D21/494, 506-511, 811; D25/1, 4, 7, 14-17,  
D25/22, 29; 446/423, 476-478, 110; D30/108  
See application file for complete search history.

(56) **References Cited**

**U.S. PATENT DOCUMENTS**

- D84,958 S \* 8/1931 Rowles ..... D25/22
- D111,534 S \* 9/1938 Duncan ..... D25/17
- D139,527 S \* 11/1944 Olson ..... D21/511
- D185,041 S \* 4/1959 Sanderson ..... D21/511
- D281,986 S \* 12/1985 Nottingham et al. .... D21/511
- D286,307 S \* 10/1986 Roy ..... D21/511
- D295,898 S \* 5/1988 Rupp ..... D25/1

- D335,904 S \* 5/1993 Krebs ..... D21/511
- D344,770 S \* 3/1994 Swiderski ..... D21/511
- D346,836 S \* 5/1994 El-Masri et al. .... D21/510
- D432,593 S \* 10/2000 Naughton ..... D21/511
- D532,462 S \* 11/2006 DeBlanco ..... D21/511

\* cited by examiner

*Primary Examiner*—Holly H. Baynham

*Assistant Examiner*—Cynthia M. Chin

(74) *Attorney, Agent, or Firm*—Finnegan, Henderson,  
Farabow, Garrett & Dunner, L.L.P.

(57) **CLAIM**

The ornamental design for a play house, as shown and described.

**DESCRIPTION**

FIG. 1 is front perspective view of a play house of our new design;

FIG. 2 is a front elevational view thereof;

FIG. 3 is a rear elevational view thereof;

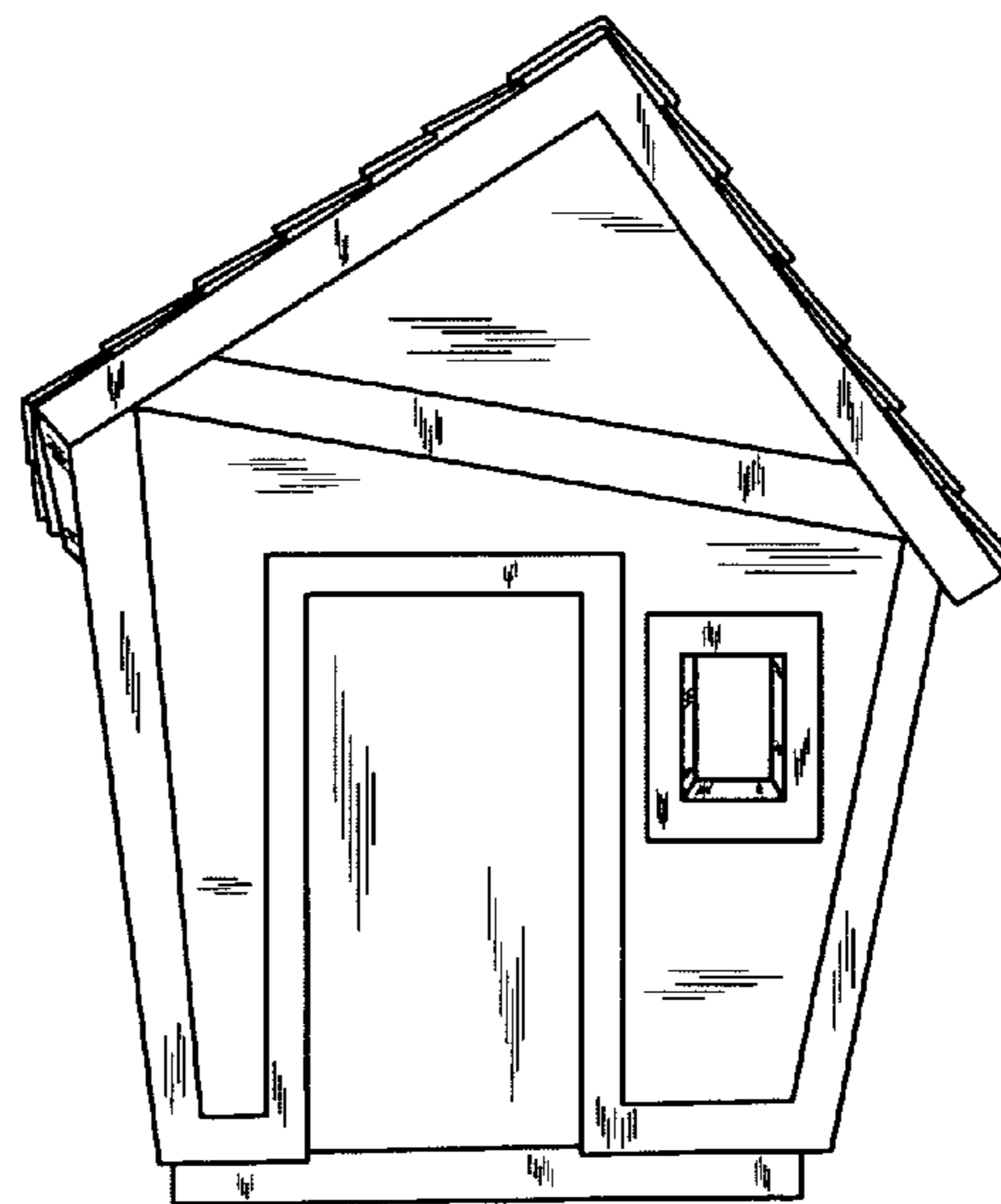
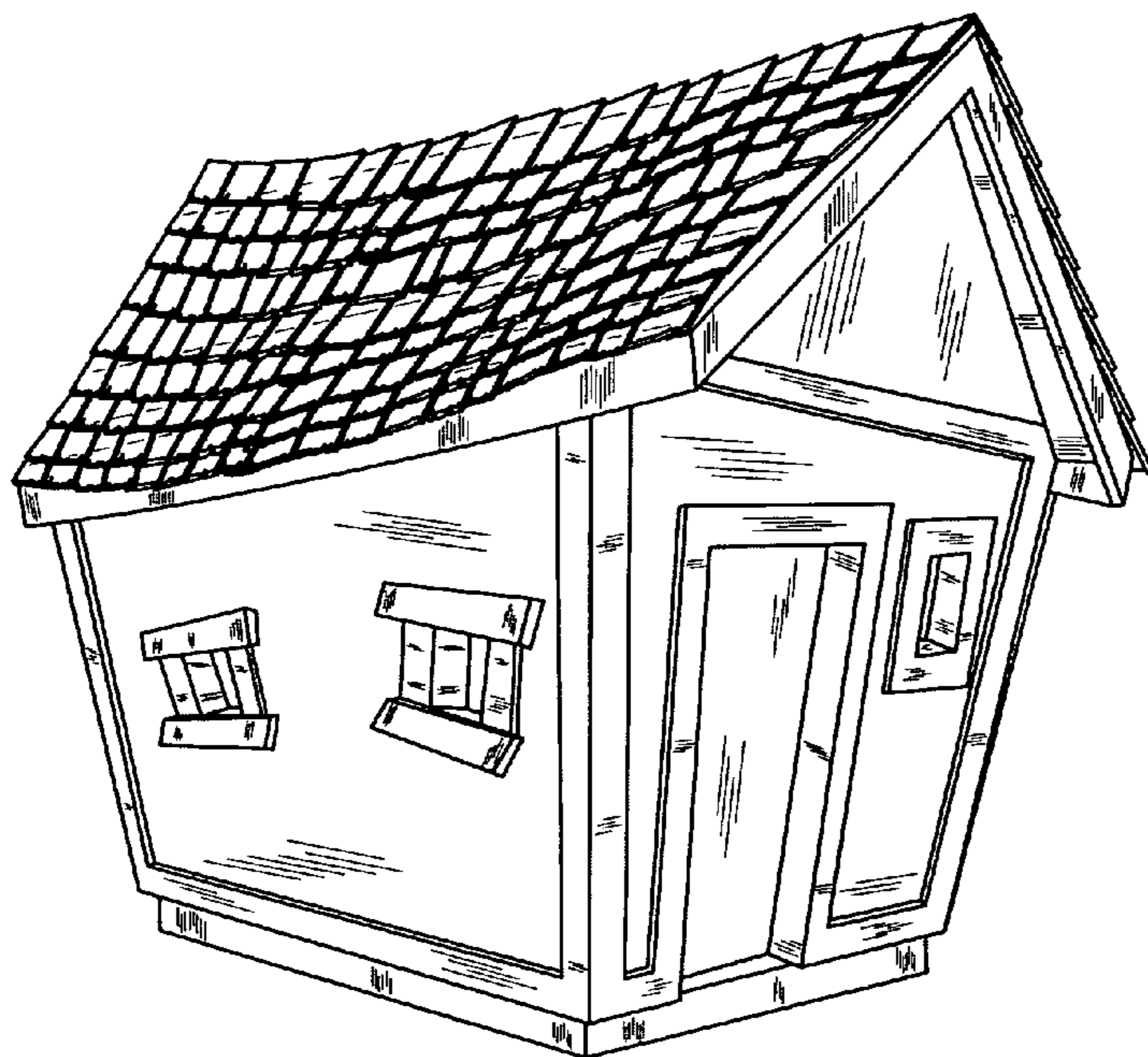
FIG. 4 is a left side view thereof;

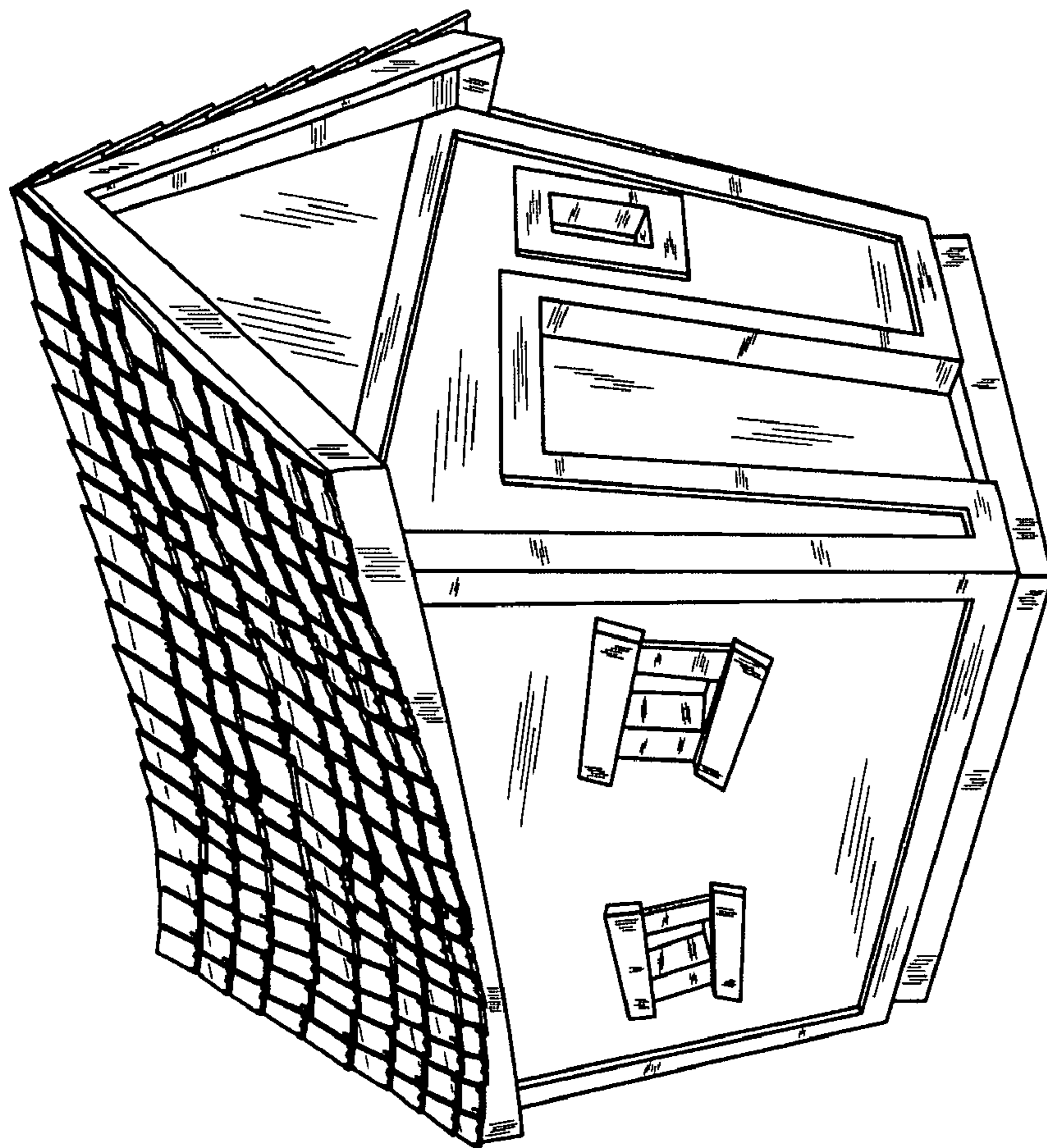
FIG. 5 is a right side view thereof; and,

FIG. 6 is a top plan view thereof.

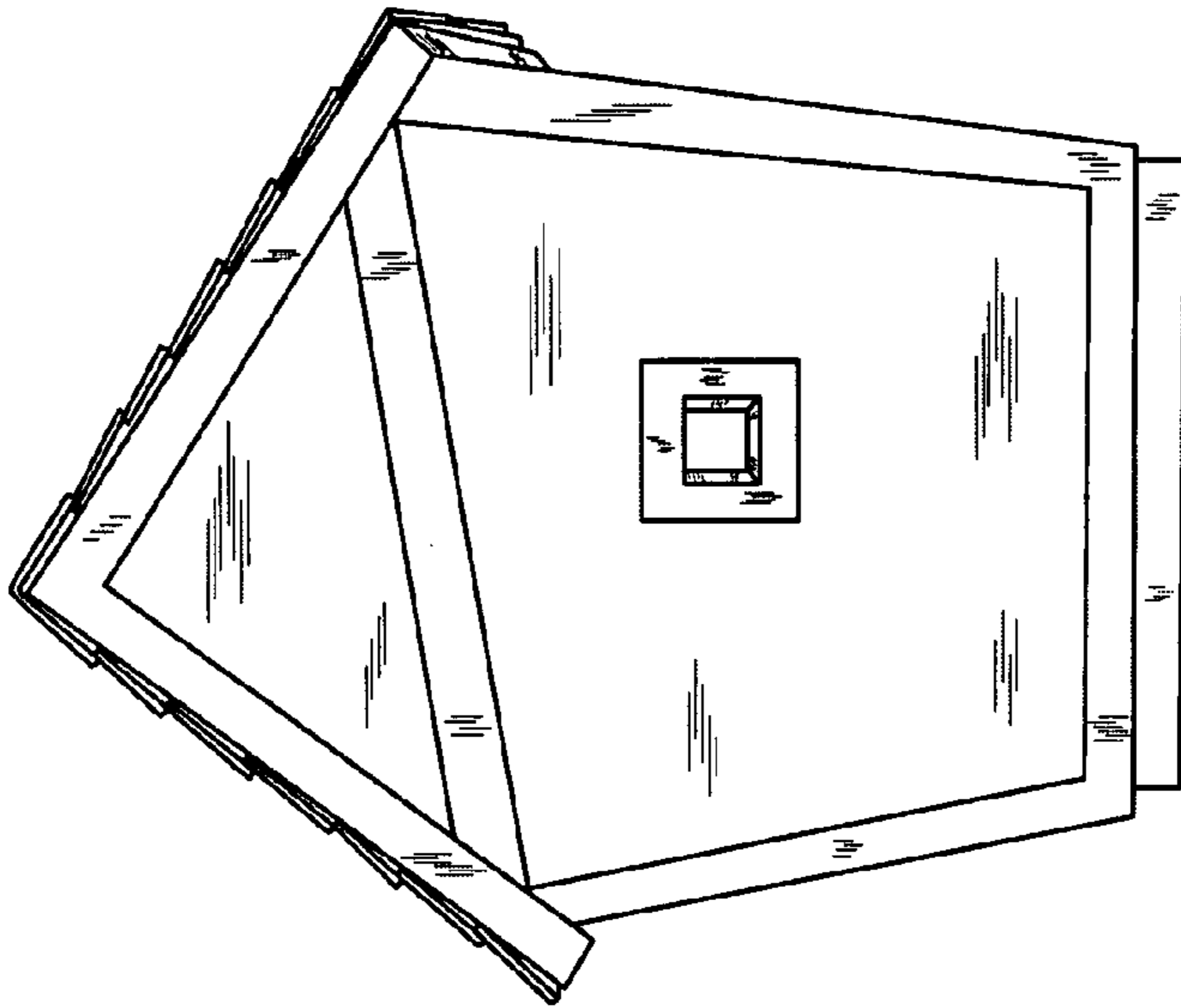
The bottom view of our design is not part of the claimed design.

**1 Claim, 4 Drawing Sheets**

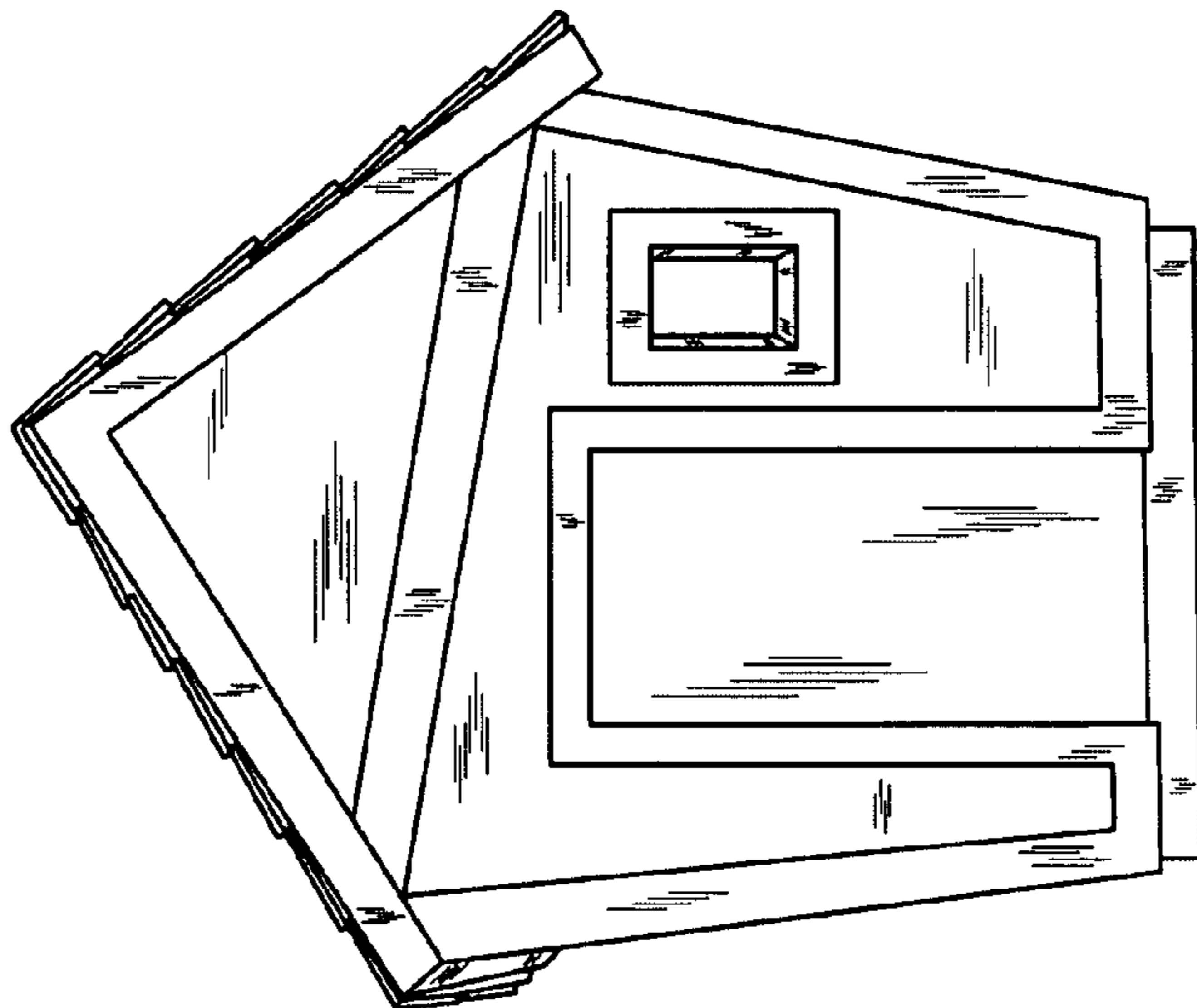




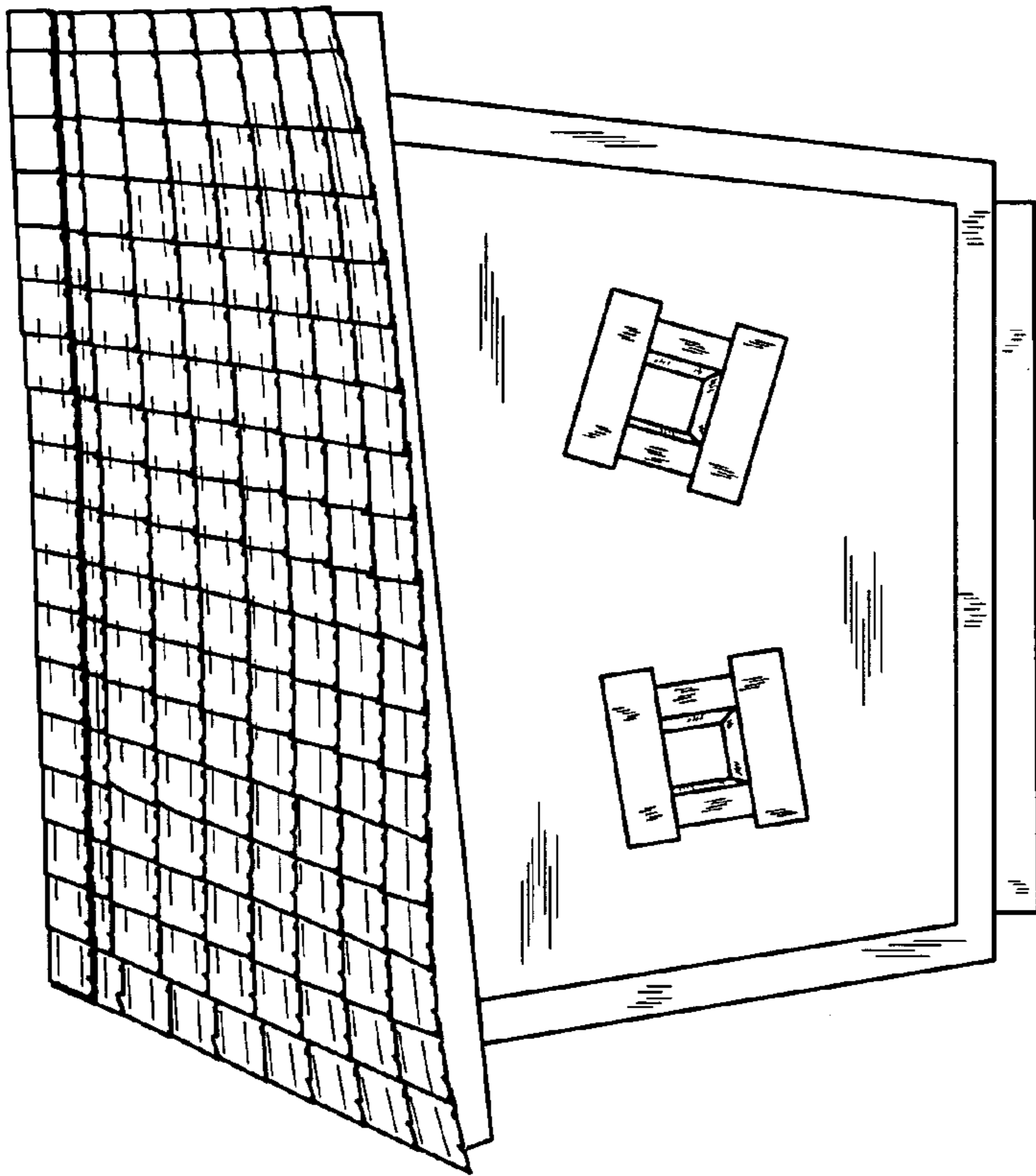
**FIG. 1**



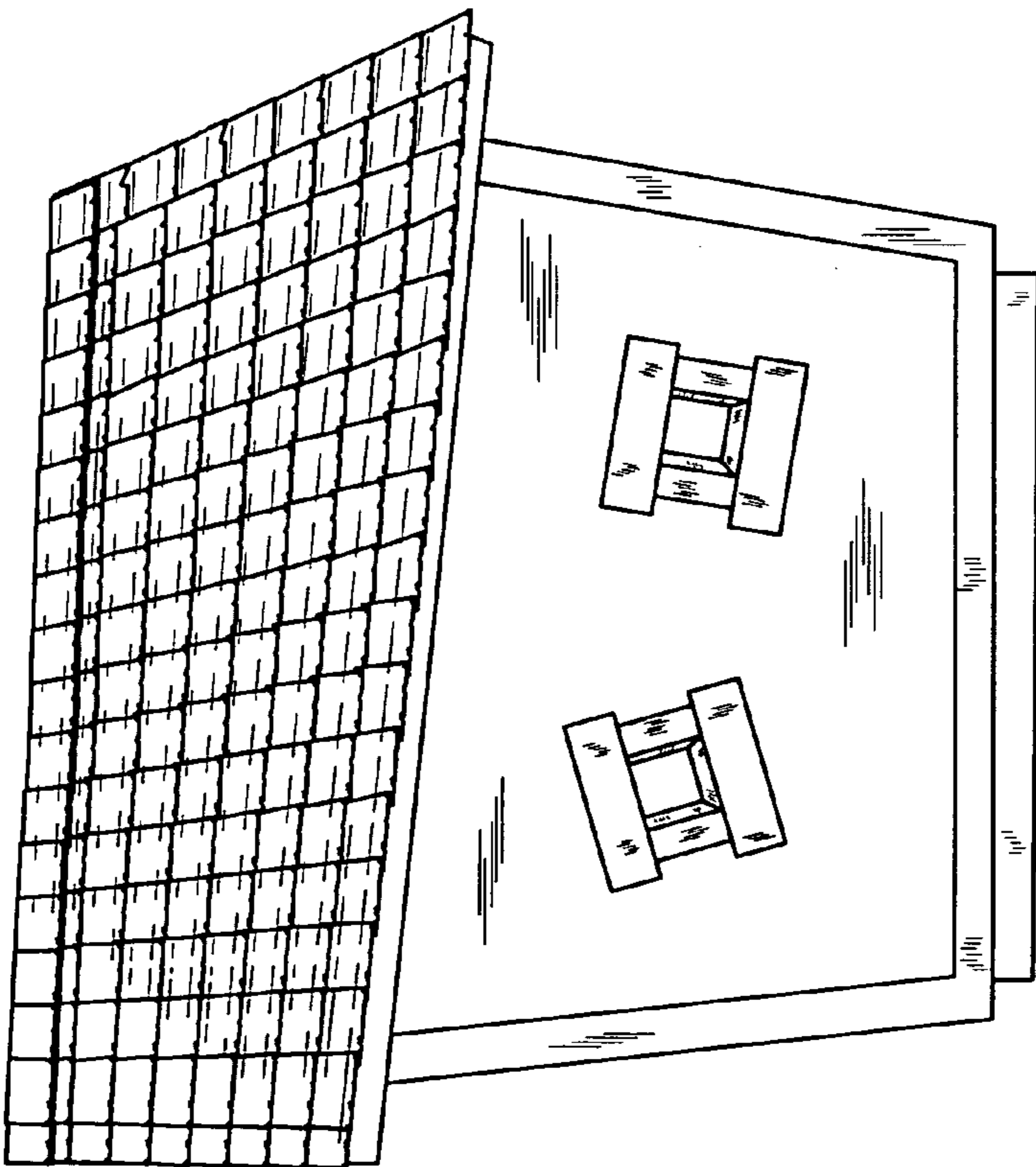
**FIG. 3**



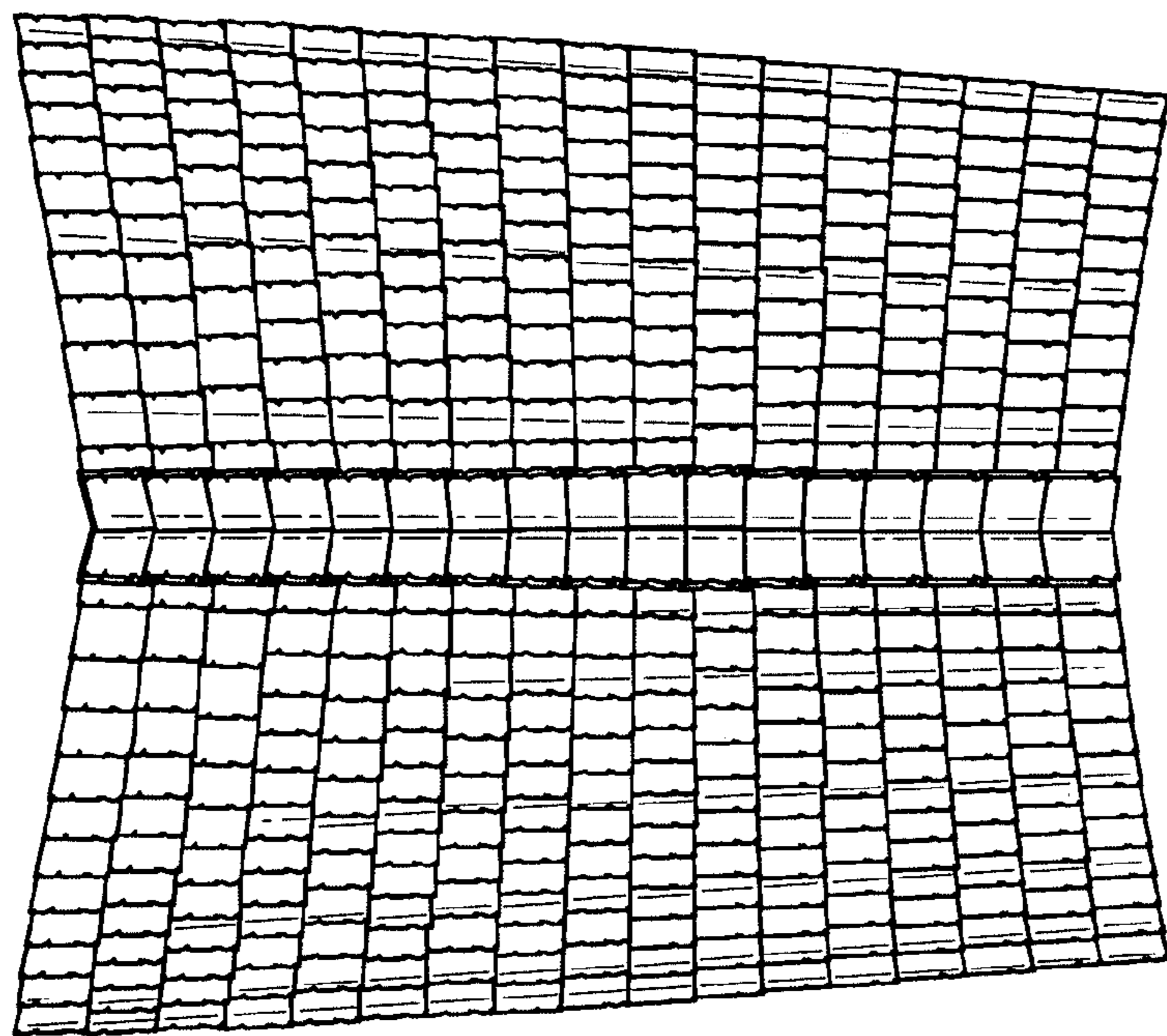
**FIG. 2**



**FIG. 5**



**FIG. 4**



**FIG. 6**