

US00D569014S

(12) **United States Design Patent**
Coates

(10) **Patent No.:** **US D569,014 S**
(45) **Date of Patent:** **** May 13, 2008**

(54) **CORNER POST**

(76) Inventor: **Tim W. Coates**, 8775 Bardstown Rd.,
Elizabethtown, KY (US) 42701

(**) Term: **14 Years**

(21) Appl. No.: **29/276,724**

(22) Filed: **Feb. 2, 2007**

(51) **LOC (8) Cl.** **25-01**

(52) **U.S. Cl.** **D25/139; D25/102**

(58) **Field of Classification Search** D25/139,
D25/102, 136, 124, 199; 52/407.1, 406.1,
52/520, 406.2, 555, 406.3, 174, 320, 325,
52/407.2, 323, 532, 404.1, 374, 519, 287.1,
52/288.1

See application file for complete search history.

(56) **References Cited**

U.S. PATENT DOCUMENTS

335,342 A	2/1886	Daugherty	
1,961,627 A	6/1934	Wilber	
1,976,947 A	10/1934	Krauss	
1,986,829 A	1/1935	Klimsza	
2,241,898 A	5/1941	Bawtenheimer	
2,255,736 A	9/1941	Odell	
2,305,280 A	12/1942	Strunk et al.	
4,319,439 A	3/1982	Gussow	
5,542,222 A	8/1996	Wilson et al.	
5,586,422 A	12/1996	Hoffner	
5,787,661 A	8/1998	Sharp	
5,836,123 A	11/1998	Gulino	
5,850,717 A	12/1998	Schiedegger et al.	
6,341,458 B1	1/2002	Burt	
D454,648 S *	3/2002	Shaw et al.	D25/139
D456,086 S *	4/2002	Habeck et al.	D25/124
6,385,927 B2	5/2002	Schiedegger et al.	
6,405,503 B1	6/2002	Reed	

D472,333 S	3/2003	Shaw	
6,553,732 B2	4/2003	Shaw	
D551,779 S *	9/2007	Swanson et al.	D25/102
2001/0022056 A1	9/2001	Gifford	
2001/0037617 A1 *	11/2001	Chi	52/288.1
2001/0054266 A1 *	12/2001	Bennett	52/312
2002/0121057 A1 *	9/2002	Steffes et al.	52/287.1
2002/0129572 A1	9/2002	Jurvis et al.	
2003/0037495 A1	2/2003	Shaw	

FOREIGN PATENT DOCUMENTS

JP 2016260 1/1990

* cited by examiner

Primary Examiner—Catherine R. Oliver
(74) *Attorney, Agent, or Firm*—Laura M. Hagan; Kerrick,
Stivers, Coyle & Yan Zant, PLC

(57) **CLAIM**

I claim the ornamental design for a “corner post,” as shown and described.

DESCRIPTION

FIG. 1 is a perspective view of a corner post;
FIG. 2 is a perspective view of a corner post, shown fragmented, indicating indefinite length for covering a corner of a structure;
FIG. 3 is a right-side, front elevational view of the one-piece corner post, the left side front elevational view being a mirror image thereof;
FIG. 4 is a left-side, rear elevational view of the one-piece corner post, the right side rear elevational view being a mirror image thereof;
FIG. 5 is a top plan view of the decorative corner post; and,
FIG. 6 is a bottom plan view of the one-piece corner post.

1 Claim, 5 Drawing Sheets

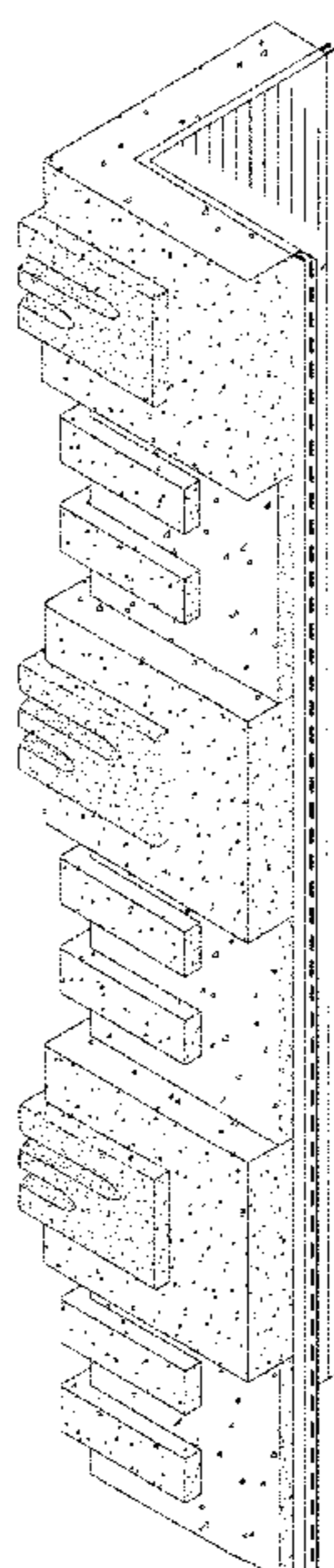

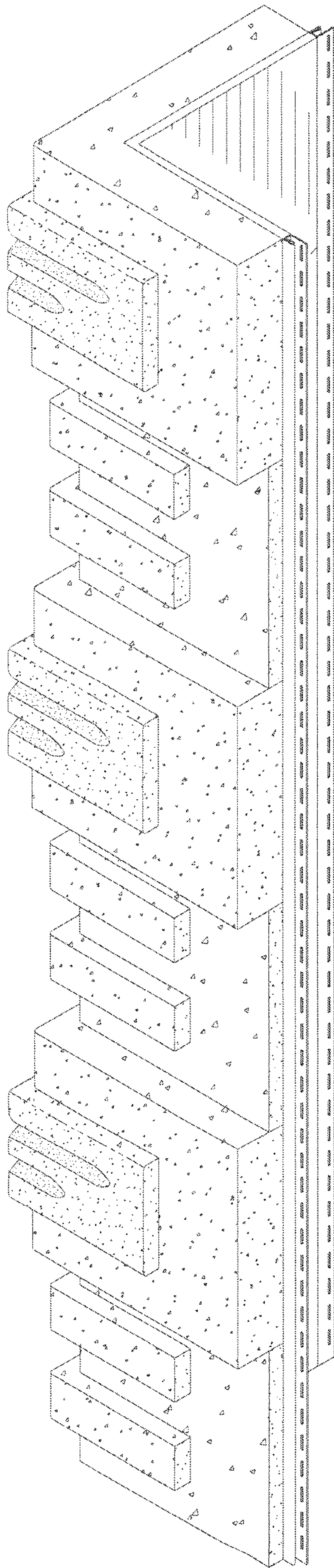

FIGURE 1

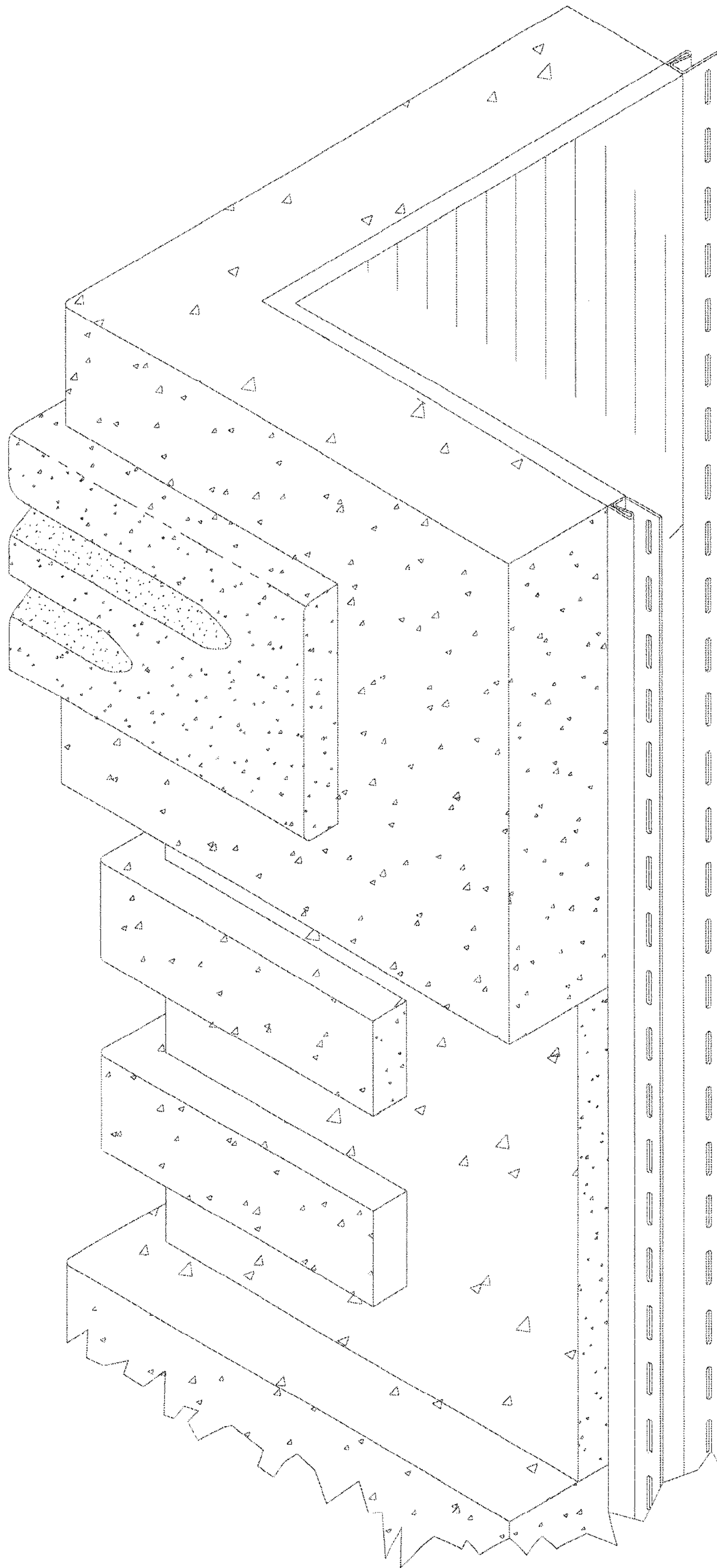

FIGURE 2

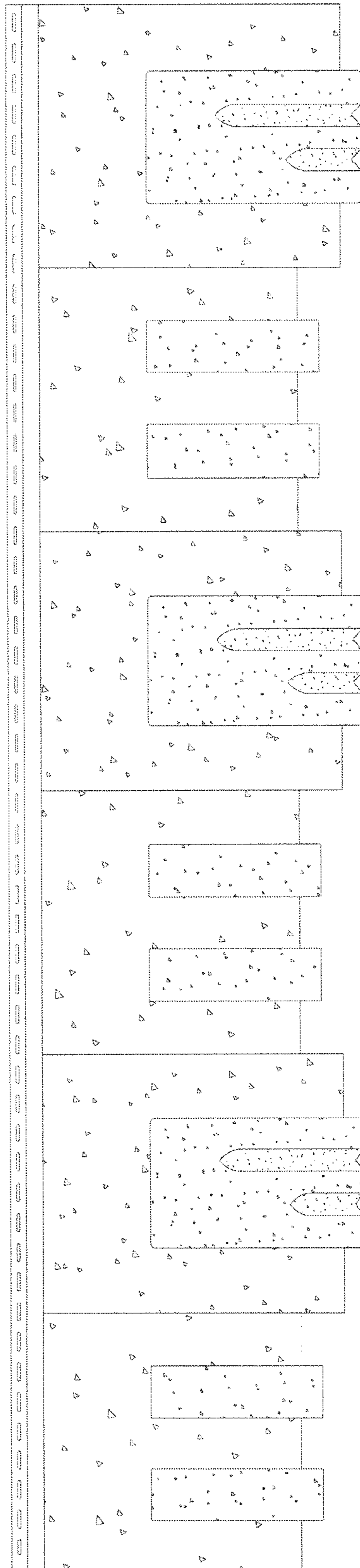

FIGURE 3

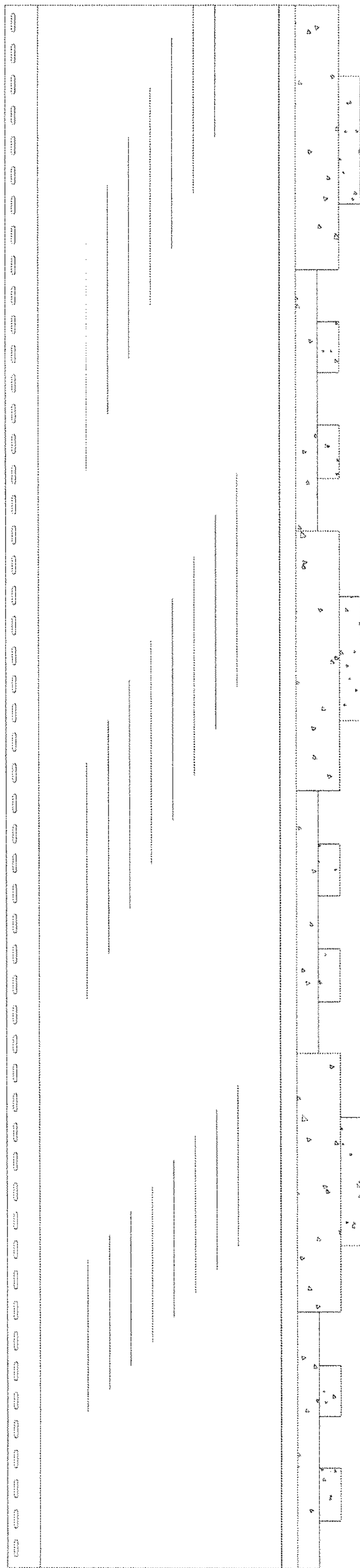

FIGURE 4

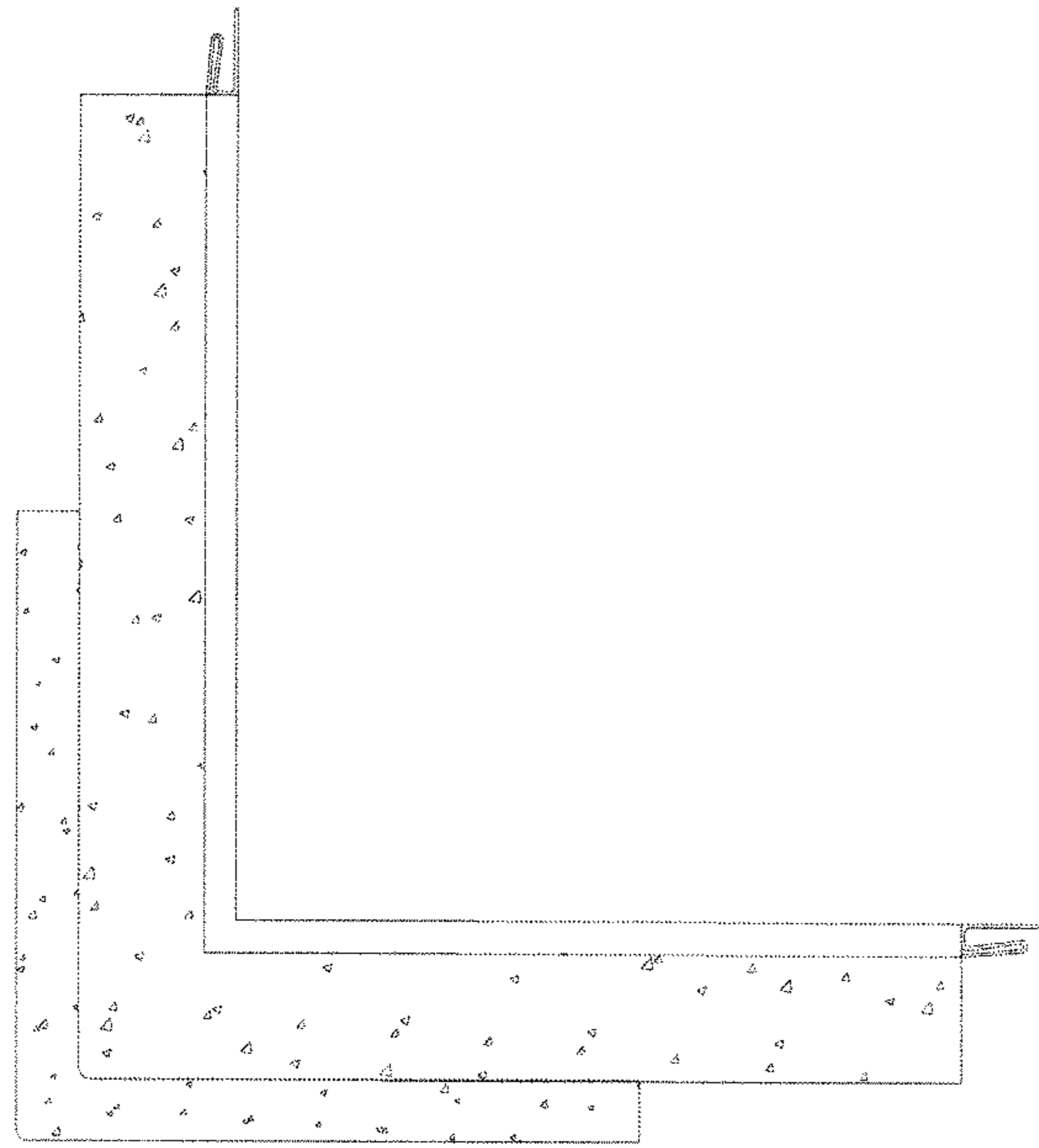

FIGURE 5

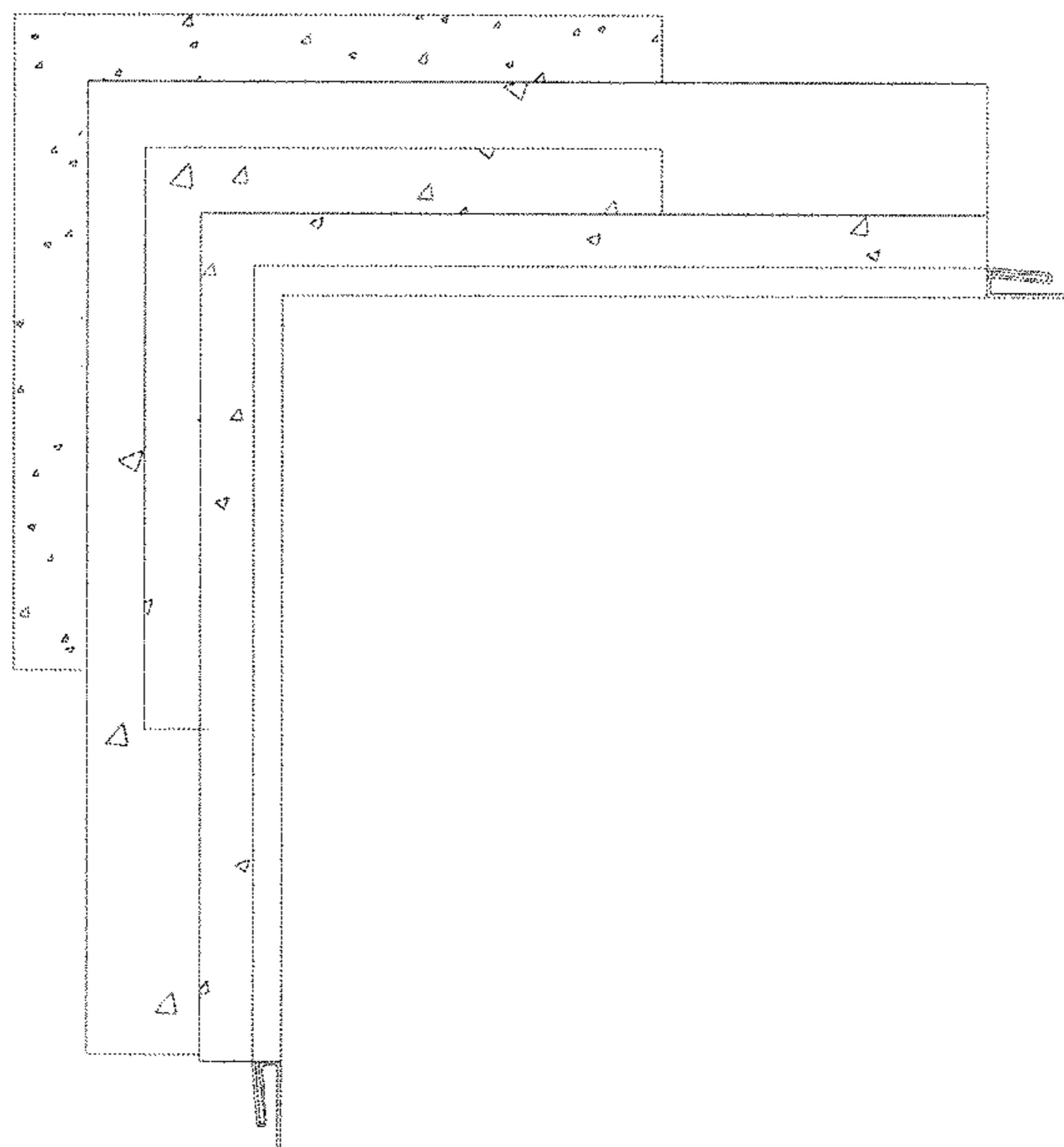

FIGURE 6