



US00D568393S

(12) **United States Design Patent**
Bhavnani

(10) **Patent No.:** **US D568,393 S**

(45) **Date of Patent:** **** May 6, 2008**

- (54) **PEN**
- (75) Inventor: **Dilip Bhavnani**, Beverly Hills, CA (US)
- (73) Assignee: **Sun Coast Merchandise Corporation**, Commerce, CA (US)
- (**) Term: **14 Years**
- (21) Appl. No.: **29/283,163**
- (22) Filed: **Aug. 7, 2007**
- (51) **LOC (8) Cl.** **19-06**
- (52) **U.S. Cl.** **D19/51**
- (58) **Field of Classification Search** D19/35, D19/36, 41-51, 53-57; 24/11 R, 11 F, 11 P; 401/52, 99, 100, 104, 105, 106, 107, 108, 401/109, 192, 195, 196
See application file for complete search history.

- D501,506 S * 2/2005 Kommer D19/51
- D512,457 S * 12/2005 Anand D19/48
- D513,766 S * 1/2006 Cetera D19/36
- D519,563 S * 4/2006 Pellissa Beneyto D19/51
- D523,081 S * 6/2006 Pellissa Beneyto D19/51
- 7,086,798 B1 * 8/2006 Cetera 401/195
- D529,089 S * 9/2006 Bhavnani D19/36
- D545,900 S * 7/2007 Gerules D19/51
- D546,385 S * 7/2007 Bhavnani D19/41
- D551,709 S * 9/2007 Pellissa Beneyto D19/50
- D552,678 S * 10/2007 Pellissa Beneyto D19/51

* cited by examiner

Primary Examiner—Elizabeth A. Albert

(74) *Attorney, Agent, or Firm*—The Soni Law Firm

(57) **CLAIM**

The ornamental design for a pen, as shown and described.

DESCRIPTION

FIG. 1 is a front bottom side perspective view of the pen showing my new design;

FIG. 2 is a right side elevational view thereof;

FIG. 3 is a front elevational view thereof;

FIG. 4 is a left side elevational view thereof;

FIG. 5 is a back elevational view thereof;

FIG. 6 is a bottom plan view thereof; and,

FIG. 7 is a top plan view thereof.

1 Claim, 2 Drawing Sheets

(56) **References Cited**
U.S. PATENT DOCUMENTS

- D233,613 S * 11/1974 Hand, III D3/225
- D394,875 S * 6/1998 Izushima D19/51
- D413,145 S * 8/1999 Brescia et al. D19/51
- D415,199 S * 10/1999 Pellissa Beneyto D19/51
- D435,065 S * 12/2000 Nagel D19/50
- D441,015 S * 4/2001 Izushima D19/47
- D448,803 S * 10/2001 Izushima D19/51
- D458,964 S * 6/2002 Nakazawa D19/48

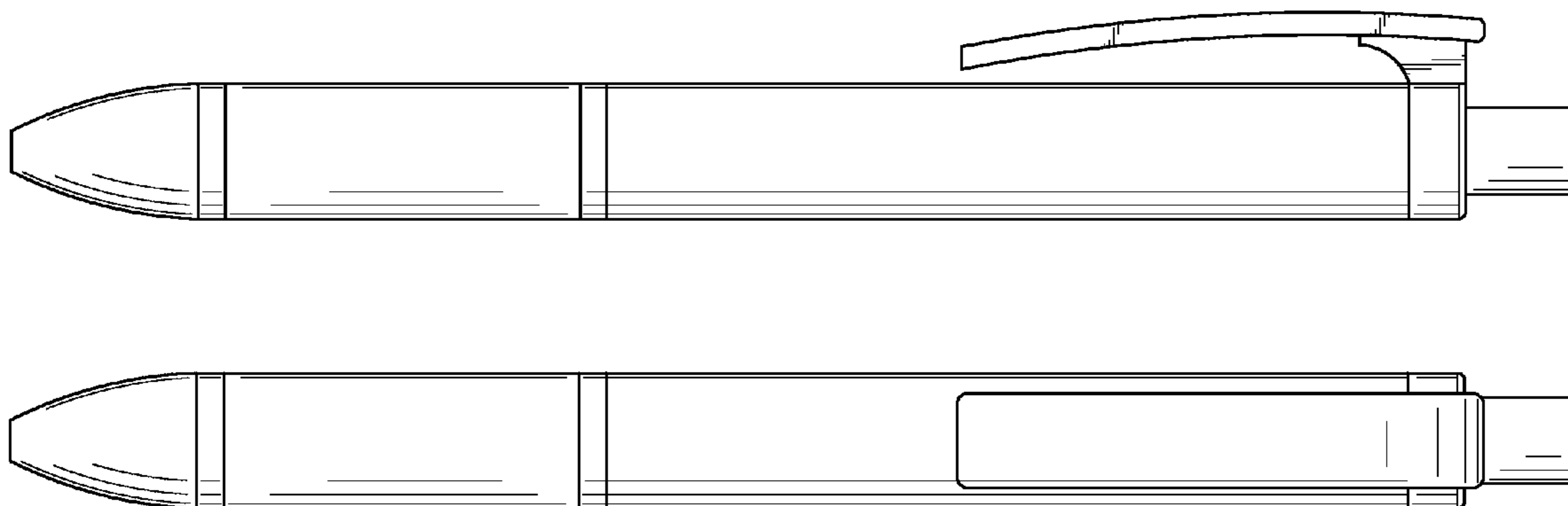

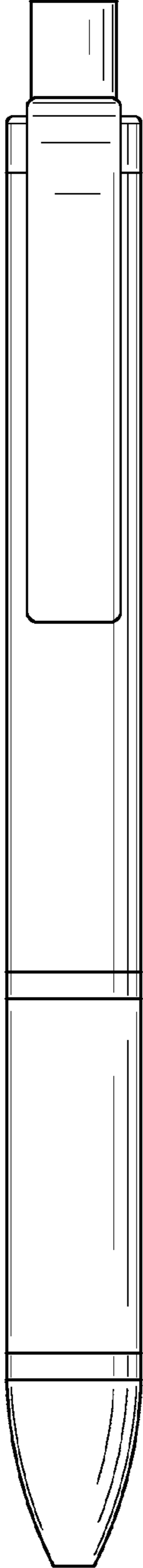
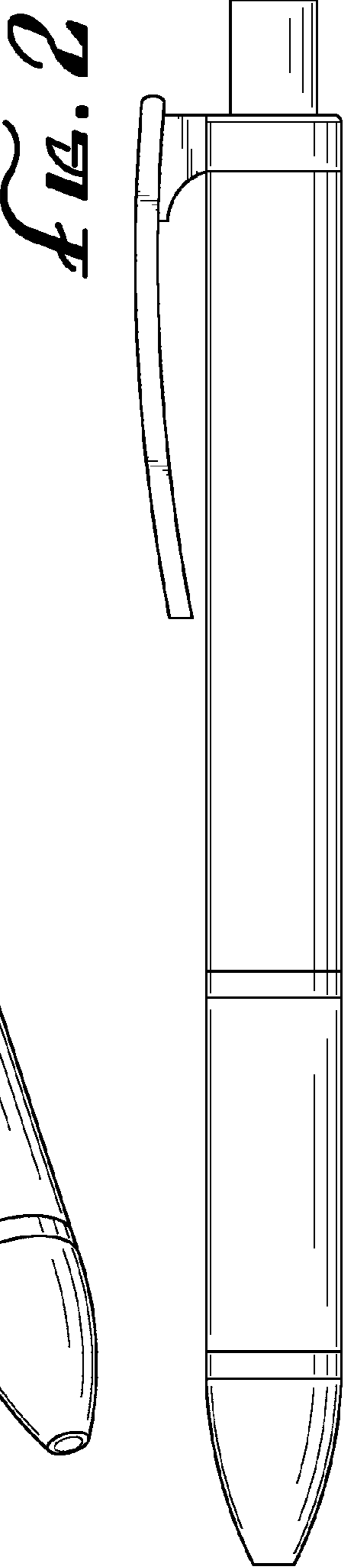
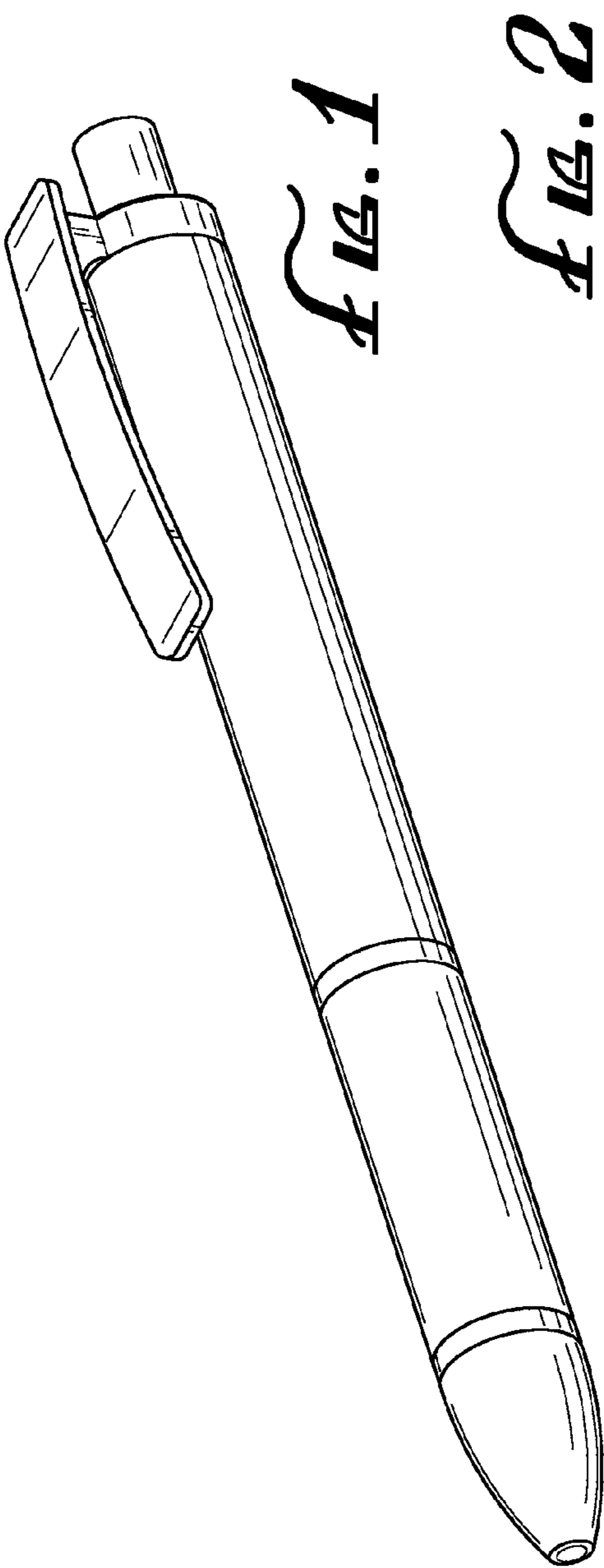

FIG. 4

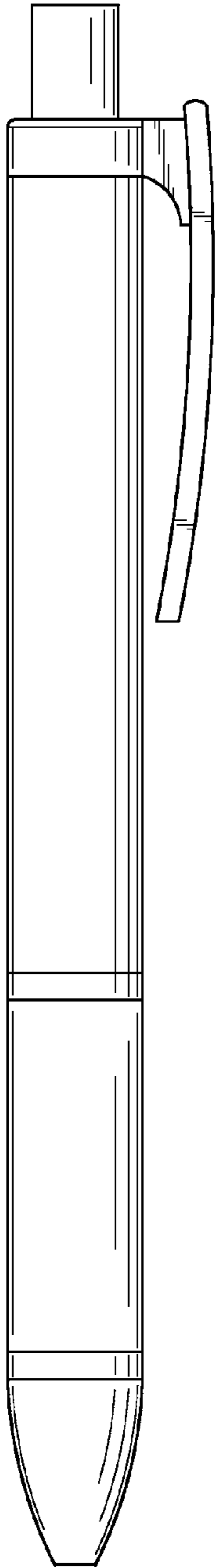

FIG. 5

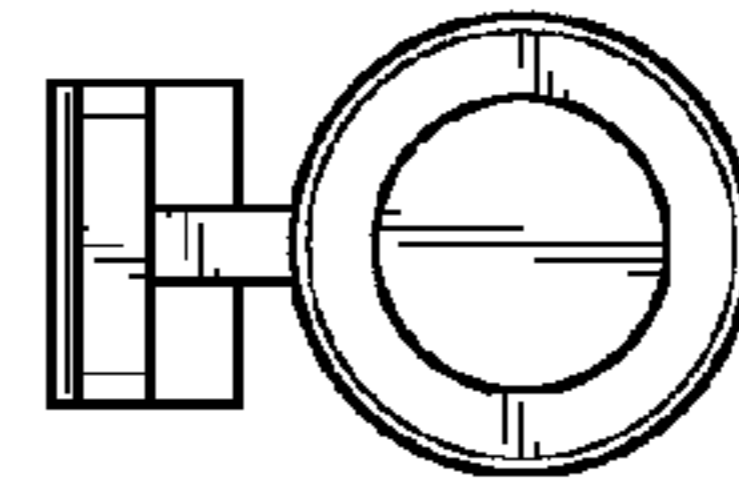
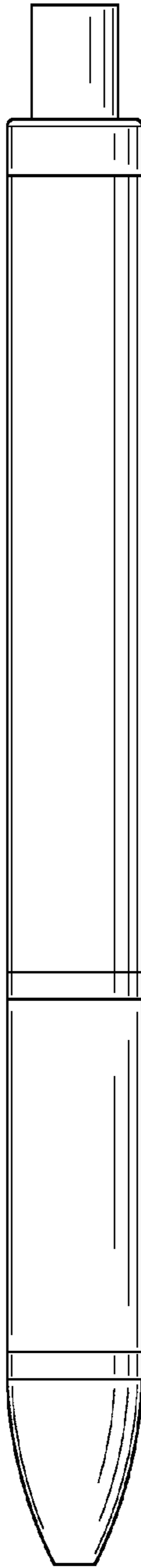

FIG. 7

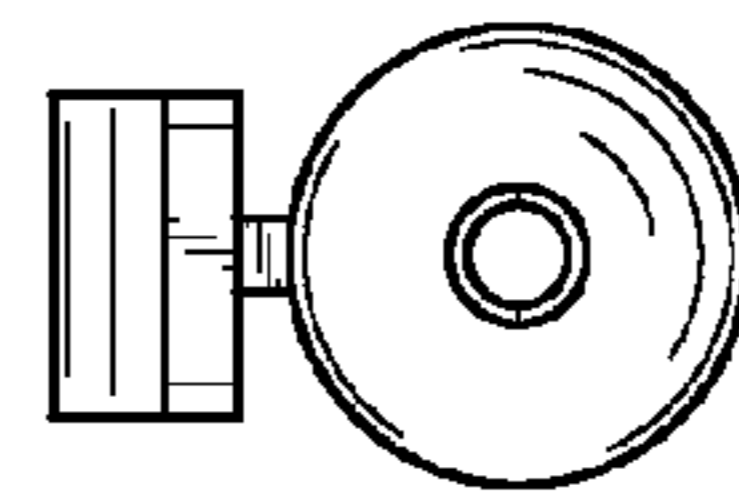

FIG. 8