



US00D568250S

(12) **United States Design Patent**
Wu et al.

(10) **Patent No.:** **US D568,250 S**

(45) **Date of Patent:** **** May 6, 2008**

(54) **TWO-IN-ONE CARD CONNECTOR**

(75) Inventors: **Yin-Lung Wu**, Tu-Cheng (TW);
Min-Chiang Chen, Tu-Cheng (TW);
Wei-hong Liao, Tu-Cheng (TW)

(73) Assignee: **Cheng Uei Precision Industry Co., Ltd.**, Taipei Hsien (TW)

(**) Term: **14 Years**

(21) Appl. No.: **29/274,051**

(22) Filed: **Mar. 26, 2007**

(51) **LOC (8) Cl.** **13-03**

(52) **U.S. Cl.** **D13/147**

(58) **Field of Classification Search** D13/133,
D13/146-147, 154, 184; D14/432-435,
D14/436, 438; 361/684-685; 439/64, 79,
439/159-160, 330-331, 341-342, 607-610,
439/629-630, 636, 660, 773, 862

See application file for complete search history.

(56) **References Cited**

U.S. PATENT DOCUMENTS

D488,444 S * 4/2004 Motojima D13/147
6,899,565 B2 * 5/2005 Kodera et al. 439/607
7,104,820 B1 * 9/2006 Lu et al. 439/159
7,118,397 B1 * 10/2006 Su et al. 439/159

D547,728 S * 7/2007 Lee et al. D13/147
D550,629 S * 9/2007 Kagami D13/147
2004/0127079 A1 * 7/2004 Nagata 439/159
2004/0161977 A1 * 8/2004 Nagata et al. 439/630
2006/0166532 A1 * 7/2006 Tsai 439/159

* cited by examiner

Primary Examiner—Daniel Bui

(74) *Attorney, Agent, or Firm*—Rosenberg, Klein & Lee

(57) **CLAIM**

The ornamental design for a two-in-one card connector, as shown and described.

DESCRIPTION

FIG. 1 is a perspective view of a two-in-one card connector showing our new design;

FIG. 2 is a front elevational view thereof;

FIG. 3 is a rear elevational view thereof;

FIG. 4 is a left side elevational view thereof;

FIG. 5 is a right side elevational view thereof;

FIG. 6 is a top plan view thereof; and,

FIG. 7 is a bottom plan view thereof.

Features shown in broken lines are included for illustrative purposes and do not form a part of the claimed design.

1 Claim, 7 Drawing Sheets

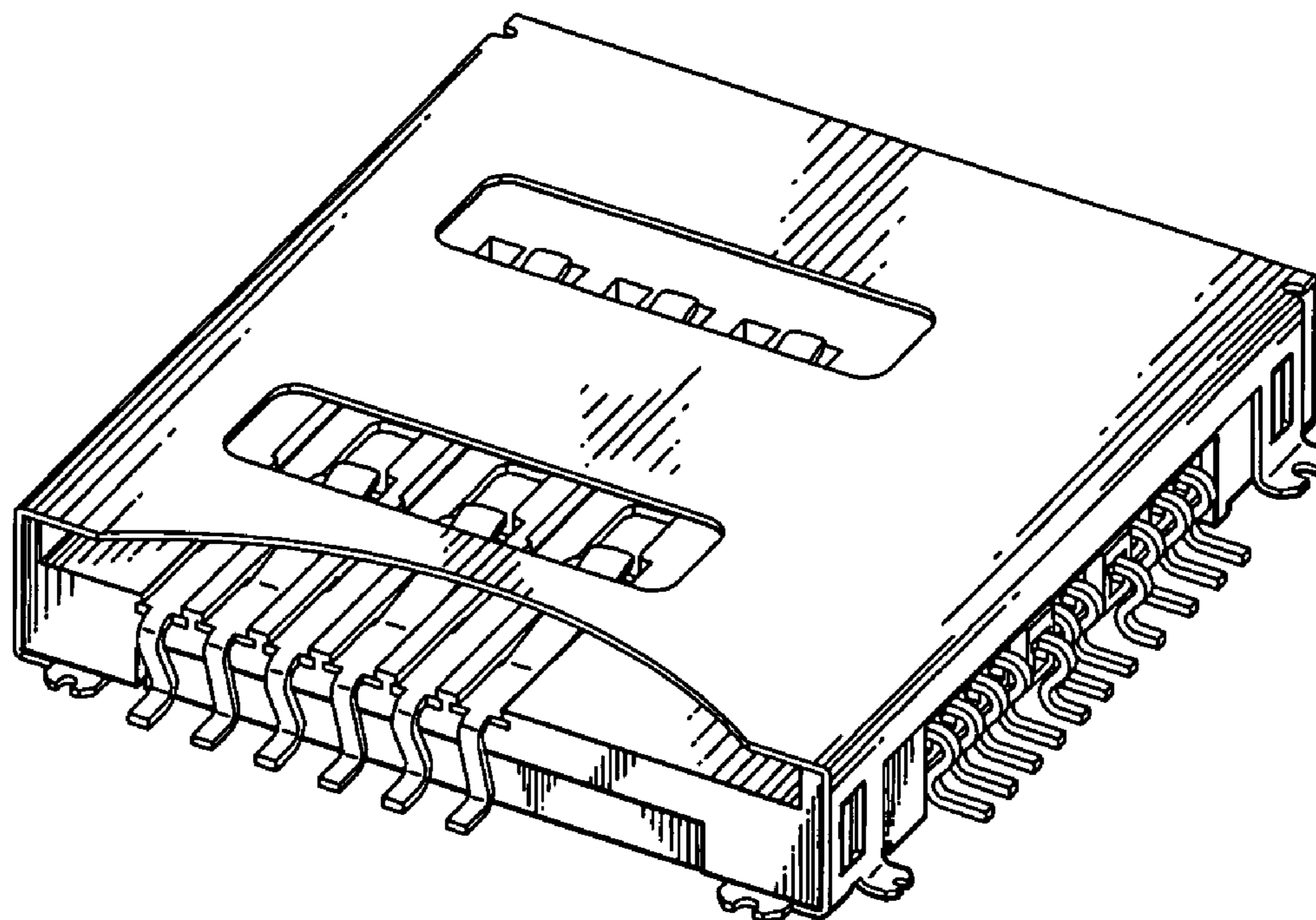

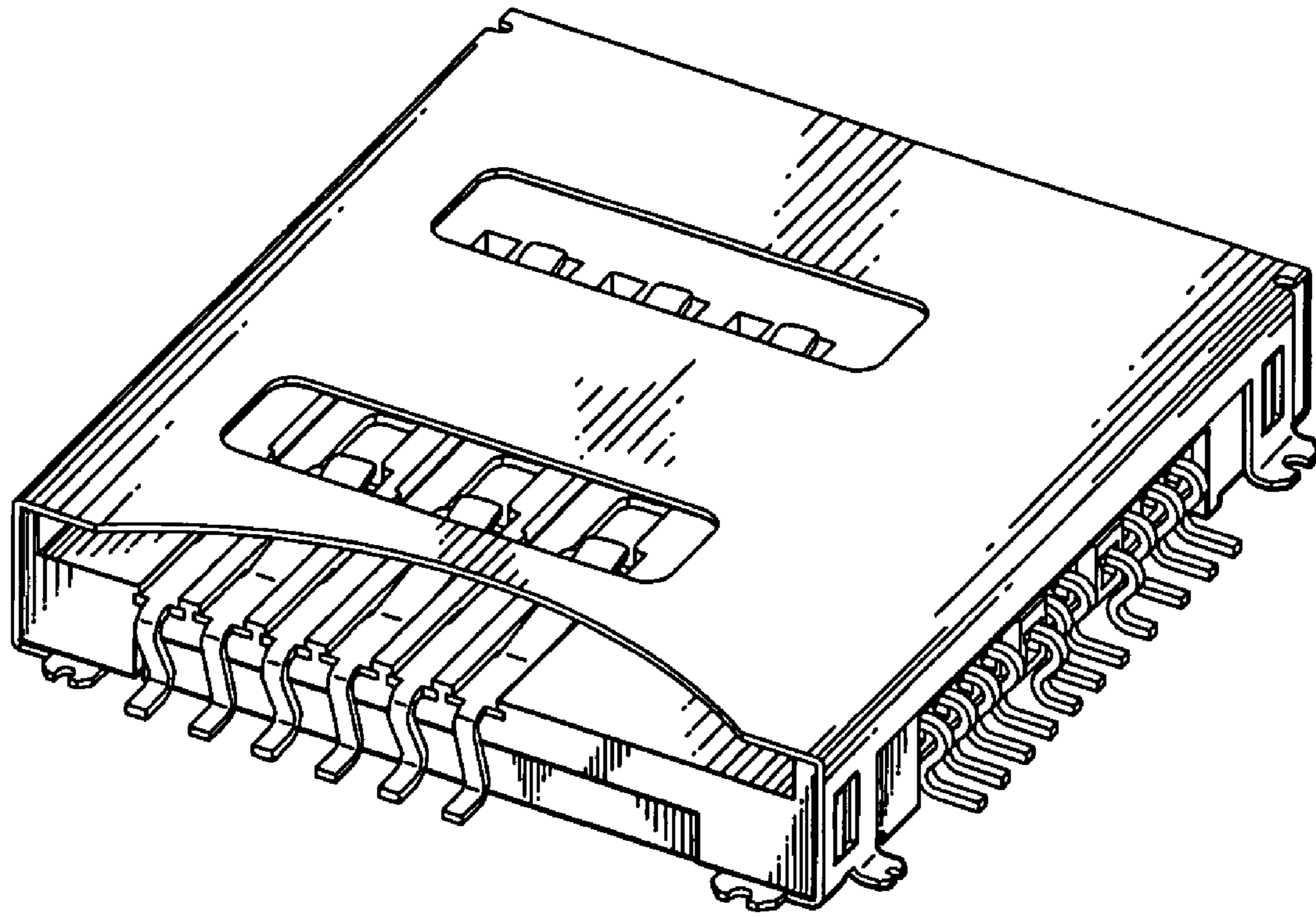

FIG. 1

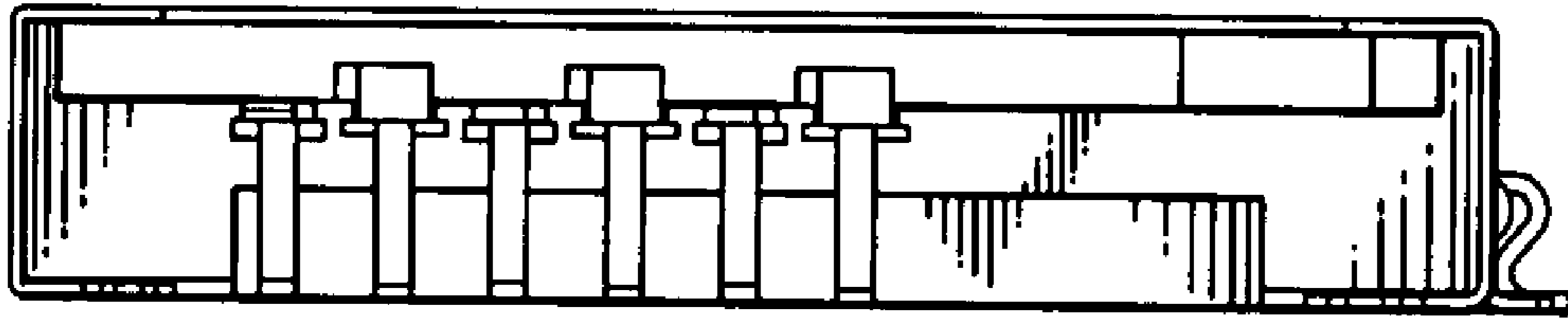

FIG. 2

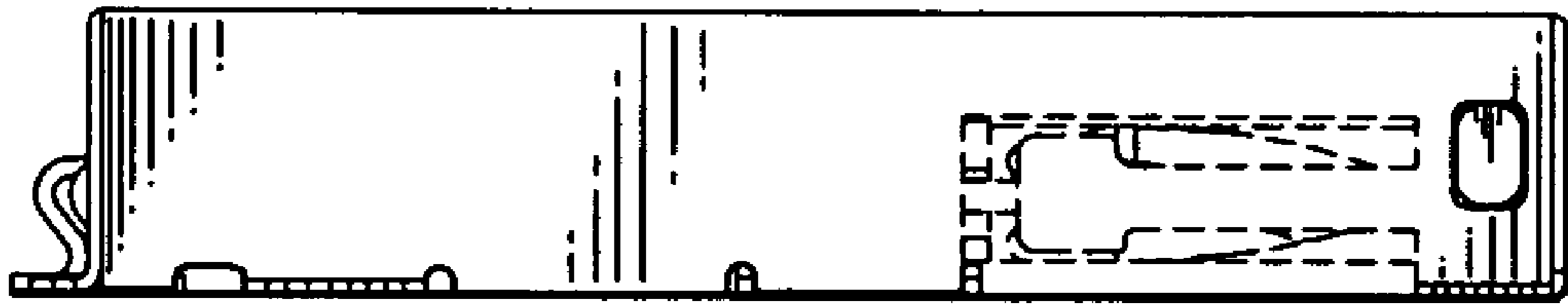

FIG. 3

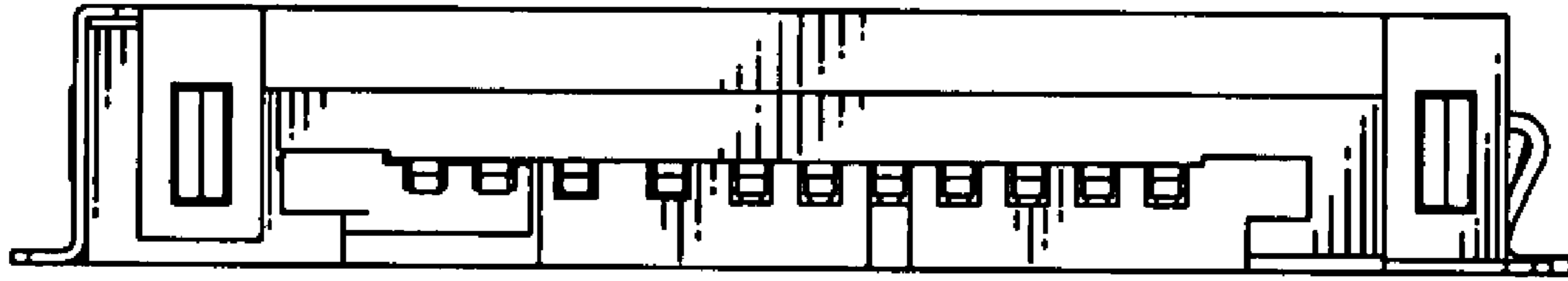

FIG. 4

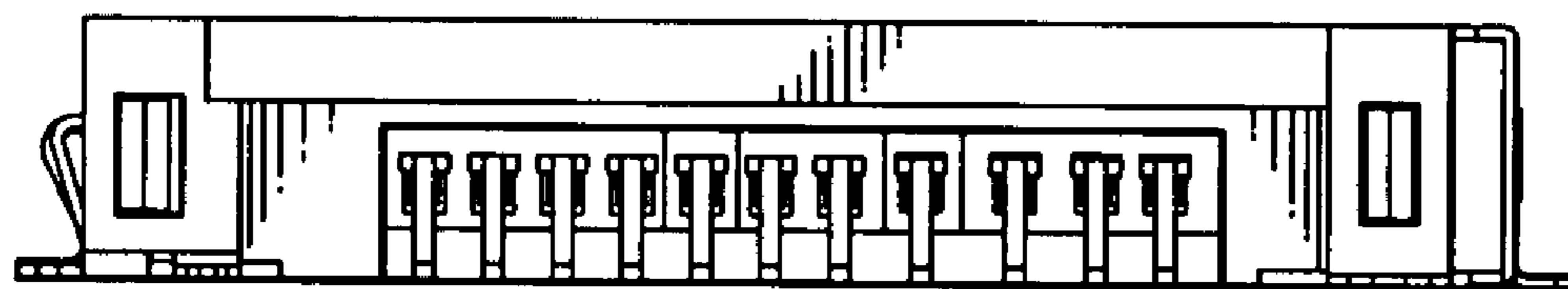

FIG. 5

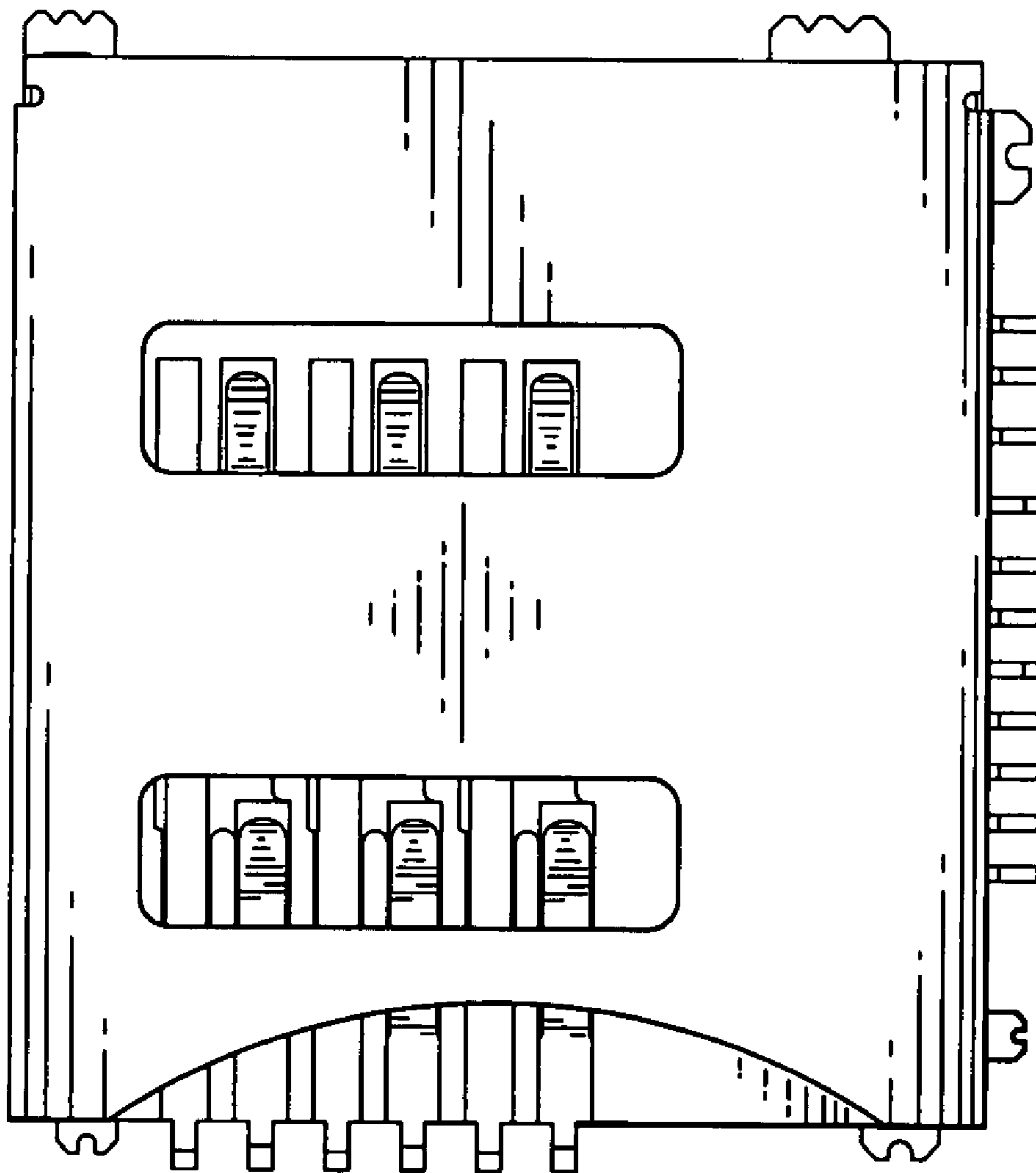

FIG. 6

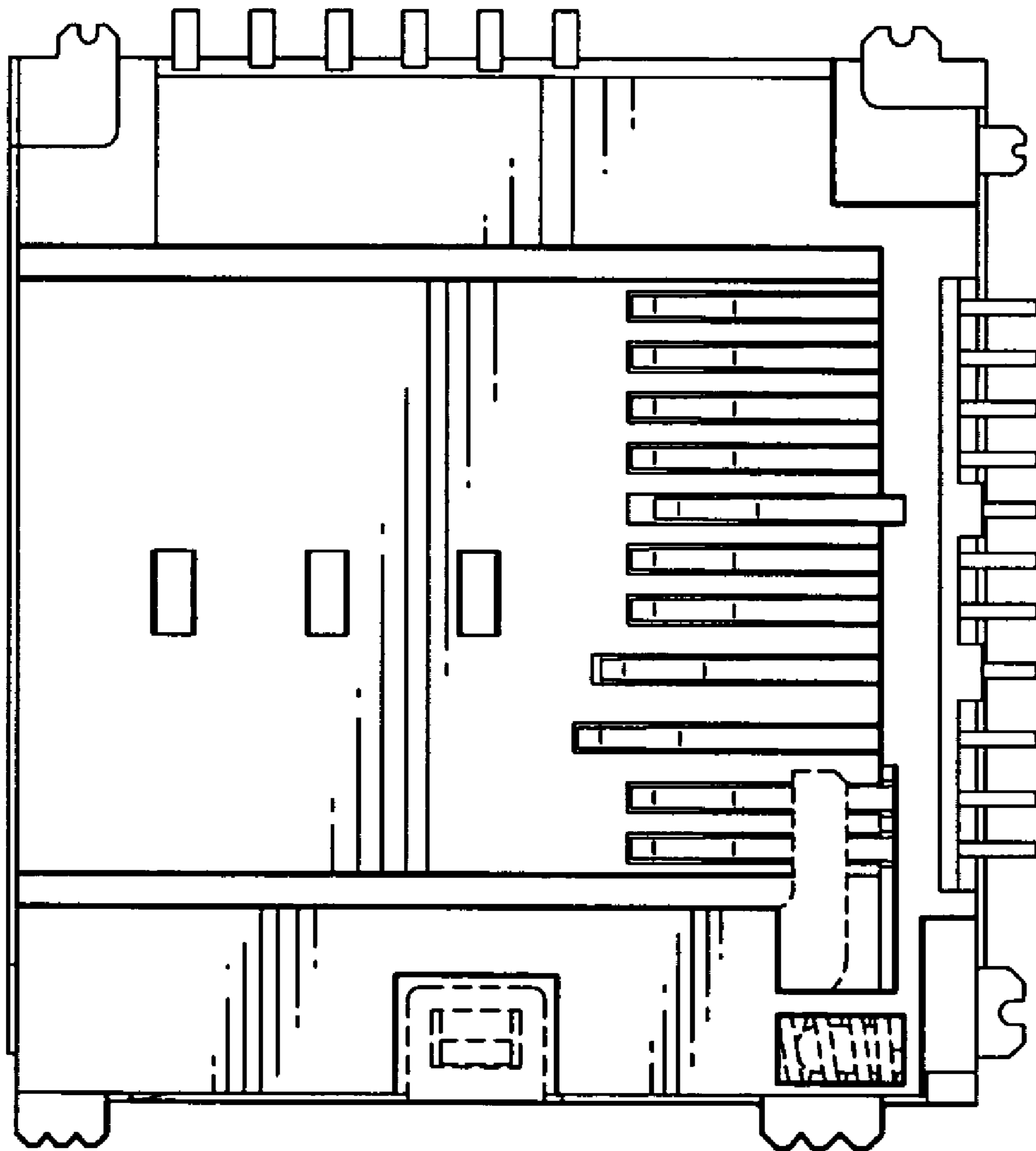

FIG. 7