



US00D565813S

(12) **United States Design Patent**  
**Shin**

(10) **Patent No.:** **US D565,813 S**

(45) **Date of Patent:** **\*\* \*Apr. 1, 2008**

(54) **VACUUM CLEANER**

(75) Inventor: **Gwan Woo Shin**, Seoul (KR)

(73) Assignee: **Samsung Electronics Co., Ltd.**, Suwon (KR)

(\*) Notice: This patent is subject to a terminal disclaimer.

(\*\*) Term: **14 Years**

(21) Appl. No.: **29/269,298**

(22) Filed: **Nov. 28, 2006**

(51) **LOC (8) Cl.** ..... **15-05**

(52) **U.S. Cl.** ..... **D32/21**

(58) **Field of Classification Search** ..... D32/21,  
D32/23-24, 31; 15/301, 320-321, 323, 327.1-327.4,  
15/327.6-327.7, 329, 347, 352-353, 412;  
55/337, 429, 345; 95/271; 210/512.1, 512.2  
See application file for complete search history.

(56) **References Cited**

**U.S. PATENT DOCUMENTS**

- D448,128 S \* 9/2001 Oh ..... D32/21
- D498,886 S \* 11/2004 Fujii ..... D32/21
- D523,195 S \* 6/2006 Choi ..... D32/21
- D530,467 S \* 10/2006 Tokunaga ..... D32/21

D533,693 S \* 12/2006 Lee ..... D32/21  
2006/0101610 A1\* 5/2006 Oh et al. .... 15/327.2

\* cited by examiner

*Primary Examiner*—Ruth McInroy

(74) *Attorney, Agent, or Firm*—Ladas and Parry LLP

(57) **CLAIM**

I claim the ornamental design for vacuum cleaner, as shown.

**DESCRIPTION**

FIG. 1 is a front/left-side/top perspective view of a vacuum cleaner showing our new design;

FIG. 2 is a front elevational view thereof;

FIG. 3 is a rear elevational view thereof;

FIG. 4 is a left-side elevational view thereof;

FIG. 5 is a right-side elevational view thereof;

FIG. 6 is a top plan view thereof;

FIG. 7 is a bottom plan view thereof; and,

FIG. 8 is a top, front and right side perspective view of the vacuum cleaner of FIG. 1 shown with the hose and the brush connected.

The broken lines in the drawings are for illustrative purposes only and form no part of the claimed design.

**1 Claim, 8 Drawing Sheets**

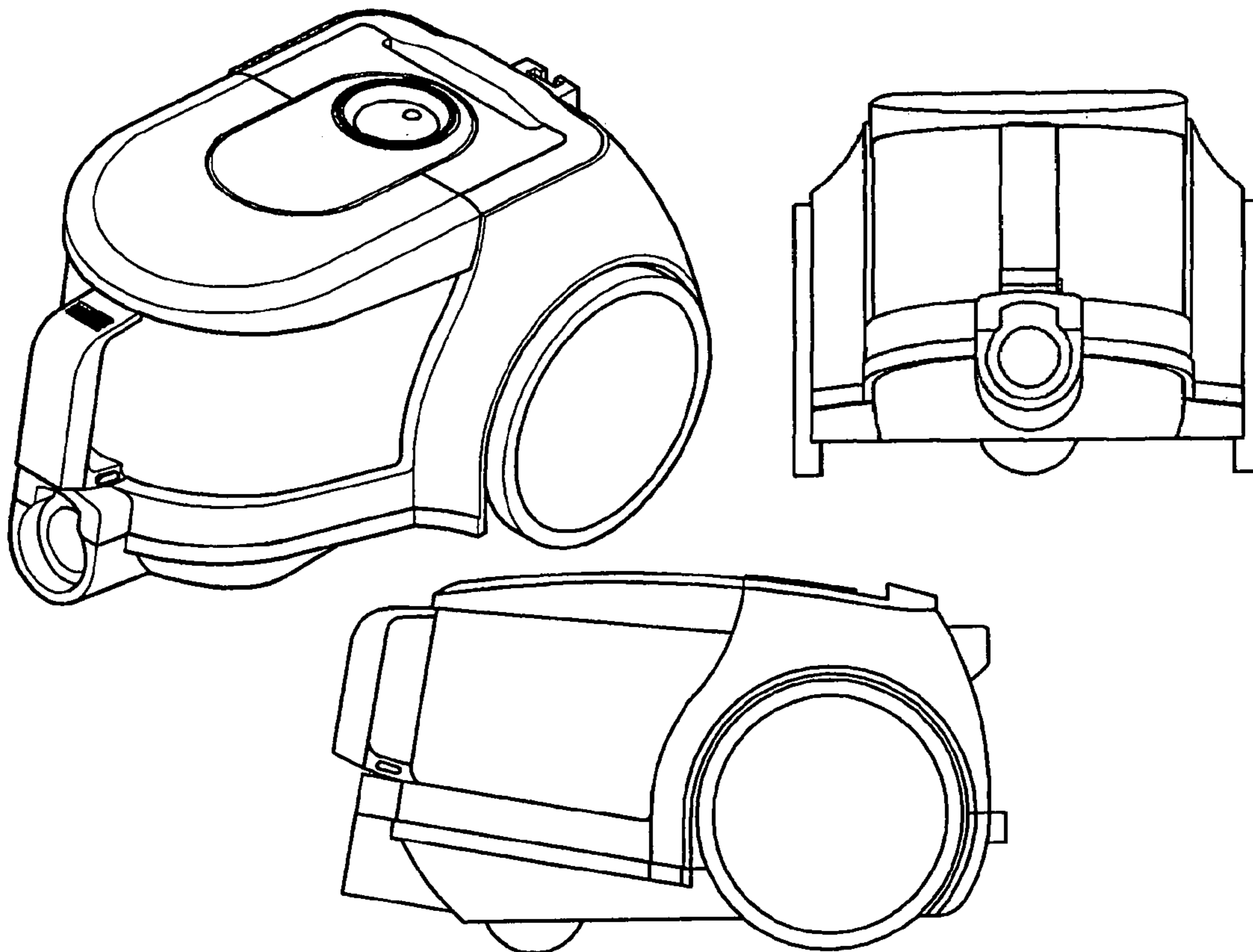

FIG. 1

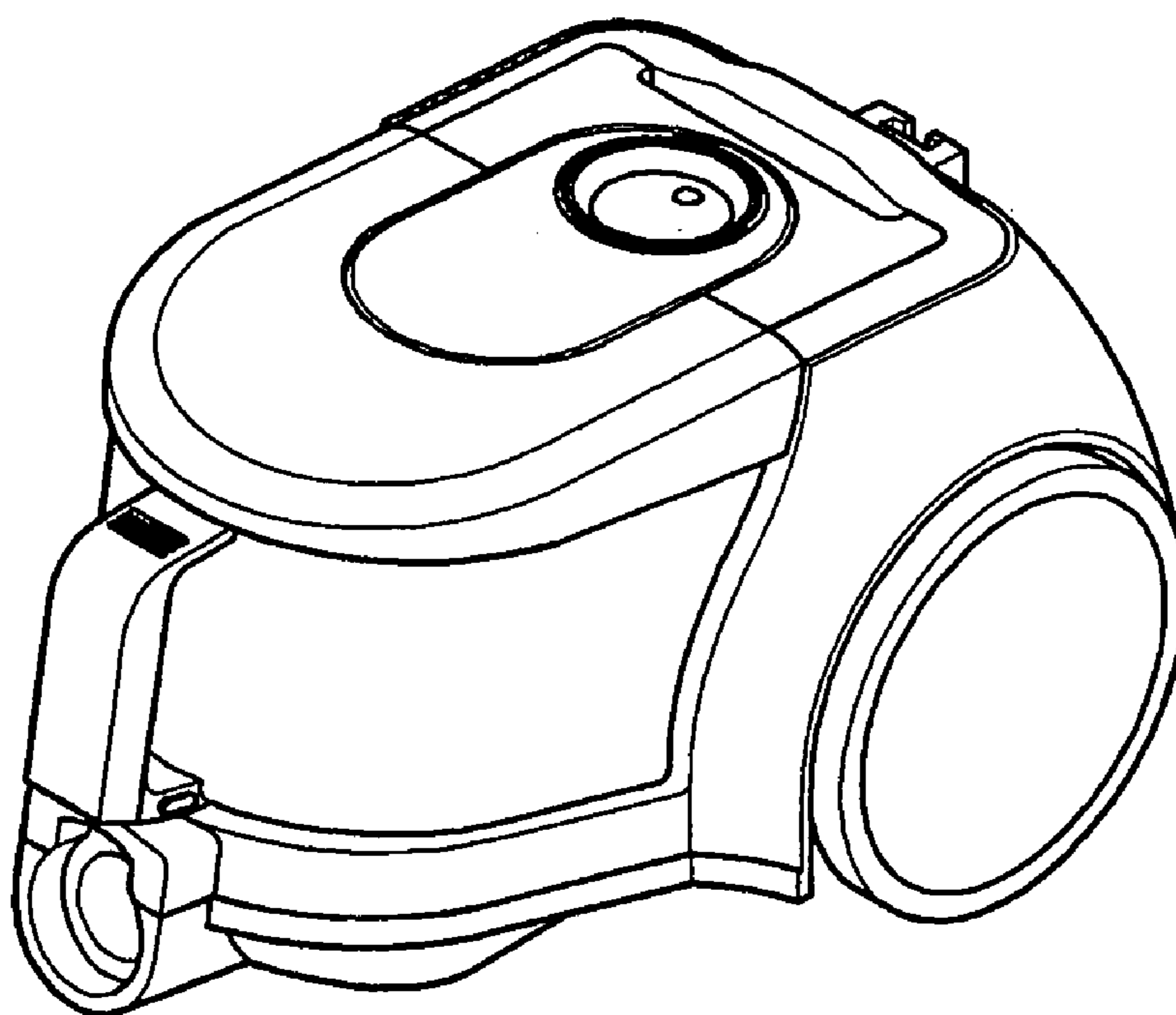

FIG. 2

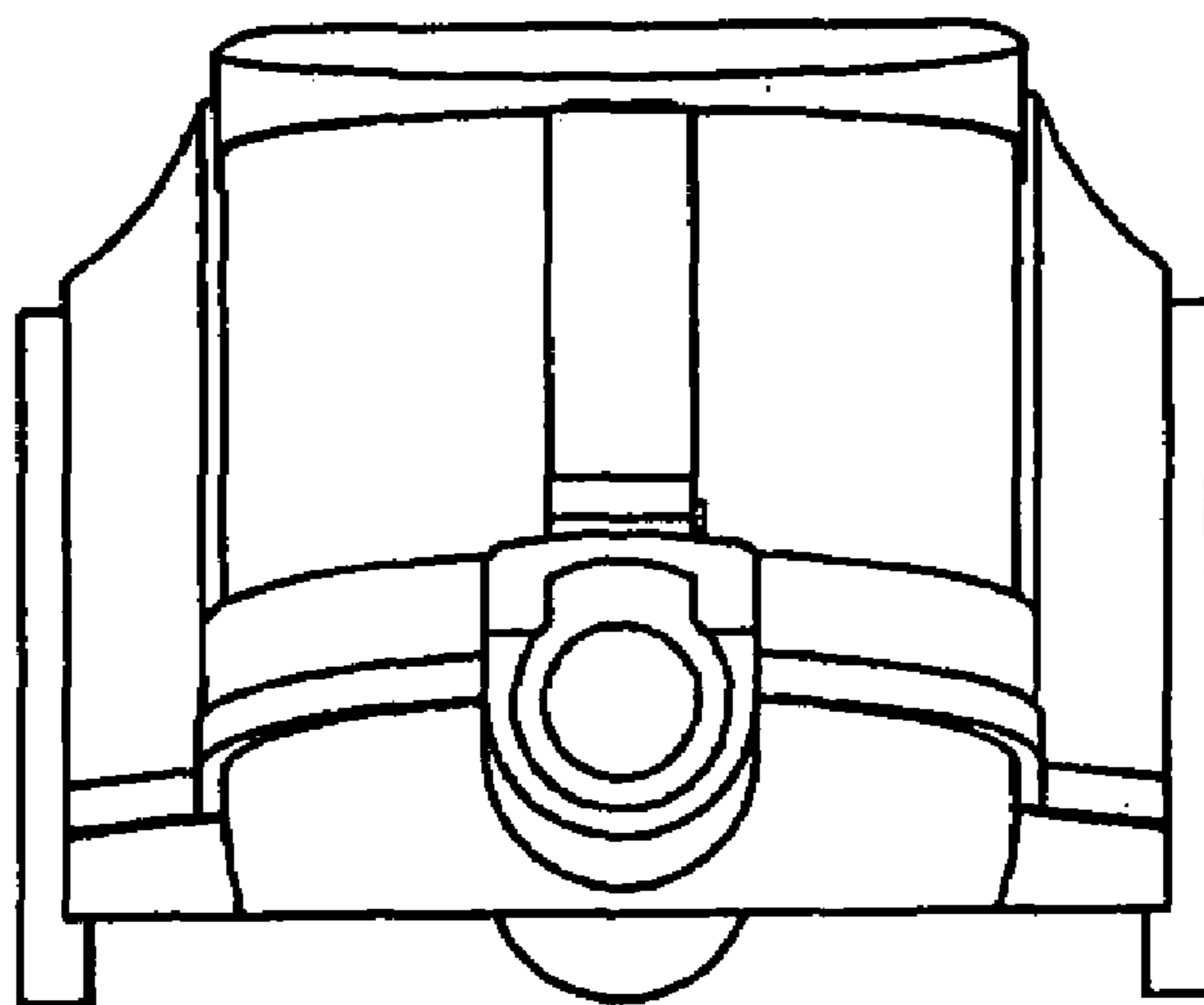
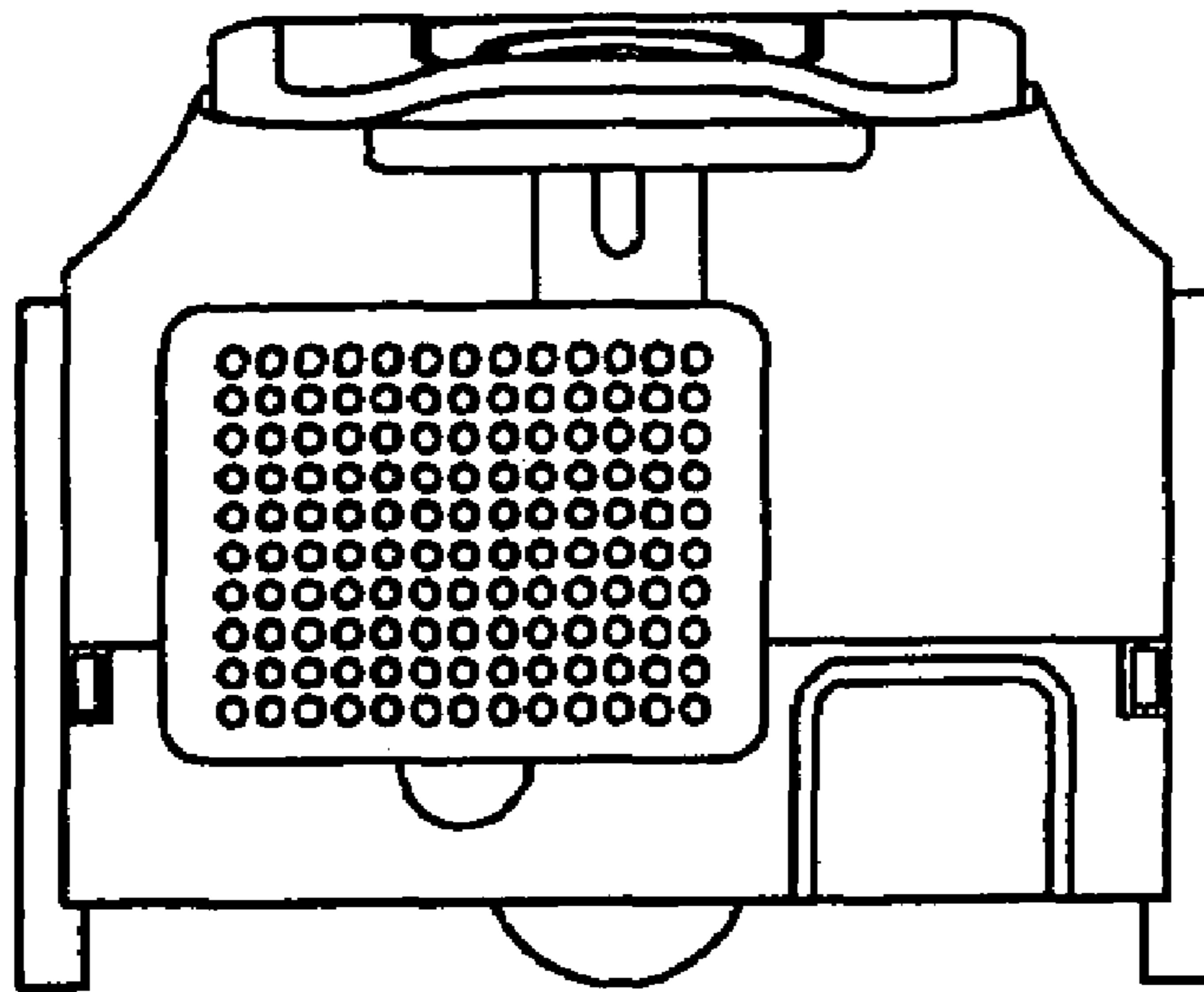

FIG. 3



**FIG. 4**

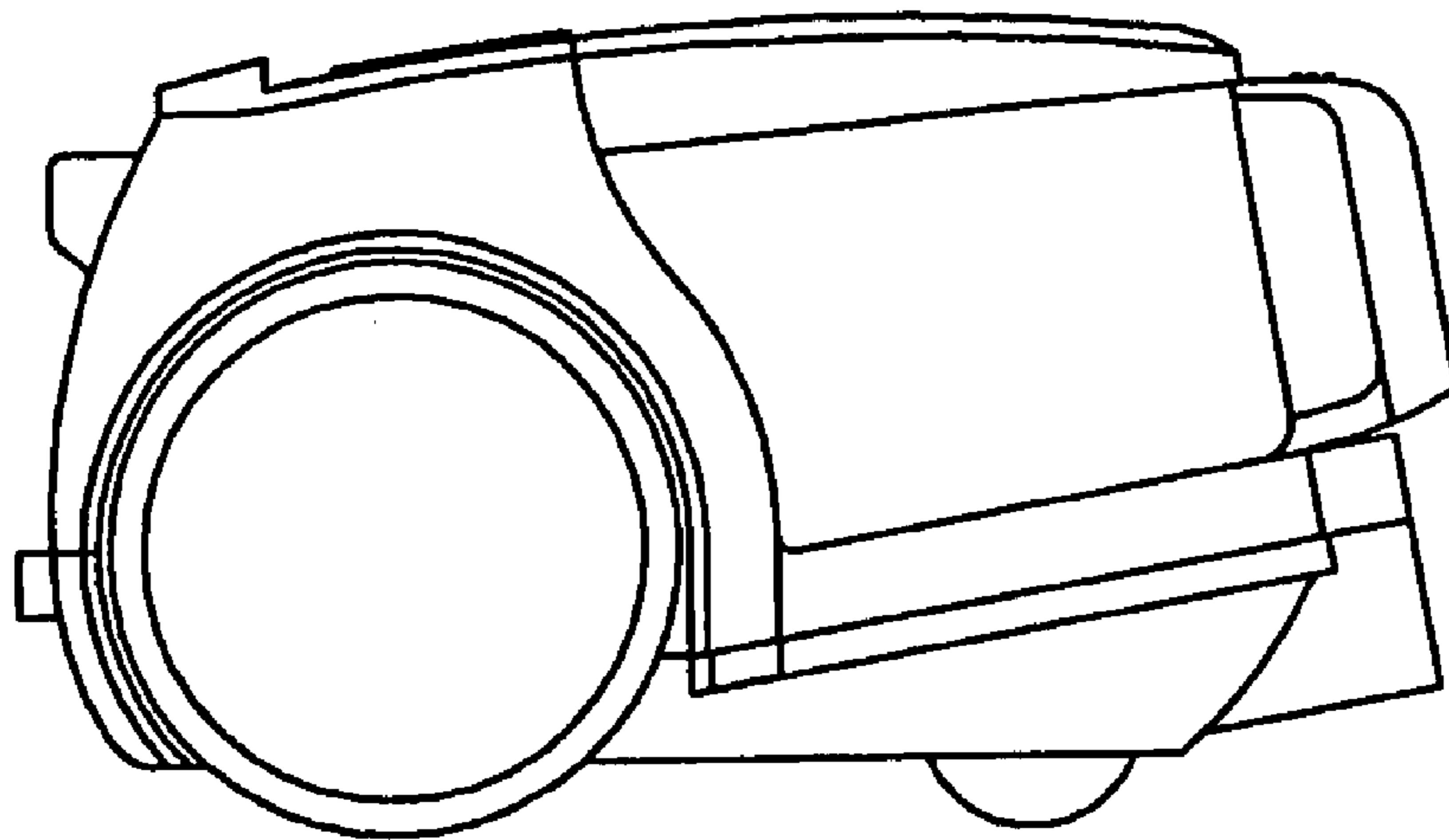

FIG. 5

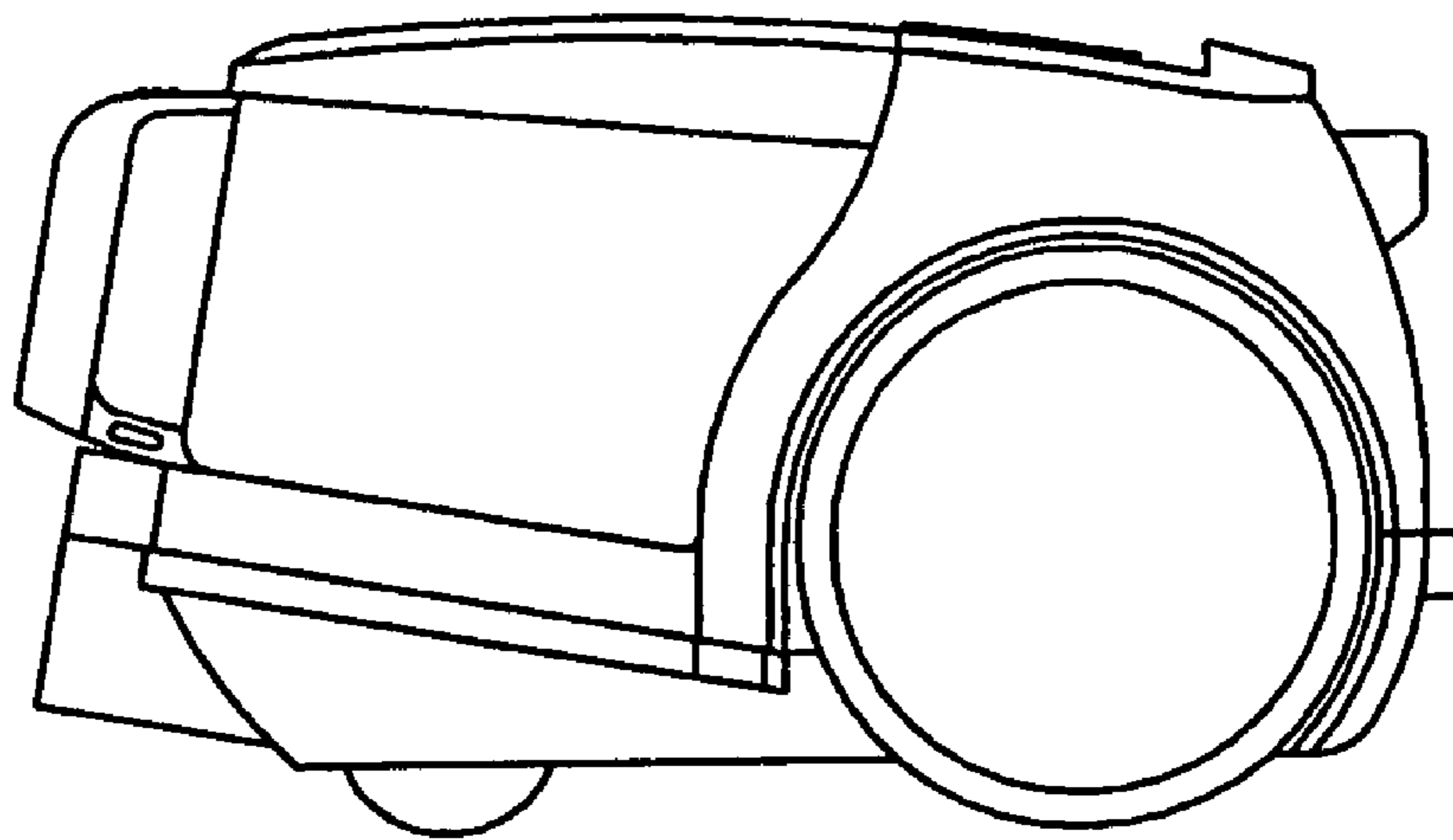
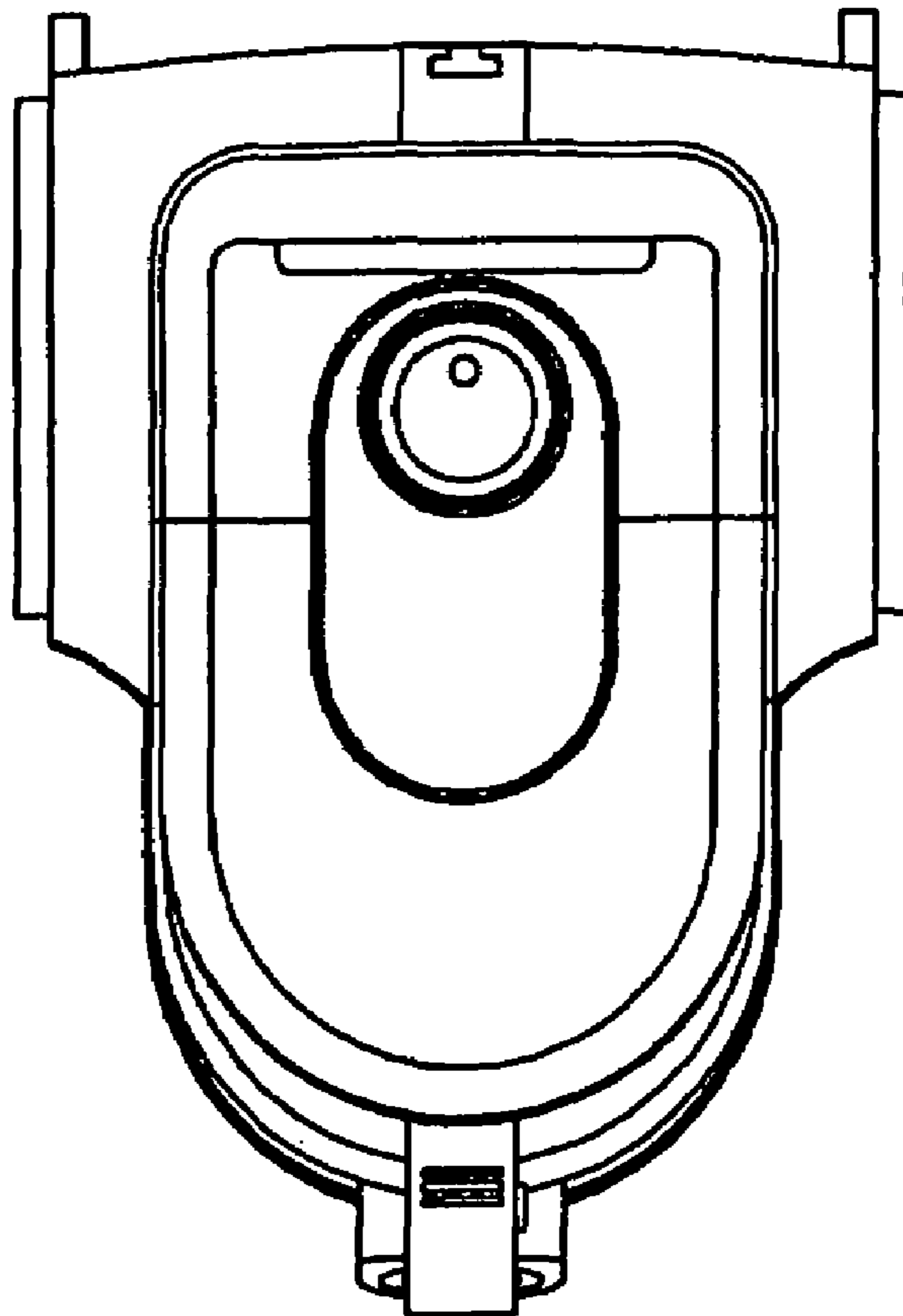
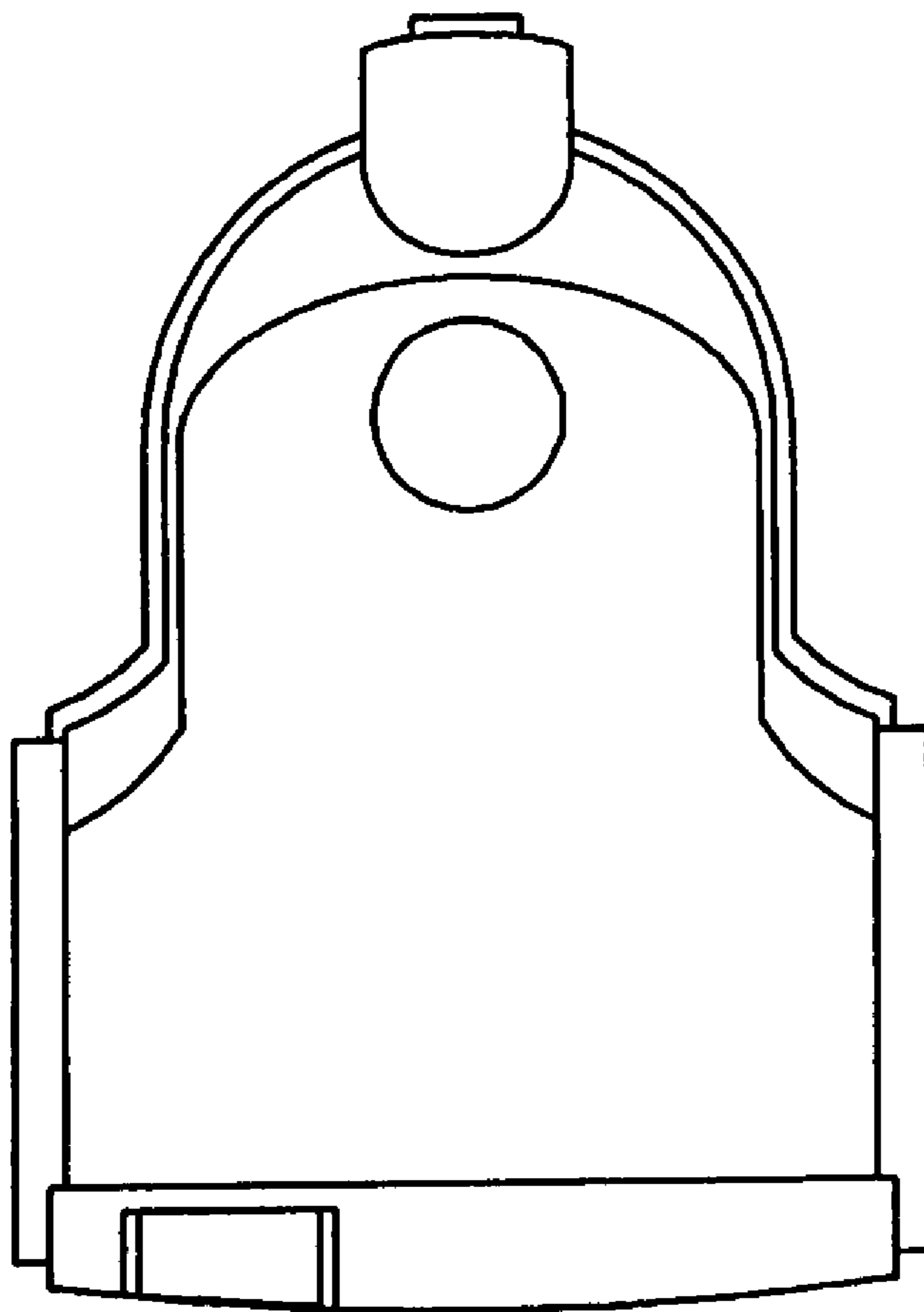

FIG. 6



**FIG. 7**





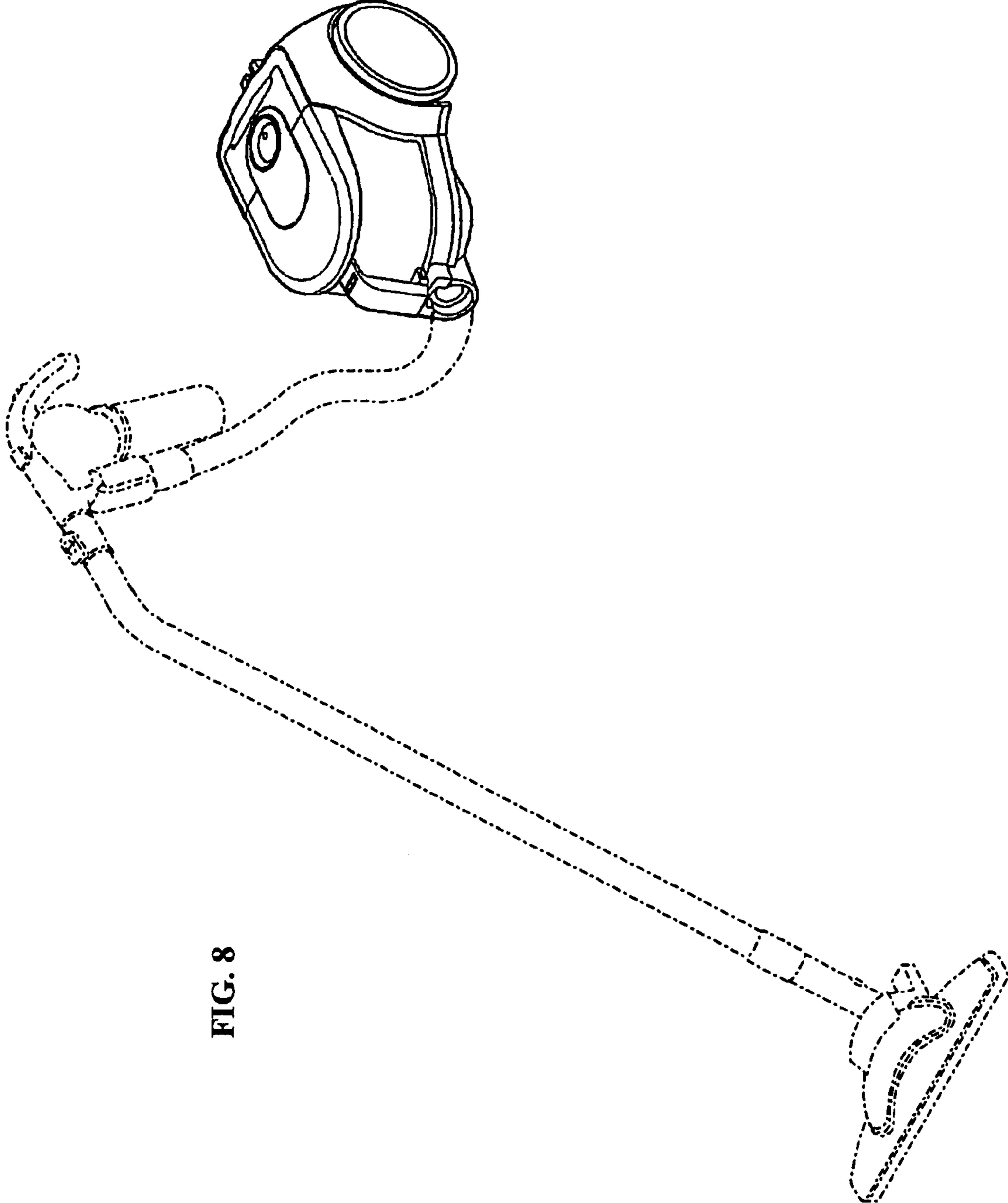

FIG. 8