



US00D565486S

(12) **United States Design Patent**
James

(10) **Patent No.:** **US D565,486 S**
(45) **Date of Patent:** **** Apr. 1, 2008**

(54) **MOTORCYCLE FOOT CONTROL**

(75) Inventor: **Jesse G. James**, Surfside, CA (US)

(73) Assignee: **West Coast Choppers, Inc.**, Long Beach, CA (US)

(**) Term: **14 Years**

(21) Appl. No.: **29/276,157**

(22) Filed: **Jan. 17, 2007**

(51) **LOC (8) Cl.** **12-11**

(52) **U.S. Cl.** **D12/179; D12/114**

(58) **Field of Classification Search** D12/110,
D12/114, 122, 125, 179, 180; 74/560, 564,
74/594.4, 594.6, 594.7, 512, 478, 473.16,
74/473.17, 478.5; 296/75; 280/288.4, 291;
180/219, 230; 188/73.1, 344; 192/3.54,
192/3.61, 48.1, 48.3, 48.7, 99 A, 99 B, 99 R,
192/99 S

See application file for complete search history.

(56) **References Cited**

U.S. PATENT DOCUMENTS

5,476,162	A *	12/1995	Reed et al.	188/344
5,661,999	A *	9/1997	Carone	74/473.16
D401,535	S *	11/1998	Joseph, Jr.	D12/114
6,339,972	B1 *	1/2002	Paris	74/564
D498,442	S *	11/2004	James	D12/114
7,028,818	B1 *	4/2006	James	188/344

OTHER PUBLICATIONS

Google™ search sheets (two pages) of a search on 'FTW' on Sep. 5, 2007.*
Google™ search sheets (two pages) of a search on 'CFL' on Sep. 14, 2007.*
GT Bear Claw BMX Pedals ebay product listing; <http://cgi.ebay.com/ws/eBayISAPI.dll?ViewItem&item=330083527373>; downloaded Feb. 7, 2007; 4 pages.

Jesse G. James, U.S. Appl. No. 29/276,160, filed Jan. 17, 2007.

Jesse G. James, U.S. Appl. No. 29/276,161, filed Jan. 18, 2007.

* cited by examiner

Primary Examiner—Cathron Brooks

Assistant Examiner—Linda Brooks

(74) *Attorney, Agent, or Firm*—Gary D. Mann; Fitch Even Tabin & Flannery

(57) **CLAIM**

The ornamental design for a motorcycle foot control, substantially as shown and described.

DESCRIPTION

This application is related to U.S. application Ser. No. 29/276,160 filed Jan. 17, 2007, entitled "Foot Peg For A Motorcycle Foot Control", and is further related to U.S. application Ser. No. 29/276,161, filed Jan. 18, 2007, entitled "Foot Peg For A Motorcycle Foot Control", both of which such applications are incorporated herein by reference.

FIG. 1 is a top perspective view of the motorcycle foot control showing my new design;

FIG. 2 is a left side elevational view of the foot control of FIG. 1;

FIG. 3 is a right side elevational view of the foot control of FIG. 1;

FIG. 4 is a rear elevational view of the foot control of FIG. 1;

FIG. 5 is front elevational view of the foot control of FIG. 1;

FIG. 6 is a top plan view of the foot control of FIG. 1; and,

FIG. 7 is a bottom plan view of the foot control of FIG. 1.

1 Claim, 4 Drawing Sheets

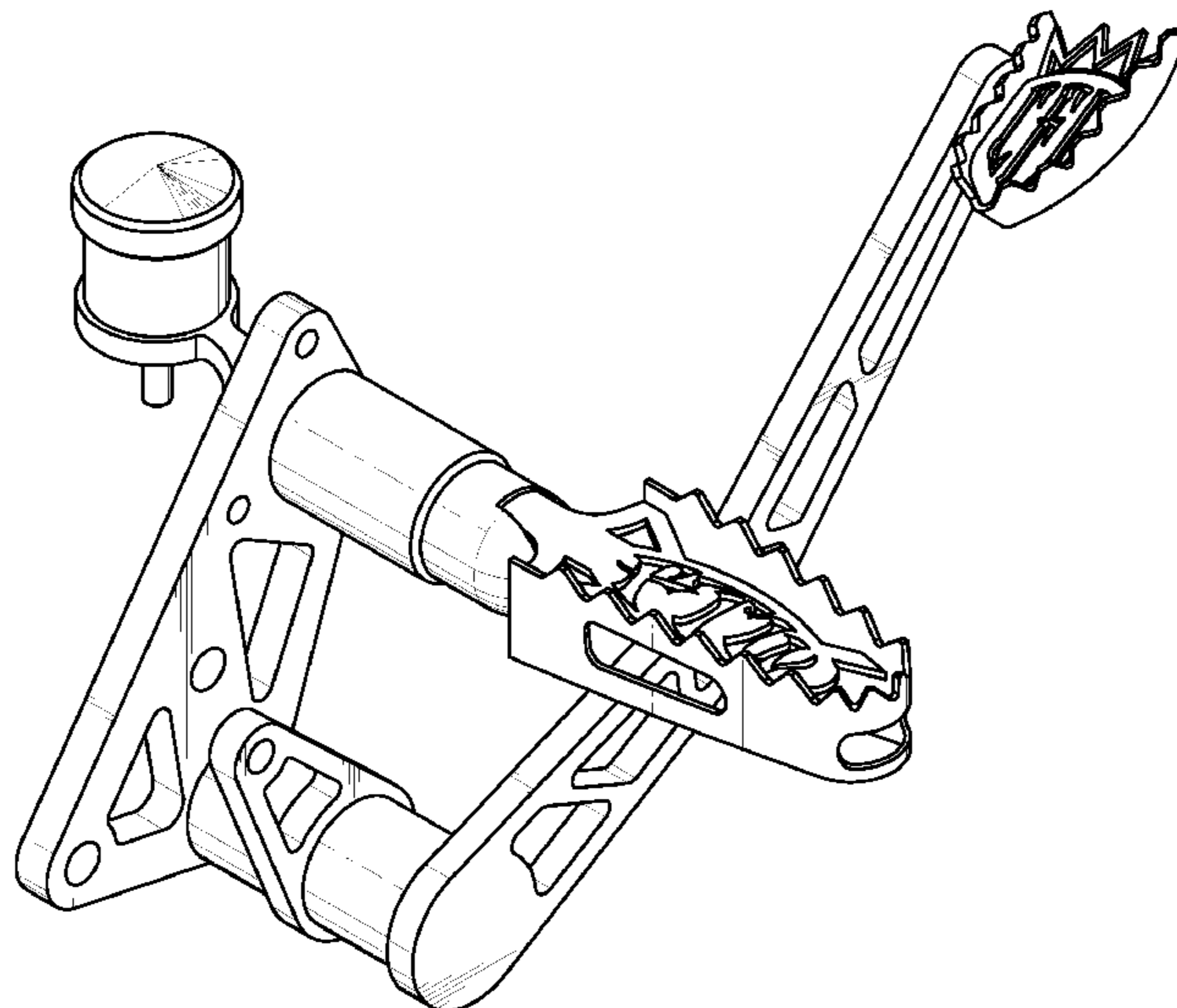

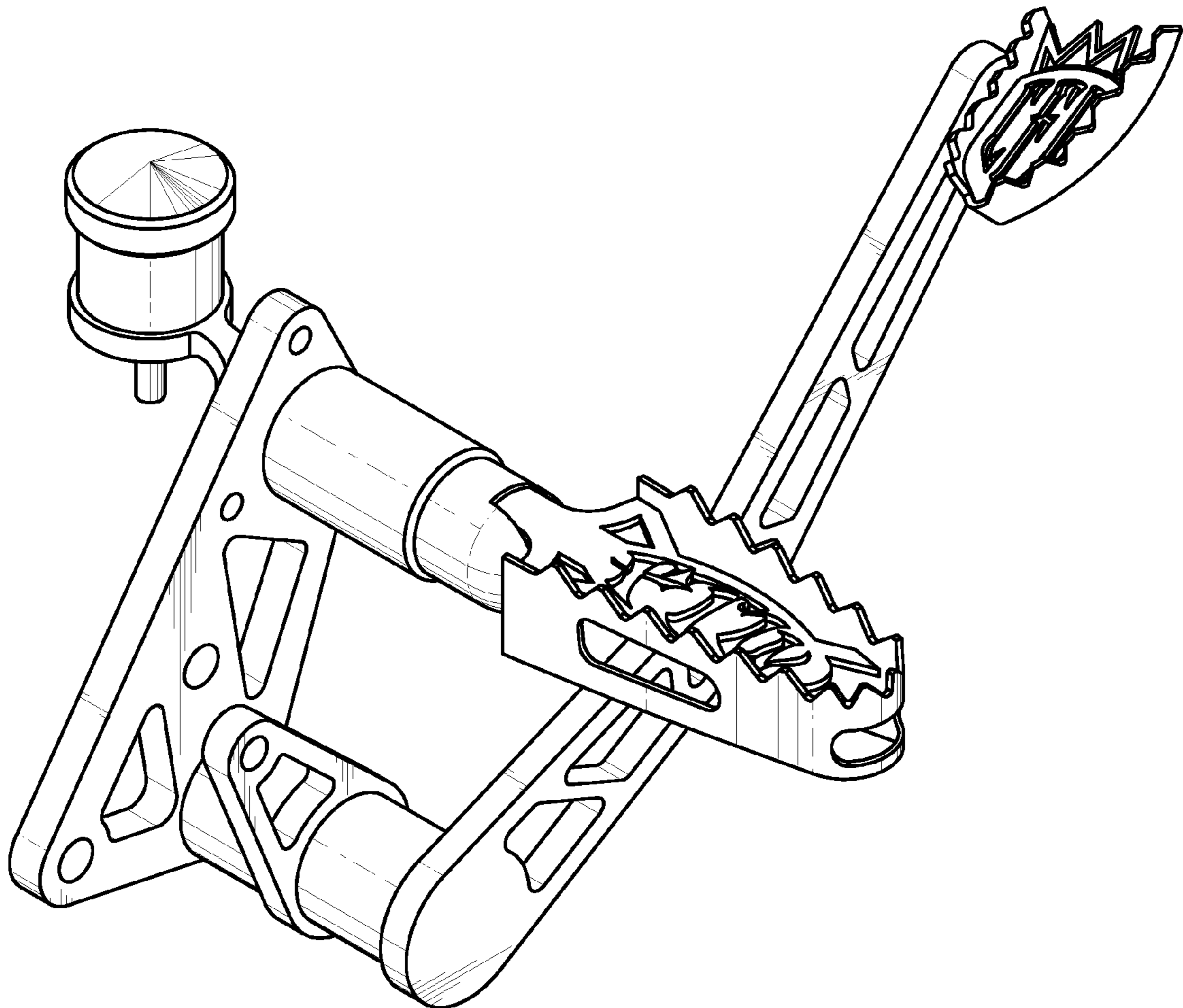
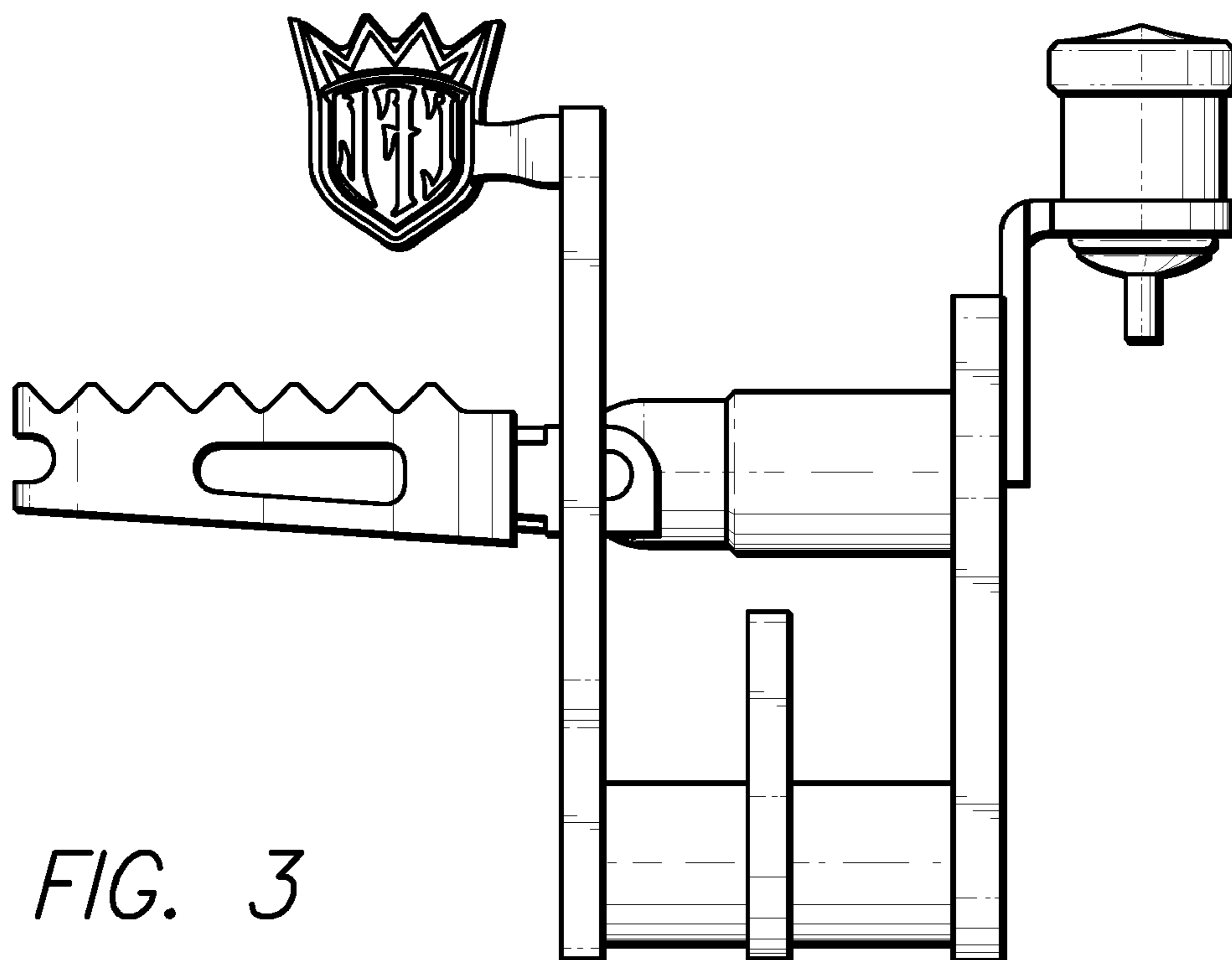
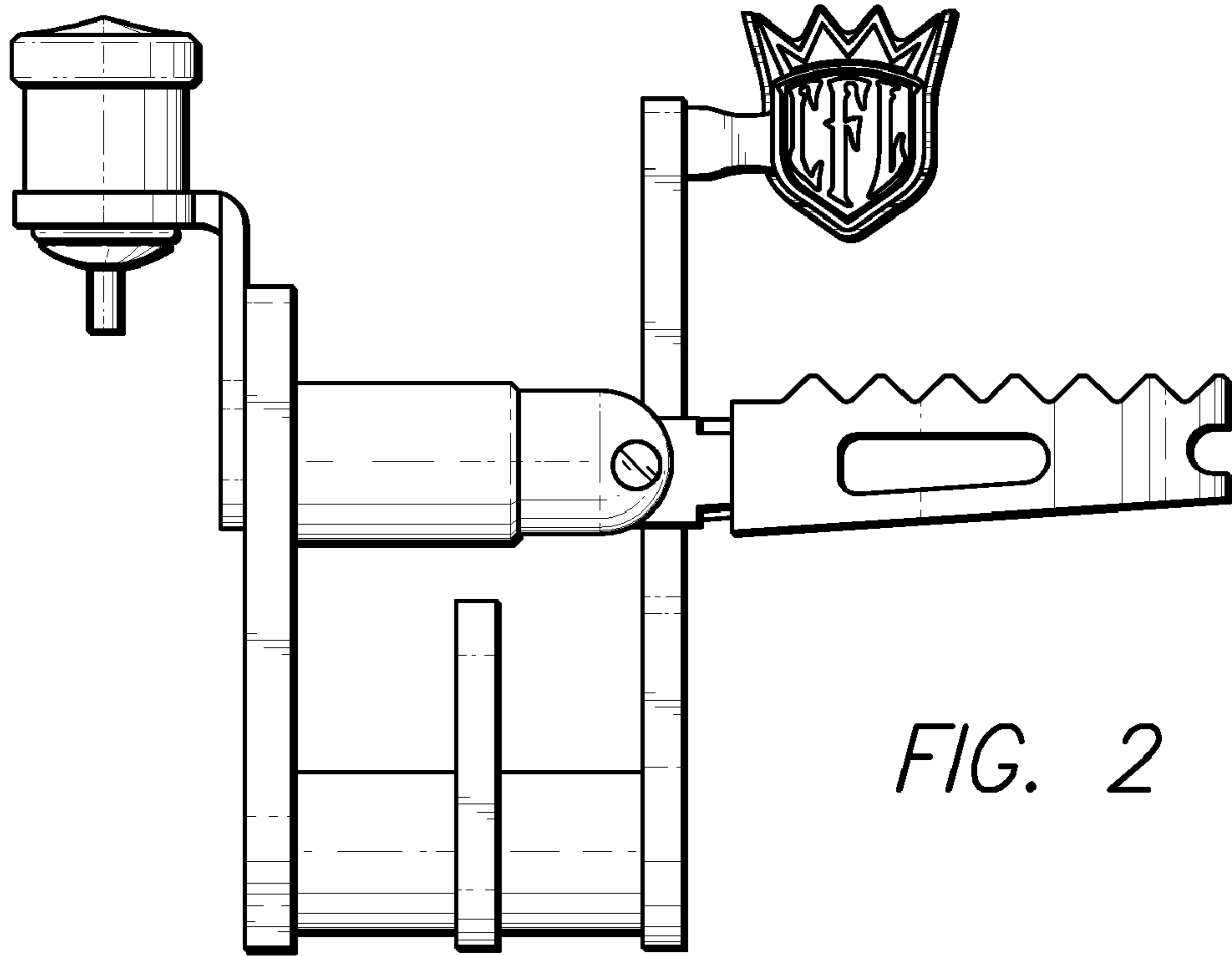
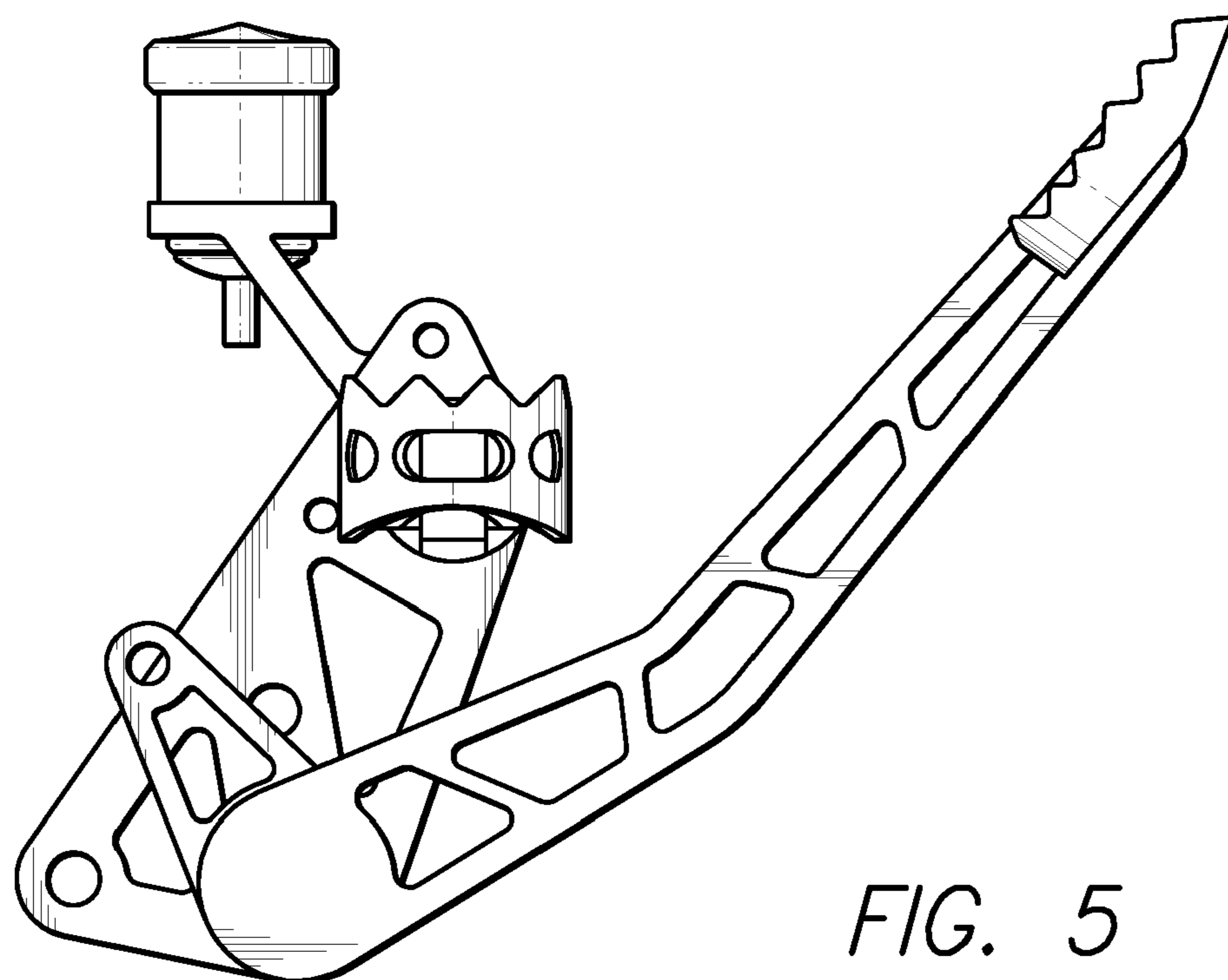
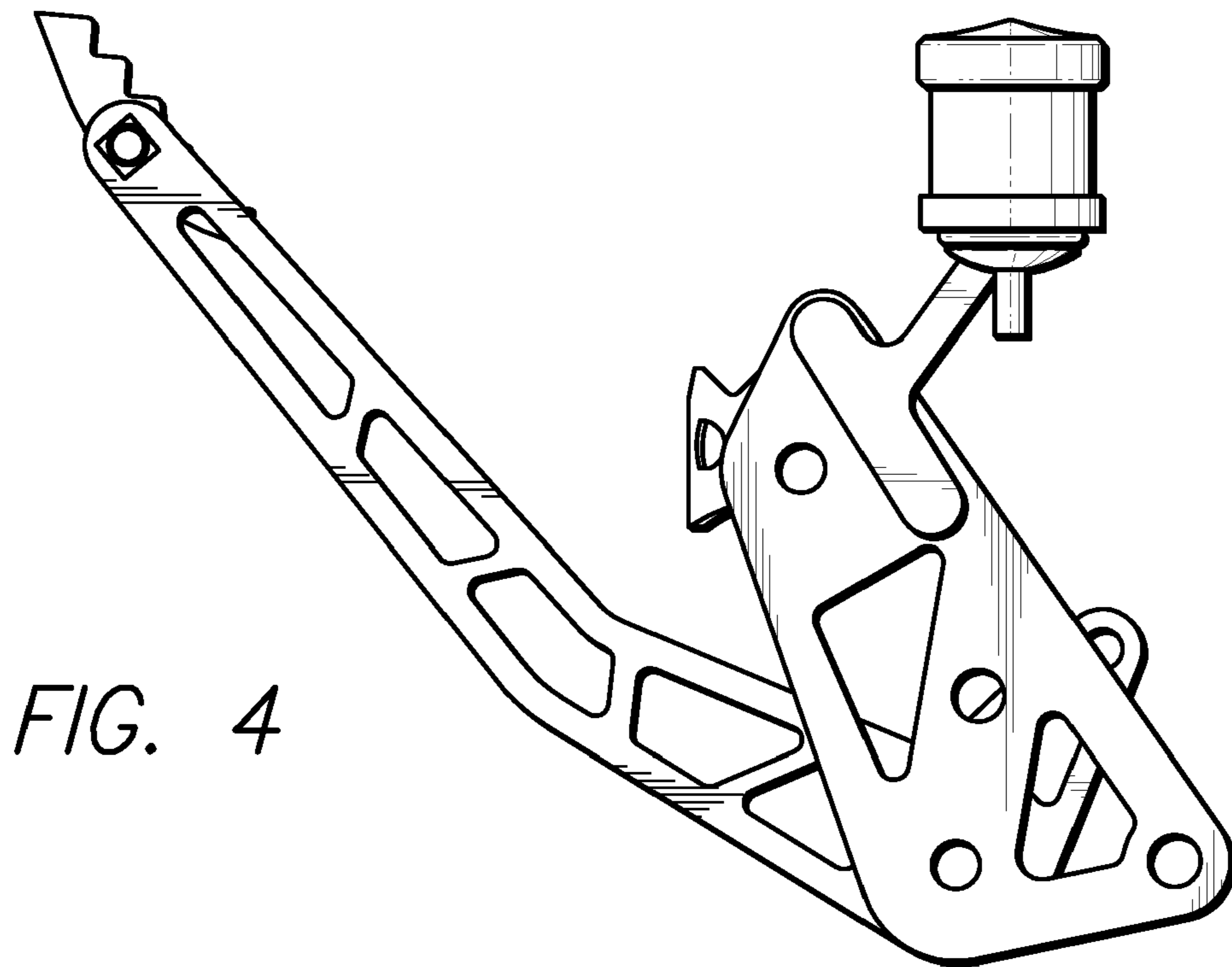

FIG. 1





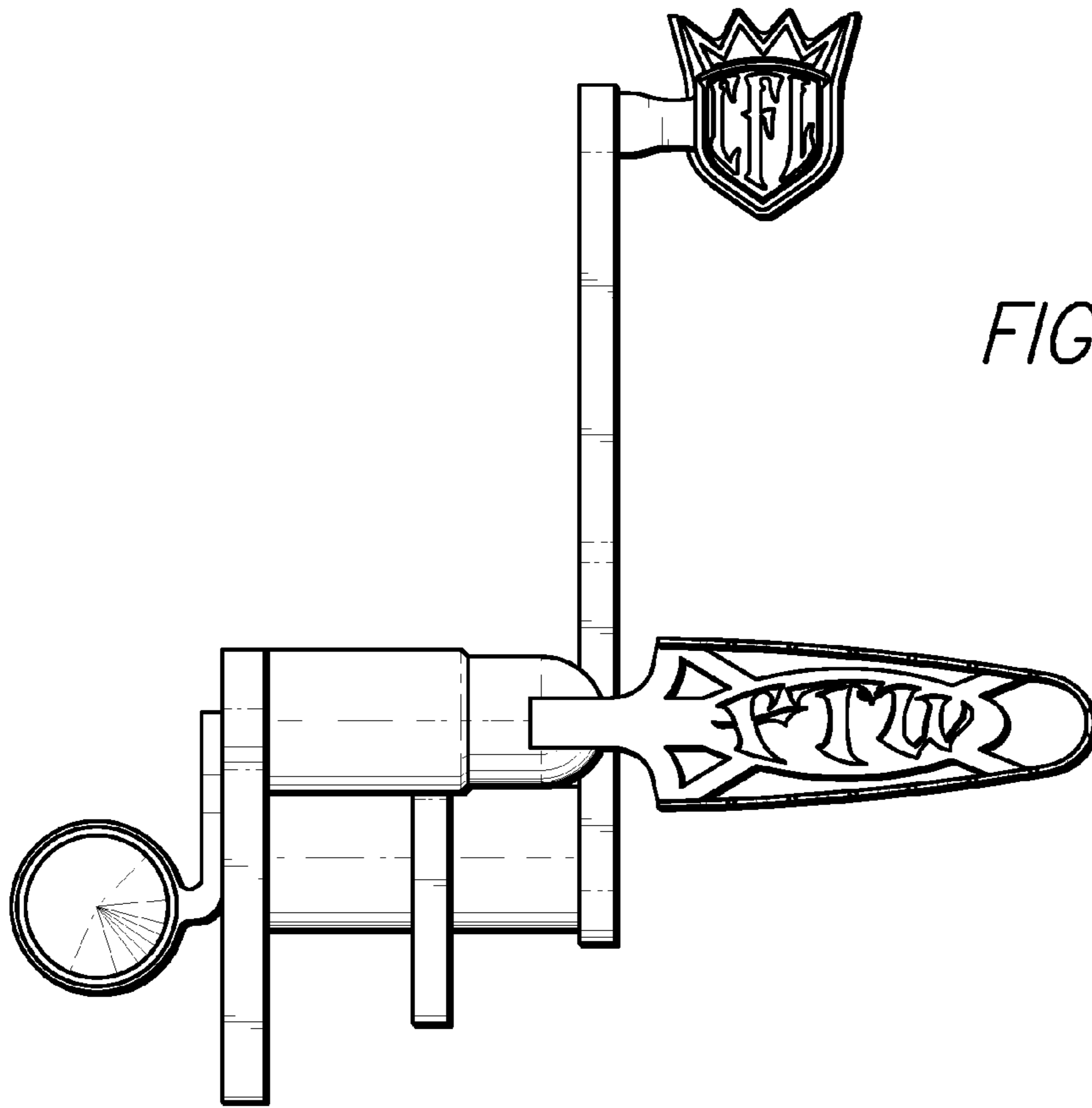

FIG. 6

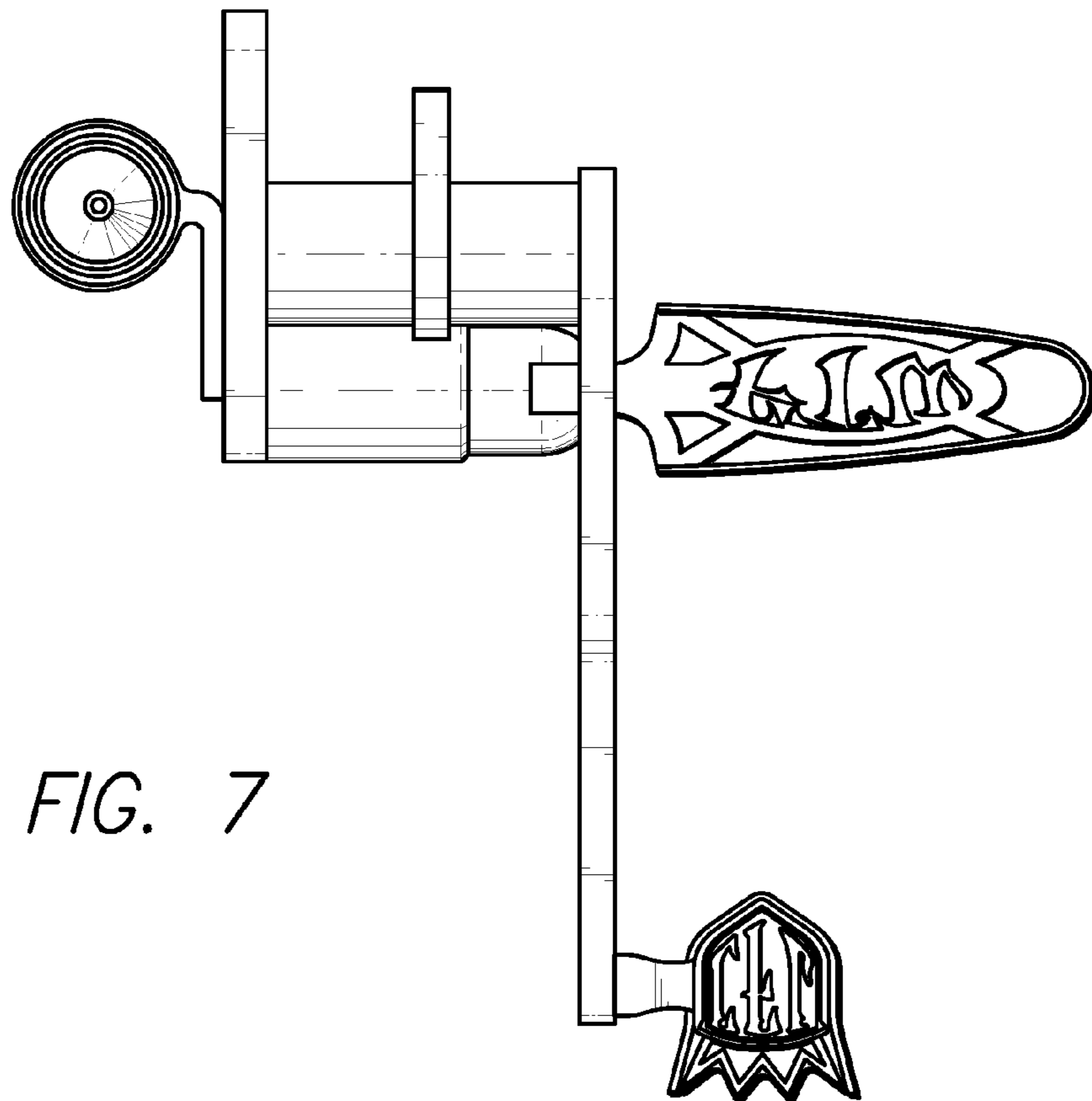

FIG. 7