



US00D564781S

(12) **United States Design Patent**  
**Fessak**

(10) **Patent No.:** **US D564,781 S**  
(45) **Date of Patent:** **\*\* Mar. 25, 2008**

(54) **PLANT SUPPORT**

(76) Inventor: **Michael Fessak**, 5 Sylvan Dr.,  
Pinebrook, NJ (US) 07058

(\*\*) Term: **14 Years**

(21) Appl. No.: **29/295,824**

(22) Filed: **Oct. 8, 2007**

**Related U.S. Application Data**

(62) Division of application No. 29/230,280, filed on May  
19, 2005, now Pat. No. Des. 552,945.

(51) **LOC (8) Cl.** ..... **06-03**

(52) **U.S. Cl.** ..... **D6/405; D8/1**

(58) **Field of Classification Search** ..... D25/38,  
D25/45, 49, 53, 100; D8/1; D6/332, 565,  
D6/405; 312/117; 47/42-47  
See application file for complete search history.

(56) **References Cited**

**U.S. PATENT DOCUMENTS**

159,300	A *	2/1875	Buell	47/47
799,510	A *	9/1905	Williams	52/664
1,018,157	A *	2/1912	Black	47/45
1,085,314	A *	1/1914	Williams	47/44
1,499,933	A *	7/1924	Jones	256/48
2,030,249	A *	2/1936	Goldberg	47/44
2,119,237	A *	5/1938	Mendel	248/27.8
3,113,400	A *	12/1963	Emond	47/45
D209,419	S *	11/1967	Riegelman et al.	D25/53
3,657,841	A *	4/1972	Jordan	47/44
4,026,068	A *	5/1977	Tepper	47/45
4,073,091	A *	2/1978	Vogel	47/45
D247,532	S *	3/1978	Tenney	D6/465
4,269,382	A *	5/1981	Coulson	248/472
4,285,163	A *	8/1981	Booker, Jr.	47/45
4,553,740	A *	11/1985	Bailey	256/33
5,048,231	A *	9/1991	Brown	47/45
D327,173	S *	6/1992	De Leu	D6/317
D343,101	S *	1/1994	Rappleyea et al.	D8/1
5,323,559	A *	6/1994	Allman	47/45
D390,759	S *	2/1998	Grady	D8/1
D396,372	S *	7/1998	Goodman	D6/566
D406,355	S *	3/1999	Kinsey	D25/49
D406,468	S *	3/1999	Byers	D6/312

D413,233	S *	8/1999	Allison	D8/1
D419,405	S *	1/2000	Wagoner	D8/1
6,490,825	B1 *	12/2002	Dillon et al.	47/47
7,017,299	B1 *	3/2006	Speed et al.	47/44
D526,509	S *	8/2006	Glamos	D6/403

\* cited by examiner

*Primary Examiner*—Holly H. Baynham

*Assistant Examiner*—Sheryl Friedman

(74) *Attorney, Agent, or Firm*—Andrew Fessak

(57) **CLAIM**

The ornamental design for a plant support, as shown and described.

**DESCRIPTION**

The present design relates to a plant support for supporting plants, such as vegetables, flowers, shrubs, and ornamentals, which are growing in an outdoor or indoor garden or container. The plant support may also be used to support artificial plants placed in a potting medium or as a decorative garden trellis. One embodiment of the present design is collapsible for ease of storage.

FIG. 1 is a front perspective view of a plant support according to a first embodiment of the present invention;

FIG. 2 is a rear perspective view of the plant support shown in FIG. 1;

FIG. 3 is a right side plan view of the plant support shown in FIG. 1;

FIG. 4 is a left side plan view of the plant support shown in FIG. 1;

FIG. 5 is a top view of the plant support shown in FIG. 1;

FIG. 6 is a front perspective view of a plant support according to a second embodiment of the present invention;

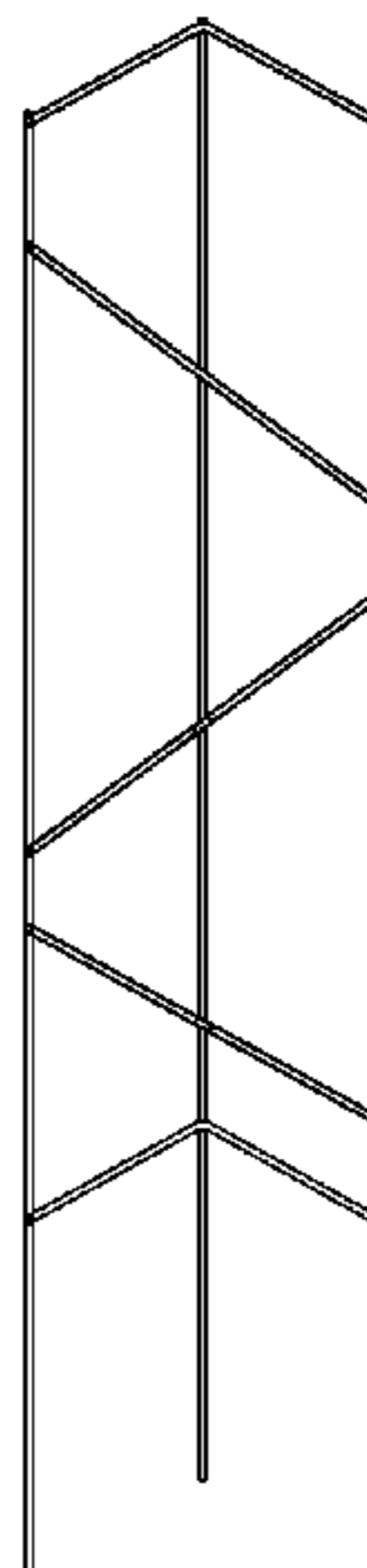
FIG. 7 is a back perspective view of the plant support shown in FIG. 6;

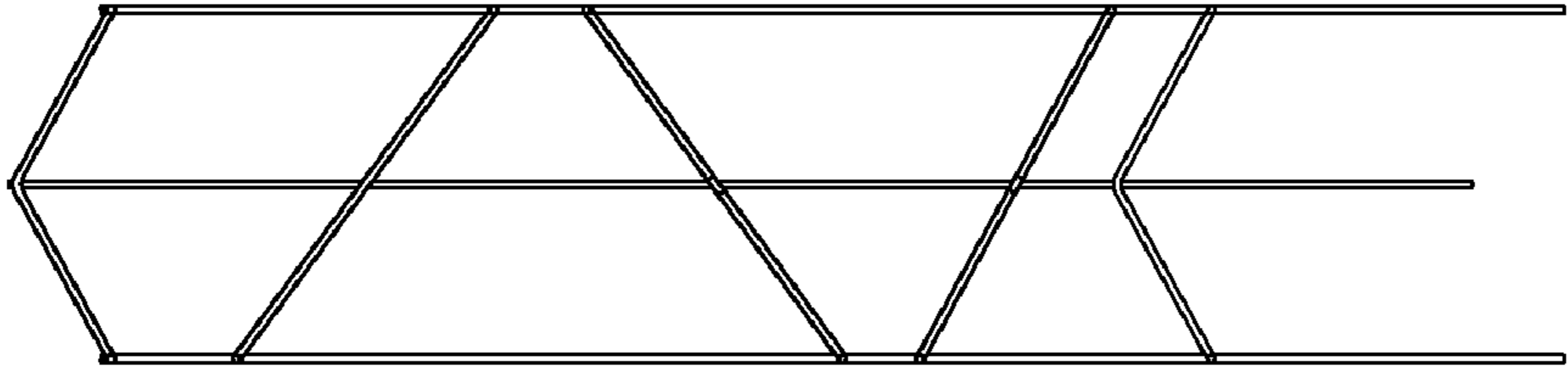
FIG. 8 is a right side plan view of the plant support shown in FIG. 6;

FIG. 9 is a left side plan view of the plant support shown in FIG. 6; and,

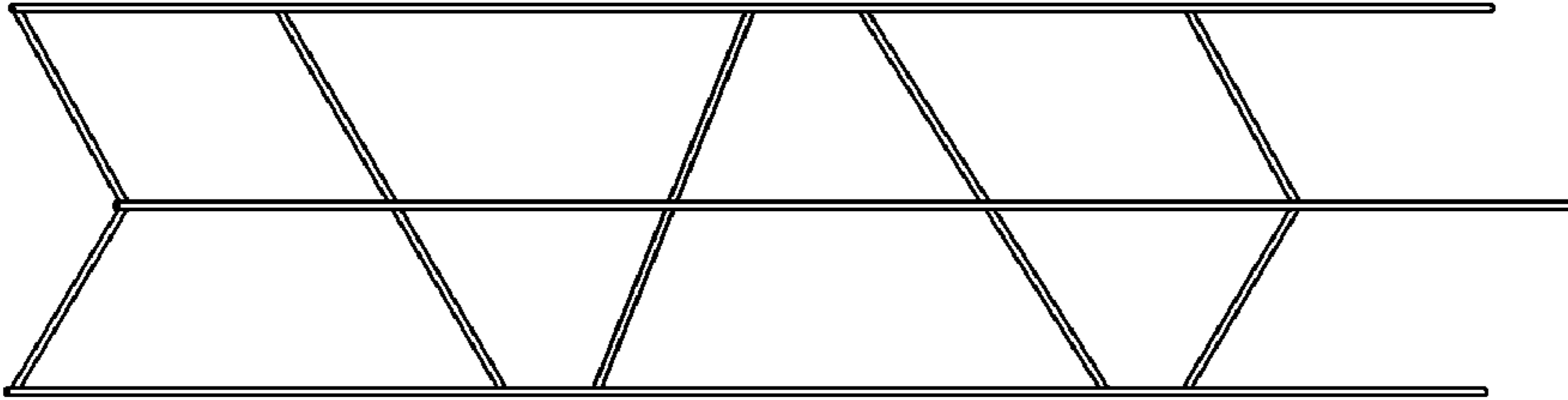
FIG. 10 is a top view of the plant support shown in FIG. 6.

**1 Claim, 2 Drawing Sheets**

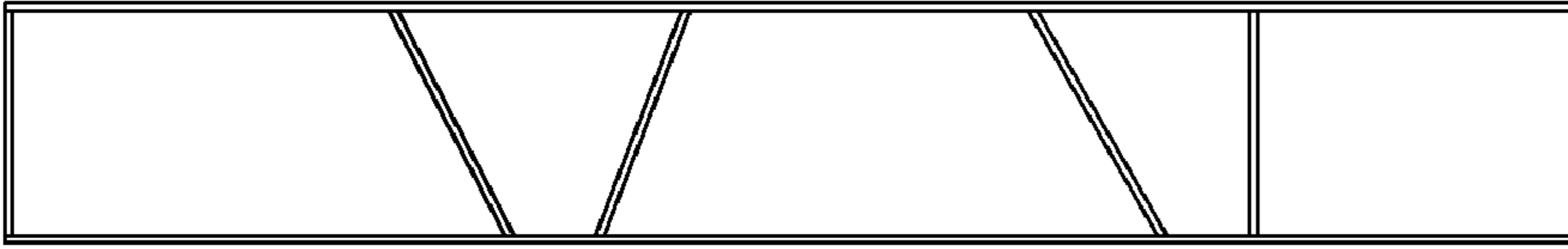




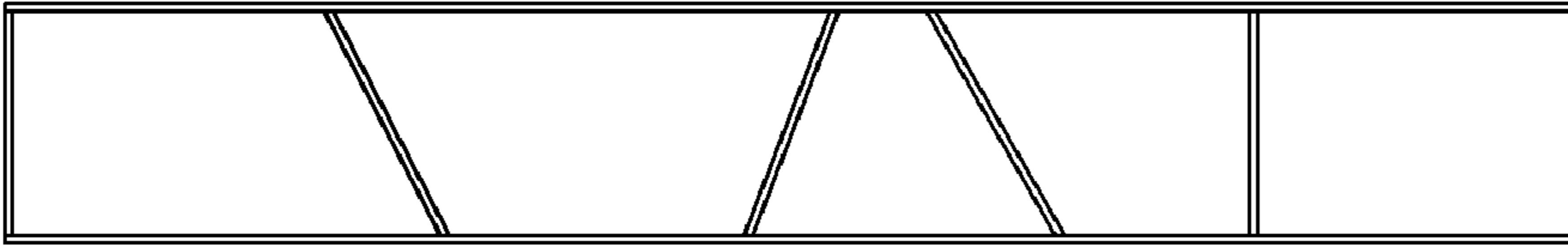
**FIG. 1**



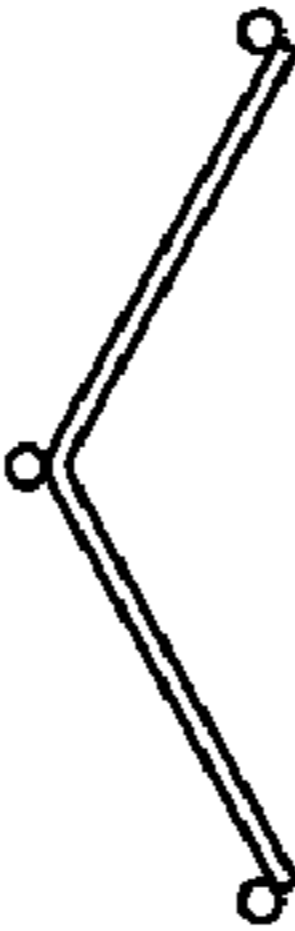
**FIG. 2**



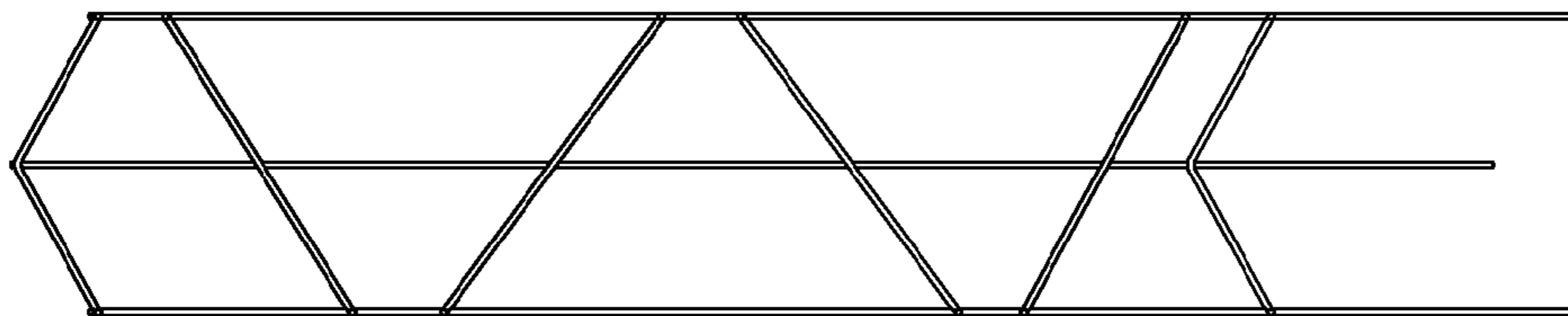
**FIG. 3**



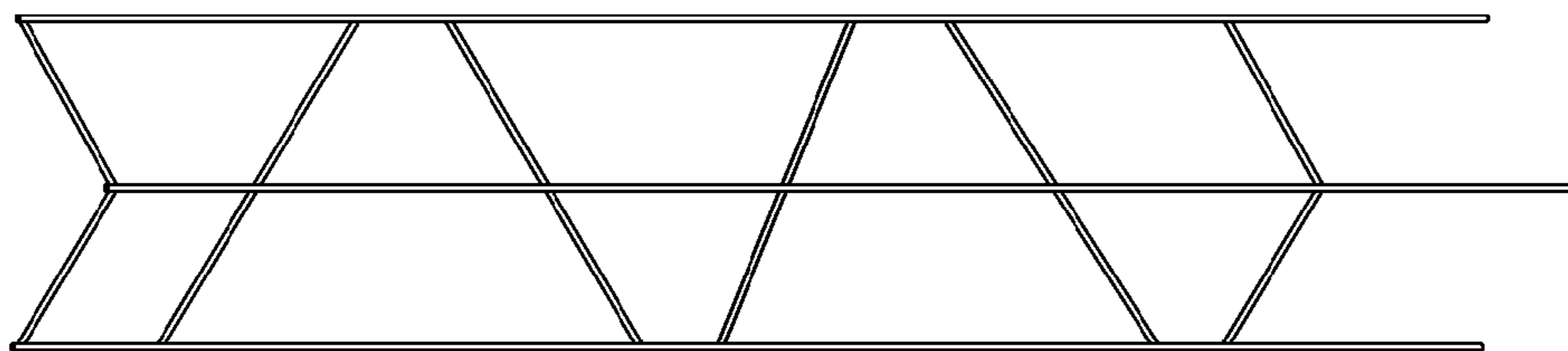
**FIG. 4**



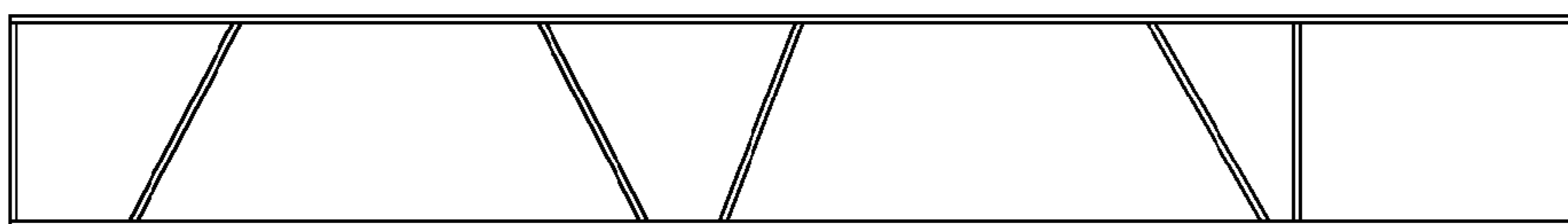
**FIG. 5**



**FIG. 6**



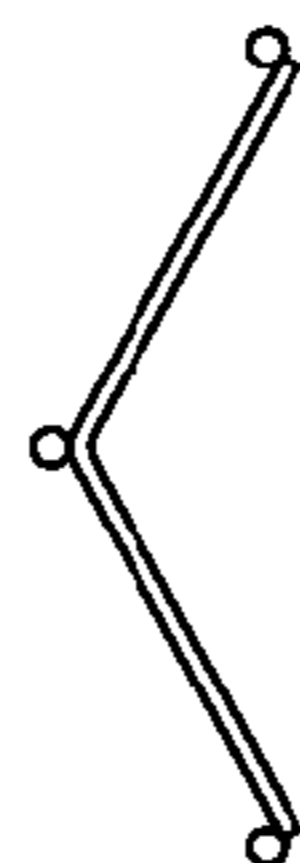
**FIG. 7**



**FIG. 8**



**FIG. 9**



**FIG. 10**