

US00D562176S

(12) **United States Design Patent**
Stowe

(10) **Patent No.:** **US D562,176 S**
(45) **Date of Patent:** **** Feb. 19, 2008**

(54) **JEWELRY ITEM**

DESCRIPTION

(76) Inventor: **Linda Faye Stowe**, 13901 S.
Springfield Rd., Brandywine, MD (US)
20613

(**) Term: **14 Years**

(21) Appl. No.: **29/260,912**

(22) Filed: **Jun. 2, 2006**

(51) **LOC (8) Cl.** **11-01**

(52) **U.S. Cl.** **D11/79**

(58) **Field of Classification Search** D11/1-25,
D11/32, 93, 94; 59/78, 79.2; 63/1.11, 3,
63/3.1, 3.2, 5.1, 5.2, 7-11; 224/175; D21/478,
D21/479, 480

See application file for complete search history.

(56) **References Cited**

U.S. PATENT DOCUMENTS

D374,194 S * 10/1996 Brocchi D11/81

* cited by examiner

Primary Examiner—Cathron Brooks

Assistant Examiner—Michael A. Pratt

(74) *Attorney, Agent, or Firm*—General Counsel, P.C.

(57) **CLAIM**

The ornamental design for a jewelry item, as shown and described.

FIG. 1 is a front, perspective view of the new jewelry item design;

FIG. 2 is a top view of said jewelry item from view line A;

FIG. 3 is a side view of said jewelry item from view line B;

FIG. 4 is a side view of said jewelry item from view line C;

FIG. 5 is a bottom view of said jewelry item from view line D;

FIG. 6 is a partial, perspective view of an upper portion of said jewelry item taken and enlarged for magnification purposes from an indicated portion of the jewelry item of FIG. 7;

FIG. 7 is a perspective view of said jewelry item indicating the portion of the jewelry item detailed in FIG. 6.

FIG. 8 is a partial, perspective view of a lower left portion of said jewelry item taken and enlarged for magnification purposes from an indicated portion of the jewelry item of FIG. 9;

FIG. 9 is a perspective view of said jewelry item indicating the portion of the jewelry item detailed in FIG. 8;

FIG. 10 is a partial, perspective view of a lower right portion of said jewelry item taken and enlarged for magnification purposes from an indicated portion of the jewelry item of FIG. 11; and,

FIG. 11 is a perspective view of said jewelry item indicating the portion of the jewelry item detailed in FIG. 12.

1 Claim, 5 Drawing Sheets

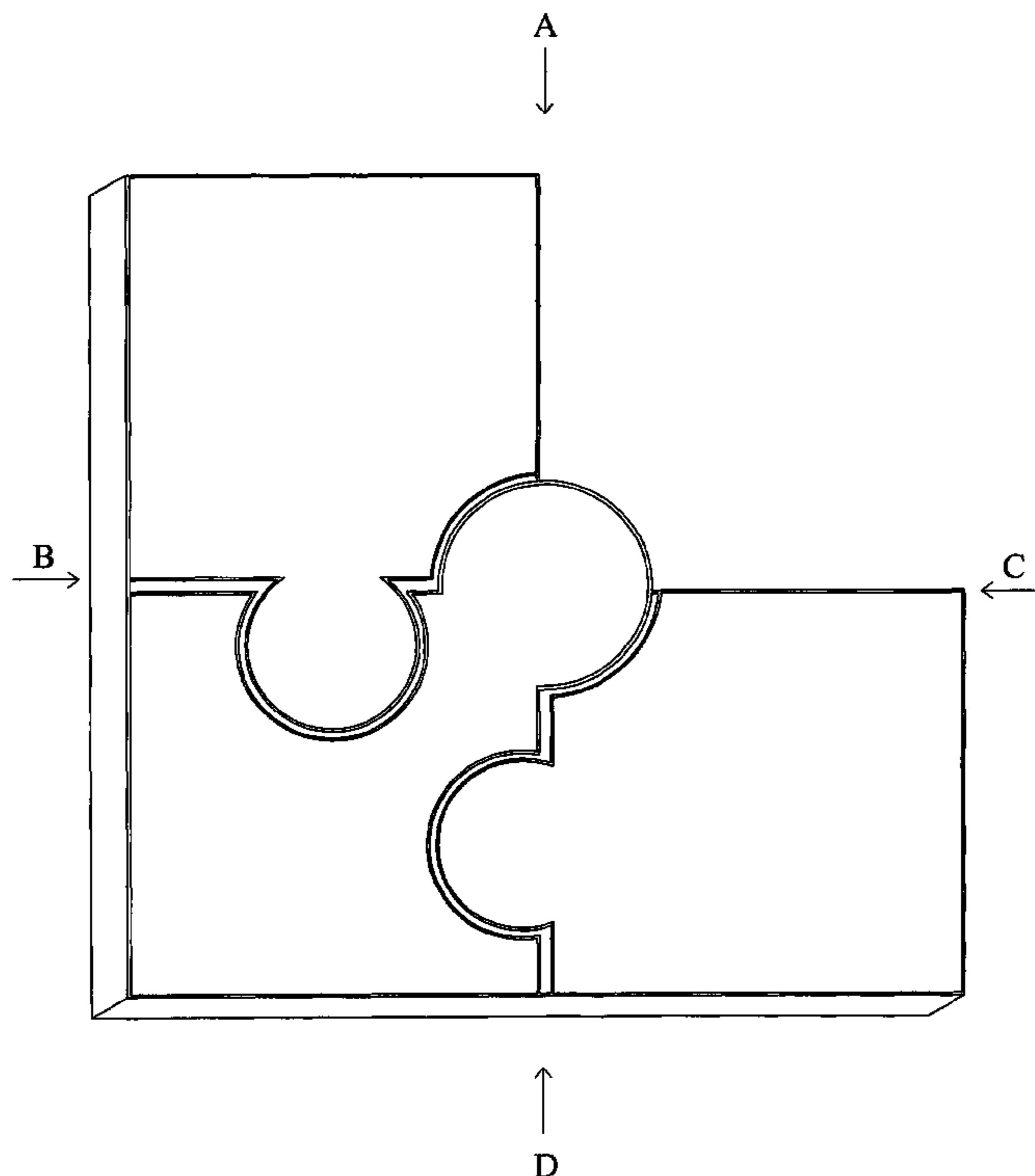

FIG. 1

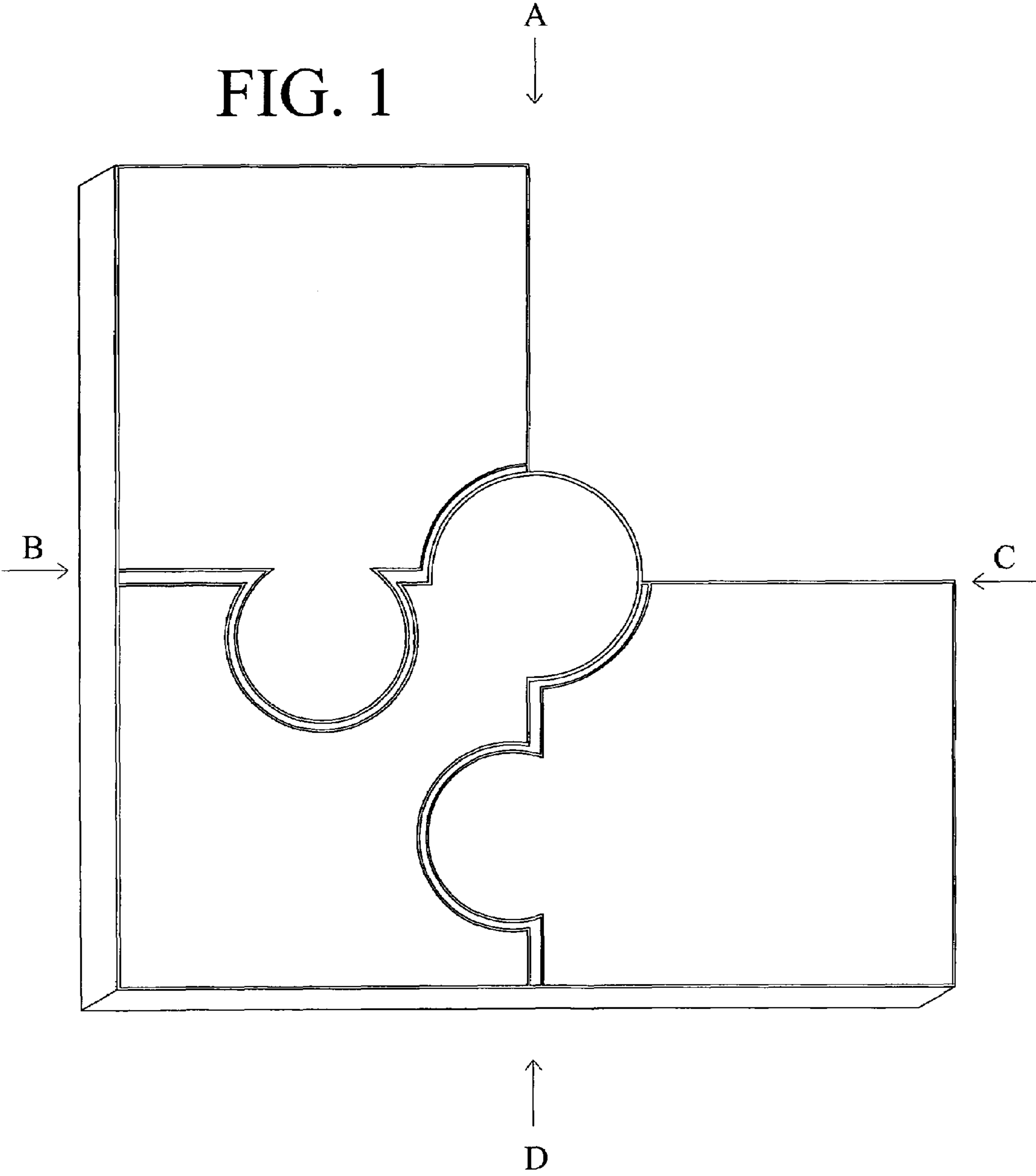

FIG. 2

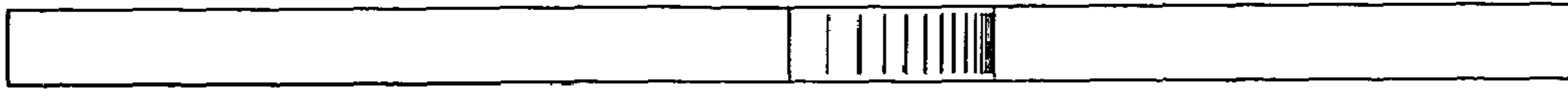

FIG. 3



FIG. 4



FIG. 5



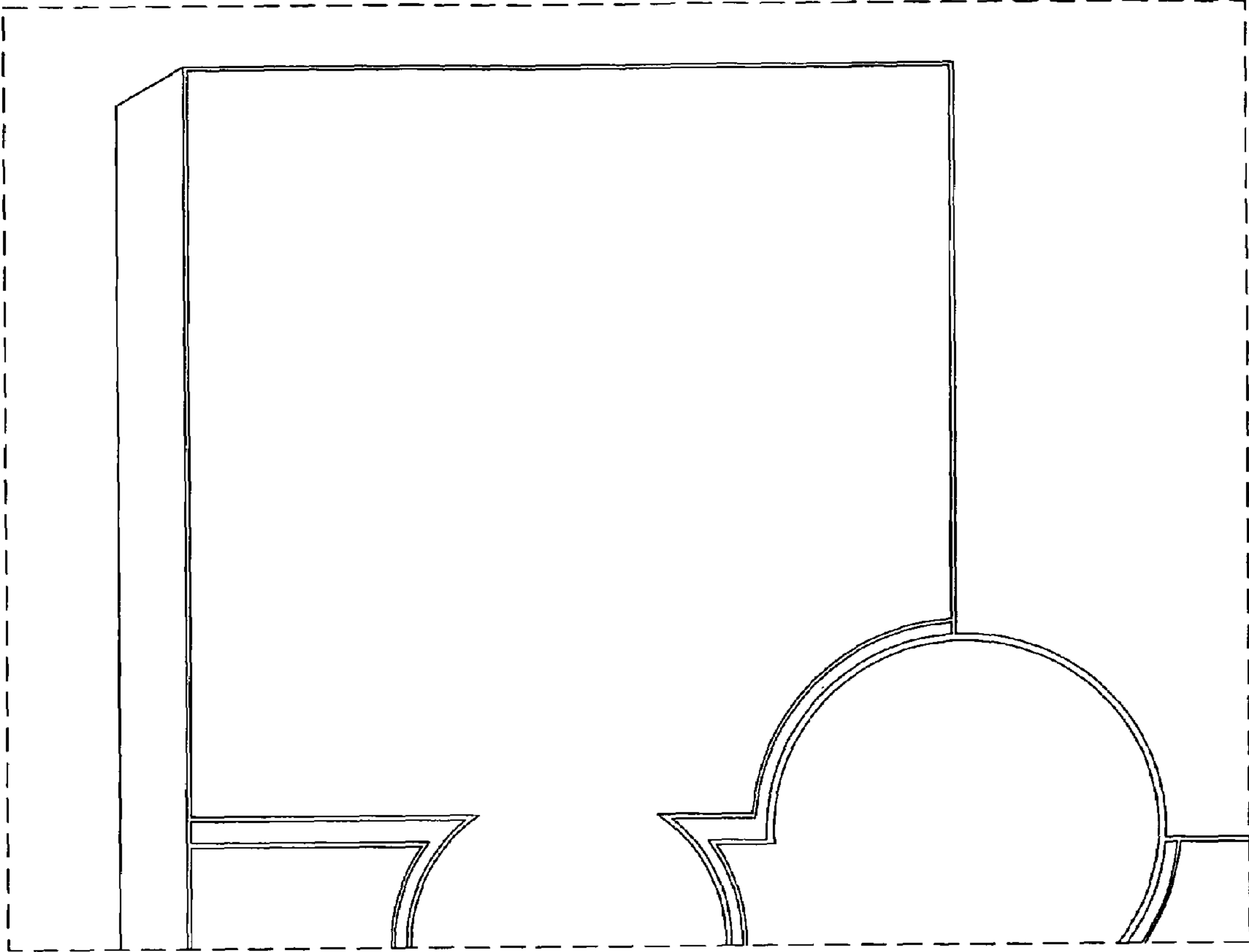

FIG. 6

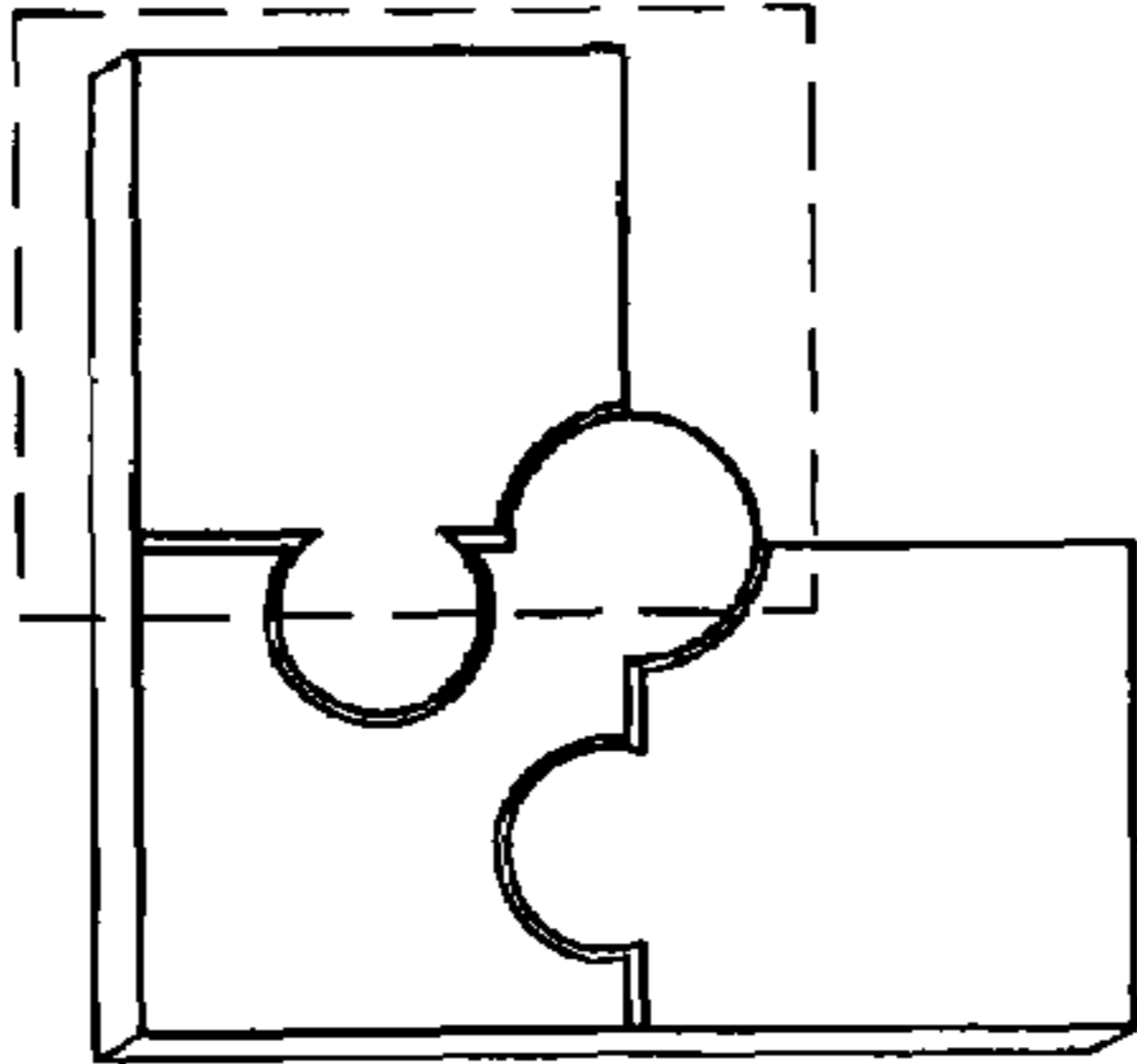

FIG. 7

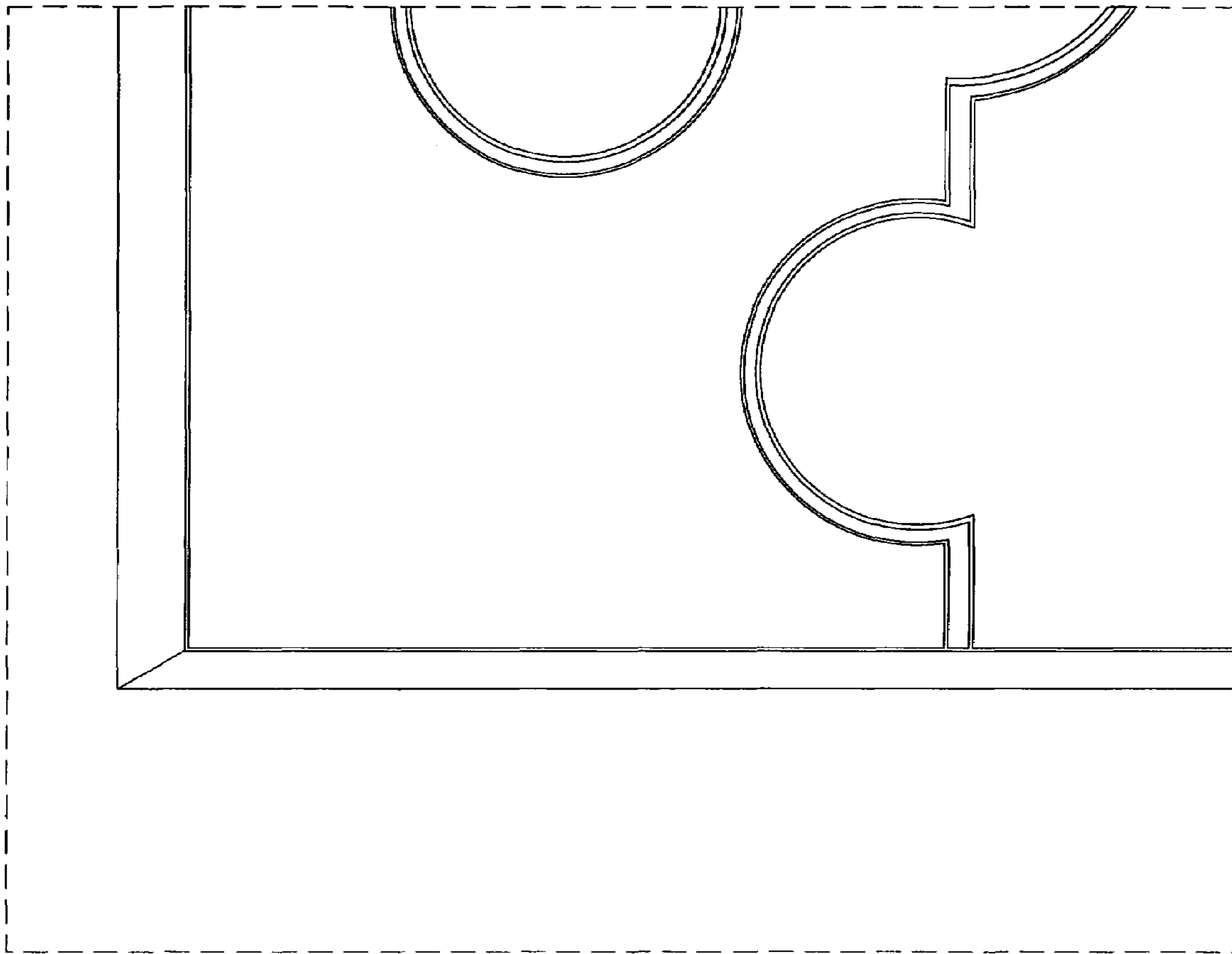

FIG. 8

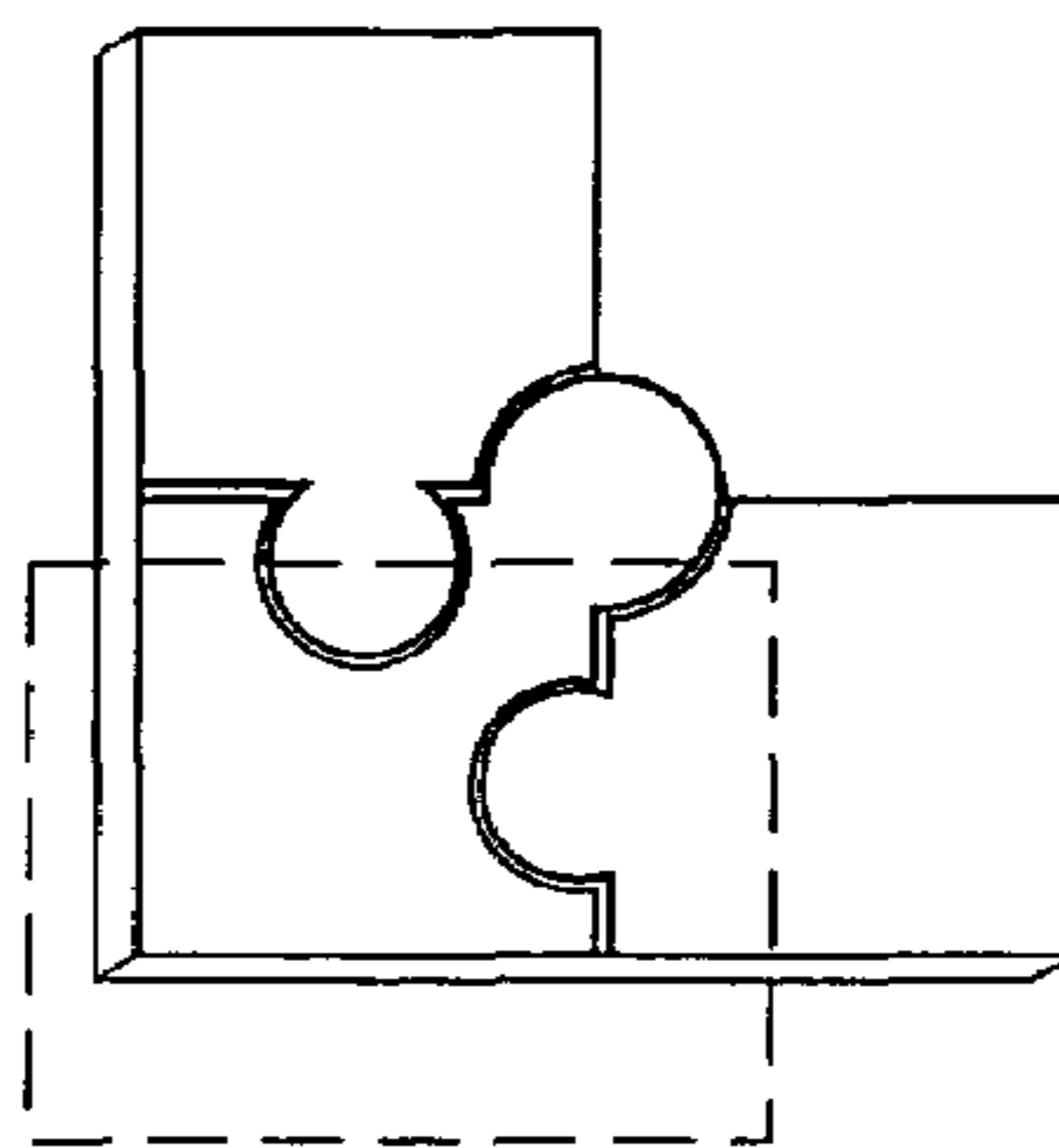

FIG. 9

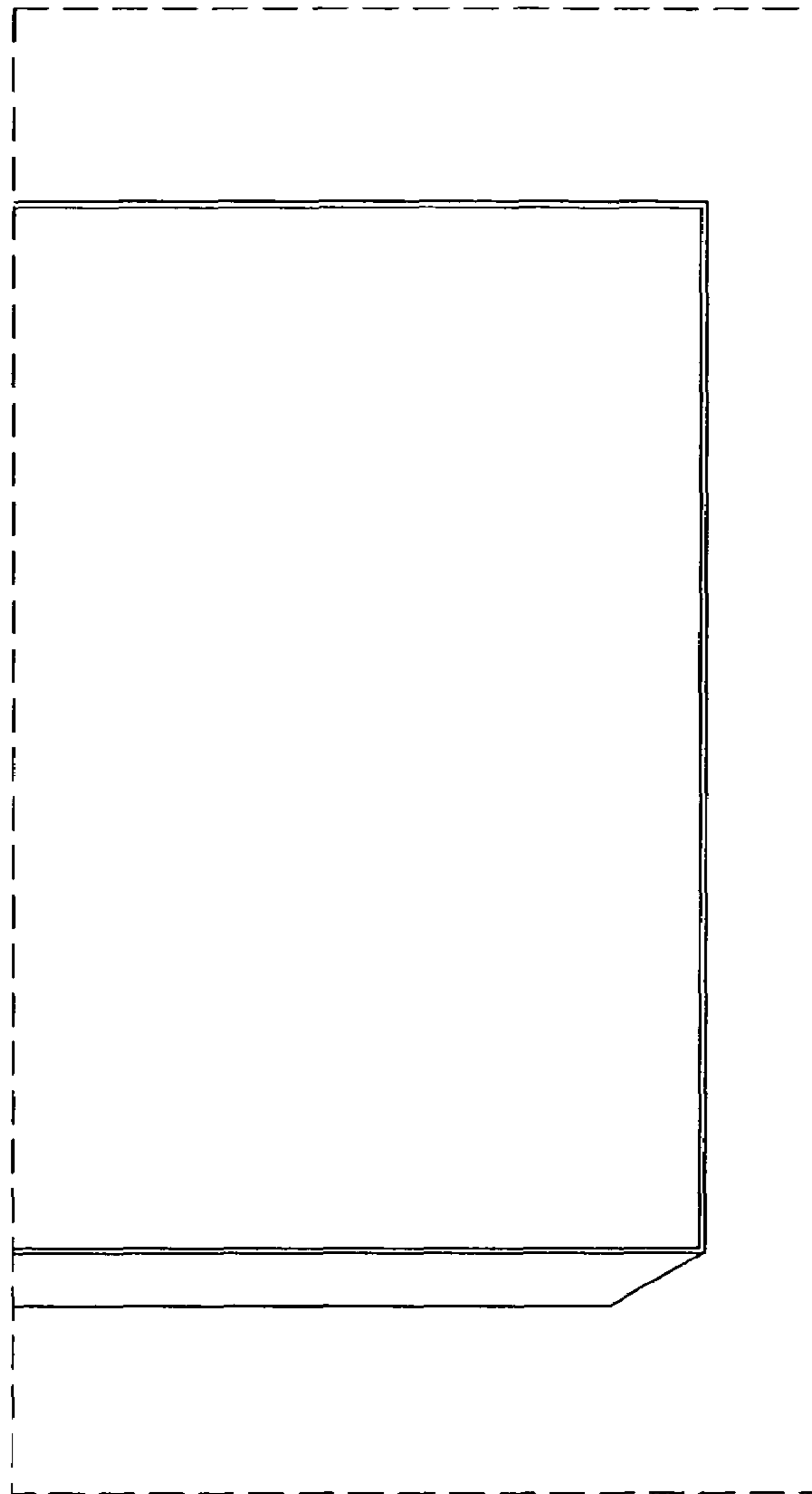

FIG. 10

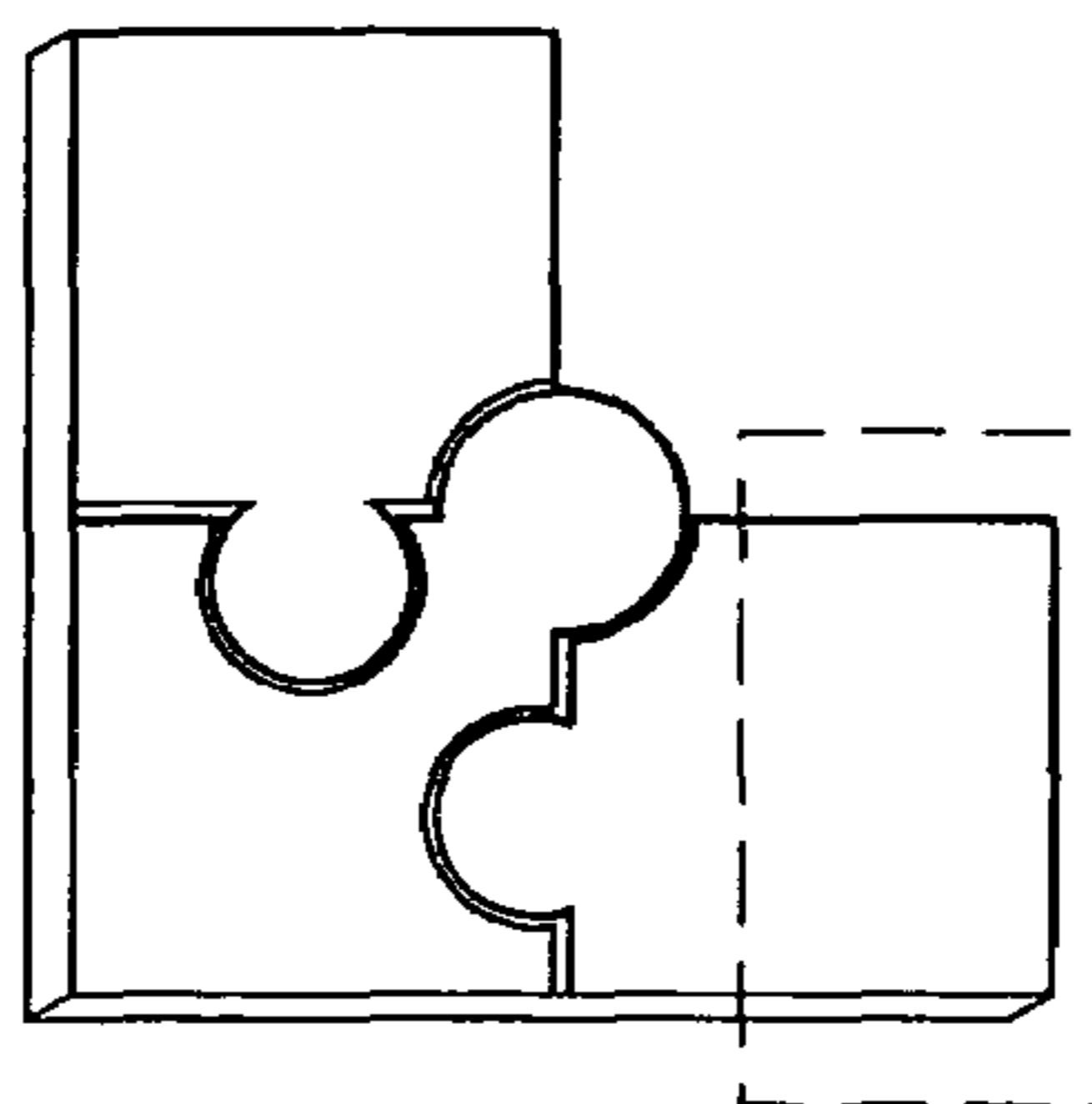

FIG. 11