

US00D561354S

(12) **United States Design Patent**
Antonic

(10) **Patent No.:** **US D561,354 S**

(45) **Date of Patent:** **** Feb. 5, 2008**

(54) **CORNER POST**

(76) Inventor: **James P. Antonic**, 9111 Southmont
Cove #406, Ft. Myers, FL (US) 33908

(**) Term: **14 Years**

(21) Appl. No.: **29/273,781**

(22) Filed: **Mar. 13, 2007**

Related U.S. Application Data

(63) Continuation of application No. 11/356,482, filed on
Feb. 17, 2006.

(51) **LOC (8) Cl.** **25-01**

(52) **U.S. Cl.** **D25/122**

(58) **Field of Classification Search** D25/122,
D25/136, 164; 52/716.1, 243, 716.8, 718.01,
52/718.04, 717.06, 718.05, 718.06, 318,
52/290, 579, 287.1, 311.1, 241, 311.2, 311.3,
52/314, 236.9, 481.1, 730.6, 731.7, 282.2,
52/282.3, 460, 461, 220.1

See application file for complete search history.

(56) **References Cited**

U.S. PATENT DOCUMENTS

2,731,116	A *	1/1956	Allison	52/731.5
4,542,614	A *	9/1985	Malachowski	52/282.3
5,070,667	A *	12/1991	Schulte	52/241
D371,208	S *	6/1996	De Zen	D25/122
D384,169	S	9/1997	Leonelli		
5,927,039	A	7/1999	De Boer		
6,341,458	B1 *	1/2002	Burt	52/287.1

6,553,731	B2	4/2003	Hsueh
6,837,012	B2	1/2005	Scherrer et al.
D511,217	S	11/2005	Bullock et al.
2002/0148178	A1	10/2002	Farag

OTHER PUBLICATIONS

U.S. Appl. No. 29/273,841, filed Mar. 14, 2007, Antonic.
U.S. Appl. No. 29/273,728, filed Mar. 12, 2007, Antonic.
U.S. Appl. No. 29/273,414, filed Mar. 5, 2007, Antonic.
U.S. Appl. No. 29/267,244, filed Oct. 10, 2006, Antonic.
U.S. Appl. No. 29/267,246, filed Oct. 10, 2006, Antonic.

* cited by examiner

Primary Examiner—Doris Clark

(74) *Attorney, Agent, or Firm*—Laura G. Barrow

(57) **CLAIM**

The ornamental design of a corner post, as shown and described.

DESCRIPTION

FIG. 1 is a front/right/top perspective view of the corner post showing my new design, shown broken in the center with a double line to indicate that no particular length is claimed.

FIG. 2 is a front side elevation view thereof;

FIG. 3 is a rear elevation view thereof;

FIG. 4 is a left side view thereof;

FIG. 5 is a right side view thereof; and,

FIG. 6 is a top view thereof.

The bottom view is identical to the top view.

1 Claim, 3 Drawing Sheets

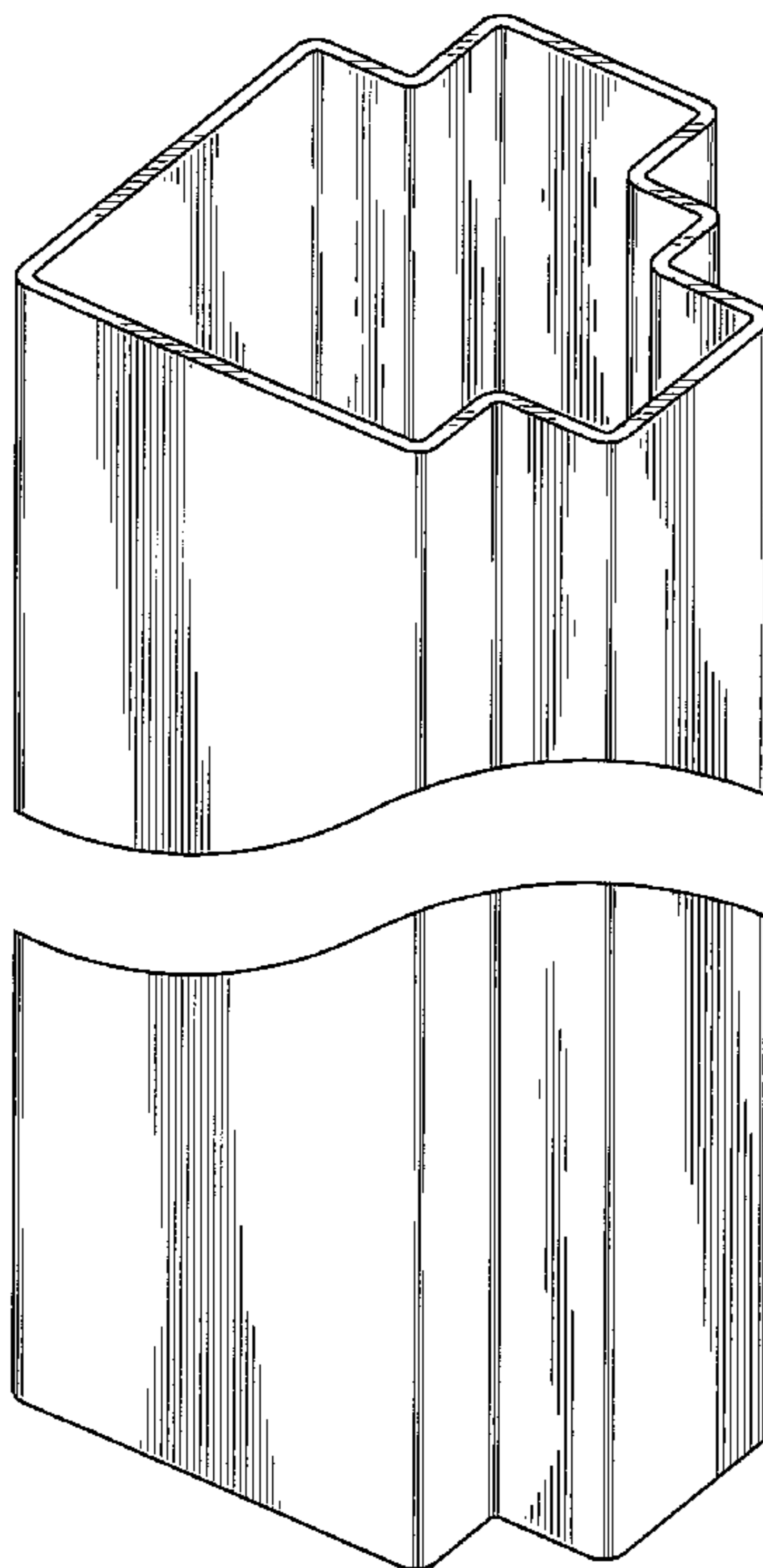
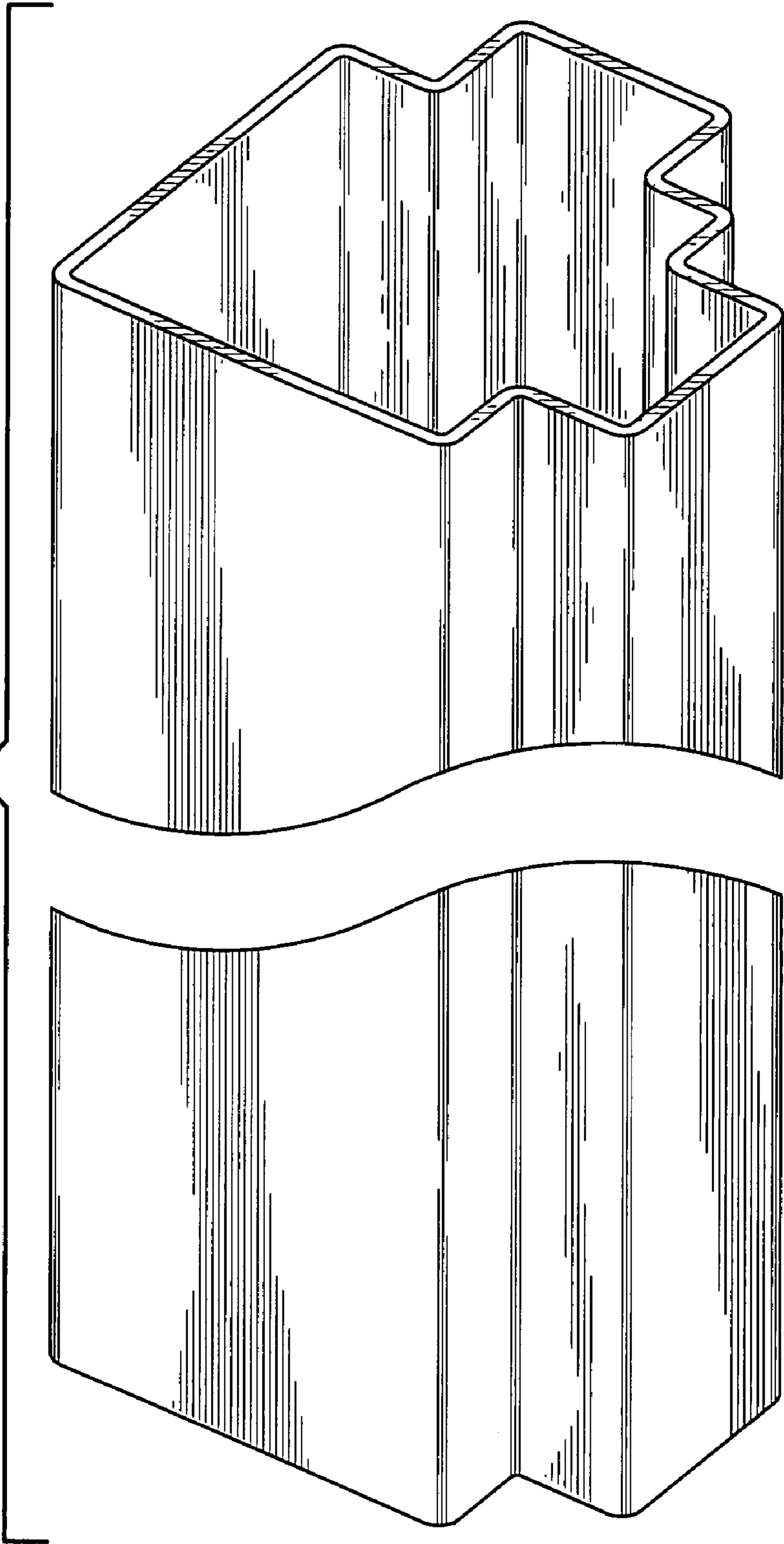

Fig. 1



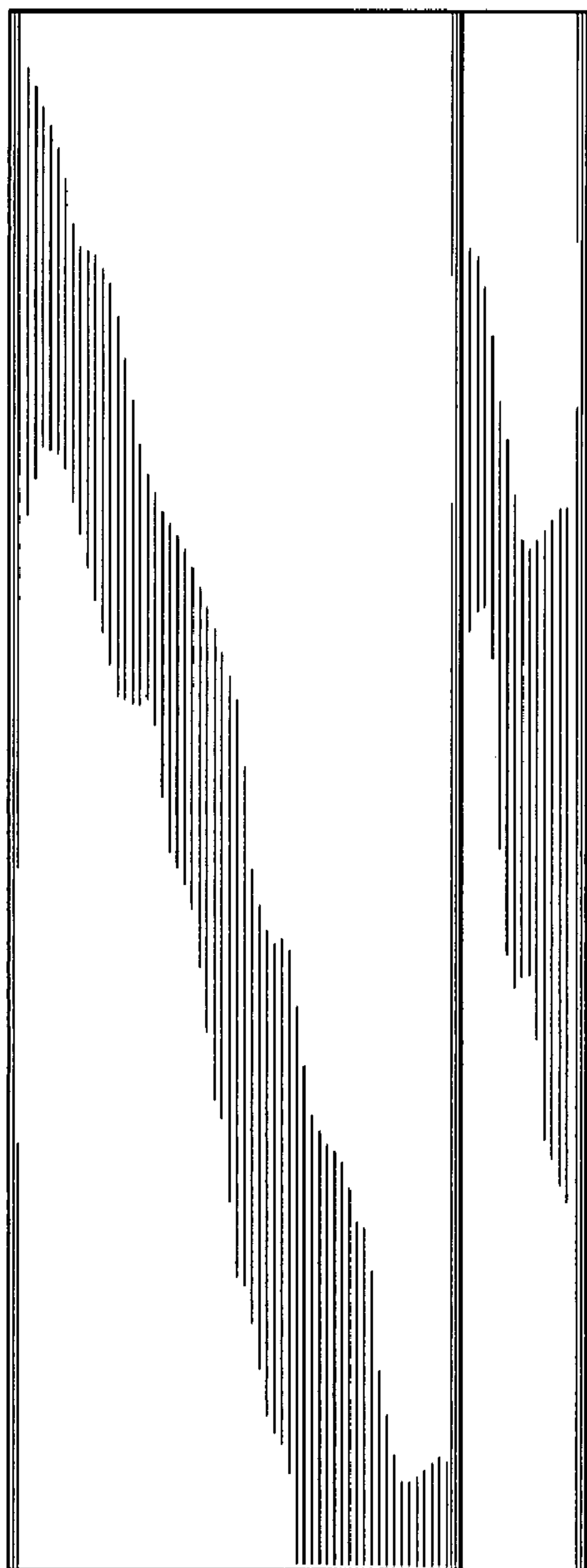

Fig. 2

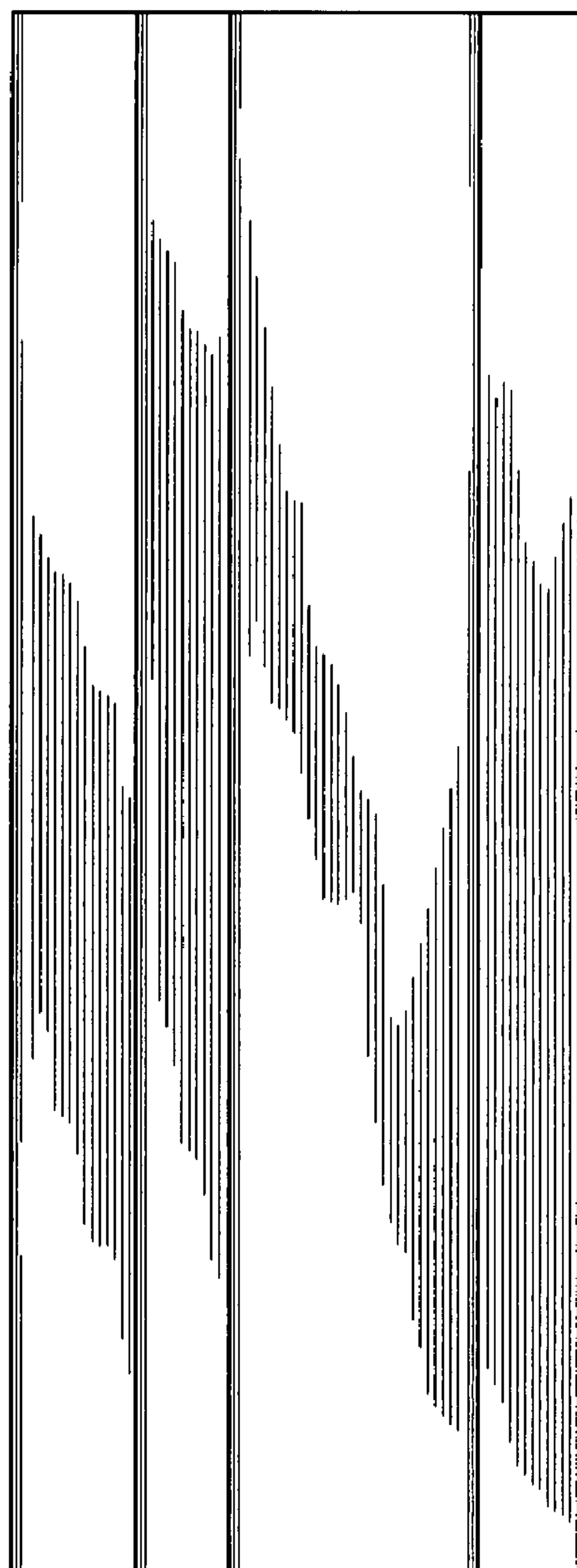

Fig. 3



Fig. 4

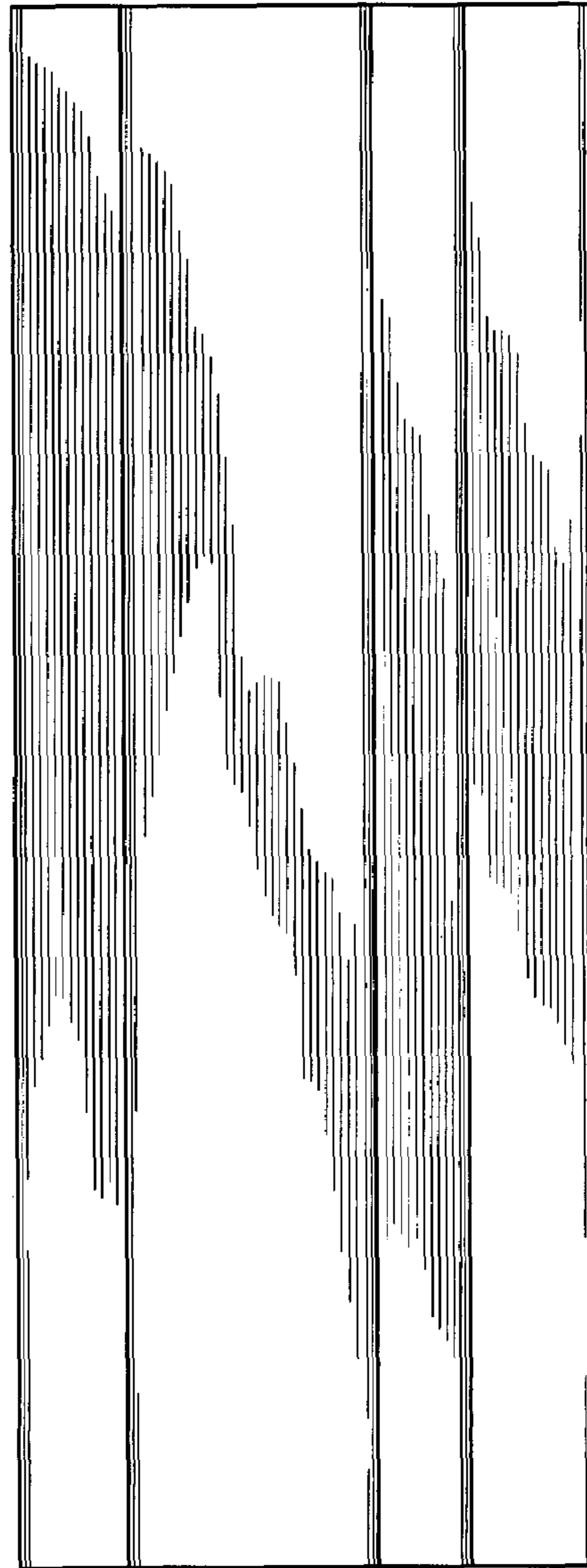

Fig. 5

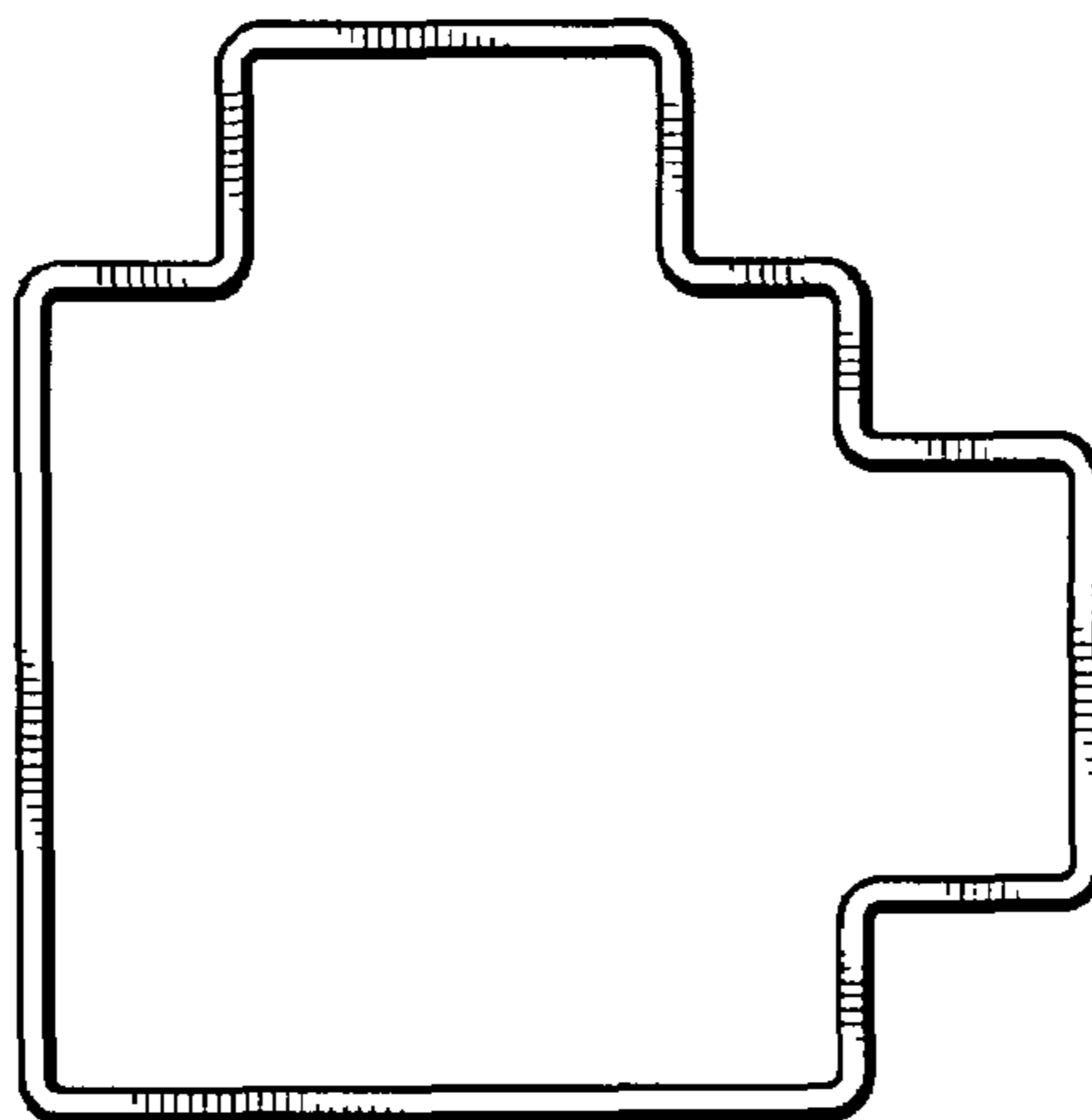

Fig. 6