



US00D561098S

(12) **United States Design Patent**
Kobayashi

(10) **Patent No.:** **US D561,098 S**

(45) **Date of Patent:** **** Feb. 5, 2008**

(54) **COMPONENT FOR AIDING CONNECTION
OF A DRY CELL BATTERY TO A PORTABLE
DEVICE**

6,951,488 B2 * 10/2005 Hsieh 439/660
D529,443 S * 10/2006 Chien D13/147
D538,228 S * 3/2007 Wang et al. D13/146
2003/0190848 A1 * 10/2003 Wu 439/862

(75) Inventor: **Hiroaki Kobayashi**, Kanagawa (JP)

* cited by examiner

(73) Assignee: **IRISO Electronics Co., Ltd.**,
Kanagawa (JP)

Primary Examiner—Cathron Brooks

Assistant Examiner—Rosemary K Tarca

(**) Term: **14 Years**

(74) *Attorney, Agent, or Firm*—Lowe Hauptman Ham &
Berner LLP

(21) Appl. No.: **29/221,457**

(57) **CLAIM**

(22) Filed: **Jan. 18, 2005**

The ornamental design for a component for aiding connec-
tion of a dry cell battery to a portable device, as shown and
described.

(30) **Foreign Application Priority Data**

DESCRIPTION

Jul. 15, 2004 (JP) 2004-021439

(51) **LOC (8) Cl.** **13-03**

(52) **U.S. Cl.** **D13/120; D13/147**

(58) **Field of Classification Search** D13/120,
D13/133, 146–147, 184, 199; 439/108, 577,
439/630, 660, 680, 773, 862

See application file for complete search history.

FIG. 1 is a front view of a component for aiding connection
of a dry cell battery to a portable device showing my new
design in a position of use. The broken line of the connector
shown in FIG. 1 is for illustrative purposes only and forms
no part of the claimed design. The broken lines which define
the bounds of the claimed design form no part thereof;

(56) **References Cited**

FIG. 2 is a rear view thereof;

U.S. PATENT DOCUMENTS

FIG. 3 is a left side view thereof;

5,752,841 A * 5/1998 Hori 439/108
D419,133 S * 1/2000 Yoshida et al. D13/120
6,068,519 A * 5/2000 Lok 439/660
6,113,440 A * 9/2000 Fijten et al. 439/862
6,315,620 B1 * 11/2001 Moir et al. 439/862
D455,126 S * 4/2002 Wu D13/147
D485,807 S * 1/2004 Kao et al. D13/133
D486,448 S * 2/2004 Watanabe et al. D13/120
6,702,621 B2 * 3/2004 Yeh 439/660

FIG. 4 is a right side view thereof;

FIG. 5 is a top plan view thereof;

FIG. 6 is a bottom plan view thereof;

FIG. 7 is a perspective view thereof from the rear side; and,

FIG. 8 is a perspective view thereof from the front side.

1 Claim, 4 Drawing Sheets

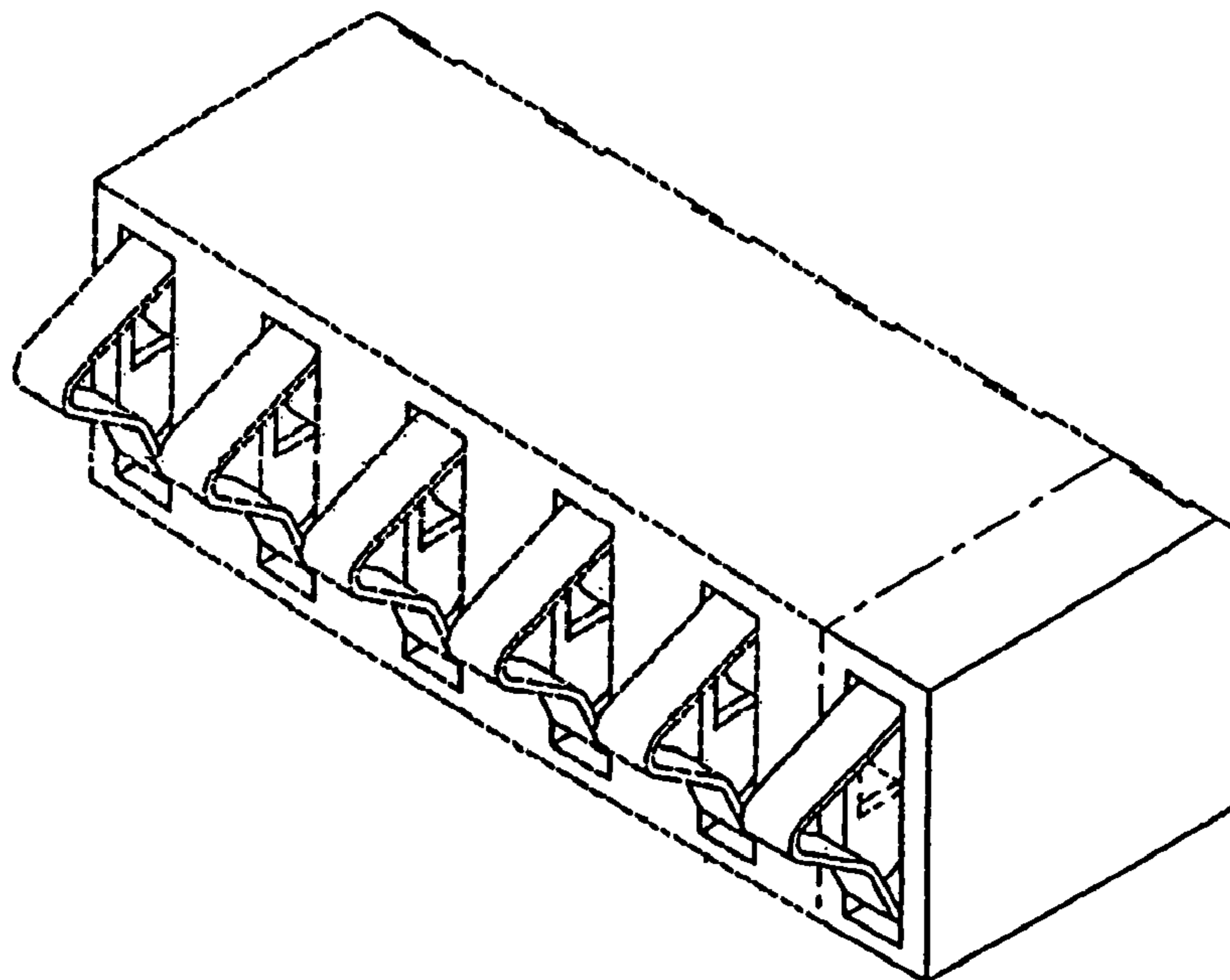

Figure 1

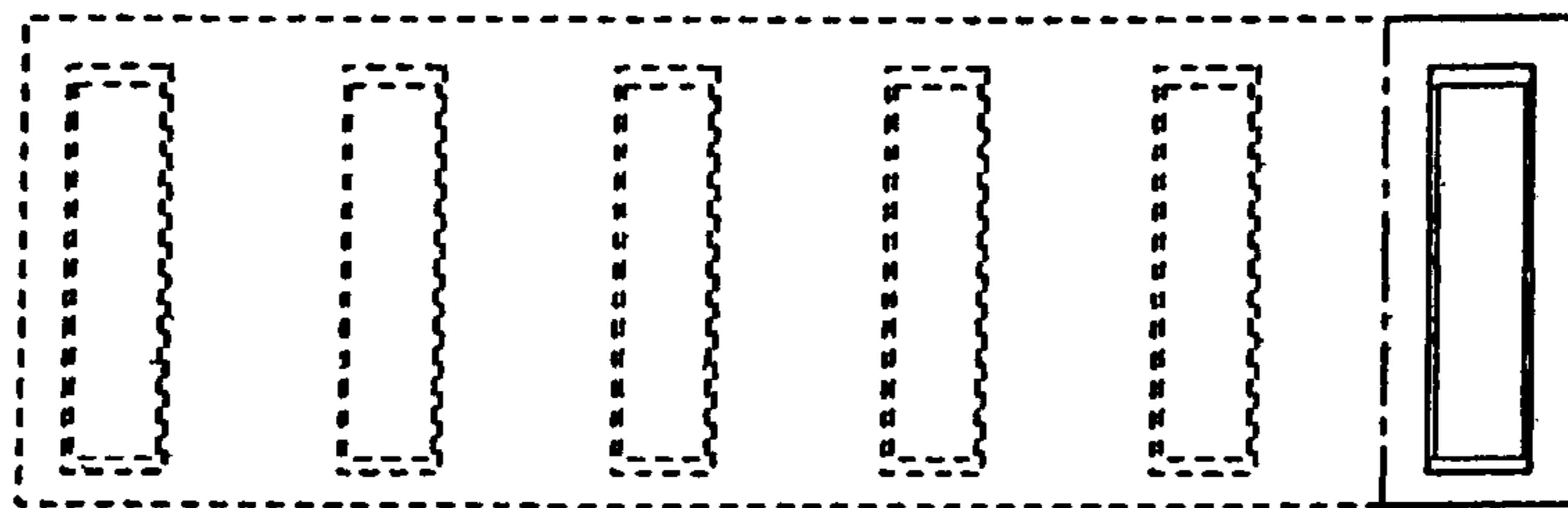

Figure 2

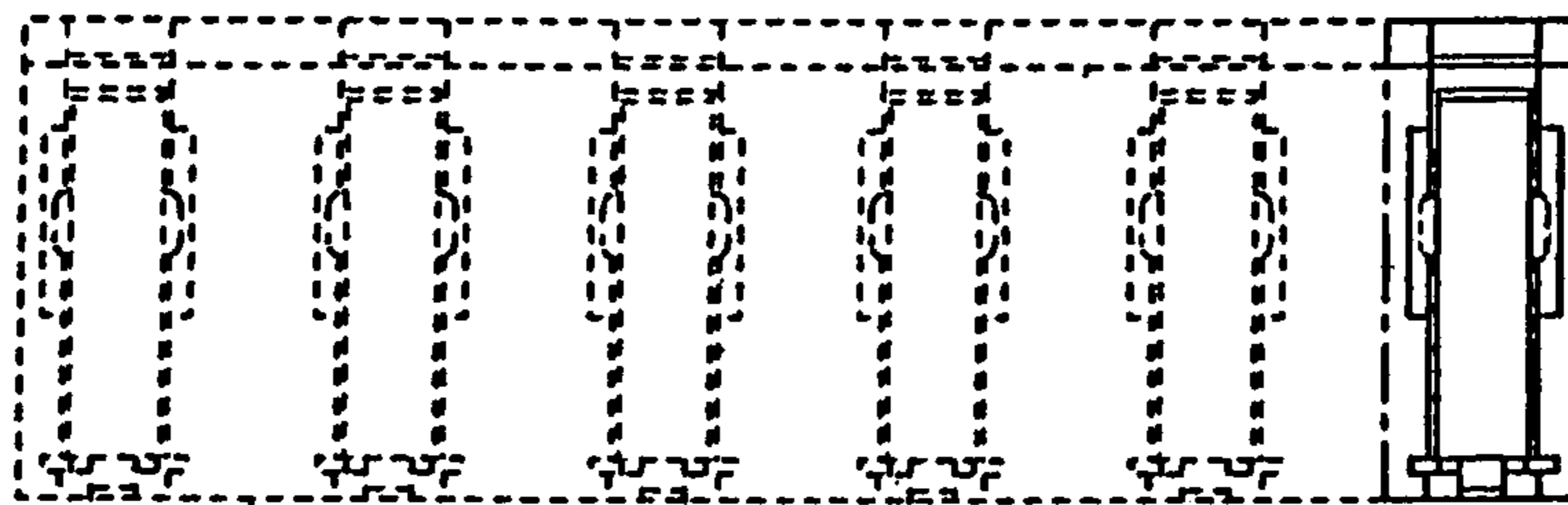

Figure 3

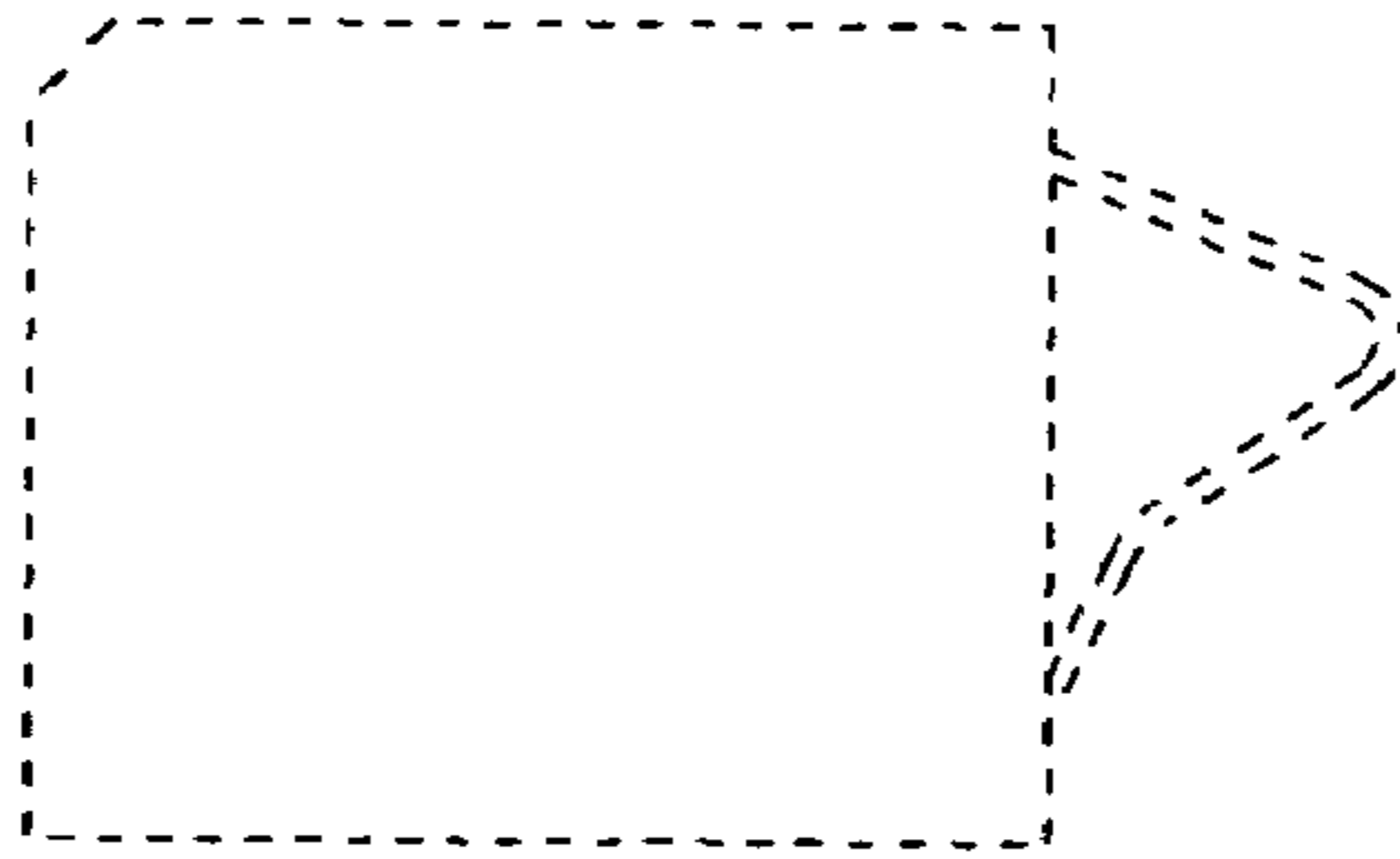

Figure 4

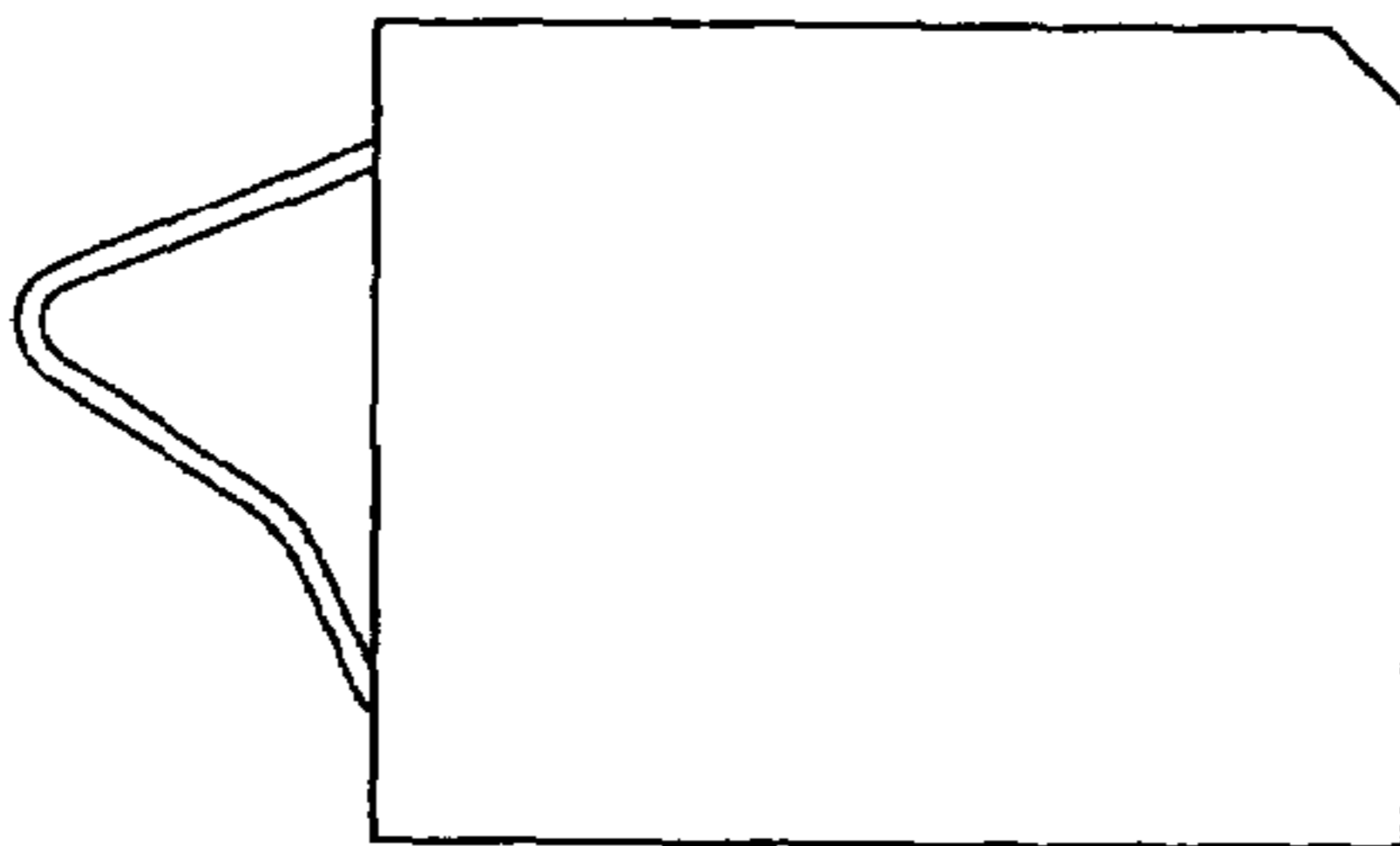

Figure 5

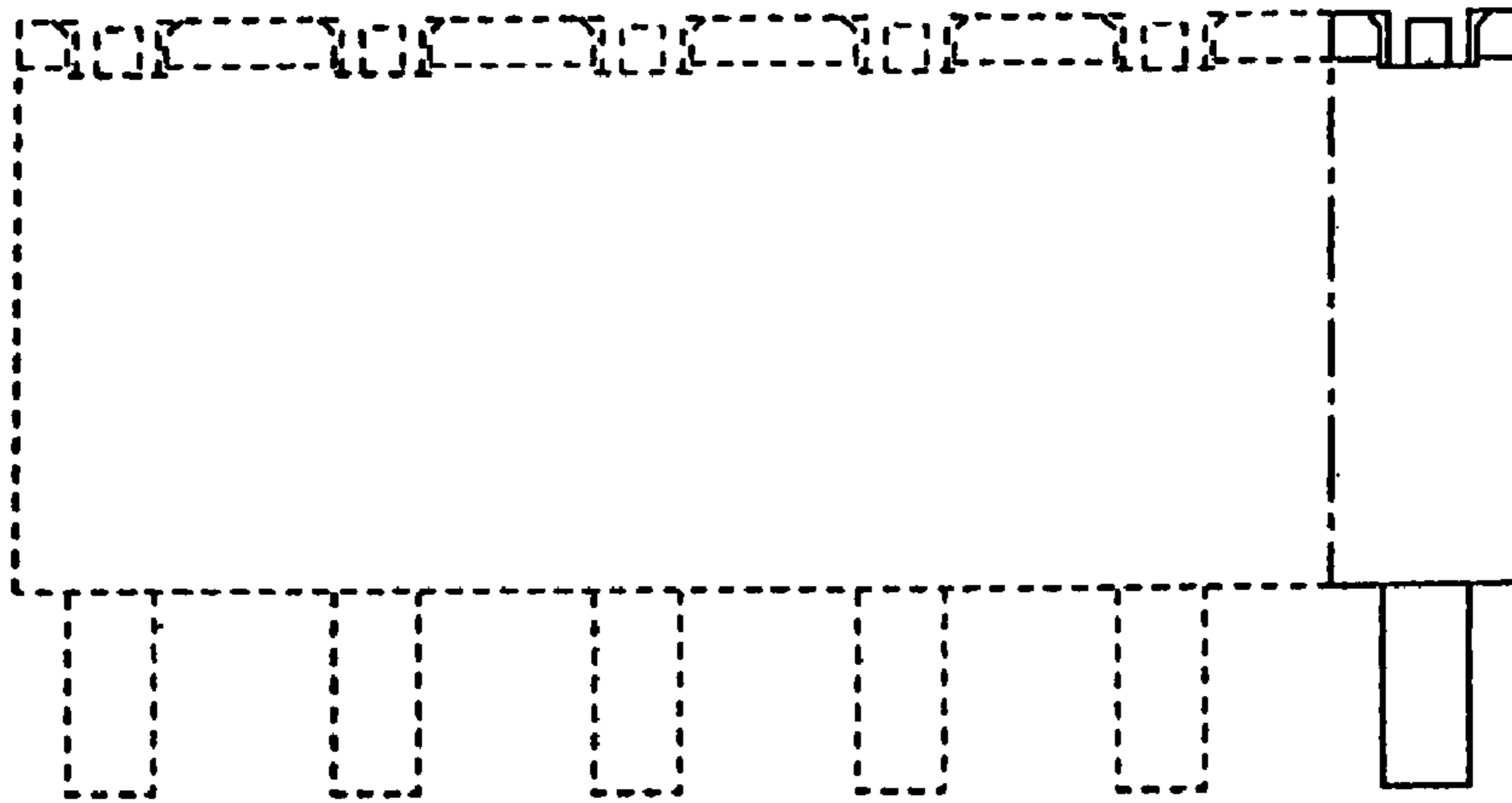

Figure 6



Figure 7

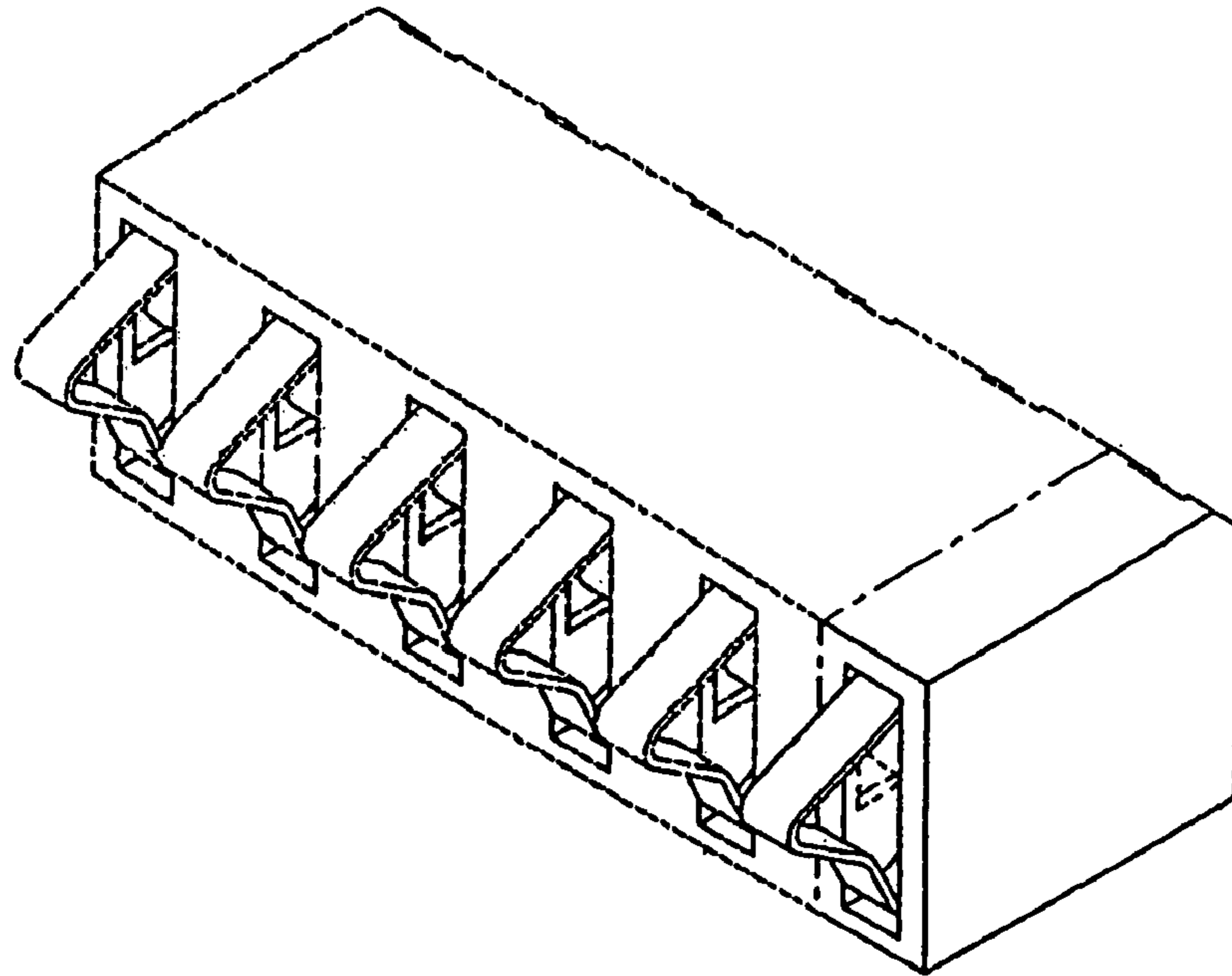

Figure 8

