



US00D560519S

(12) **United States Design Patent**  
**Skelton et al.**

(10) **Patent No.: US D560,519 S**  
(45) **Date of Patent: \*\* Jan. 29, 2008**

(54) **END CAPS FOR A NAVIGATIONAL DEVICE**

(75) Inventors: **Paul E. Skelton**, Lenexa, KS (US);  
**Kevin M. Hansen**, Lawrence, KS (US);  
**Warren R. Stevens**, Olathe, KS (US)

(73) Assignee: **Garmin Ltd.** (KY)

(\*\*) Term: **14 Years**

(21) Appl. No.: **29/275,092**

(22) Filed: **Dec. 12, 2006**

(51) **LOC (8) Cl.** ..... **10-04**

(52) **U.S. Cl.** ..... **D10/65**

(58) **Field of Classification Search** ..... D10/65,  
D10/80; D14/347; 342/351, 419, 457, 357.06-357.13;  
343/702; 345/87, 104, 133, 156, 168, 173,  
345/901-905; 348/180, 184, 315, 739; 364/444,  
364/499; 701/206-209, 213, 214  
See application file for complete search history.

(56) **References Cited**

U.S. PATENT DOCUMENTS

D467,512 S \* 12/2002 Miyazaki ..... D10/65

(Continued)

*Primary Examiner*—Antoine D. Davis

(74) *Attorney, Agent, or Firm*—Kevin E. West; Samuel M. Korte

(57) **CLAIM**

The ornamental design for end caps for a navigational device, as shown and described.

**DESCRIPTION**

FIG. 1 is a top isometric view of end caps for a navigational device according to the present invention;

FIG. 2 is a bottom isometric view thereof;

FIG. 3 is a top plan view of the bottom portion thereof;

FIG. 4 is a rear elevational view of the bottom portion thereof;

FIG. 5 is a right side elevational view of the bottom portion thereof;

FIG. 6 is a front elevational view of the bottom portion thereof;

FIG. 7 is a bottom plan view of the bottom portion thereof;

FIG. 8 is a top plan view of the top portion thereof;

FIG. 9 is a front elevational view of the top portion thereof;

FIG. 10 is a right side elevational view of the top portion thereof;

FIG. 11 is a rear elevational view of the top portion thereof;

FIG. 12 is a bottom plan view of the top portion thereof;

FIG. 13 is a top isometric view thereof;

FIG. 14 is a bottom isometric view thereof;

FIG. 15 is a top plan view of the bottom portion thereof;

FIG. 16 is a rear elevational view of the bottom portion thereof;

FIG. 17 is a right side elevational view of the bottom portion thereof;

FIG. 18 is a front elevational view of the bottom portion thereof;

FIG. 19 is a bottom plan view of the bottom portion thereof;

FIG. 20 is a top plan view of the top portion thereof;

FIG. 21 is a front elevational view of the top portion thereof;

FIG. 22 is a right side elevational view of the top portion thereof;

FIG. 23 is a rear elevational view of the top portion thereof; and,

FIG. 24 is a bottom plan view of the top portion thereof.

Portions of FIGS. 1 through 24 are shown in dashed lines for illustrative purposes only and form no part of the claimed design.

**1 Claim, 6 Drawing Sheets**

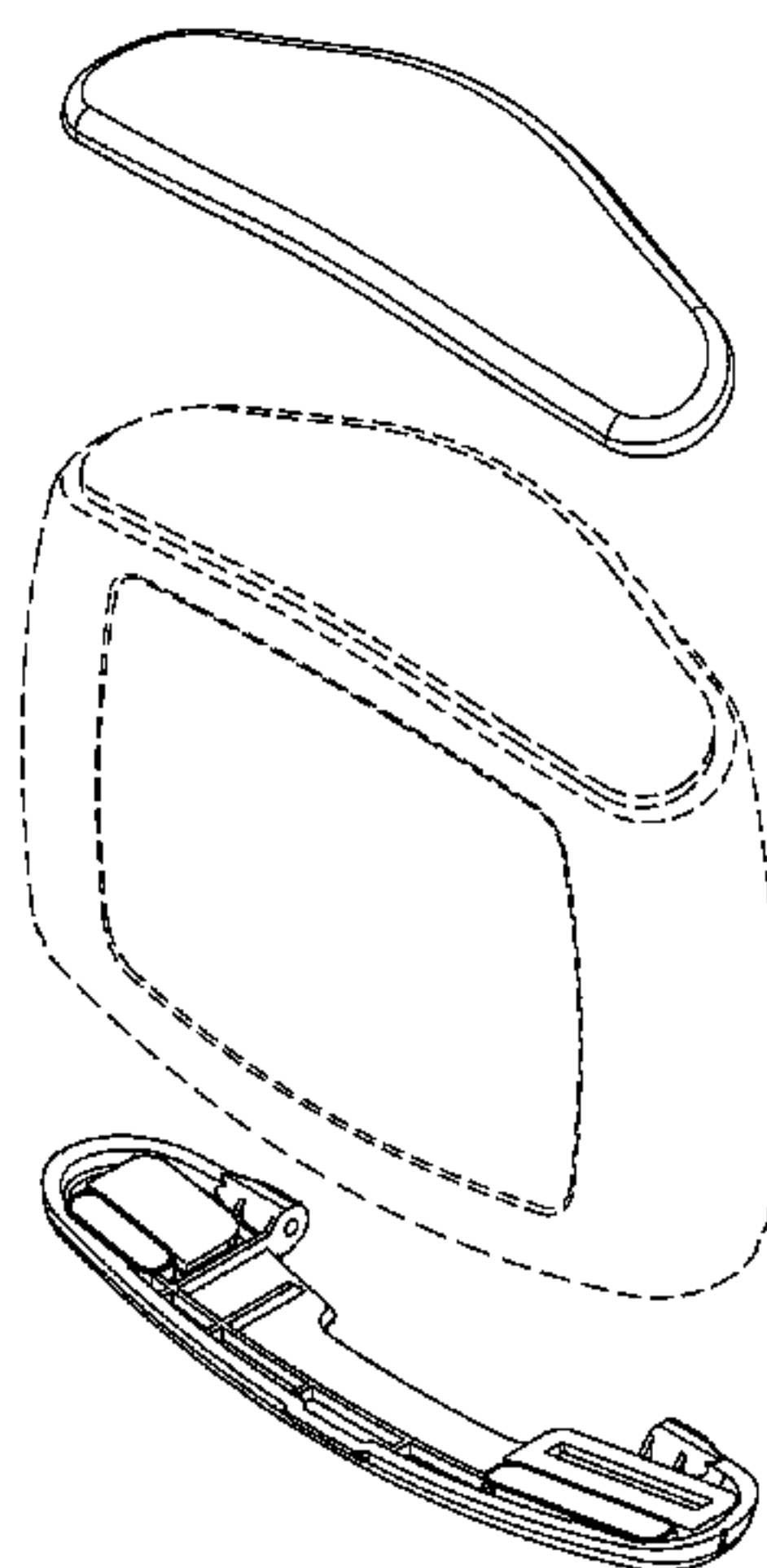

# US D560,519 S

Page 2

---

## U.S. PATENT DOCUMENTS

D514,003 S *	1/2006	Kim .....	D10/65	D541,682 S *	5/2007	Uno .....	D10/65
D540,203 S *	4/2007	Jeon .....	D10/65	D543,876 S *	6/2007	Kalis et al. ....	D10/65
D541,186 S *	4/2007	Lammers-Meis et al. ....	D10/65	D544,381 S *	6/2007	Lammers-Meis et al. ....	D10/65

\* cited by examiner

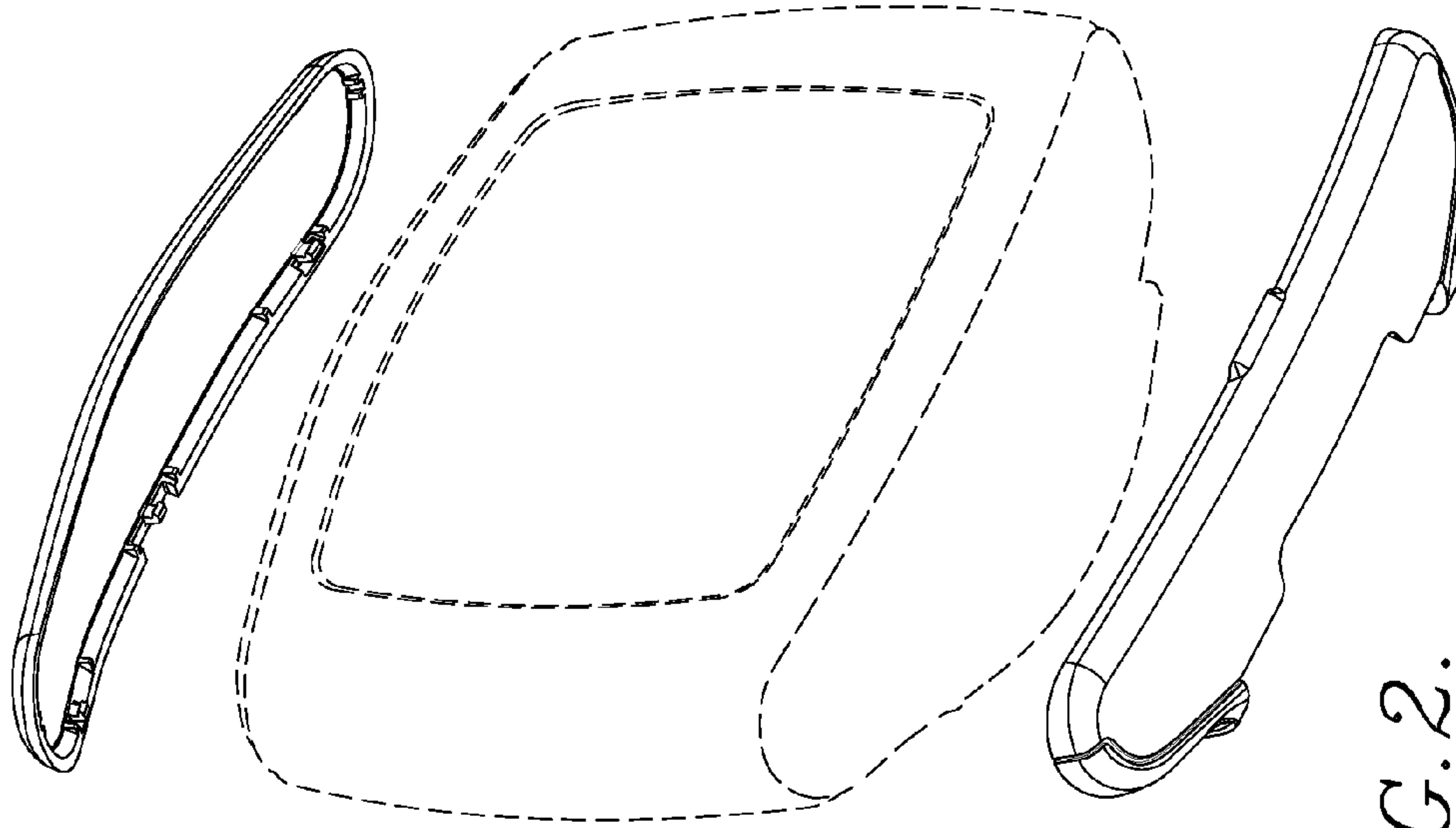
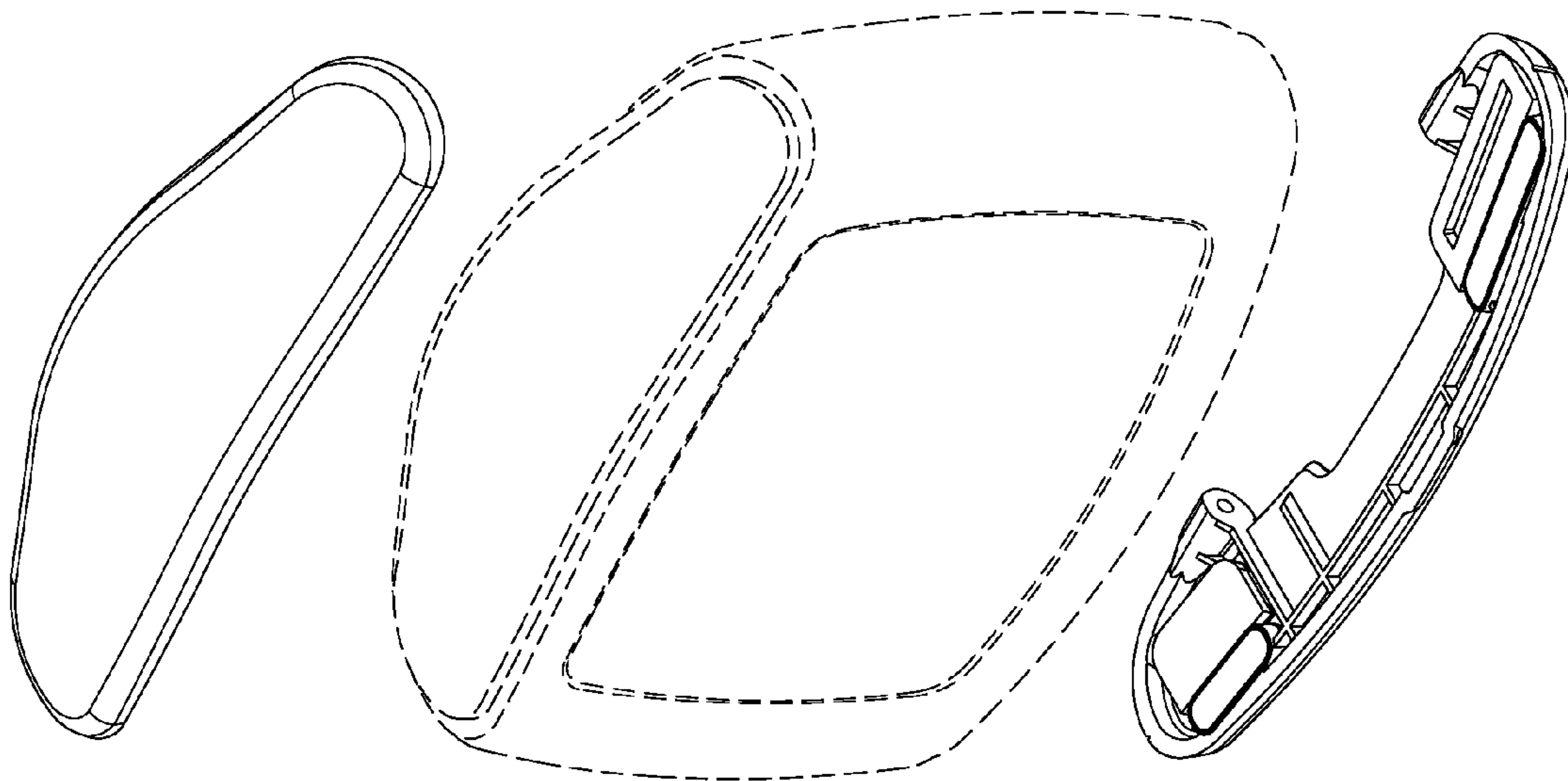

FIG. 1.

FIG. 2.



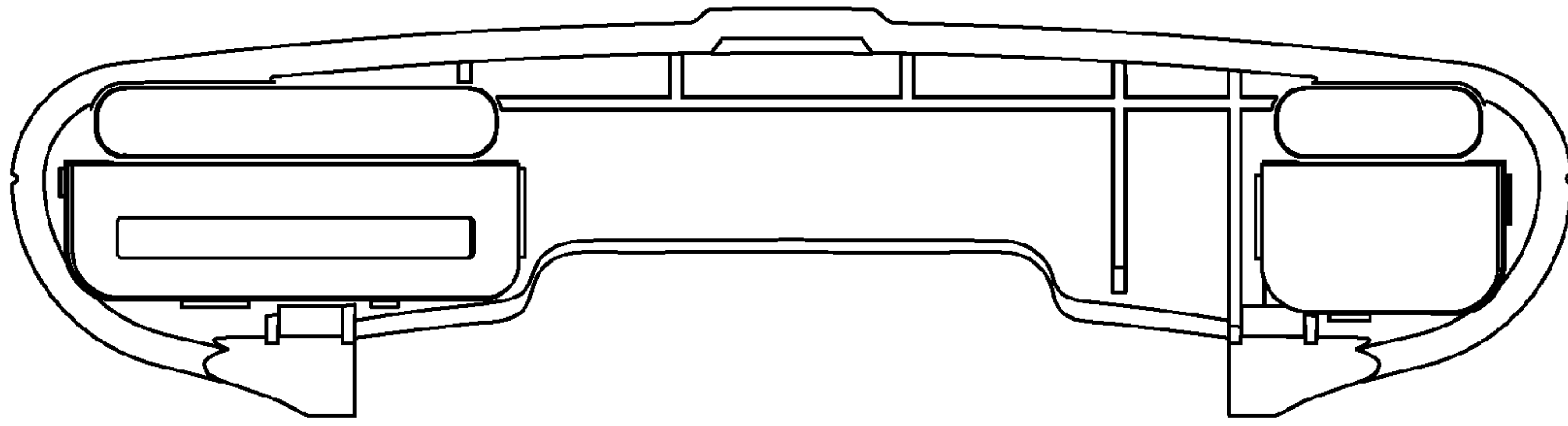

FIG. 3.

FIG. 4.



FIG. 5.

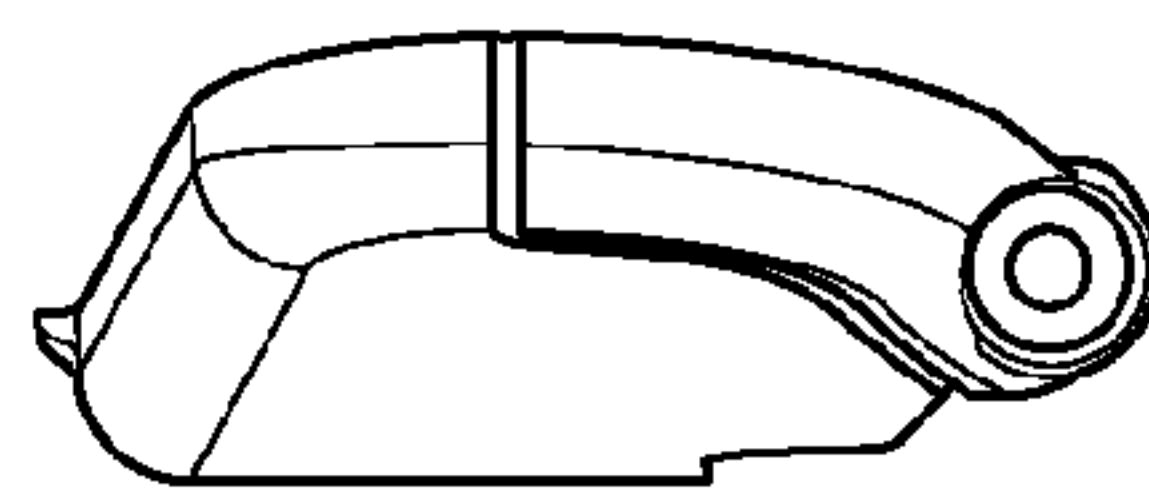

FIG. 6.

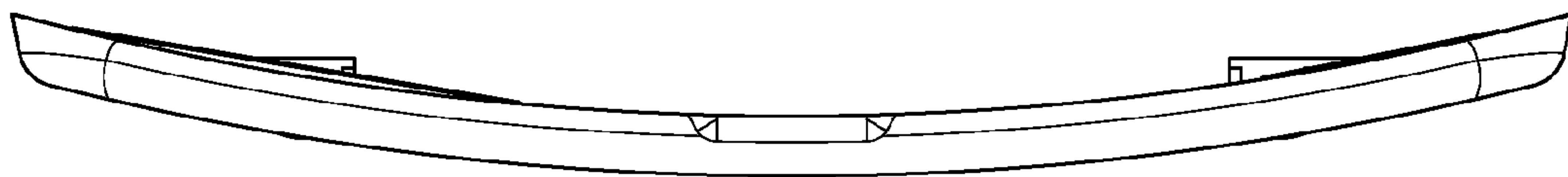
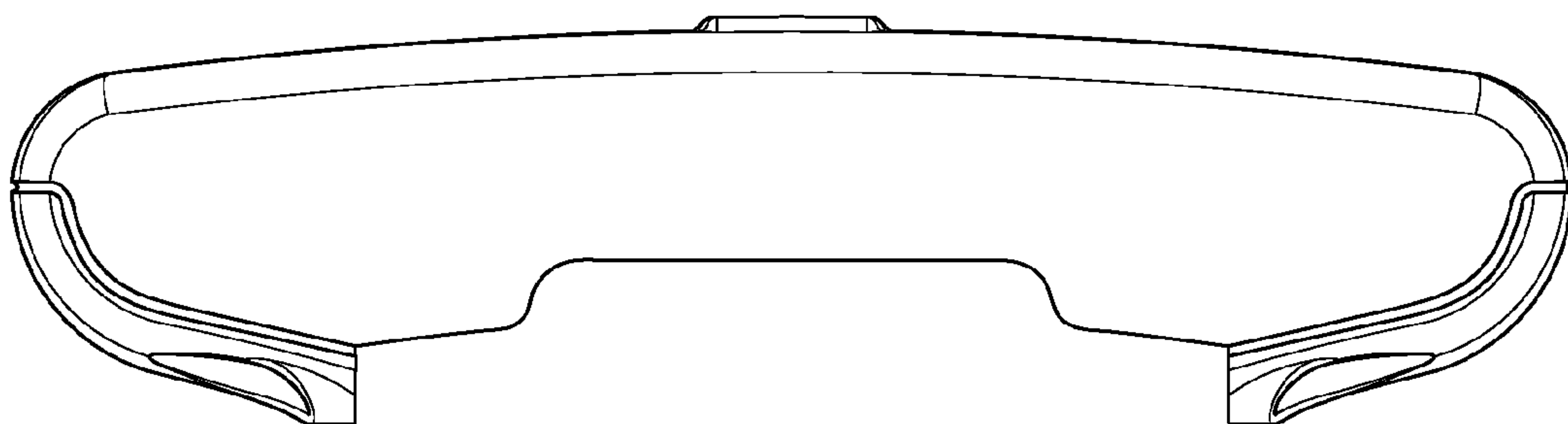

FIG. 7.



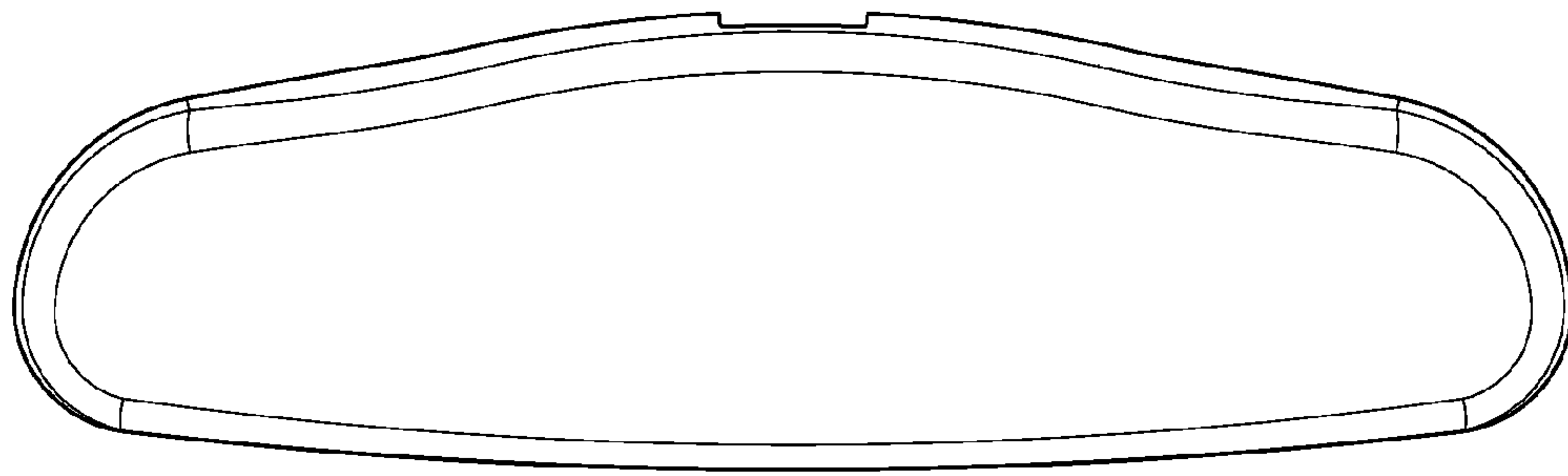

FIG. 8.

FIG. 9.

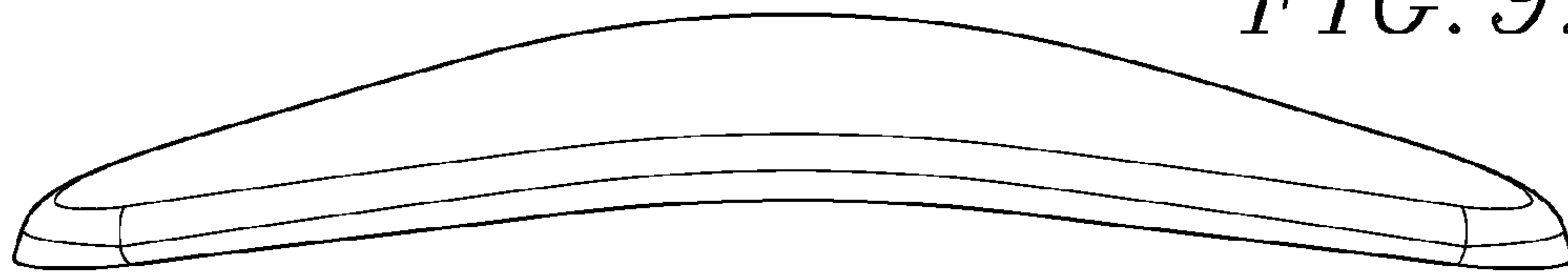

FIG. 10.

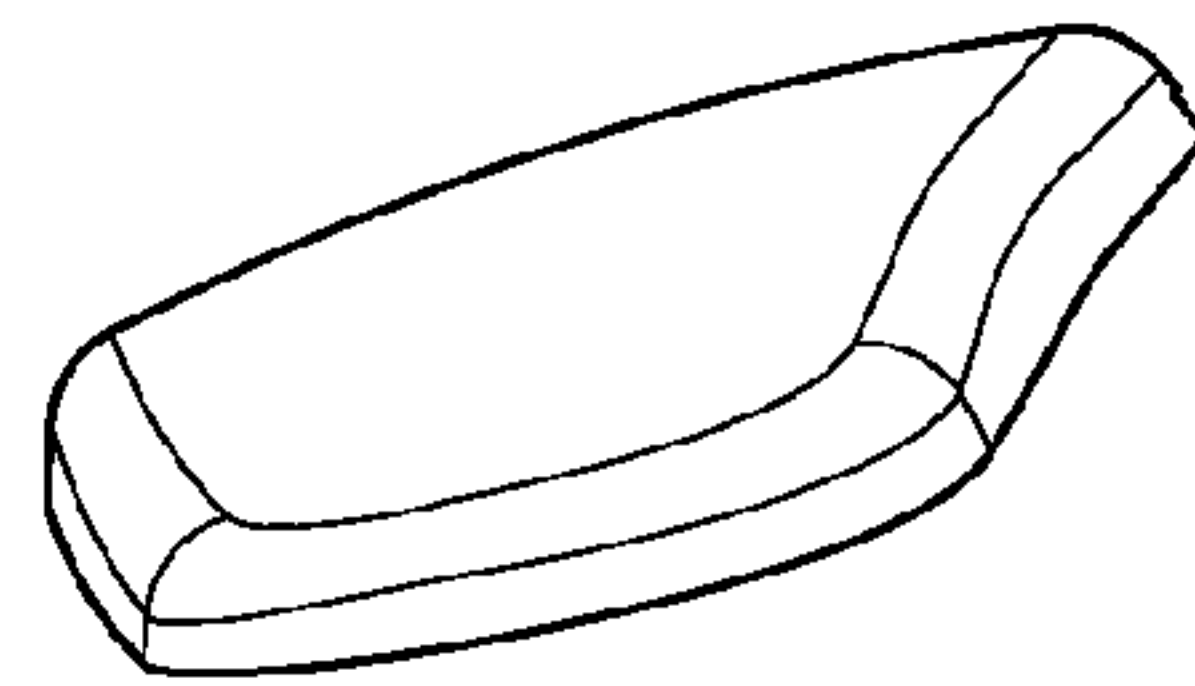

FIG. 11.

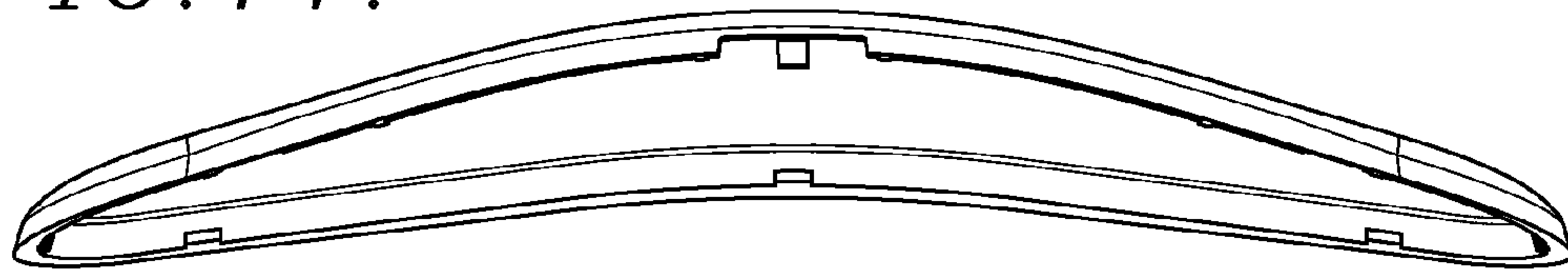
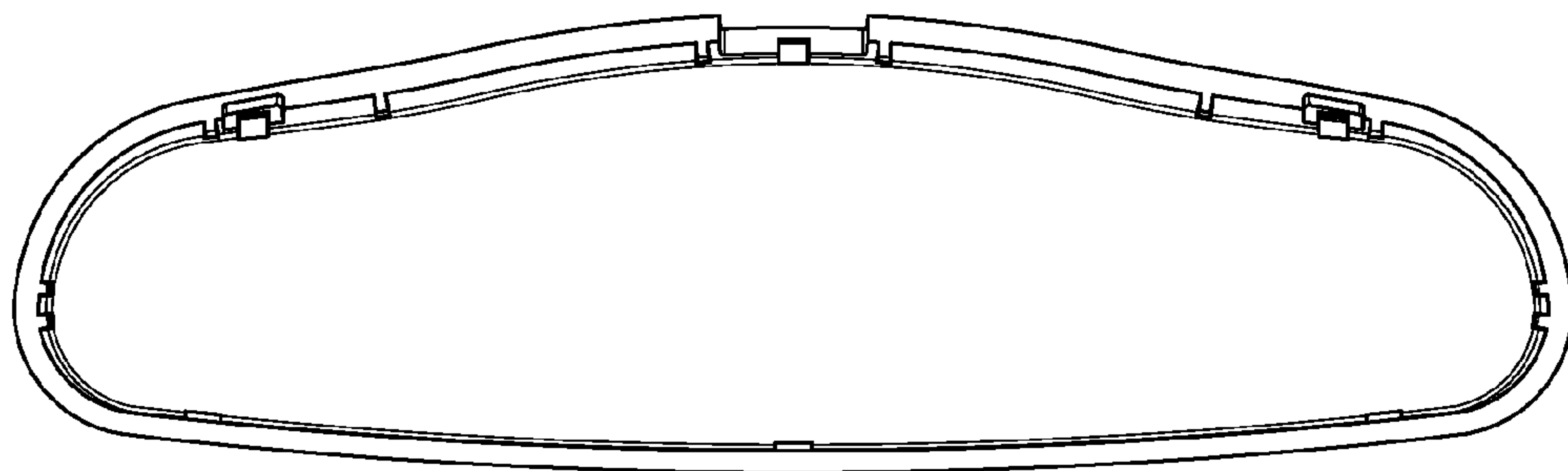

FIG. 12.





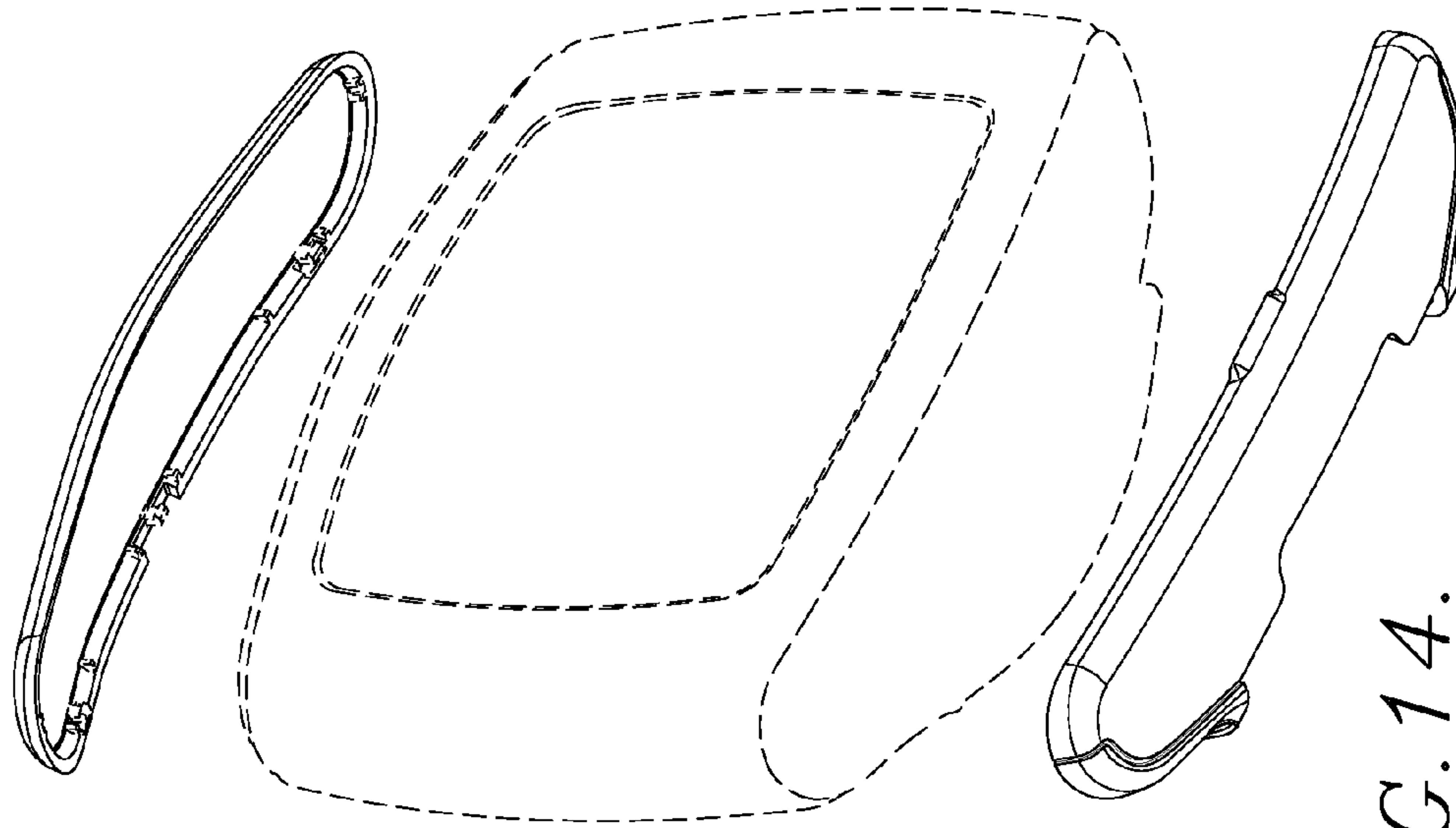
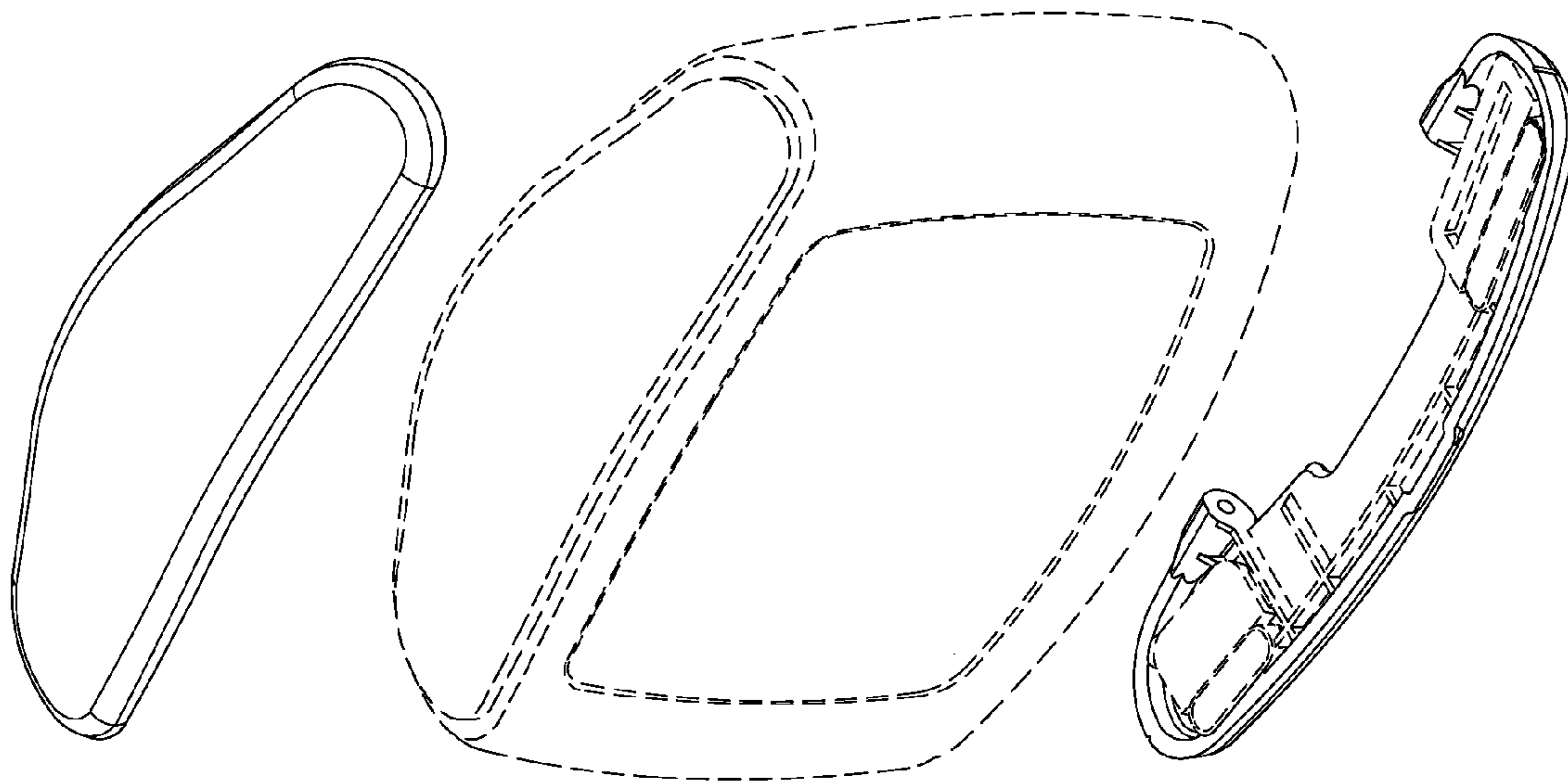

FIG. 13.

FIG. 14.



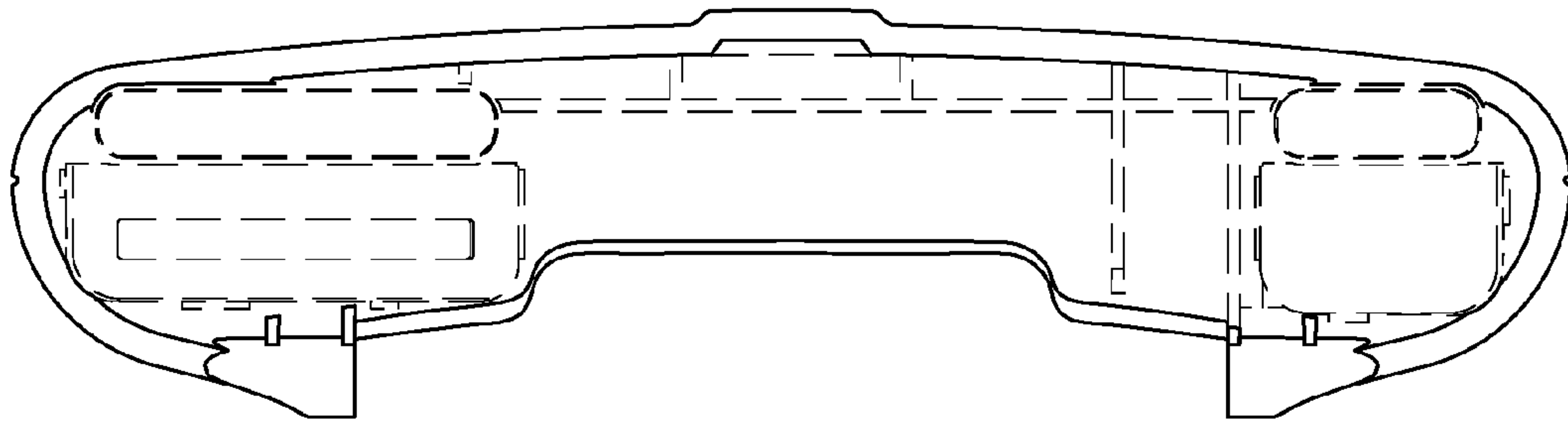

FIG. 15.

FIG. 16.

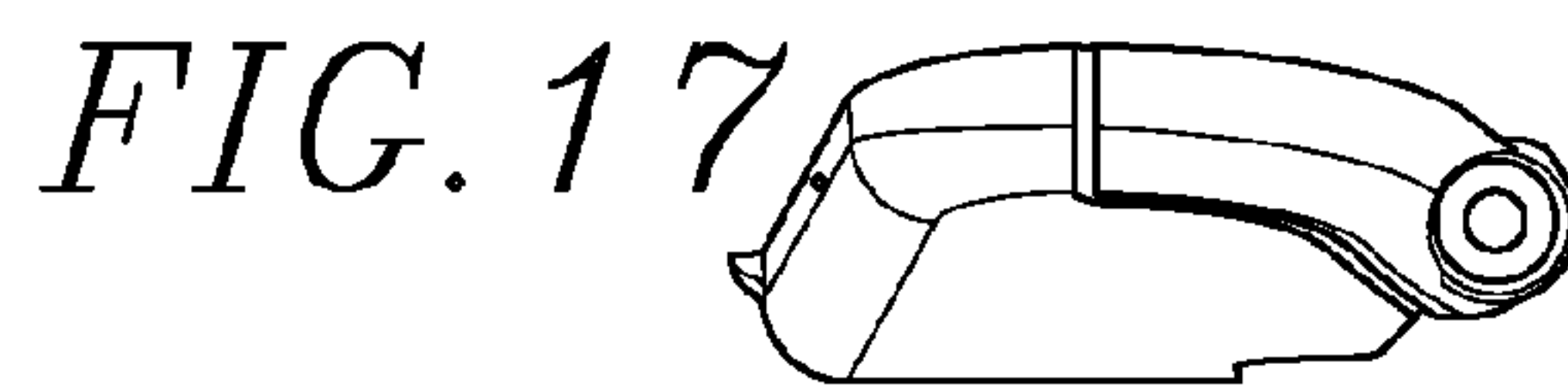
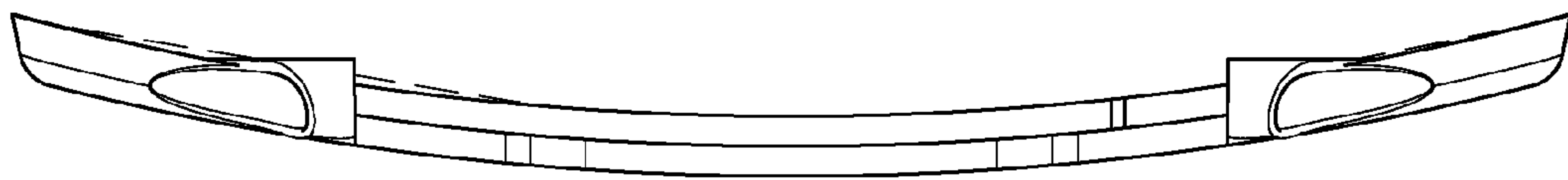

FIG. 17.

FIG. 18.

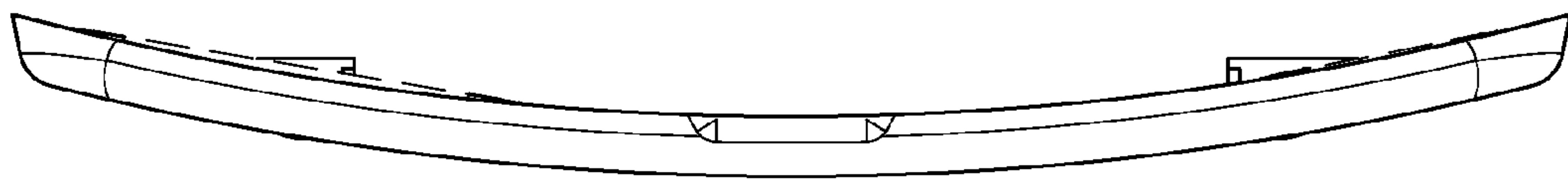
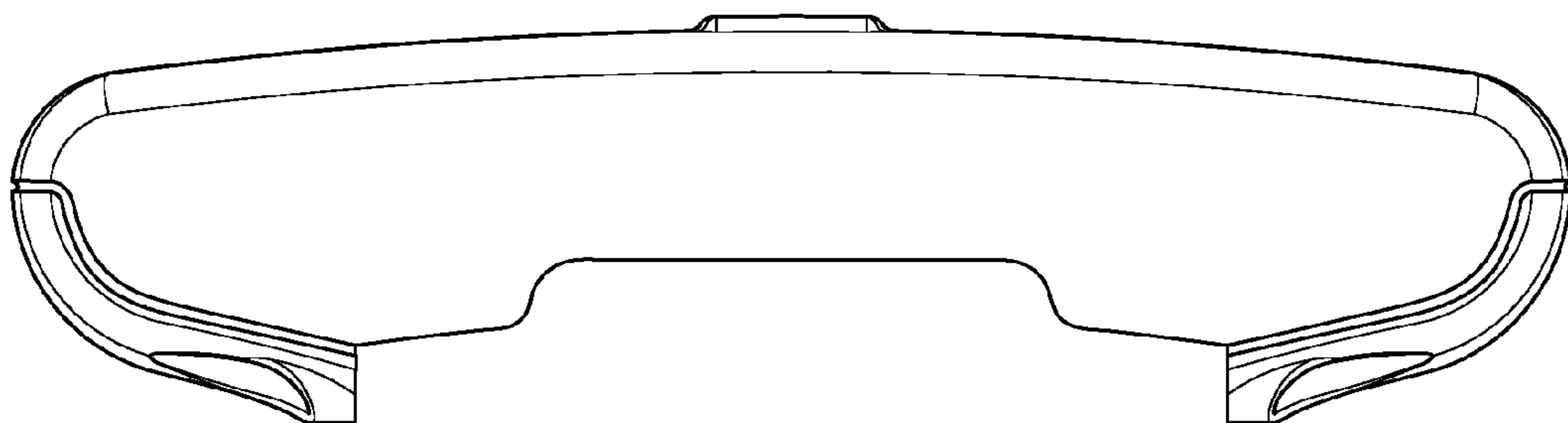

FIG. 19.



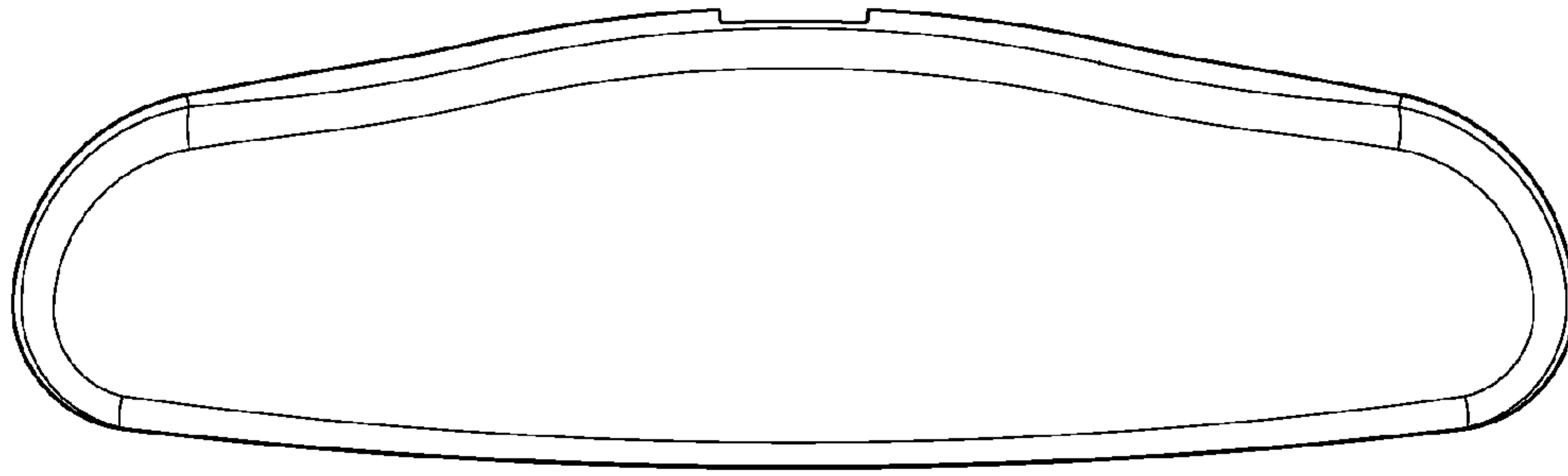

FIG. 20.

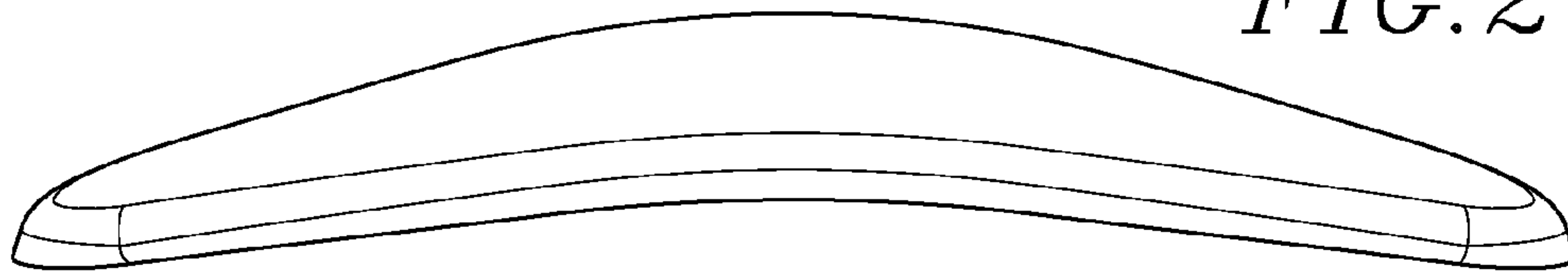

FIG. 21.

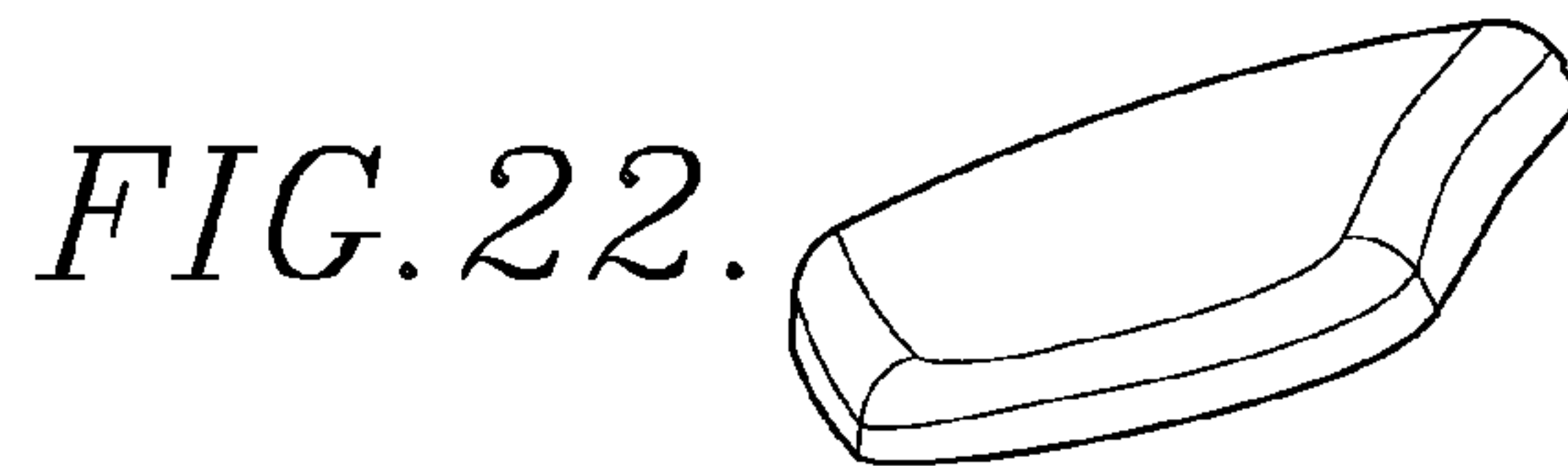

FIG. 22.

FIG. 23.

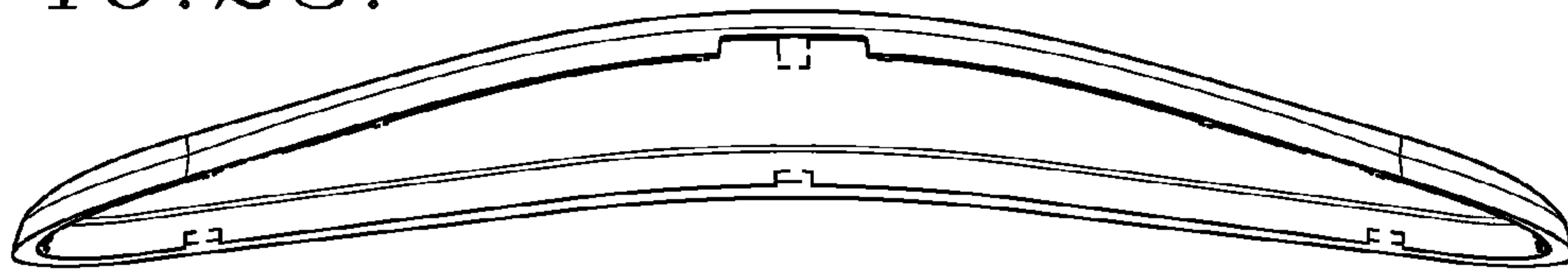

FIG. 24.

