



US00D558554S

(12) **United States Design Patent**
Carbonaro

(10) **Patent No.:** **US D558,554 S**

(45) **Date of Patent:** **** Jan. 1, 2008**

(54) **HANDHELD PACKAGE OPENING APPARATUS**

D515,390 S * 2/2006 Scimone D8/102

* cited by examiner

(76) Inventor: **Greg Carbonaro**, 22523 Willow Lakes Dr., Lutz, FL (US) 33549

Primary Examiner—Philip S. Hyder

(74) *Attorney, Agent, or Firm*—Myron Amer P.C.

(**) Term: **14 Years**

(57) **CLAIM**

(21) Appl. No.: **29/262,574**

The ornamental design for a handheld package opening apparatus, as shown and described.

(22) Filed: **Jul. 7, 2006**

DESCRIPTION

(51) **LOC (8) Cl.** **08-03**

(52) **U.S. Cl.** **D8/98**

(58) **Field of Classification Search** D8/14,
D8/51, 98, 99, 102; 30/287, 289, 294, 299
See application file for complete search history.

FIG. 1 is a perspective view of a handheld package opening apparatus showing my new design, wherein the broken line showing of the hands and package are included for the purpose of illustrating environmental structure and form no part of the claimed design.

FIG. 2 is a front perspective view of said handheld package opening apparatus;

FIG. 3 is a rear perspective view thereof;

FIG. 4 is a front elevational view thereof;

FIG. 5 is a rear elevational view thereof;

FIG. 6 is a top view thereof.

FIG. 7 is a bottom view thereof;

FIG. 8 is a left side elevational view thereof; and,

FIG. 9 is a right side elevational view thereof.

The broken line showings of the arrow and the word logo in FIGS. 1, 2 and 4 form no part of the claimed design.

(56) **References Cited**

U.S. PATENT DOCUMENTS

4,001,934	A *	1/1977	Bell	30/124
4,205,440	A *	6/1980	Morgan	30/287
D312,955	S *	12/1990	Melamed	D8/102
5,127,161	A *	7/1992	Ikeda	30/294
D366,407	S *	1/1996	Kendall et al.	D8/98
5,555,624	A *	9/1996	McCracken	30/2
5,666,731	A *	9/1997	Rungren	30/287
D419,417	S *	1/2000	Kane	D8/98
D423,318	S *	4/2000	Lacy	D8/98
D424,397	S *	5/2000	Wiseman	D8/98
D435,775	S *	1/2001	Rothschild et al.	D8/98
D477,520	S *	7/2003	McCracken	D8/98

1 Claim, 2 Drawing Sheets

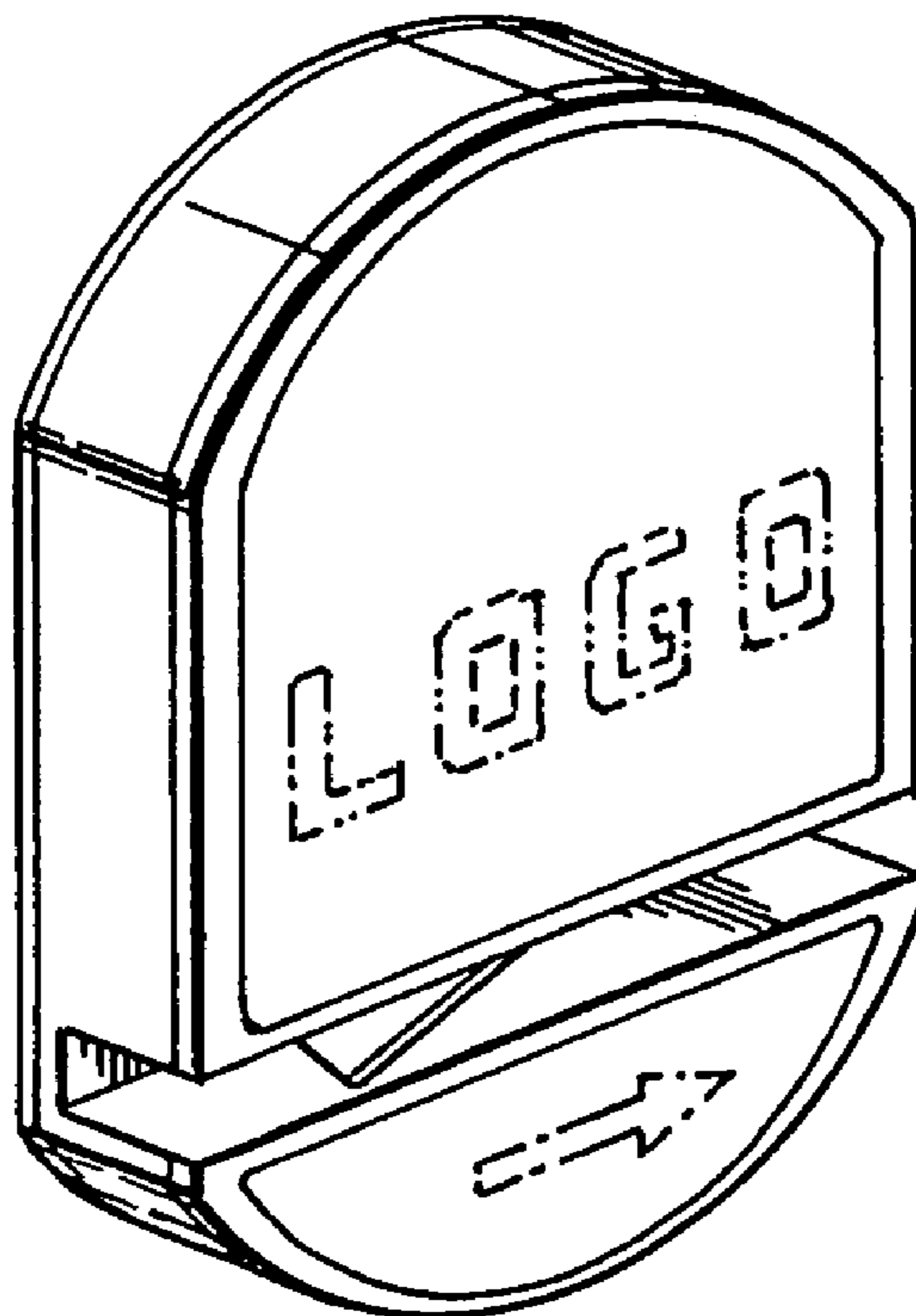

Fig. 1

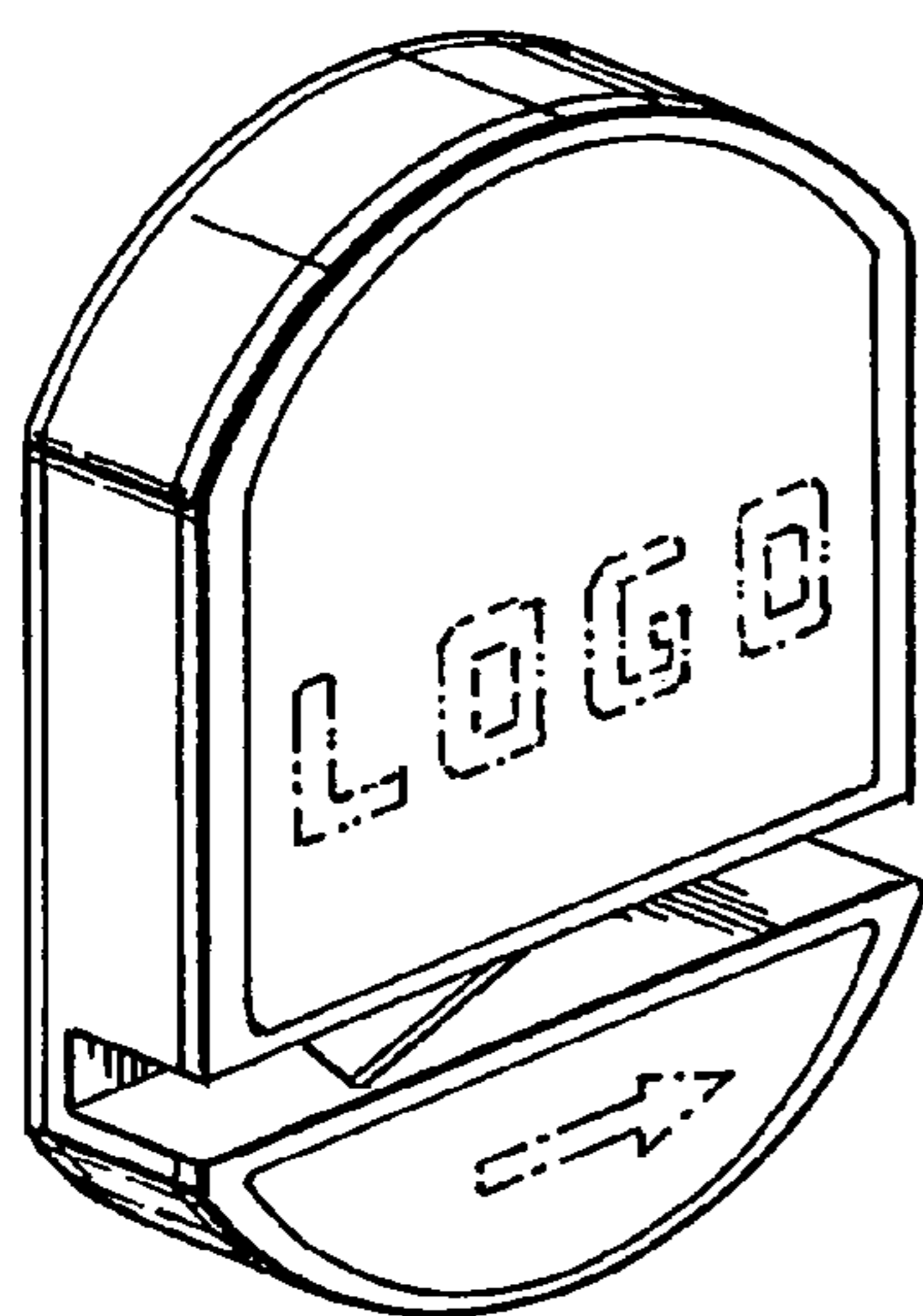
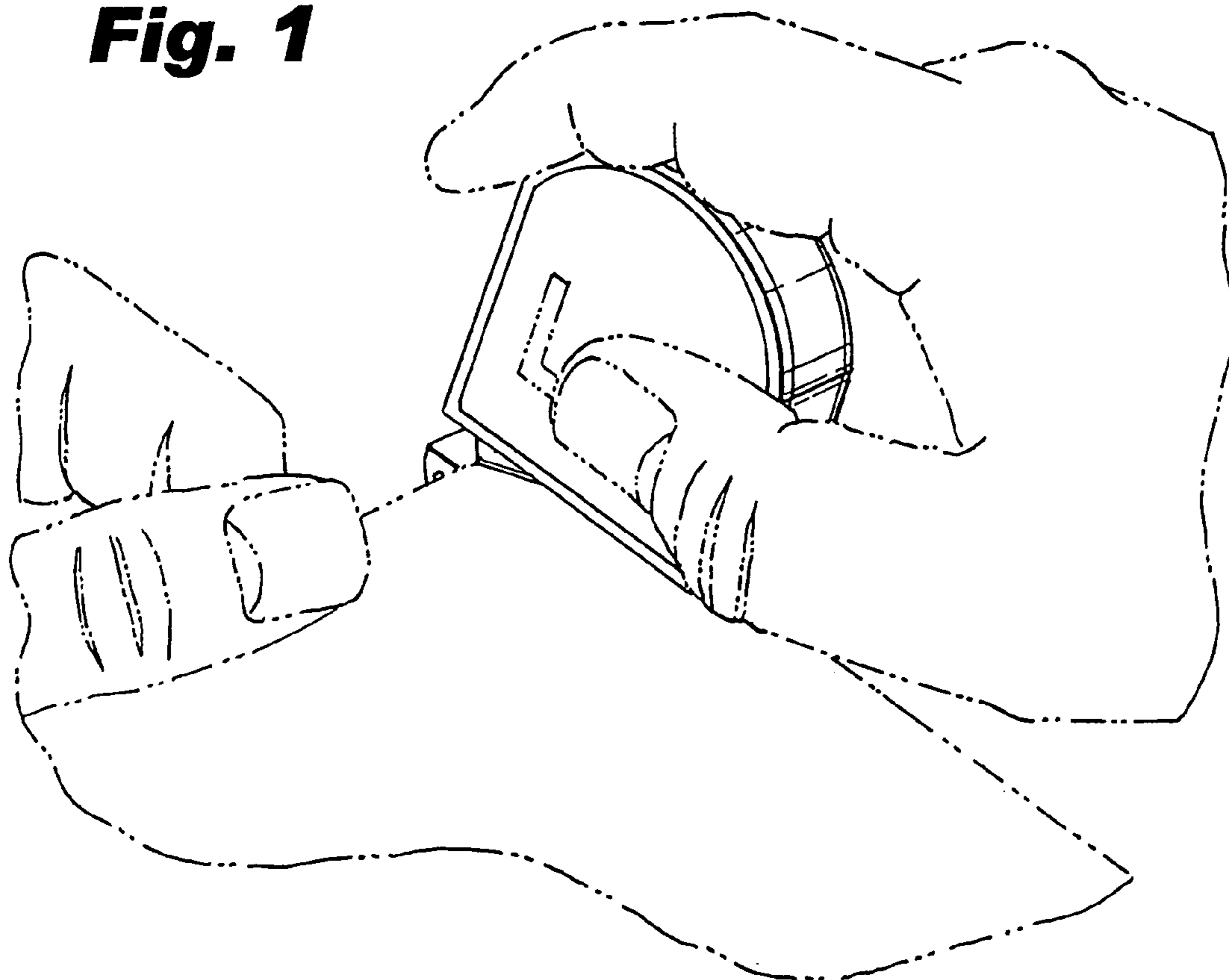

Fig. 2

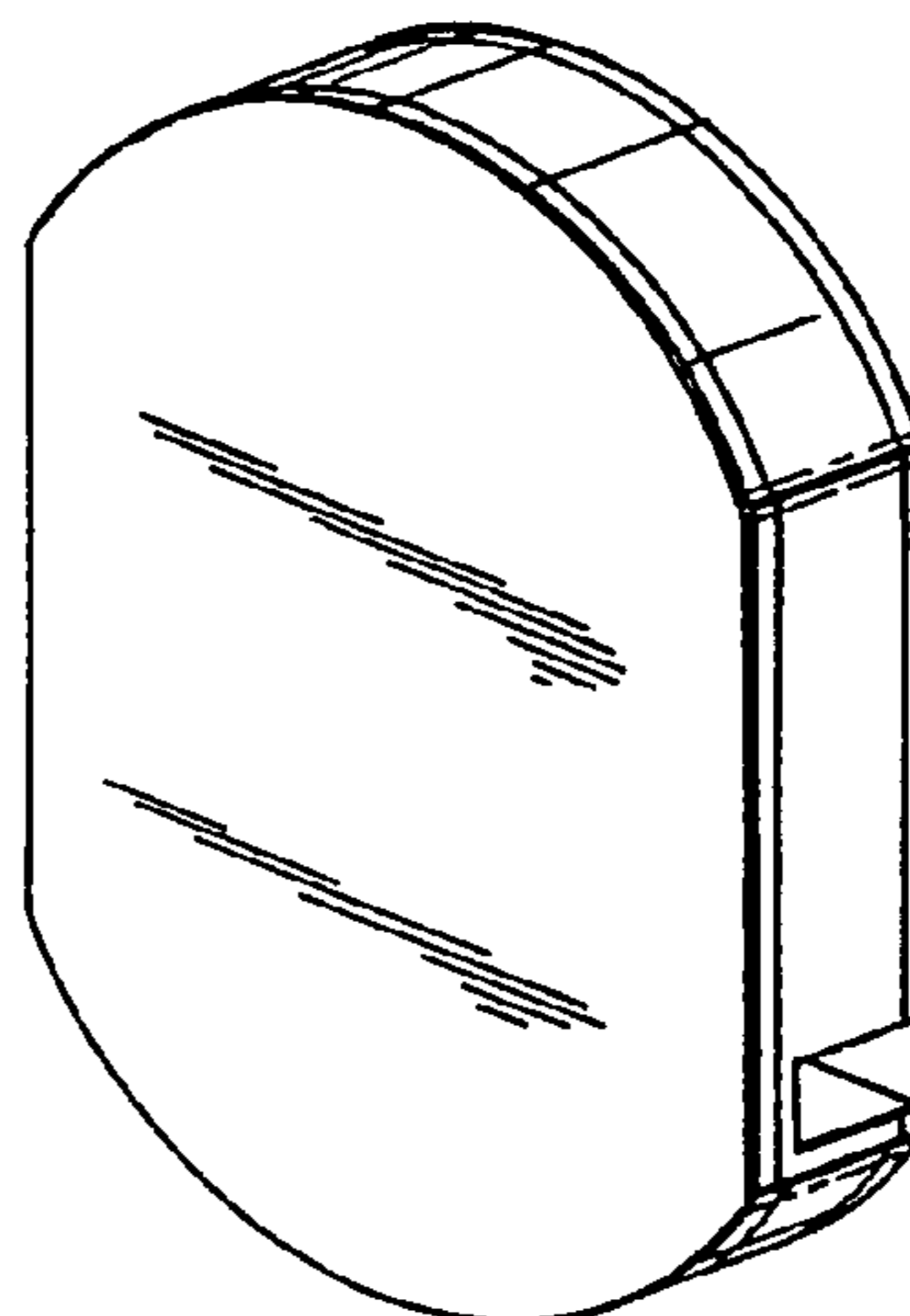

Fig. 3

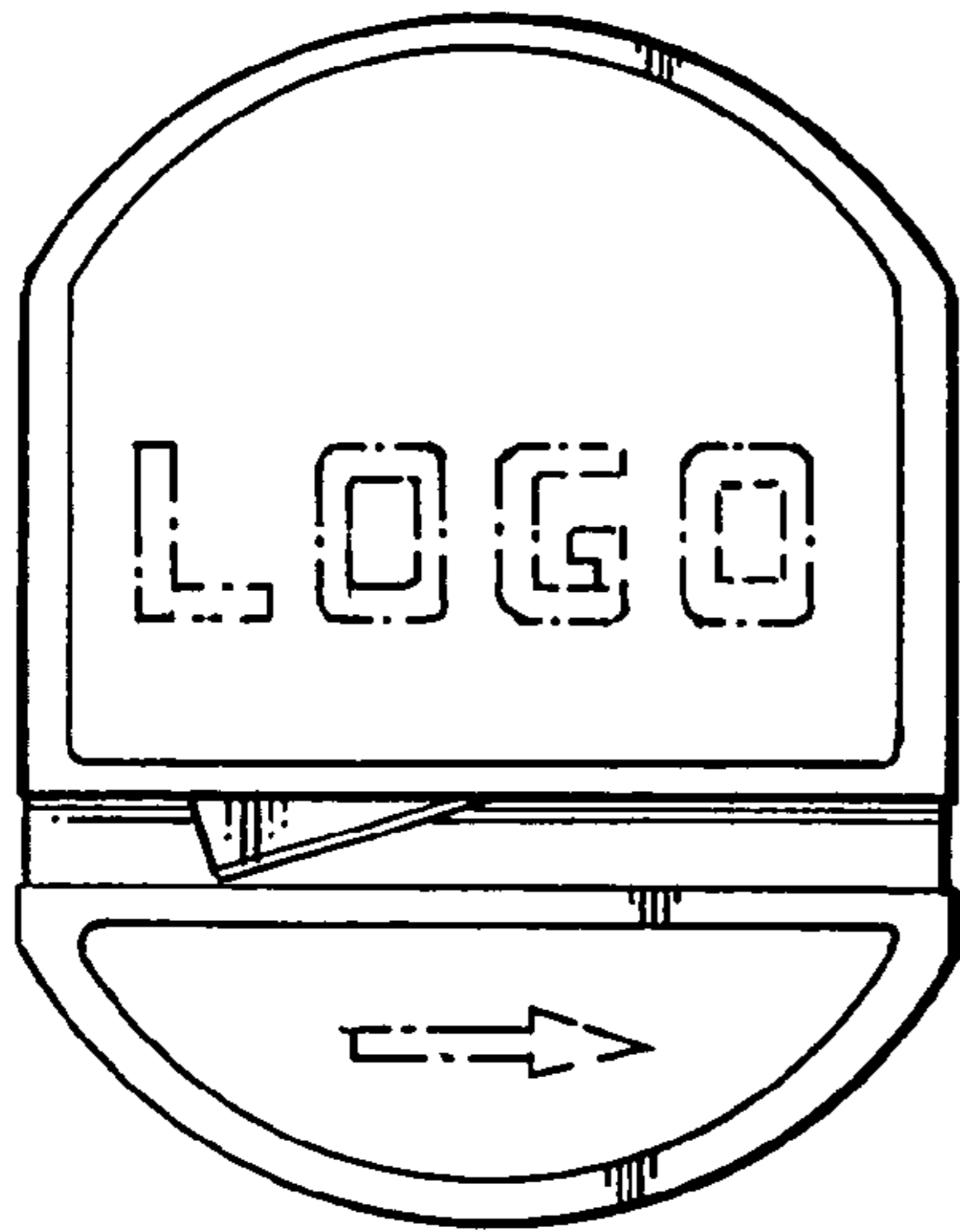

Fig. 4

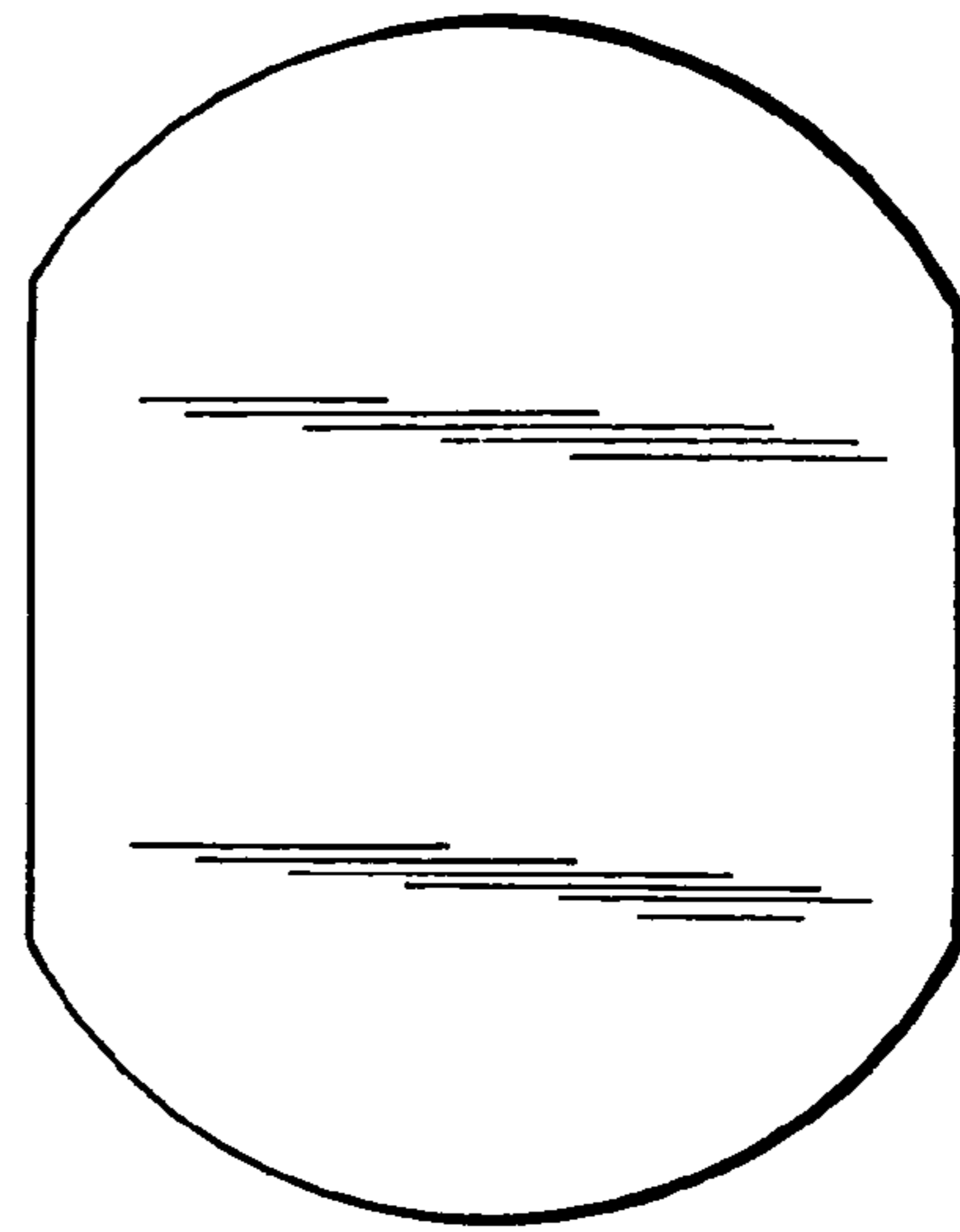

Fig. 5

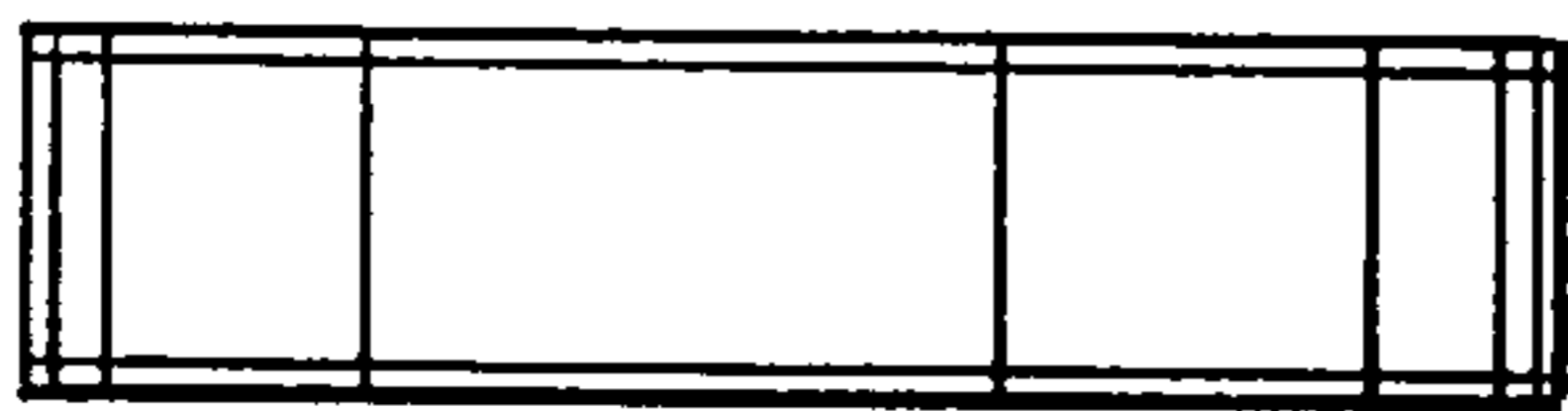

Fig. 6

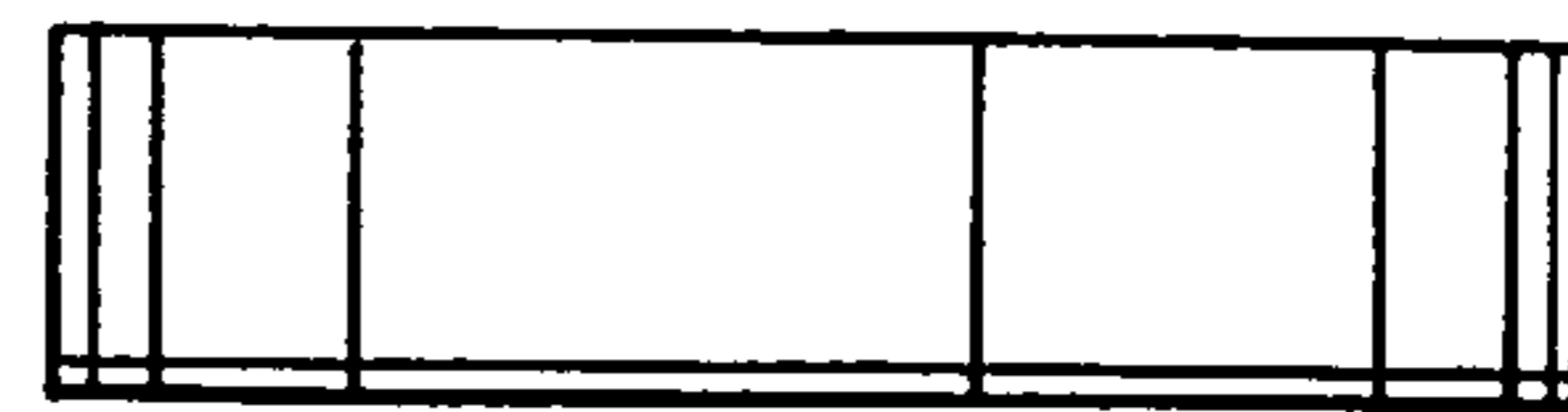

Fig. 7



Fig. 8

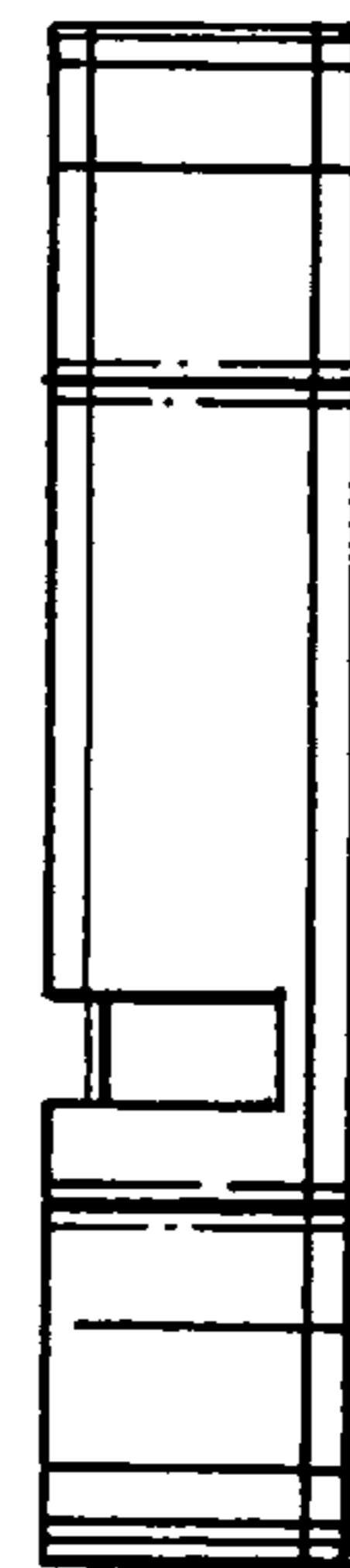

Fig. 9