



US00D558019S

(12) **United States Design Patent** (10) **Patent No.:** **US D558,019 S**
Granberg et al. (45) **Date of Patent:** **** Dec. 25, 2007**

(54) **CHAIN SAW**

(75) Inventors: **Ann Granberg**, Västra Frölunda (SE);
Hans P. Zachau, Göteborg (SE);
Kenneth Karlsson, Hyssna (SE);
Mattias Ossiansson, Huskvarna (SE)

(73) Assignee: **Husqvarna AB**, Huskvarna (SE)

(**) Term: **14 Years**

(21) Appl. No.: **29/277,852**

(22) Filed: **Mar. 12, 2007**

Related U.S. Application Data

(63) Continuation of application No. 29/208,851, filed on Jul. 7, 2004.

(51) **LOC (8) Cl.** **08-03**

(52) **U.S. Cl.** **D8/65**

(58) **Field of Classification Search** D8/7,
D8/8, 9, 68, 70, 65, 66, 67, 62, 63, 64, 61;
30/386, 383, 382, 371, 123; 125/21
See application file for complete search history.

(56) **References Cited**

U.S. PATENT DOCUMENTS

D176,963 S	2/1956	Mall	
D233,075 S	10/1974	Tuggle	
4,534,005 A	8/1985	Nagashima et al.	
4,602,656 A *	7/1986	Nagashima et al. 137/590
4,630,372 A	12/1986	Nagashima	
4,654,970 A	4/1987	Nagashima	
4,662,071 A	5/1987	Hoppner et al.	
H000378 H	12/1987	Matsumoto	
4,819,332 A	4/1989	Sugihara et al.	
D320,728 S	10/1991	Arvidsson	
5,070,618 A	12/1991	Edlund	
D348,192 S *	6/1994	Griffin D8/65
D361,251 S	8/1995	Griffin	

D364,326 S	11/1995	Lohse et al.	
5,485,814 A	1/1996	Tuggle et al.	
D377,441 S *	1/1997	Hoppner et al. D8/65
D381,249 S *	7/1997	Hubbe D8/65
5,666,734 A	9/1997	Morrison	
D386,958 S	12/1997	Karlsson et al.	
D412,652 S	8/1999	Durr et al.	
5,992,025 A	11/1999	Fricke	
6,016,604 A	1/2000	Wolf et al.	
6,637,117 B2	10/2003	Kobayashi	
6,842,987 B1	1/2005	Martinsson et al.	
6,944,957 B2	9/2005	Donnerdal et al.	
2002/0073558 A1	6/2002	Tajima et al.	
2003/0051351 A1	3/2003	Buchholtz et al.	
2004/0016133 A1	1/2004	Gorenflo et al.	
2004/0103857 A1	6/2004	Kruse	

* cited by examiner

Primary Examiner—Cathron C. Brooks

Assistant Examiner—Austin Murphy

(74) *Attorney, Agent, or Firm*—Pearne & Gordon LLP

(57) **CLAIM**

The ornamental design for a chain saw, as shown and described.

DESCRIPTION

FIG. 1 is a perspective view of my new design for a chain saw;

FIG. 2 is a rear view thereof;

FIG. 3 is a front view of FIG. 1;

FIG. 4 is a right side view of FIG. 1;

FIG. 5 is a left side view of FIG. 1;

FIG. 6 is a top view of FIG. 1; and,

FIG. 7 is a bottom view of FIG. 1.

The broken lines shown in the drawings form no part of the claimed design.

1 Claim, 7 Drawing Sheets

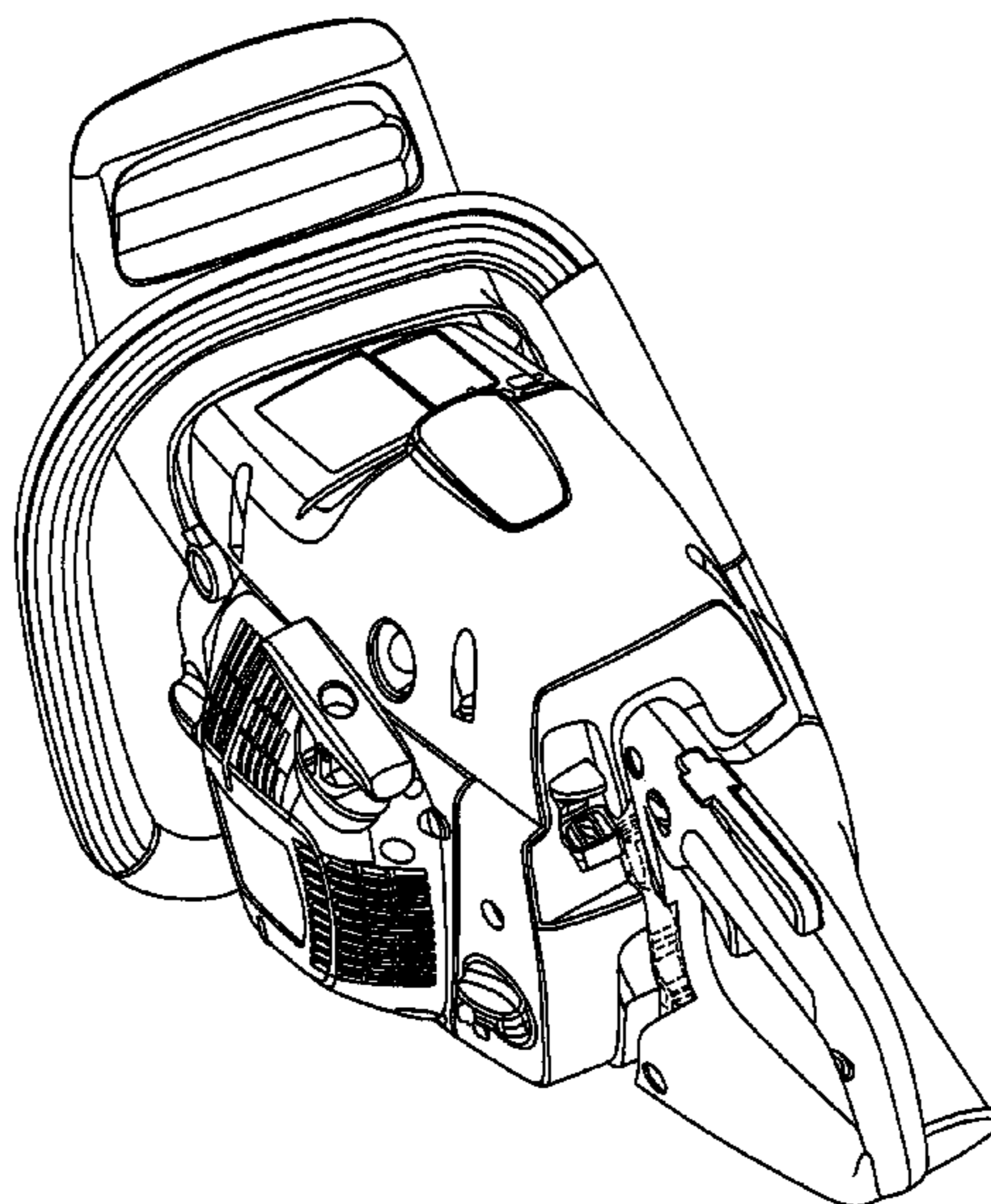

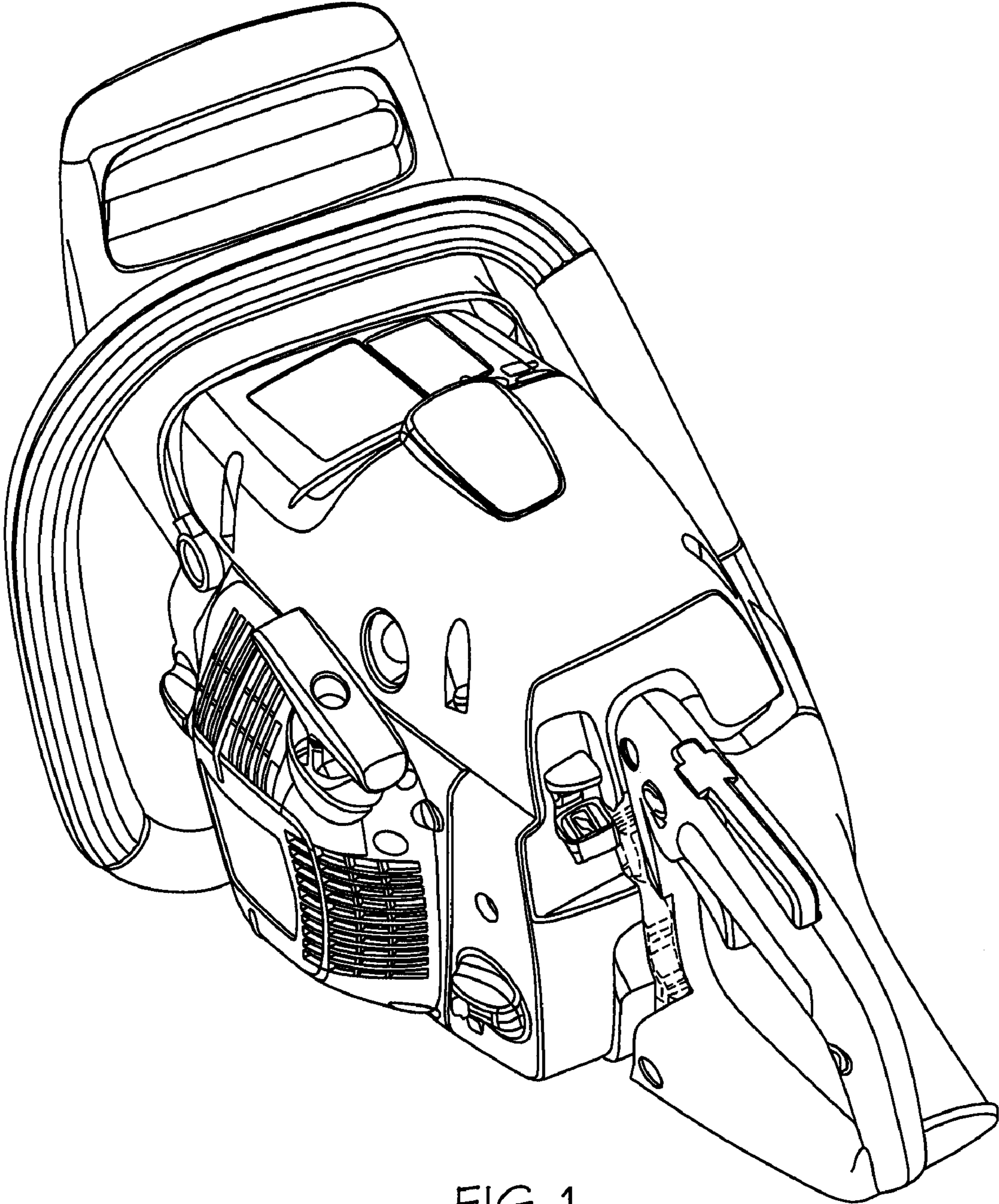

FIG. 1

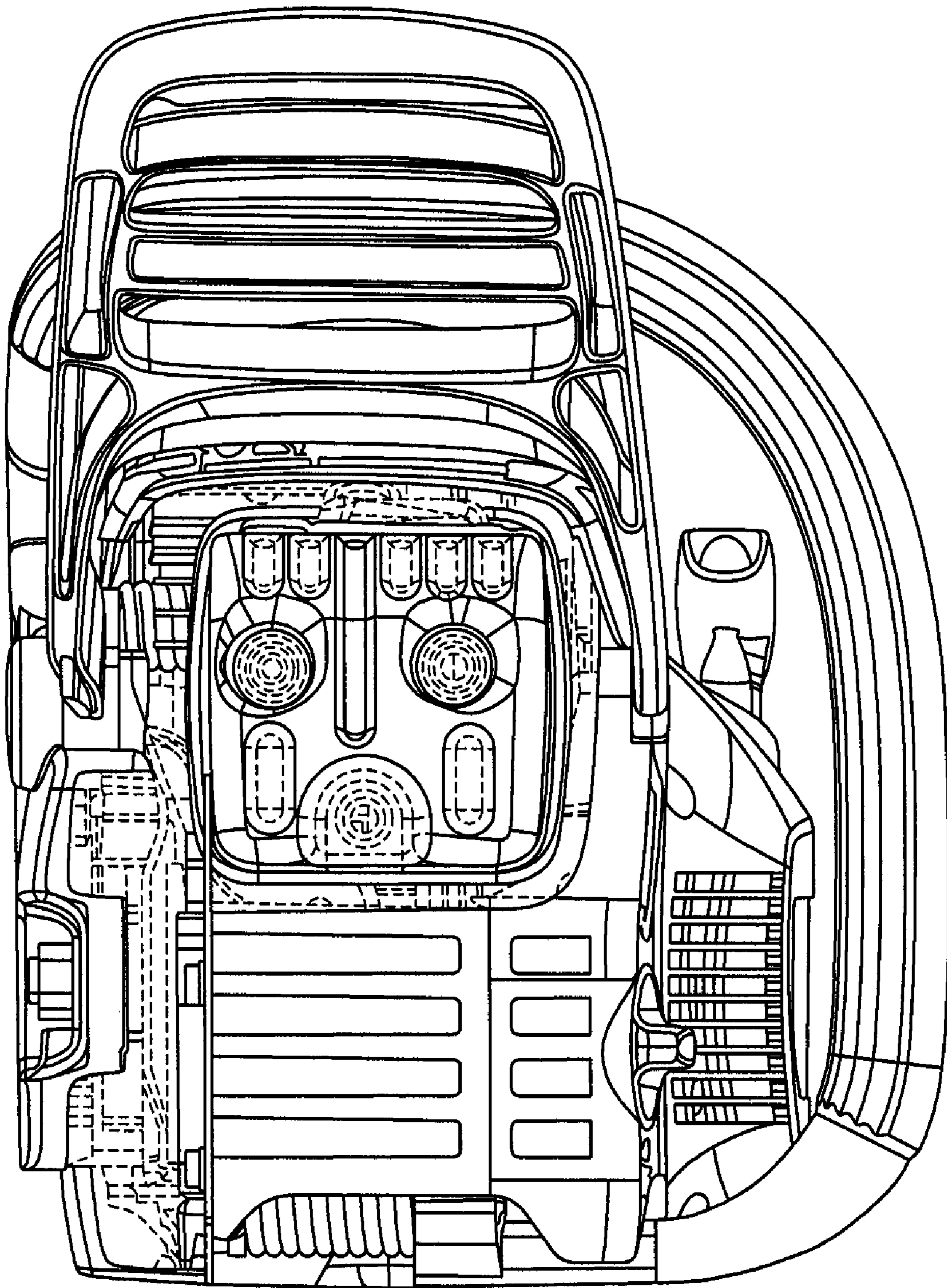

FIG. 2

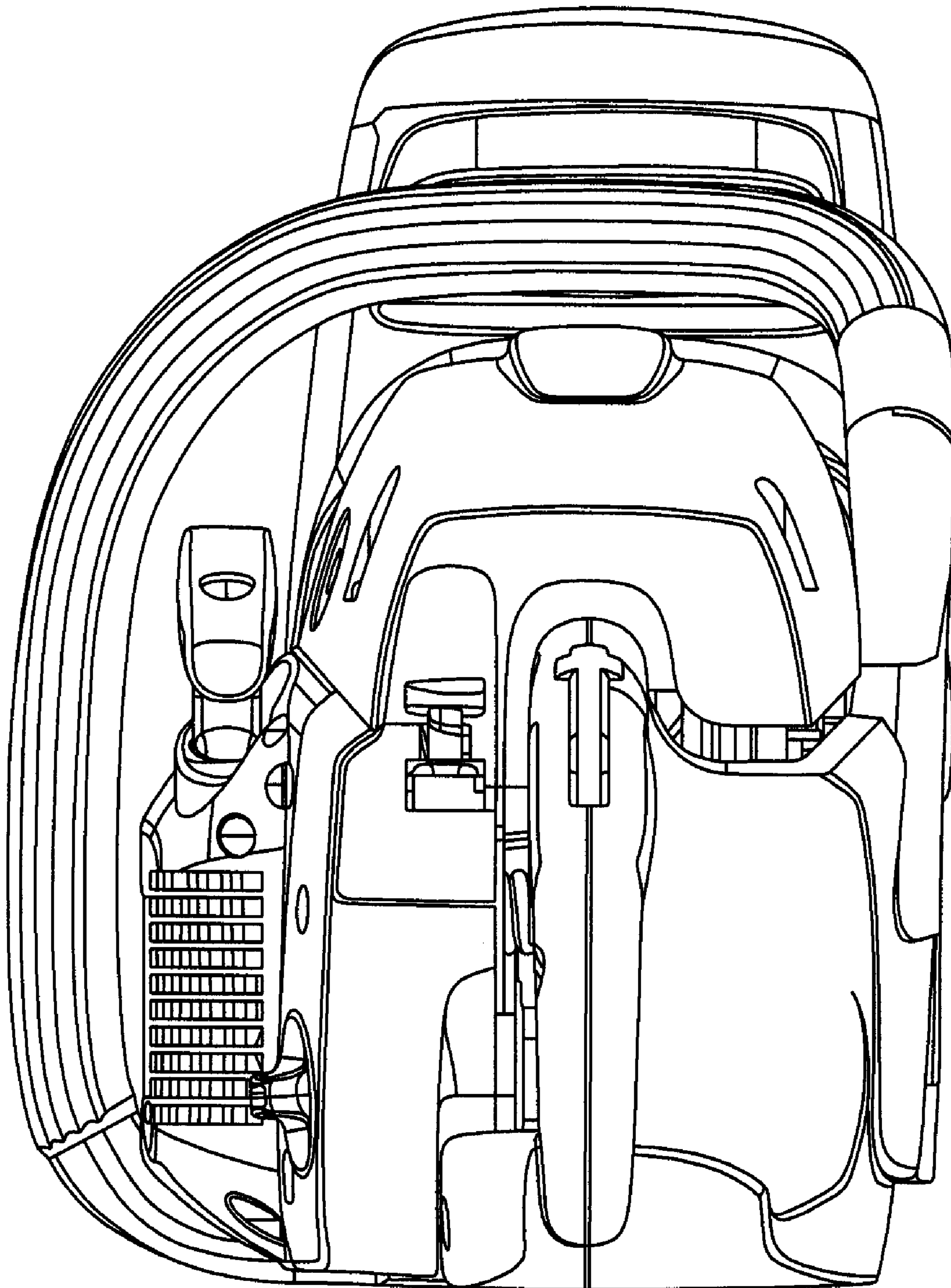

FIG. 3

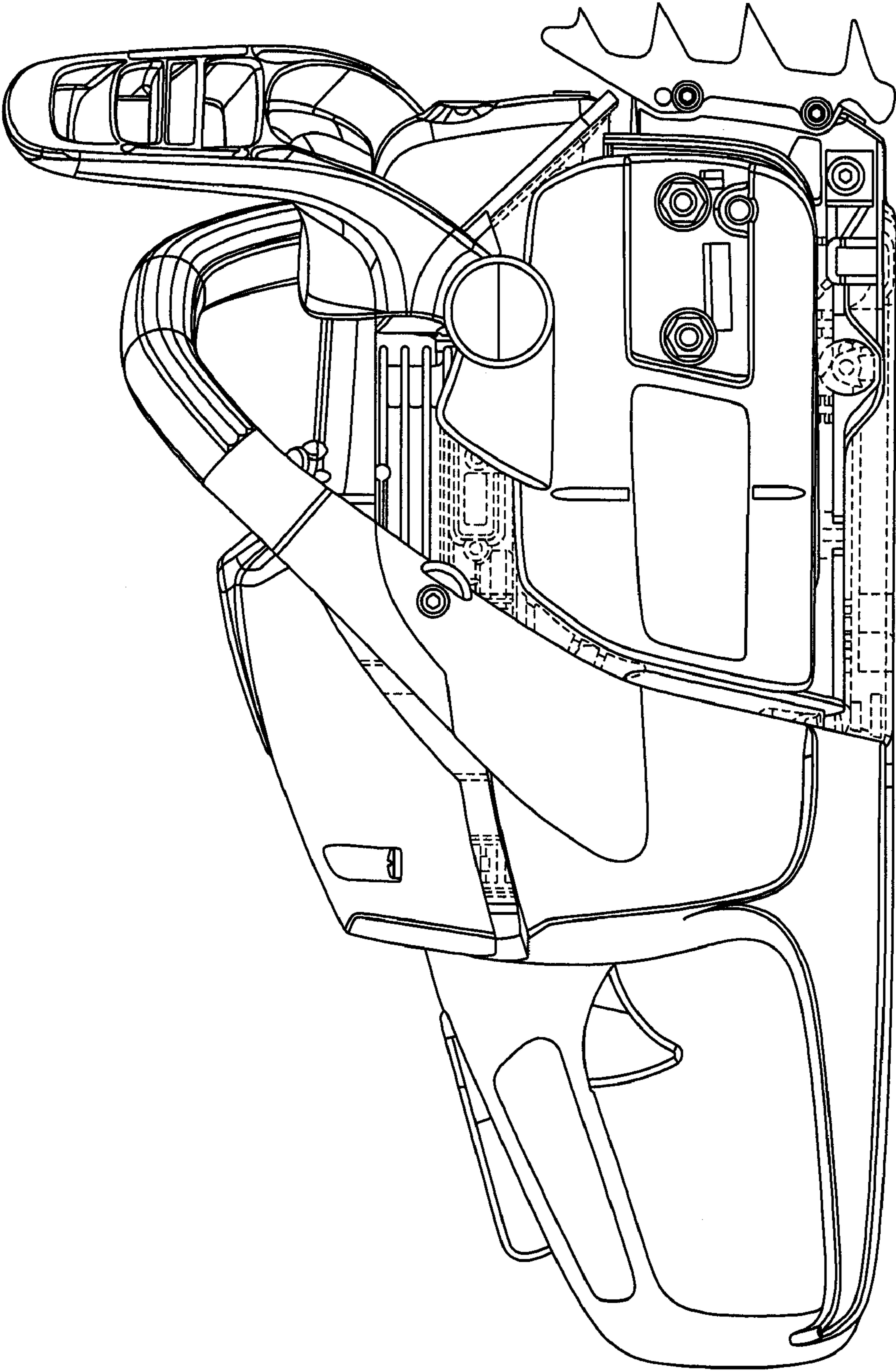

FIG. 4

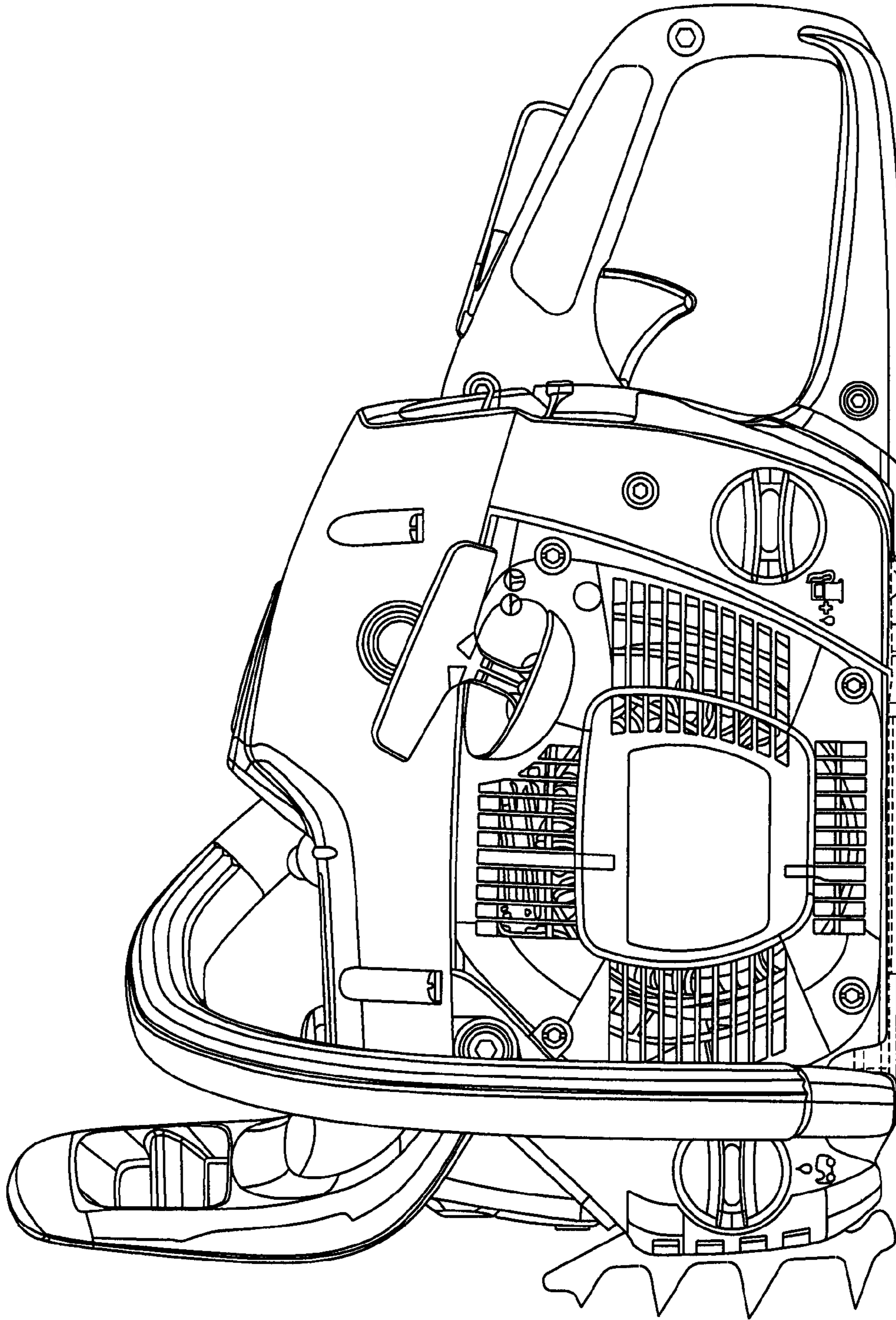

FIG. 5

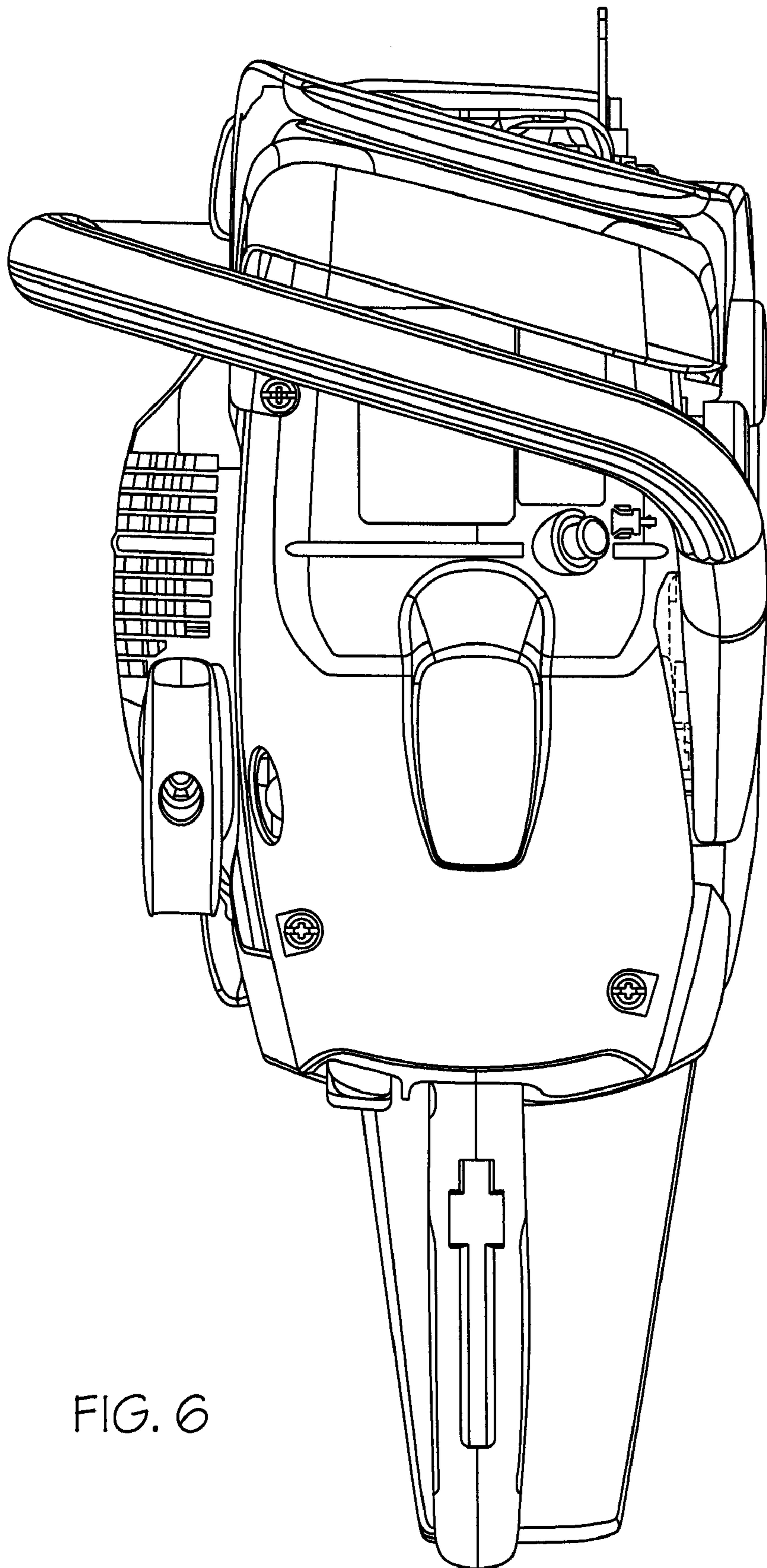

FIG. 6

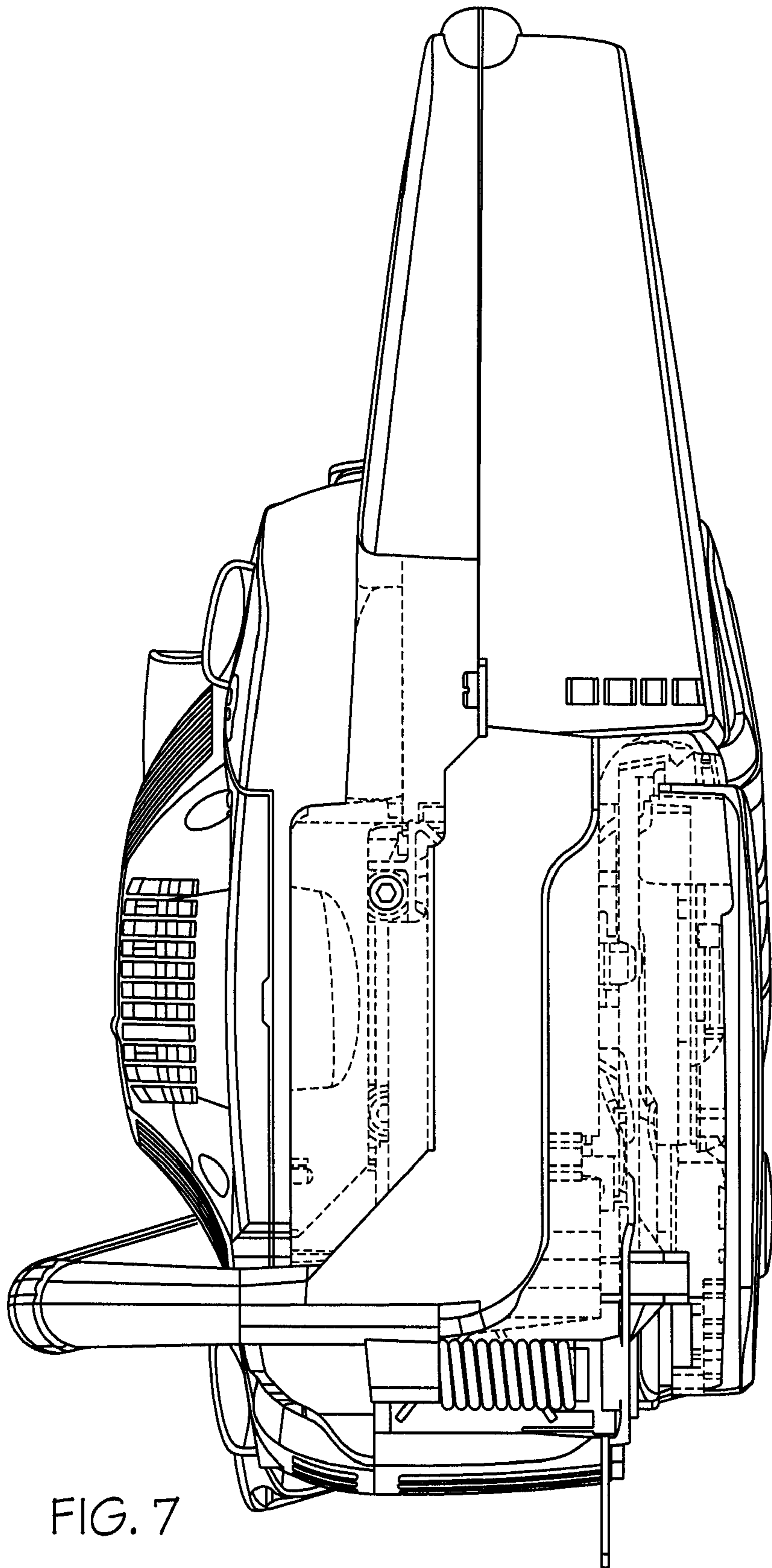

FIG. 7