



US00D554415S

(12) **United States Design Patent**
Sheppard

(10) **Patent No.:** **US D554,415 S**

(45) **Date of Patent:** **** Nov. 6, 2007**

(54) **CABINET**

D545,103 S * 6/2007 Shapiro et al. D6/559

(75) Inventor: **Peter Ralph Sheppard**, London (GB)

* cited by examiner

(73) Assignee: **Smallbone USA, Inc.**, New York, NY (US)

Primary Examiner—Brian N Vinson
(74) *Attorney, Agent, or Firm*—Alston & Bird LLP

(**) Term: **14 Years**

(57) **CLAIM**

(21) Appl. No.: **29/247,985**

The ornamental design for a cabinet, as shown and described.

(22) Filed: **Jul. 24, 2006**

(30) **Foreign Application Priority Data**

Jan. 31, 2006 (GB) 3023810

(51) **LOC (8) Cl.** **06-04**

(52) **U.S. Cl.** **D6/561**

(58) **Field of Classification Search** D6/553,
D6/559, 560–561, 432, 509, 445–446, 448,
D6/491, 494, 441; 312/209, 234, 224–225,
312/242, 245; 206/320, 823

See application file for complete search history.

(56) **References Cited**

U.S. PATENT DOCUMENTS

- D405,225 S * 2/1999 Vicale D6/441
- D435,741 S * 1/2001 Schlereth D6/446
- D472,070 S * 3/2003 de Carolis D6/441
- D513,907 S * 1/2006 O'Hare D6/470
- D528,223 S * 9/2006 Jansson D6/441
- D544,277 S * 6/2007 Hoyvik D6/559

DESCRIPTION

FIG. 1 is a perspective view of a cabinet according to an embodiment of the present invention;

FIG. 2 is a front plan view of the cabinet shown in FIG. 1;

FIG. 3 is a top plan view of the cabinet shown in FIG. 1; and

FIG. 4 is a top cross-sectional view of the cabinet shown in FIG. 1 taken along line 4—4, wherein the doors are in a closed position;

FIG. 5 is a top cross-sectional view of the cabinet shown in FIG. 1 taken along line 4—4, wherein the doors are in an opened position; and,

FIG. 6 is a right side plan view of the cabinet shown in FIG. 1, the left side plan view is a mirror image of the right side plan view.

The broken lines shown herein form no part of the claimed design.

1 Claim, 4 Drawing Sheets

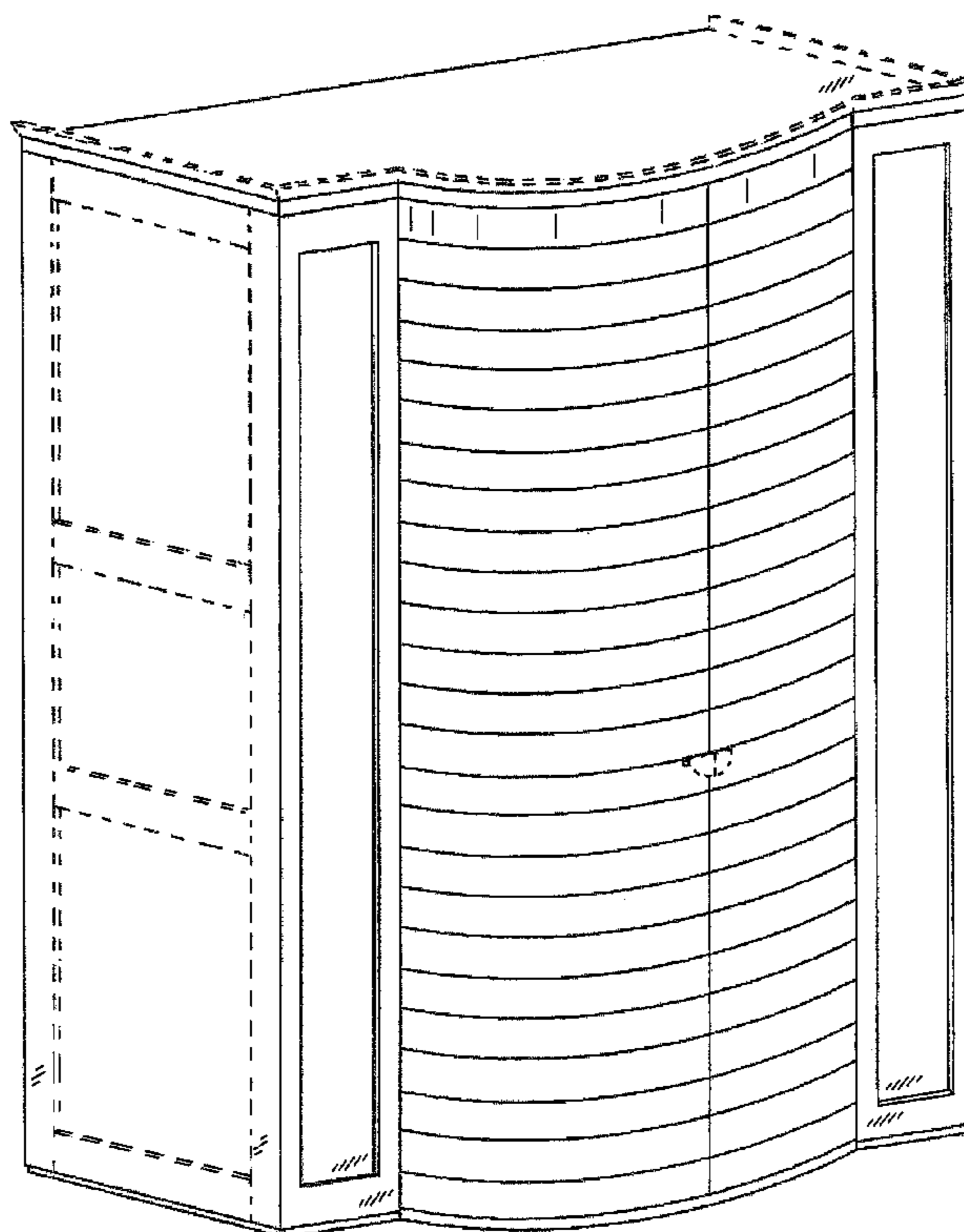

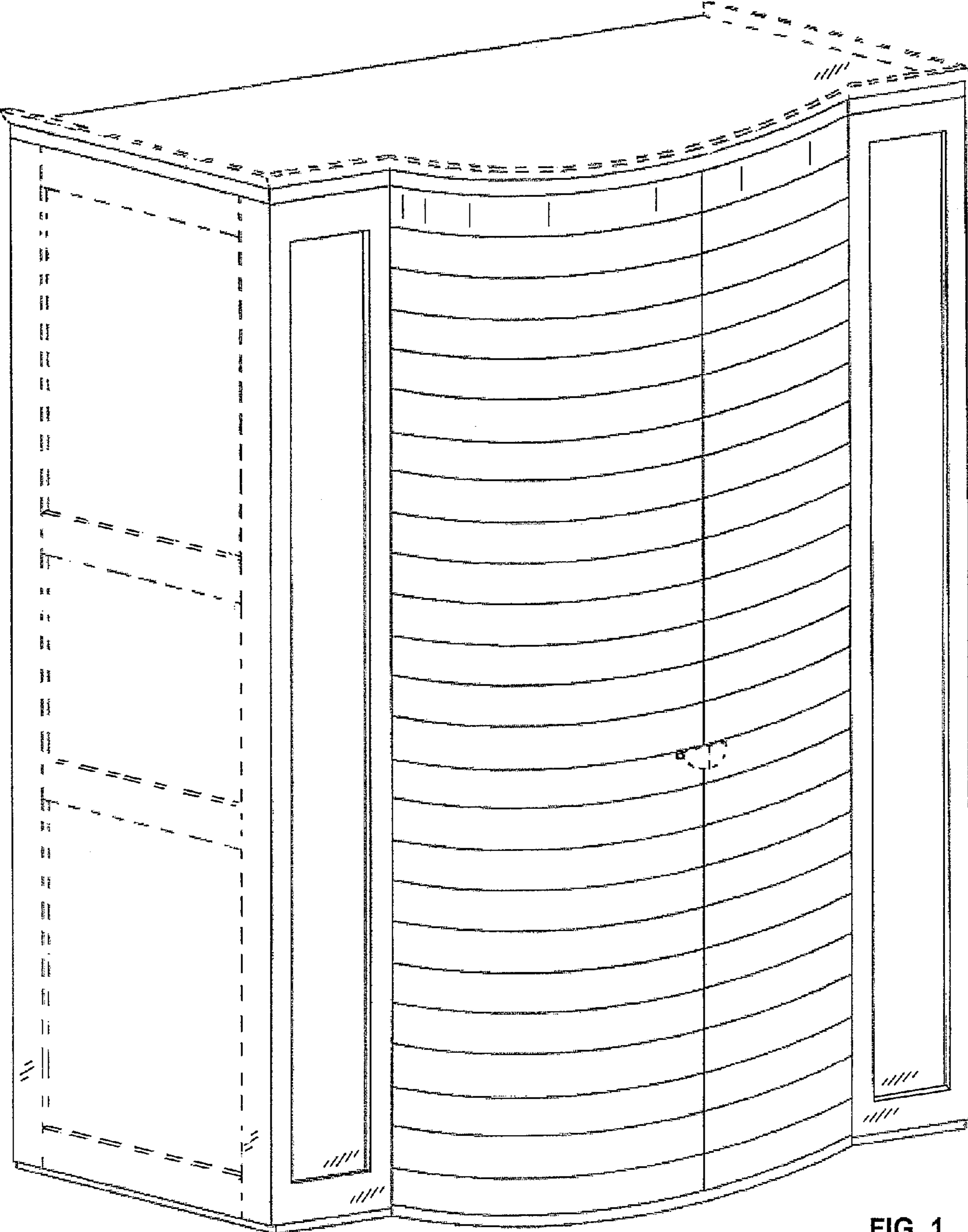

FIG. 1

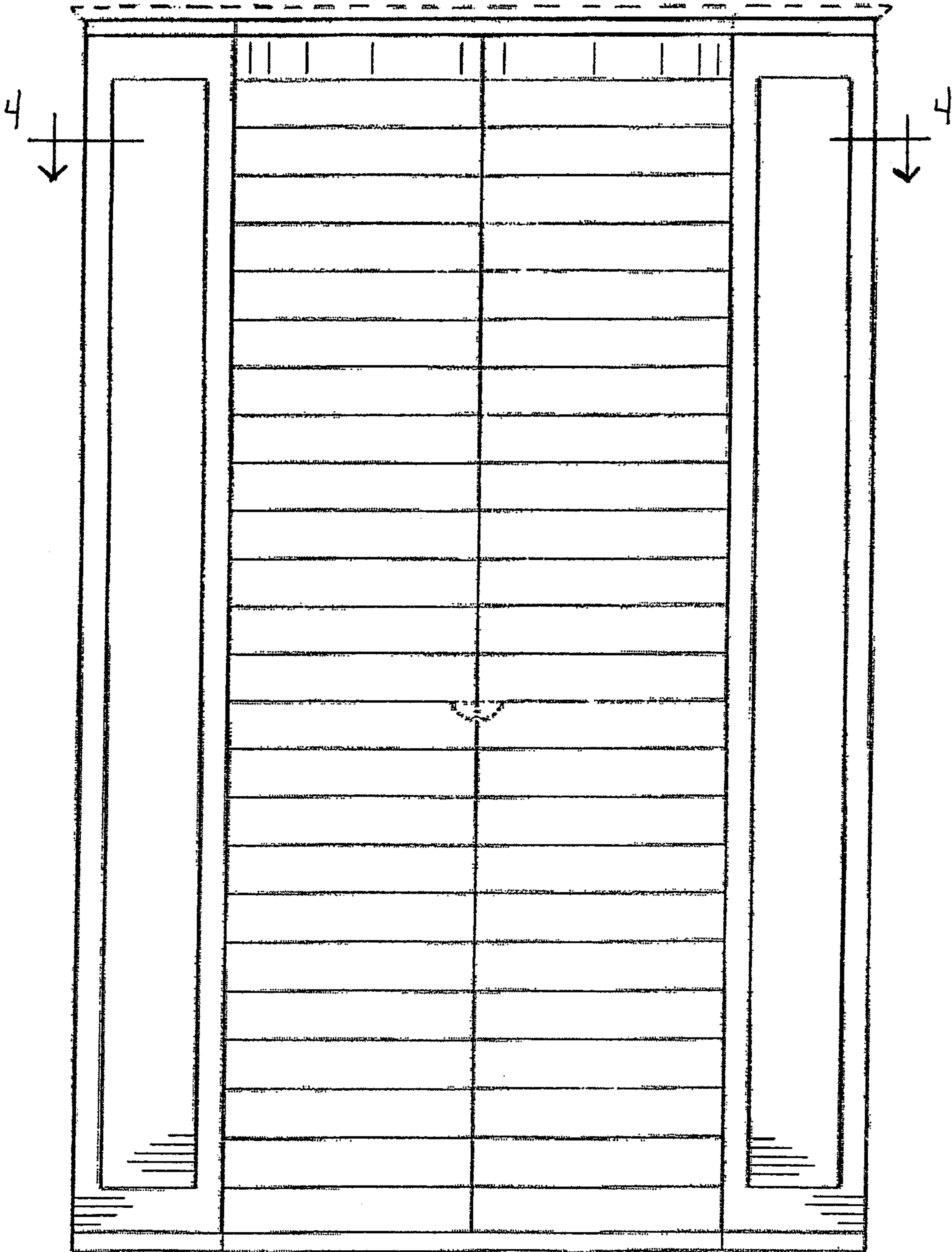

FIG. 2

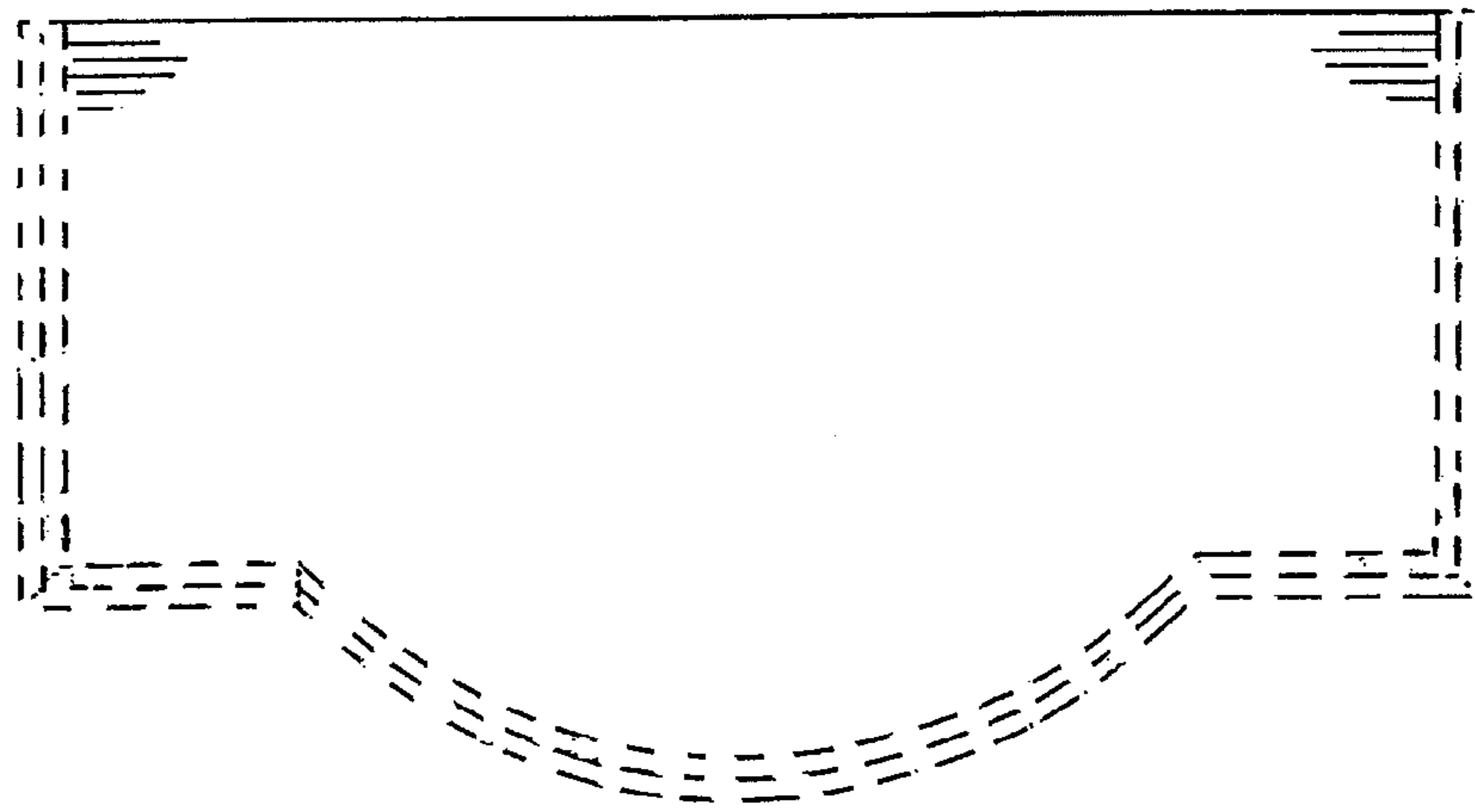

FIG. 3

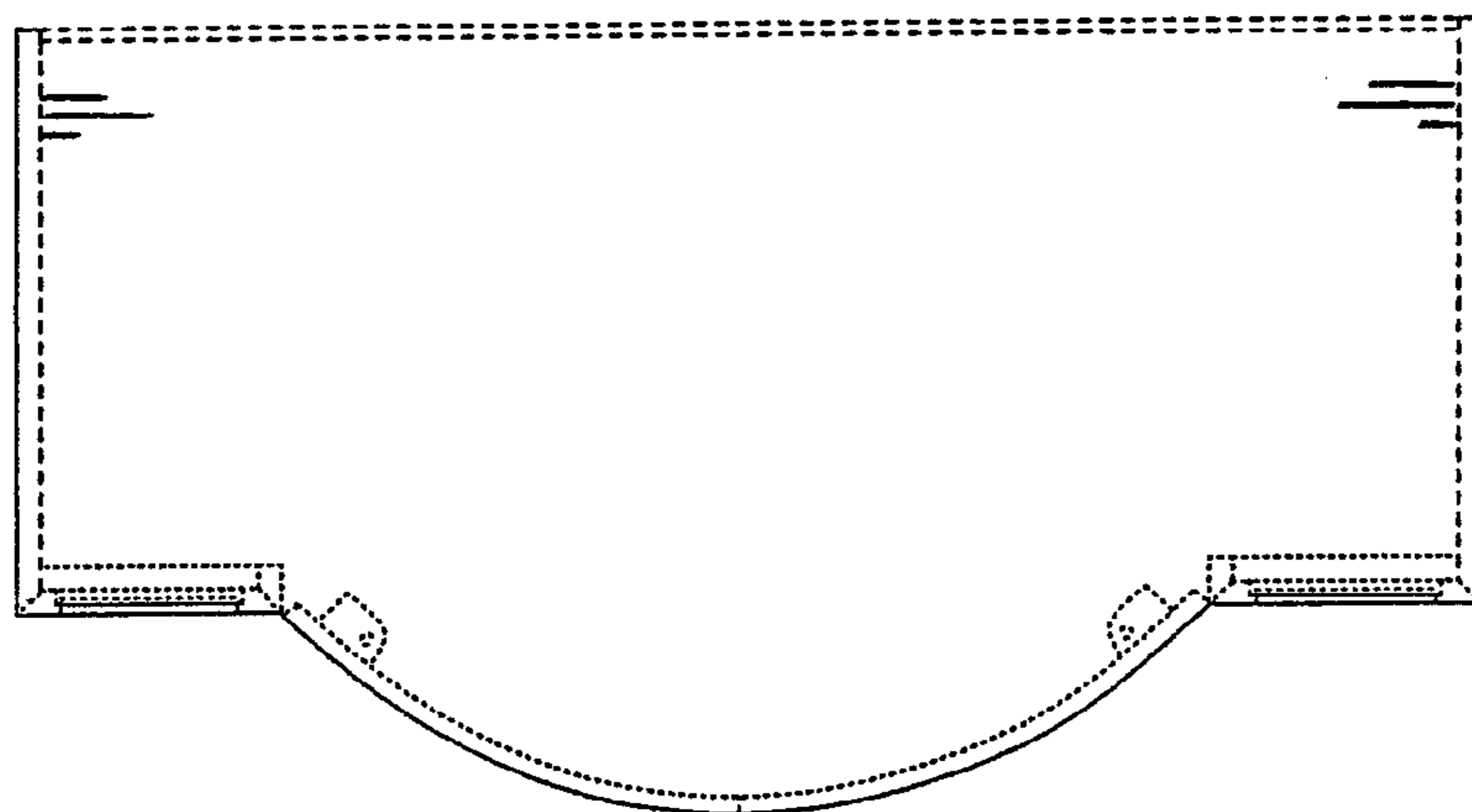

FIG. 4

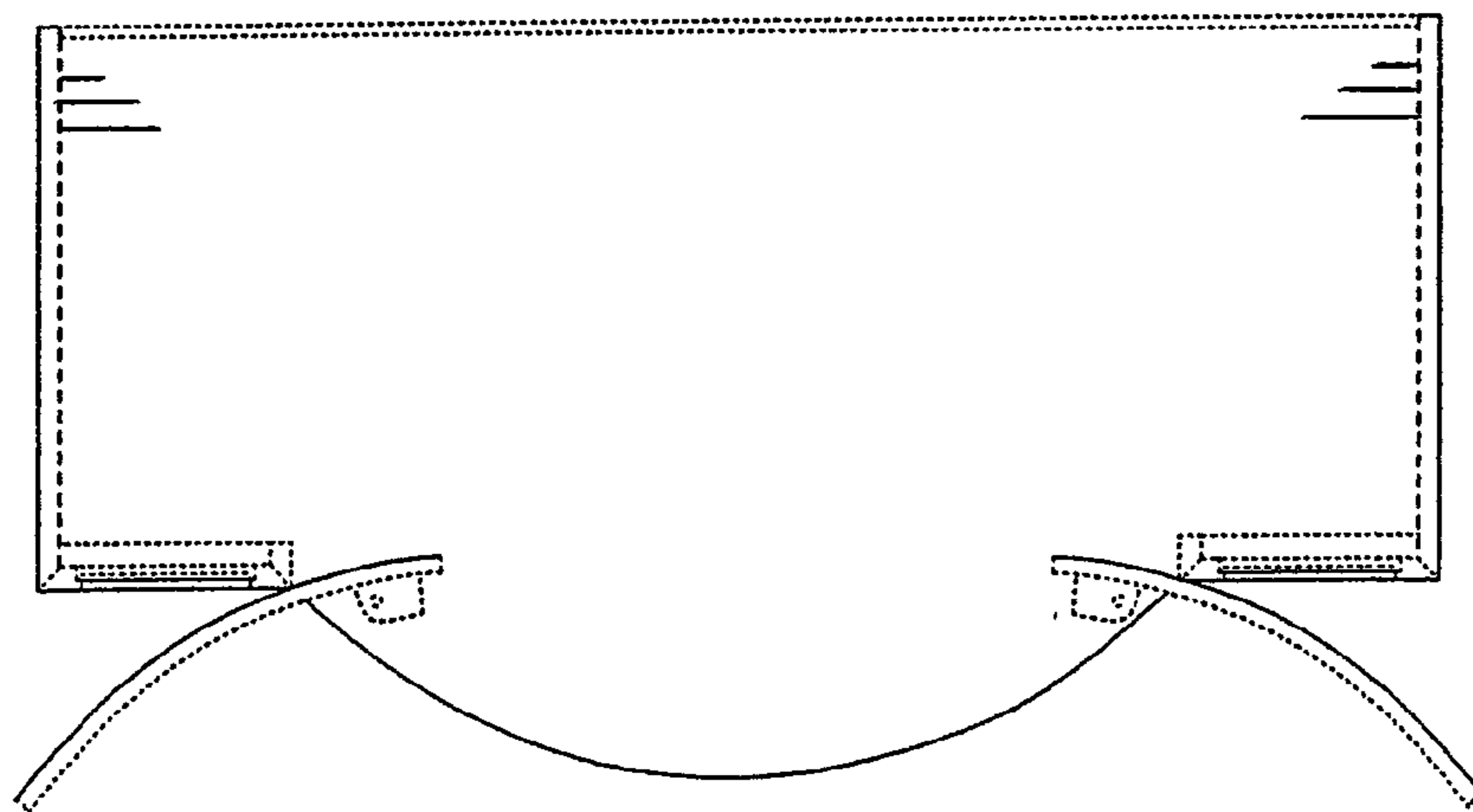

FIG. 5

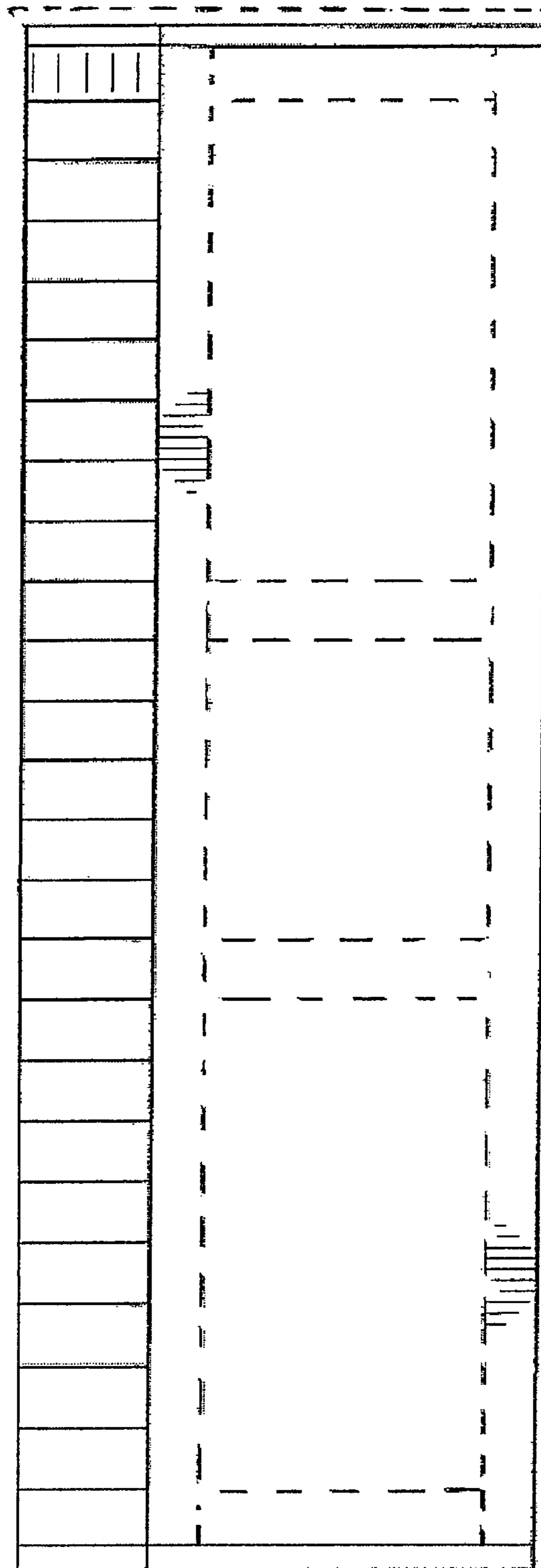

FIG. 6