



US00D553470S

(12) **United States Design Patent**
Chaconas

(10) **Patent No.:** **US D553,470 S**
(45) **Date of Patent:** **** Oct. 23, 2007**

(54) **LOFTED PANEL FOR A HANDLE OF A HAND TOOL**

(75) Inventor: **Peter C. Chaconas**, Glyndon, MD (US)

(73) Assignee: **Easco Hand Tools, Inc.**, Simsbury, CT (US)

(**) Term: **14 Years**

(21) Appl. No.: **29/258,724**

(22) Filed: **Apr. 26, 2006**

(51) **LOC (8) Cl.** **08-01**

(52) **U.S. Cl.** **D8/107; D7/402.1; D8/25**

(58) **Field of Classification Search** D8/107,
D8/82-87, 25, 300; D7/662, 633, 368, 649,
D7/393, 653, 645, 401.2; 81/177.1-177.7,
81/436, 439-440, 481, 63.2; 16/110.1, 430-431;
15/236.04-236.06, 164.9, 105, 236.01

See application file for complete search history.

(56) **References Cited**

U.S. PATENT DOCUMENTS

2,184,216 A * 12/1939 Gross 294/26

(Continued)

OTHER PUBLICATIONS

U.S. Appl. No. 11/187,779, filed Jul. 22, 2005, entitled "Oil Drain Plug Wrench".

(Continued)

Primary Examiner—Pamela J. Burgess

(74) *Attorney, Agent, or Firm*—Nelson Mullins Riley & Scarborough, L.L.P.

(57) **CLAIM**

The ornamental design of a lofted panel for a handle of a hand tool, illustrated substantially as shown and described.

DESCRIPTION

FIG. 1 is a perspective view of a lofted panel shown on a handle of a hand tool embodying the design of the present invention;

FIG. 2 is an end view of the lofted panel illustrated in FIG. 1;

FIG. 3 is a top plan view of the lofted panel illustrated in FIG. 1;

FIG. 4 is a right side view of the lofted panel illustrated in FIG. 1, the left side view being a mirror image of the right side view;

FIG. 5 is a perspective view of a second embodiment of a lofted panel shown on a handle of a hand tool showing my new design;

FIG. 6 is an end view of the lofted panel illustrated in FIG. 5;

FIG. 7 is a top plan view of the lofted panel illustrated in FIG. 5;

FIG. 8 is a right side view of the lofted panel illustrated in FIG. 5, the left side view being a mirror image of the right side view;

FIG. 9 is a perspective view of a third embodiment of a lofted panel shown on a handle of a hand tool showing my new design;

FIG. 10 is an end view of the lofted panel illustrated in FIG. 9;

FIG. 11 is a top plan view of the lofted panel illustrated in FIG. 9; and

FIG. 12 is a right side view of the lofted panel illustrated in FIG. 9, the left side view being a mirror image of the right side view.

FIG. 13 is a perspective view of a fourth embodiment of a lofted panel shown on a handle of a hand tool showing my new design;

FIG. 14 is an end view of the lofted panel illustrated in FIG. 13;

FIG. 15 is a top plan view of the lofted panel illustrated in FIG. 13; and,

FIG. 16 is a right side view of the lofted panel illustrated in FIG. 13, the left side view being a mirror image of the right side view.

Broken lines are for illustrative purposes and form no part of the claim.

1 Claim, 8 Drawing Sheets

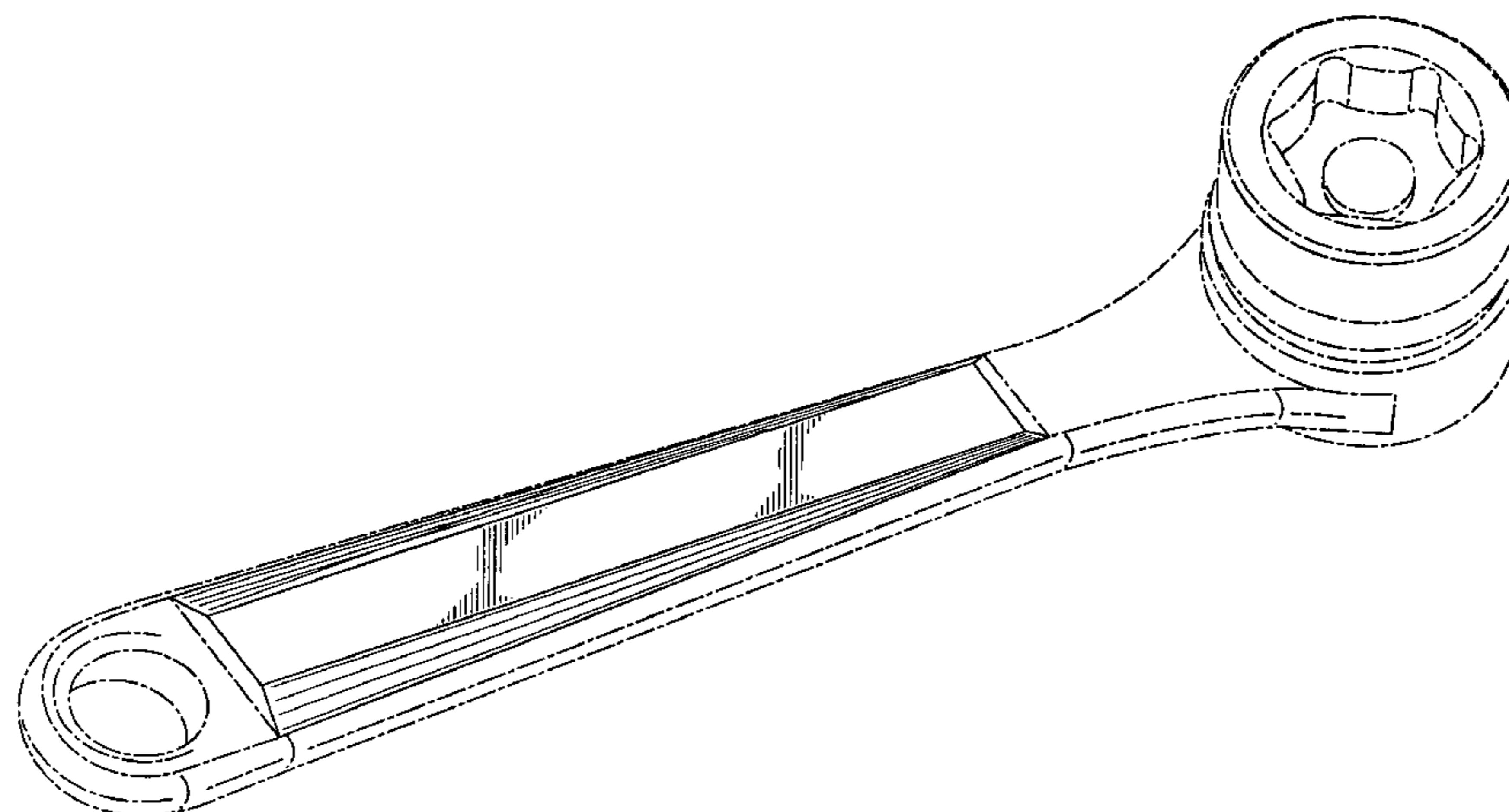

US D553,470 S

Page 2

U.S. PATENT DOCUMENTS

2,312,809	A *	3/1943	Fletcher	30/171	6,584,692	B1 *	7/2003	Stills et al.	30/129
D271,672	S *	12/1983	Bulgari	D11/5	D483,990	S *	12/2003	Munari	D7/395
D279,447	S *	7/1985	Gangelhoff et al.	D7/649	D487,379	S *	3/2004	Porsche	D7/649
D283,743	S *	5/1986	Moser	D32/48	6,711,973	B2	3/2004	Arnold et al.	81/63.2
D299,206	S	1/1989	Krapowicz et al.	D8/28	6,868,759	B2	3/2005	Tuan-Mu	81/63.2
D300,296	S	3/1989	Krapowicz et al.	D8/25	D509,717	S	9/2005	Folkenroth et al.	D8/25
D326,985	S	6/1992	Chow	D8/25	D514,405	S	2/2006	Chaconas	D8/25
D340,628	S	10/1993	Chow	D8/25						
D366,986	S *	2/1996	Williams	D7/401.2						
5,850,657	A *	12/1998	List et al.	15/105						
D476,546	S *	7/2003	Ping	D8/107						

OTHER PUBLICATIONS

U.S. Appl. No. 11/338,358, filed Jan. 24, 2006, entitled "Cap Wrench".

* cited by examiner

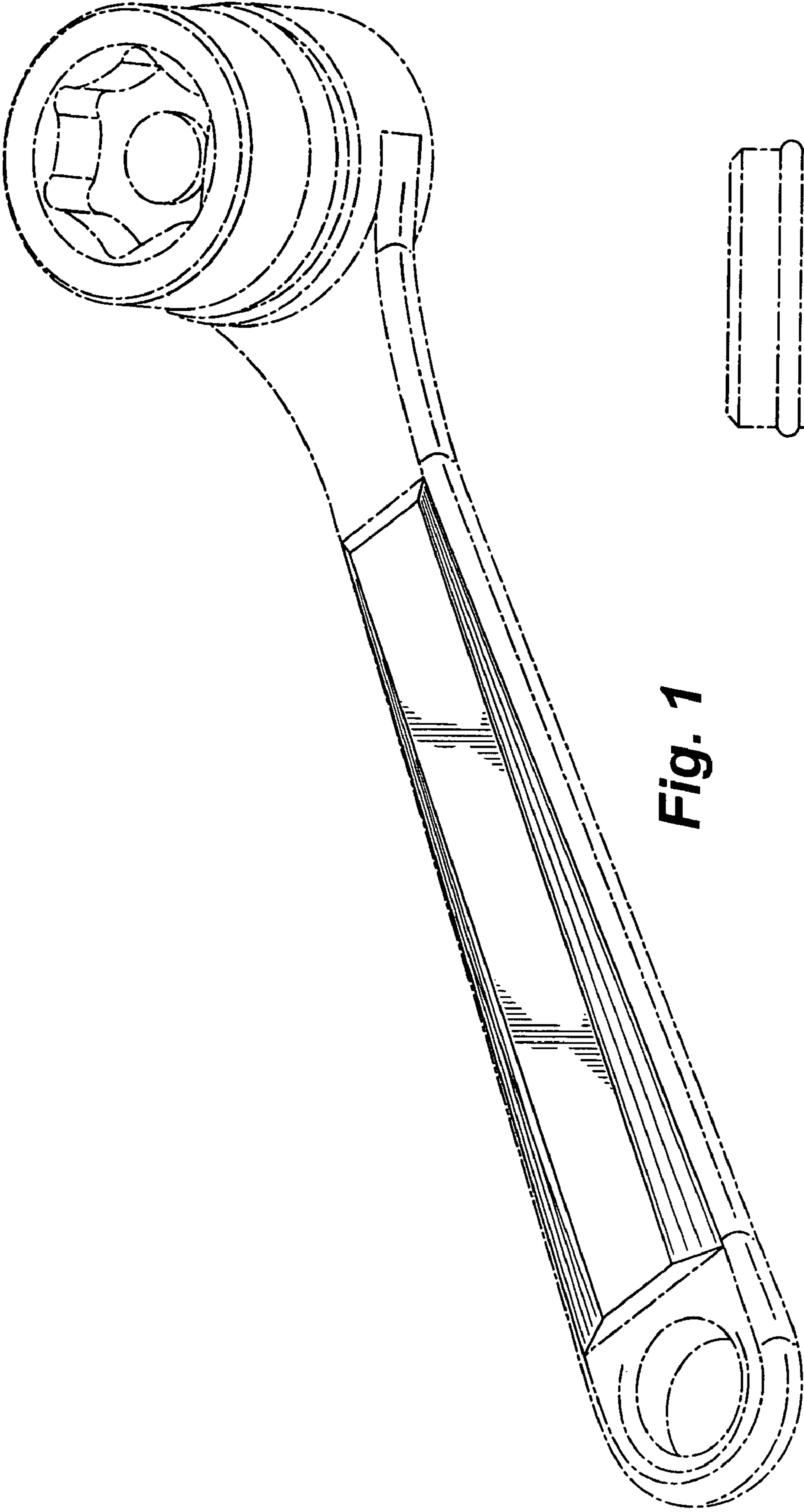

Fig. 1

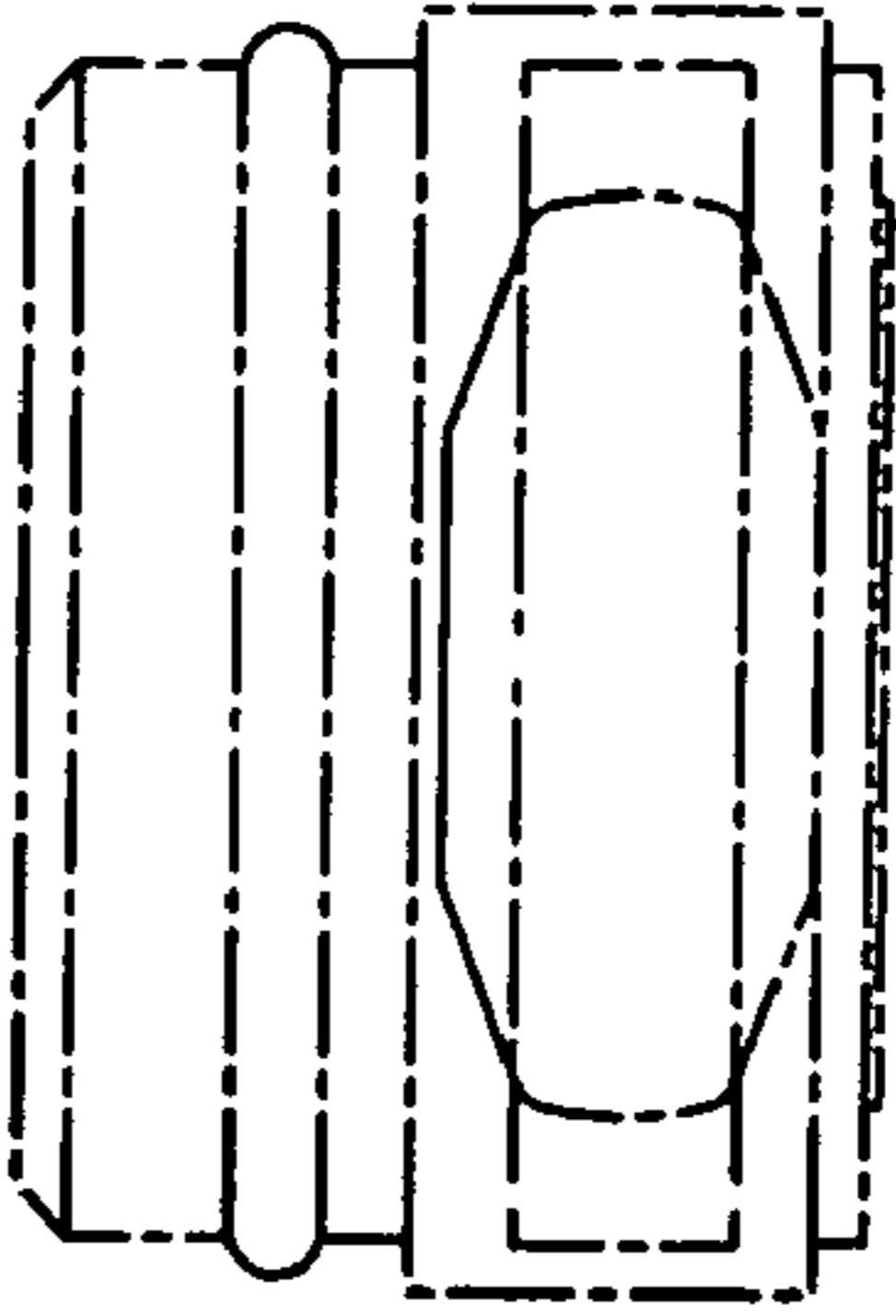

Fig. 2

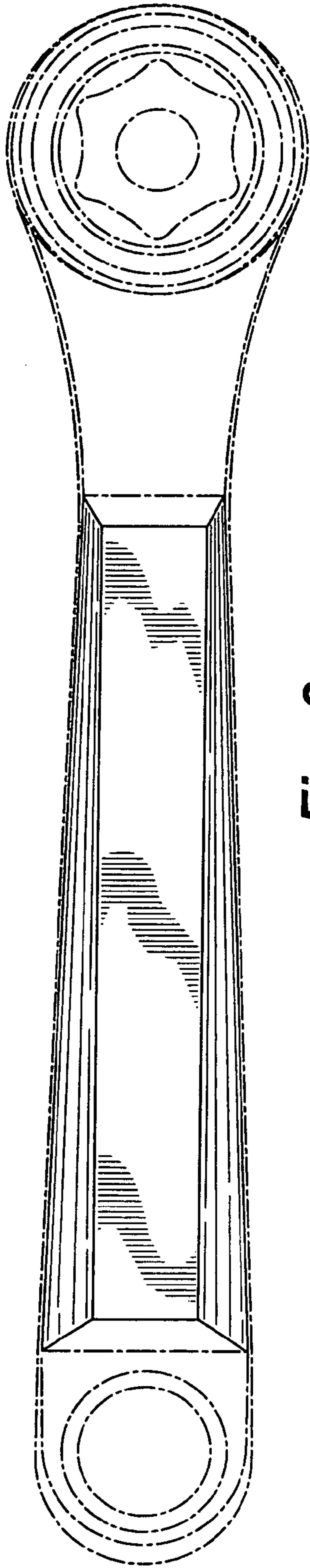

Fig. 3

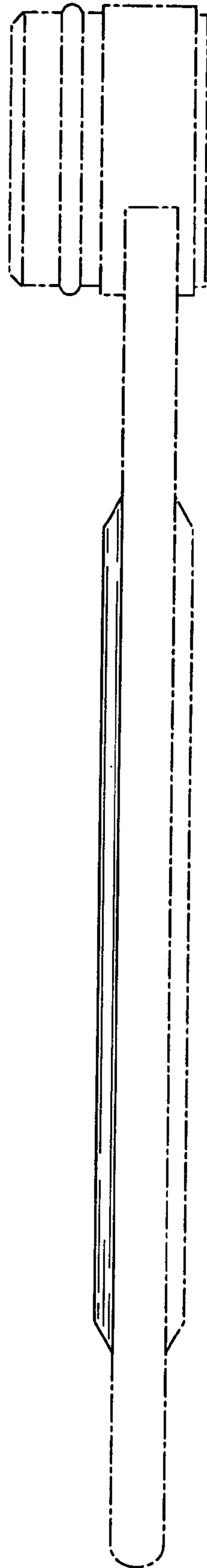

Fig. 4

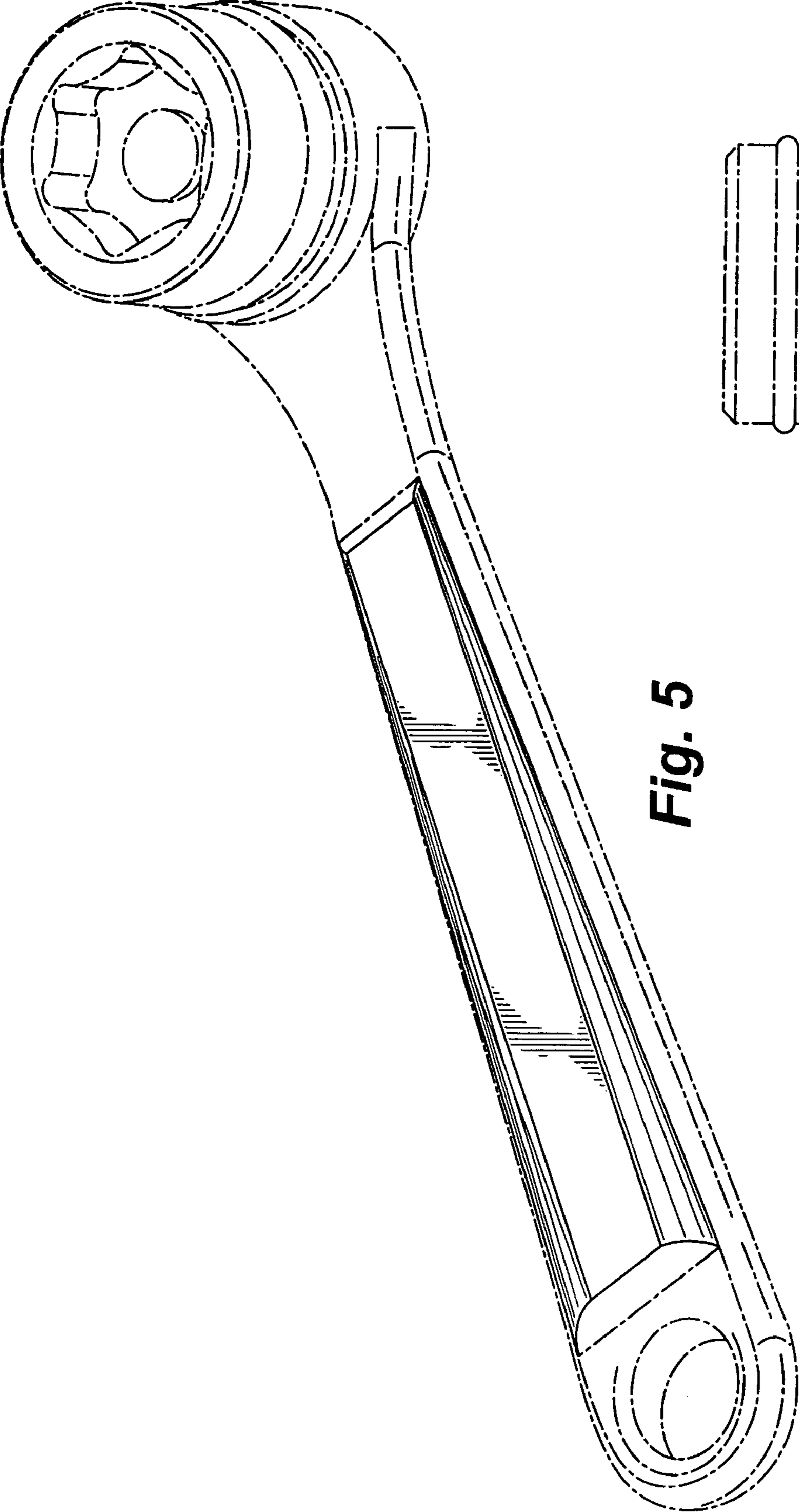

Fig. 5

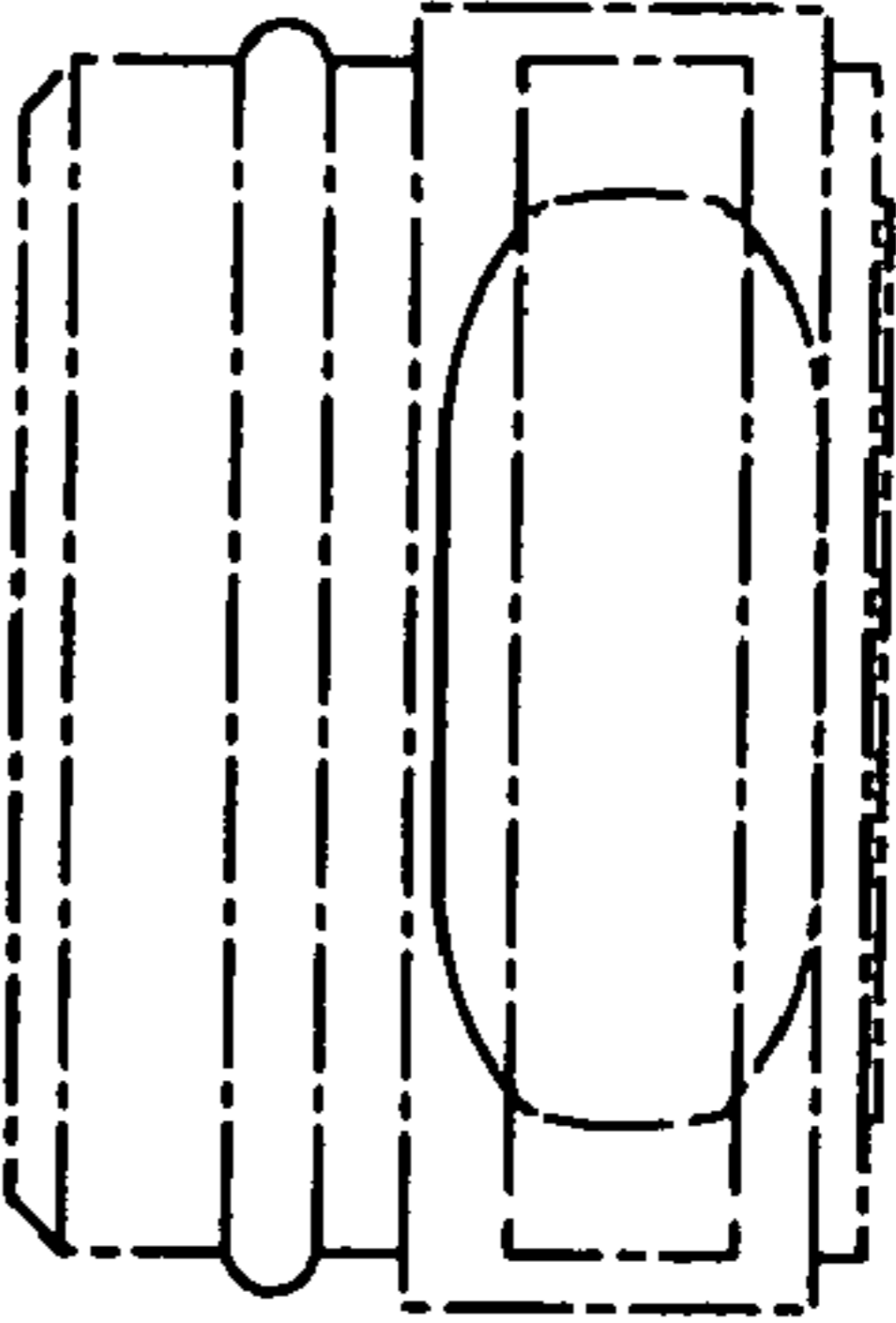

Fig. 6

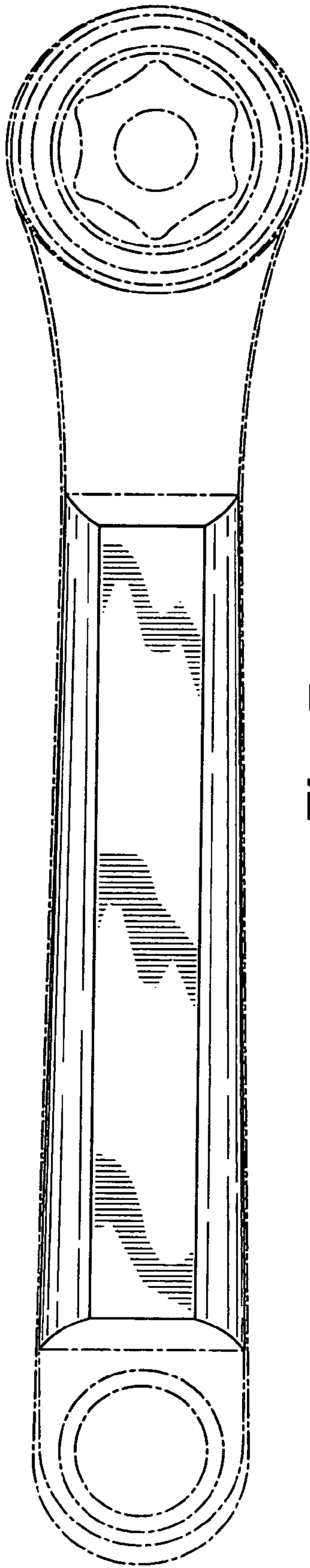

Fig. 7

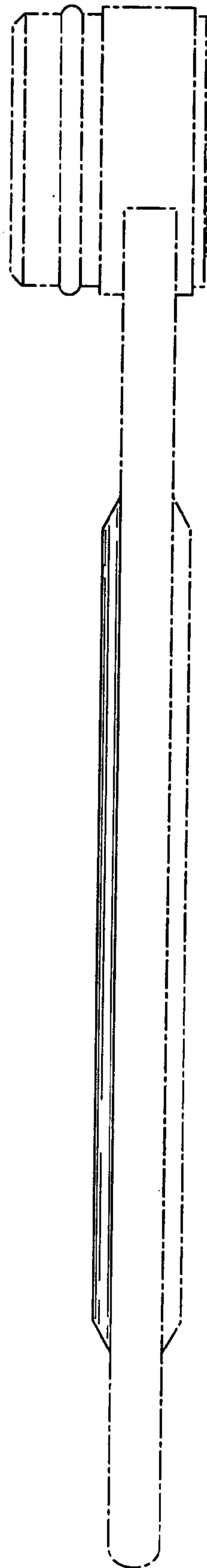

Fig. 8

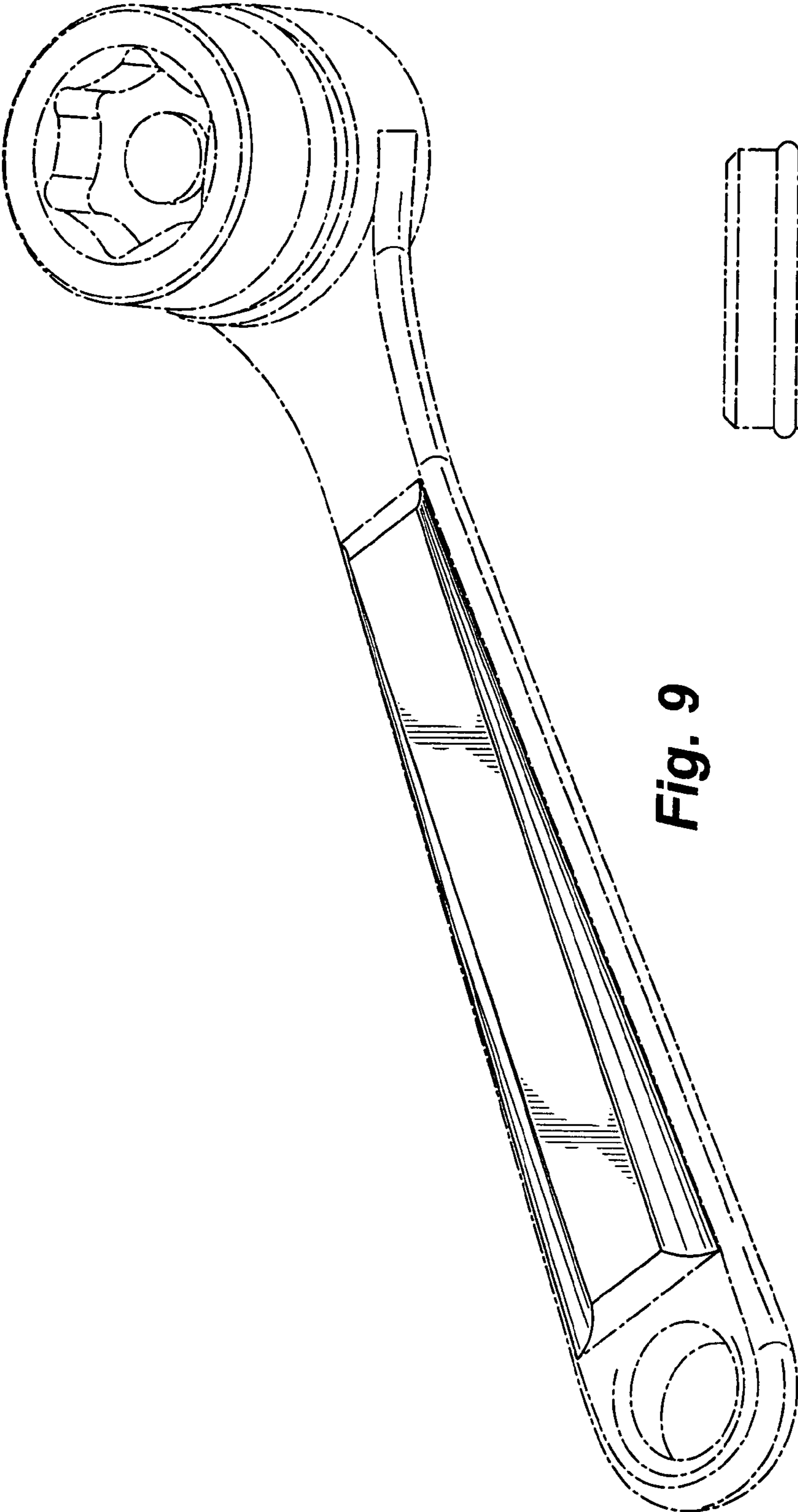

Fig. 9

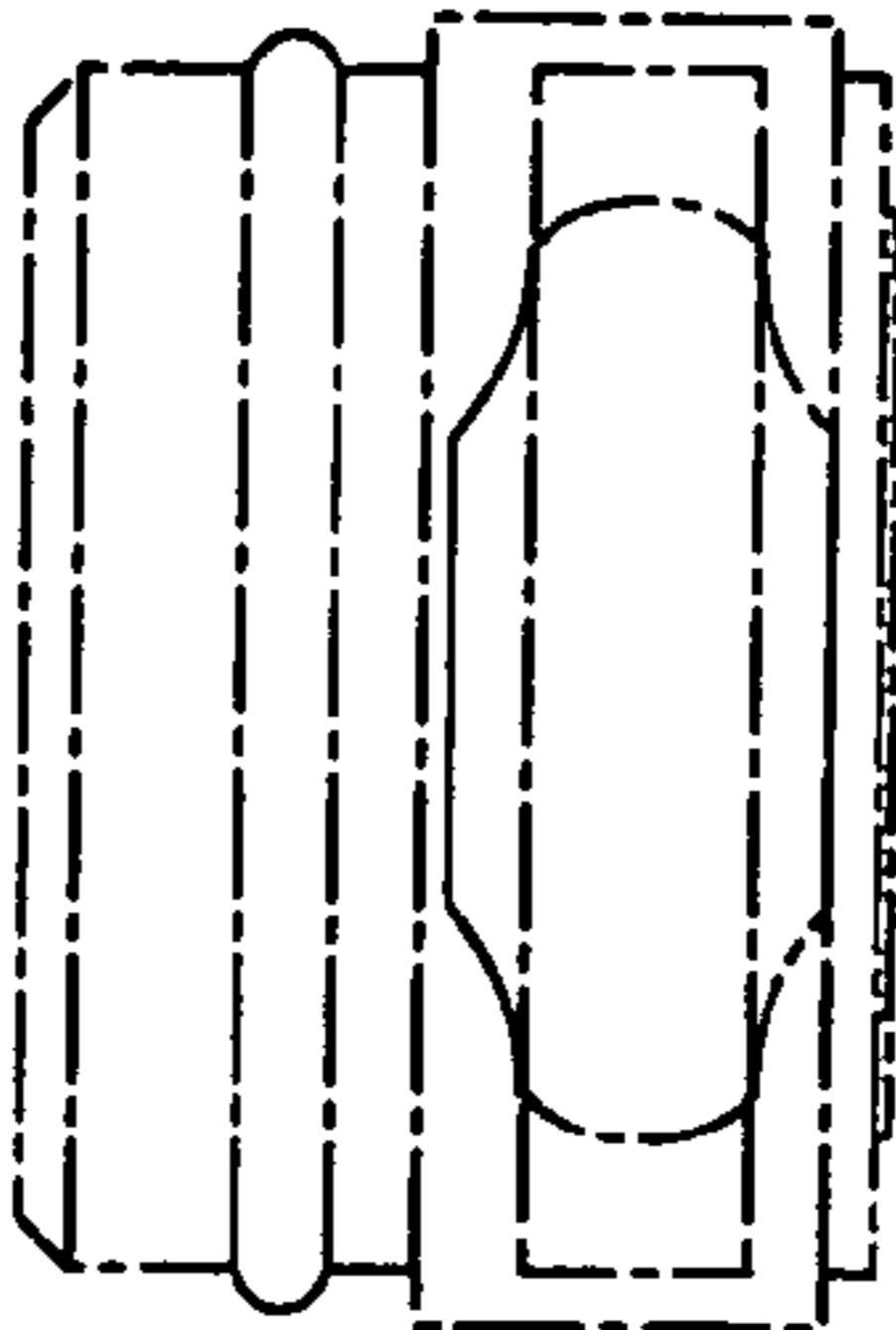

Fig. 10

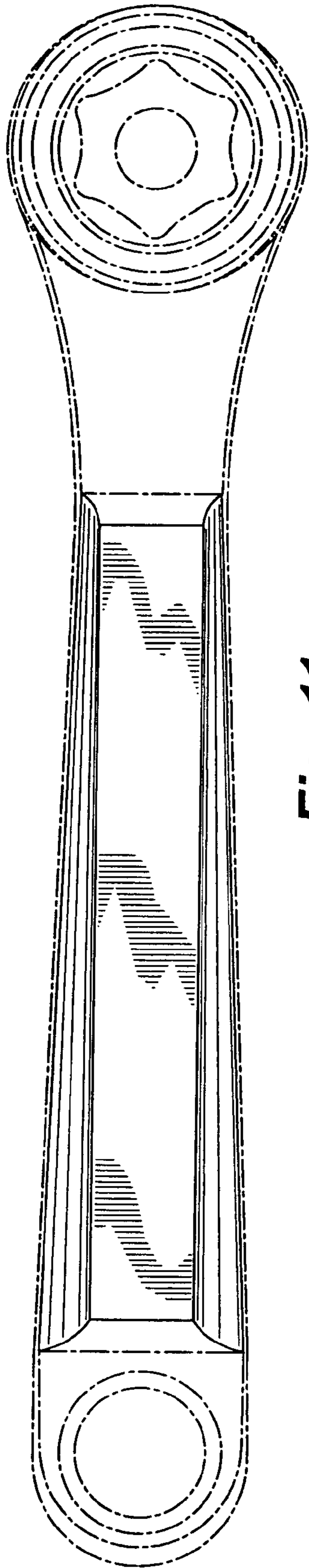

Fig. 11

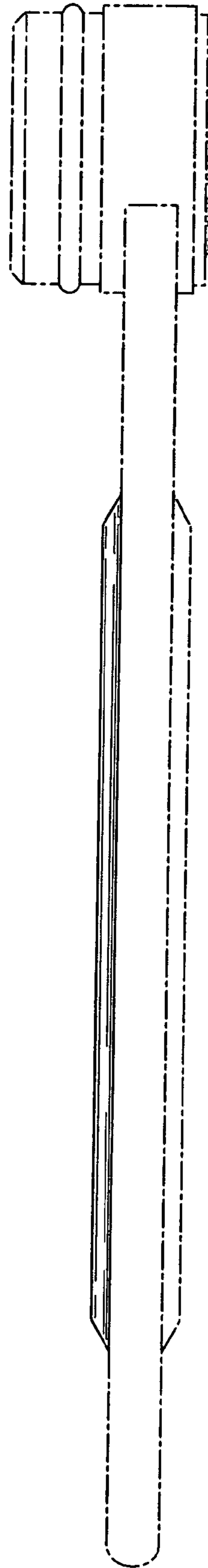

Fig. 12

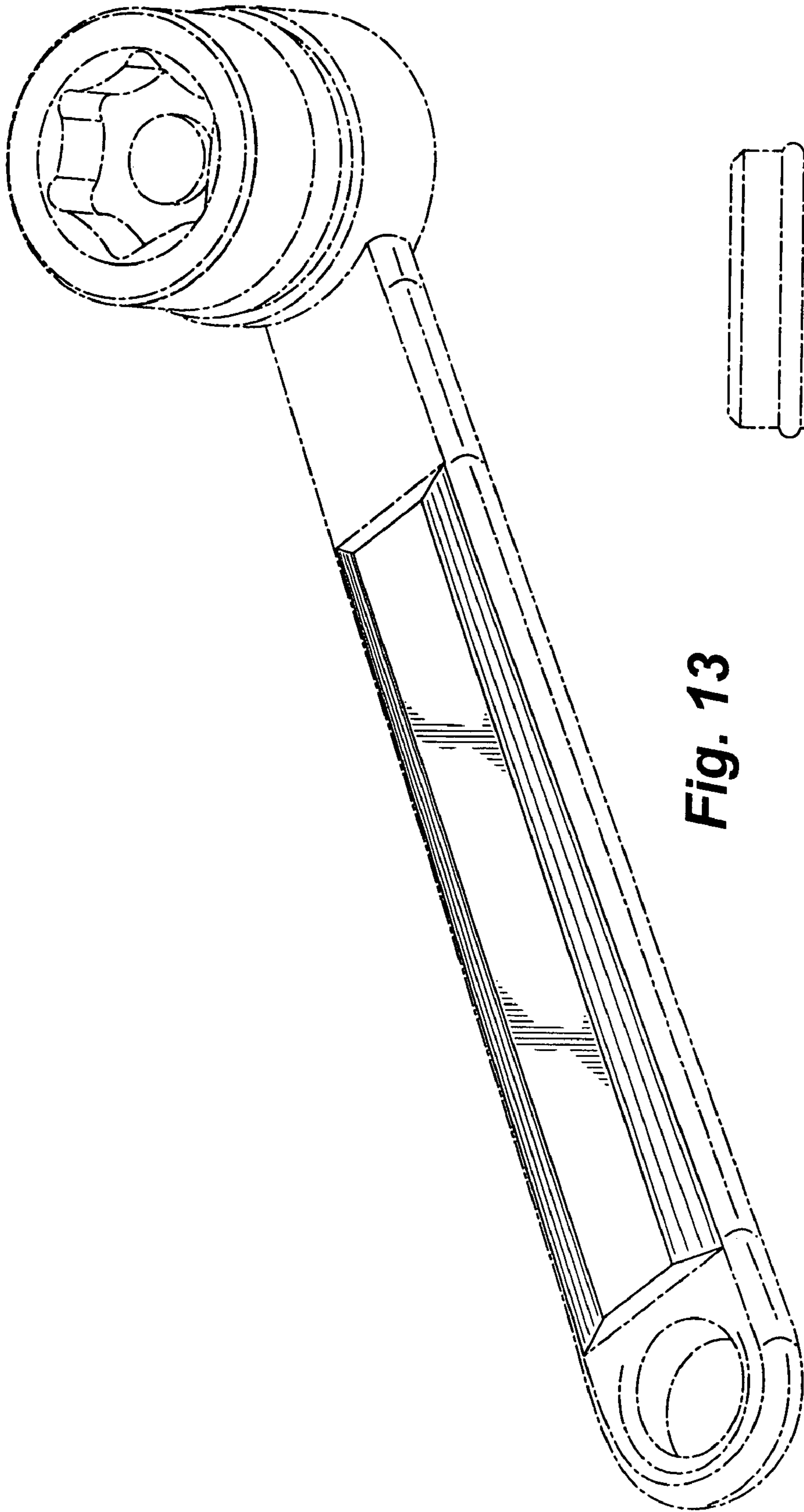

Fig. 13

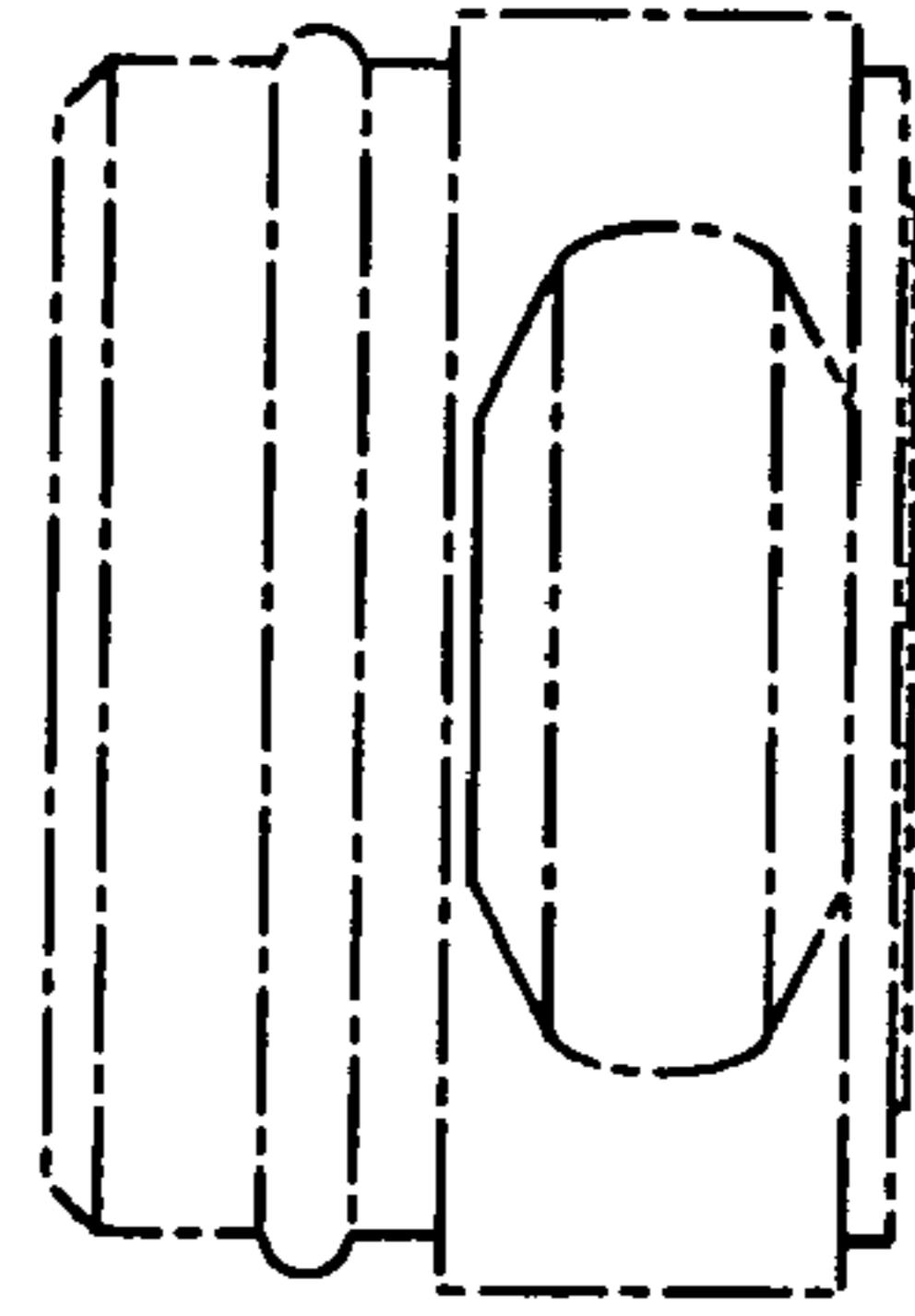

Fig. 14

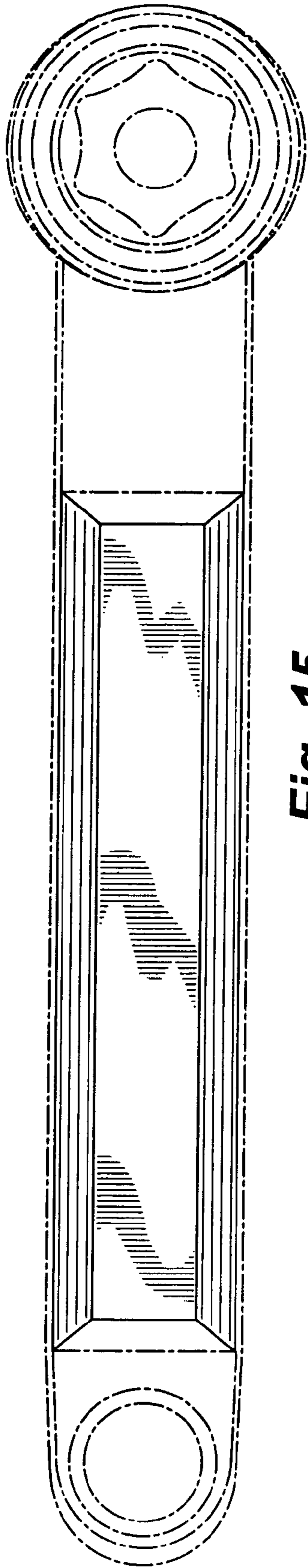

Fig. 15

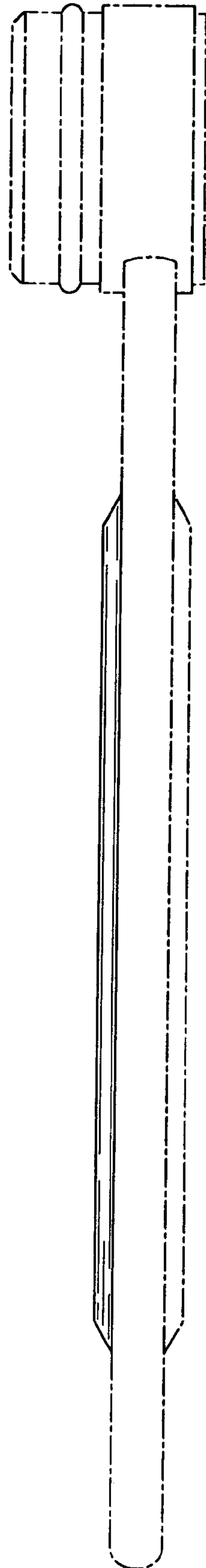

Fig. 16