

US00D546740S

(12) **United States Design Patent**  
**Phipps**

(10) **Patent No.:** **US D546,740 S**  
(45) **Date of Patent:** **\*\* Jul. 17, 2007**

(54) **CONTROL LEVER PERCH**

(75) Inventor: **Eric Phipps**, Placerville, CA (US)

(73) Assignee: **Works Connection, Inc.**, Diamond Springs, CA (US)

(\*\*) Term: **14 Years**

(21) Appl. No.: **29/237,397**

(22) Filed: **Aug. 31, 2005**

(51) **LOC (8) Cl.** ..... **12-16**

(52) **U.S. Cl.** ..... **D12/179**

(58) **Field of Classification Search** ..... D12/110,  
D12/111, 114, 126, 179; 180/219; 74/469,  
74/471 R, 479.01, 488, 489, 491, 519, 523-525,  
74/551.8, 551.9, 502.2; 288/304.3, 288.4;  
192/3.62, 99 R, 99 S

See application file for complete search history.

(56) **References Cited**

**U.S. PATENT DOCUMENTS**

D298,309 S *	11/1988	Coue	.....	D12/179
D339,096 S *	9/1993	Bean et al.	.....	D12/179
6,360,628 B1 *	3/2002	Corso	.....	74/502.2
D521,427 S *	5/2006	Tsai	.....	D12/179
2002/0096010 A1 *	7/2002	Ose	.....	74/502.2
2004/0069087 A1 *	4/2004	Lumpkin	.....	74/469

**OTHER PUBLICATIONS**

2005 Yamaha YZ250F part Nos. 16-040 and 16-085, posted Jun. 16, 2004. [Retrieved on Sep. 8, 2006]. Retrieved from the Internet <URL: [http://www.transworldmotocross.com/mx/product\\_reviews/article](http://www.transworldmotocross.com/mx/product_reviews/article)>.\*

2001 Tucker Rocky Distributing catalog, MSR dominator Clutch Brackets on p. 431.\*

(Continued)

*Primary Examiner*—Alan P. Douglas

*Assistant Examiner*—Linda Brooks

(74) *Attorney, Agent, or Firm*—Knobbe, Martens, Olson & Bear LLP

(57) **CLAIM**

The ornamental design for a control lever perch, as shown and described.

**DESCRIPTION**

FIG. 1 is a perspective view of the top, front and inboard side of a first embodiment of a control lever perch.

FIG. 2 is a top view of the control lever perch of FIG. 1.

FIG. 3 is a bottom view of the control lever perch of FIG. 1.

FIG. 4 is a rear view of the control lever perch of FIG. 1.

FIG. 5 is a front view of the control lever perch of FIG. 1.

FIG. 6 is inboard side view of the control lever perch of FIG. 1.

FIG. 7 is an outboard side view of the control lever perch of FIG. 1.

FIG. 8 is a perspective view of the top, front and outboard side of a second embodiment of a control lever perch.

FIG. 9 is a perspective view of the bottom, rear and outboard side of the control lever perch of FIG. 8.

FIG. 10 is a top view of the control lever perch of FIG. 8.

FIG. 11 is a bottom view of the control lever perch of FIG. 8.

FIG. 12 is a rear view of the control lever perch of FIG. 8.

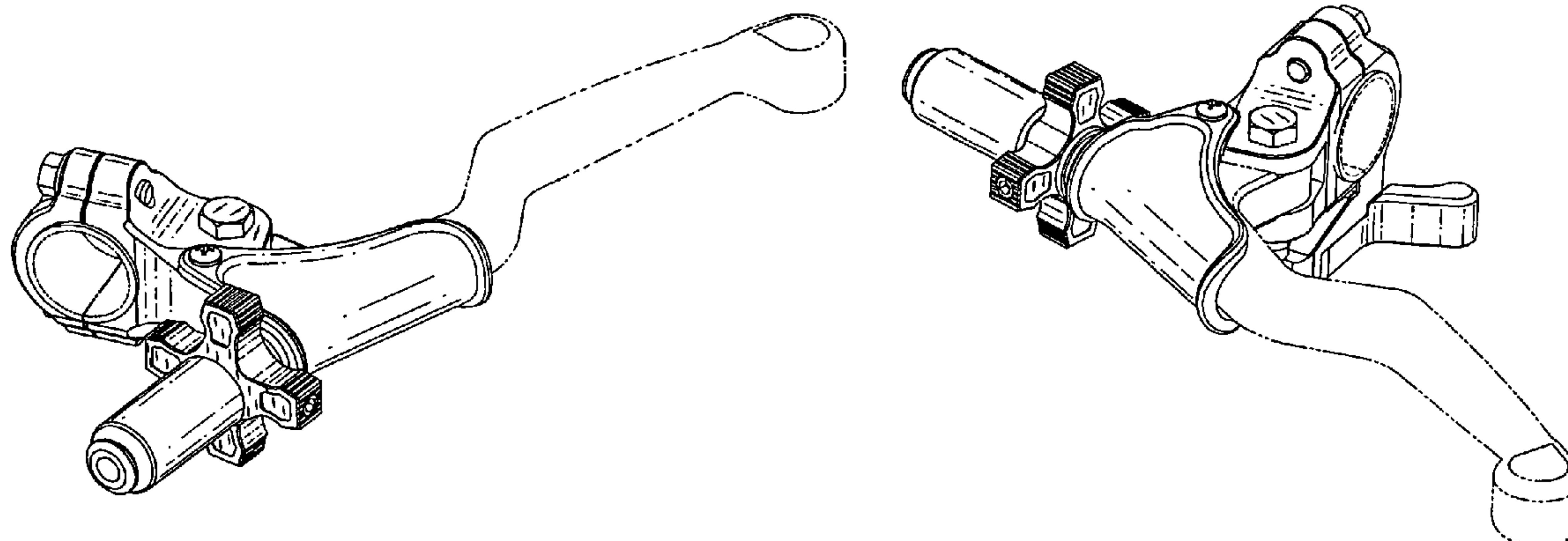
FIG. 13 is a front view of the control lever perch of FIG. 8.

FIG. 14 is an inboard side view of the control lever perch of FIG. 8; and,

FIG. 15 is an outboard side view of the control lever perch of FIG. 8.

The elements illustrated in dashed lines in the drawing figures are environmental and do not form a part of the claimed design.

**1 Claim, 9 Drawing Sheets**

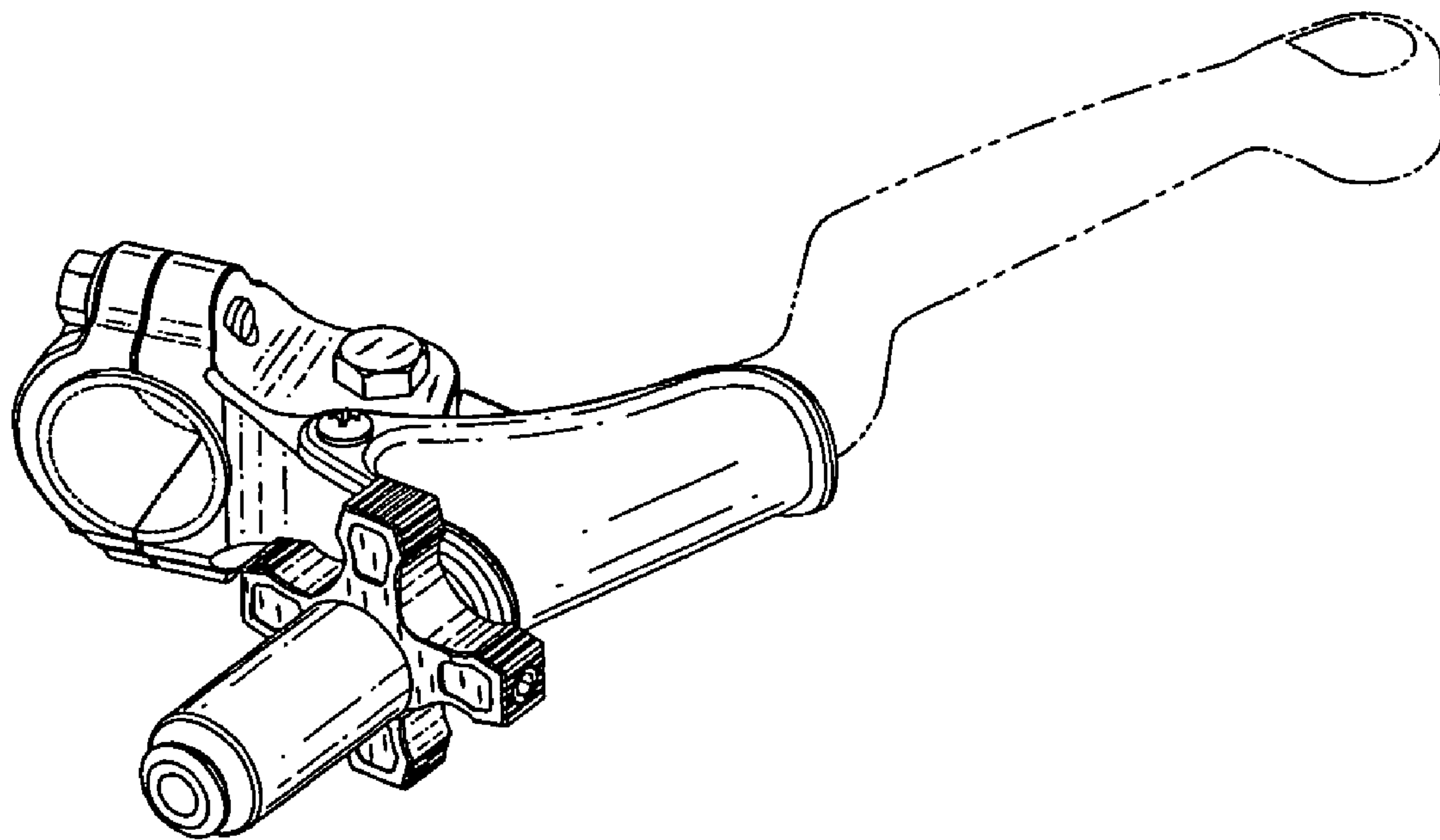


OTHER PUBLICATIONS

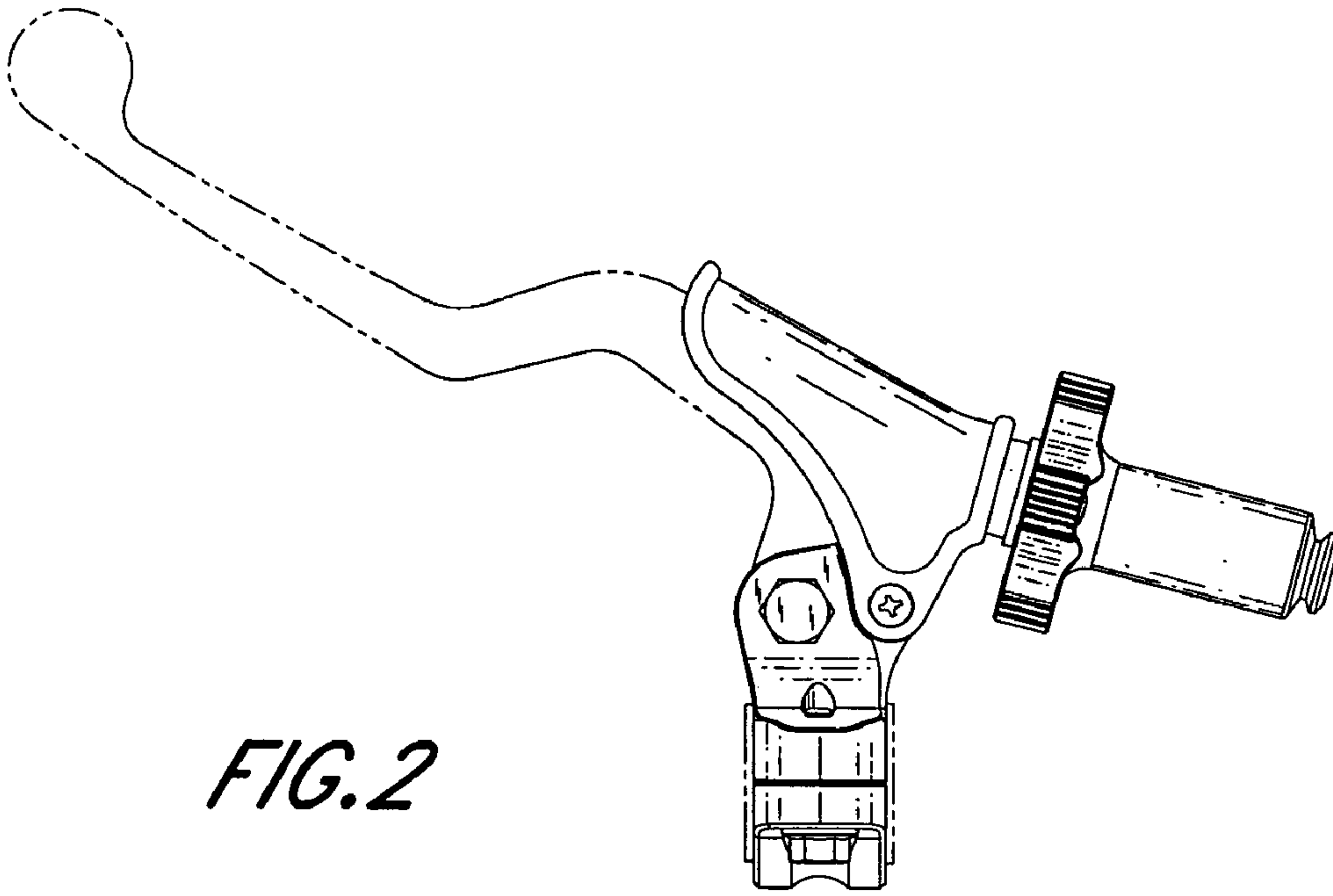
Works Connection Factory Hardware—Motocross and ATV parts;  
[http://www.worksconnection.com/store/product.html?prod\\_id=2337](http://www.worksconnection.com/store/product.html?prod_id=2337).

Works Connection Factory Hardware—Motocross and ATV parts;  
[http://www.worksconnection.com/store/product.html?prod\\_id=2338](http://www.worksconnection.com/store/product.html?prod_id=2338).

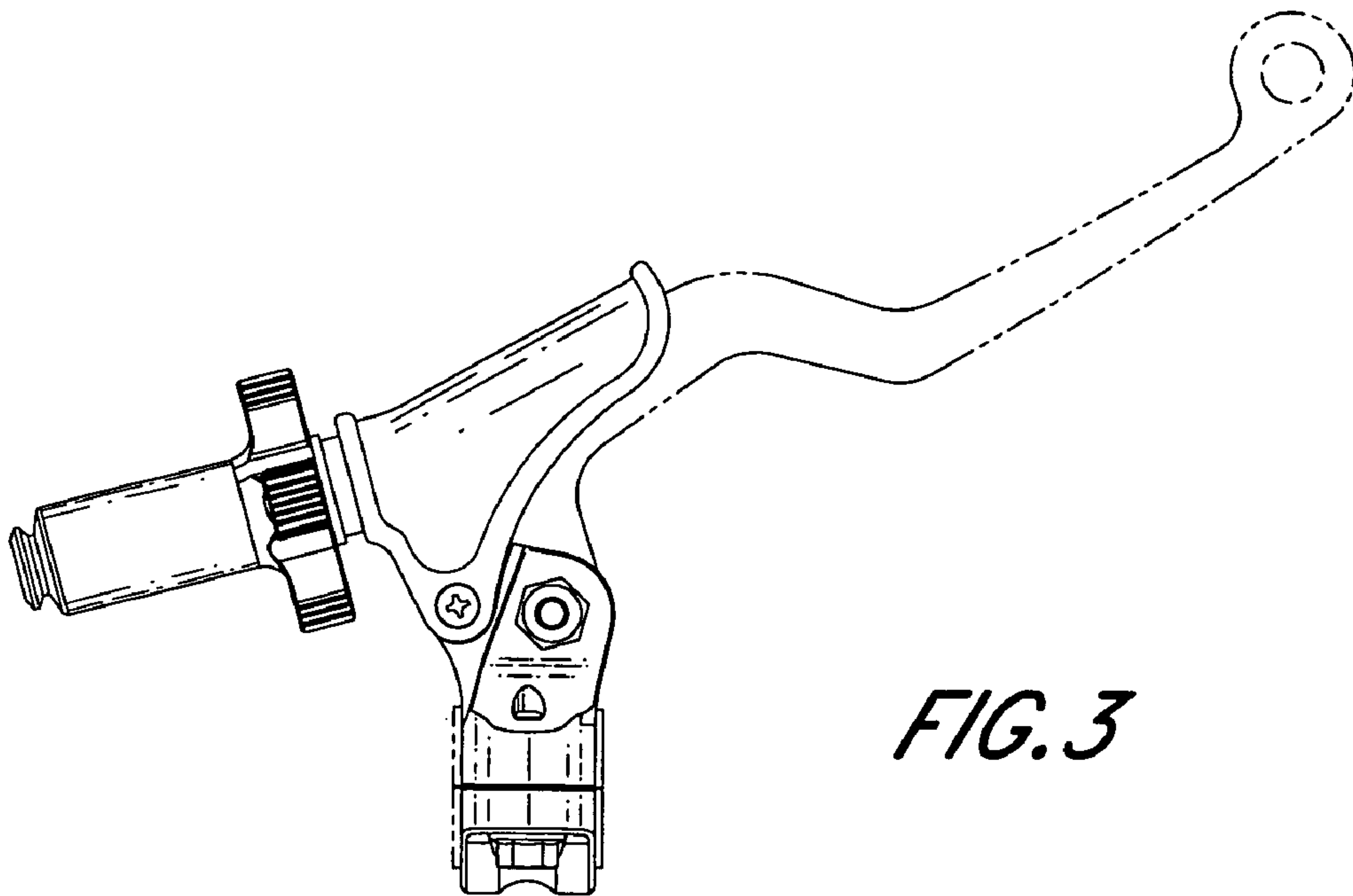
\* cited by examiner



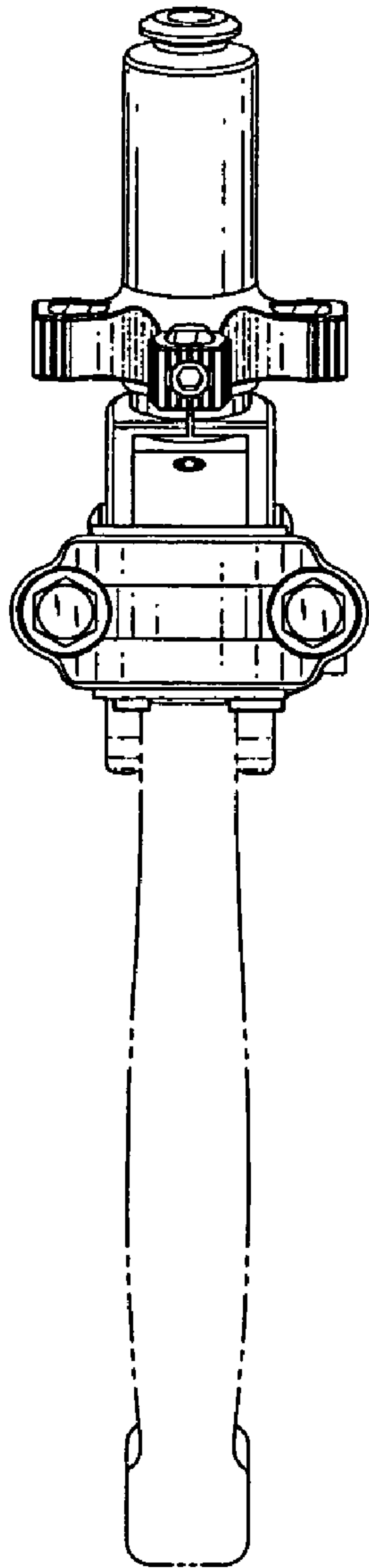
*FIG. 1*



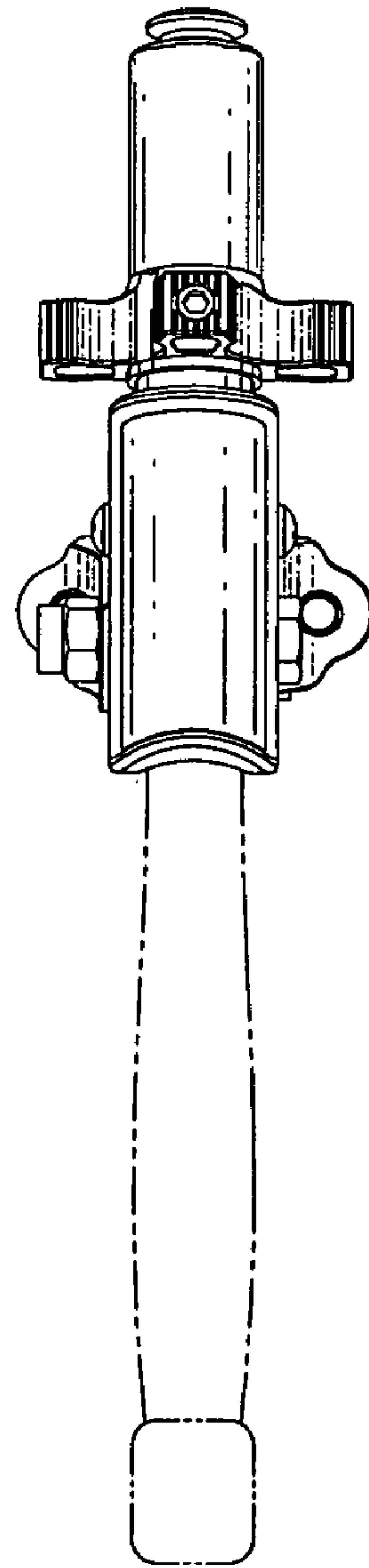
*FIG. 2*



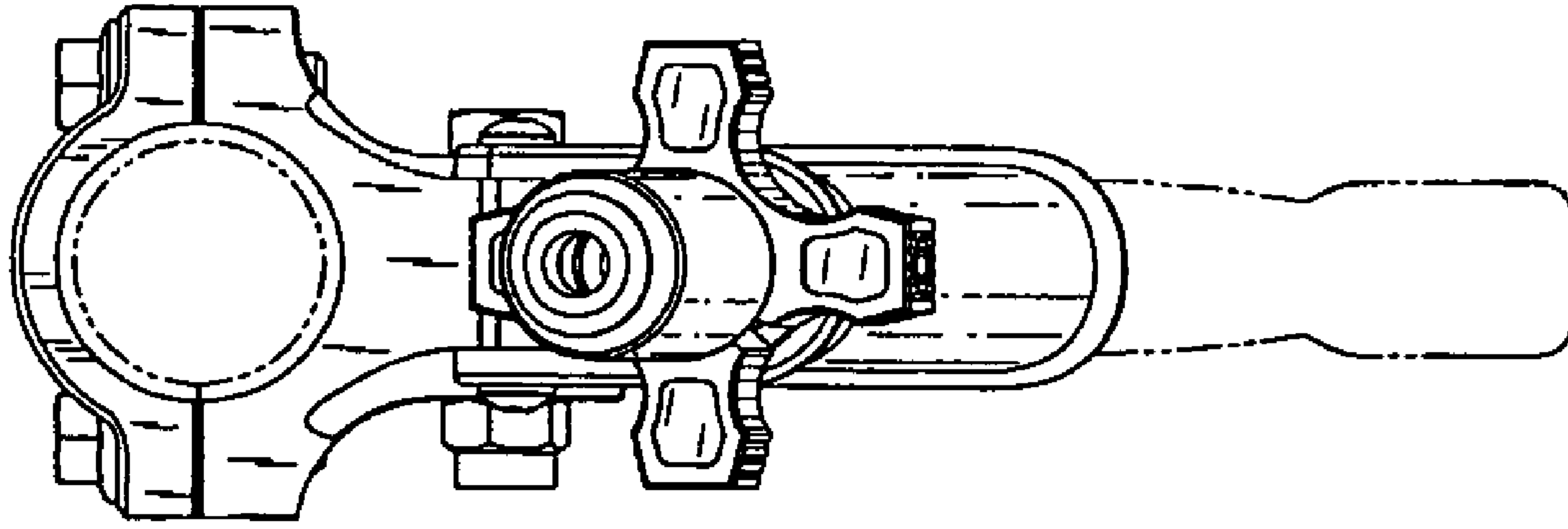
*FIG. 3*



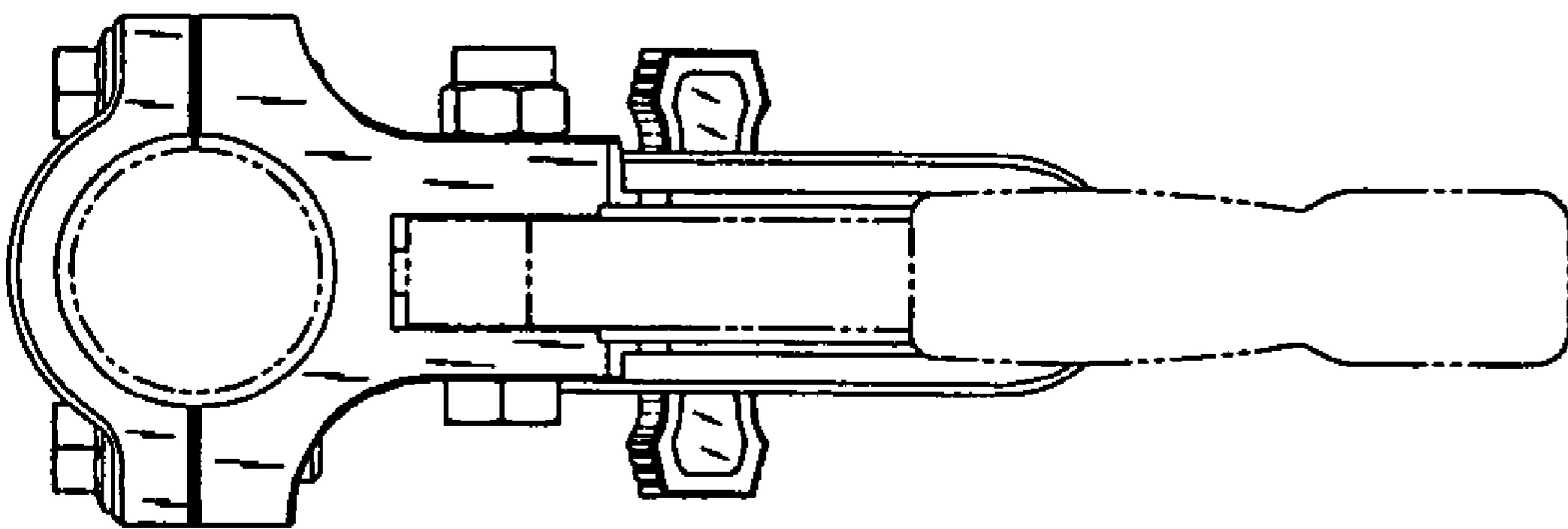
*FIG. 4*



*FIG. 5*

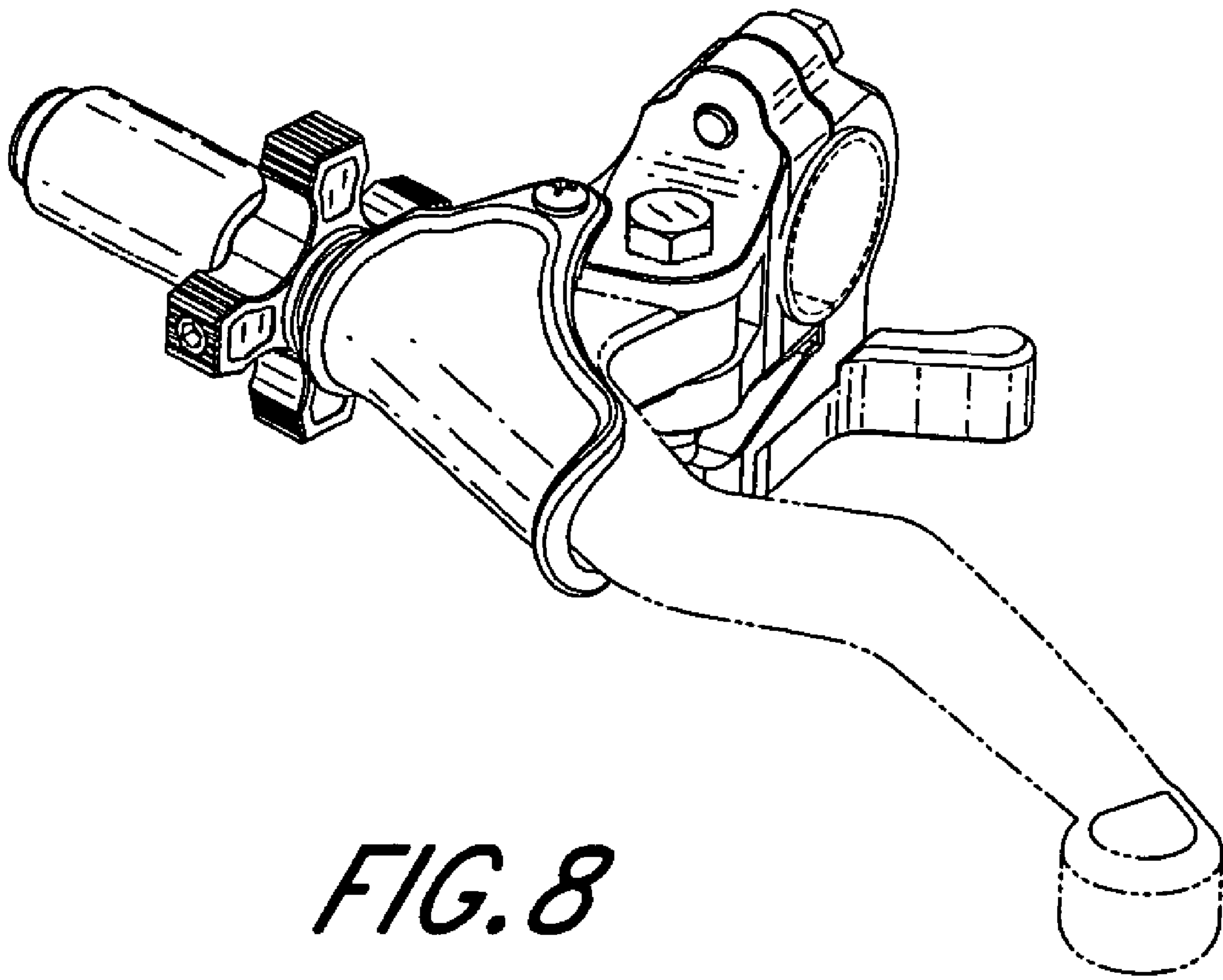


*FIG. 6*

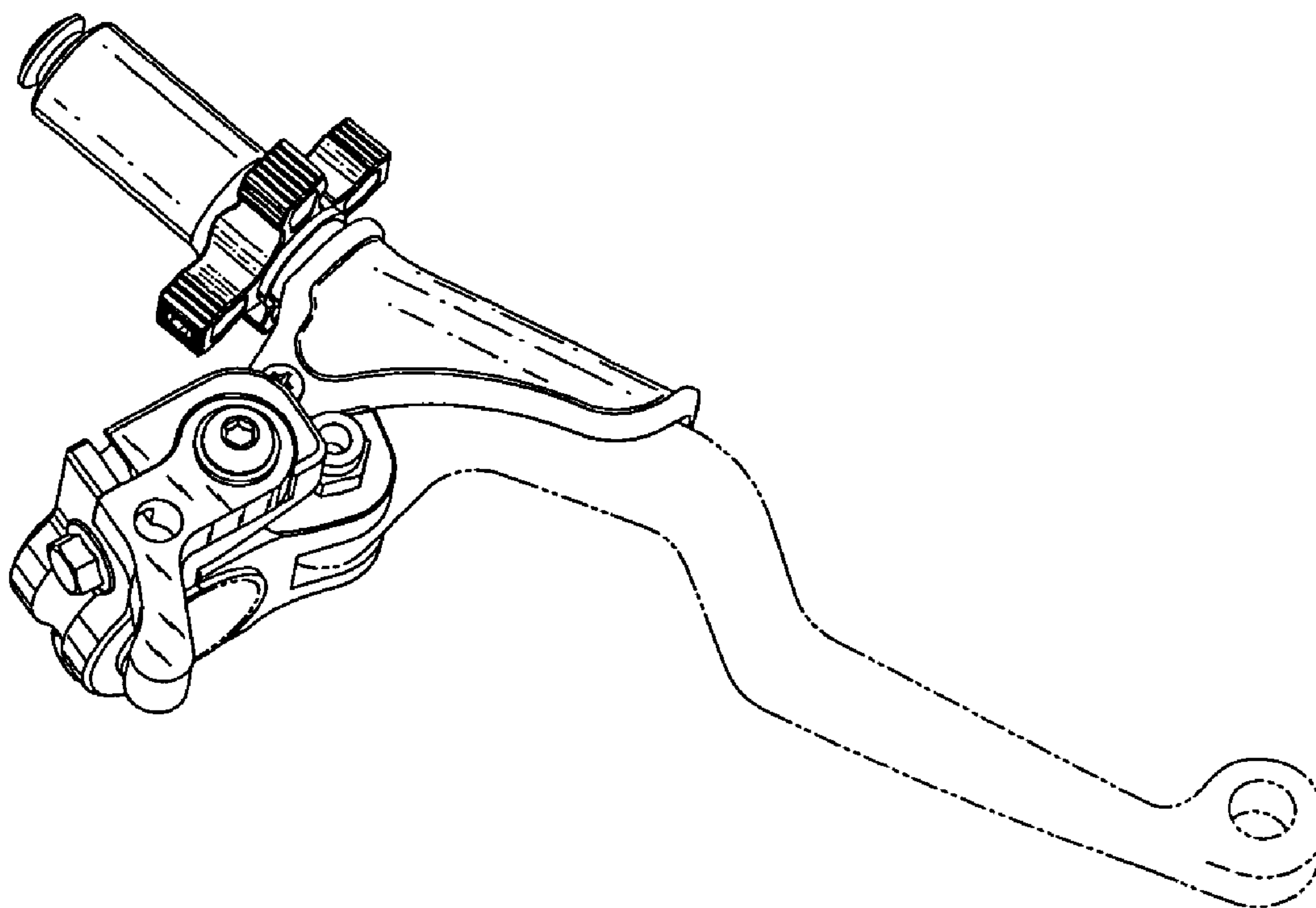


*FIG. 7*



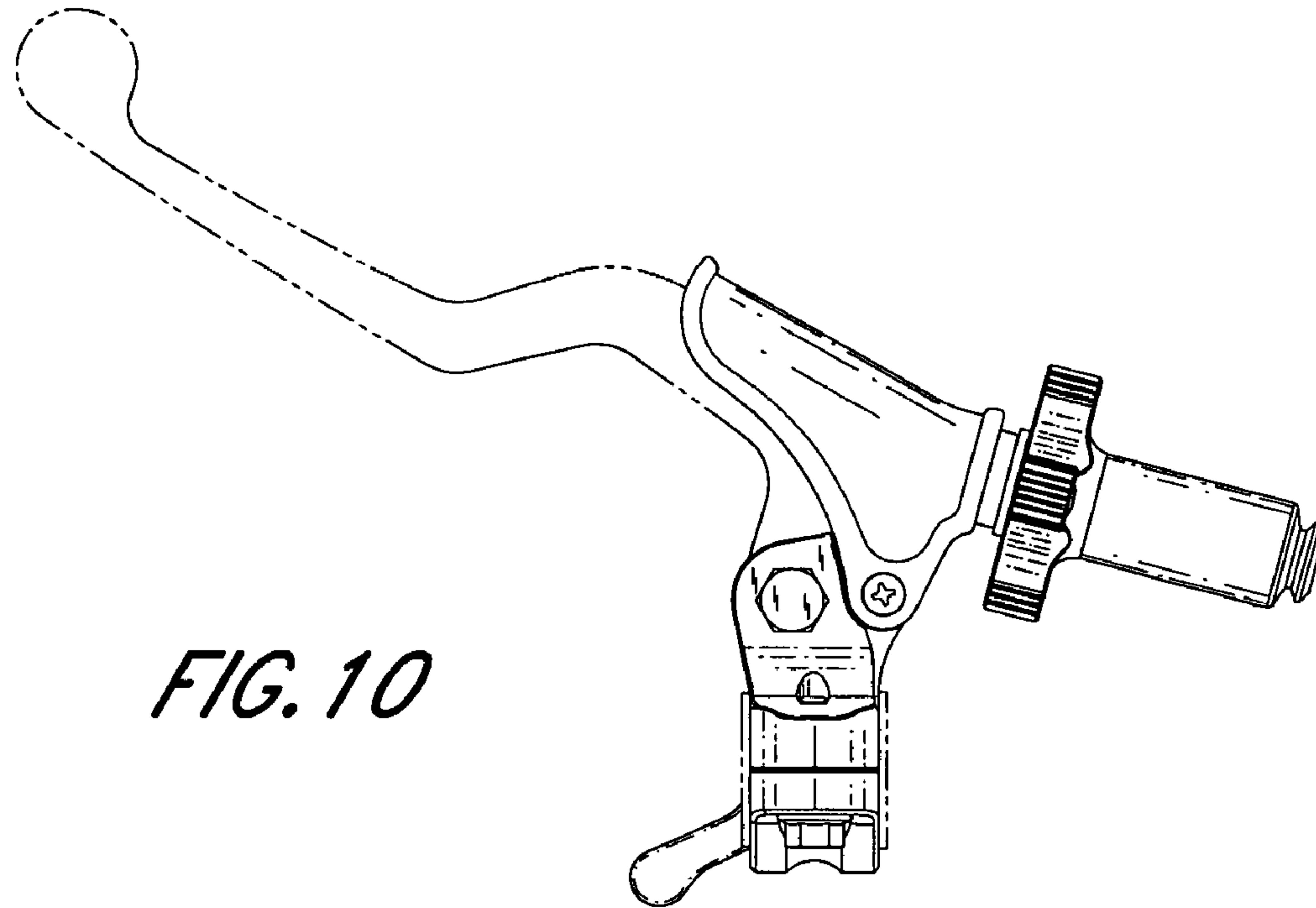


*FIG. 8*

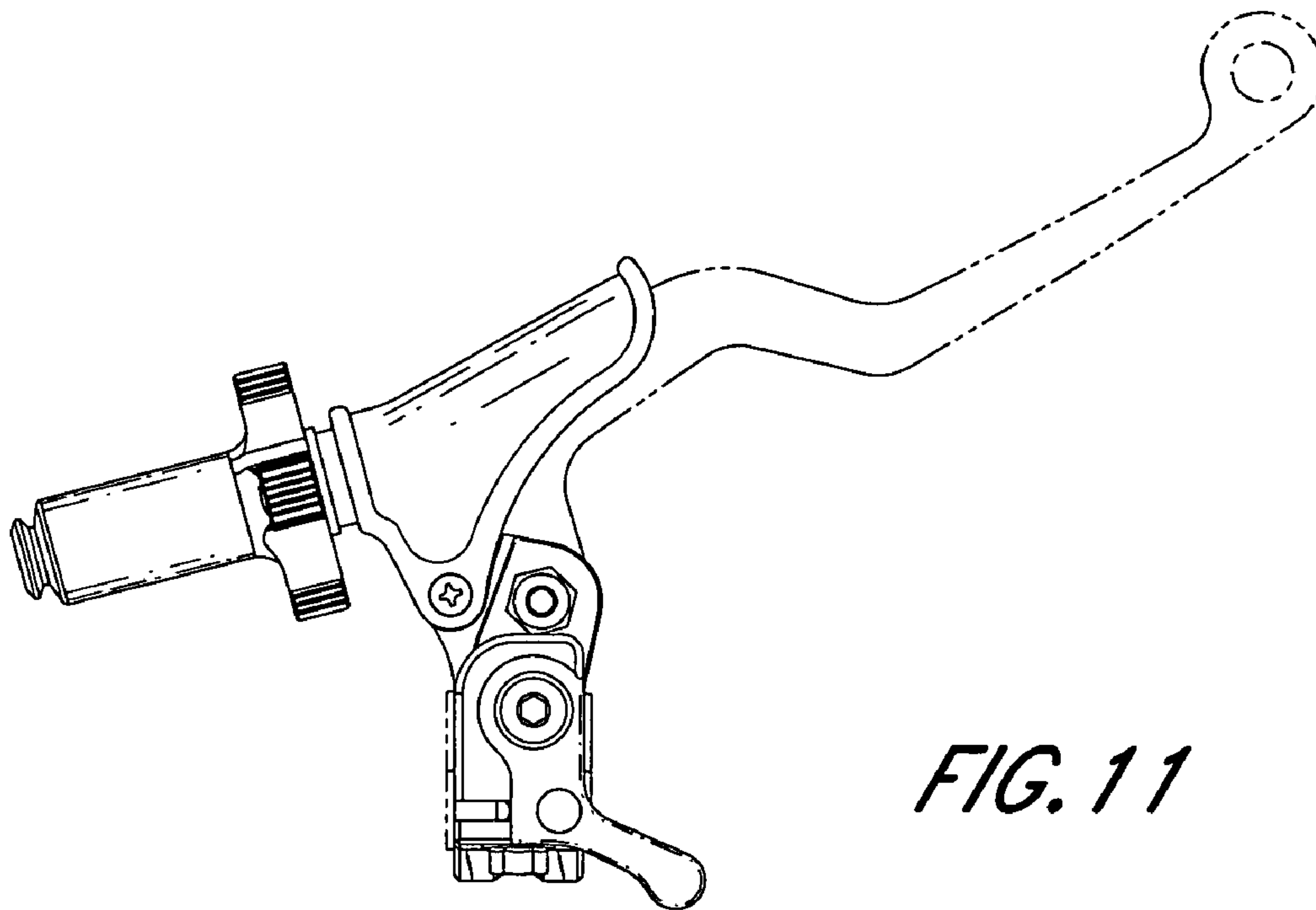


*FIG. 9*

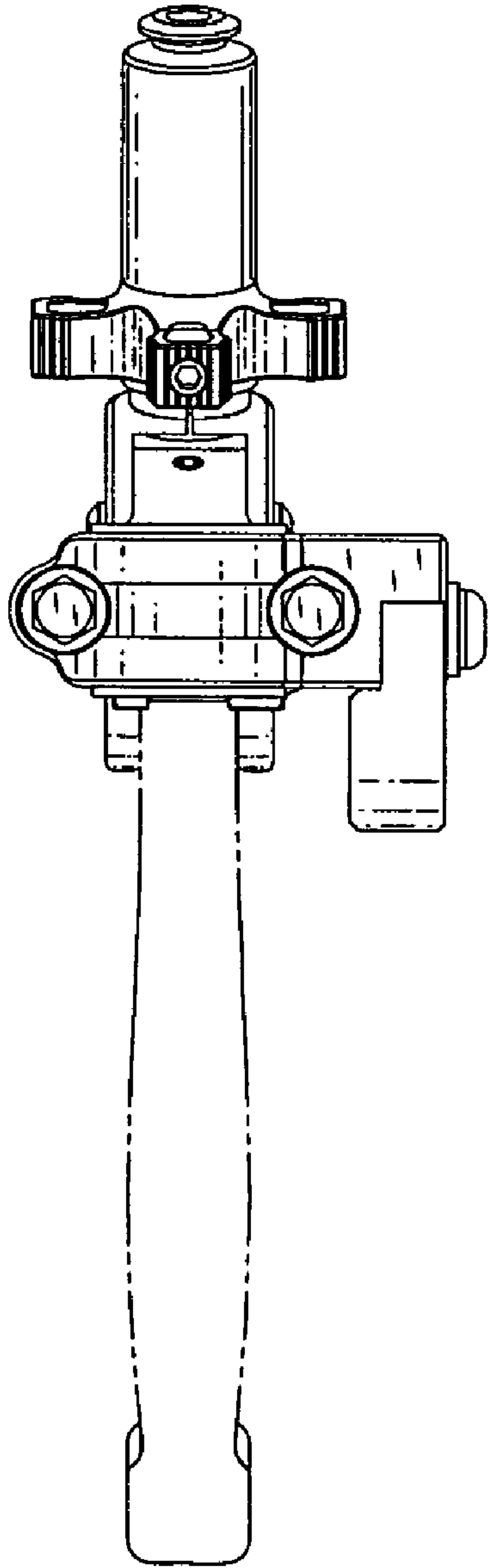




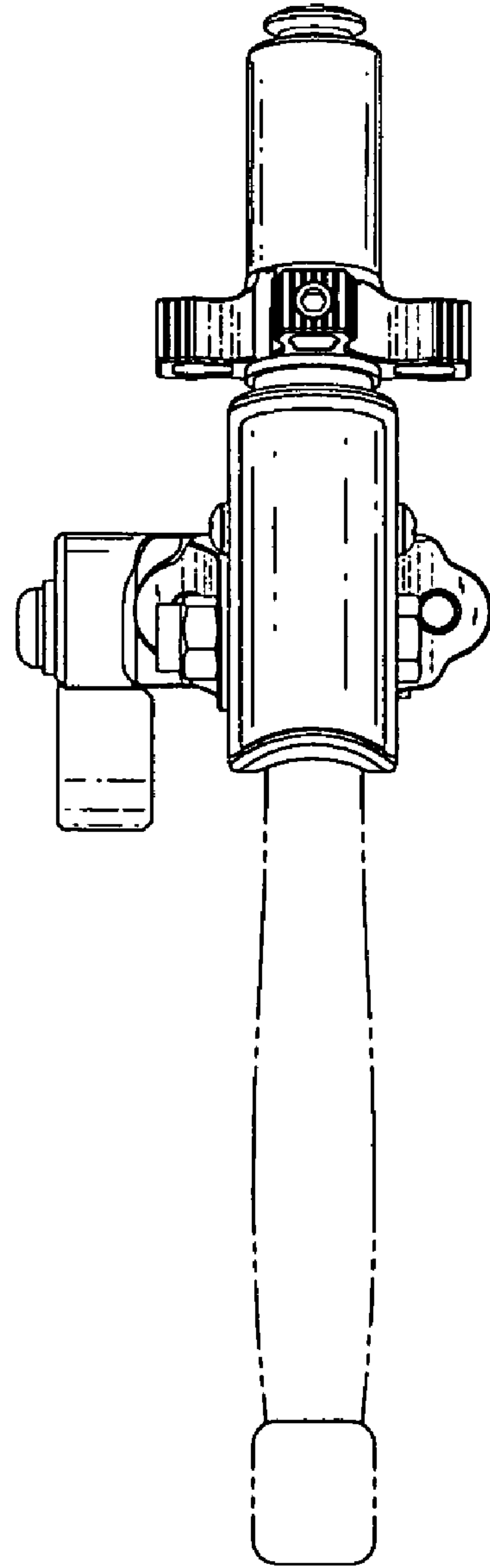
*FIG. 10*



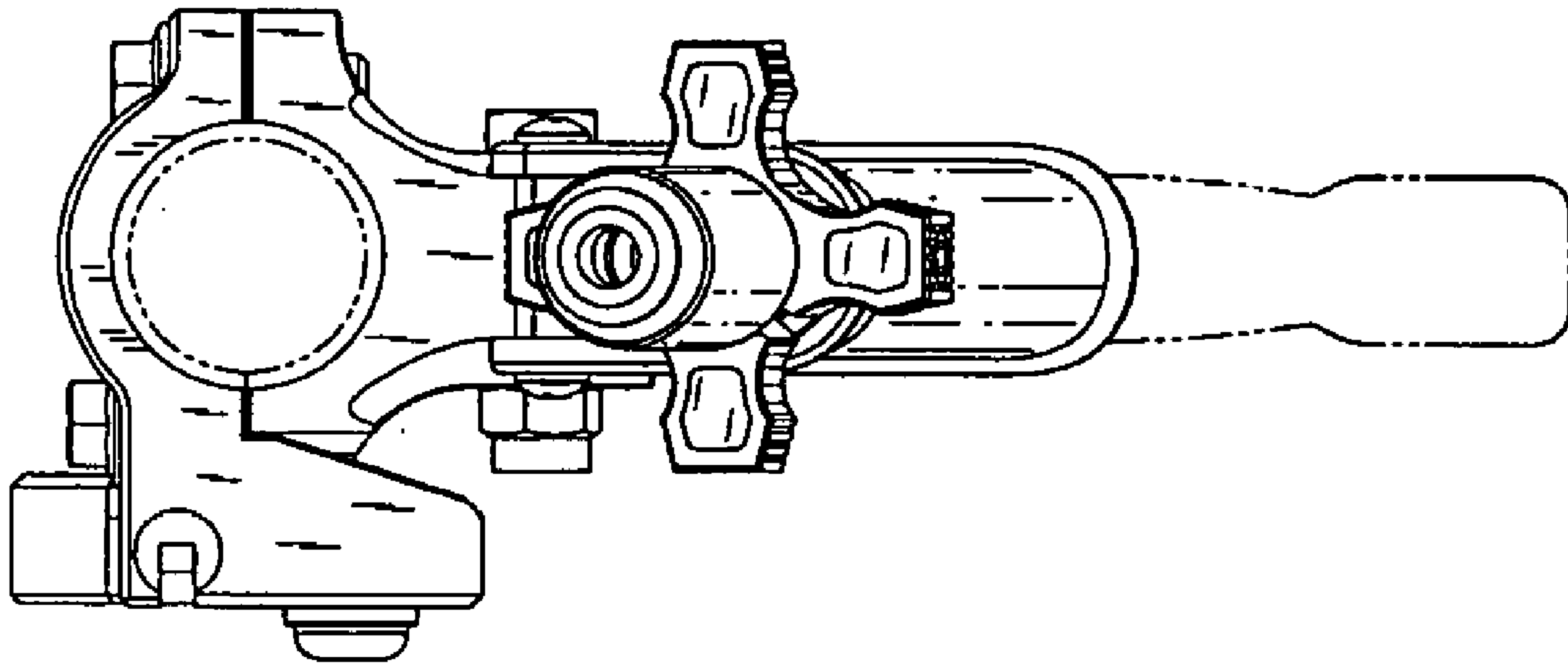
*FIG. 11*



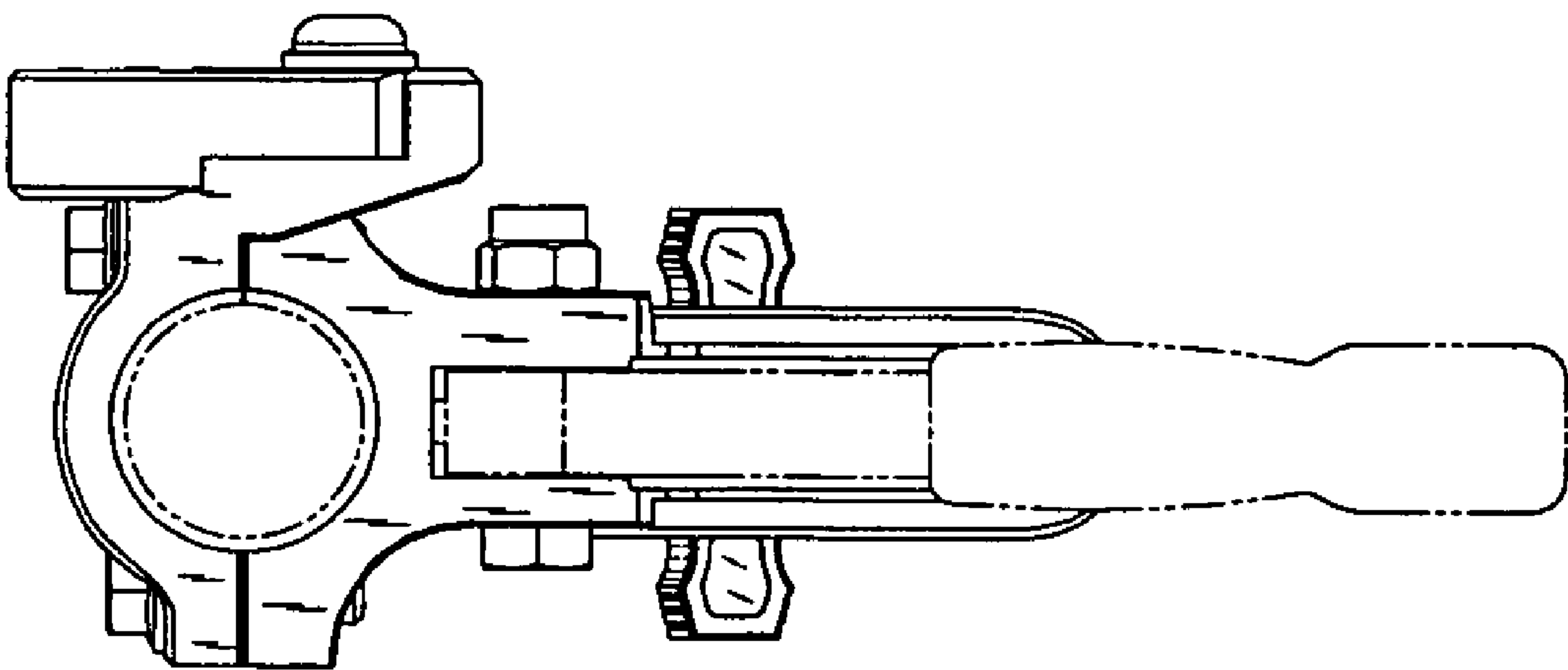
*FIG. 12*



*FIG. 13*



*FIG. 14*



*FIG. 15*