

US00D545129S

(12) **United States Design Patent**  
**Tien**

(10) **Patent No.:** **US D545,129 S**

(45) **Date of Patent:** **\*\* Jun. 26, 2007**

(54) **TUMBLER**

(75) Inventor: **Kuang-Hsia Tien**, Monrovia, CA (US)

(73) Assignee: **Sweda Company, LLC**, Monrovia, CA (US)

(\*\*) Term: **14 Years**

(21) Appl. No.: **29/238,426**

(22) Filed: **Sep. 15, 2005**

(51) **LOC (8) Cl.** ..... **07-01**

(52) **U.S. Cl.** ..... **D7/510; D7/533**

(58) **Field of Classification Search** ..... D7/392-394,  
D7/509-511, 523, 531-533, 536, 605, 608,  
D7/619.1, 622, 624.2; 215/382, 384, 386-388,  
215/392, 394, 396, 398, DIG. 7; 220/62.12,  
220/592.17, 669, 696, 710, 710.5, 711, 713,  
220/715, 719, 739

See application file for complete search history.

(56) **References Cited**

**U.S. PATENT DOCUMENTS**

- D119,862 S \* 4/1940 Lundy ..... D7/523
- 3,108,707 A \* 10/1963 Kend ..... 206/457
- D200,018 S \* 1/1965 Brocken ..... D7/321
- D279,083 S \* 6/1985 Gray ..... D11/152
- D283,677 S \* 5/1986 Fortuna et al. .... D9/500
- 4,624,384 A \* 11/1986 Ko ..... 220/212
- D362,156 S \* 9/1995 Goto et al. .... D7/511
- D371,936 S \* 7/1996 Goto et al. .... D7/523
- D398,815 S \* 9/1998 Hatsumoto et al. .... D7/533

- D404,613 S \* 1/1999 Hatsumoto et al. .... D7/510
- D410,174 S \* 5/1999 Sheu ..... D7/510
- D422,179 S \* 4/2000 Stephenson ..... D7/510
- D438,757 S \* 3/2001 Joergensen ..... D7/510
- D439,473 S \* 3/2001 Lin ..... D7/510
- D483,995 S \* 12/2003 Otake ..... D7/523
- D486,996 S \* 2/2004 Karp ..... D7/510
- D509,408 S \* 9/2005 Ward et al. .... D7/523
- D509,707 S \* 9/2005 Tien ..... D7/510
- D511,653 S \* 11/2005 Oas ..... D7/507
- D534,038 S \* 12/2006 Kramer et al. .... D7/510
- D534,770 S \* 1/2007 Gluck ..... D7/532
- D535,524 S \* 1/2007 Kramer ..... D7/533

\* cited by examiner

*Primary Examiner*—T. Chase Nelson

*Assistant Examiner*—Karen Acker

(74) *Attorney, Agent, or Firm*—Clement Cheng

(57) **CLAIM**

The ornamental design for a tumbler, as shown and described.

**DESCRIPTION**

FIG. 1 is a front perspective view of the tumbler.

FIG. 2 is a top perspective view of the tumbler.

FIG. 3 is a bottom perspective view of the tumbler.

FIG. 4 is a left side perspective view of the tumbler.

FIG. 5 is a right side perspective view of the tumbler; and,

FIG. 6 is another front perspective view of the tumbler.

**1 Claim, 3 Drawing Sheets**

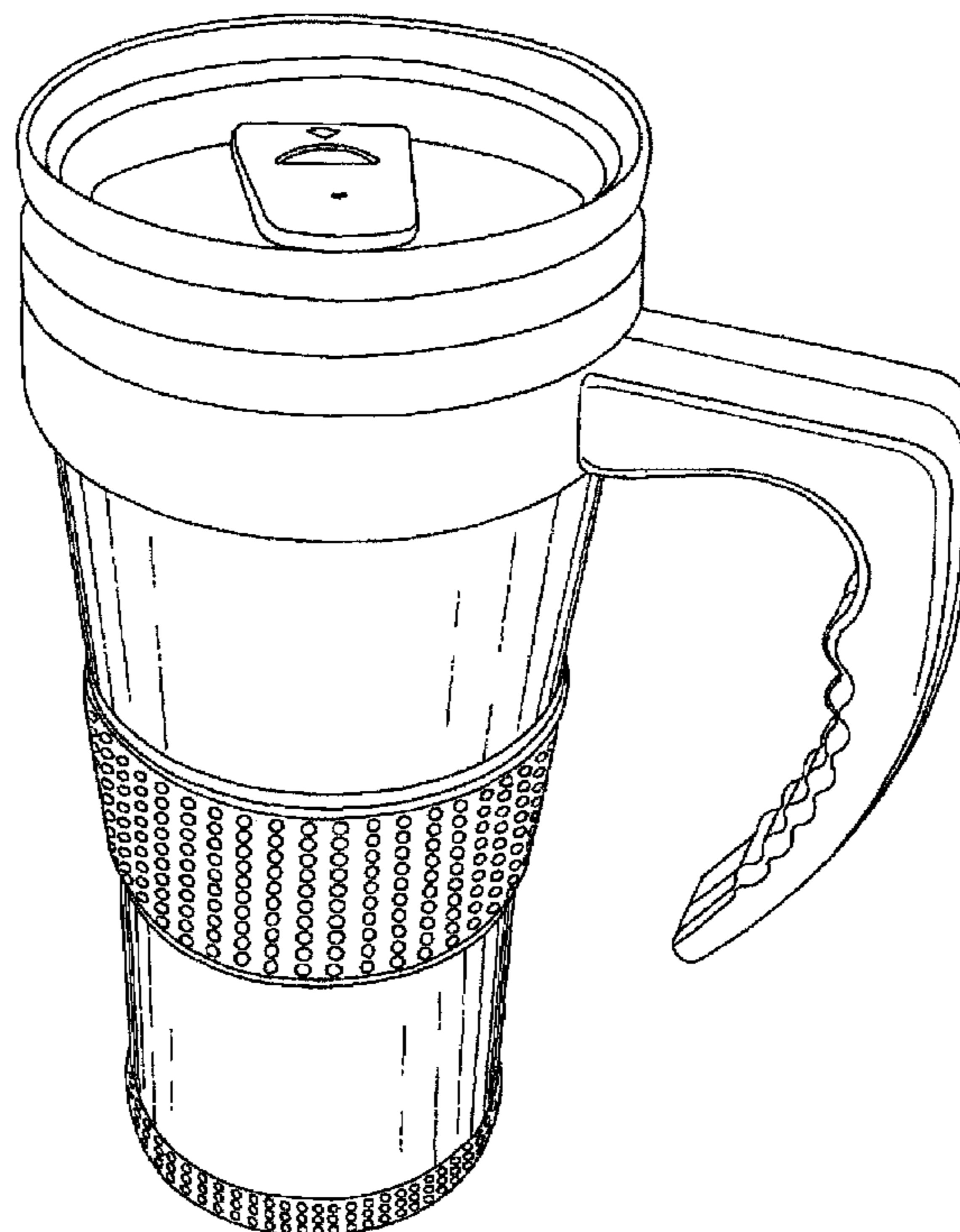

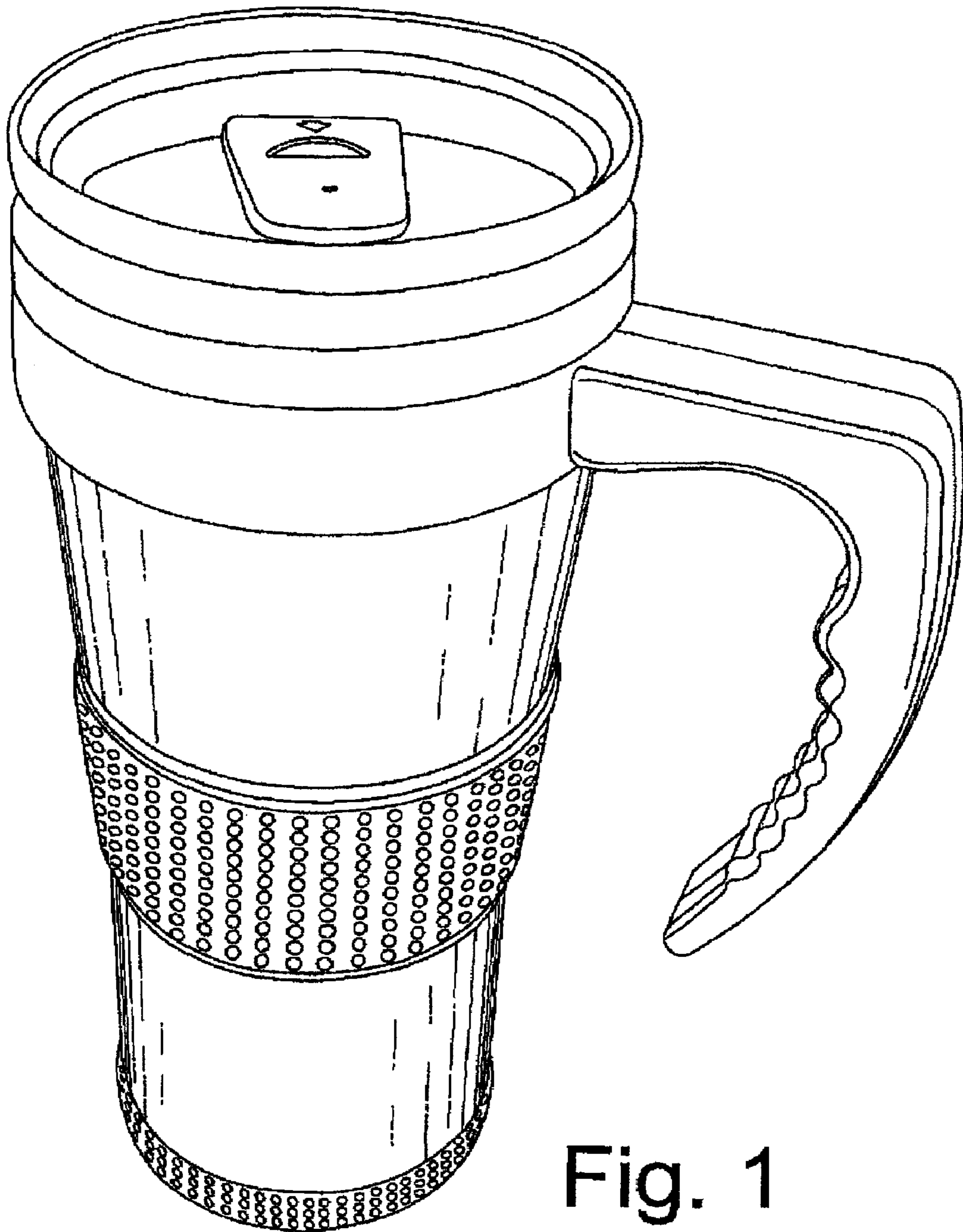

Fig. 1

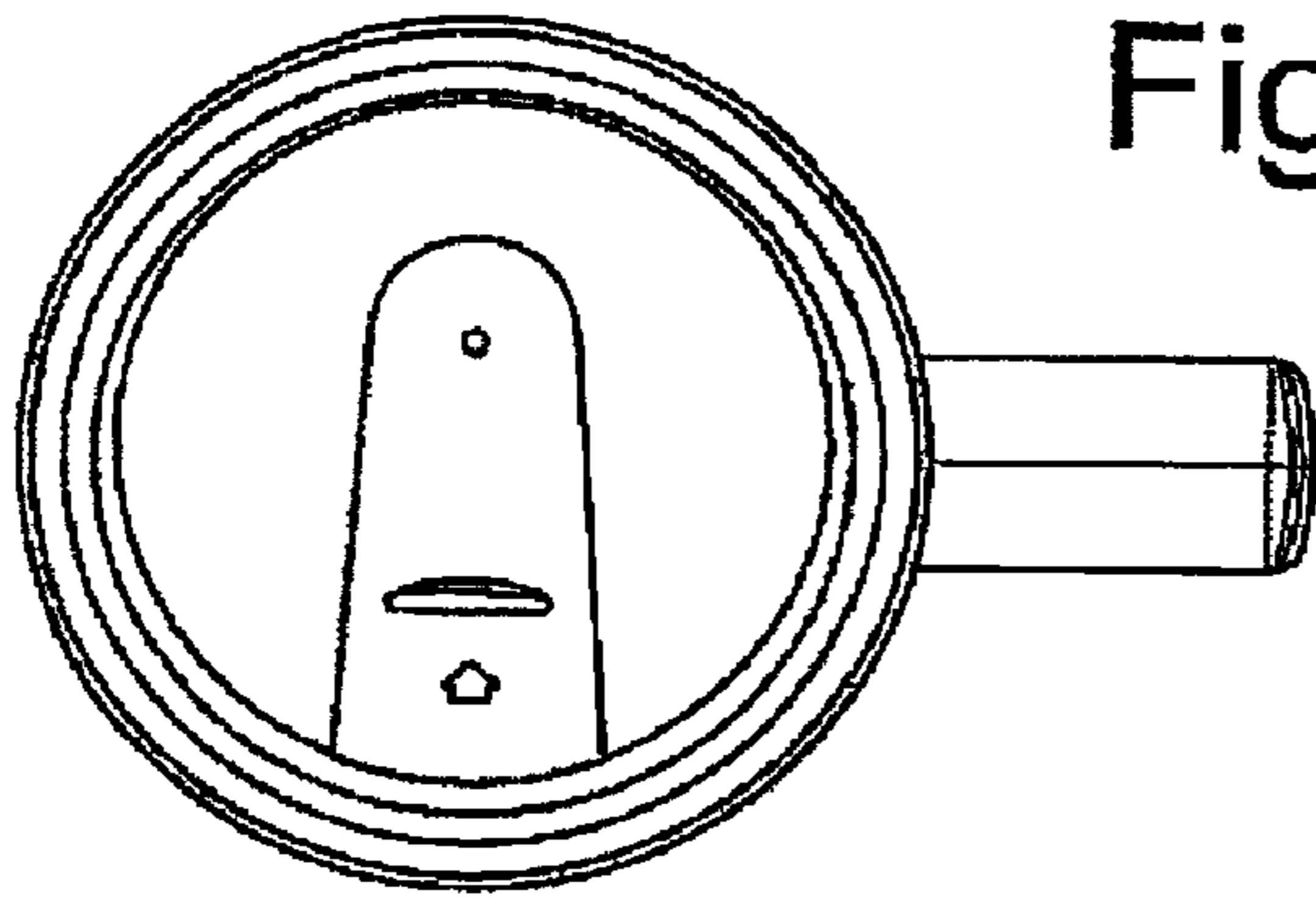

Fig. 2

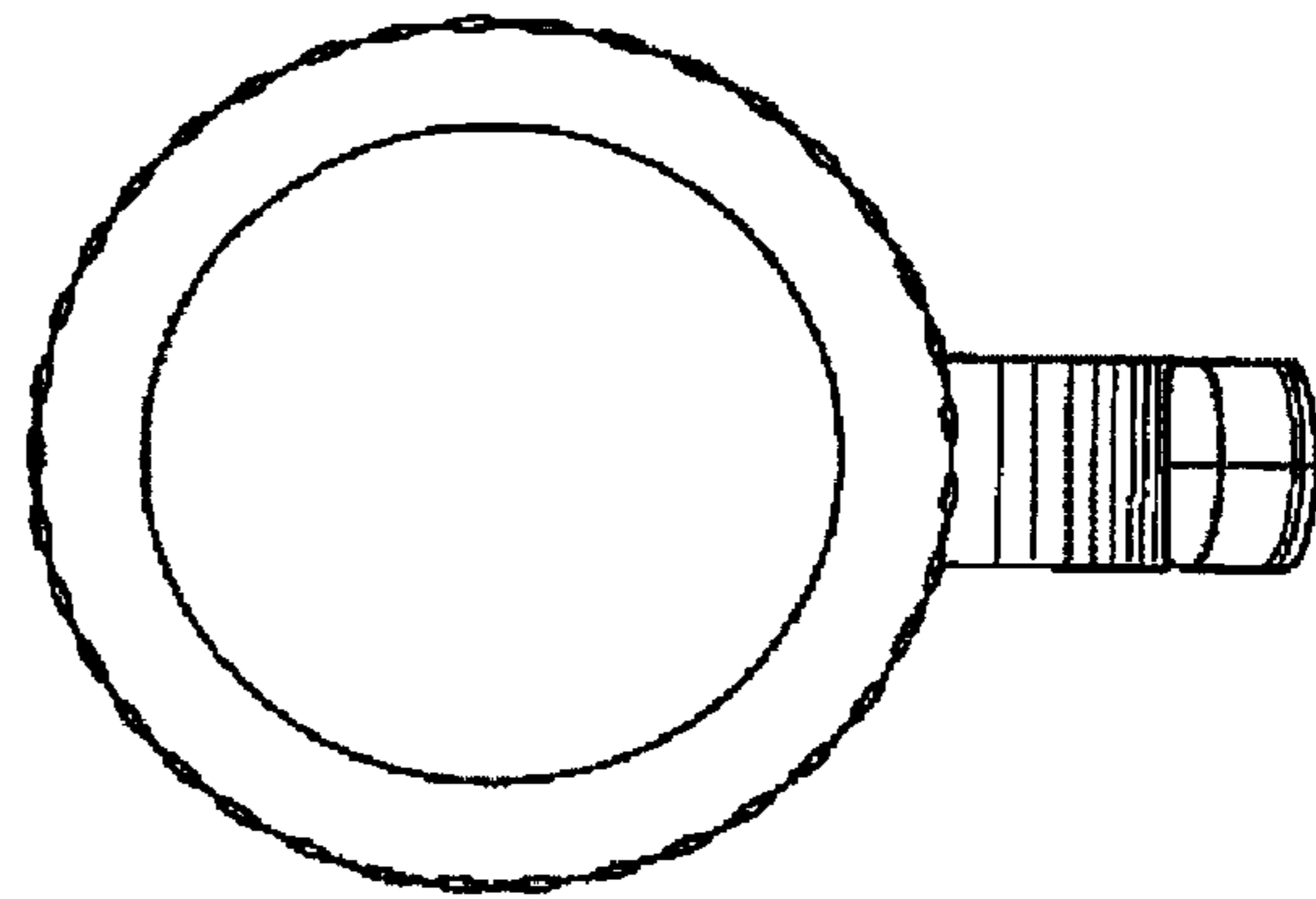

Fig. 3

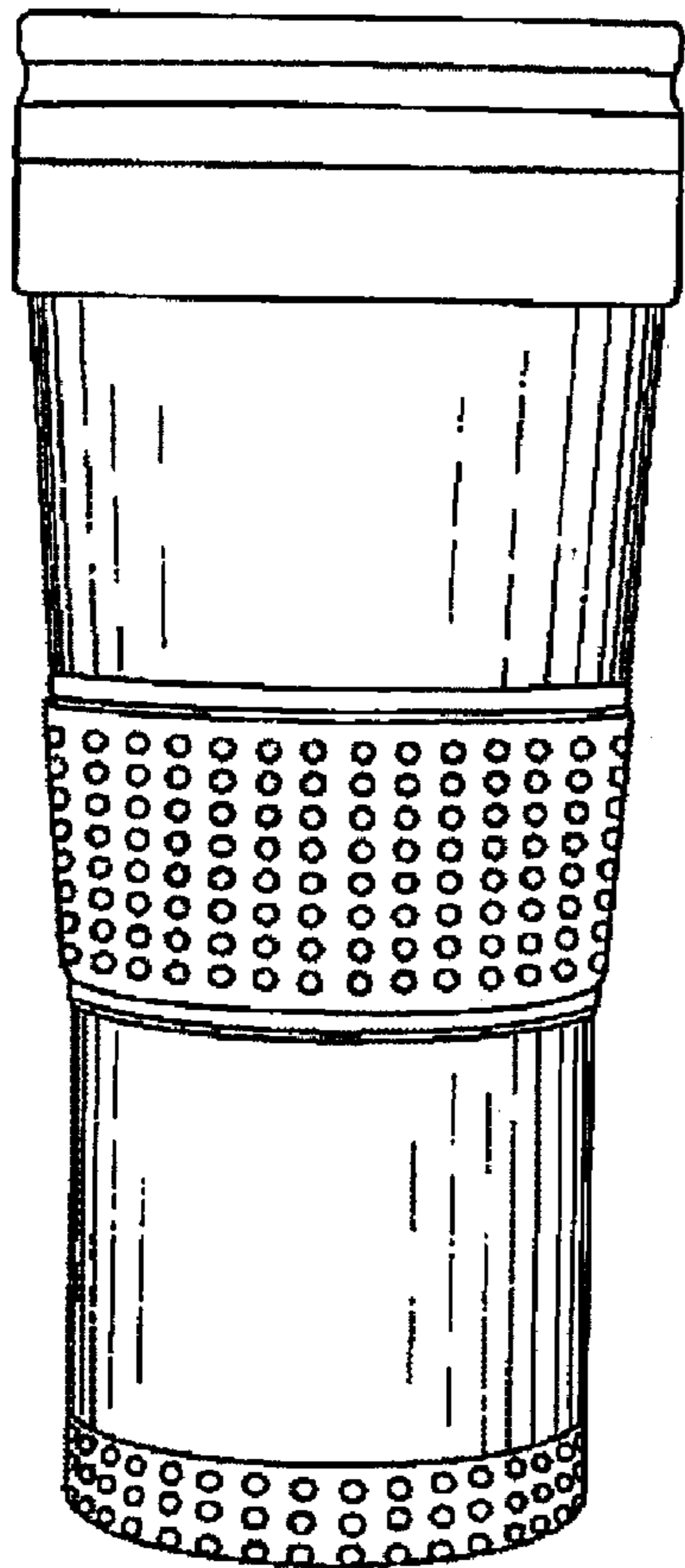

Fig. 4

Fig. 5

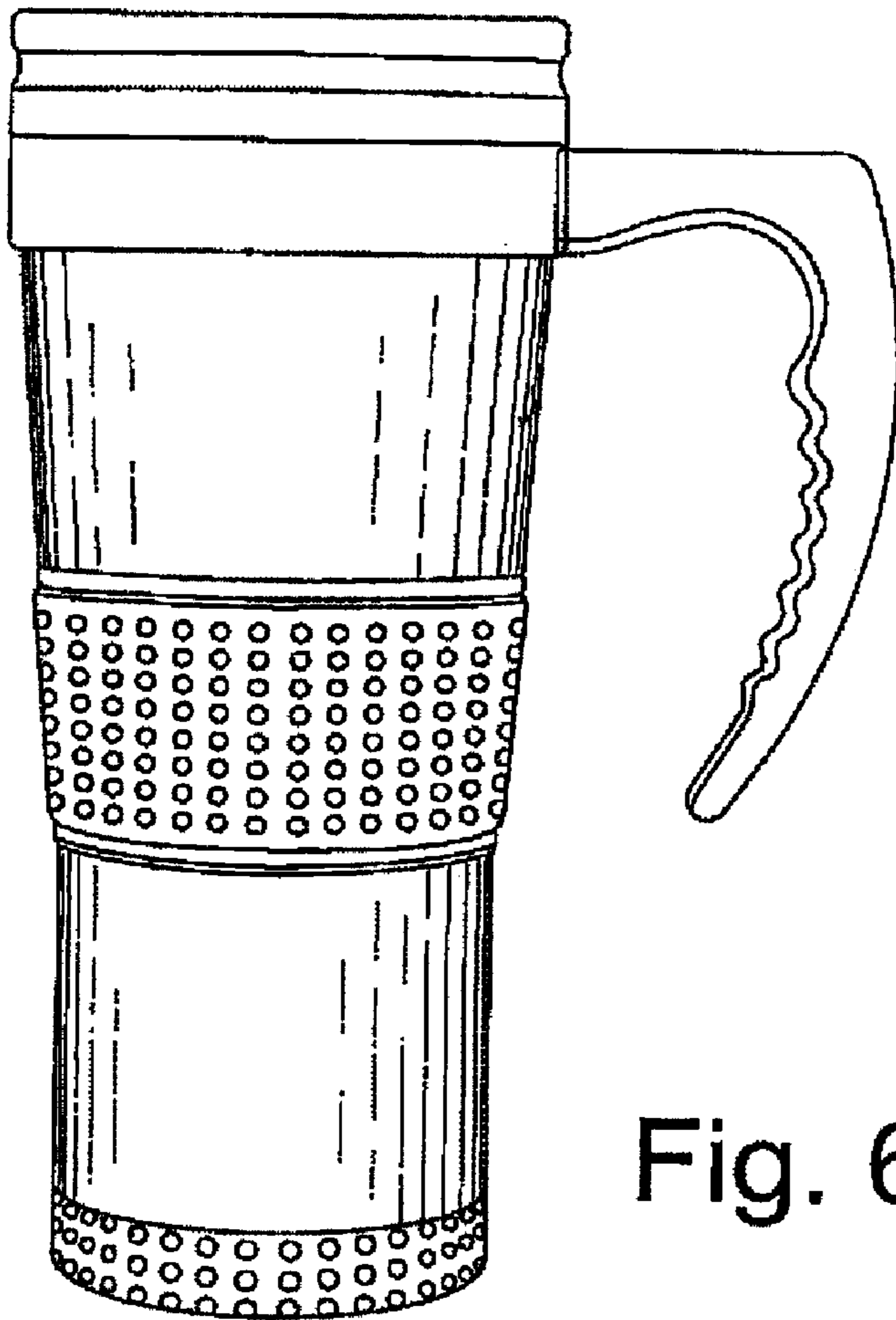
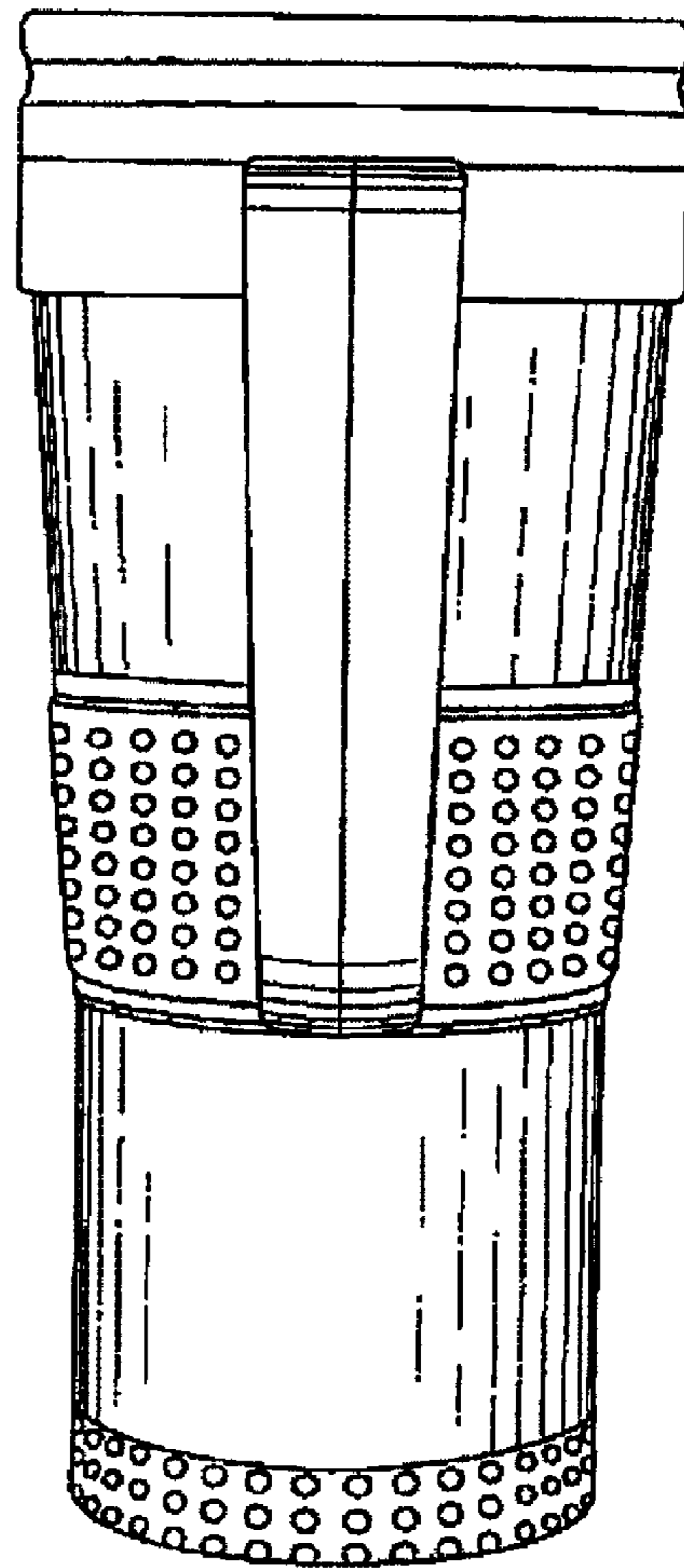

Fig. 6