



US00D541539S

(12) **United States Design Patent**  
**Basset et al.**

(10) **Patent No.:** **US D541,539 S**

(45) **Date of Patent:** **\*\* May 1, 2007**

(54) **SEAT**

(75) Inventors: **Damien B. Basset**, Los Angeles, CA (US); **Hideaki Yamazumi**, Torrance, CA (US); **Asao Itaya**, Torrance, CA (US); **Darin King**, Raymond, OH (US); **Stephen Hlopick**, Marysville, OH (US); **Michael Peterson**, Marysville, OH (US); **Michio Nakamura**, Marysville, OH (US)

(73) Assignee: **Honda Motor Company, Ltd.**, Tokyo (JP)

(\*\*) Term: **14 Years**

(21) Appl. No.: **29/226,842**

(22) Filed: **Apr. 1, 2005**

(51) **LOC (8) Cl.** ..... **06-01**

(52) **U.S. Cl.** ..... **D6/354**

(58) **Field of Classification Search** ..... D6/354;  
D12/87, 107, 110; 180/225, 229, 233, 311,  
180/312, 315; 297/195.1, 196-215, 215.1-215.16  
See application file for complete search history.

(56) **References Cited**

**U.S. PATENT DOCUMENTS**

D276,033 S	*	10/1984	Ohba et al.	.....	D12/110
D276,328 S	*	11/1984	Ishiyama	.....	D12/110
4,917,207 A	*	4/1990	Yasui et al.	.....	180/312
D312,807 S	*	12/1990	Kohama et al.	.....	D12/110
D330,694 S	*	11/1992	Kimura et al.	.....	D12/107
D349,078 S	*	7/1994	Kimura et al.	.....	D12/107
D445,363 S	*	7/2001	Luh	.....	D12/107
D482,639 S	*	11/2003	Yamamoto et al.	.....	D12/110
D513,396 S	*	1/2006	Lin	.....	D12/107

**OTHER PUBLICATIONS**

Yamaha 2003 Utility ATV's sales catalog, seat on the Kodiak 450 Automatic 4WD, © 2002, page unnumbered.\*  
Zipwear motorized cycle seats, © 2003. [Retrieved on Feb. 8, 2006]. Retrieved from the Internet <URL: http://www.zipracing.co.uk/covers3.htm.>.\*

\* cited by examiner

*Primary Examiner*—Alan P. Douglas

*Assistant Examiner*—Linda Brooks

(74) *Attorney, Agent, or Firm*—Dinsmore & Shohl LLP

(57) **CLAIM**

The ornamental design for a seat, as shown and described.

**DESCRIPTION**

FIG. 1 is a left rear perspective view of a seat;  
FIG. 2 is a left side elevational view of the seat of FIG. 1;  
FIG. 3 is a bottom plan view of the seat of FIG. 1;  
FIG. 4 is a left front perspective view of the seat of FIG. 1 on a reduced scale provided upon an exemplary four wheeled vehicle;  
FIG. 5 is a left rear perspective view of the seat of FIG. 4 provided upon the exemplary four wheeled vehicle;  
FIG. 6 is a rear perspective view of the seat of FIG. 4 provided upon the exemplary four wheeled vehicle;  
FIG. 7 is a left side perspective view of the seat of FIG. 4 provided upon the exemplary four wheeled vehicle;  
FIG. 8 is a right side perspective view of the seat of FIG. 4 provided upon the exemplary four wheeled vehicle; and,  
FIG. 9 is a top perspective view of the seat of FIG. 4 provided upon the exemplary four wheeled vehicle.  
The phantom lines and areas shown in the figures are for illustrative purposes only and form no part of the claimed design.

**1 Claim, 9 Drawing Sheets**

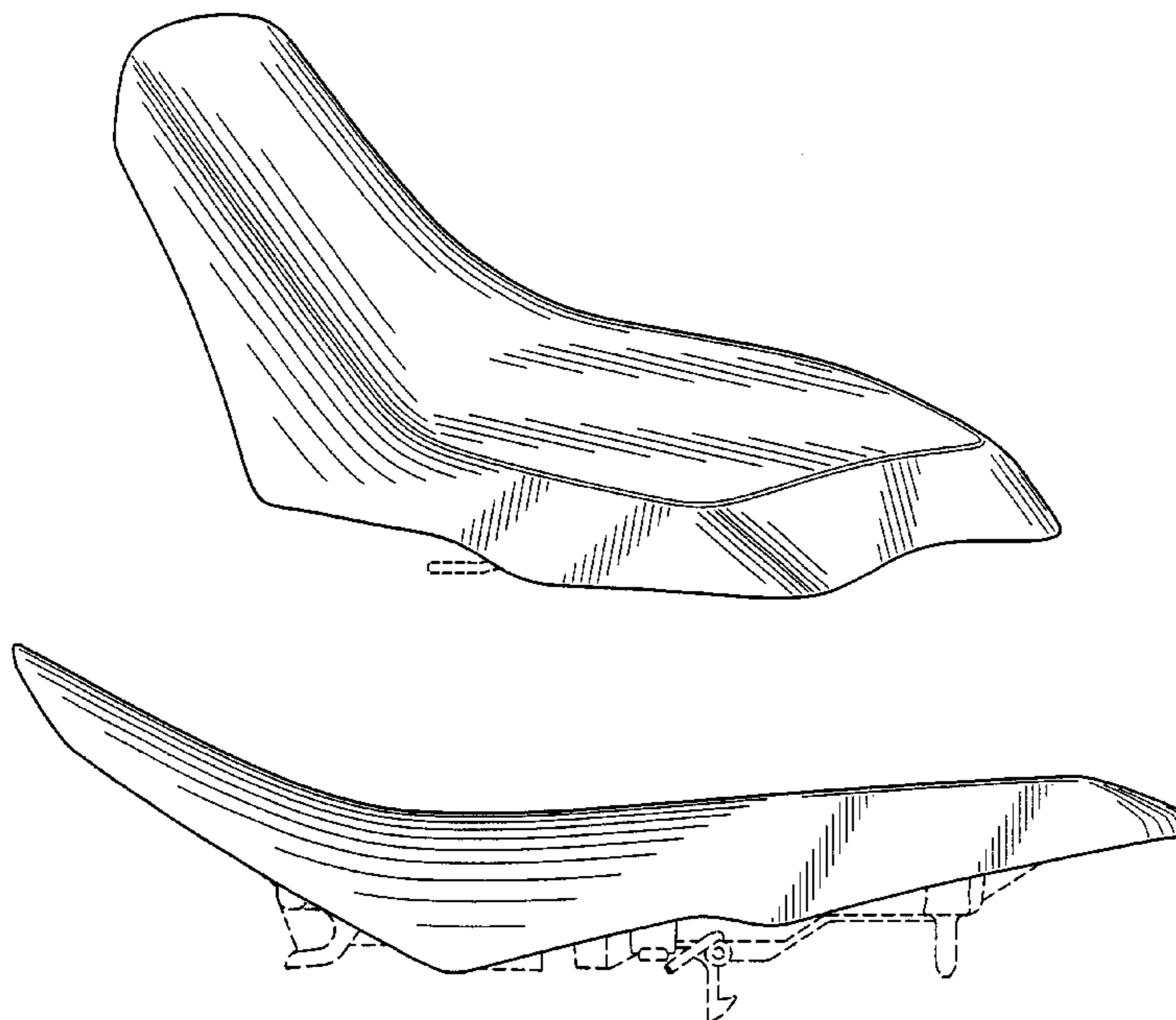

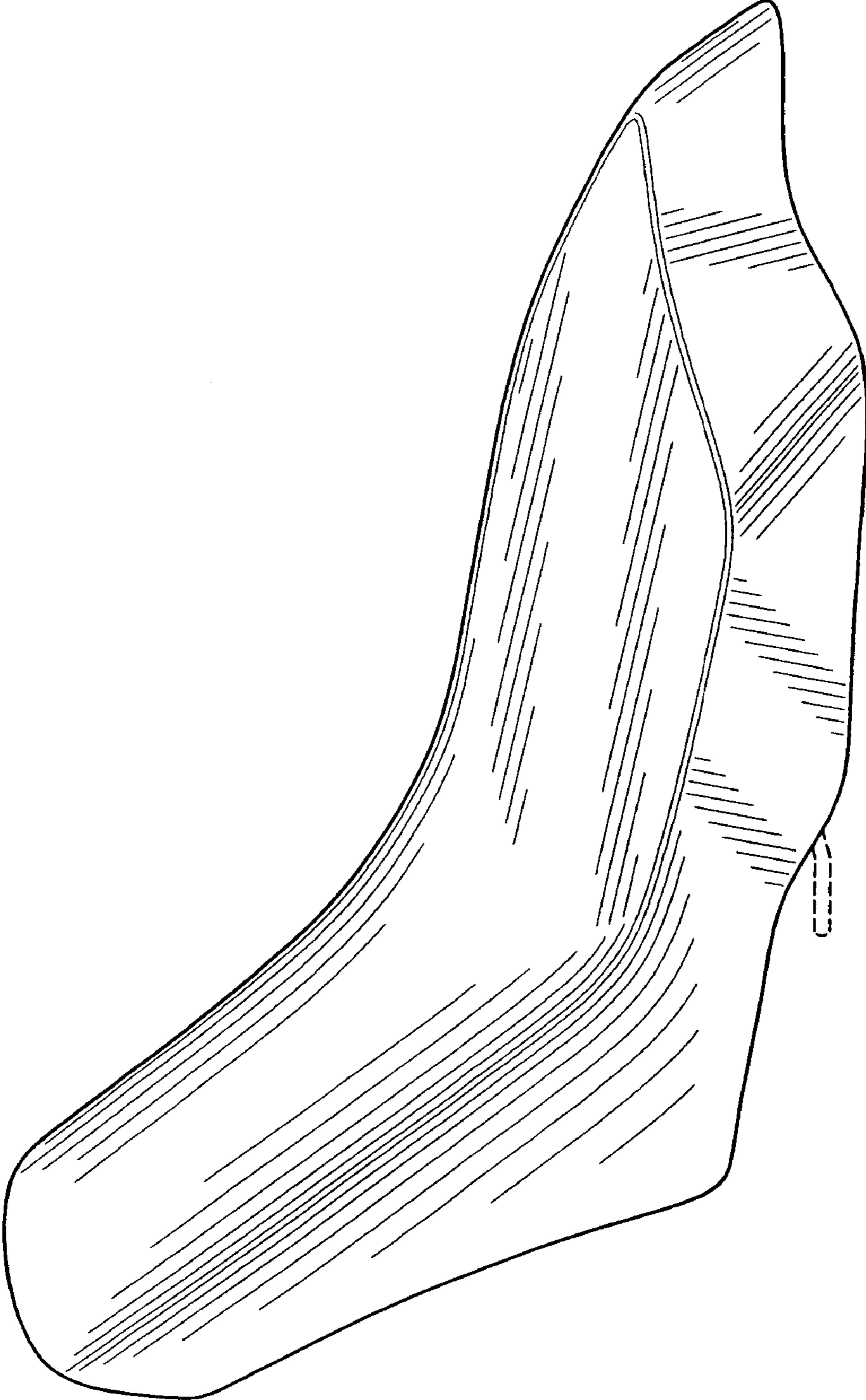

FIG. 1

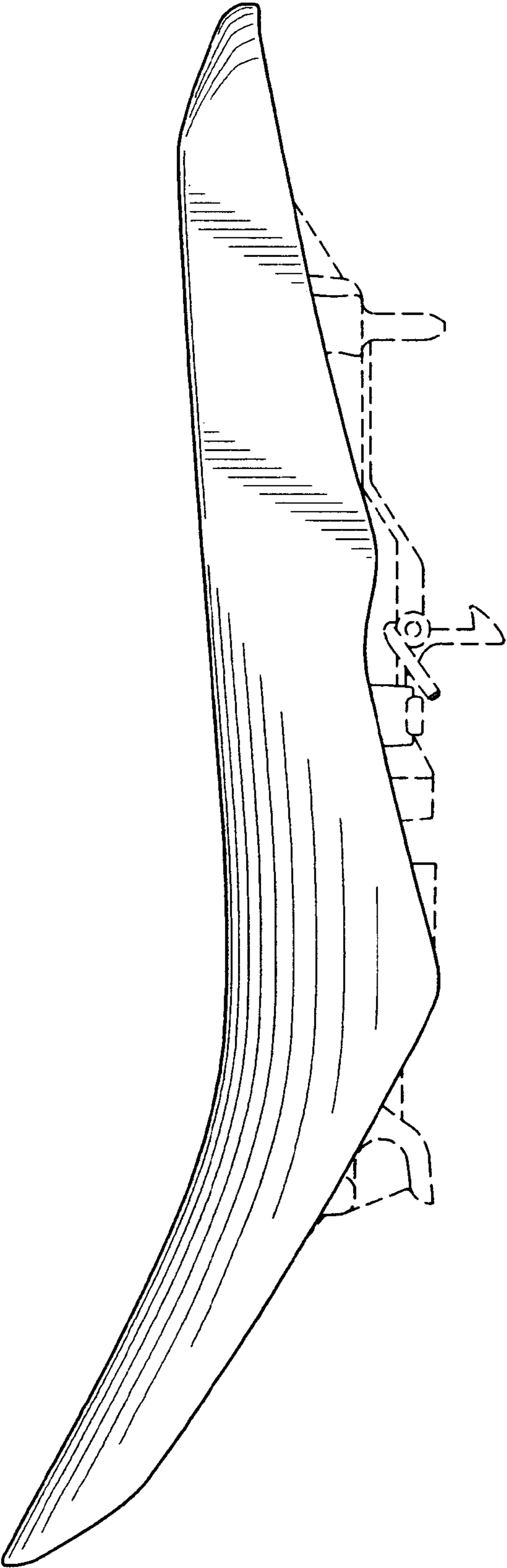

FIG. 2

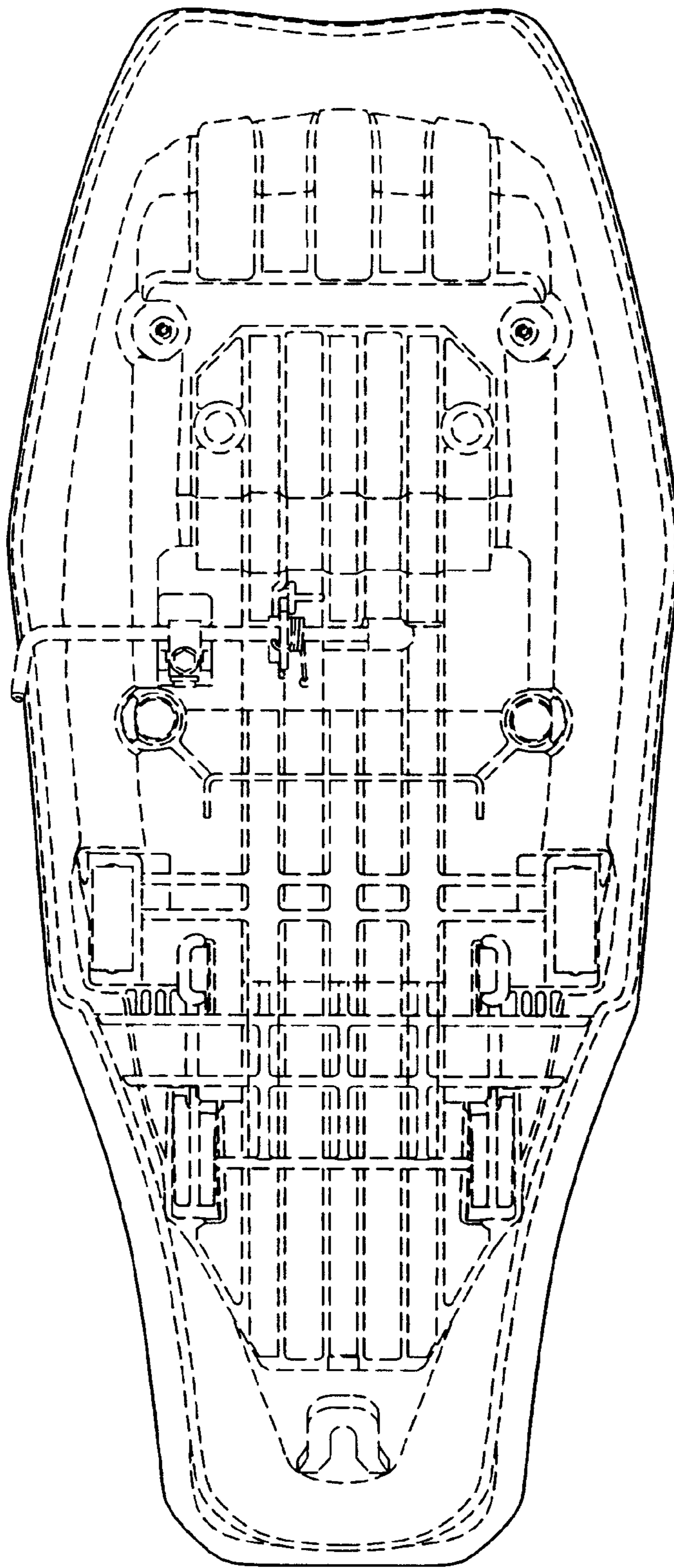

FIG. 3

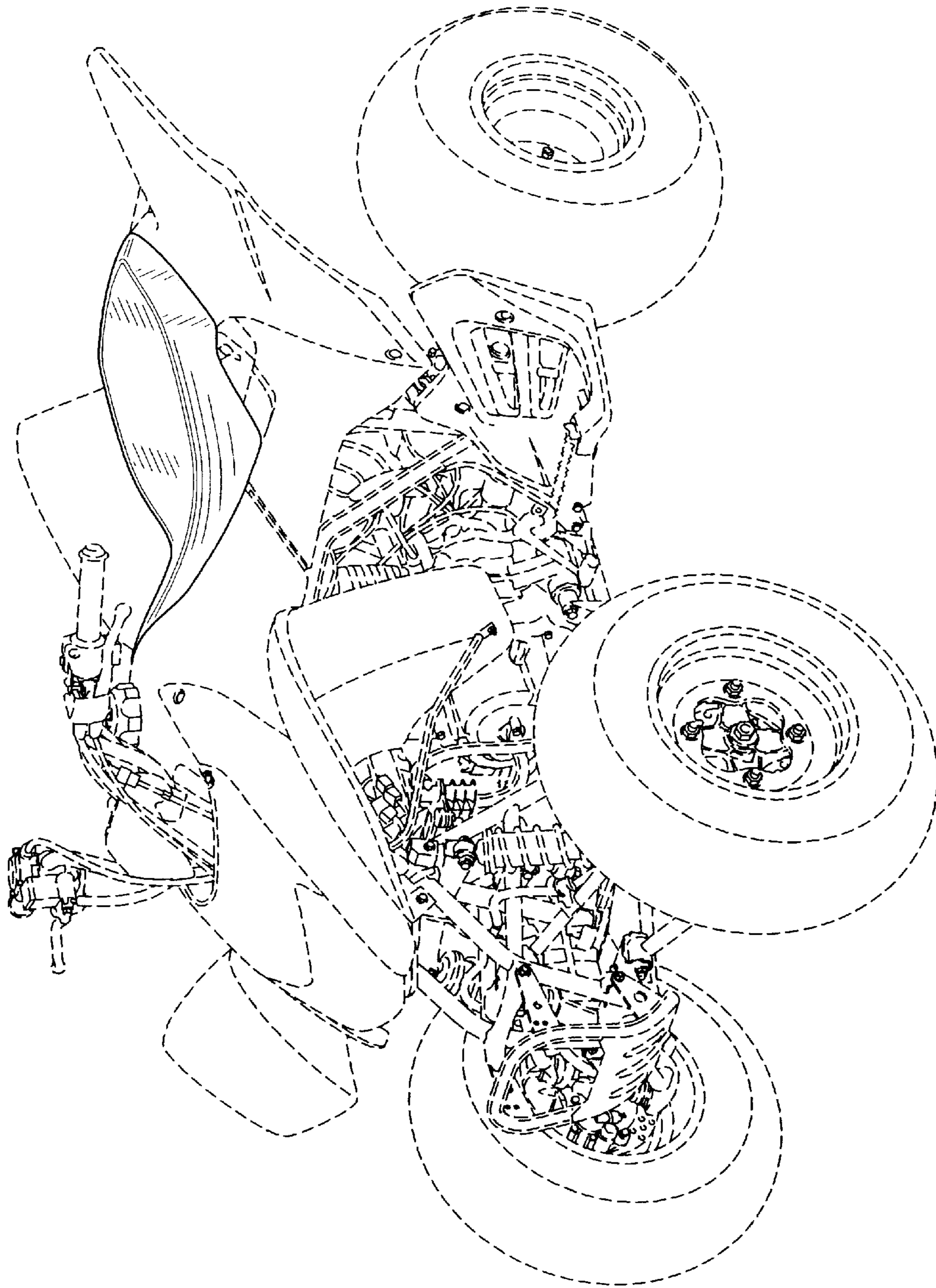

FIG. 4

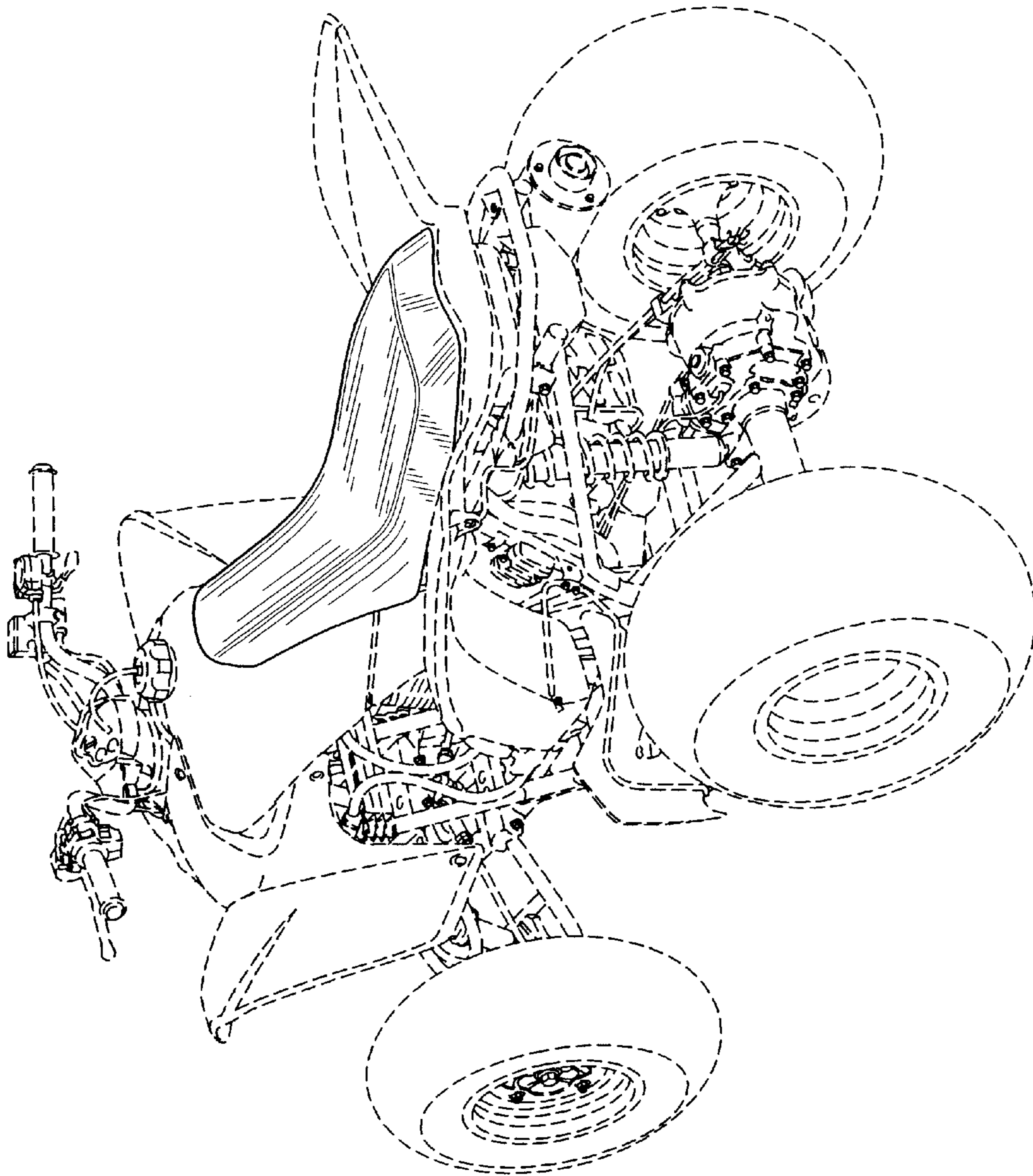

FIG. 5

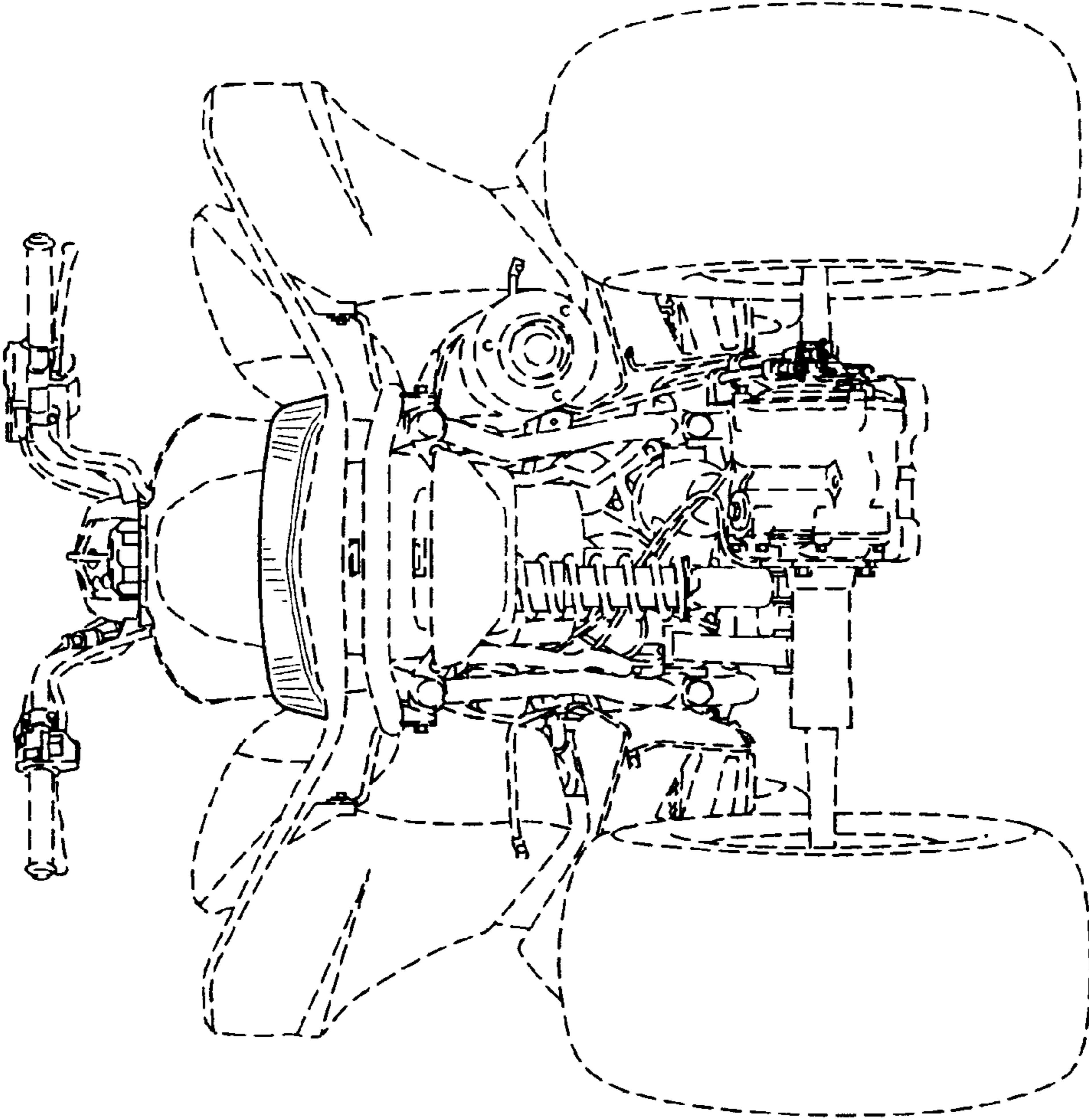

FIG. 6

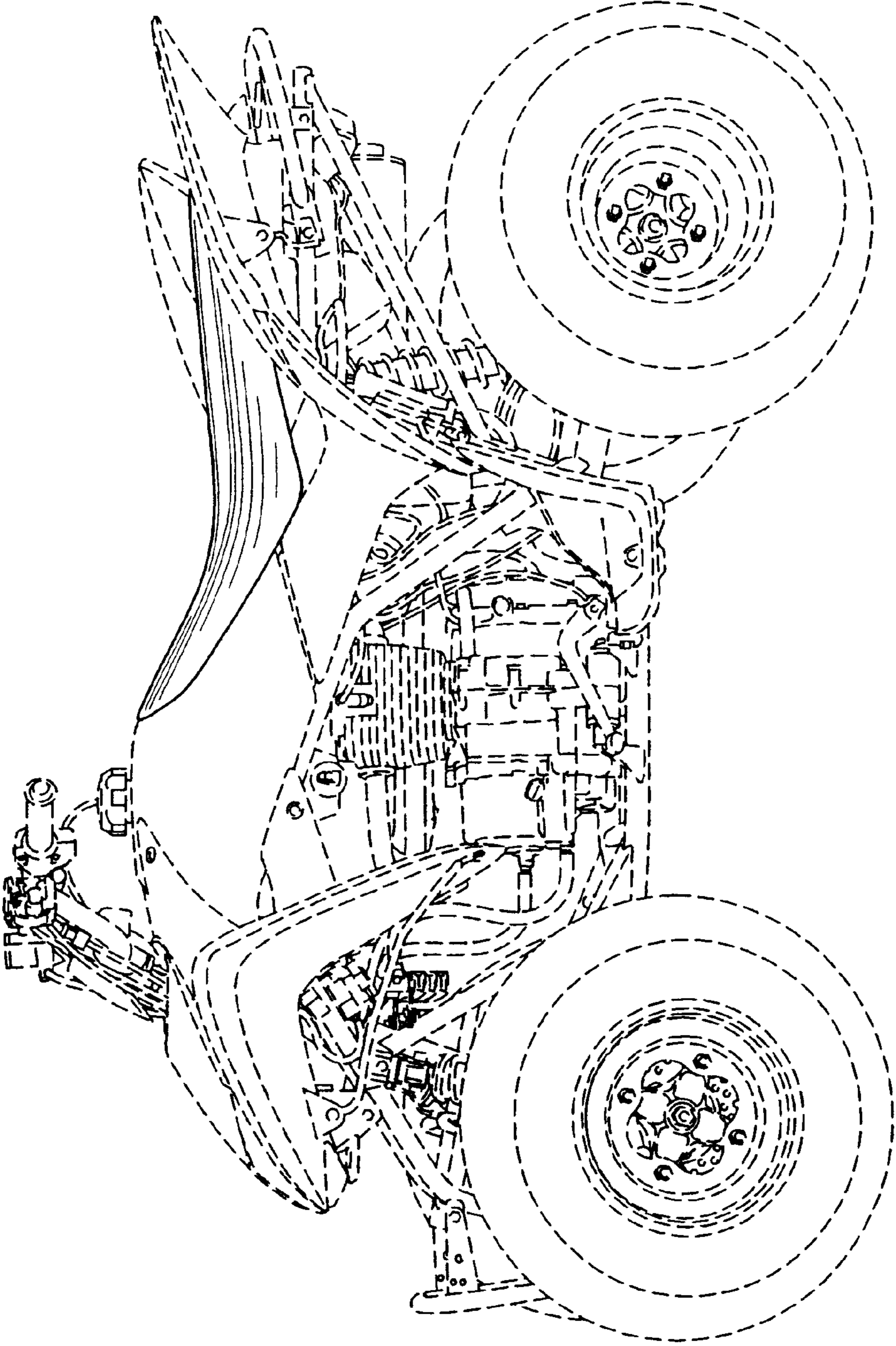

FIG. 7



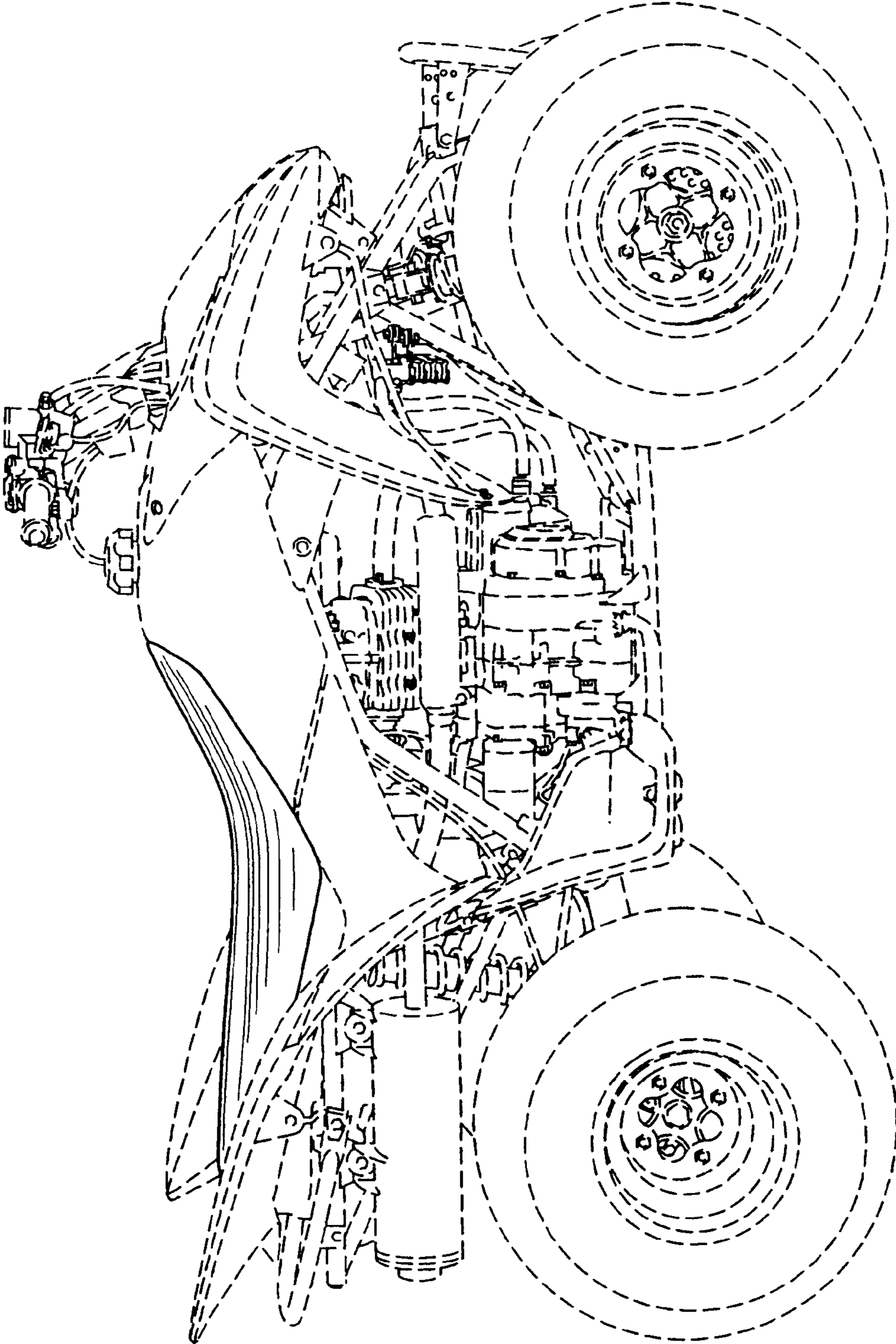

FIG. 8

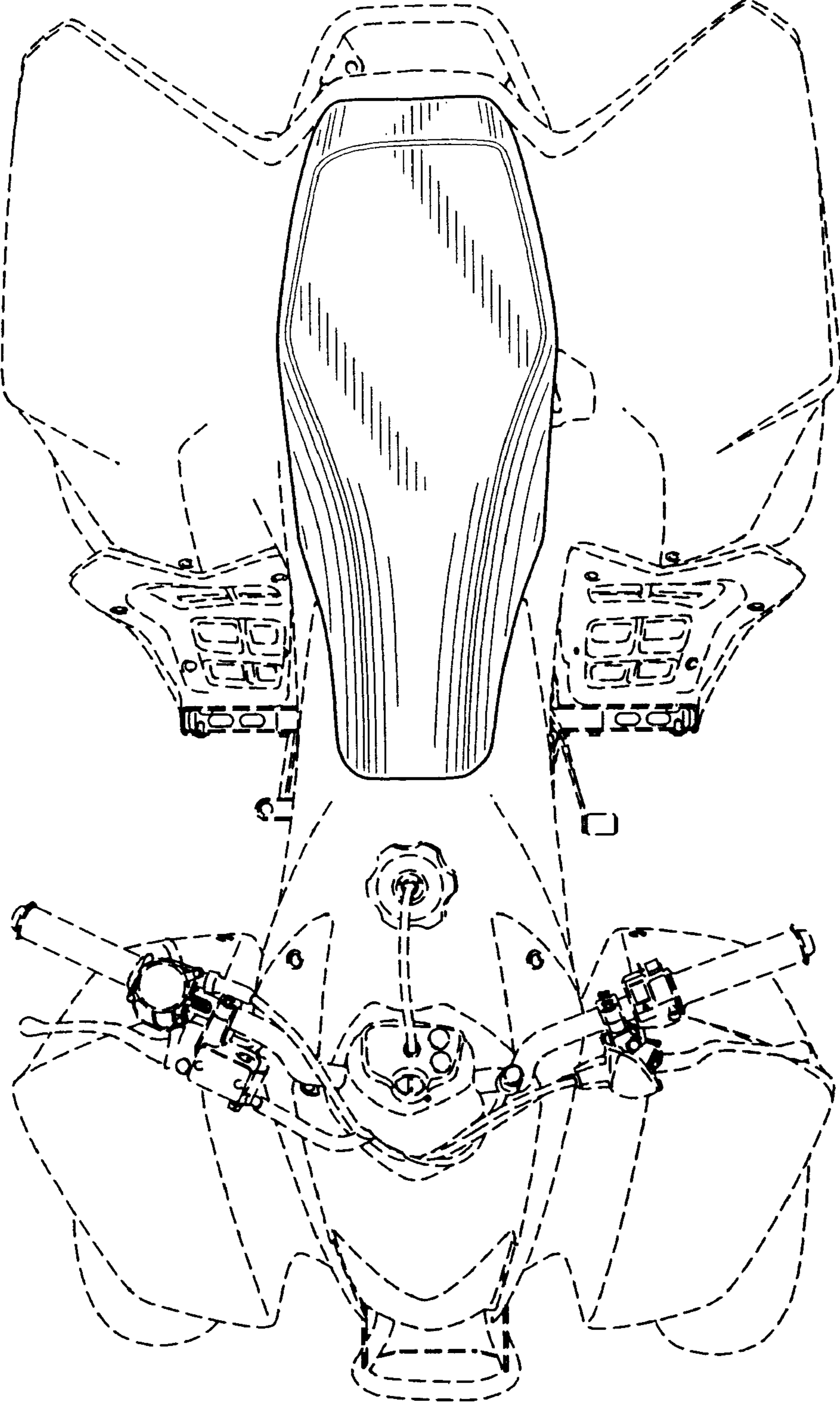

FIG. 9