



US00D540706S

(12) **United States Design Patent**  
**Soetenga et al.**

(10) **Patent No.:** **US D540,706 S**

(45) **Date of Patent:** **\*\* Apr. 17, 2007**

(54) **HEIGHT INDICATOR**

D488,731 S \* 4/2004 Barr ..... D10/69

(75) Inventors: **Dowie Soetenga**, West Allis, WI (US);  
**Ronald White**, North Prairie, WI (US)

\* cited by examiner

*Primary Examiner*—Antoine D. Davis

*Assistant Examiner*—Patricia Palasik

(73) Assignee: **Russell Corporation**, Atlanta, GA (US)

(\*\*) Term: **14 Years**

(57) **CLAIM**

The ornamental design for a height indicator, as shown and described.

(21) Appl. No.: **29/235,201**

(22) Filed: **Jul. 29, 2005**

**DESCRIPTION**

(51) **LOC (8) Cl.** ..... **10-04**

(52) **U.S. Cl.** ..... **D10/69**

(58) **Field of Classification Search** ..... D10/65,  
D10/69; 33/365–390

See application file for complete search history.

FIG. 1 is a perspective view of a height indicator embodying our design;

FIG. 2 is a front elevational view thereof;

FIG. 3 is a top view thereof;

FIG. 4 is a bottom view thereof;

FIG. 5 is a right side elevational view thereof;

FIG. 6 is a left side elevational view thereof;

FIG. 7 is a side view of the height indicator in FIG. 1 shown on a basketball goal support apparatus; and,

FIG. 8 is another side view of the height indicator in FIG. 1 shown on a portion of a basketball goal support apparatus.

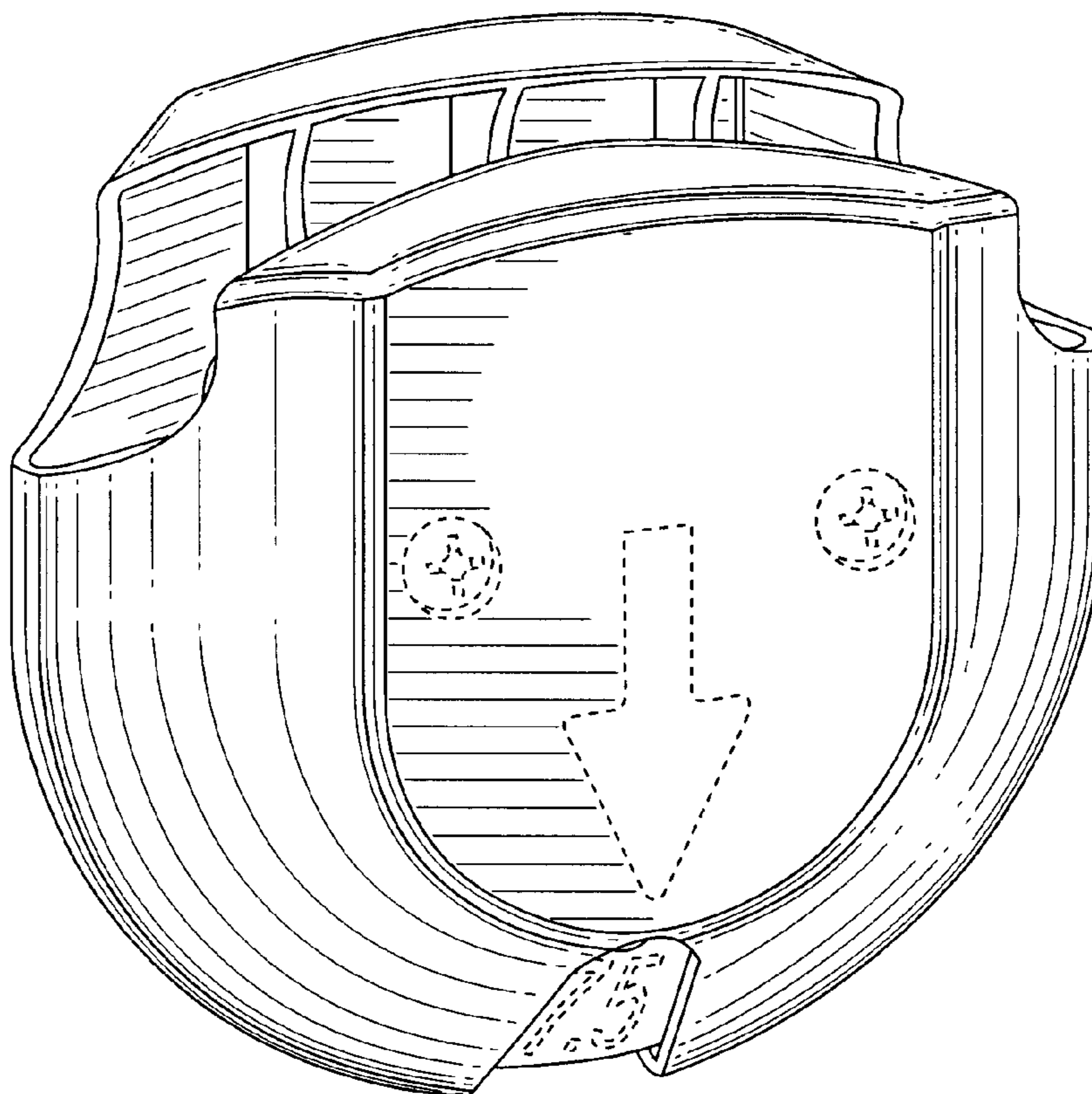
The broken lines shown in the Figures are for illustrative purposes only and form no part of the claimed design.

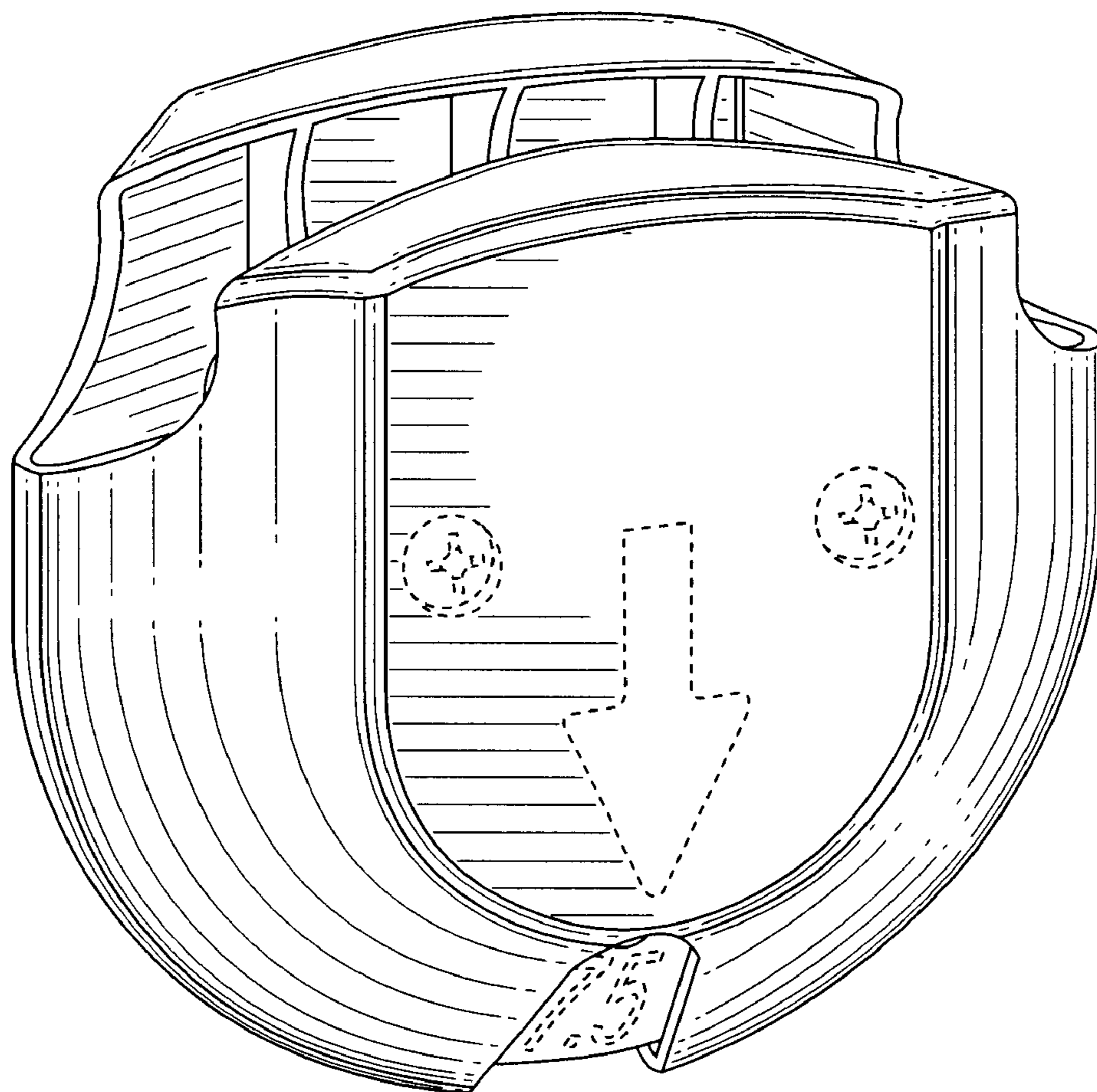
(56) **References Cited**

**U.S. PATENT DOCUMENTS**

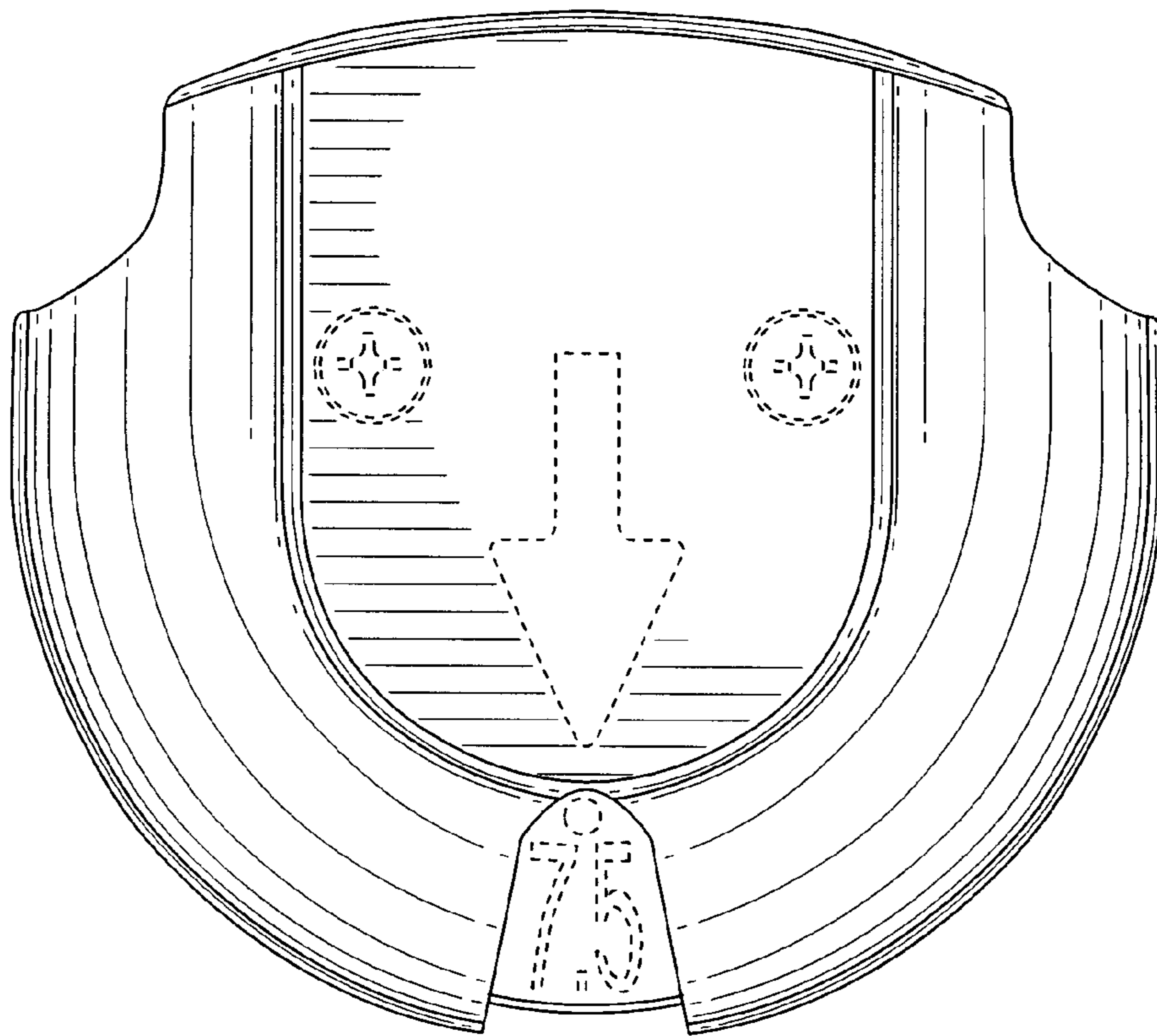
596,855	A	*	1/1898	Foss et al.	.....	56/67
D206,105	S	*	10/1966	Foster	.....	D10/65
RE32,570	E	*	1/1988	Conn	.....	241/141
4,798,087	A	*	1/1989	Takeda et al.	.....	33/366.23
4,852,266	A	*	8/1989	Whitman et al.	.....	33/366.11
5,001,838	A	*	3/1991	Huxley et al.	.....	33/388
D389,756	S	*	1/1998	Gruetzmacher	.....	D10/65

**1 Claim, 6 Drawing Sheets**

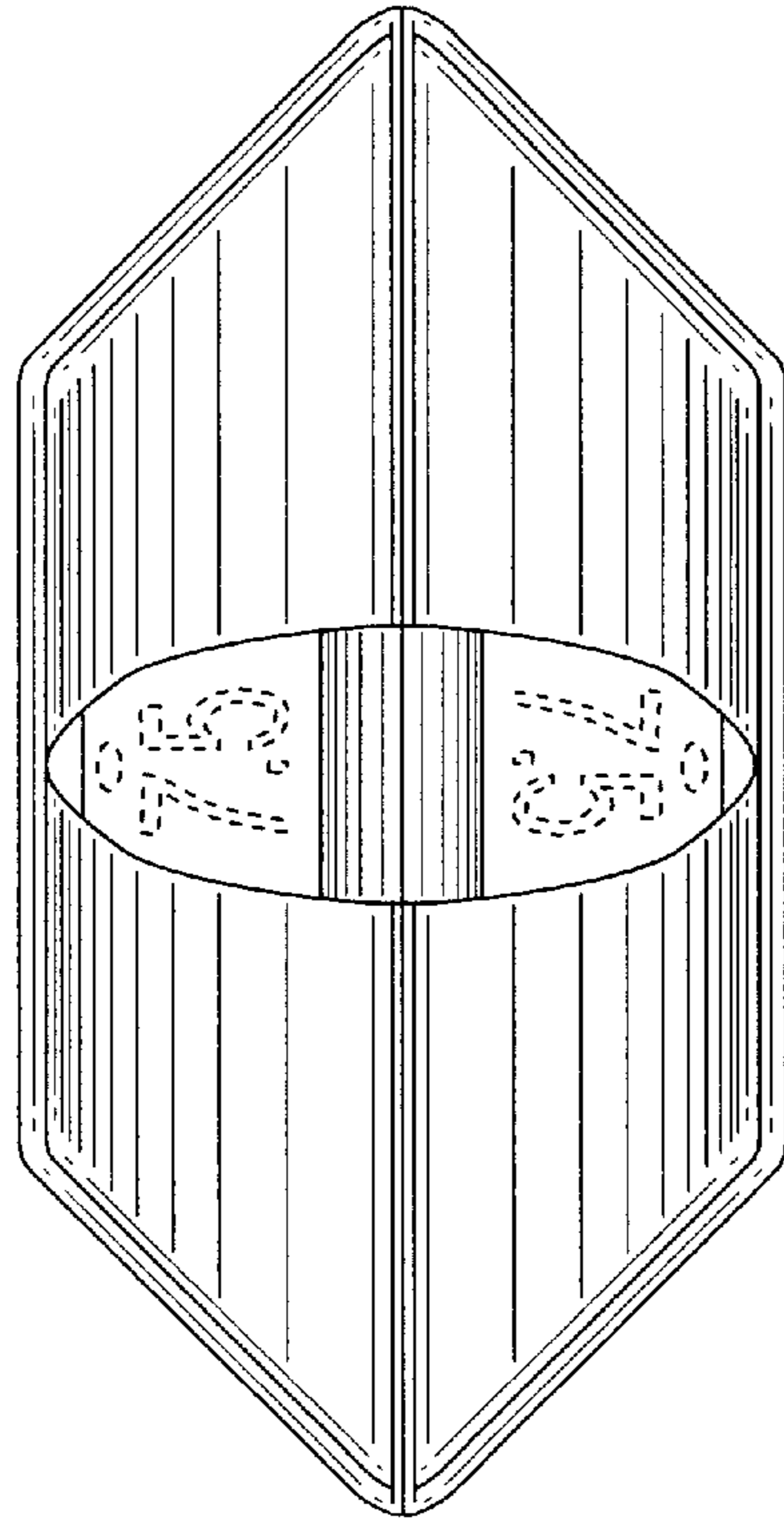




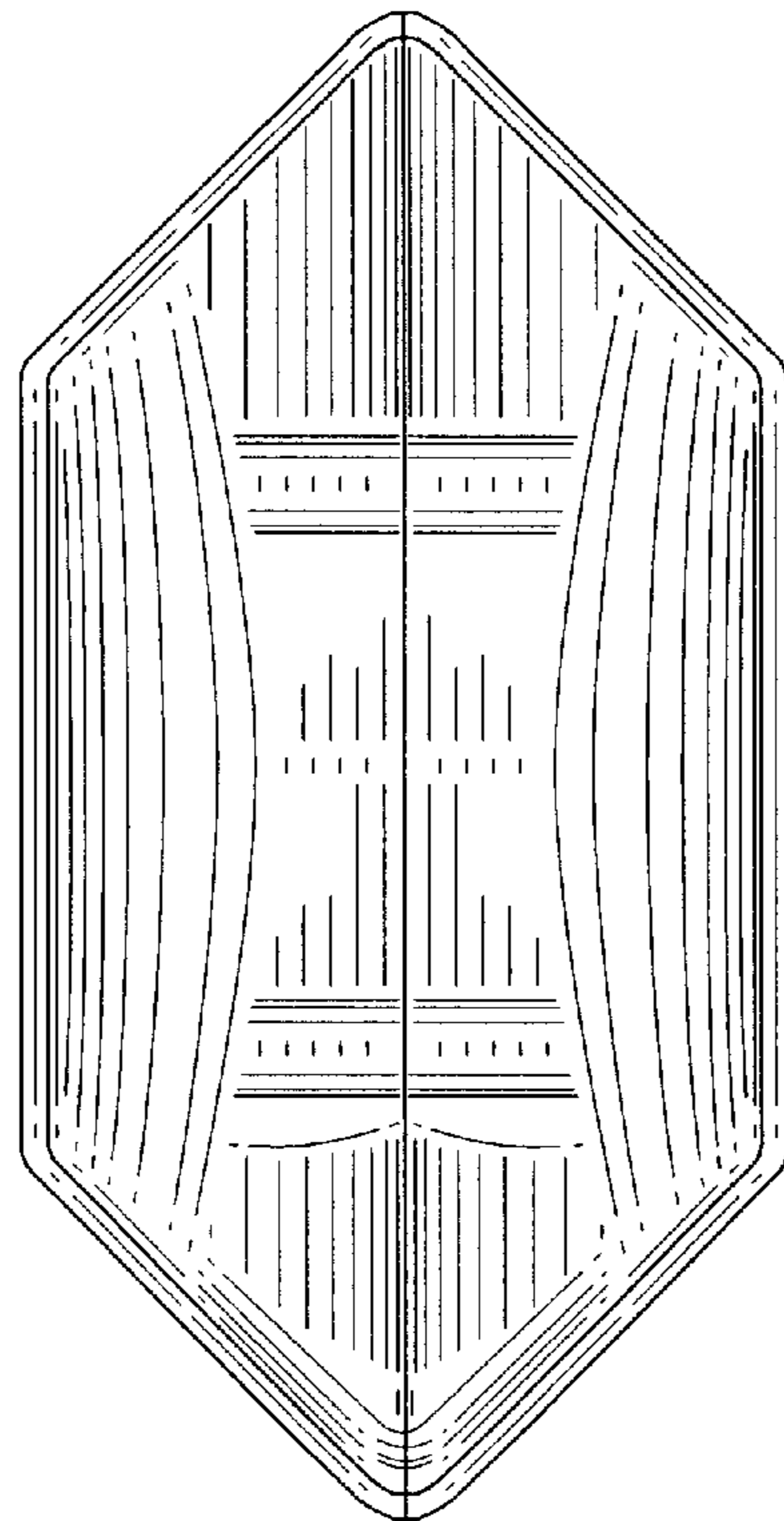
**FIG. 1**



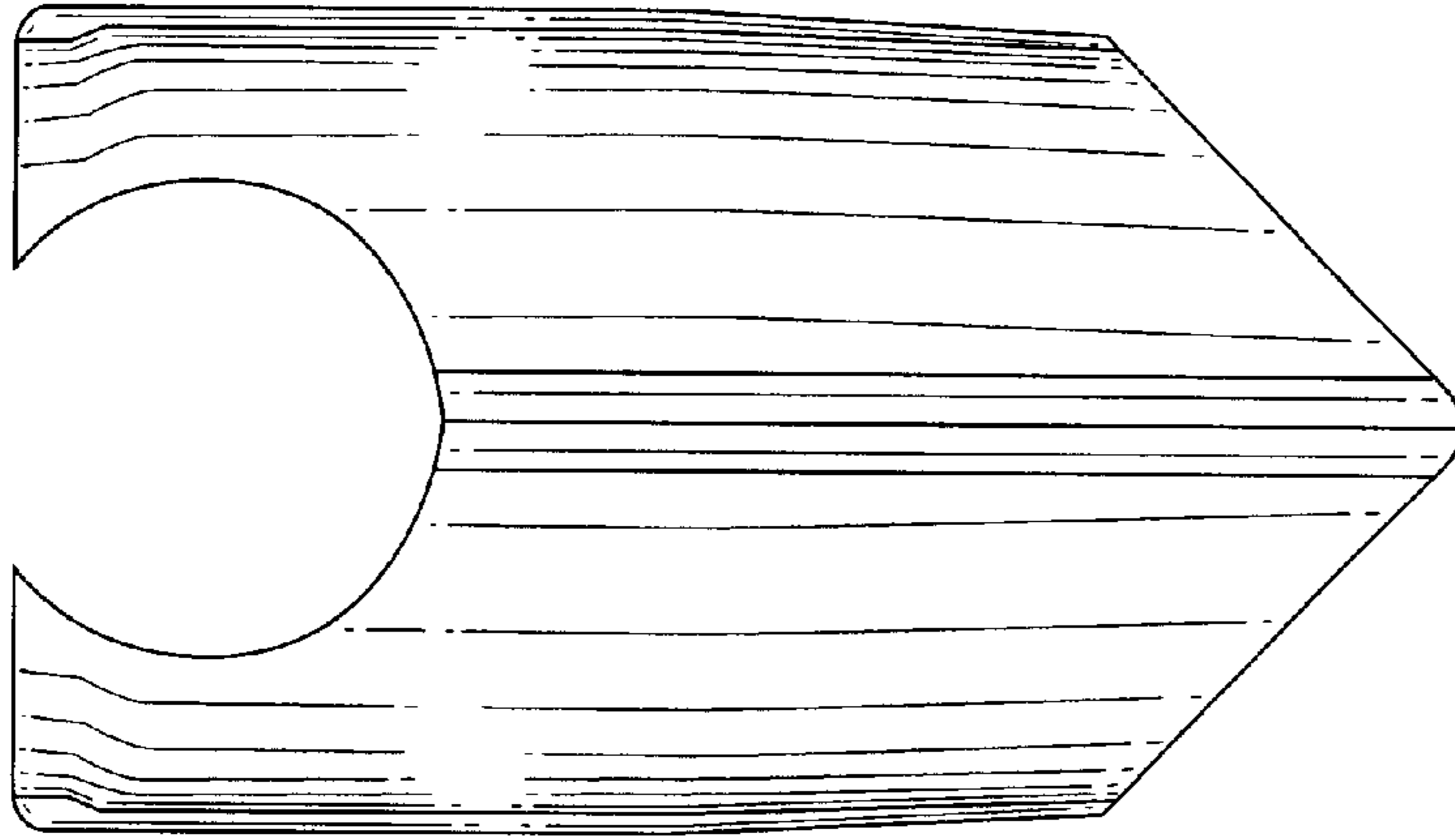
**FIG. 2**



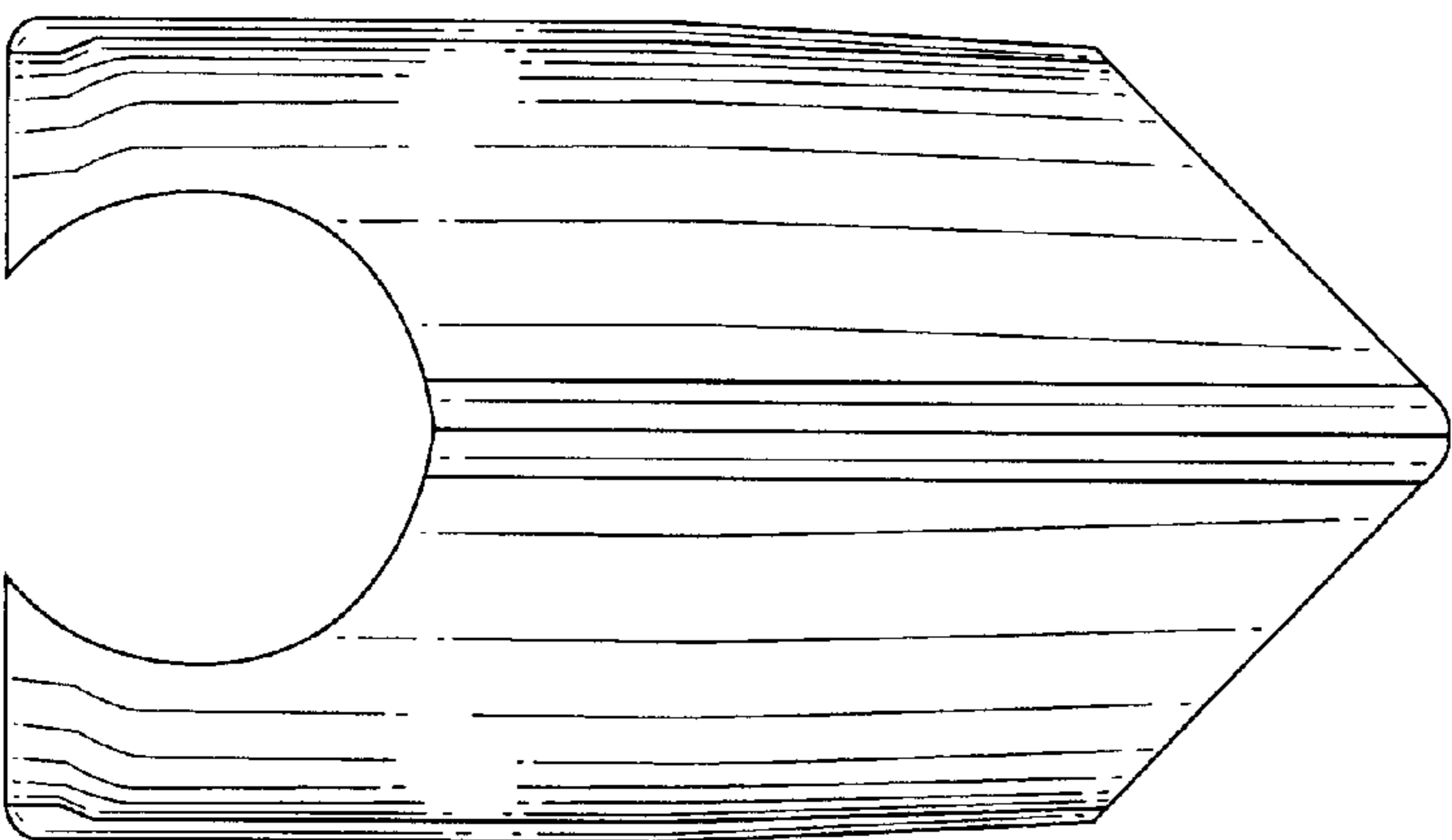
**FIG. 4**



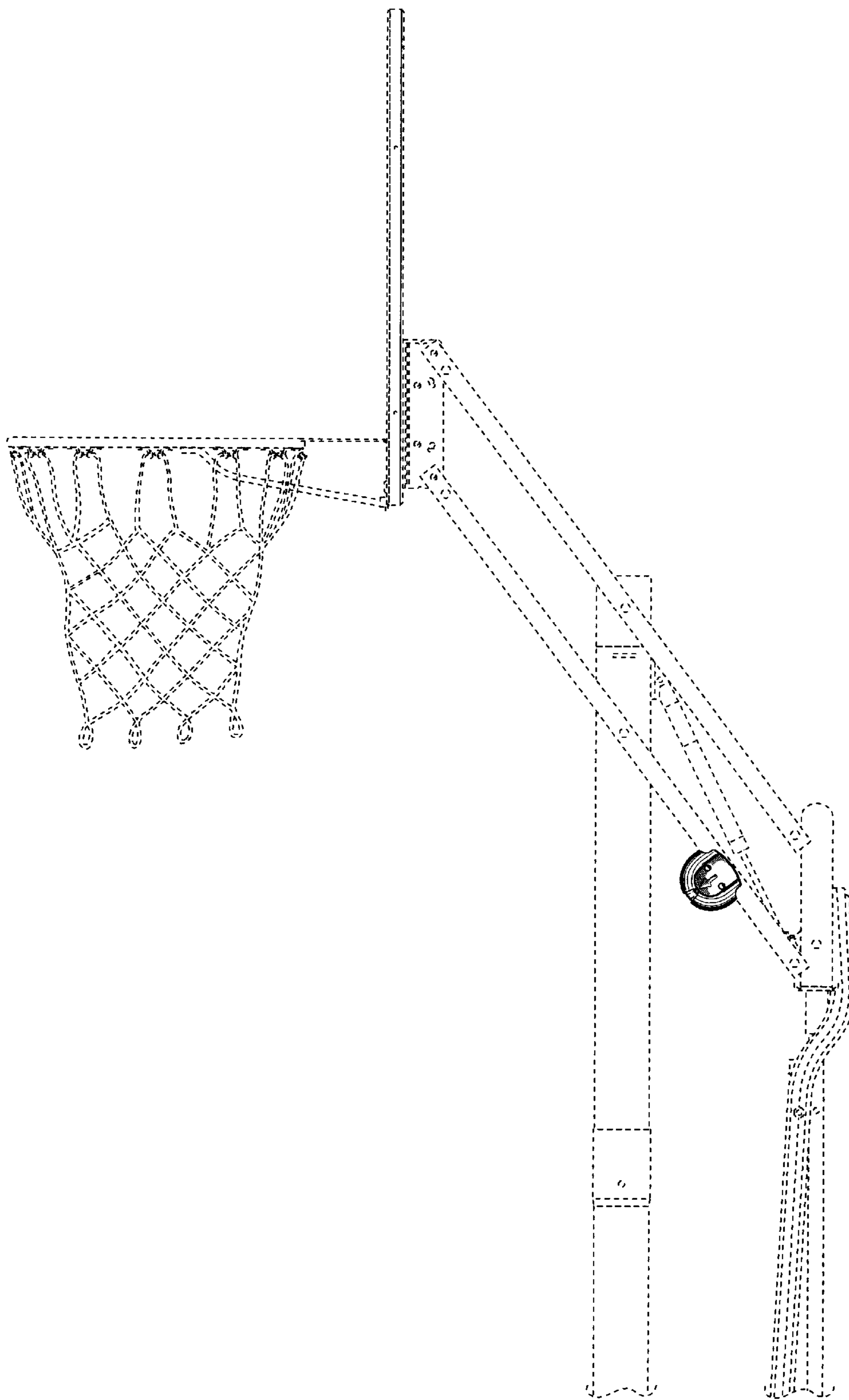
**FIG. 3**



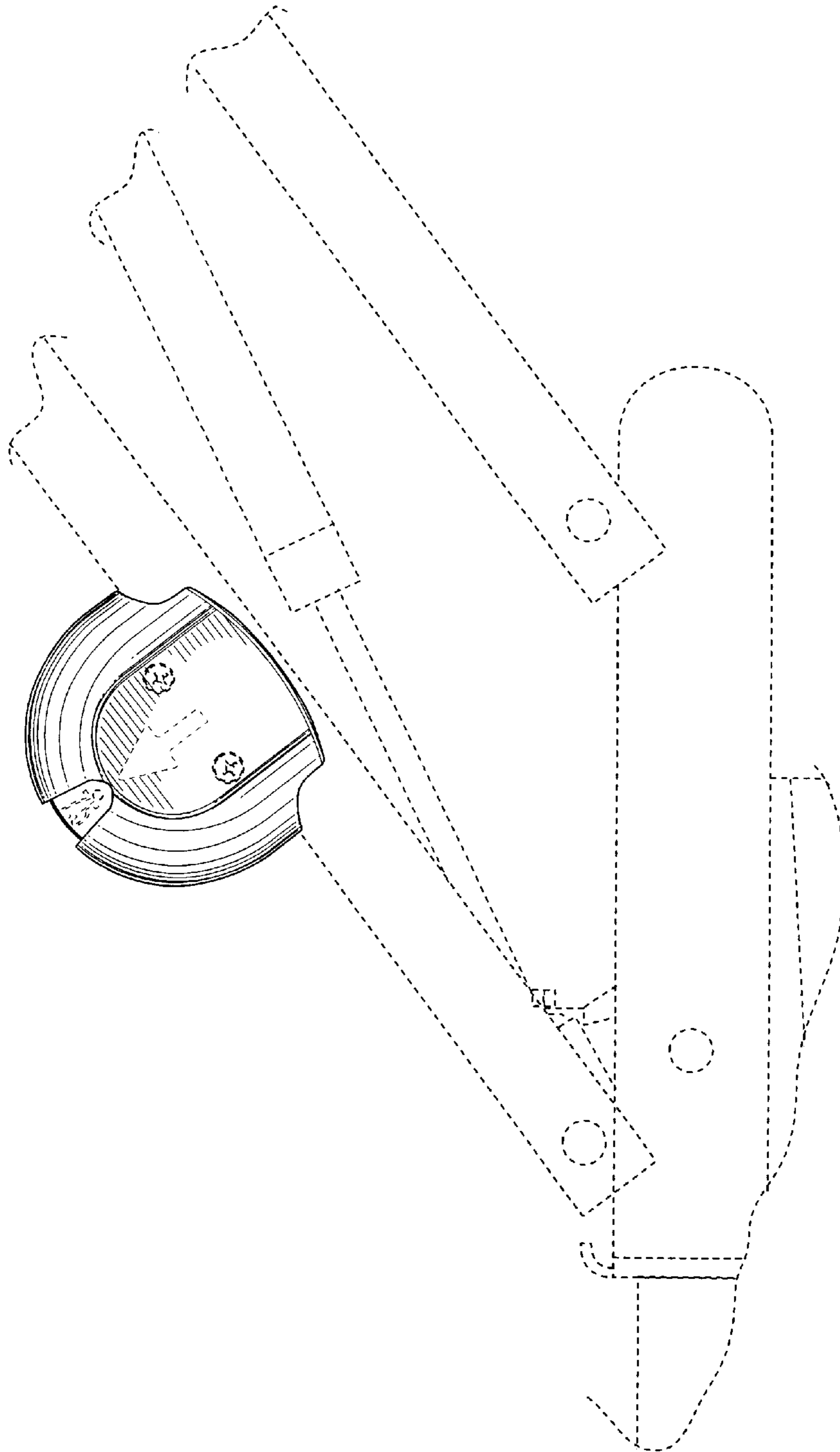
**FIG. 5**



**FIG. 6**



**FIG. 7**



**FIG. 8**