

US00D539489S

(12) **United States Design Patent**
Scott

(10) **Patent No.:** **US D539,489 S**

(45) **Date of Patent:** **** Mar. 27, 2007**

(54) **TWO-HANDLED LEASH**

(76) **Inventor:** **Randall W. Scott**, 533 S. Aurora St.,
Stockton, CA (US) 95203

(**) **Term:** **14 Years**

(21) **Appl. No.:** **29/230,402**

(22) **Filed:** **May 23, 2005**

(51) **LOC (8) Cl.** **30-04**

(52) **U.S. Cl.** **D30/153**

(58) **Field of Classification Search** 119/792-98,
119/758, 760, 769-70, 712, 784, 802, 856,
119/857, 863, 865; D30/151-54; 54/71; 441/75;
128/878, 882, DIG. 15; D29/120.1-120.2
See application file for complete search history.

(56) **References Cited**

U.S. PATENT DOCUMENTS

4,638,764	A *	1/1987	Anderson	119/770
4,751,896	A *	6/1988	Miley	119/770
5,724,921	A *	3/1998	Bell	119/795
6,237,539	B1 *	5/2001	Sporn	119/795
6,439,168	B1 *	8/2002	Maglich et al.	119/795
6,701,873	B2 *	3/2004	Fradette, II	119/784

* cited by examiner

Primary Examiner—M. H. Tung

Assistant Examiner—Susan Moon Lee

(74) *Attorney, Agent, or Firm*—Basil Travis

(57) **CLAIM**

The ornamental design for a two-handed leash, as shown and described.

DESCRIPTION

FIG. 1 is a front, side and top perspective view of my new design of a two-handed leash, the broken lines are for illustrational purposes and form no part of the claimed design;

FIG. 2 is an enlarged partial view thereof taken from section 2—2 of FIG. 1;

FIG. 3 is an enlarged partial view thereof taken from section 3—3 of FIG. 1;

FIG. 4 is an enlarged partial view thereof taken from section 4—4 of FIG. 1;

FIG. 5 is a front elevational view;

FIG. 6 is a top plan view;

FIG. 7 is a right side elevational view;

FIG. 8 is a left side elevational view;

FIG. 9 is a bottom plan view; and,

FIG. 10 is a rear elevational view.

1 Claim, 2 Drawing Sheets

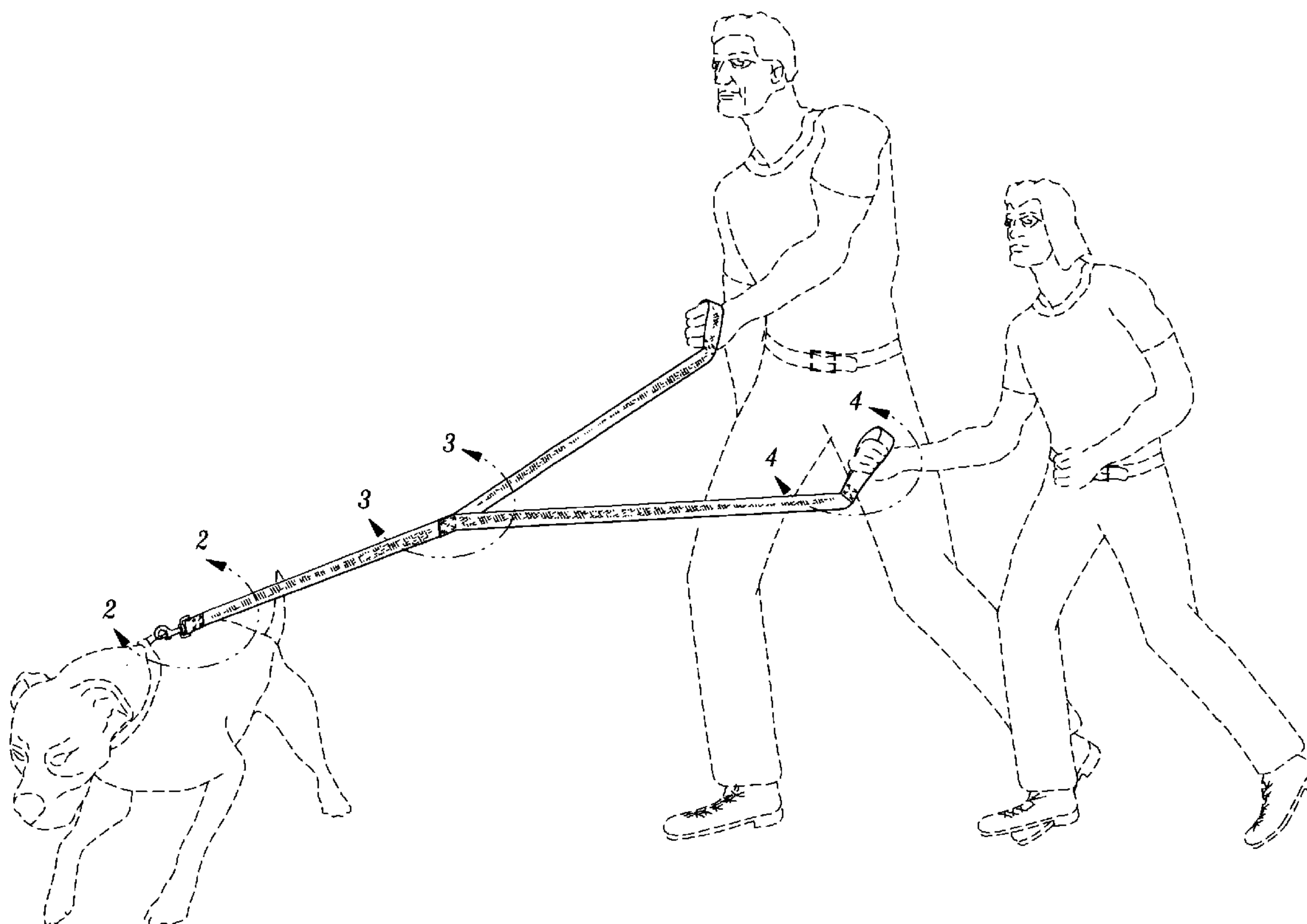

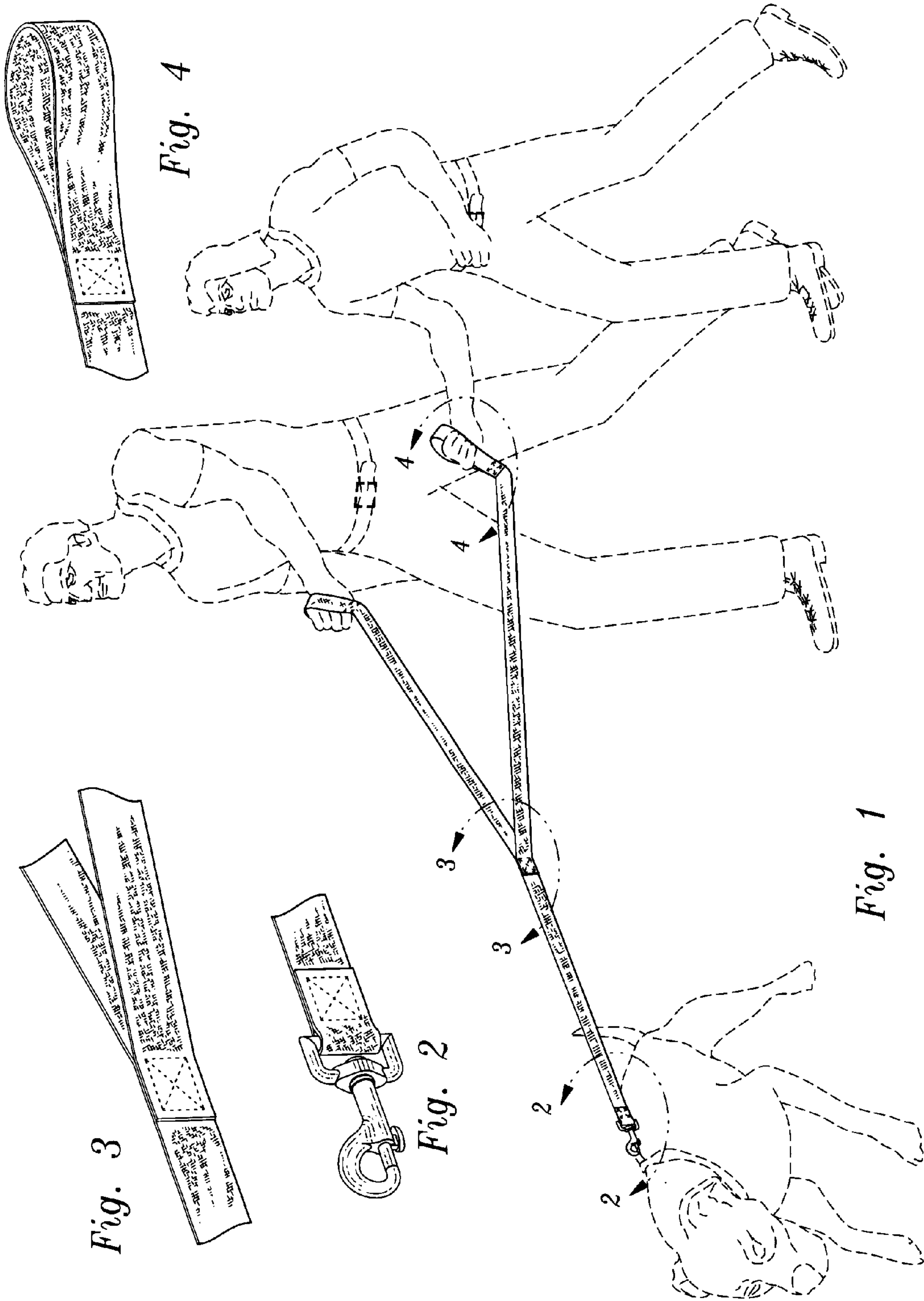

Fig. 3

Fig. 2

Fig. 4

Fig. 1

