



US00D539062S

(12) **United States Design Patent**
Styka et al.

(10) **Patent No.:** **US D539,062 S**
(45) **Date of Patent:** **** Mar. 27, 2007**

(54) **SLIDING BATHROOM SINK DRAWER**

(76) Inventors: **Kimberly A. Styka**, 2522 Renata Ct.,
Thousand Oaks, CA (US) 91362;
Thomas A. Derrico, 2522 Renata Ct.,
Thousand Oaks, CA (US) 91362

(**) Term: **14 Years**

(21) Appl. No.: **29/217,570**

(22) Filed: **Nov. 18, 2004**

(51) **LOC (8) Cl.** **06-06**

(52) **U.S. Cl.** **D6/510**

(58) **Field of Classification Search** D6/491,
D6/509-511, 402, 481, 500; 312/330.1, 334.1,
312/228, 348.5, 334.24, 334.28, 348.3
See application file for complete search history.

(56) **References Cited**

U.S. PATENT DOCUMENTS

1,270,496	A	6/1918	Cimaglia	
1,684,589	A *	9/1928	Kirts	312/212
1,853,989	A	4/1932	Nuebel	
1,866,314	A	7/1932	Meldahl	
2,376,032	A	5/1945	Clare	
2,723,894	A	11/1955	Bartleson	
3,272,583	A *	9/1966	Averdieck	312/334.38
3,292,983	A	12/1966	Service	
D250,867	S *	1/1979	Elliott	D6/510
D297,080	S *	8/1988	Hemberg	D6/430
D351,079	S *	10/1994	Brown	D6/510

D370,806	S	6/1996	Sklovsky	D6/510
D387,923	S *	12/1997	McKinney	D6/429
5,947,573	A	9/1999	Tovar et al.	312/404
D490,259	S *	5/2004	Schumann et al.	D6/510
2004/0004420	A1 *	1/2004	Pine et al.	312/348.3
2005/0099101	A1 *	5/2005	Lowe	312/228

* cited by examiner

Primary Examiner—Cathron C. Brooks

(74) *Attorney, Agent, or Firm*—Cislo & Thomas LLP

(57) **CLAIM**

We claim the ornamental design for a sliding bathroom sink drawer, as shown and described herein.

DESCRIPTION

FIG. 1 is a perspective view of our sliding bathroom sink drawer shown in an in-use location; FIG. 2 is a perspective view of the drawer shown in FIG. 1; FIG. 3 is a top view thereof; FIG. 4 is a bottom view thereof; FIG. 5 is a front view thereof; FIG. 6 is a rear view thereof; FIG. 7 is a right side elevational view thereof with the left side elevational view being a mirror image thereof; and, FIG. 8 is a perspective view of an alternative embodiment of our drawer, shown broken apart to indicate the adjustability of the drawer width. The broken lines showing in the drawings are for illustrative purposes only and form no part of the claimed design.

1 Claim, 5 Drawing Sheets

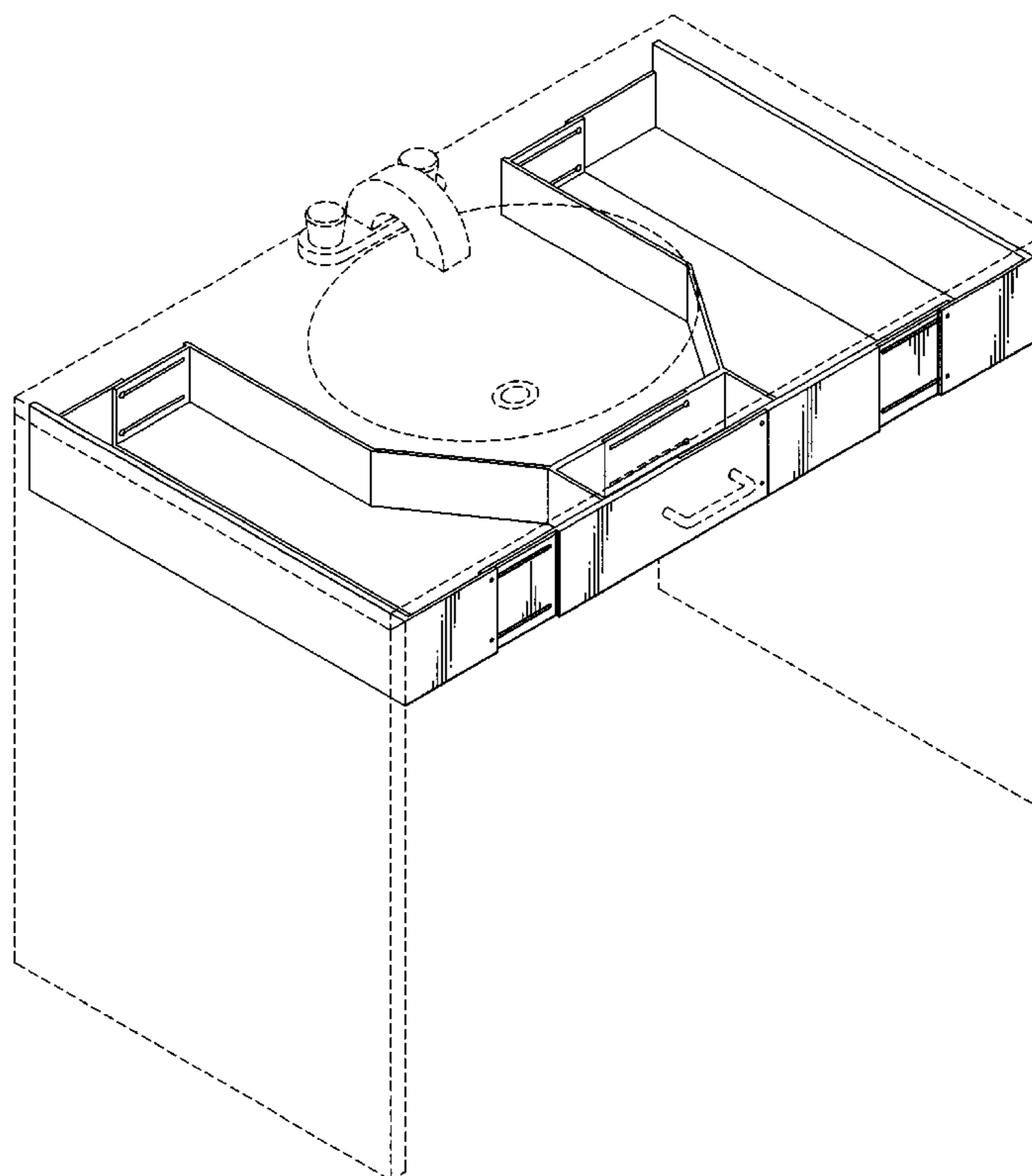

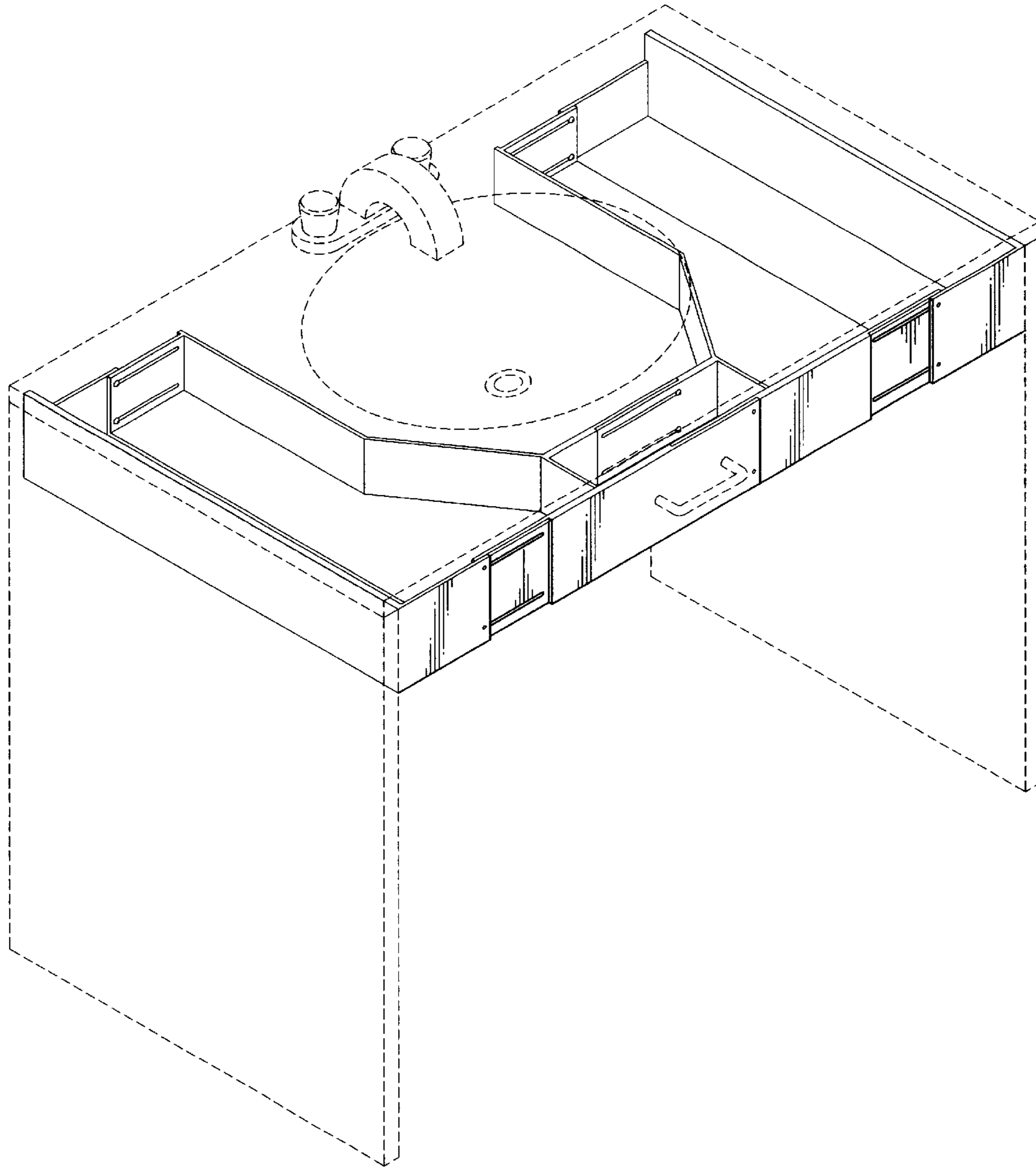

FIG. 1

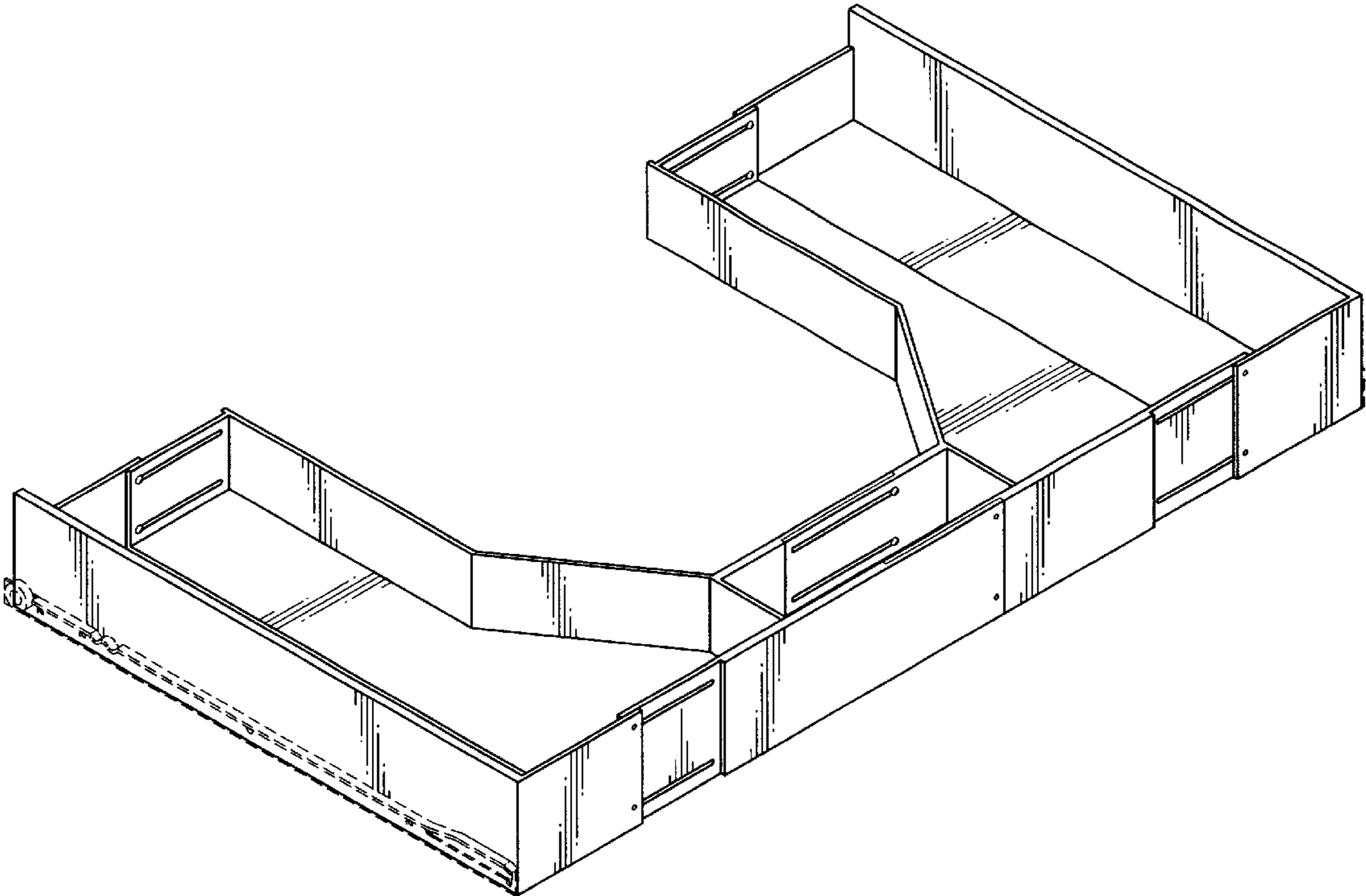

FIG. 2

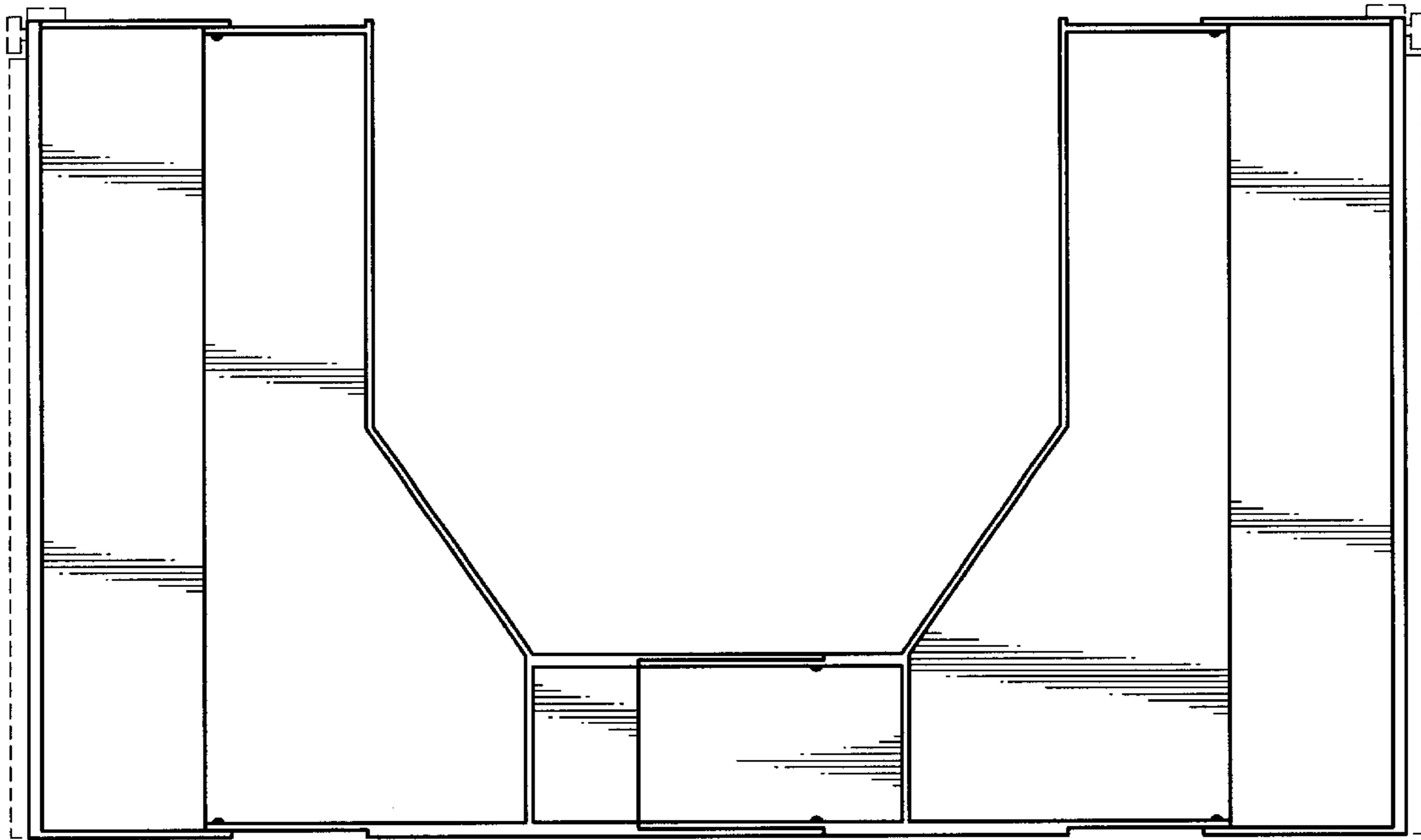

FIG. 3

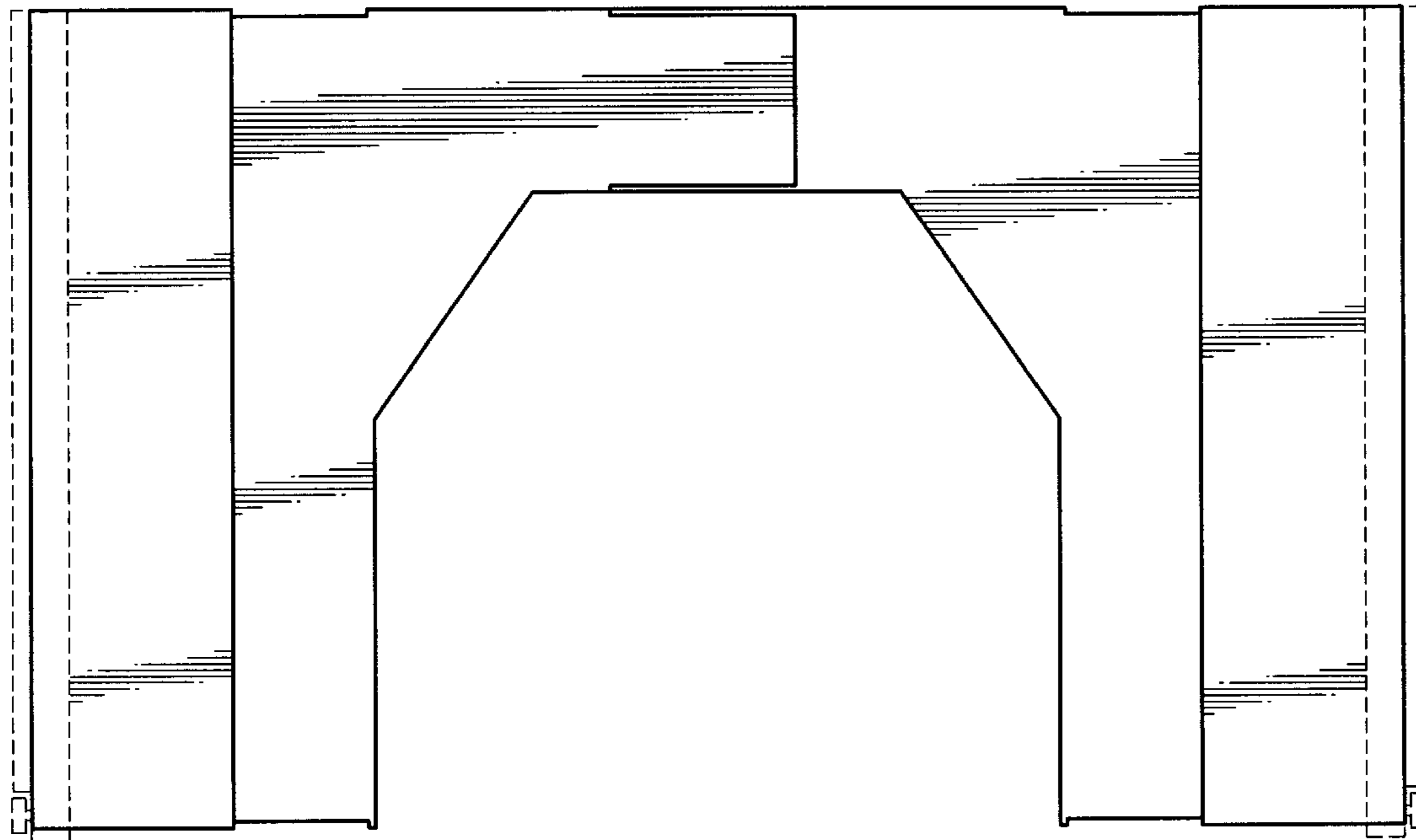

FIG. 4

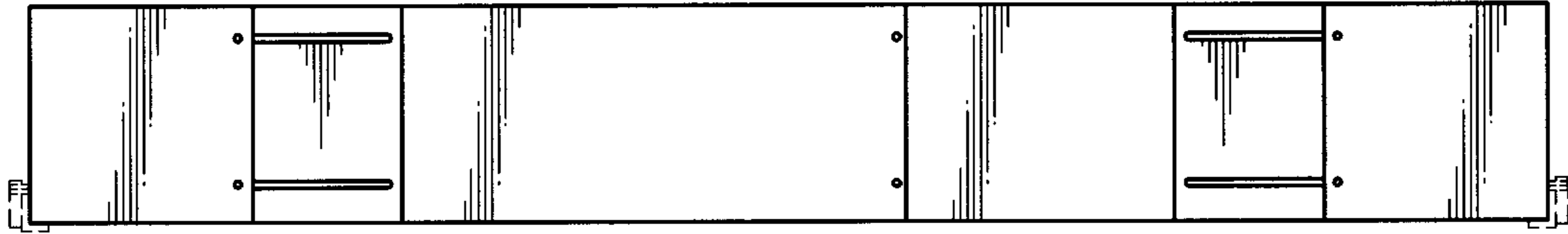

FIG. 5

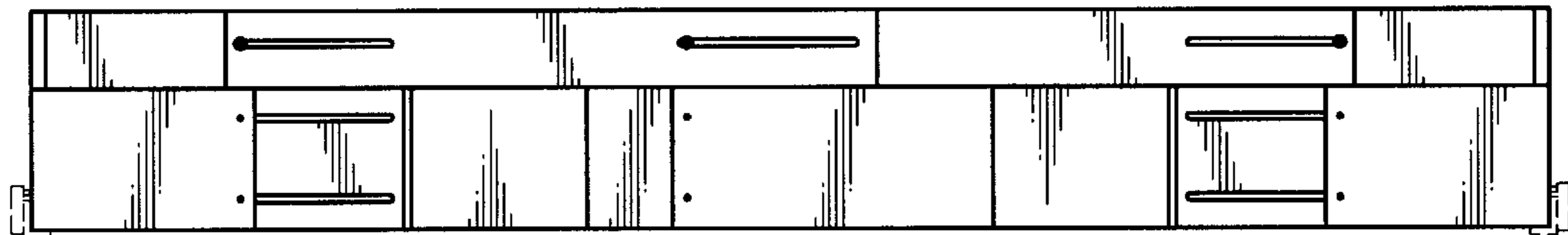

FIG. 6

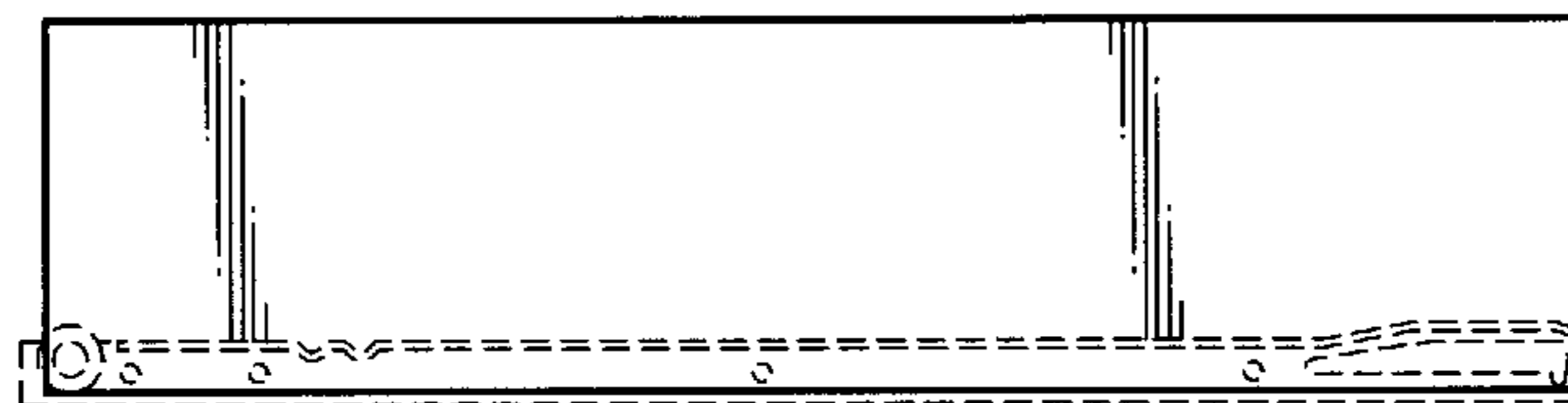

FIG. 7

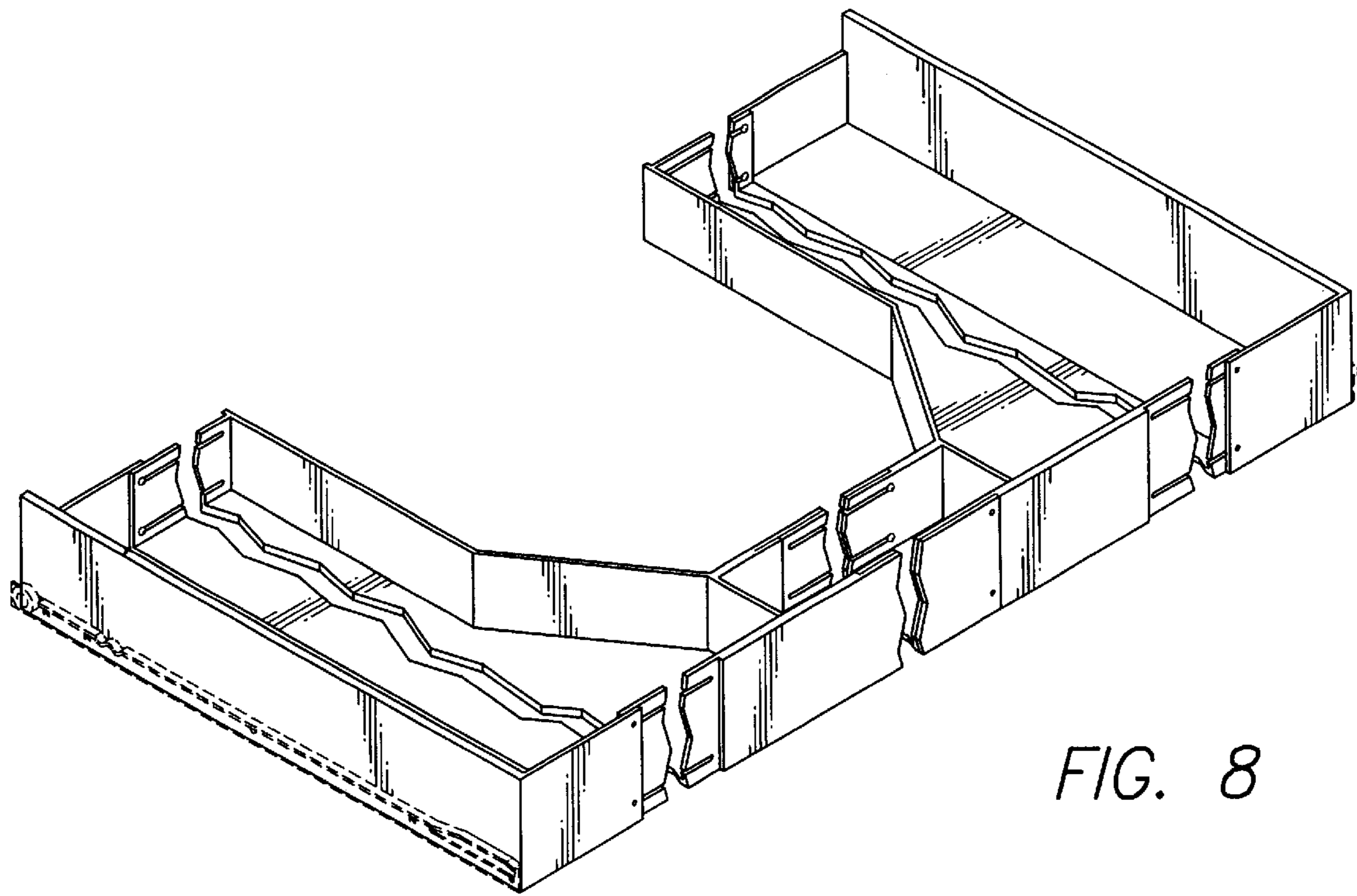

FIG. 8