



US00D539043S

(12) **United States Design Patent**
Gouldson

(10) **Patent No.:** **US D539,043 S**
(45) **Date of Patent:** **** Mar. 27, 2007**

(54) **INTIMATE APPAREL HANGER**

(75) **Inventor:** **Stanley F. Gouldson**, Northport, NY
(US)

(73) **Assignee:** **Spotless Plastics Pty. Ltd.**, Moorabbin
(AU)

(**) **Term:** **14 Years**

(21) **Appl. No.:** **29/195,380**

(22) **Filed:** **Dec. 10, 2003**

(51) **LOC (8) Cl.** **06-08**

(52) **U.S. Cl.** **D6/326**

(58) **Field of Classification Search** D6/326,
D6/315, 323, 328, 318; 211/113; 223/85,
223/88, 90-96; 40/322

See application file for complete search history.

(56) **References Cited**

U.S. PATENT DOCUMENTS

D196,214 S	*	9/1963	Warmath, III	D6/318
D348,987 S	*	7/1994	Gouldson et al.	D6/326
D350,236 S	*	9/1994	Gouldson et al.	D6/326
D371,246 S	*	7/1996	Gouldson et al.	D6/326
D388,620 S	*	1/1998	Gouldson et al.	D6/326
D388,964 S	*	1/1998	Gouldson	D6/326
D392,113 S	*	3/1998	Gouldson	D6/326
D394,754 S	*	6/1998	Gouldson	D6/328
D413,446 S	*	9/1999	Gouldson	D6/326
D414,946 S	*	10/1999	Gouldson	D6/326
6,105,835 A	*	8/2000	Hatakeyama	223/88
D439,751 S	*	4/2001	Gouldson	D6/326

* cited by examiner

Primary Examiner—Stella Reid

Assistant Examiner—Sandra C. Hill

(74) *Attorney, Agent, or Firm*—Scully, Scott, Murphy &
Presser

(57) **CLAIM**

The ornamental design for an intimate apparel hanger, as shown and described.

DESCRIPTION

FIG. 1 is an isometric perspective view of a first embodiment of a intimate apparel hanger;

FIG. 2 is a front elevation view of a first embodiment of a intimate apparel hanger, the rear elevation view being a mirror image thereof;

FIG. 3 is a plan view of a first embodiment of a intimate apparel hanger;

FIG. 4 is a bottom view of a first embodiment of a intimate apparel hanger;

FIG. 5 is a left side elevation view of a first embodiment of a intimate apparel hanger;

FIG. 6 is a right side elevation view of a first embodiment of a intimate apparel hanger;

FIG. 7 is an isometric perspective view of a second embodiment of a intimate apparel hanger;

FIG. 8 is a front elevation view of a second embodiment of a intimate apparel hanger, the rear elevation view being a mirror image thereof;

FIG. 9 is a plan view of a second embodiment of a intimate apparel hanger;

FIG. 10 is a bottom view of a second embodiment of a intimate apparel hanger;

FIG. 11 is a left side elevation view of a second embodiment of a intimate apparel hanger;

FIG. 12 is a right side elevation view of a second embodiment of a intimate apparel hanger;

FIG. 13 is an isometric perspective view of a third embodiment of a intimate apparel hanger;

FIG. 14 is a front elevation view of a third embodiment of a intimate apparel hanger, the rear elevation view being a mirror image thereof;

FIG. 15 is a plan view of a third embodiment of a intimate apparel hanger;

FIG. 16 is a bottom view of a third embodiment of a intimate apparel hanger;

FIG. 17 is a left side elevation view of a third embodiment of a intimate apparel hanger; and,

FIG. 18 is a right side elevation view of a third embodiment of a intimate apparel hanger.

1 Claim, 12 Drawing Sheets

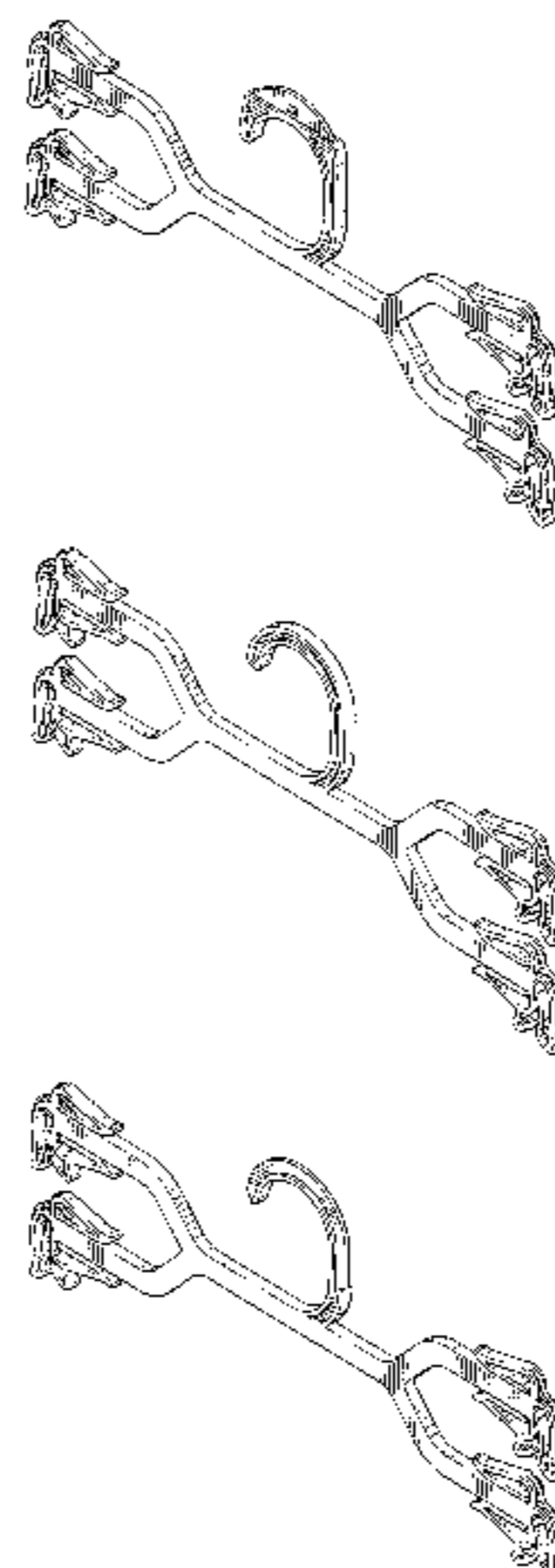

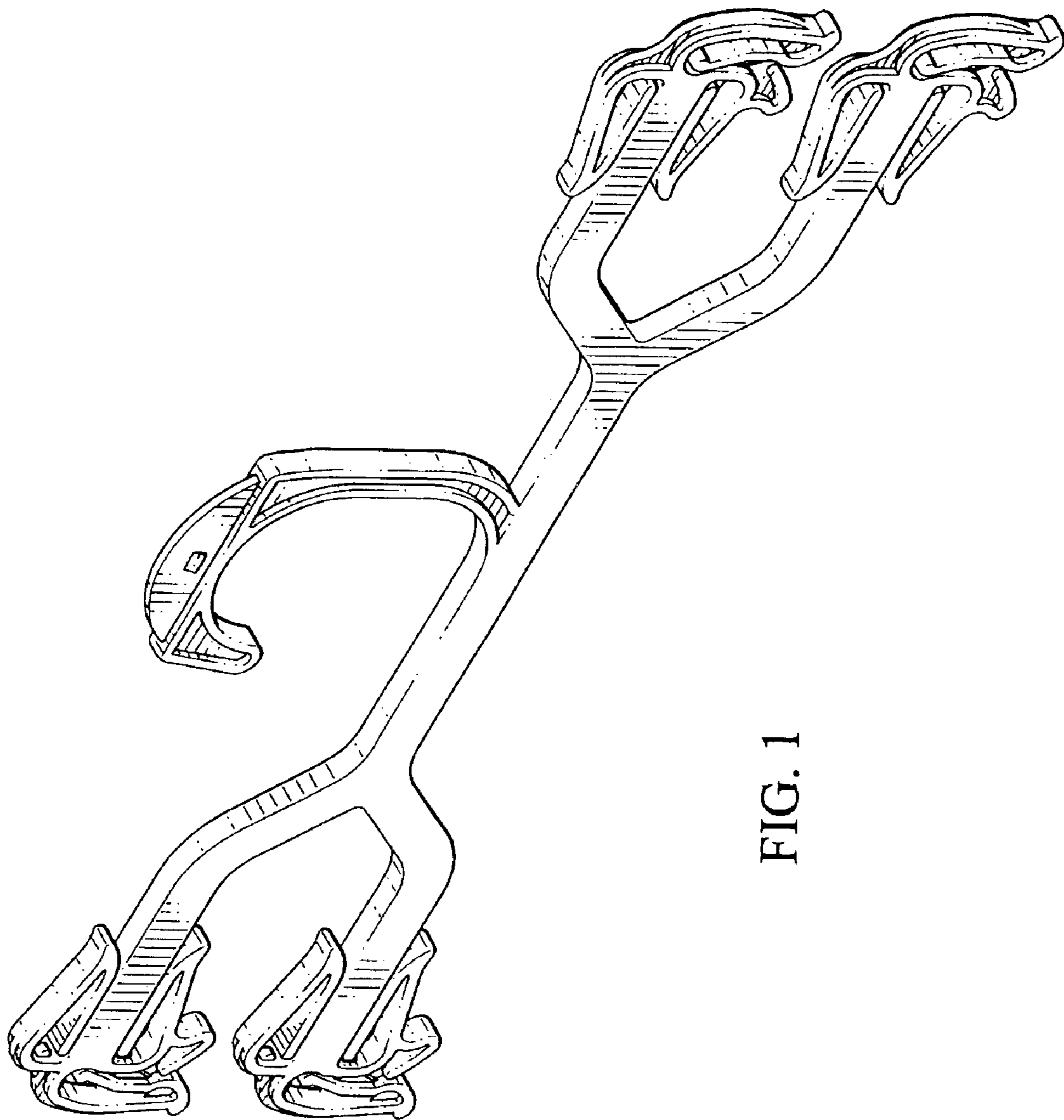

FIG. 1

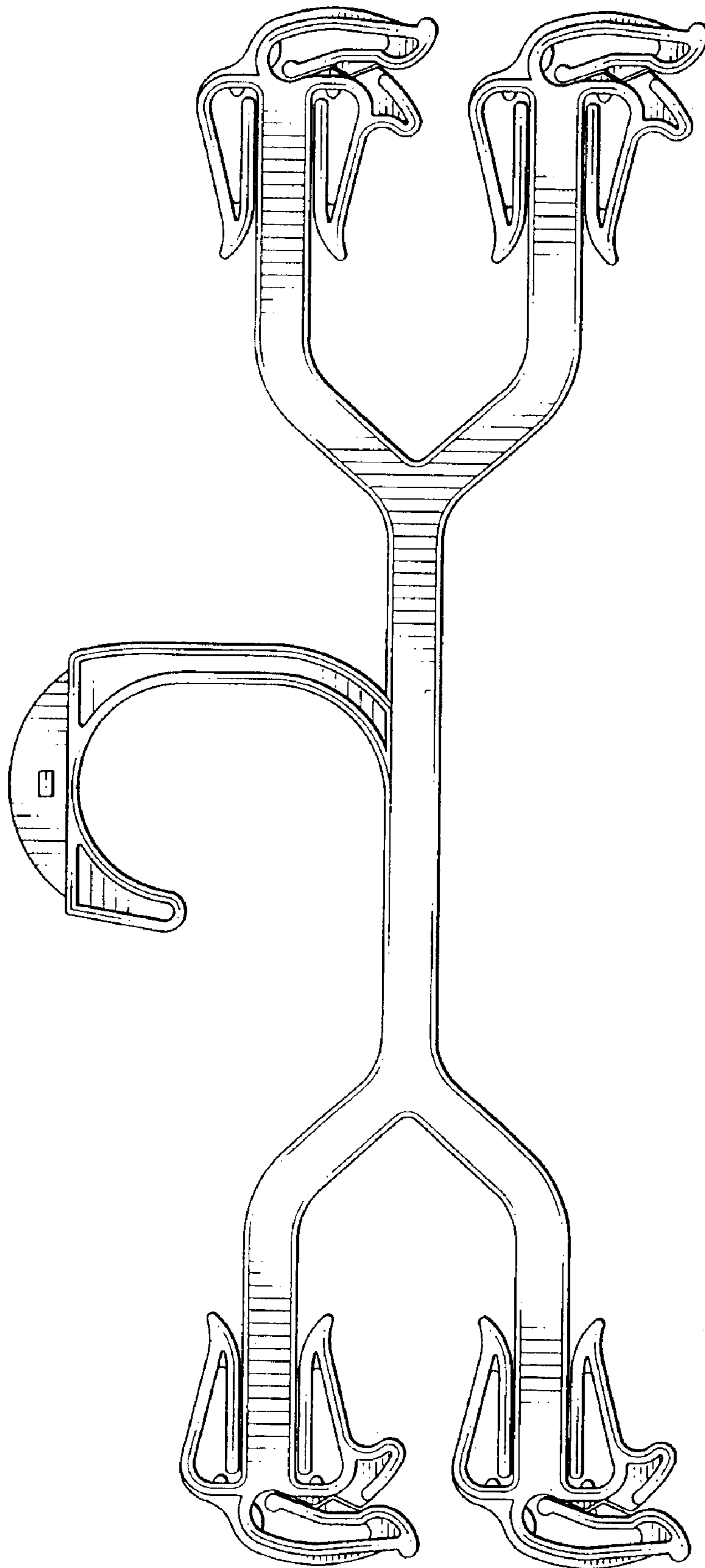

FIG. 2



FIG. 3

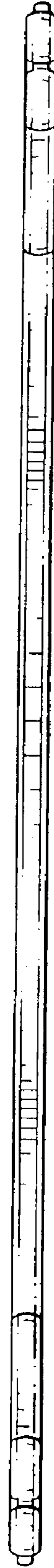

FIG. 4

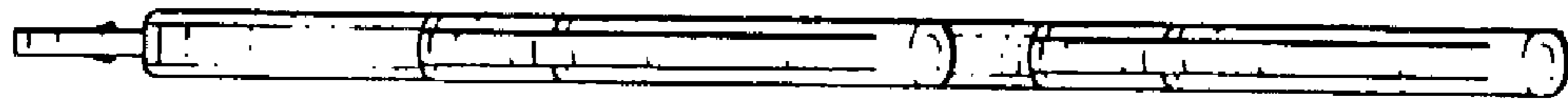

FIG. 6

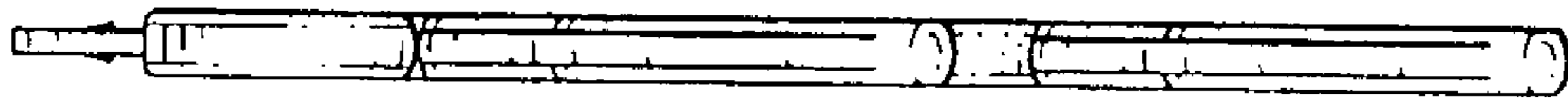

FIG. 5

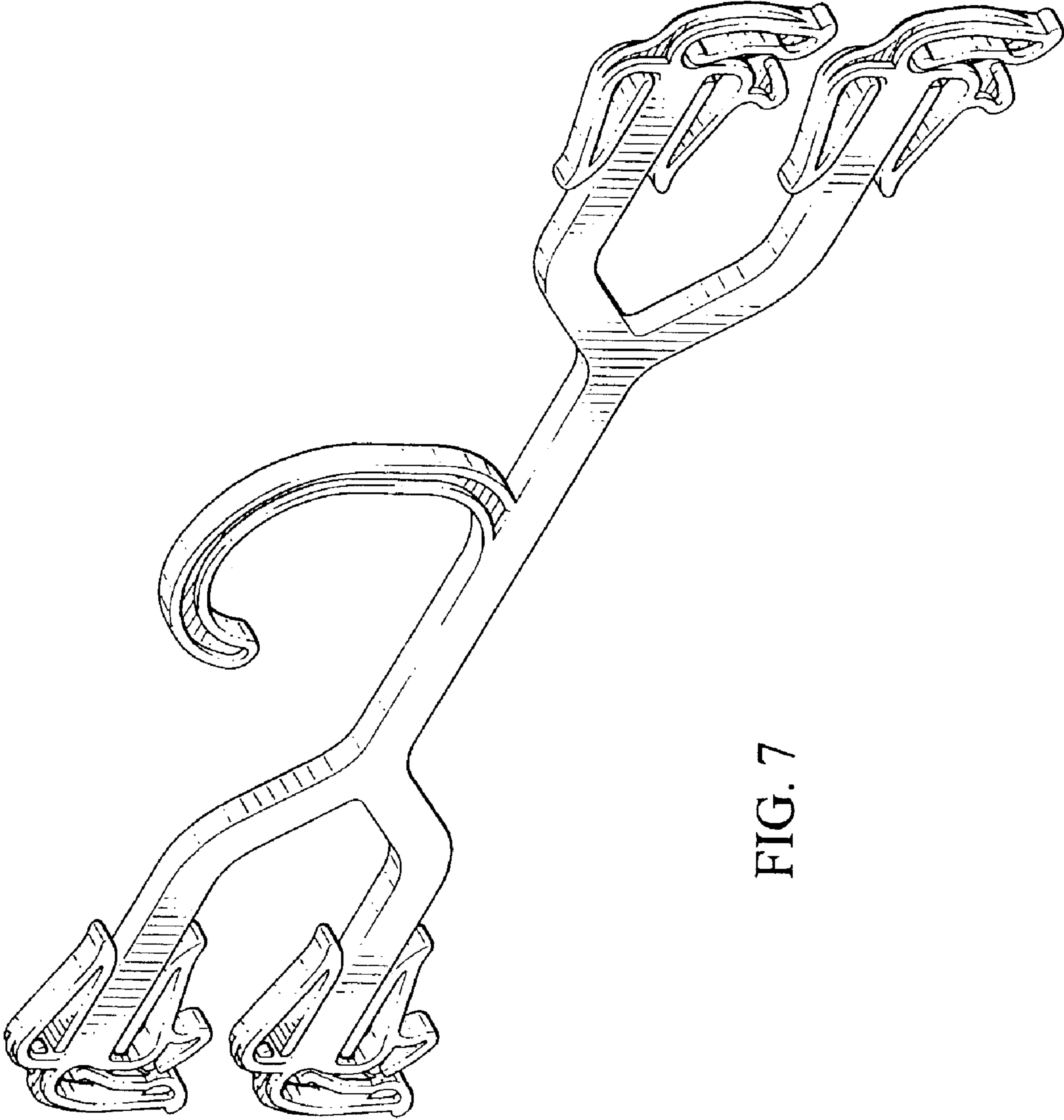

FIG. 7

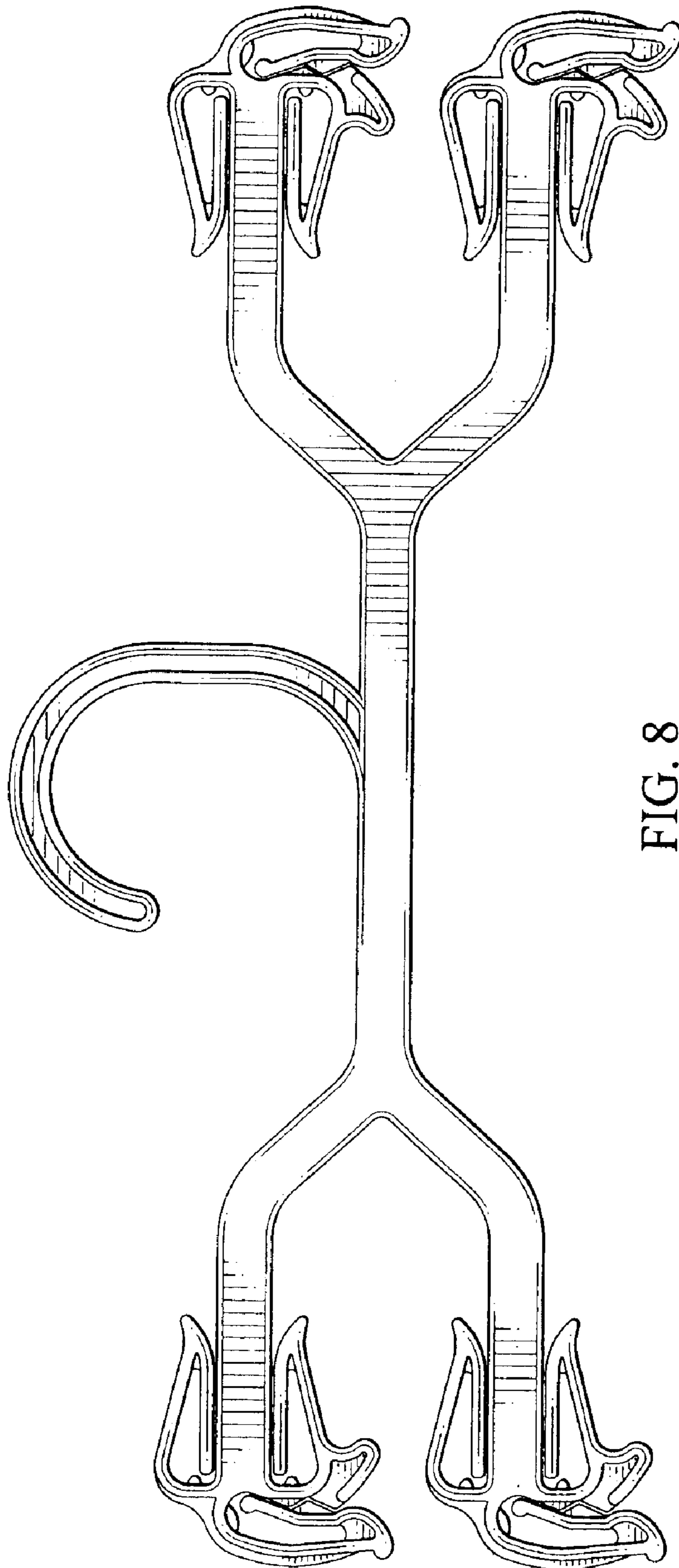

FIG. 8

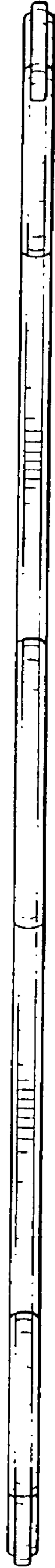

FIG. 9



FIG. 10

FIG. 12

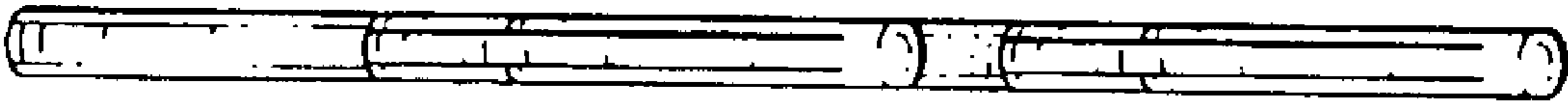
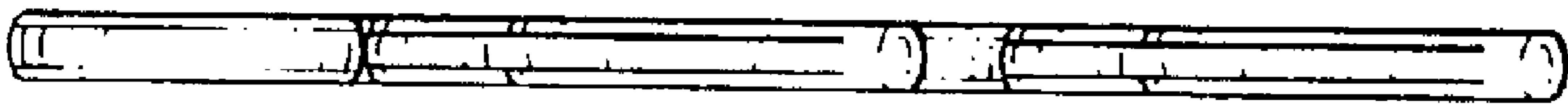

FIG. 11



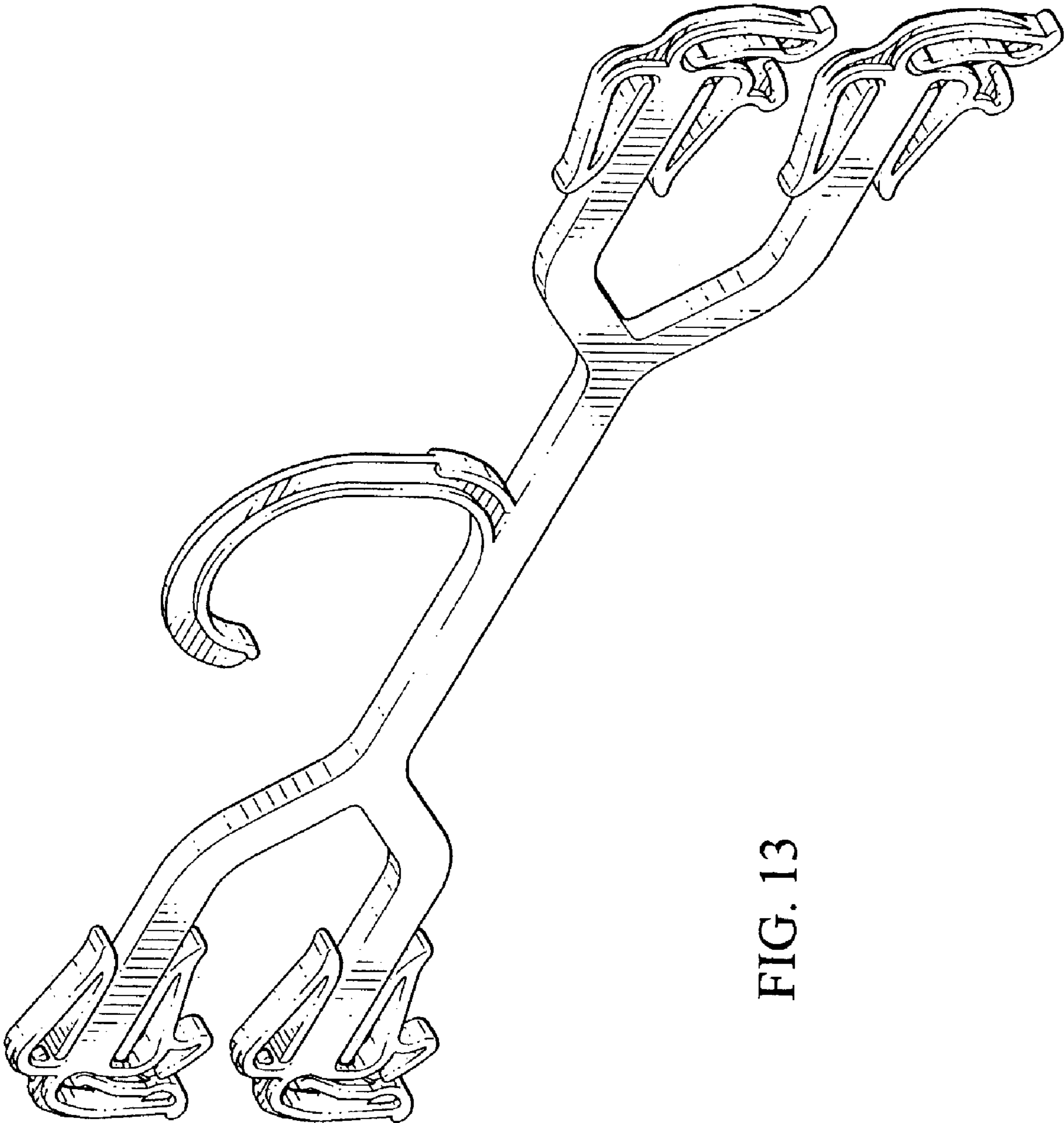

FIG. 13

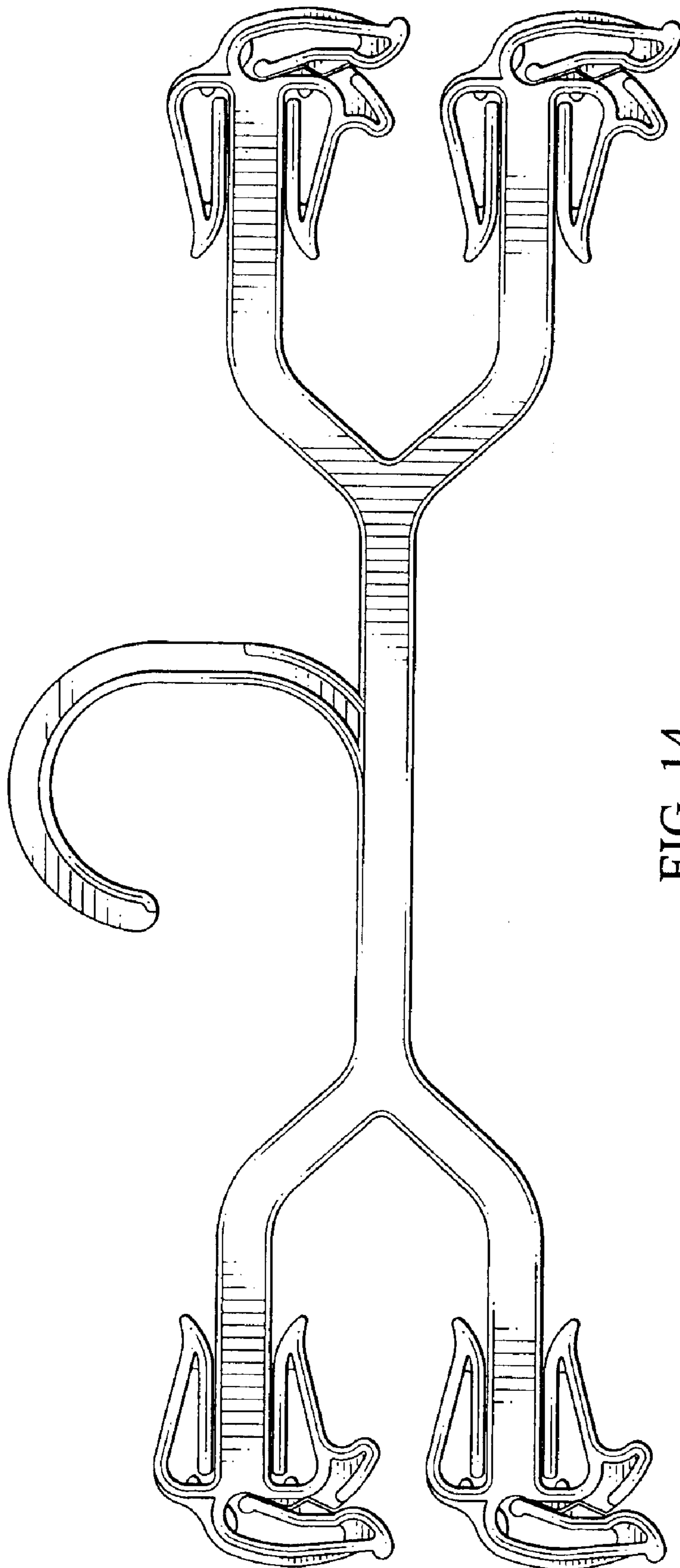

FIG. 14



FIG. 15



FIG. 16

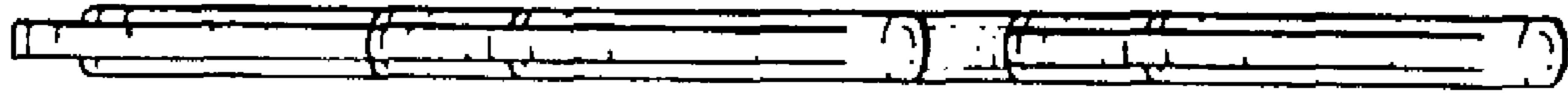

FIG. 17

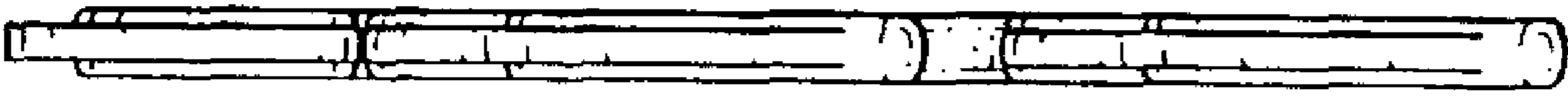

FIG. 18